

VILAS P. SHELDON

Consulting Geologist and Registered Land Surveyor  
Valuations, Appraisals, Geological Reports, Surveys

Carper Building

ARTESIA, NEW MEXICO

January 19, 1957

NSP-351

Dec 4 1957

cc - OGC - Hester  
1/21/57  
MAIN OFFICE OGC  
157 AM E. MI 8:44  
Mr. A. L. Porter  
New Mexico Oil Conservation Commission  
P.O. Box 871  
Santa Fe, New Mexico

all DE-398  
Dec 4/31/57

AMENDED APPLICATION

Dear Mr. Porter:

This letter constitutes an application for authorization to dually complete an oil - gas well and for approval of a non-standard gas proration unit.

1. Resler & Sheldon operates a well located 1980' from the south and 660' from the west lines of Section 20-T23S-R37E, Lea County, New Mexico.
2. The well above described is known as the Steeler #1. It was completed at a depth of 3668' as an oil well producing from the lower Queen sands and is prorated as being in the Langlie-Mattix oil field.
3. It is proposed to perforate the section between 3000' and 3100', to fracture the formation, and to produce gas through the casing-tubing annulus. The dual completion would be accomplished by setting a Halliburton type CL production packer at approximately 3120'.
4. The section from 3000' to 3100' is part of the Yates formation and being located in the NW $\frac{1}{4}$  SW $\frac{1}{4}$  of Section 20-T23S-R37E will be in the Jalmat gas pool.
5. The acreage dedicated to the gas well will be the SW $\frac{1}{4}$  of Section 20-T23S-R37E. It is herewith requested that this non-standard gas proration unit be approved.
6. A plat of the area showing the location, acreage dedicated, and the offset properties is attached hereto.
7. The applicant herewith states that copies of this application together with copies of the plat and copies of form C-128 have been furnished by mail to each offset operator, namely:

Gulf Oil Corporation, Box 669, Roswell, New Mexico  
Skelly Oil Company, Box 38, Hobbs, New Mexico  
Western Natural Gas Company, Box 1060, Jal, New Mexico  
R. Olsen Oil Company, Jal, New Mexico  
Amerada Petroleum Corporation, Box 591, Midland, Texas

Yours very truly,  
RESLER & SHELDON

*Vilas P. Sheldon*

Vilas P. Sheldon

GOVERNOR

EDWIN L. MECHEM  
CHAIRMAN

New Mexico

OIL CONSERVATION COMMISSION

LAND COMMISSIONER MURRAY E. MORGAN  
MEMBER

STATE GEOLOGIST A.L. PORTER JR.  
SECRETARY DIRECTOR



P. O. BOX 2045  
HOBBS, NEW MEXICO

February 26, 1957

Mr. A. L. Porter, Jr., Director  
Oil Conservation Commission  
Box 871  
Santa Fe, New Mex.

Dear Mr. Porter:

Please refer to NSP-351 on the Resler and Sheldon  
Steeler No. 1.

The above order reads 1980 feet from the North  
line and 660 feet from the West line and in the NW/4  
SW/4, Section 20, T-23-S, R-37-E.

The correct location is 1980 feet from the South  
line and 660 feet from the West line.

Yours very truly,

OIL CONSERVATION COMMISSION

*R. F. Montgomery*

R. F. Montgomery  
Proration Manager

RFM/mc

MAIN OFFICE  
OIL CONSERVATION COMMISSION  
BOX 2045  
HOBBS, NEW MEXICO  
1957 JAN 24 AM 8:43

Date Jan. 24, 1957

*Jan 2/20/57*

OIL CONSERVATION COMMISSION  
BOX 871  
SANTA FE, NEW MEXICO

Re: Proposed NSP 351  
Proposed NSL */*

Gentlemen:

I have examined the application dated 1/21/57  
for the Resler & Sheldon Steeler #1-L 20-23-37  
Operator Lease and Well No. S-T-R

and my recommendations are as follows:

O.K.---E.J.F.

O.K.---J.W.R.

Yours very truly,

OIL CONSERVATION COMMISSION

*E. J. Fischer*  
Engineer

NEW MEXICO  
OIL CONSERVATION COMMISSION

Form C-128

Well Location and/or Gas Proration Plat

Date January 14, 1957

Operator Resler & Sheldon Lease Steeler "A"

Well No. 1 Section 20 Township 23S Range 37E NMPM

Located 1980 Feet From South Line, 660 Feet From West Line,

Lea County, New Mexico. G. L. Elevation \_\_\_\_\_

Name of Producing Formation Yates Pool Jalmat Dedicated Acreage 160

(Note: All distances must be from outer boundaries of Section)

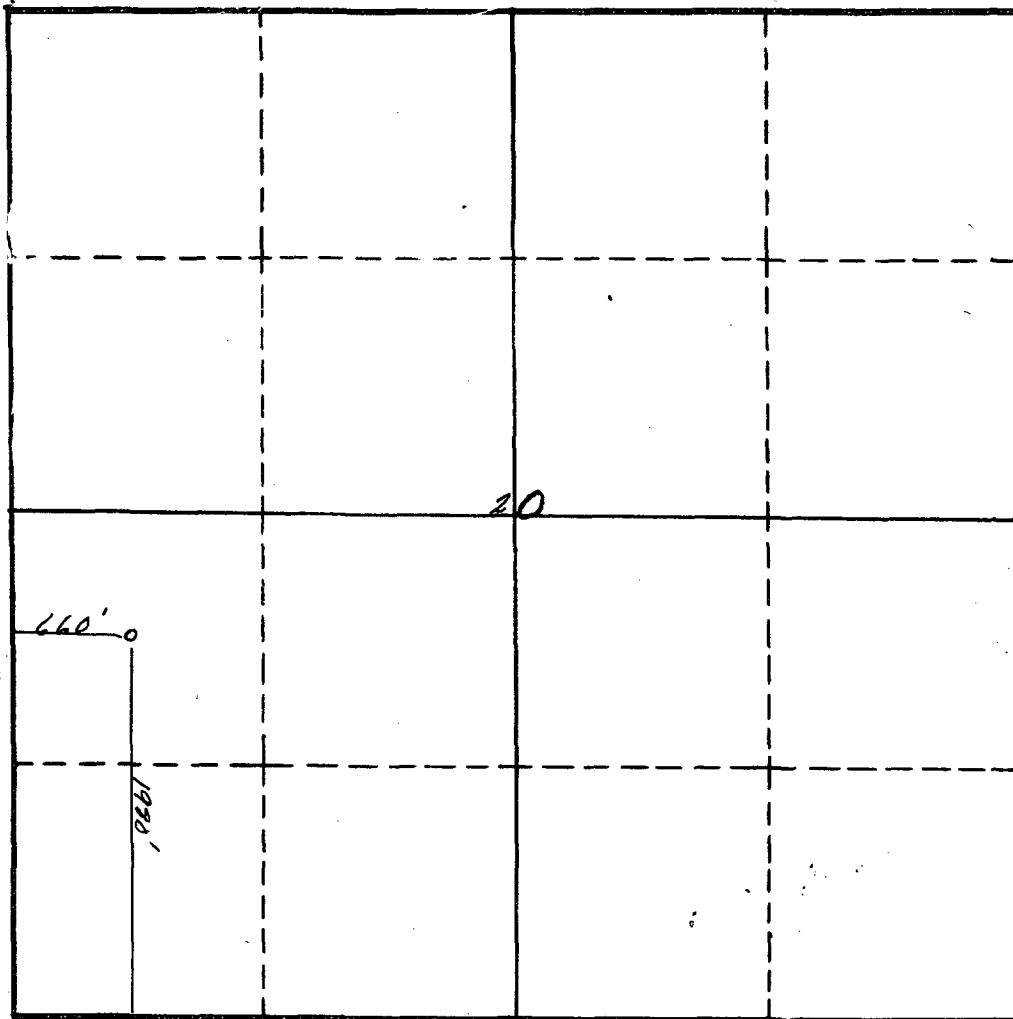

NOTE

This section of  
form is to be  
used for gas  
wells only.

SCALE: 1"=1000'

1. Is this Well a Dual Comp. ? Yes x No \_\_\_\_.
2. If the answer to Question 1 is yes, are there any other dually completed wells within the dedicated acreage ? Yes \_\_\_\_ No x.

Name Vilas B. Sheldon  
Position Partner  
Representing Resler & Sheldon  
Address 302 Carper Bldg., Artesia, New Mexico

This is to certify that the above plat was prepared from field notes of actual surveys made by me or under my supervision and that the same are true and correct to the best of my knowledge and belief.

Date Surveyed \_\_\_\_\_

Registered Professional Engineer and/or  
Land Surveyor