

El Paso NATURAL GAS
COMPANY

CONSERVATION

P.O. BOX 990

FARMINGTON, NEW MEXICO 87401

PHONE: 505-325-2841

EB 21 1973

NSL-927

October 20, 1977

Mr. Joe Ramey
New Mexico Oil Conservation Commission
Post Office Box 2088
Santa Fe, New Mexico 87501

Dear Mr. Ramey:

This is a request for administrative approval for an unorthodox gas well location in the Blanco Mesa Verde pool.

It is intended to locate the El Paso Natural Gas Company's El Paso #1A well at 500' from the North line and 1840' from the West line of Section 20, T-29-N, R-9-W, San Juan County, New Mexico.

Largo Canyon and Largo Wash cover most of the northern half of this section, making it impossible to build an orthodox gas well location.

All operators of proration units offsetting the proposed unorthodox location have been notified of this application by certified mail.

Plats showing the proposed well location and the terrain of Section 20, along with an ownership plat, are attached.

Yours truly,

Don Read

D. R. Read
Division Drilling Engineer

DRR:pb

NSL-927
Rul 104 F
March 16
I n n d w f e

EL PASO NATURAL GAS COMPANY

Well Name El Paso #1 A, Blanco Mesaverde

Footage---- 500' FNL, 1840' FWL

APPLICATION FOR NON-STANDARD LOCATION

County San Juan

State New Mexico

Section 20 Township 29N

Range 9W

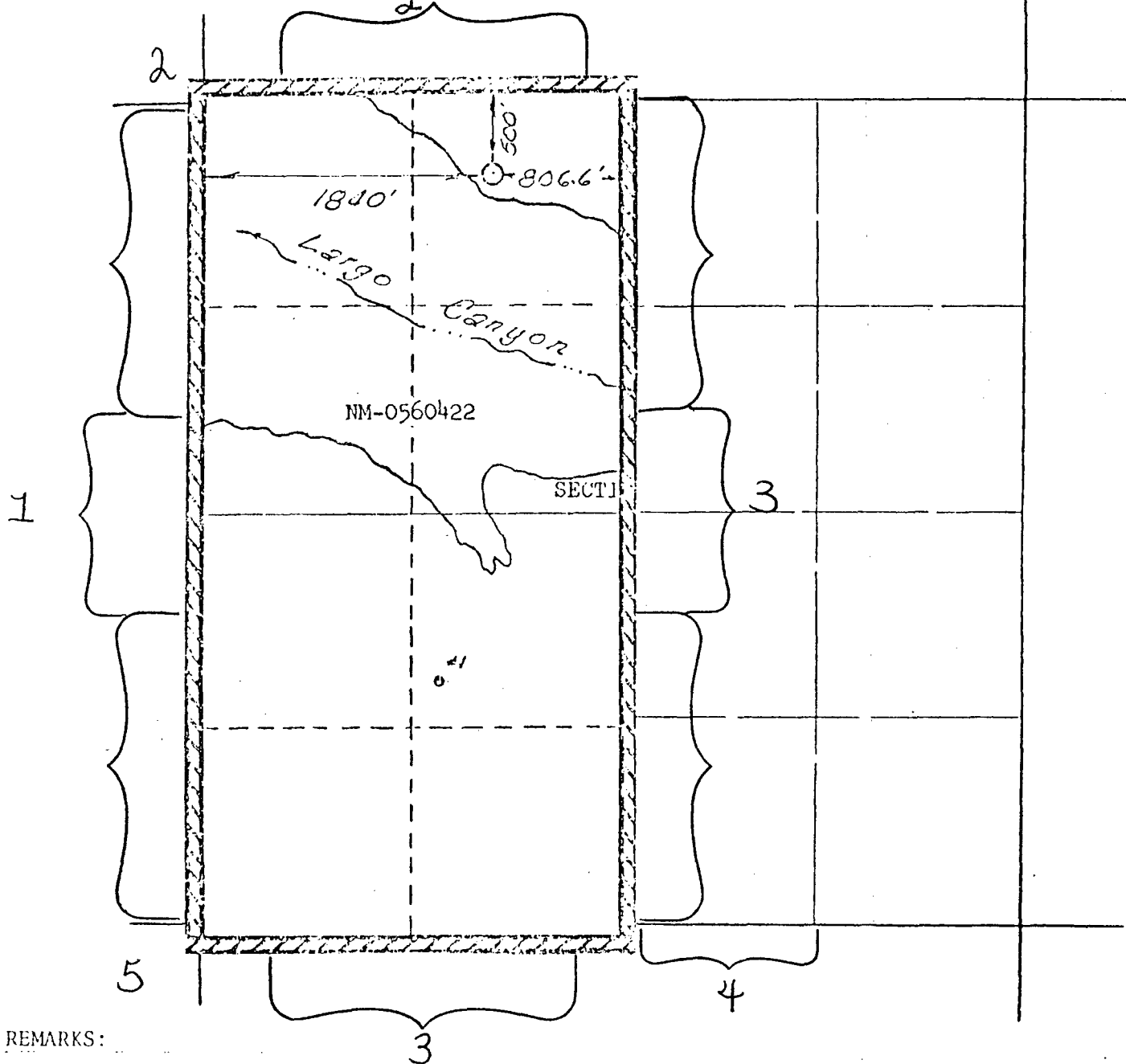

REMARKS:

- (1) El Paso Natural Gas Company
- (2) Amoco ✓
- (3) Tenneco Oil Company ✓
- (4) D. J. Simmons
- (5) Aztec Oil & Gas Company ✓

UNITED STATES
DEPARTMENT OF THE INTERIOR
GEOLOGICAL SURVEY

FEB 24 1978

5. LEASE DESIGNATION AND SERIAL NO.

NM 0560422

6. IF INDIAN, ALLOTTEE OR TRIBE NAME

7. UNIT AGREEMENT NAME

8. FARM OR LEASE NAME

El Paso

9. WELL NO.

1A

10. FIELD AND POOL, OR WILDCAT

Blanco Mesa Verde

11. SEC., T., R., M., OR BLK.
AND SURVEY OR AREASec. 20, T-29-N, R-9-W
NMPM

12. COUNTY OR PARISH 13. STATE

San Juan

NM

1a. TYPE OF WORK

DRILL ☒DEEPEN ☐PLUG BACK ☐

b. TYPE OF WELL

OIL
WELL ☐GAS
WELL ☒

OTHER

SINGLE
ZONE ☒MULTIPLE
ZONE ☐

2. NAME OF OPERATOR

El Paso Natural Gas Company

3. ADDRESS OF OPERATOR

PO Box 990, Farmington, NM 87401

4. LOCATION OF WELL (Report location clearly and in accordance with any State requirements.*)

At surface

500'N, 1840'W

At proposed prod. zone

14. DISTANCE IN MILES AND DIRECTION FROM NEAREST TOWN OR POST OFFICE*

15. DISTANCE FROM PROPOSED*

LOCATION TO NEAREST
PROPERTY OR LEASE LINE, FT.
(Also to nearest drlg. unit line, if any)

16. NO. OF ACRES IN LEASE

17. NO. OF ACRES ASSIGNED
TO THIS WELL

320.00

18. DISTANCE FROM PROPOSED LOCATION*
TO NEAREST WELL, DRILLING, COMPLETED,
OR APPLIED FOR, ON THIS LEASE, FT.

19. PROPOSED DEPTH

4720'

20. ROTARY OR CABLE TOOLS

Rotary

21. ELEVATIONS (Show whether DF, RT, GR, etc.)

5559'GL

22. APPROX. DATE WORK WILL START*

23.

PROPOSED CASING AND CEMENTING PROGRAM

SIZE OF HOLE	SIZE OF CASING	WEIGHT PER FOOT	SETTING DEPTH	QUANTITY OF CEMENT
13 3/4"	9 5/8"	32.3#	200'	224 cu.ft. to circulate
8 3/4"	7"	20.0#	2325'	322 cu.ft. to cover Ojo Alamo
6 1/4"	4 1/2" liner	10.5#	2175-4720'	443 cu.ft. to fill to 2175'

Selectively perforate and sandwater fracture the Mesa Verde formation.

A 3000 psi WP and 6000 psi test double gate preventer equipped with blind and pipe rams will be used for blow out prevention on this well.

This gas is dedicated.

The W/2 of Section 20 is dedicated to this well.

IN ABOVE SPACE DESCRIBE PROPOSED PROGRAM: If proposal is to deepen or plug back, give data on present productive zone and proposed new productive zone. If proposal is to drill or deepen directionally, give pertinent data on subsurface locations and measured and true vertical depths. Give blowout preventer program, if any.

24.

SIGNED

A. G. Davis

TITLE

Drilling Clerk

DATE

10-20-77

(This space for Federal or State office use)

PERMIT NO.

APPROVAL DATE

APPROVED BY

TITLE

DATE

CONDITIONS OF APPROVAL, IF ANY:

*See Instructions On Reverse Side

NEW MEXICO OIL CONSERVATION COMMISSION
WELL LOCATION AND ACREAGE DEDICATION PLAT

Form C-102
Supersedes C-128
Effective 1-1-65

All distances must be from the outer boundaries of the Section.

Operator EL PASO NATURAL GAS COMPANY		Lease EL PASO (NM-0560422)		Well No. 1A
Unit Letter C	Section 20	Township 29-N	Range 9-W	County SAN JUAN
Actual Footage Location of Well: 500 feet from the NORTH line and 1840 feet from the WEST line				
Ground Level Elev. 5559	Producing Formation MESA VERDE	Pool BLANCO MESA VERDE	Dedicated Acreage: 320.00 Acres	

1. Outline the acreage dedicated to the subject well by colored pencil or hachure marks on the plat below.
2. If more than one lease is dedicated to the well, outline each and identify the ownership thereof (both as to working interest and royalty).
3. If more than one lease of different ownership is dedicated to the well, have the interests of all owners been consolidated by communitization, unitization, force-pooling, etc?

☐ Yes ☐ No If answer is "yes," type of consolidation _____

If answer is "no," list the owners and tract descriptions which have actually been consolidated. (Use reverse side of this form if necessary.) _____

No allowable will be assigned to the well until all interests have been consolidated (by communitization, unitization, forced-pooling, or otherwise) or until a non-standard unit, eliminating such interests, has been approved by the Commission. THIS PLAT REISSUED TO SHOW REVISED NOMENCLATURE. 9-6-77

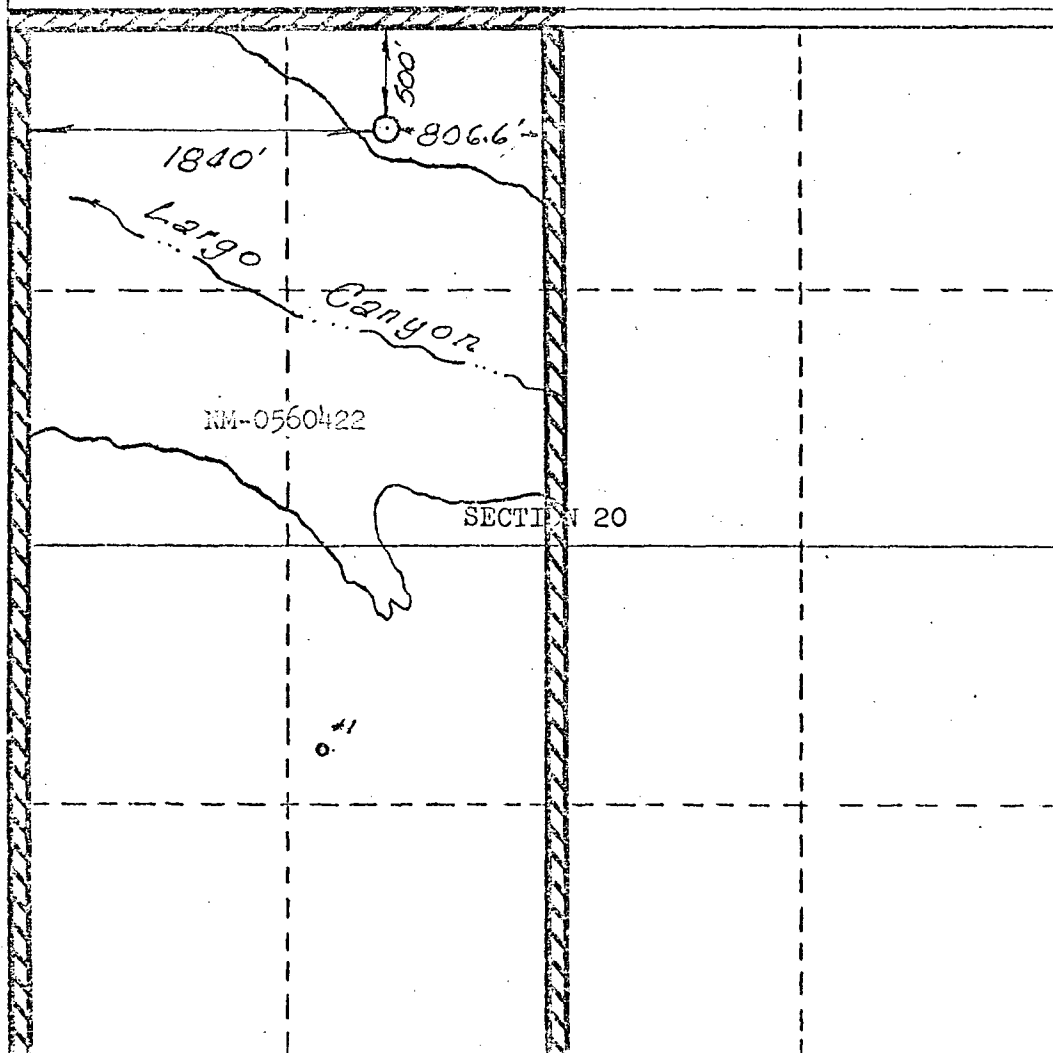

CERTIFICATION

I hereby certify that the information contained herein is true and complete to the best of my knowledge and belief.

Name _____

Position _____

Company _____

Date _____

I hereby certify that the well location shown on this plat was plotted from field notes of actual surveys made by me or under my supervision, and that the same is true and correct to the best of my knowledge and belief.

Date Surveyed

AUGUST 28, 1977

Registered Professional Engineer and/or Land Surveyor

Certificate No. **1760**

El Paso NATURAL GAS
COMPANY

P. O. BOX 990 - 77017
FARMINGTON, NEW MEXICO 87401
PHONE 505-325-2841
Conservation Commission

October 20, 1977

Amoco Production
Tenneco Oil Company
D. J. Simmons
Aztec Oil & Gas Company

Re: Unorthodox Gas Well Location

Gentlemen:

El Paso Natural Gas Company has requested administrative approval for an unorthodox gas well location in the Blanco Mesa Verde pool.

It is intended to locate the El Paso Natural Gas Company's El Paso #1A at 500' from the North line and 1840' from the West line of Section 20, T-29-N, R-9-W, San Juan County, New Mexico.

Largo Canyon and Largo Wash cover most of the northern half of this section, making it impossible to build an orthodox gas well location.

In compliance with New Mexico Oil Conservation Commission, we are notifying you, as operators of an offsetting proration unit, of our application for administrative approval for the aforementioned unorthodox gas well location. Enclosed are three copies of this letter. If there is no objection to this location, please sign and return one copy to New Mexico Oil Conservation Commission, Post Office Box 2088, Santa Fe, New Mexico 87501; one copy to El Paso Natural Gas Company, and keep one copy for your files.

A plat showing the proposed well location and offsetting Mesa Verde ownership is attached.

Yours truly,



D. R. Read
Division Drilling Engineer

DRR:pb

Approved: Tenneco Oil Co.
D. D. Myers

Date: 11-3-77

El Paso NATURAL GAS
COMPANY

OCT 31 1977
OIL CONSERVATION COMMISSION
SANTA FE, N.M.

P. O. BOX 990
FARMINGTON, NEW MEXICO 87401
PHONE: 505-325-2841

October 20, 1977

Amoco Production
Tenneco Oil Company
D. J. Simmons
Aztec Oil & Gas Company

Re: Unorthodox Gas Well Location

Gentlemen:

El Paso Natural Gas Company has requested administrative approval for an unorthodox gas well location in the Blanco Mesa Verde pool.

It is intended to locate the El Paso Natural Gas Company's El Paso #1A at 500' from the North line and 1840' from the West line of Section 20, T-29-N, R-9-W, San Juan County, New Mexico.

Largo Canyon and Largo Wash cover most of the northern half of this section, making it impossible to build an orthodox gas well location.

In compliance with New Mexico Oil Conservation Commission, we are notifying you, as operators of an offsetting proration unit, of our application for administrative approval for the aforementioned unorthodox gas well location. Enclosed are three copies of this letter. If there is no objection to this location, please sign and return one copy to New Mexico Oil Conservation Commission, Post Office Box 2088, Santa Fe, New Mexico 87501; one copy to El Paso Natural Gas Company, and keep one copy for your files.

A plat showing the proposed well location and offsetting Mesa Verde ownership is attached.

Yours truly,

Don Read

D. R. Read
Division Drilling Engineer

DRR:pb

Approved: *Amoco Prod Co.*
Donlan D. Perie

Date: 10-28-77

El Paso NATURAL GAS
COMPANY

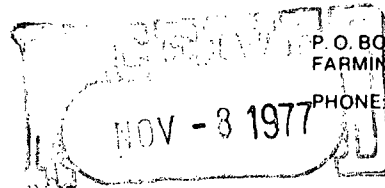

P. O. BOX 990
FARMINGTON, NEW MEXICO 87401
PHONE 505-325-2841

NEW MEXICO OIL CONSERVATION COMM.

Santa Fe October 20, 1977

Amoco Production
Tenneco Oil Company
D. J. Simmons
Aztec Oil & Gas Company

Re: Unorthodox Gas Well Location

Gentlemen:

El Paso Natural Gas Company has requested administrative approval for an unorthodox gas well location in the Blanco Mesa Verde pool.

It is intended to locate the El Paso Natural Gas Company's El Paso #1A at 500' from the North line and 1840' from the West line of Section 20, T-29-N, R-9-W, San Juan County, New Mexico.

Largo Canyon and Largo Wash cover most of the northern half of this section, making it impossible to build an orthodox gas well location.

In compliance with New Mexico Oil Conservation Commission, we are notifying you, as operators of an offsetting proration unit, of our application for administrative approval for the aforementioned unorthodox gas well location. Enclosed are three copies of this letter. If there is no objection to this location, please sign and return one copy to New Mexico Oil Conservation Commission, Post Office Box 2088, Santa Fe, New Mexico 87501; one copy to El Paso Natural Gas Company, and keep one copy for your files.

A plat showing the proposed well location and offsetting Mesa Verde ownership is attached.

Yours truly,

D. R. Read
Division Drilling Engineer

DRR:pb

Approved: Mrs. D. J. Simmons

Date: Nov. 7-1977

El Paso NATURAL GAS
COMPANY

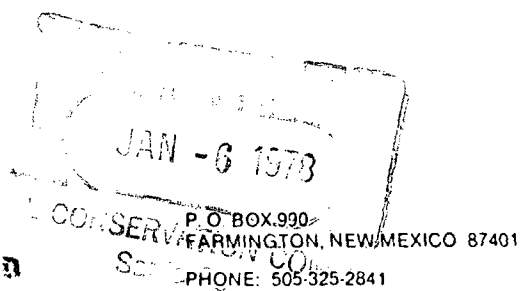

RECEIVED
EL PASO NATURAL GAS
COMPANY
FARMINGTON OFFICE

October 20, 1977

NOV 2 1977

Amoco Production
Tenneco Oil Company
D. J. Simmons
Aztec Oil & Gas Company

Re: Unorthodox Gas Well Location

Gentlemen:

El Paso Natural Gas Company has requested administrative approval for an unorthodox gas well location in the Blanco Mesa Verde pool.

It is intended to locate the El Paso Natural Gas Company's El Paso #1A at 500' from the North line and 1840' from the West line of Section 20, T-29-N, R-9-W, San Juan County, New Mexico.

Largo Canyon and Largo Wash cover most of the northern half of this section, making it impossible to build an orthodox gas well location.

In compliance with New Mexico Oil Conservation Commission, we are notifying you, as operators of an offsetting proration unit, of our application for administrative approval for the aforementioned unorthodox gas well location. Enclosed are three copies of this letter. If there is no objection to this location, please sign and return one copy to New Mexico Oil Conservation Commission, Post Office Box 2088, Santa Fe, New Mexico 87501; one copy to El Paso Natural Gas Company, and keep one copy for your files.

A plat showing the proposed well location and offsetting Mesa Verde ownership is attached.

Yours truly,

A handwritten signature in cursive script, appearing to read "Don Read".

D. R. Read
Division Drilling Engineer

DRR:pb

Approved:
District Production Manager
AZTEC OIL & GAS COMPANY

Date: October 28, 1977

RECEIVED

OCT 27 1977

FARMINGTON DISTRICT

El Paso NATURAL GAS
COMPANY

JAN - 6 1978
NEW MEXICO OIL CONSERVATION COMMISSION

P. O. BOX 990
FARMINGTON, NEW MEXICO 87401
PHONE: 505-325-2841

October 20, 1977

Amoco Production
Tenneco Oil Company
D. J. Simmons
Aztec Oil & Gas Company

Re: Unorthodox Gas Well Location

Gentlemen:

El Paso Natural Gas Company has requested administrative approval for an unorthodox gas well location in the Blanco Mesa Verde pool.

It is intended to locate the El Paso Natural Gas Company's El Paso #1A at 500' from the North line and 1840' from the West line of Section 20, T-29-N, R-9-W, San Juan County, New Mexico.

Largo Canyon and Largo Wash cover most of the northern half of this section, making it impossible to build an orthodox gas well location.

In compliance with New Mexico Oil Conservation Commission, we are notifying you, as operators of an offsetting proration unit, of our application for administrative approval for the aforementioned unorthodox gas well location. Enclosed are three copies of this letter. If there is no objection to this location, please sign and return one copy to New Mexico Oil Conservation Commission, Post Office Box 2088, Santa Fe, New Mexico 87501; one copy to El Paso Natural Gas Company, and keep one copy for your files.

A plat showing the proposed well location and offsetting Mesa Verde ownership is attached.

Yours truly,

Don Read

D. R. Read
Division Drilling Engineer

DRR:pb

Approved: Tenneco Oil Co.
D. D. Myers

Date: 11-3-77

El Paso NATURAL GAS
COMPANY

JAN - 6 1978
P. O. BOX 990
FARMINGTON, NEW MEXICO 87401
PHONE: 505-325-2841

October 20, 1977

NOV 8 1977

Amoco Production
Tenneco Oil Company
D. J. Simmons
Aztec Oil & Gas Company

Re: Unorthodox Gas Well Location

Gentlemen:

El Paso Natural Gas Company has requested administrative approval for an unorthodox gas well location in the Blanco Mesa Verde pool.

It is intended to locate the El Paso Natural Gas Company's El Paso #1A at 500' from the North line and 1840' from the West line of Section 20, T-29-N, R-9-W, San Juan County, New Mexico.

Largo Canyon and Largo Wash cover most of the northern half of this section, making it impossible to build an orthodox gas well location.

In compliance with New Mexico Oil Conservation Commission, we are notifying you, as operators of an offsetting proration unit, of our application for administrative approval for the aforementioned unorthodox gas well location. Enclosed are three copies of this letter. If there is no objection to this location, please sign and return one copy to New Mexico Oil Conservation Commission, Post Office Box 2088, Santa Fe, New Mexico 87501; one copy to El Paso Natural Gas Company, and keep one copy for your files.

A plat showing the proposed well location and offsetting Mesa Verde ownership is attached.

Yours truly,

Don Read

D. R. Read
Division Drilling Engineer

DRR:pb

Approved: *Mrs. D. J. Simmons*

Date: *Nov. 7, 1977*

El Paso NATURAL GAS
COMPANY

RECEIVED
FARMINGTON, NEW MEXICO
OCT 19 1977
FARMINGTON OFFICE

P. O. BOX 990
FARMINGTON, NEW MEXICO 87401
PHONE 505-325-2841

OCT 31 1977

October 20, 1977

Amoco Production
Tenneco Oil Company
D. J. Simmons
Aztec Oil & Gas Company

Re: Unorthodox Gas Well Location

Gentlemen:

El Paso Natural Gas Company has requested administrative approval for an unorthodox gas well location in the Blanco Mesa Verde pool.

It is intended to locate the El Paso Natural Gas Company's El Paso #1A at 500' from the North line and 1840' from the West line of Section 20, T-29-N, R-9-W, San Juan County, New Mexico.

Largo Canyon and Largo Wash cover most of the northern half of this section, making it impossible to build an orthodox gas well location.

In compliance with New Mexico Oil Conservation Commission, we are notifying you, as operators of an offsetting proration unit, of our application for administrative approval for the aforementioned unorthodox gas well location. Enclosed are three copies of this letter. If there is no objection to this location, please sign and return one copy to New Mexico Oil Conservation Commission, Post Office Box 2088, Santa Fe, New Mexico 87501; one copy to El Paso Natural Gas Company, and keep one copy for your files.

A plat showing the proposed well location and offsetting Mesa Verde ownership is attached.

Yours truly,

D. R. Read

D. R. Read
Division Drilling Engineer

DRR:pb

Approved:

Amoco Prod Co.
Clinton D. Smith

Date:

10-28-77

Tenneco Oil
A Tenneco Company

Penthouse
720 South Colorado Blvd.
Denver, CO 80222

00



November 2, 1977

NOV - 2 1977
Oil Conservation Commission

New Mexico Oil Conservation Commission
Post Office Box 2088
Santa Fe, New Mexico 87501

El Paso Natural Gas Company
P. O. Box 990
Farmington, New Mexico 87401

Re: Unorthodox Gas Well Location
El Paso #1-A
NW/4, Section 20, T29N-R9W
San Juan County, New Mexico

Gentlemen:

Attached is an approved copy of the request by El Paso Natural Gas for an unorthodox location for the captioned Mesaverde Infill Well. Tenneco Oil Company has no objection to the approval of this request by the Commission.

Yours very truly,

TENNECO OIL COMPANY

A handwritten signature in cursive script that reads "D. D. Myers".

D. D. Myers
Division Production Manager

RJG:DDM:v
Attachment

OIL CONSERVATION COMMISSION
Antee DISTRICT

OIL CONSERVATION COMMISSION
BOX 2088
SANTA FE, NEW MEXICO

27 1977

DATE 10-26-77

RE: Proposed MC _____
Proposed DHC _____
Proposed NSL ✓ _____
Proposed SWD _____
Proposed WFX _____
Proposed PMX _____

Gentlemen:

I have examined the application dated 10-20-77
for the El Paso Natural Gas Co. El Paso #1A C-20-29N-9W
Operator Lease and Well No. Unit, S-T-R

and my recommendations are as follows:

Approve

Yours very truly,

RR Kendrick

OIL CONSERVATION COMMISSION
Hobbs DISTRICT

OIL CONSERVATION COMMISSION
BOX 2088
SANTA FE, NEW MEXICO

SEP 12 1977

CONSERVATION COMMISSION
Santa Fe

DATE September 7, 1977

RE: Proposed MC _____
Proposed DHC _____
Proposed NSL X _____
Proposed SWD _____
Proposed WFX _____
Proposed PMX _____

Gentlemen:

I have examined the application dated _____
for the Atlantic Richfield Co. Wimberly WN #11-C 24-25-37
Operator Lease and Well No. Unit, S-T-R

and my recommendations are as follows:

O.K.---J.S.

Yours very truly,

James L. Smith