

**El Paso** NATURAL GAS  
COMPANY

AUG 11 1978

P. O. BOX 990  
FARMINGTON, NEW MEXICO 87401  
PHONE: 505-325-2841

August 10, 1978

NSL-973  
Rule 104 F  
Aug 31, 1978

Mr. Joe Ramey  
New Mexico Oil Conservation Commission  
Post Office Box 2088  
Santa Fe, New Mexico 87501

Dear Mr. Ramey:

This is a request for administrative approval for an unorthodox gas well location in the Blanco Mesa Verde pool.

It is intended to locate the El Paso Natural Gas Company's Moore #5A at 2000' from the North line and 800' from the West line of Section 24, T-32-N, R-12-W, San Juan County, New Mexico.

A wide dry wash bed and sandstone cliffs cover most of the northwest corner of this section and this makes it impossible to build an orthodox gas well location.

All operators of proration units offsetting the proposed unorthodox location have been notified of this application by certified mail.

Plats showing the proposed well location and the terrain of Section 24, along with an ownership plat, are attached.

Yours truly,

*Don Walker*

D. C. Walker  
Project Drilling Engineer

DCW:pb

**El Paso** NATURAL GAS  
COMPANY

P. O. BOX 990  
FARMINGTON, NEW MEXICO 87401  
PHONE: 505-325-2841

AUG 14 1978

August 10, 1978

Southland Royalty  
Post Office Drawer 570  
Farmington, New Mexico

Re: Unorthodox Gas Well Location

Gentlemen:

El Paso Natural Gas Company has requested administrative approval for an unorthodox location for a well in the Blanco Mesa Verde pool.

It is intended to locate the El Paso Natural Gas Company's Moore #5A at 2000' from the North line and 800' from the West line of Section 24, T-32-N, R-12-W, San Juan County, New Mexico.

A wide dry wash bed and sandstone cliffs cover most of the northwest corner of this section and this makes it impossible to build an orthodox location.

In compliance with New Mexico Oil Conservation Commission rules, we are notifying you, as operators of an offsetting proration unit, of our application for administrative approval for the aforementioned unorthodox gas well location. Enclosed are three copies of this letter. If there is no objection to this location, please sign and return one copy to the New Mexico Oil Conservation Commission, Post Office Box 2088, Santa Fe, New Mexico 87501; one copy to El Paso Natural Gas Company; and keep one copy for your files.

A plat showing the proposed well location and offsetting Mesa Verde lease ownership is attached.

Yours truly,

*Don Walker*

D. C. Walker  
Project Drilling Engineer

DCW:pb

Approved: *Van Rye*

District Production Mgr.

SOUTHLAND ROYALTY CO.

Date: 8-11-78

EL PASO NATURAL GAS COMPANY

Well Name. Moore #5 A

Footage---- 2000 FNL, 800 FWL

## APPLICATION FOR NON-STANDARD LOCATION

County San Juan State New Mexico Section 24 Township 32N Range 12W

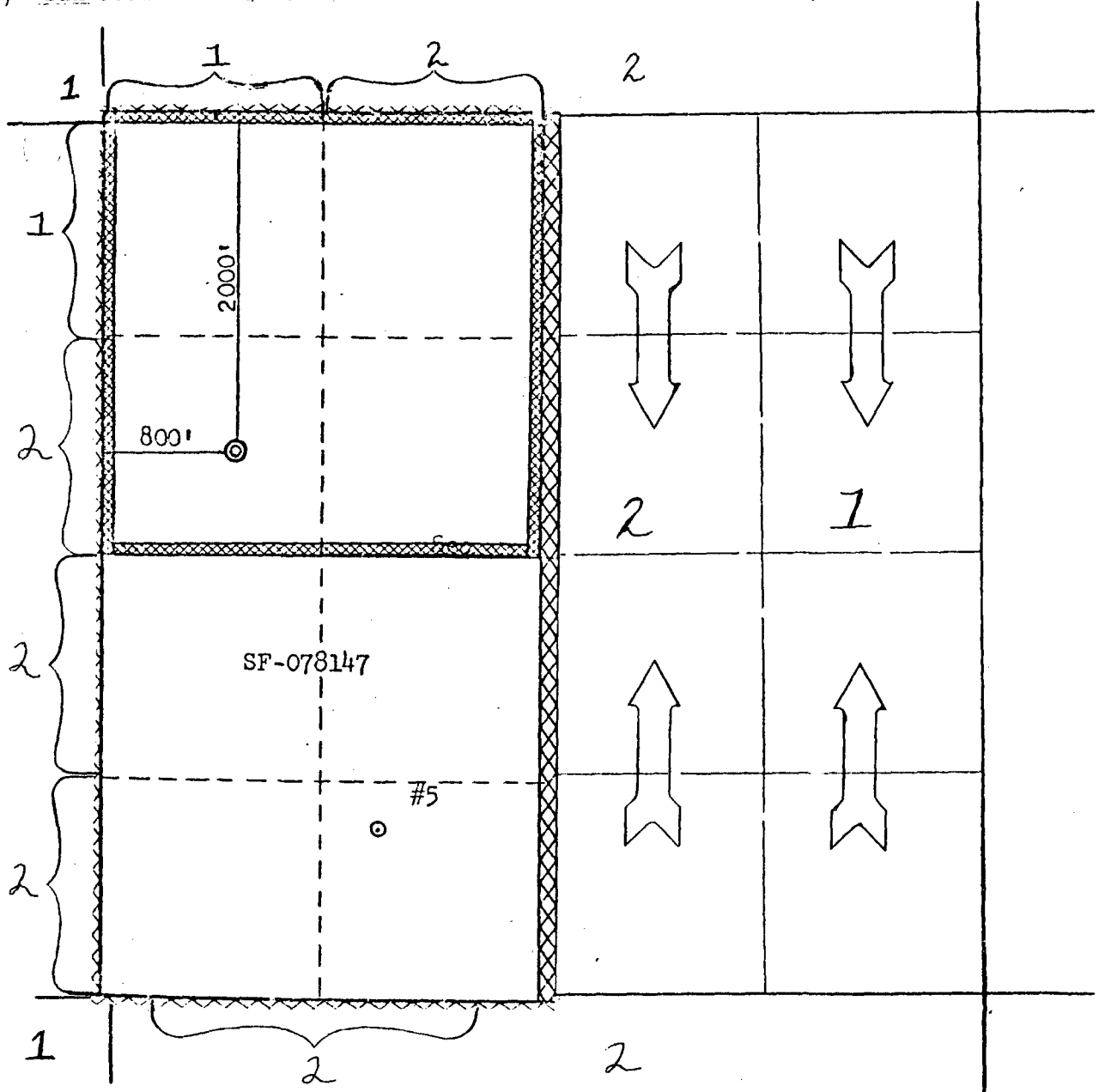

## REMARKS:

- (1) SOUTHLAND ROYALTY COMPANY  
(2) EL PASO NATURAL GAS COMPANY

lit

N. MEXICO OIL CONSERVATION COMMISSION  
WELL LOCATION AND ACREAGE DEDICATION PLAT

Form C-102  
Supersedes C-128  
Effective 1-1-65

All distances must be from the outer boundaries of the Section.

Operator <b>EL PASO NATURAL GAS COMPANY</b>			Lease <b>MOORE (SF-078147)</b>		Well No. <b>5A</b>
Unit Letter <b>E</b>	Section <b>24</b>	Township <b>32N</b>	Range <b>12W</b>	County <b>San Juan</b>	
Actual Footage Location of Well: <b>2000</b> feet from the <b>North</b> line and <b>800</b> feet from the <b>West</b> line					
Ground Level Elev. <b>6468</b>	Producing Formation <b>Pictured Cliffs-Mesa Verde</b>		Pool Blanco Pictured Cliffs Ext. <b>Blanco Mesa Verde</b>		Dedicated Acreage: <b>160.00 &amp; 320.00 Acres</b>

1. Outline the acreage dedicated to the subject well by colored pencil or hachure marks on the plat below.
2. If more than one lease is dedicated to the well, outline each and identify the ownership thereof (both as to working interest and royalty).
3. If more than one lease of different ownership is dedicated to the well, have the interests of all owners been consolidated by communitization, unitization, force-pooling, etc?

☐ Yes ☐ No If answer is "yes," type of consolidation \_\_\_\_\_

If answer is "no," list the owners and tract descriptions which have actually been consolidated. (Use reverse side of this form if necessary.) \_\_\_\_\_

No allowable will be assigned to the well until all interests have been consolidated (by communitization, unitization, forced-pooling, or otherwise) or until a non-standard unit, eliminating such interests, has been approved by the Commission.

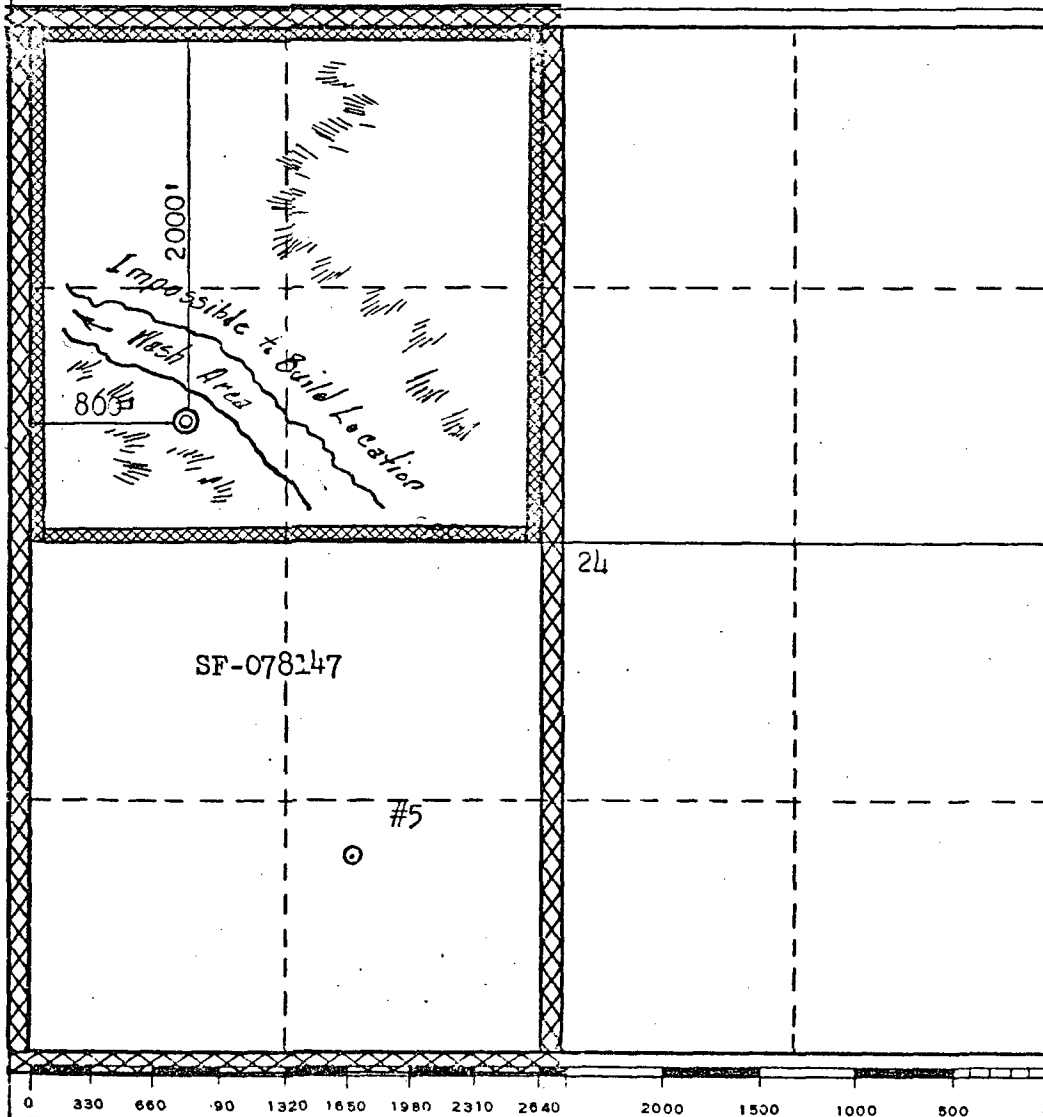

CERTIFICATION

I hereby certify that the information contained herein is true and complete to the best of my knowledge and belief.

*D. G. Guiso*  
Name

Drilling Clerk

Position

El Paso Natural Gas Co.

Company

August 10, 1978

Date

I hereby certify that the well location shown on this plat was plotted from field notes of actual surveys made by me or under my supervision, and that the same is true and correct to the best of my knowledge and belief.

Date Surveyed

June 21, 1978

Registered Professional Engineer and/or Land Surveyor

*Fred H Kerr Jr.*  
Fred H Kerr Jr.

Certificate No.

3950

OIL CONSERVATION COMMISSION  
Aztec DISTRICT

OIL CONSERVATION COMMISSION  
BOX 2088  
SANTA FE, NEW MEXICO

DATE 8/22/78

RE: Proposed MC \_\_\_\_\_  
Proposed DHC \_\_\_\_\_  
Proposed NSL XXXX \_\_\_\_\_  
Proposed SWD \_\_\_\_\_  
Proposed WFX \_\_\_\_\_  
Proposed PMX \_\_\_\_\_

Dick Stamets

Gentlemen:

I have examined the application dated 8/10/78  
for the El Paso Natural Gas Co. Moore #5A E-24-32N-12W  
Operator Lease and Well No. Unit, S-T-R

and my recommendations are as follows:

Approve

\_\_\_\_\_

\_\_\_\_\_

\_\_\_\_\_

\_\_\_\_\_

\_\_\_\_\_

Yours very truly,

AR Kendrick

