

**DOYLE HARTMAN**

Oil Operator

SUITE 508

C & K PETROLEUM BUILDING  
MIDLAND, TEXAS 79701

(915) 684-4011

August 24, 1978

New Mexico Oil Conservation Commission  
P. O. Box 2088  
Santa Fe, New Mexico 87501

Re: Request for Non-Standard Location

Cooper State No. 2  
NE/4 SW/4 Section 2  
T-24-S, R-36-E  
Lea County, New Mexico

Attention: R. L. Stamets

*e Simultaneous dedication*

Gentlemen:

At the present time, I am in the process of attempting a Jalmat Gas completion with my Cooper State No. 2 well from the Yates formation between 2998 - 3118. The subject well is located 2310' FSL and 2310' FWL Section 2, T-24-S, R-36-E and was recently drilled to a total depth of 3800 feet as a Langlie Mattix test.

Since the drill site for the Cooper State No. 2 is located closer than 660 feet from the lease line, I hereby request that the NMOCC administratively approve a non-standard gas location for the subject well.

Also, a check of NMOCC records will show that my Cooper State No. 2 is located on the same 160-acre non-standard Jalmat Gas proration unit (SW/4 Section 2) that was approved by the NMOCC for my Cooper State No. 1 in July, 1976. Therefore, I furthermore request that the NMOCC allow my Cooper State No. 2 to share a 160-acre Jalmat Gas Allowable with my marginal Cooper State No. 1 well which is located 660' FSL and 1980' FWL Section 2. This request is being made in the event that the average combined producing capability of my Cooper State No. 1 and Cooper State No. 2 either equals or exceeds the non-marginal allowable for a 160-acre Jalmat Gas proration unit.

Six copies of a plat showing the location of my well and the outline of the proposed spacing unit are enclosed.

Copies of this application and plat have also been sent to all offsetting operators owning Jalmat Gas rights. A list of these operators is as follows:

NSL-983

RECEIVED

AUG 31 1978

Oil Conservation Commission

NSL-983  
Rule 3 Order R1670  
Sept 19, 1978  
And simultaneous  
Dedication  
previously  
approved  
NSP

NSP1028

Mr. R. L. Stamets  
August 24, 1978  
Page 2

Amoco Production Company  
P. O. Box 3092  
Houston, Texas 77001  
Attention: J. W. Durkee

Exxon Company U. S. A.  
P. O. Box 1600  
Midland, Texas 79701  
Attention: W. H. Leifeste

Getty Oil Company  
P. O. Box 1231  
Midland, Texas 79701  
Attention: James B. Davis  
District Landman

Texas Pacific Oil Company  
P. O. Box 4067  
Midland, Texas 79701  
Attention: Julian Stroud

WECO Development Corporation  
1100 Western Federal Savings Building  
718 17th Street  
Denver, Colorado 80202  
Attention: Mr. David Spelman

Yours very truly,



Doyle Hartman

cc: Cities Service Oil Company  
Box 1919  
Midland, Texas 79702  
Attention: Mr. Don Peters

Exxon Company, U. S. A.  
Box 1600  
Midland, Texas 79702  
Attention: Jack Naumann  
Division Landman

DH/mv

**NEW MEXICO OIL CONSERVATION COMMISSION  
WELL LOCATION AND ACREAGE DEDICATION PLAT**

Form C-102  
Supersedes C-128  
Effective 1-1-65

All distances must be from the outer boundaries of the Section

|                                                                                                                                |                                     |                              |                                         |                      |
|--------------------------------------------------------------------------------------------------------------------------------|-------------------------------------|------------------------------|-----------------------------------------|----------------------|
| Operator<br><b>Doyle Hartman</b>                                                                                               |                                     | Lease<br><b>Cooper State</b> |                                         | Well No.<br><b>2</b> |
| Unit Letter<br><b>K</b>                                                                                                        | Section<br><b>2</b>                 | Township<br><b>24 South</b>  | Range<br><b>36 East</b>                 | County<br><b>Lea</b> |
| Actual Footage Location of Well:<br><b>2310</b> feet from the <b>South</b> line and <b>2310</b> feet from the <b>West</b> line |                                     |                              |                                         |                      |
| Ground Level Elev.<br><b>3366.8</b>                                                                                            | Producing Formation<br><b>Yates</b> | Pool<br><b>Jalmat (Gas)</b>  | Dedicated Acreage:<br><b>160*</b> Acres |                      |

1. Outline the acreage dedicated to the subject well by colored pencil or hatchure marks on the plat below.
2. If more than one lease is dedicated to the well, outline each and identify the ownership thereof (both as to working interest and royalty). See Reverse Side
3. If more than one lease of different ownership is dedicated to the well, have the interests of all owners been consolidated by communitization, unitization, force-pooling, etc?

☒ Yes    ☐ No    If answer is "yes," type of consolidation Communitization Agreement

If answer is "no," list the owners and tract descriptions which have actually been consolidated. (Use reverse side of this form if necessary.) \_\_\_\_\_

No allowable will be assigned to the well until all interests have been consolidated (by communitization, unitization, forced-pooling, or otherwise) or until a non-standard unit, eliminating such interests, has been approved by the Commission. \* Request has been filed for Cooper State No. 2 to share an allowable with Cooper State

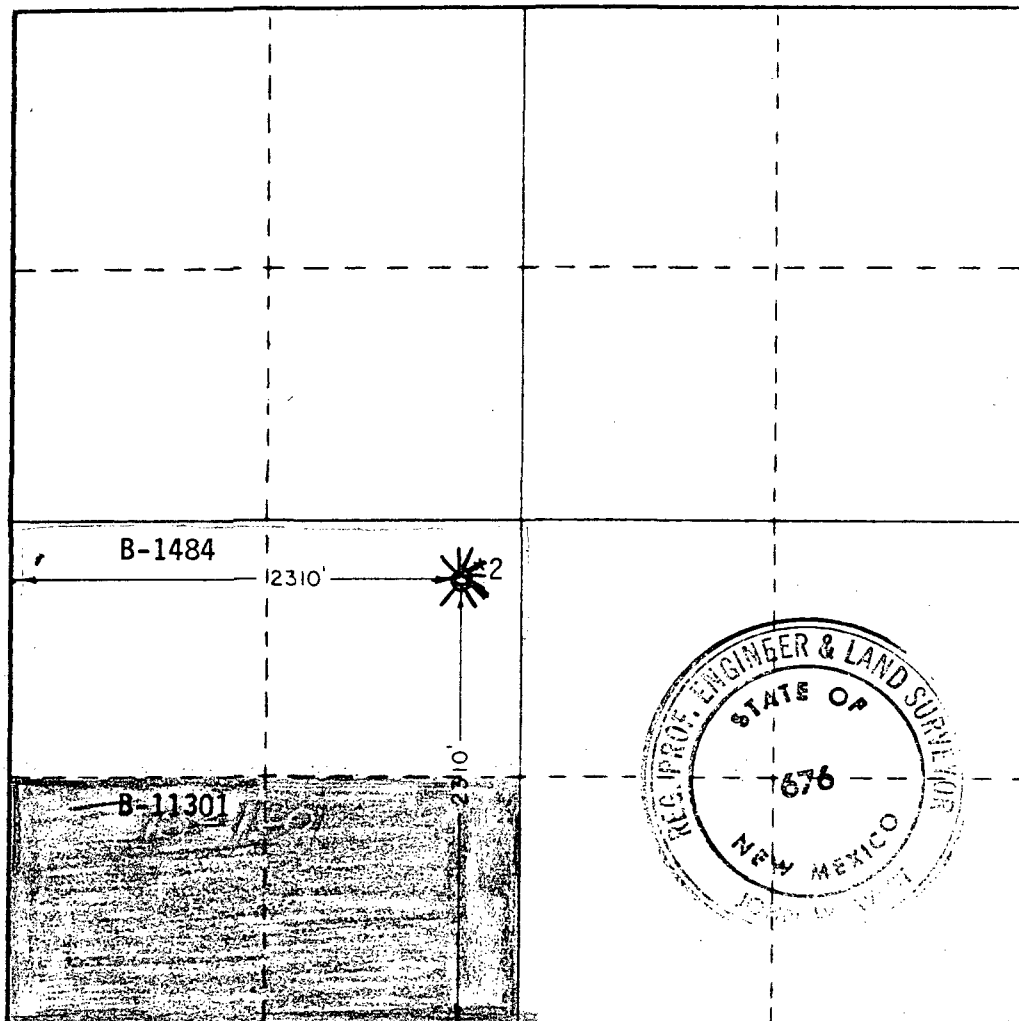

**No. 1  
CERTIFICATION**

I hereby certify that the information contained herein is true and complete to the best of my knowledge and belief.

*Doyle Hartman*  
Name

**Doyle Hartman**

Position

**Operator - Part Owner**

Company

**Individual**

Date

**8-25-78**

I hereby certify that the well location shown on this plat was plotted from field notes of actual surveys made by me or under my supervision, and that the same is true and correct to the best of my knowledge and belief.

**March 15, 1978**

Date Surveyed

Registered Professional Engineer  
and/or Land Surveyor

*John W. West*

Certificate No. **John W. West 676**  
**Ronald J. Eidson 3239**

**OIL CONSERVATION COMMISSION**

**P. O. BOX 2088**

**SANTA FE, NEW MEXICO 87501**

**August 5, 1976**

**Doyle Hartman  
C & K Petroleum Building  
Suite 312  
Midland, Texas 79701**

**Administrative Order MSP-1028**

**Gentlemen:**

**Reference is made to your application for a 160-acre non-standard proration unit consisting of the following described acreage in the Jalmat Gas Pool:**

**LEA COUNTY, NEW MEXICO  
TOWNSHIP 24 SOUTH, RANGE 36 EAST, NMPM  
Section 2: SW/4**

**It is understood that this unit is to be dedicated to your Cooper State Well No. 1, located 660 feet from the South line and 1980 feet from the West line of said Section 2.**

**By authority granted me under the provisions of Rule 104 D II, you are hereby authorized to operate the above-described acreage as a non-standard proration unit.**

**Very truly yours,**

**JOE D. RAMEY  
Secretary-Director**

**JDR/JEK/dr**

**cc: Oil Conservation Commission - Hobbs  
Oil & Gas Engineering Committee - Hobbs  
Central Leasing - State Land Office - Santa Fe  
Proration Department, OCC - Santa Fe**