

El Paso NATURAL GAS
COMPANY

P. O. BOX 990
FARMINGTON, NEW MEXICO 87401
PHONE: 505-325-2841

September 7, 1978

NSL-987
Bak 104 F
10-1-78

Mr. Joe Ramey
New Mexico Oil Conservation Commission
Post Office Box 2088
Santa Fe, New Mexico 87501

Dear Mr. Ramey:

This is a request for administrative approval for an unorthodox gas well location in the Blanco Mesa Verde pool.

It is intended to locate the El Paso Natural Gas Company's San Juan 30-6 Unit #9A at 545' from the South line and 510' from the East line of Section 30, T-30-N, R-7-W, Rio Arriba County, New Mexico.

E/2 Dedication

A high mesa ridge with steeply sloping sides in conjunction with a pipeline and a power line in the southeast corner of this section makes it impossible to build an orthodox gas well location.

All operators of proration units offsetting the proposed unorthodox location have been notified of this application by certified mail.

Plats showing the proposed well location and the terrain of Section 30, along with an ownership plat, are attached.

Yours truly,

Don Walker

D. C. Walker
Project Drilling Engineer

DCW:pb

El Paso NATURAL GAS
COMPANY

SEP 11 1978

P. O. BOX 990
FARMINGTON, NEW MEXICO 87401
PHONE: 505-325-2841

September 7, 1978

Blackwood & Nichols
Tenneco Oil
Zallea Bros. & S. Laub

Re: Unorthodox Gas Well Location

Gentlemen:

El Paso Natural Gas Company has requested administrative approval for an unorthodox location for a well in the Blanco Mesa Verde pool.

It is intended to locate the El Paso Natural Gas Company's San Juan 30-6 Unit #9A at 545' from the South line and 510' from the East line of Section 30, T-30-N, R-7-W, Rio Arriba County, New Mexico.

A high mesa ridge with steeply sloping sides in conjunction with a pipeline and a power line in the southeast corner makes it impossible to build an orthodox location.

In compliance with New Mexico Oil Conservation Commission rules, we are notifying you, as operators of an offsetting proration unit, of our application for administrative approval for the aforementioned unorthodox gas well location. Enclosed are three copies of this letter. If there is no objection to this location, please sign and return one copy to the New Mexico Oil Conservation Commission, Post Office Box 2088, Santa Fe, New Mexico 87501; one copy to El Paso Natural Gas Company; and keep one copy for your files.

A plat showing the proposed well location and offsetting Mesa Verde lease ownership is attached.

Yours truly,

Don Walker

D. C. Walker
Project Drilling Engineer

DCW:pb

Approved: _____ Date: _____

EL PASO NATURAL GAS COMPANY

Well Name San Juan 30-6 Unit #9 A

BLANCO MESAVERTIDE

Footage---- 545' FSL, 510' FEL

APPLICATION FOR NON-STANDARD LOCATION

County Rio Arriba

State New Mexico

Section 30 Township 30N

R. 111111 7W

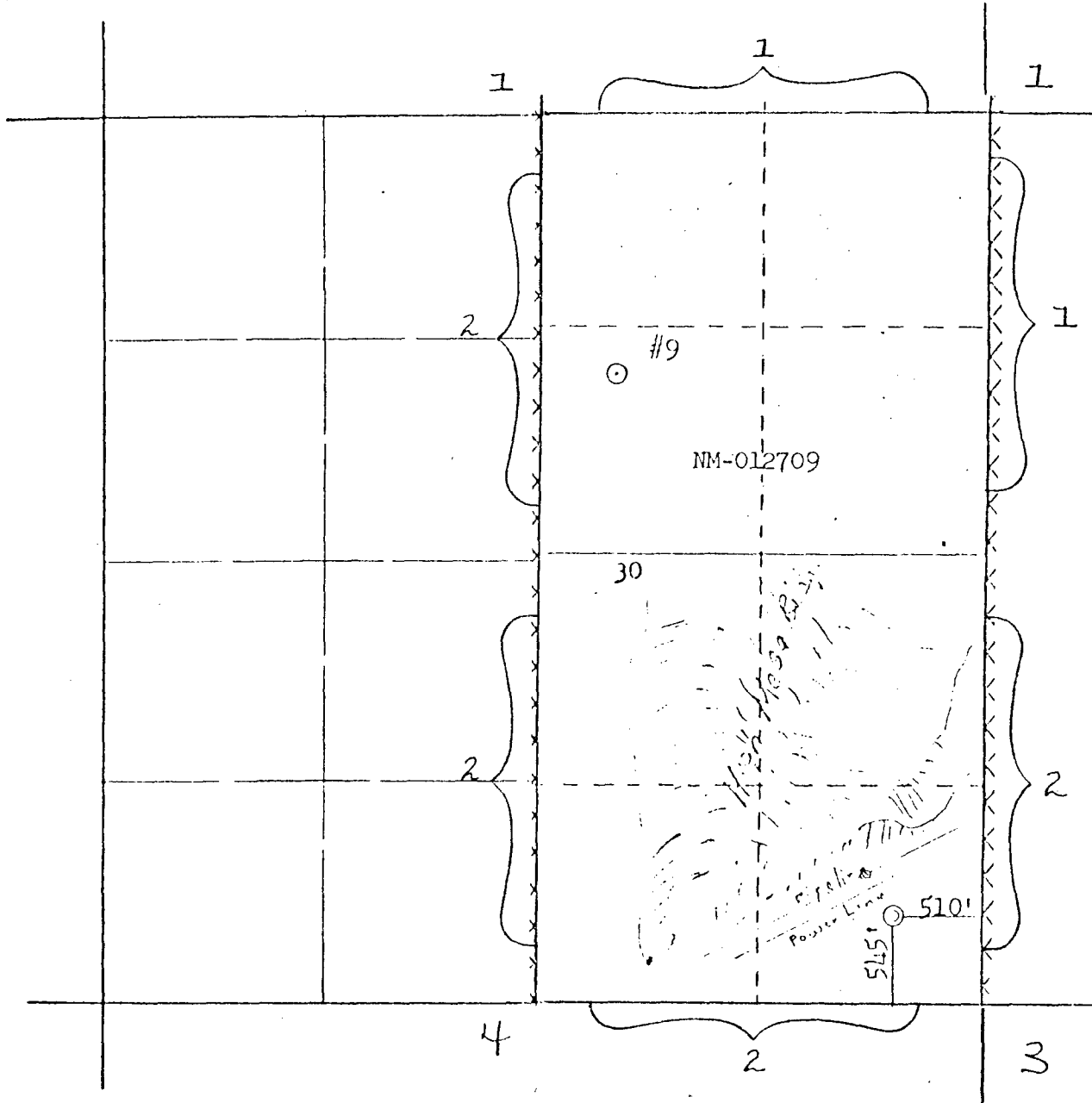

REMARKS:

- (1) NORTHEAST BLANCO UNIT-BLACKWOOD & NICHOLS, Operator
- (2) EL PASO NATURAL GAS COMPANY
- (3) ZALLEA BROS. & S. LAUB
- (4) TENNECO OIL COMPANY

**NEW MEXICO OIL CONSERVATION COMMISSION
WELL LOCATION AND ACREAGE DEDICATION PLAT**

Form C-102
Supersedes C-128
Effective 1-1-65

All distances must be from the outer boundaries of the Section.

Operator EL PASO NATURAL GAS COMPANY			Lease SAN JUAN 30-6 UNIT (NM-012709)		Well No. 9A
Unit Letter P	Section 30	Township 30N	Range 7W	County RIO ARriba	
Actual Postage Location of Well:					
545	feet from the	South	line and	510	feet from the
					East
Ground Level Elev. 6289	Producing Formation Mesa Verde		Pool Blanco Mesa Verde	Dedicated Acreage 320.00	

1. Outline the acreage dedicated to the subject well by colored pencil or hachure marks on the plat below.
2. If more than one lease is dedicated to the well, outline each and identify the ownership thereof (both as to working interest and royalty).
3. If more than one lease of different ownership is dedicated to the well, have the interests of all owners been consolidated by communitization, unitization, force-pooling, etc?

☒ Yes ☐ No If answer is "yes," type of consolidation Unitization

If answer is "no," list the owners and tract descriptions which have actually been consolidated. (Use reverse side of this form if necessary.) _____

No allowable will be assigned to the well until all interests have been consolidated (by communitization, unitization, forced-pooling, or otherwise) or until a non-standard unit, eliminating such interests, has been approved by the Commission.

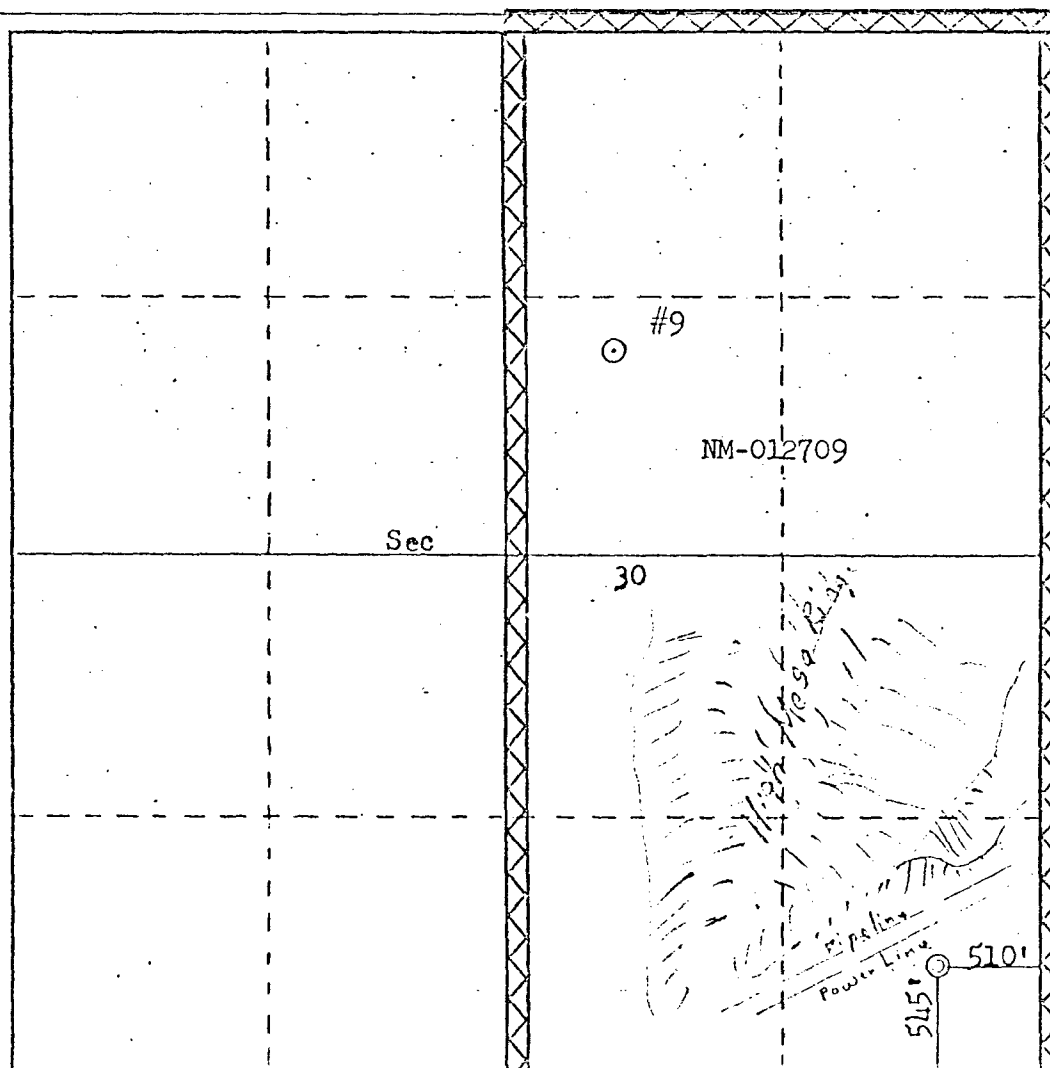

CERTIFICATION

I hereby certify that the information contained herein is true and complete to the best of my knowledge and belief.

D. P. Davis

Name

Drilling Clerk

Position

El Paso Natural Gas Co.

Company

September 7, 1978

Date

I hereby certify that the well location shown on this plat was plotted from field notes of actual surveys made by me or under my supervision, and that the same is true and correct to the best of my knowledge and belief.

Date Surveyed

August 9, 1978

By District Engineer

or District Engineer

Fred B. Kern

Fred B. Kern

Continued on

3950



JERRY APODACA
GOVERNOR

NICK FRANKLIN
SECRETARY

STATE OF NEW MEXICO
ENERGY AND MINERALS DEPARTMENT
OIL CONSERVATION DIVISION

September 12, 1978

SEP 28 1978
RECEIVED
EL PASO NATURAL GAS
COMPANY
FARMINGTON OFFICE

POST OFFICE BOX 2088
STATE LAND OFFICE BUILDING
SANTA FE, NEW MEXICO 87501
(505) 827-2434

El Paso Natural Gas Company
P. O. Box 990
Farmington, New Mexico 87401.

SEP 13 1978

Re: Application for Non-Standard
Location San Juan 30-6
Unit No. 9A, Sec. 30, T-30-N
R-7-W, Blanco-Mesaverde Pool

Gentlemen:

We may not process the subject application for non-standard location until the required information or plats checked below (is) (are) submitted.

- ☐ A plat must be submitted showing the ownership of the offsetting leases.
- ☐ A statement must be submitted that offset owners have been notified of the application by certified mail.
- * ☒ A plat must be submitted fully identifying the topography necessitating the non-standard location.
- ☐ The application must be signed.

Very truly yours,

R. L. STAMETS
Technical Support Chief

*The plat submitted is such a poor copy that it does not demonstrate the topography requiring the change in well location.

NEW MEXICO OIL CONSERVATION COMMISSION
WELL LOCATION AND ACREAGE DEDICATION PLAT

Form O-102
Supersedes O-120
Effective 1-1-65

SEP 28 1978

All distances must be from the outer boundaries of the Section.

Operator EL PASO NATURAL GAS COMPANY			Lease SAN JUAN 30-6 UNIT (NM-012709)		Well No. 9A
Unit Letter P	Section 30	Township 30N	Range 7W	County RIO ARriba	
Actual Postage Location of Well:					
545 feet from the South line and		510 feet from the East line			
Ground Level Elev. 6289	Producing Formation Mesa Verde	Pool Blanco Mesa Verde	Dedicated Acreage: 320.00 Acres		

1. Outline the acreage dedicated to the subject well by colored pencil or hachure marks on the plat below.
2. If more than one lease is dedicated to the well, outline each and identify the ownership thereof (both as to working interest and royalty).
3. If more than one lease of different ownership is dedicated to the well, have the interests of all owners been consolidated by communitization, unitization, force-pooling, etc?

☒ Yes ☐ No If answer is "yes," type of consolidation Unitization

If answer is "no," list the owners and tract descriptions which have actually been consolidated. (Use reverse side of this form if necessary.)

No allowable will be assigned to the well until all interests have been consolidated (by communitization, unitization, forced-pooling, or otherwise) or until a non-standard unit, eliminating such interests, has been approved by the Commission.

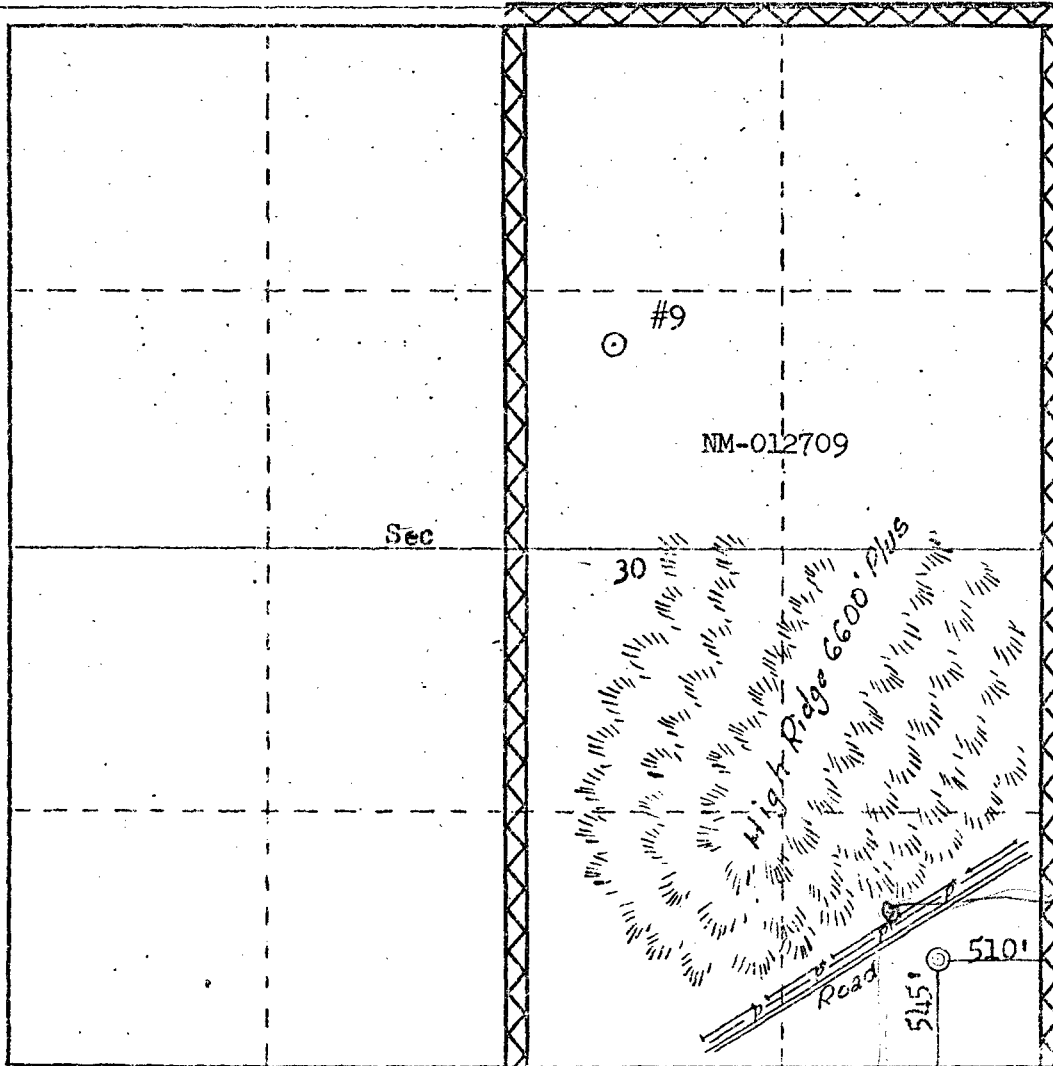

CERTIFICATION

I hereby certify that the information contained herein is true and complete to the best of my knowledge and belief.

Nora D. Grisco
Name

Drilling Clerk

Position

El Paso Natural Gas Co.

Company

9-27-78

Date

I hereby certify that the well location shown on this plat was plotted from field notes of actual surveys made by me or under my supervision, and that the same is true and correct to the best of my knowledge and belief.

Date Surveyed

August 9, 1978

Registered Professional Engineer and/or Land Surveyor

Fred B. Kerr Jr.
Fred B. Kerr Jr.

Certificate No.

3950

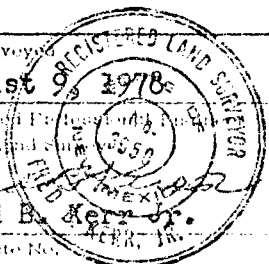

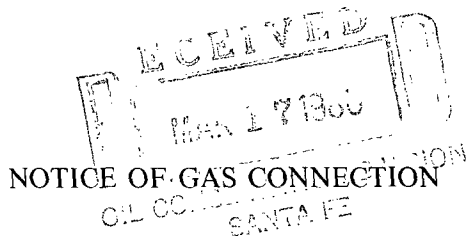
EL PASO NATURAL GAS COMPANY
POST OFFICE BOX 990
FARMINGTON, NEW MEXICO

NOTICE OF GAS CONNECTION

DATE February 28, 1980

THIS IS TO NOTIFY THE OIL CONSERVATION COMMISSION THAT CONNECTION FOR PURCHASE OF

GAS FROM El Paso Natural Gas Company
OperatorSan Juan 30-6 Unit #9-A
Well Name90-902-01

Meter Code

71488-51

Site Code

P

Well Unit

30-30-7

S-T-R

Blanco Mesaverde

Pool

El Paso Natural Gas Company

Name of Purchaser

WAS MADE ON February 18, 1980
DateFIRST DELIVERY February 19, 1980
DateAOF -CHOKE -El Paso Natural Gas Company
Purchaser
RepresentativeAssistant Chief Dispatcher
Titlecc: Operator
Oil Conservation Commission - 2
Proration - El Paso

File



OIL CONSERVATION COMMISSION
Agtec DISTRICT

OIL CONSERVATION COMMISSION
BOX 2088
SANTA FE, NEW MEXICO

DATE 9-12-78

RE: Proposed MC _____
Proposed DHC _____
Proposed NSL ✓ _____
Proposed SWD _____
Proposed WFX _____
Proposed PMX _____

Gentlemen:

I have examined the application dated 9-7-78
for the El Paso Natural Gas Co. San Juan 30-6 Unit # 9 A
Operator Lease and Well No. Unit, S-T-R
and my recommendations are as follows: P-30-30N-7W

Approve

Yours very truly,

SEP 24 1978