



Chevron U.S.A. Production Company

P.O. Box 1150, Midland, TX 79702

OIL CONSERVATION DIVISION
RECEIVED

JUL 15 1993 AM 10 24
Midland, Texas
July 15, 1993

Administrative Application for
Simultaneous Dedication and
Unorthodox Well Location
Eumont YTS-7RVRS-QN
(Pro Gas) Pool
660' FNL and 1980' FWL
Section 35, T-21-S, R-36-E
Lea County, New Mexico

State of New Mexico
Energy, Minerals & Natural Resources Dept.
Oil Conservation Division
P.O. Box 2088
Santa Fe, New Mexico 87504

Dear Mr. LeMay:

Chevron U.S.A. is planning to recomplete the **W.A. Ramsay (NCT-A) #18** in the Eumont YTS-7RVRS-QN (Pro Gas) Pool. The well is currently completed in the Eumont (Queen) Oil Pool. The location of the proposed recompletion is 660' FNL and 1980' FWL in Section 35, T-21-S, R-36-E, Lea County, New Mexico.

The captioned well is on an existing standard 640-acre Eumont gas spacing and proration unit (GPU) which comprises all of Section 35 of T-21-S, R-36-E according to Division Order R-4590, dated July 13, 1973. The same order authorized the simultaneous dedication of the W.A. Ramsay (NCT-A) Nos. 7 and 20, located in Units N and E, respectively, of T-21-S, R-36-E, to the said standard GPU. Since that time, the W.A. Ramsay (NCT-A) Nos. 3, 10, 12, and 13 have been dedicated to the GPU. We respectfully request that the production from the **W.A. Ramsay (NCT-A) #18** be simultaneously dedicated to the said GPU with the existing wells.

Because the location of the captioned well is 660' from the boundary of the 640-acre GPU, we also request your approval for an unorthodox well location.

A copy of this administrative application is being provided to our offset operators via Certified Mail. Attached is a commercial map and C-102 plats illustrating the proration unit acreage and well locations for each of the wells in the GPU. Also included is a copy of Division Order R-4590 as well as copies of the letters to our offset operators.

Administrative Application
Eumont YTS-7RVRS-QN
(Pro Gas) Pool

-2-

July 15, 1993

If you have any questions, or if you require further information, please contact Richard Black at (915) 687-7284.

Sincerely,



F.S. Godbold
Petroleum Engineering Supervisor
New Mexico Area

REB/tmdr
9476.DOC

Attachments

cc: NMOCD - Hobbs, New Mexico

CHEVRON U.S.A. INC.
W.A. Ramsay (NCT-A) Lease
Well No. 18

Administrative Application for
Simultaneous Dedication and
Unorthodox Well Location
Eumont YTS-7RVRS-QN
(Pro Gas) Pool
660' FNL and 1980' FWL
Section 35, T-21-S, R-36-E
Lea County, New Mexico

OFFSET OPERATORS

ARCO Oil and Gas Company
P.O. Box 1610
Midland, Texas 79701

Conoco Inc.
10 Desta Drive
Midland, Texas 79705

Exxon U.S.A. Inc.
P.O. Box 3116
Midland, Texas 79702

Marathon Oil Company
P.O. Box 552
Midland, Texas 79702

Meridian Oil, Inc.
21 Desta Dr.
Midland, Texas 79705

CHEVRON U.S.A. INC.
W.A. Ramsay (NCT-A) Lease
Well No. 18

Administrative Application for
Simultaneous Dedication and
Unorthodox Well Location
Eumont YTS-7RVRS-QN
(Pro Gas) Pool
660' FNL and 1980' FWL
Section 35, T-21-S, R-36-E
Lea County, New Mexico

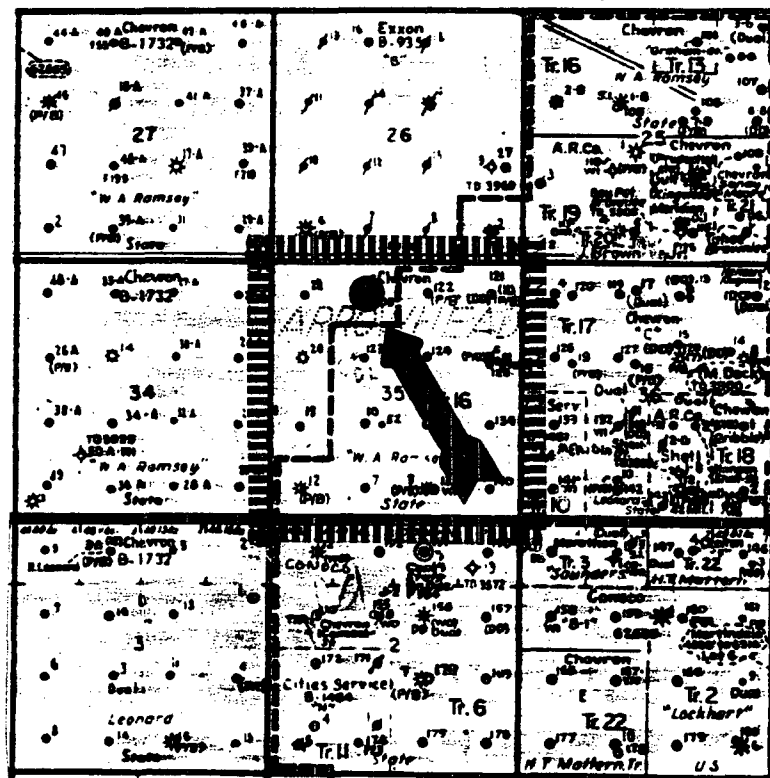

Where to Address
Interest Office
This Lease - 4 copies
No Lease - 3 copies

State of New Mexico
Energy, Minerals and Natural Resources Department

Form 6-102
Revised 1-1-59

OIL CONSERVATION DIVISION

P.O. Box 2038

Santa Fe, New Mexico 87504-2038

DISTRICT IV
P.O. Box 1760, Hobbs, NM 87400

DISTRICT V
P.O. Drawer 140, Aztec, NM 87410

DISTRICT VI
1000 Rio Grande Rd., Aztec, NM 87410

WELL LOCATION AND ACREAGE DEDICATION PLAT

All Distances must be from the outer boundaries of the section

Operator CHEVRON U.S.A. Inc.			Lease W.A. RAMSAY (NCT-A)		Well No. 3
Well Letter O	Section 35	Township 21 S	Range 36 E	County LEA	
Actual Foreign Location of Well: 660 feet from the SOUTH line and 1980 feet from the EAST line					
Well 3570	Producing Formation QUEEN		Pool EUMONT	Dedicated Acreage 640 Acres	

1. Outline the acreage dedicated to the subject well by concrete posts or accurate marks on the plat below.

2. If more than one lease is dedicated to the well, outline each and identify the ownership thereof (both as to working interest and royalty).

3. If more than one lease of different ownership is dedicated to the well, have the interest of all owners been consolidated by commutation, unitization, joint-venturing, etc.?

☐ Yes

☐ No

If answer is "yes" type of consolidation

If answer is "no" list the owners and their descriptions which have actually been consolidated. (Use reverse side of this form if necessary).

No allowable will be assigned to the well until all interests have been consolidated (by commutation, unitization, joint-venturing, or otherwise) or until a non-unitized unit, eliminating such interest, has been approved by the Division.

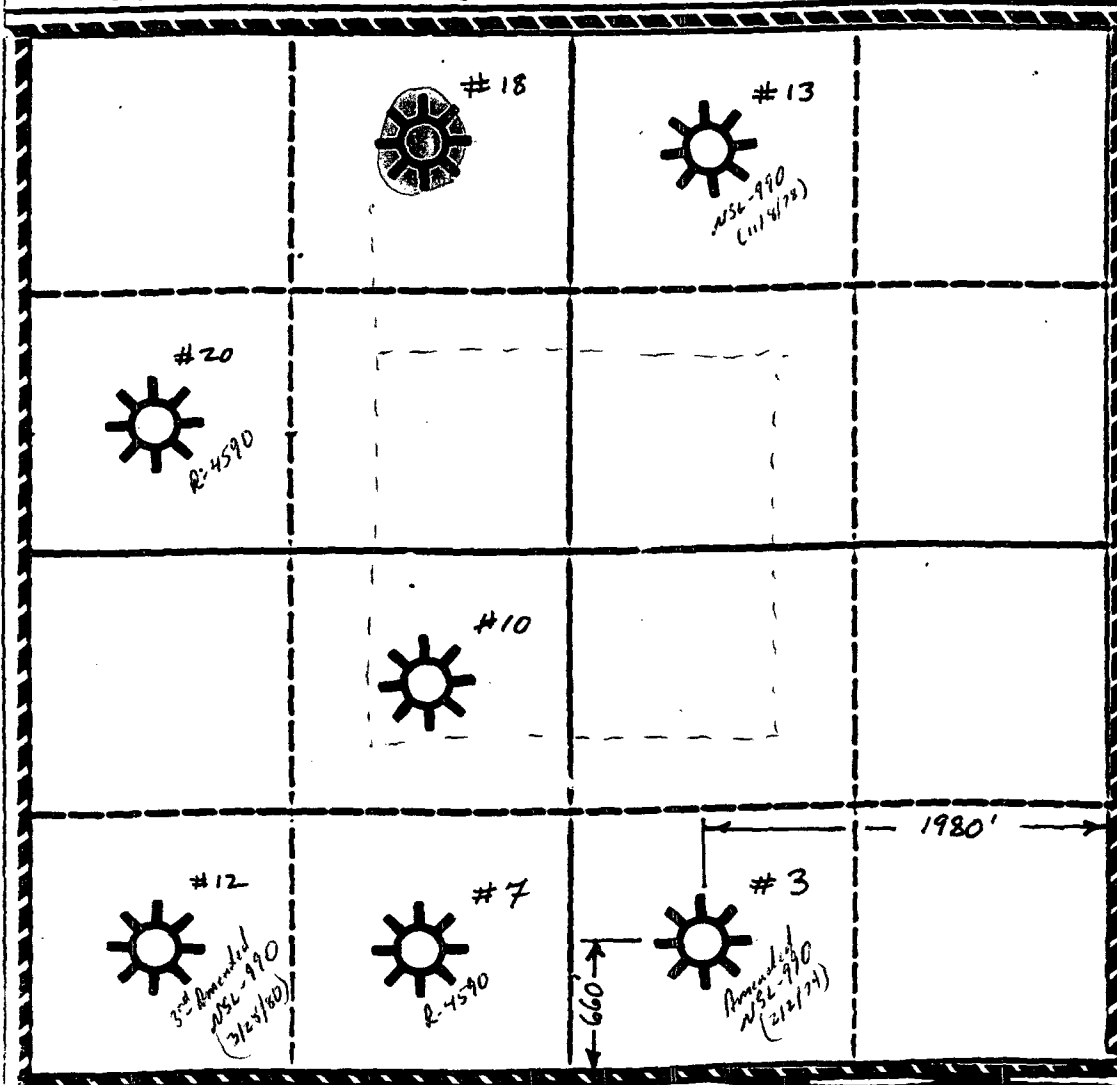

OPERATOR CERTIFICATION

I hereby certify that the information contained herein is true and correct to the best of my knowledge and belief.

Signature
Richard E. Black

Printed Name
RICHARD E. BLACK

Position
PETROLEUM ENGINEER

Company
CHEVRON U.S.A. Inc.

Date
7/6/93

SURVEYOR CERTIFICATION

I hereby certify that the well location on this plat was plotted from field or aerial surveys made by me or one of my assistants, and that the same is in correct to the best of my knowledge and belief.

Date Surveyed

Signature of Joint or Professional Surveyor

Comments, etc.

Submit to ADDRESSEE
MINERALS SECTION
State Lease - 4 copies
Oil Lease - 3 copies

State of New Mexico
Energy, Minerals and Natural Resources Department

Form C-102
Revised 4-1-89

OIL CONSERVATION DIVISION
P.O. Box 2088
Santa Fe, New Mexico 87504-2088

DISTRICT OFFICE
P.O. Box 1760, Hobbs, NM 87401

DISTRICT OFFICE
P.O. Drawer 100, Aztec, NM 87410

DISTRICT OFFICE
1000 Rio Arriba Rd., Aztec, NM 87410

WELL LOCATION AND ACREAGE DEDICATION PLAT

All Distances must be from the outer boundaries of the section

Operator CHEVRON U.S.A. Inc.			Lease W.A. RAMSAY (NCT-A)			Well No. 7		
Unit Letter N	Section 35	Township 21 S	Range 36 E	County LEA				
Actual Forfeiture Location of Well: 660 feet from the SOUTH line and 1980 feet from the WEST line								
Unit 3581	Producing Formation YATES / TRURS / Queen			Pool EUMONT		Dedication Acreage 640 Acres		

1. Outline the acreage dedicated to the subject well by crossed pencils or accurate marks on the plat below.

2. If more than one lease is dedicated to the well, outline each and identify the ownership thereof (both as to working interest and royalty).

3. If more than one lease of different ownership is dedicated to the well, have the interests of all owners been consolidated by communitization.

consolidation, joint-ownership, etc.?

☐ Yes

☐ No

If answer is "yes" type of consolidation

If answer is "no" list the owners and tract descriptions which have actually been consolidated. (Use reverse side of this form if necessary.)

No allowable will be assigned to the well until all interests have been consolidated (by communitization, joint-ownership, or otherwise) or until a non-consent unit, eliminating such interest, has been approved by the Division.

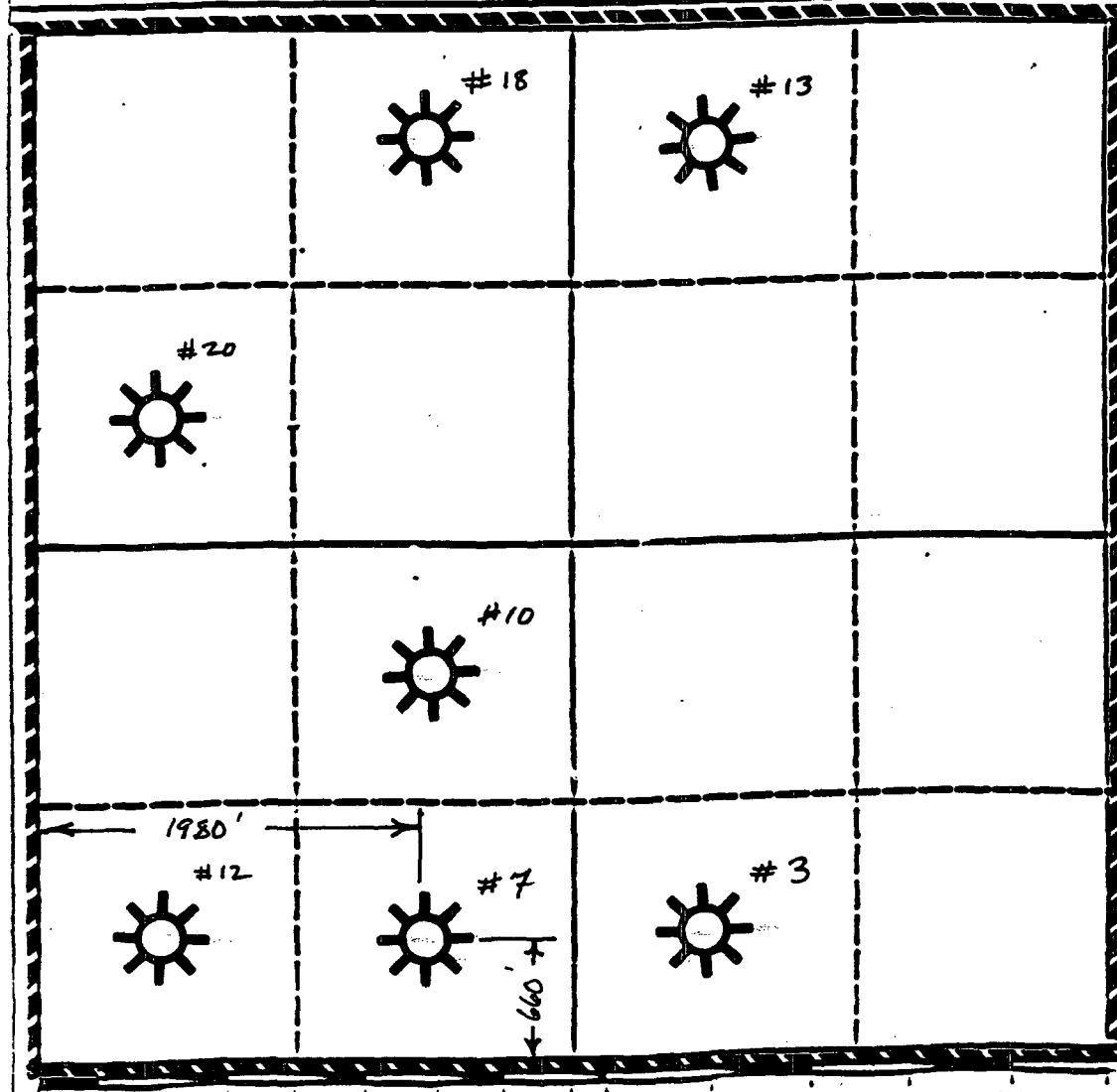

OPERATOR CERTIFICATION

I hereby certify that the above contained herein is true and complete to the best of my knowledge and belief.

Signature
Richard E. Black

Printed Name
RICHARD E. BLACK

Position
PETROLEUM ENGINEER

Company
CHEVRON U.S.A. INC.

Date
7/6/93

SURVEYOR CERTIFICATION

I hereby certify that the well location on this plat was plotted from field or aerial surveys made by me or under my supervision, and that the same is true and correct to the best of my knowledge and belief.

Date Surveyed

Signature and Seal of Professional Surveyor

Comments, etc.

Form C-102
Revised 4-1-83

State of New Mexico
Energy, Minerals and Natural Resources Department

OIL CONSERVATION DIVISION

P.O. Box 2088
Santa Fe, New Mexico 87504-2088

DISTRICT 1
P.O. Box 1960, Hobbs, NM 88240

DISTRICT 2
P.O. Drawer 100, Artesia, NM 88210

DISTRICT 3
1000 Rio Grande Rd., Alamogordo, NM 87410

WELL LOCATION AND ACREAGE DEDICATION PLAT

All Distances must be from the outer boundaries of the section

Operator CHEVRON U.S.A. Inc.			Lease W.A. RAMSAY (NCT-A)			Well No. 10		
Unit K	Section 35	Township 21 S	Range 36 E	County LEA				
Actual Forage Location of Well								
1980 feet from the SOUTH			1980 feet from the WEST					
3581' YATES / QUEEN			EUMONT			Dedicated Acreage 640 Acres		

1. Outline the acreage dedicated to the subject well by concrete posts or accurate marks on the plat below.

2. If more than one lease is dedicated to the well, outline each and identify the ownership thereof (both as to working interest and royalty).

3. If more than one lease of different ownership is dedicated to the well, have the interest of all owners been consolidated by commutation, unitization, forced-pooling, etc.?

☐ Yes ☐ No If answer is "yes" type of consolidation

If answer is "no" list the owners and tract descriptions which have actually been consolidated. (Use reverse side of this form if necessary).

No allowable will be assigned to the well until all interests have been consolidated (by commutation, unitization, forced-pooling, or otherwise) or until a non-unitized unit, eliminating such interest, has been approved by the Division.

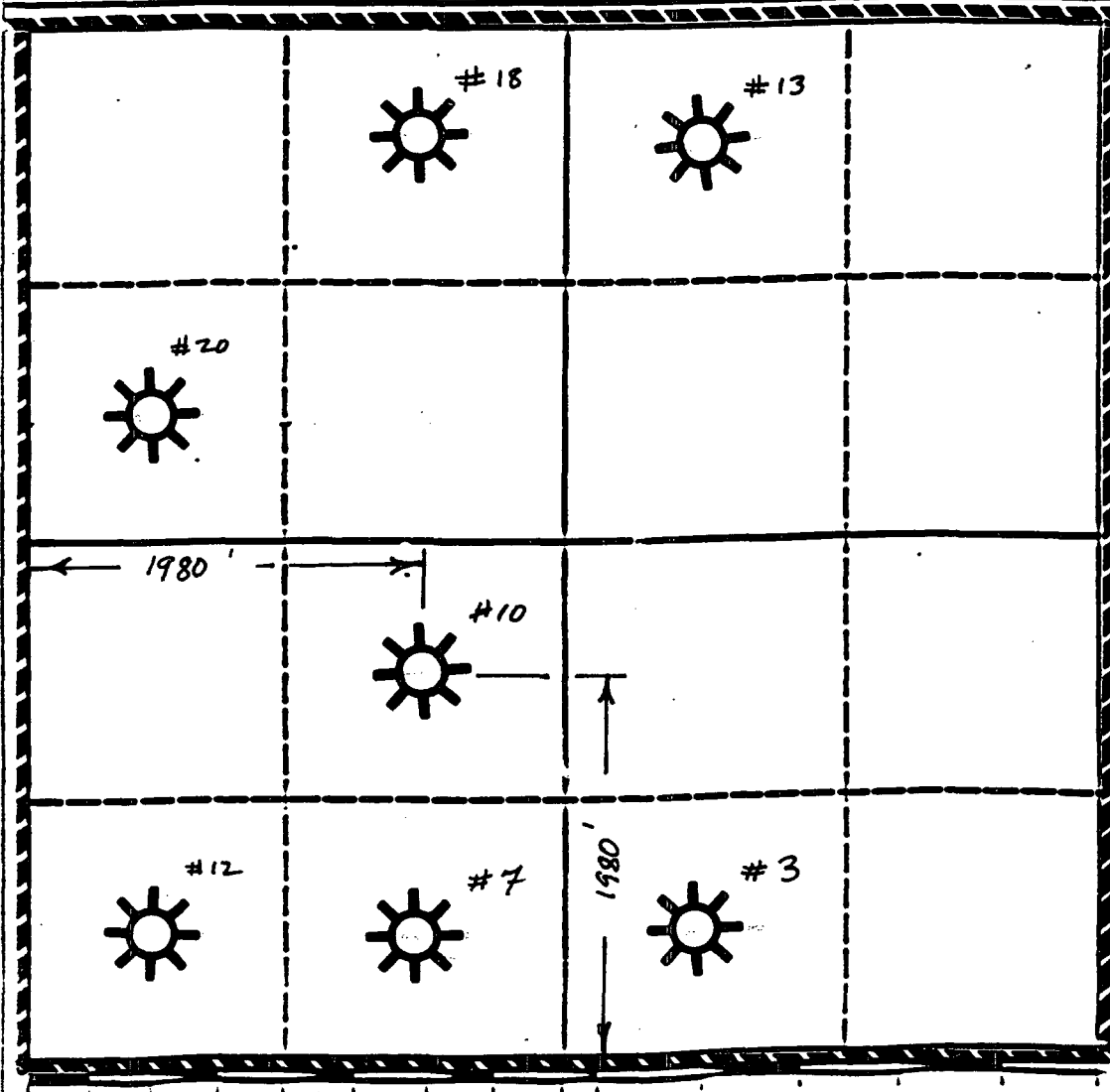

OPERATOR CERTIFICATION

I hereby certify that the information contained herein is true and accurate to the best of my knowledge and belief.

Signature
Richard E. Black

Printed Name
RICHARD E. BLACK

Position
PETROLEUM ENGINEER

Company
CHEVRON U.S.A. INC.

Date
7/6/93

SURVEYOR CERTIFICATION

I hereby certify that the well location on this plat was plotted from field or aerial surveys made by me or under my supervision, and that the same is true and correct to the best of my knowledge and belief.

Date Surveyed

Signature of State of Professional Surveyor

Comments

Submit to ADDRESSEE
MAILING OFFICE
DATE LEASE - 4-4-1988
IN LEASE - 3-4-1988

State of New Mexico
Energy, Minerals and Natural Resources Department

Form G-102
Revised 4-1-89

OIL CONSERVATION DIVISION
P.O. Box 2088
Santa Fe, New Mexico 87504-2088

DISTRICT OFFICE
P.O. Box 1761, Hobbs, NM 88240

DISTRICT OFFICE
P.O. Drawer 140, Aztec, NM 88210

DISTRICT OFFICE
1000 Rio Grande Rd., Aztec, NM 87410

WELL LOCATION AND ACREAGE DEDICATION PLAT

All Distances must be from the clear boundaries of the section

Operator CHEVRON U.S.A. Inc.		Lease W.A. RAMSAY (NCT-A)		Well No. 12	
Unit Letter M	Section 35	Township 21 S	Range 36 E	County LEA	
Actual Forage Location of Well: 660 feet from the SOUTH line and 660 feet from the WEST line					
Depth 3580	Producing Formation YATES / TRURS		Pool EUMONT		Dedicated Acreage 640 Acres

- Outline the acreage dedicated to the subject well by colored pencil or marking ink on the plat below.
- If more than one lease is dedicated to the well, outline each and identify the ownership thereof (both as to working interest and royalty).
- If more than one lease of different ownership is dedicated to the well, have the interest of all owners been consolidated by communication, assignment, force-pooling, etc.?
☐ Yes ☐ No If answer is "yes" type of consolidation _____

If answer is "no" list the owners and tract descriptions which have actually been consolidated. (Use reverse side of this form if necessary.)

No allowable well be assigned to the well until all interests have been consolidated (by communication, assignment, force-pooling, or otherwise) or until a non-consent unit, eliminating such interest, has been approved by the Division.

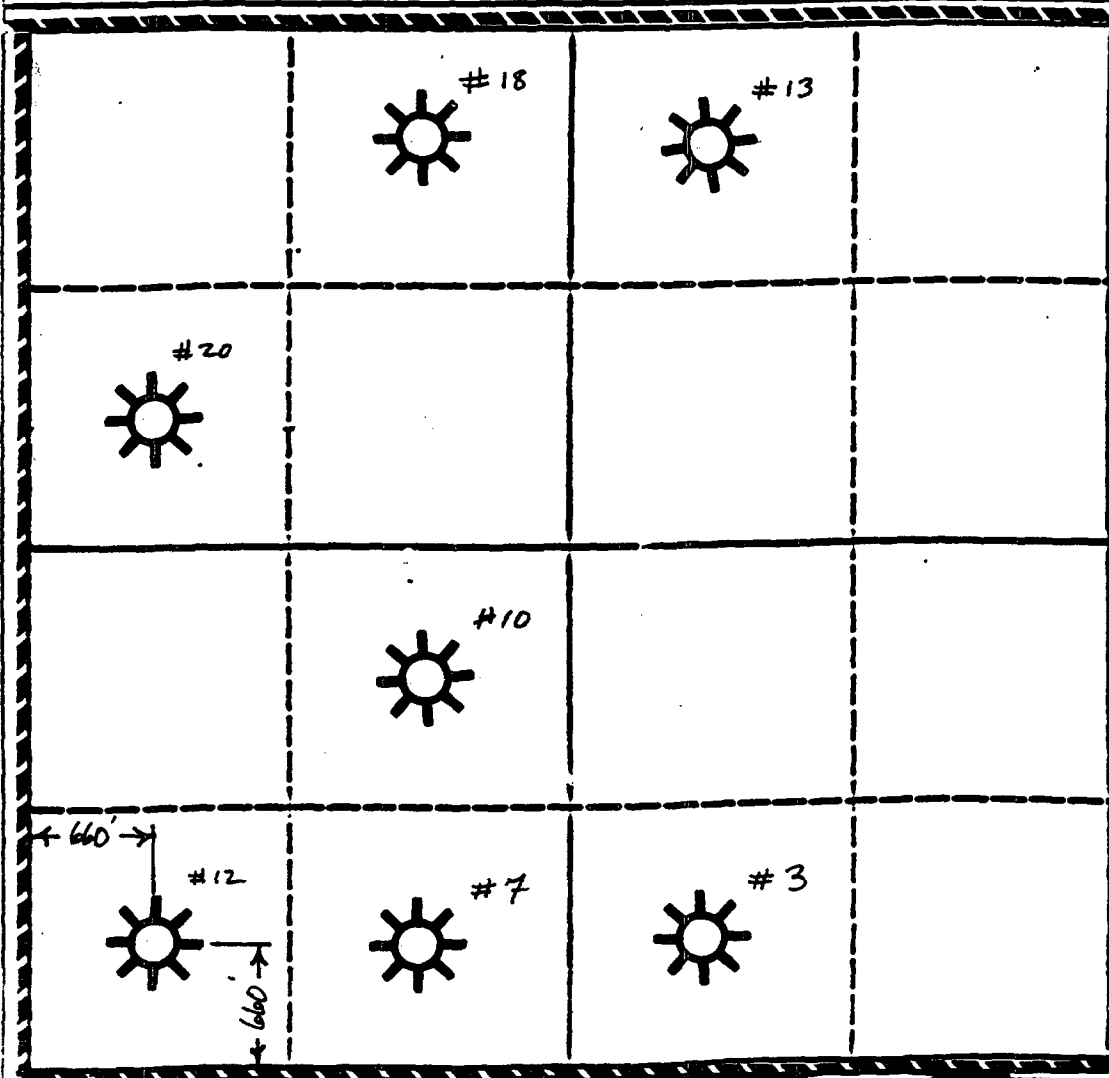

OPERATOR CERTIFICATION

I hereby certify that the information contained herein is true and complete to the best of my knowledge and belief.

Signature
Richard E. Black Jr.

Printed Name
RICHARD E. BLACK.

Position
PETROLEUM ENGINEER

Company
CHEVRON U.S.A. INC.

Date
7/6/93

SURVEYOR CERTIFICATION

I hereby certify that the well location on this plat was plotted from field actual surveys made by me or under my supervision, and that the same is true and correct to the best of my knowledge and belief.

Date Surveyed

Signature of Seal of Professional Surveyor

Certification No.

Where to Acquire
Form 6-102
State of New Mexico
Energy, Minerals and Natural Resources Department

State of New Mexico
Energy, Minerals and Natural Resources Department

Form 6-102
Revised 4-1-89

OIL CONSERVATION DIVISION

P.O. Box 2088
Santa Fe, New Mexico 87504-2088

INTEREST
P.O. Box 1461, Hobbs, NM 88240

INTEREST
P.O. Drawer 101, Aztec, NM 88210

INTEREST
1000 Rio Arriba Rd., Aztec, NM 87410

WELL LOCATION AND ACREAGE DEDICATION PLAT

All Distances must be from the outer boundaries of the section

Operator CHEVRON U.S.A. Inc.			Lease W.A. RAMSAY (NCT-A)			Well No. 13		
Unit B	Section 35	Township 21S	Range 36E	County LEA				
Actual Footage Location of Well: 660 feet from the NORTH line and 1980 feet from the EAST line								
Unit 3548	Producing Formation QUEEN		Pool EUMONT		Dedication Acreage 640		Acres	

- Outline the acreage dedicated to the subject well by crosses placed on the plat below.
- If more than one lease is dedicated to the well, outline each and identify the ownership thereof (both as to working interest and royalty).
- If more than one lease of different ownership is dedicated to the well, have the interest of all owners been consolidated by commutation, unitization, force-pooling, etc?

☐ Yes ☐ No If answer is "yes" type of consolidation _____

If answer is "no" list the owners and tract descriptions which have actually been consolidated. (Use reverse side of this form if necessary).

No allowable will be assigned to the well until all interests have been consolidated (by commutation, unitization, force-pooling, or otherwise) or until a non-unitized unit, eliminating such interest, has been approved by the Division.

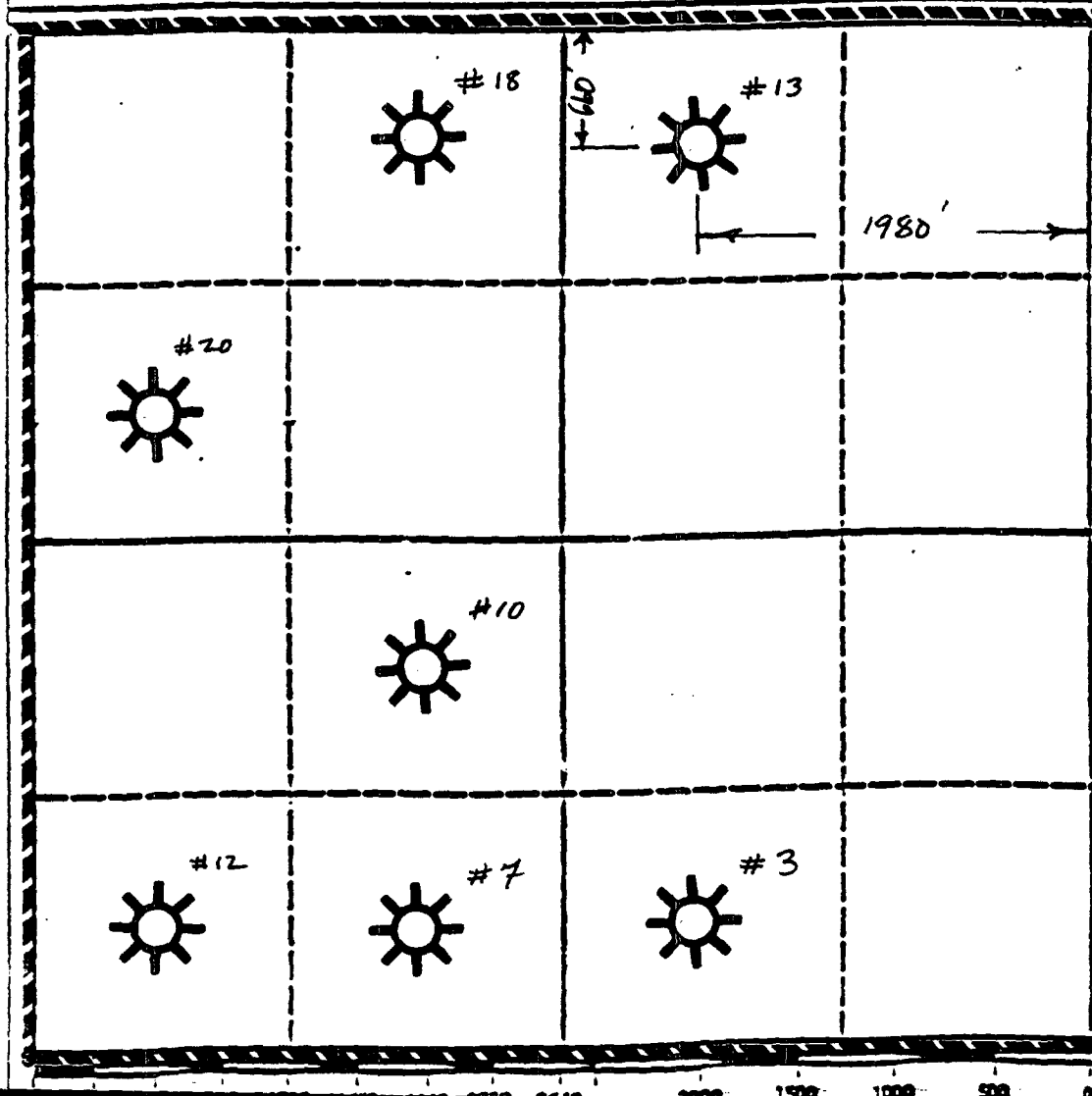

OPERATOR CERTIFICATION

I hereby certify that the information contained herein is true and complete to the best of my knowledge and belief.

Signature
Richard E. Black Jr.

Printed Name
RICHARD E. BLACK.

Position
PETROLEUM ENGINEER

Company
CHEVRON U.S.A. INC.

Date
7/6/93

SURVEYOR CERTIFICATION

I hereby certify that the well location on this plat was plotted from field notes and surveys made by me or under my supervision, and that the same is true and correct to the best of my knowledge and belief.

Date Surveyed _____

Signature or Seal of Professional Surveyor _____

Certification No. _____

There is Additional
Interest in this
Lease - 4 acres
in Lease - 2 acres

State of New Mexico
Energy, Minerals and Natural Resources Department

Form C-102
Revised 4-4-59

OIL CONSERVATION DIVISION

P.O. Box 2088
Santa Fe, New Mexico 87504-2088

DISTRICT IV
P.O. Box 1360, Hobbs, NM 88240

DISTRICT V
P.O. Drawer 100, Artesa, NM 88210

DISTRICT VI
1000 Rio Grande Rd., Artesa, NM 87410

WELL LOCATION AND ACREAGE DEDICATION PLAT

All Distances must be from the outer boundaries of the section

Operator CHEVRON U.S.A. Inc.		Lease W.A. RAMSAY (NCT-A)		Well No. 18
Use Lease C	Section 35	Township 21 S	Range 36 E	County LEA
Actual Surface Location of Well: 660 feet from the NORTH line and 1980 feet from the WEST line				
Section 3553	Producing Formation YATES / TRURS		Foot EUMONT	Dedication Acreage 640 Acres

1. Outline the acreage dedicated to the subject well by corner points or section marks on the plat below.

2. If more than one lease is dedicated to the well, outline each and identify the ownership thereof (both as to working interest and royalty).

3. If more than one lease of different ownership is dedicated to the well, have the interest of all owners been consolidated by communitization.

unitization, forced-pooling, etc.

☐ Yes ☐ No If answer is "yes" type of consolidation

If answer is "no" list the owners and tract descriptions which have actually been consolidated. (Use reverse side of this form if necessary.)

No allowable will be assigned to the well until all interests have been consolidated (by communitization, unitization, forced-pooling, or otherwise) or until a non-standard unit, relinquishing such interest, has been approved by the Division.

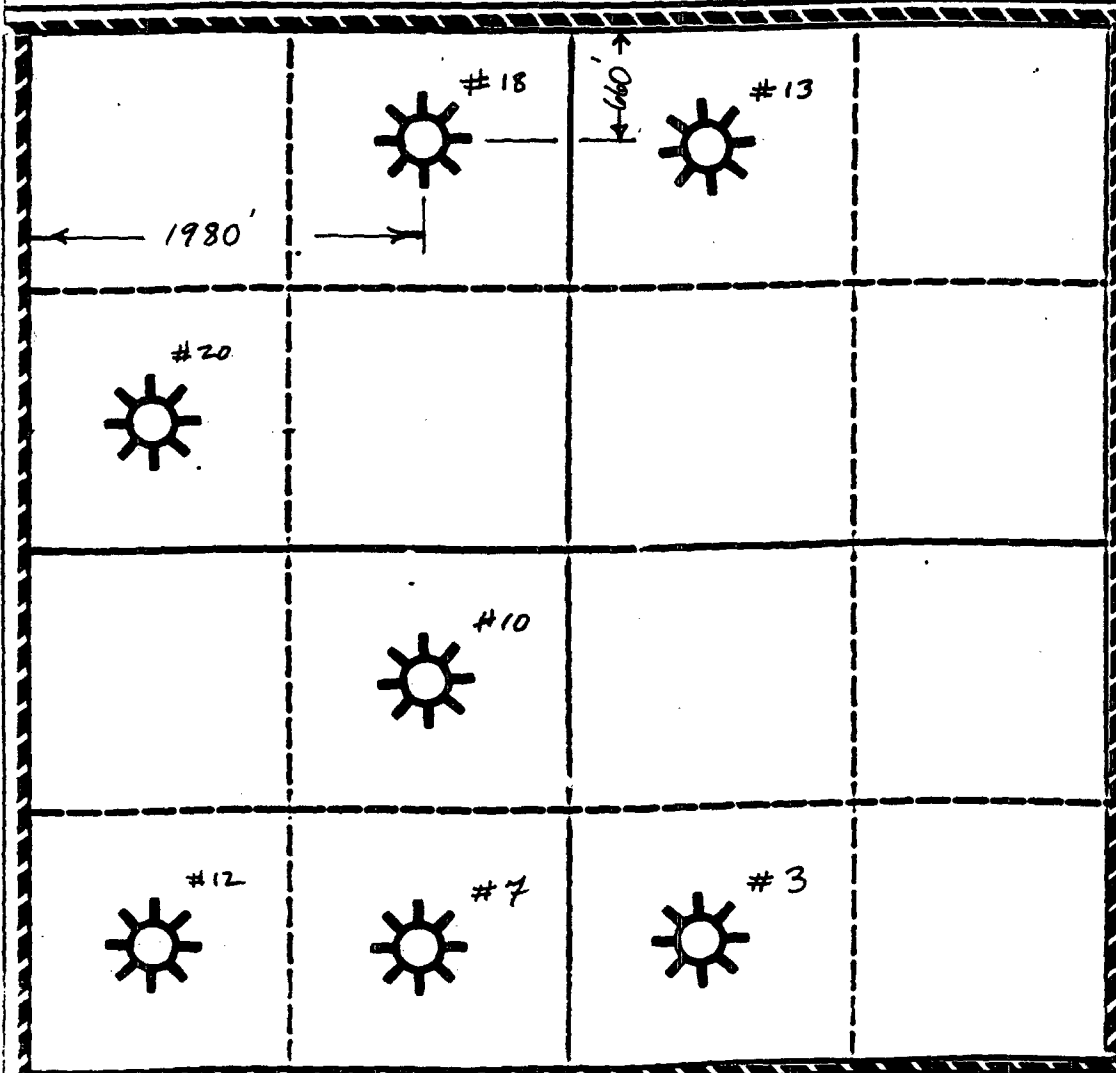

OPERATOR CERTIFICATION

I hereby certify that the information contained herein is true and complete to the best of my knowledge and belief.

Signature
Richard E. Black Jr.

Printed Name
RICHARD E. BLACK

Position
PETROLEUM ENGINEER

Company
CHEVRON U.S.A. Inc.

Date
7/6/93

SURVEYOR CERTIFICATION

I hereby certify that the well location on this plat was plotted from field actual surveys made by me or my supervision, and that the same is true and correct to the best of my knowledge and belief.

Date Surveyed

Signature of Seal of Professional Surveyor

Certification No.

Where to Address
Mining Office
State Lands - 4 copies
Oil Lands - 3 copies

State of New Mexico
Energy, Minerals and Natural Resources Department

Form C-102
Revised 4-1-59

OIL CONSERVATION DIVISION

P.O. Box 2088
Santa Fe, New Mexico 87504-2088

DISTRICT OFFICE
P.O. Box 1961, Hobbs, NM 88240

DISTRICT OFFICE
P.O. Drawer 101, Artesia, NM 88210

DISTRICT OFFICE
1000 Rio Grande Rd., Artesia, NM 87410

WELL LOCATION AND ACREAGE DEDICATION PLAT

All Distances must be from the outer boundaries of the section

Operator CHEVRON U.S.A. Inc.		Lease W.A. RAMSAY (NCT-A)		Well No. 20	
Use Lease E	Section 35	Township 21S	Range 36E	County LEA	
Actual Surface Location of Well: 1980 feet from the NORTH line and 660 feet from the WEST line					
Gate 3577	Producing Formation YATES		Pool EUMONT		Dedication Acreage 640 Acres

1. Outline the acreage dedicated to the subject well by concrete posts or painted marks on the plat below.

2. If more than one lease is dedicated to the well, outline each and identify the ownership thereof (both as to working interest and royalty).

3. If more than one lease of different ownership is dedicated to the well, have the interest of all owners been consolidated by communication, unification, lease-pooling, etc.?

☐ Yes ☐ No If answer is "yes" type of consolidation

If answer is "no" list the owners and tract descriptions which have actually been consolidated. (Use reverse side of this form if necessary.)

No allowable will be assigned to the well until all interests have been consolidated (by communication, unification, lease-pooling, or otherwise) or until a non-consent unit, eliminating such interest, has been approved by the Division.

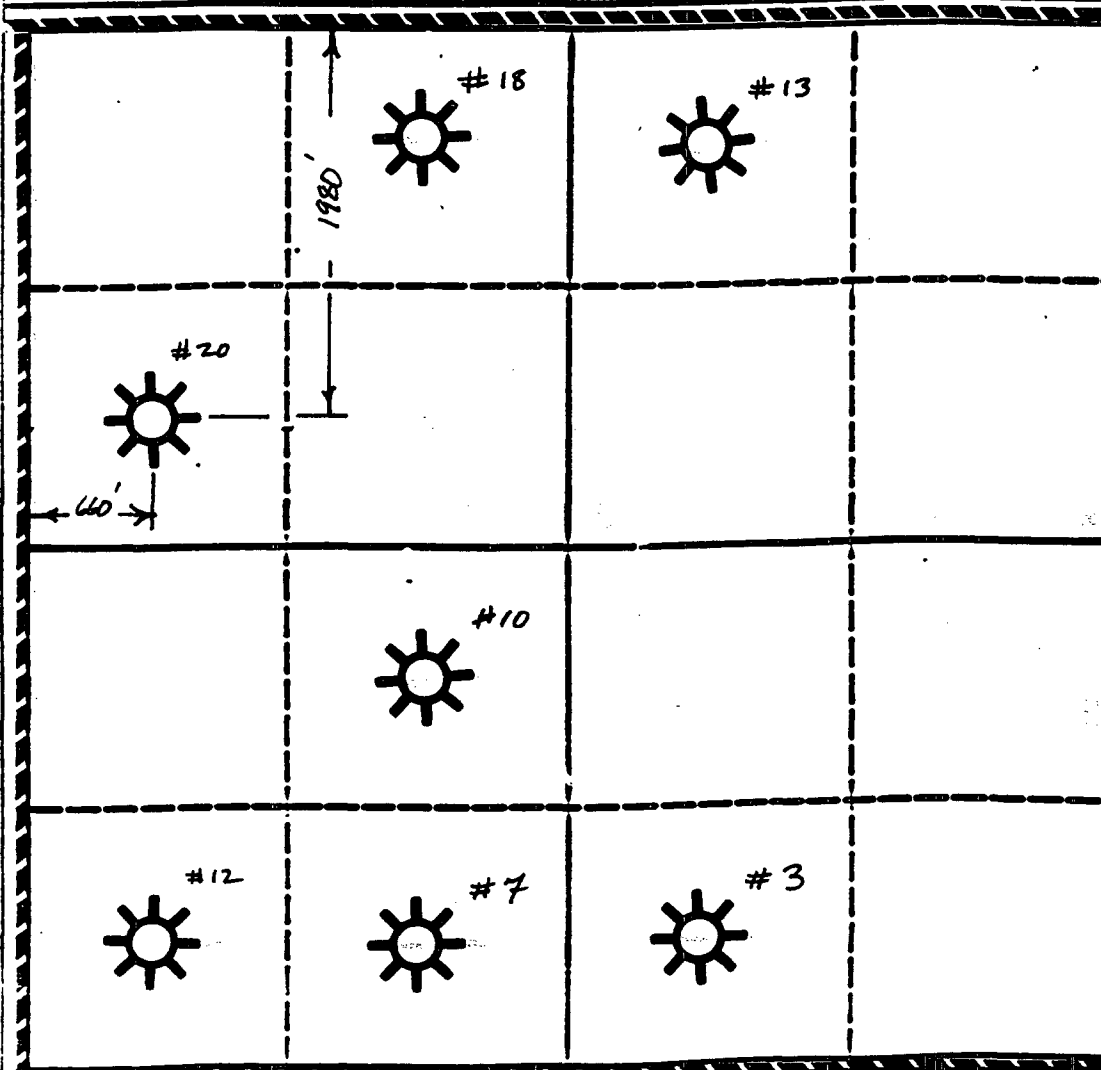

OPERATOR CERTIFICATION

I hereby certify that the information contained herein is true and complete to the best of my knowledge and belief.

Signature
Richard E. Black Jr.

Printed Name
RICHARD E. BLACK

Position
PETROLEUM ENGINEER

Company
CHEVRON U.S.A. INC.

Date
7/6/93

SURVEYOR CERTIFICATION

I hereby certify that the well location on this plat was plotted from field actual survey made by me or under my supervision, and that the same is true and correct to the best of my knowledge and belief.

Date Surveyed

Signature and Seal of Professional Surveyor

Certification No.

BEFORE THE OIL CONSERVATION COMMISSION
OF THE STATE OF NEW MEXICO

IN THE MATTER OF THE HEARING
CALLED BY THE OIL CONSERVATION
COMMISSION OF NEW MEXICO FOR
THE PURPOSE OF CONSIDERING:

CASE NO. 4983
Order No. R-4590

APPLICATION OF GULF OIL CORPORATION
FOR SIMULTANEOUS WELL DEDICATION
AND NON-STANDARD LOCATIONS, LEA
COUNTY, NEW MEXICO.

ORDER OF THE COMMISSION

BY THE COMMISSION:

This cause came on for hearing at 9 a.m. on June 27, 1973, at Santa Fe, New Mexico, before Examiner Elvis A. Utz.

NOW, on this 13th day of July, 1973, the Commission, a quorum being present, having considered the testimony, the record, and the recommendations of the Examiner, and being fully advised in the premises,

FINDS:

(1) That due public notice having been given as required by law, the Commission has jurisdiction of this cause and the subject matter thereof.

(2) That the applicant, Gulf Oil Corporation, is the owner and operator of the W. A. Ramsay (NCT-A) Well No. 20 in Unit E of Section 35 and the W. A. Ramsay (NCT-A) Well No. 7 in Unit N of Section 35, both in Township 21 South, Range 36 East, NMPM, Eumont Gas Pool, Lea County, New Mexico.

(3) That the applicant seeks approval for the simultaneous dedication of the above two described wells to a standard 640-acre gas proration unit comprising all of Section 35, Township 21 South, Range 36 East, NMPM, Eumont Gas Pool, Lea County, New Mexico.

(4) That the applicant seeks approval of a non-standard location for its W. A. Ramsay (NCT-A) Well No. 7 in Unit N, located 660 feet from the South line and 1980 feet from the West line of said Section 35.

(5) That the applicant further seeks authority to produce the allowable assigned to the unit from either of the aforesaid wells in any proportion and to make up the gas underage accrued on the said W. A. Ramsay (NCT-A) No. 20.

(6) That approval of the subject application will afford the applicant the opportunity to produce its just and equitable share of the gas in the Eumont Gas Pool and will otherwise prevent waste and protect correlative rights.

IT IS THEREFORE ORDERED:

(1) That the applicant, Gulf Oil Corporation, is hereby authorized the simultaneous dedication of its W. A. Ramsay (NCT-A) Well No. 20 in Unit E, located at a non-standard location in Unit E of Section 35, Township 21 South, Range 36 East, NMPM, and its W. A. Ramsay (NCT-A) Well No. 7 in Unit N, located at a non-standard location in Unit N of said Section 35 to a standard 640-acre gas proration unit comprising all of said Section 35.

(2) That the allowable assigned to the above-described gas proration unit shall be based upon the unit size of 640 acres; that the operator may produce the allowable assigned to the unit from the subject wells in any proportion; and that the status of said consolidated unit shall be the combined status, as of August 1, 1973, of the two wells being consolidated.

(3) That jurisdiction of this cause is retained for the entry of such further orders as the Commission may deem necessary.

DONE at Santa Fe, New Mexico, on the day and year hereinabove designated.

STATE OF NEW MEXICO
OIL CONSERVATION COMMISSION

I. R. TRUJILLO, Chairman

ALEX J. ARMIJO, Member

A. L. PORTER, Jr., Member & Secretary

S E A L

dr/



Chevron U.S.A. Production Company

P.O. Box 1150, Midland, TX 79702

Midland, Texas

July 15 1993

Simultaneous Dedication and
Unorthodox Gas Well Location
Eumont YTS-7RVRS-QN
(Pro Gas) Pool
Lea County, New Mexico

ARCO Oil and Gas Company

P.O. Box 1610

Midland, Texas 79701

New Mexico Operations Director:

Attached is a copy of an administrative application for NMOCD approval of an unorthodox well location and simultaneous dedication in the Eumont YTS-7RVRS-QN (Pro Gas) Pool.

Chevron U.S.A. is planning to recomplete the W.A. Ramsay (NCT-A) #18 from the Eumont Oil Pool to the Eumont Gas Pool. The subject well is located 660' FNL and 1980' FWL in Section 35 of T-21-S, R-36-E, Lea County, New Mexico. We have requested that the NMOCD approve the simultaneous dedication of this well with the W.A. Ramsay (NCT-A) Nos. 3, 7, 10, 12, 13, and 20 which produce on an existing standard 640-acre Eumont gas spacing and proration unit (GPU). This GPU comprises all of Section 35 in T-21-S, R-36-E. Because the subject well is located 660' from the boundary of a 640-acre GPU, we have also requested NMOCD approval of an unorthodox well location.

If you have any questions about the application, please contact Richard Black at (915) 687-7284.

Sincerely,

F.S. Godbold

Petroleum Engineering Supervisor
New Mexico Area

REB/tmdr
9476.DOC

Attachments



Chevron U.S.A. Production Company

P.O. Box 1150, Midland, TX 79702

Midland, Texas
July 15, 1993

Simultaneous Dedication and
Unorthodox Gas Well Location
Eumont YTS-7RVRS-QN
(Pro Gas) Pool
Lea County, New Mexico

CONOCO Inc.
10 Desta Drive
Midland, Texas 79705

New Mexico Operations Director:

Attached is a copy of an administrative application for NMOCD approval of an unorthodox well location and simultaneous dedication in the Eumont YTS-7RVRS-QN (Pro Gas) Pool.

Chevron U.S.A. is planning to recomplete the W.A. Ramsay (NCT-A) #18 from the Eumont Oil Pool to the Eumont Gas Pool. The subject well is located 660' FNL and 1980' FWL in Section 35 of T-21-S, R-36-E, Lea County, New Mexico. We have requested that the NMOCD approve the simultaneous dedication of this well with the W.A. Ramsay (NCT-A) Nos. 3, 7, 10, 12, 13, and 20 which produce on an existing standard 640-acre Eumont gas spacing and proration unit (GPU). This GPU comprises all of Section 35 in T-21-S, R-36-E. Because the subject well is located 660' from the boundary of a 640-acre GPU, we have also requested NMOCD approval of an unorthodox well location.

If you have any questions about the application, please contact Richard Black at (915) 687-7284.

Sincerely,

F.S. Godbold
Petroleum Engineering Supervisor
New Mexico Area

REB/tmdr
9476.DOC

Attachments



Chevron U.S.A. Production Company

P.O. Box 1150, Midland, TX 79702

Midland, Texas

July 15, 1993

Simultaneous Dedication and
Unorthodox Gas Well Location
Eumont YTS-7RVRS-QN
(Pro Gas) Pool
Lea County, New Mexico

EXXON U.S.A. Inc.
New Mexico Operations Superintendent
P.O. Box 3116
Midland, TX 79702

Mr. Dixon:

Attached is a copy of an administrative application for NMOCD approval of an unorthodox well location and simultaneous dedication in the Eumont YTS-7RVRS-QN (Pro Gas) Pool.

Chevron U.S.A. is planning to recomplete the W.A. Ramsay (NCT-A) #18 from the Eumont Oil Pool to the Eumont Gas Pool. The subject well is located 660' FNL and 1980' FWL in Section 35 of T-21-S, R-36-E, Lea County, New Mexico. We have requested that the NMOCD approve the simultaneous dedication of this well with the W.A. Ramsay (NCT-A) Nos. 3, 7, 10, 12, 13, and 20 which produce on an existing standard 640-acre Eumont gas spacing and proration unit (GPU). This GPU comprises all of Section 35 in T-21-S, R-36-E. Because the subject well is located 660' from the boundary of the 640-acre GPU, we have also requested NMOCD approval of an unorthodox well location.

If you have any questions about the application, please contact Richard Black at (915) 687-7284.

Sincerely,

F.S. Godbold
Petroleum Engineering Supervisor
New Mexico Area

REB/tmdr
9476.DOC

Attachments



Chevron U.S.A. Production Company

P.O. Box 1150, Midland, TX 79702

Midland, Texas
July 15, 1993

Simultaneous Dedication and
Unorthodox Gas Well Location
Eumont YTS-7RVRS-QN
(Pro Gas) Pool
Lea County, New Mexico

MARATHON Oil Company
P.O. Box 552
Midland, Texas 79702

New Mexico Operations Director:

Attached is a copy of an administrative application for NMOCD approval of an unorthodox well location and simultaneous dedication in the Eumont YTS-7RVRS-QN (Pro Gas) Pool.

Chevron U.S.A. is planning to recomplete the W.A. Ramsay (NCT-A) #18 from the Eumont Oil Pool to the Eumont Gas Pool. The subject well is located 660' FNL and 1980' FWL in Section 35 of T-21-S, R-36-E, Lea County, New Mexico. We have requested that the NMOCD approve the simultaneous dedication of this well with the W.A. Ramsay (NCT-A) Nos. 3, 7, 10, 12, 13, and 20 which produce on an existing standard 640-acre Eumont gas spacing and proration unit (GPU). This GPU comprises all of Section 35 in T-21-S, R-36-E. Because the subject well is located 660' from the boundary of a 640-acre GPU, we have also requested NMOCD approval of an unorthodox well location.

If you have any questions about the application, please contact Richard Black at (915) 687-7284.

Sincerely,

F.S. Godbold
Petroleum Engineering Supervisor
New Mexico Area

REB/tmdr
9476.DOC

Attachments



Chevron U.S.A. Inc.
P.O. Box 1150, Midland, TX 79702

Permian Basin Production Business Unit

Midland, Texas
July 16, 1993

Simultaneous Dedication and
Unorthodox Gas Well Location
Eumont YTS-7RVRS-QN
(Pro Gas) Pool
Lea County, New Mexico

MERIDIAN Oil, Inc.
21 Desta Dr.
Midland, Texas 79705

New Mexico Operations Director:

Attached is a copy of an administrative application for NMOCD approval of an unorthodox well location and simultaneous dedication in the Eumont YTS-7RVRS-QN (Pro Gas) Pool.

Chevron U.S.A. is planning to recomplete the W.A. Ramsay (NCT-A) #18 from the Eumont Oil Pool to the Eumont Gas Pool. The subject well is located 660' FNL and 1980' FWL in Section 35 of T-21-S, R-36-E, Lea County, New Mexico. We have requested that the NMOCD approve the simultaneous dedication of this well with the W.A. Ramsay (NCT-A) Nos. 3, 7, 10, 12, 13, and 20 which produce on an existing standard 640-acre Eumont gas spacing and proration unit (GPU). This GPU comprises all of Section 35 in T-21-S, R-36-E. Because the subject well is located 660' from the boundary of a 640-acre GPU, we have also requested NMOCD approval of an unorthodox well location.

If you have any questions about the application, please contact Richard Black at (915) 687-7284.

Sincerely,

F.S. Godbold
F.S. Godbold
Petroleum Engineering Supervisor
New Mexico Area

REB/tmdr
9476.DOC

Attachments



STATE OF NEW MEXICO

ENERGY, MINERALS AND NATURAL RESOURCES DEPARTMENT

OIL CONSERVATION DIVISION
HOBBS DISTRICT OFFICE

93 JU 7 AM 9 03

7-13-93

BRUCE KING
GOVERNOR

POST OFFICE BOX 1980
HOBBS, NEW MEXICO 88241-1980
(505) 393-6161

OIL CONSERVATION DIVISION
P. O. BOX 2088
SANTA FE, NEW MEXICO 87501

RE: Proposed:

MC	_____
DHC	_____
NSL	<u>X</u> _____
NSP	_____
SWD	_____
WFX	_____
PMX	_____

Gentlemen:

I have examined the application for the:

<u>Chevron USA Inc</u>	<u>W.A. Ramsay NCT-A</u>	<u>#18-C</u>	<u>35-21-36</u>
Operator	Lease & Well No.	Unit	S-T-R

and my recommendations are as follows:

OK

Yours very truly,

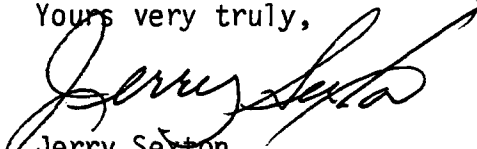
Jerry Sexton
Supervisor, District 1

/ed

Submit to Appropriate
District Office
State Lease-6 copies
Fee Lease-6 copies

State of New Mexico
Energy, Minerals and Natural Resources Department

Form C-101
Revised 1-1-89

OIL CONSERVATION DIVISION

P.O. Box 2088
Santa Fe, New Mexico 87504-2088

DISTRICT I

P.O. Box 1980, Hobbs, NM 88240

DISTRICT II

P.O. Drawer Dd, Artesia, NM 88210

DISTRICT III

1000 Rio Brazos Rd., Aztec, Nm 87410

API NO. (assigned by OCD on New Wells) 30-025-04925	
5. Indicate Type of Lease STATE <input checked="" type="checkbox"/> FEE <input type="checkbox"/>	
6. State Oil & Gas Lease No. N/A	
7. Lease Name or Unit Agreement Name W. A. RAMSAY (NCT-A)	
8. Well No. 18	
9. Pool name or Wildcat EUMONT GAS	
10. Proposed depth 3860'	
11. Formation YATES	
12. Rotary or C.T. ROTARY	
13. Elevation (Show DF, RT, GR, etc.) 3553' GL	
14. Kind & Status Plug Bond BLANKET	
15. Drig Contractor UNKNOWN	
16. Date Work will start 07/15/1993	

APPLICATION FOR PERMIT TO DRILL, DEEPEN, OF PLUG BACK					
1a. Type of Work: DRILL <input type="checkbox"/> RE-ENTER <input type="checkbox"/> DEEPEN <input type="checkbox"/> PLUG BACK <input checked="" type="checkbox"/>					
b. Type of Well: OIL WELL <input type="checkbox"/> GAS WELL <input checked="" type="checkbox"/> OTHER <input type="checkbox"/> SINGLE ZONE <input checked="" type="checkbox"/> MULTIPLE ZONE <input type="checkbox"/>					
2. Name of Operator CHEVRON U.S.A. INC.					
3. Address of Operator P.O. BOX 1150, MIDLAND, TX 79702 ATTN: NITA RICE					
4. Well Location Unit Letter <u>C</u> : <u>660</u> Feet From The <u>NORTH</u> Line on <u>1980</u> Feet From The <u>WEST</u> Line Section <u>35</u> Township <u>21S</u> Range <u>36 E</u> NMPM <u>LEA</u> County					
17. EXISTING CASING AND CEMENT PROGRAM					
SIZE OF HOLE	SIZE OF CASING	WEIGHT PER FOOT	SETTING DEPTH	SACKS OF CEMENT	EST. TOP
UNKNOWN	8-5/8"	24#	260'	225	SURFAC
UNKNOWN	5-1/2"	14#	3859'	2100	TOC @ 385' BY TS

WE PROPOSE TO:

MIRU, POH W/RODS & PMP. ND WH,NU BOP. POH W/TBG. D/O TO 3760'.
SET CIBP @ 3750', CAP W/35' CEMENT. DISPLACE W/2% KCL WTR. TST CASING TO 300#.
RUN CBL-CET-GR-CCL LOG F/PBTD TO 1500'. PERF 2978-3251' W/2 JHPF, 28 TOTAL HOLES.
RIH W/PPI TOOL, TST TO 3000 PSI IN BLANK PIPE, SET AT 3260' & TEST RATHOLE & CIBP
TO 1000 PSI. ACDZ EACH SET OF PERFS (14 SETS) W/150 GALS 15% NEFE HCL.
SWAB BACK LOAD. TST WORKSTRING TO 8000 PSI W/RIH. SET PKR @ 2965, LOAD BACKSIDE
W/2% KCL WTR & TST TO 300 PSI. FRAC PERFS 2978-3251 W/57000 GALS & 202,000# 12/20 SD.
FLUSH, RUN PROD TBG, LATCH ONTO PKR, ND BOP,NU WH. PULL PLUG & TURN OVER TO PROD.

IN ABOVE SPACE DESCRIBE PROPOSED IF PROPOSAL IS TO DEEPEN OR PLUG BACK, GIVE DATA ON PRESENT PRODUCTIVE ZONE AND PROPOSED
NEW PRODUCTIVE ZONE. GIVE BLOWOUT PREVENTER PROGRAM, IF ANY.

I hereby certify that the information above is true and complete to the best of my knowledge and belief.

SIGNATURE Nita Rice TITLE TECHNICAL ASSISTANT DATE 07/7/93

TYPE OR PRINT NAME NITA RICE TELEPHONE NO. (915) 687-7436

APPROVED BY _____ TITLE _____ DATE _____
CONDITIONS OF APPROVAL, IF ANY: _____

State of New Mexico
Energy, Minerals and Natural Resources Department

Form C-102
Revised 4-1-83

OIL CONSERVATION DIVISION

P.O. Box 2088
Santa Fe, New Mexico 87504-2088

WELL LOCATION AND ACREAGE DEDICATION PLAT

All Distances must be from the corner corners of the section

Operator CHEVRON U.S.A. Inc.				Lease W.A. RAMSAY (NCT-A)		Well No. 18	
Unit Letter C	Section 35	Township 21 S	Range 36 E	County LEA			
Actual Acreage Dedication of Well:							
660 feet from the NORTH		1980 feet from the WEST					
Unit 3553	Producing Formation YATES / TRURS		Pool EUMONT		Dedication Acreage 640		Acres

- Outline the acreage contained in the subject well by corner points or bearing lines on the plat below.
- If more than one lease is dedicated to the well, outline each and identify the ownership thereof (both as to working interest and royalty).
- If more than one lease of different ownership is dedicated to the well, have the interest of all owners been consolidated by commutation, unitization, forced pooling, etc?

☐ Yes
 ☐ No

If answer is "yes" type of consolidation _____

If answer is "no" list the owners and their descriptions which have actually been consolidated. (Use reverse side of this form if necessary.) _____

No allowable will be assigned to the well until all interests have been consolidated (by commutation, unitization, forced pooling, or otherwise) or until a non-unitization unit, eliminating such interests, has been approved by the Division.

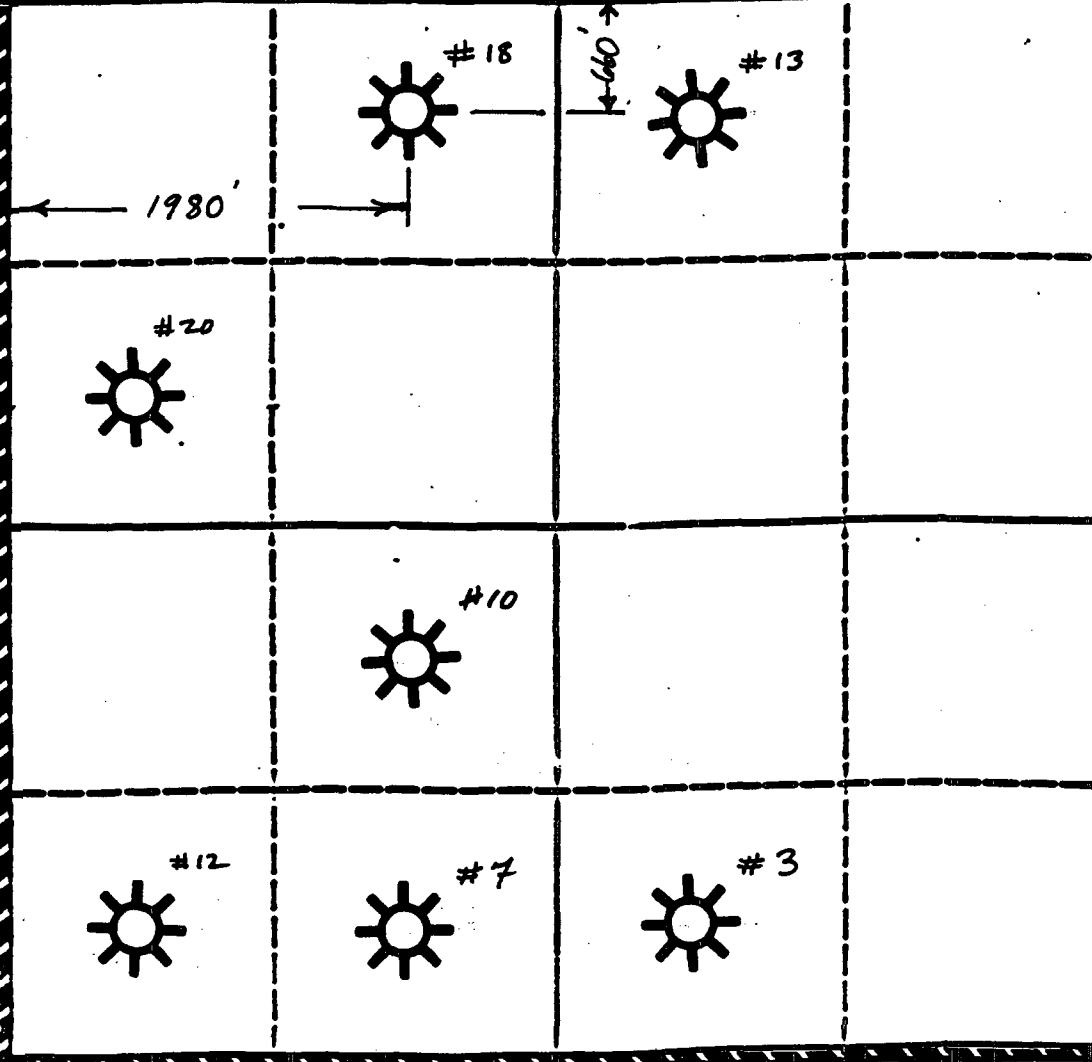

OPERATOR CERTIFICATION

I hereby certify that the information contained herein is true and complete to the best of my knowledge and belief.

Signature Richard E. Black
Printed Name **RICHARD E. BLACK**
Position **PETROLEUM ENGINEER**
Company **CHEVRON U.S.A. Inc.**
Date **7/6/93**

SURVEYOR CERTIFICATION

I hereby certify that the well location on this plat was plotted from field or aerial surveys made by me or under my supervision, and that the same is true and correct to the best of my knowledge and belief.

Date Surveyor _____
Signature of Seal of Professional Surveyor _____
Comments, if any _____

