

**SUPRON ENERGY CORPORATION**

POST OFFICE BOX 808  
FARMINGTON, NEW MEXICO 87401

October 26, 1979

*NSK - 1106  
Two pools see  
attached form  
Rule 3 R 1670  
11-28-79*

Oil Conservation Division  
P.O. Box 2088  
Santa Fe, New Mexico 87501

Re: Supron Energy Corporation  
Payne No. 4-A  
1100'/S & 135'/E  
Sec. 22, T-32N, R-10W

Gentlemen:

Supron Energy Corporation proposes to dually complete the above referenced well in an unorthodox location because of the topography.

Enclosed are copies of the Application for Permit to Drill and plat showing the topography of the area. This shows the reason for the need to locate this well as shown.

The offset operator's have been notified by registered mail on 10-26-79.

SUPRON ENERGY CORPORATION

*Rudy D. Motto*  
Rudy D. Motto  
Area Superintendent

RDM:bjs  
Enclosures

cc: Oil Conservation Division - Aztec  
El Paso Natural Gas

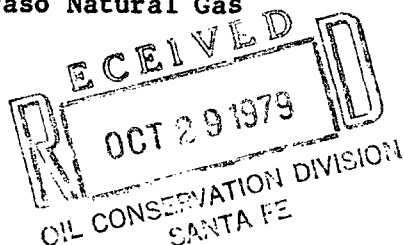

UNITED STATES  
DEPARTMENT OF THE INTERIOR  
GEOLOGICAL SURVEY

## APPLICATION FOR PERMIT TO DRILL, DEEPEN, OR PLUG BACK

## 1a. TYPE OF WORK

DRILL ☒DEEPEN ☐PLUG BACK ☐

## b. TYPE OF WELL

OIL  
WELL ☐GAS  
WELL ☒

OTHER

SINGLE  
ZONE ☐MULTIPLE  
ZONE ☒

## 2. NAME OF OPERATOR

Supron Energy Corporation

## 3. ADDRESS OF OPERATOR

P.O. Box 808, Farmington, New Mexico 87401

## 4. LOCATION OF WELL (Report location clearly and in accordance with any State requirements.)\*

At surface

1100 Ft./South; 135 ft./East line

At proposed prod. zone

Same as above

## 14. DISTANCE IN MILES AND DIRECTION FROM NEAREST TOWN OR POST OFFICE\*

2 Miles North of Cedar Hill, New Mexico

## 15. DISTANCE FROM PROPOSED\*

LOCATION TO NEAREST  
PROPERTY OR LEASE LINE, FT.  
(Also to nearest drlg. unit line, if any)

135

## 18. DISTANCE FROM PROPOSED LOCATION\*

TO NEAREST WELL, DRILLING, COMPLETED,  
OR APPLIED FOR, ON THIS LEASE, FT.

2190

## 16. NO. OF ACRES IN LEASE

1680

## 19. PROPOSED DEPTH

8670

17. NO. OF ACRES ASSIGNED  
TO THIS WELL

302.97

## 20. ROTARY OR CABLE TOOLS

Rotary

## 21. ELEVATIONS (Show whether DF, RT, GR, etc.)

6890 GR

## 22. APPROX. DATE WORK WILL START\*

2/15/80

## 23.

## PROPOSED CASING AND CEMENTING PROGRAM

SIZE OF HOLE	SIZE OF CASING	WEIGHT PER FOOT	SETTING DEPTH	QUANTITY OF CEMENT
13-3/4"	10-3/4"	32.75#	250	200 Sx.
9-7/8"	7-5/8"	26.40#	4000	200 Sx.
6-3/4"	5-1/2"	15.50#	8670	600 Sx.

We propose to drill this well through the Pictured Cliffs to an intermediate depth of approximately 4000 ft. with mud and run 7-5/8" casing to bottom. We will then drill through the Dakota to approximately 8670 ft. using air or natural gas and run a 5-1/2" liner from about 3850 to about 8670 ft. The Dakota zone will be perforated and frac'd and a bridge plug set below the Mesaverde. The Mesaverde will be perforated and frac'd. The bridge plug will be removed and a packer set between the Mesaverde and Dakota zones. Tubing will be run to both zones.

This lease is in the process of being communitized.

The well will be drilled on acreage dedicated to a gas transporter.

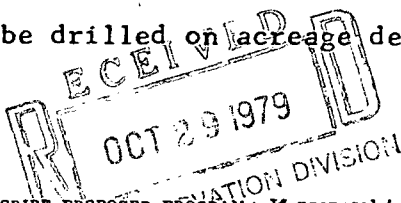

IN ABOVE SPACE DESCRIBE PROPOSED PROGRAM: If proposal is to deepen or plug back, give data on present productive zone and proposed new productive zone. If proposal is to drill or deepen directionally, give pertinent data on subsurface locations and measured and true vertical depths. Give blowout preventer program, if any.

24.

SIGNED

Kenneth E. Roddy

TITLE Production Superintendent

DATE October 18, 1979

(This space for Federal or State office use)

PERMIT NO.

APPROVAL DATE

APPROVED BY

TITLE

DATE

CONDITIONS OF APPROVAL, IF ANY:



# OFFSET OPERATOR'S PLAT

SUPRON ENERGY CORPORATION

WELL: PAYNE NO. 4-A

LOCATION: 1100 Feet from the South line and 135 feet from the East line of Section 22, Township 32 North, Range 10 West, N.M.P.M., San Juan County, New Mexico.

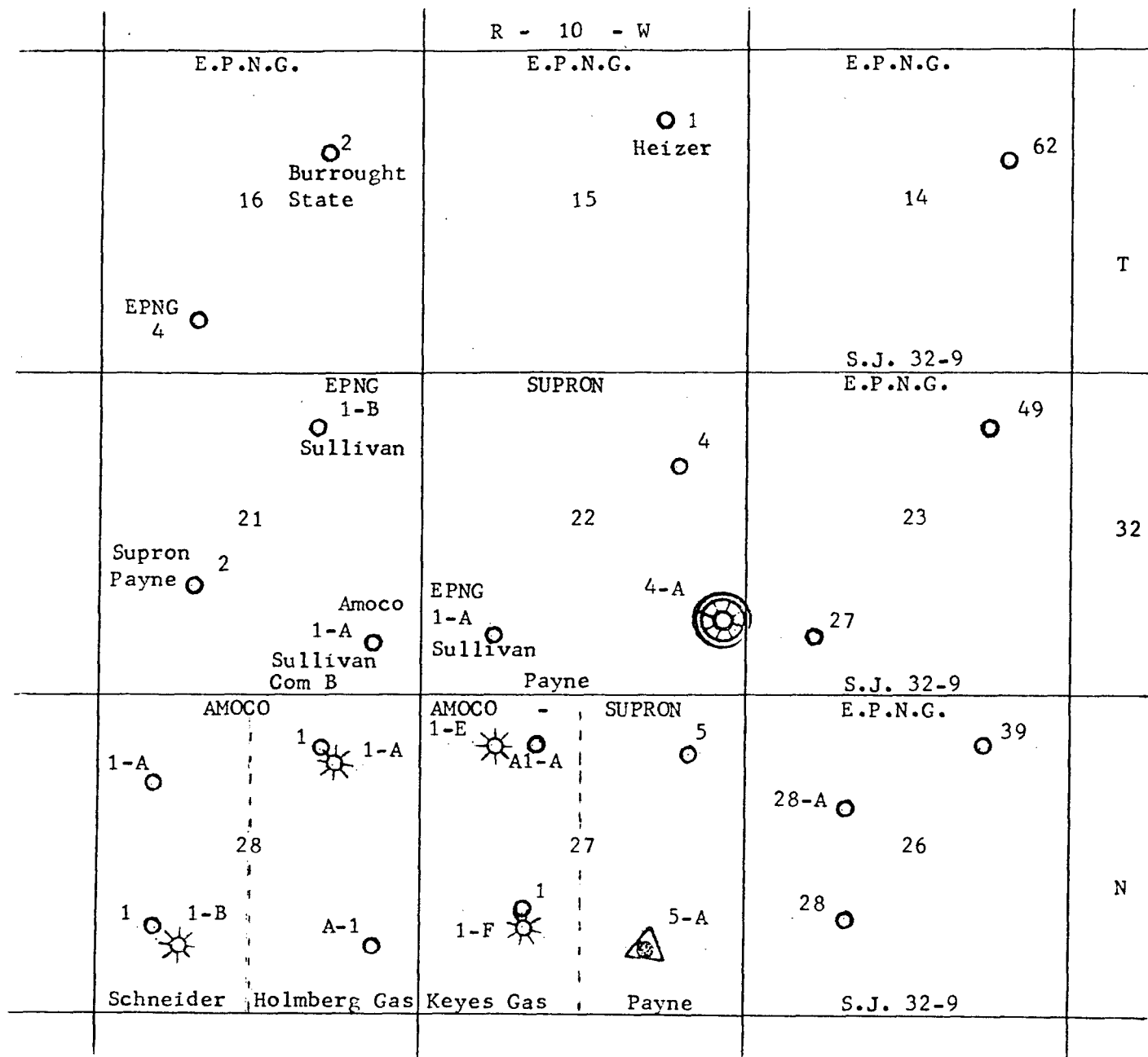

Proposed Blanco Mesaverde and Basin Dakota Dual



Mesaverde



Fruitland



Pictured Cliffs - Mesaverde



STATE OF NEW MEXICO  
ENERGY AND MINERALS DEPARTMENT  
OIL CONSERVATION DIVISION

October 30, 1979

POST OFFICE BOX 2088  
STATE LAND OFFICE BUILDING  
SANTA FE, NEW MEXICO 87501  
(505) 827-2434

Supron Energy Corp.  
P. O. Box 808  
Farmington, New Mexico 87401

Re: Application for Non-Standard  
Location: Payne No. 4-A  
1100' FSL and 135' FEL of Sec. 22,  
T-32-N, R-10-W, San Juan County

We may not process the subject application for non-standard location until the required information or plats checked below (is)(are) submitted.

- ☒ A plat must be submitted clearly showing the ownership of the offsetting leases.
- ☐ A statement must be submitted that offset owners have been notified of the application by certified mail.
- ☐ A plat must be submitted fully identifying the topography necessitating the non-standard location.
- ☐ Other:

Very truly yours

R. L. STAMETS  
Technical Support Chief

RLS/dr



BRUCE KING  
GOVERNOR

LARRY KEHOE  
SECRETARY

STATE OF NEW MEXICO  
ENERGY AND MINERALS DEPARTMENT  
OIL CONSERVATION DIVISION

POST OFFICE BOX 2088  
STATE LAND OFFICE BUILDING  
SANTA FE, NEW MEXICO 87501  
(505) 827-2434

*Supron Energy Corp*

Re: Application for Non-Standard

Location: Payne No 4-A

1100 FSL 135 FEL Sec 22-T32 N-R10 W

San Juan County, New Mexico

We may not process the subject application for non-standard location until the required information or plats checked below (is)(are) submitted.

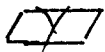

A plat must be submitted clearly showing the ownership of the offsetting leases.

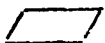

A statement must be submitted that offset owners have been notified of the application by certified mail.

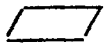

A plat must be submitted fully identifying the topography necessitating the non-standard location.



Other:

Very truly yours

R. L. STAMETS  
Technical Support Chief

RLS/dr



BRUCE KING  
GOVERNOR  
LARRY KEHOE  
SECRETARY

STATE OF NEW MEXICO  
ENERGY AND MINERALS DEPARTMENT  
OIL CONSERVATION DIVISION

October 30, 1979

Supron Energy Corp.  
P. O. Box 808  
Farmington, New Mexico 87401

*Called  
Frank  
He will  
11-17-79  
Call Rudy  
Mr. Hu  
correct  
in  
stuff*

POST OFFICE BOX 2088  
STATE LAND OFFICE BUILDING  
SANTA FE, NEW MEXICO 87501  
(505) 827-2434

Re: Application for Non-Standard  
Location: Payne No. 4-A  
1100' FSL and 135' FEL of Sec. 22,  
T-32-N, R-10-W, San Juan County

We may not process the subject application for non-standard location until the required information or plats checked below (is)(are) submitted.

- ☒ A plat must be submitted clearly showing the ownership of the offsetting leases.
- ☐ A statement must be submitted that offset owners have been notified of the application by certified mail.
- ☐ A plat must be submitted fully identifying the topography necessitating the non-standard location.
- ☐ Other:

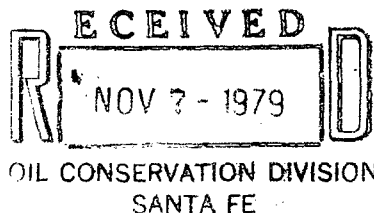

Very truly yours

*R. L. Stamets*  
R. L. STAMETS  
Technical Support Chief

RLS/dr

RECEIVED OCT 31 1979

**NEW MEXICO OIL CONSERVATION COMMISSION  
WELL LOCATION AND ACREAGE DEDICATION PLAT**

Form C-102  
Supersedes C-128  
Effective 1-1-65

All distances must be from the outer boundaries of the Section.

Operator <b>SUPRON ENERGY CORPORATION</b>			Lease <b>PAYNE</b>		Well No. <b>4-A</b>
Unit Letter <b>P</b>	Section <b>22</b>	Township <b>32 NORTH</b>	Range <b>10 WEST</b>	County <b>SAN JUAN</b>	
Actual Footage Location of Well: <b>1100</b> feet from the <b>SOUTH</b> line and <b>135</b> feet from the <b>EAST</b> line					
Ground Level Elev. <b>6890</b>	Producing Formation <b>ME SAVERDE DAKOTA</b>	Pool <b>BLANCO BASIN</b>	Dedicated Acreage: <b>E 1/2 302.97 Acres</b>		

1. Outline the acreage dedicated to the subject well by colored pencil or hachure marks on the plat below.
2. If more than one lease is dedicated to the well, outline each and identify the ownership thereof (both as to working interest and royalty).
3. If more than one lease of different ownership is dedicated to the well, have the interests of all owners been consolidated by communitization, unitization, force-pooling, etc?

☐ Yes ☒ No If answer is "yes," type of consolidation **Dakota**

If answer is "no," list the owners and tract descriptions which have actually been consolidated. (Use reverse side of this form if necessary.) \_\_\_\_\_

No allowable will be assigned to the well until all interests have been consolidated (by communitization, unitization, forced-pooling, or otherwise) or until a non-standard unit, eliminating such interests, has been approved by the Commission.

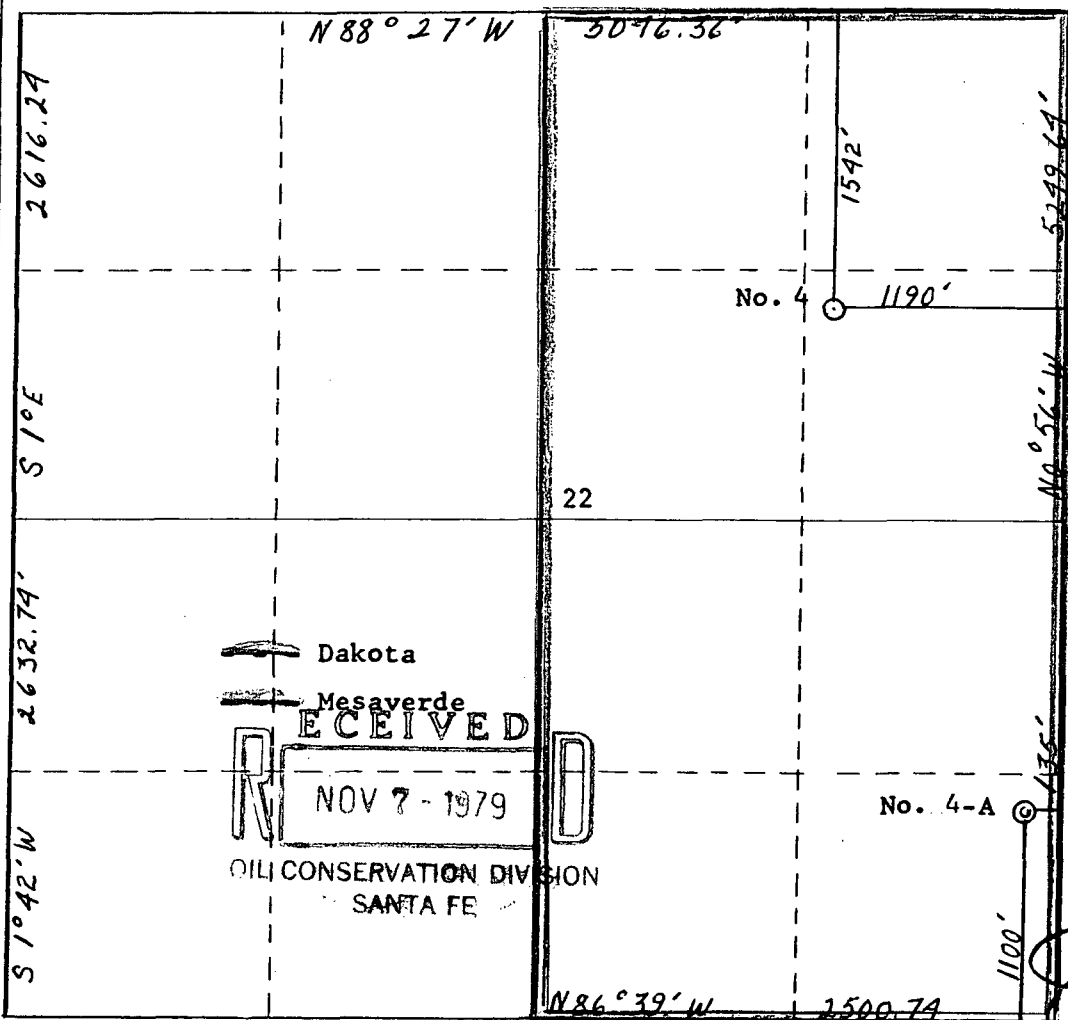

**CERTIFICATION**

I hereby certify that the information contained herein is true and complete to the best of my knowledge and belief.

*Rudy D. Motto*  
Name

**Rudy D. Motto**

Position

**Area Superintendent**

Company

**SUPRON ENERGY CORPORATION**

Date

**October 30, 1979**

I hereby certify that the well location shown on this plat was plotted from field notes and actual surveys made by me or under my supervision, and that the same is true and correct to the best of my knowledge and belief.

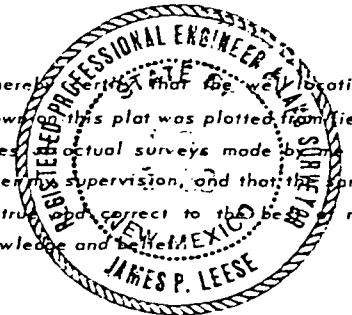

Date Surveyed

**6 April 1979**

Registered Professional Engineer and/or Land Surveyor

*James P. Leese*

Certificate No.

**1463**

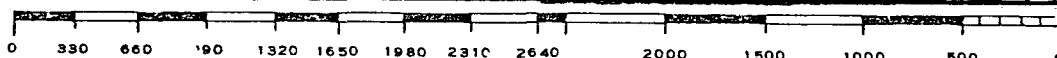



OIL CONSERVATION COMMISSION  
Antelope DISTRICT

OIL CONSERVATION COMMISSION  
BOX 2088  
SANTA FE, NEW MEXICO

DATE 10-31-79

RE: Proposed MC \_\_\_\_\_  
Proposed DHC \_\_\_\_\_  
Proposed NSL ✓ \_\_\_\_\_  
Proposed SWD \_\_\_\_\_  
Proposed WFX \_\_\_\_\_  
Proposed PMX \_\_\_\_\_

Gentlemen:

I have examined the application dated 10/26/79  
for the Scorpion Energy Corp. Payne #4A, P-22-32N-10W  
Operator Lease and Well No. Unit, S-T-R

and my recommendations are as follows:

Approve  
\_\_\_\_\_  
\_\_\_\_\_  
\_\_\_\_\_  
\_\_\_\_\_  
\_\_\_\_\_

Yours very truly,

RECEIVED  
NOV 3 - 1979  
OIL CONSERVATION DIVISION  
SANTA FE

AR Lendrick