

District I
1625 N. French Dr., Hobbs, NM 88240
District II
1301 W. Grand Avenue, Artesia, NM 88210
District III
1000 Rio Brazos Road, Aztec, NM 87410
District IV
1220 S. St. Francis Dr., Santa Fe, NM 87505

State of New Mexico
Energy Minerals and Natural Resources

Oil Conservation Division
1220 South St. Francis Dr.
Santa Fe, NM 87505

Form C-141
Revised October 10, 2003

Submit 2 Copies to appropriate
District Office in accordance
with Rule 116 on back
side of form

Release Notification and Corrective Action

~~FOR IMMEDIATE RELEASE - NOT REPORTABLE QUANTITY~~

OPERATOR

☐ Initial Report ☐ Final Report

Name of Company: DCP Midstream	Contact: Lynn Ward/Ronnie Gilchrest
Address: 10 Desta Drive, Suite 400W, Midland, TX 79705	Telephone No.: 432/620-4207
Facility Name: C-23-10 Ext	Facility Type: Low Pressure Natural Gas Gathering Line

Surface Owner: Bureau of Land Management	Mineral Owner	Lease No.
--	---------------	-----------

LOCATION OF RELEASE

Unit Letter B	Section 33	Township 19S	Range 34E	Feet from the North Line 55.5	Feet from the East Line 1969	County Lea County
------------------	---------------	-----------------	--------------	-------------------------------------	------------------------------------	----------------------

Latitude 32.62369 N Longitude -103.56269 W

NATURE OF RELEASE

Type of Release: Condensate/Slop Oil	Volume of Release: Liquids: 4 bbls	Volume Recovered: Liquids: 0 bbls
Source of Release: 8" Steel Pipeline - low pressure	Date and Hour of Occurrence: unknown	Date and Hour of Discovery: 4/23/07 @ 10:00 AM
Was Immediate Notice Given? <input type="checkbox"/> Yes <input type="checkbox"/> No <input checked="" type="checkbox"/> Not Required	If YES, To Whom? Not Applicable	
By Whom? Not Applicable	Date and Hour: Not Applicable	
Was a Watercourse Reached? <input type="checkbox"/> Yes <input checked="" type="checkbox"/> No	If YES, Volume Impacting the Watercourse. NA	

If a Watercourse was Impacted, Describe Fully.*NA
Describe Cause of Problem and Remedial Action Taken.*
On the morning of 4/23/07, DCP personnel were notified by the Bureau of Land Management of a release discovered in UL B, Section 33, T19S, R34E. Field personnel immediately responded to the notification by investigating the site. Upon arrival, DCP personnel observed a 10' x 20' area of oil saturated soils and estimated the release as between 3 - 4 bbls. Field personnel initiated an Emergency One Call in order to allow excavation of the line. The line was excavated and clamped. The cause of the release was internal and external corrosion of the gas transmission line. DCP has contacted a 3rd party contract company to investigate and remediate the location to the RRALs pursuant to the Oil Conservation Division Guidelines. No standing liquids were found on discovery.

Describe Area Affected and Cleanup Action Taken.*
The impacted area is described as a 10' x 20' area of oil saturated soils. Highlander Environmental Corp. out of Midland, TX has been retained by DCP Midstream to delineate and remediate the release site and prepare all site activity documentation.

I hereby certify that the information given above is true and complete to the best of my knowledge and understand that pursuant to NMOCD rules and regulations all operators are required to report and/or file certain release notifications and perform corrective actions for releases which may endanger public health or the environment. The acceptance of a C-141 report by the NMOCD marked as "Final Report" does not relieve the operator of liability should their operations have failed to adequately investigate and remediate contamination that pose a threat to ground water, surface water, human health or the environment. In addition, NMOCD acceptance of a C-141 report does not relieve the operator of responsibility for compliance with any other federal, state, or local laws and/or regulations.

Signature: <i>Lynn Ward</i>		OIL CONSERVATION DIVISION	
Printed Name: <i>Lynn Ward</i>		Approved by District Supervisor:	
Title: <i>Env. Specialist</i>	Approval Date:	Expiration Date:	
E-mail Address: <i>lward@dcpmidstream.com</i>	Conditions of Approval:		Attached <input type="checkbox"/>
Date: <i>5/3/07</i>	Phone: <i>432/620-4207</i>		

* Attach Additional Sheets If Necessary

Facility - PAC 0713137411
Incident - NPAC 0713137531
Application - PAC 0731313628

RP# 1321

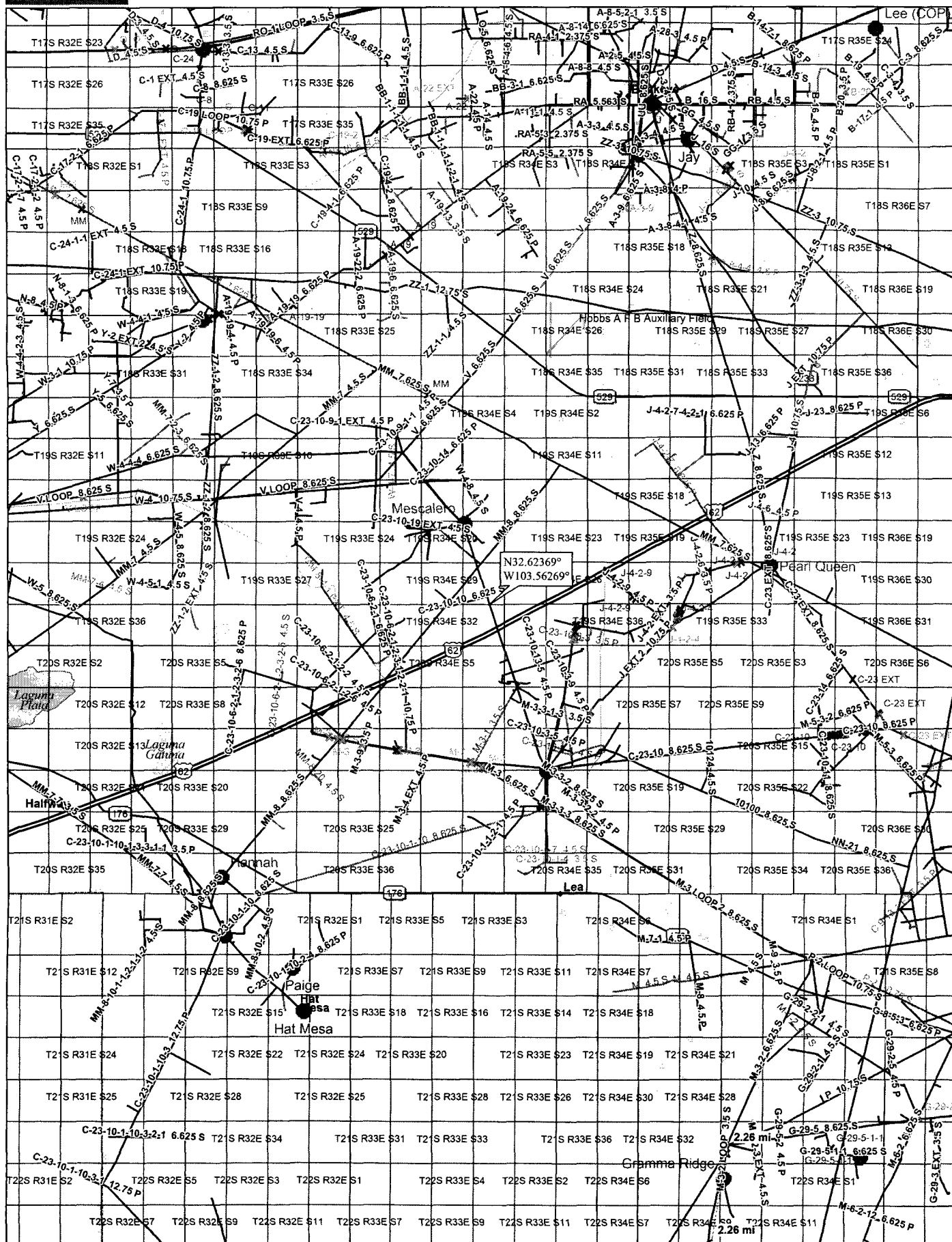

Data use subject to license.

© 2004 DeLorme. XMap® 4.5.

www.delorme.com

TN

MN (8.1°E)

Scale 1 : 200,000

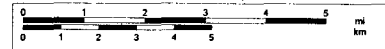

1" = 3.16 mi Data Zoom 10.0

