

CITIES SERVICE COMPANY
ENERGY RESOURCES GROUP

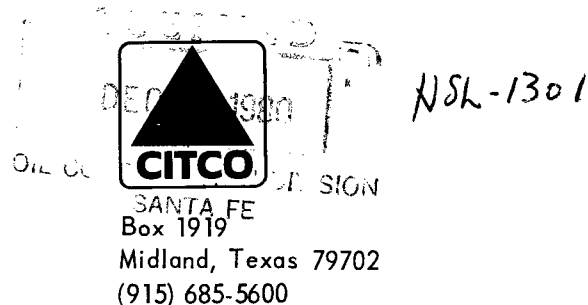

November 24, 1980

NSL-1301
Rule 104 F
1-4-80

Energy & Minerals Department
Oil Conservation Division
Box 2088
Santa Fe, New Mexico 87501

Attn: Mr. Joe D. Ramey

Re: Request of Administrative
Approval for the drilling
of Cities' Government "AK"
Well No. 1, Eddy County,
New Mexico.

Gentlemen:

Cities Service Company respectfully request administrative approval for a non-standard location for their Government AK Well No. 1, located 2130' FSL, and 1980' FEL of Section 7-T19S-R21E, Eddy County, New Mexico.

It was originally planned to drill and complete this proposed well in the Morrow formation with a 320, the E/2 of Section 7, acreage dedication. After testing the Morrow formation with negative results this well was plugged back and completed in the Abo formation and only the SE/4, instead of the E/2, of Section 7 will be dedicated to this completed well.

With the dedication of only the SE/4 of the section it causes this location to fall 510' from the north lease line of the dedicated acreage which is less than the 660' as required by the Oil Conservation Division.

Thank you for your consideration of our request.

Very truly yours,

A handwritten signature in dark ink, appearing to read "E. Y. Wilder". The signature is fluid and cursive, with a large initial "E" and a stylized "W".

E. Y. Wilder
Region Operations Manager
Southwest Region
E & P Division

EYW:JME:sl

cc: Oil Conservation Division
P. O. Drawer DD
Artesia, NM 88210

NEW MEXICO OIL CONSERVATION COMMISSION
WELL LOCATION AND ACREAGE DEDICATION PLAT

REC 011980

Form C-102
Supersedes C-128
Effective 1-1-65

All distances must be from the outer boundaries of the Section SANTA FE

Operator Cities Service Co.			Lease Government AK			Well No. 1		
Unit Letter J	Section 7	Township 19 South		Range 21 East	County Eddy			
Actual Footage Location of Well: 2130 feet from the South line and 1980 feet from the East line								
Ground Level Elev. 4407.9	Producing Formation Abo		Pool Wildcat - Abo			Dedicated Acreage: 160 Acres		

1. Outline the acreage dedicated to the subject well by colored pencil or hachure marks on the plat below.
2. If more than one lease is dedicated to the well, outline each and identify the ownership thereof (both as to working interest and royalty).
3. If more than one lease of different ownership is dedicated to the well, have the interests of all owners been consolidated by communitization, unitization, force-pooling, etc?

☐ Yes ☐ No If answer is "yes," type of consolidation _____

If answer is "no," list the owners and tract descriptions which have actually been consolidated. (Use reverse side of this form if necessary.) _____

No allowable will be assigned to the well until all interests have been consolidated (by communitization, unitization, forced-pooling, or otherwise) or until a non-standard unit, eliminating such interests, has been approved by the Commission.

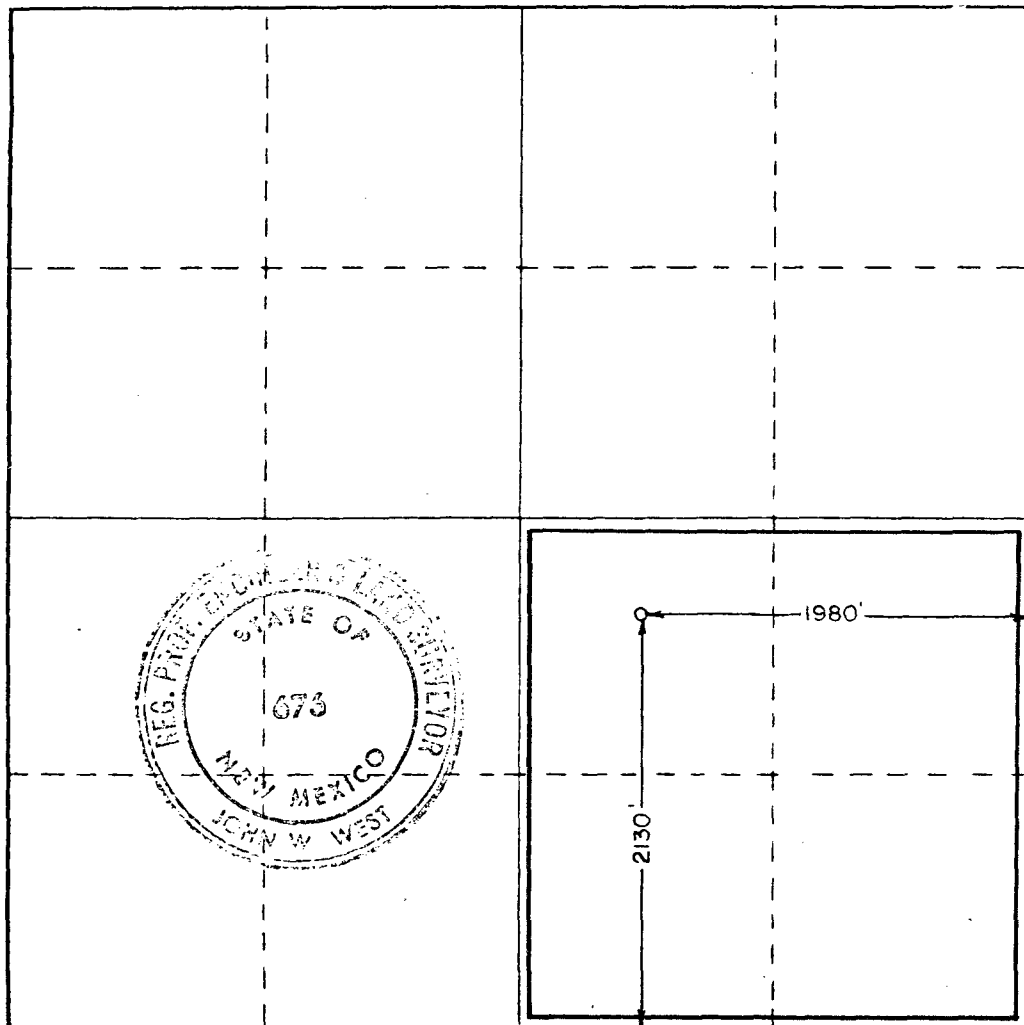

CERTIFICATION

I hereby certify that the information contained herein is true and complete to the best of my knowledge and belief.

Name *E. Spiller*
Position Region Oper. Mgr.
Company Cities Service Company
Date November 24, 1980

I hereby certify that the well location shown on this plat was plotted from field notes of actual surveys made by me or under my supervision, and that the same is true and correct to the best of my knowledge and belief.

Date Surveyed February 28, 1980
Registered Professional Engineer and/or Land Surveyor

John W. West
Certificate No. JOHN W. WEST 676
PATRICK A. ROMERO 6683

0 330 660 990 1320 1650 1980 2310 2640 2000 1800 1000 800

CITIES SERVICE COMPANY
ENERGY RESOURCES GROUP

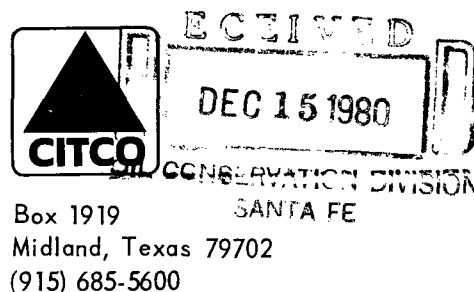

December 9, 1980

Energy & Minerals Dept.
Oil Conservation Div.
Box 2088
Santa Fe, NM 87501

Attn: R. L. Stamets

Re: Application for non-standard
location, Cities' Government
"AK" Well No. 1, Eddy County,
New Mexico.

Gentlemen:

In regard to your letter of December 3, 1980,
please find attached a plat showing the ownership of
the offsetting leases and a copy of the notification,
by Certified mail, to Phoenix Resources of Cities'
Application for Administrative Approval of a non-
standard location for the above captioned well.

Very truly yours,

CITIES SERVICE COMPANY

E. Y. Wilder
Region Operations Manager
Southwest Region
E & P Division

EYW:JME:sl

Attachments

21 E

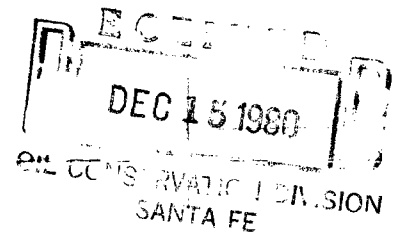

CITIES SERVICE CO.

1
S
S

CITIES
SERVICE
COMPANY

7

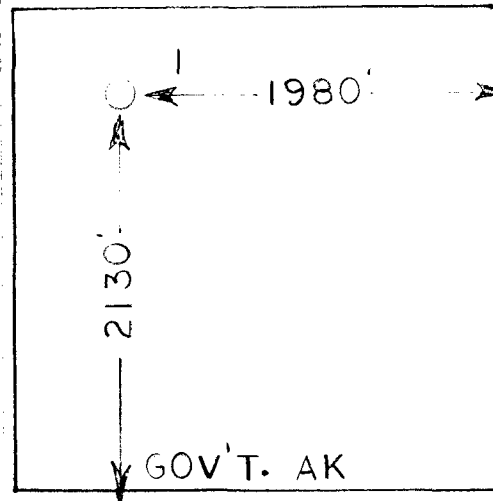

CITIES
SERVICE
COMPANY

PHOENIX RESOURCES COMPANY

18 17

PHOENIX
RESOURCES
COMPANY

I HEREBY CERTIFY THAT I AM FAMILIAR WITH THE CONDITIONS AS THEY ACTUALLY EXIST ON THIS LEASE, THAT THE ABOVE PLAT WHICH IS DRAWN HEREON IS TO THE BEST OF MY KNOWLEDGE TRUE AND CORRECT AND THAT IT ACCURATELY REFLECTS THE OWNERSHIP OF THE OFFSETTING LEASES.

E. W. Wilder
REGION OPERATIONS MANAGER

12/8/80
DATED

CITIES SERVICE COMPANY
ENERGY RESOURCES GROUP

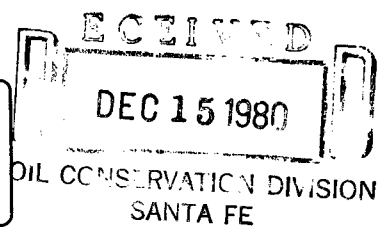

Box 1919
Midland, Texas 79702
(915) 685-5600

December 8, 1980

Phoenix Resources Co.
3524 NW 56th St., Suite 300
Oklahoma City, OK 73112

Re: Request for administrative
approval of a non-standard
location for Cities' Government
AK, Well No. 1, 2130' FSL &
1980' FEL of Sec. 7-T19S-R21E,
Eddy County, New Mexico.

Gentlemen:

Please be advised of Cities' request for administrative approval of a non-standard location for the above captioned well. Also, please find attached copies of our request letter to the Energy and Minerals Department of New Mexico and an Acreage Dedication Plat.

Very truly yours,

CITIES SERVICE COMPANY

E. Y. Wilder
Region Operations Manager
Southwest Region
E & P Division

EYW:JME:sl

Attachment



STATE OF NEW MEXICO
ENERGY AND MINERALS DEPARTMENT
OIL CONSERVATION DIVISION

December 3, 1980

BRUCE KING
GOVERNOR

LARRY KEHOE
SECRETARY

POST OFFICE BOX 2088
STATE LAND OFFICE BUILDING
SANTA FE, NEW MEXICO 87501
(505) 827-2434

Cities Service Company
P. O. Box 1919
Midland, Texas 79702

Re: Application for Non-Standard
Location: Cities Government
"AK" Well No. 1, Eddy County,
New Mexico

We may not process the subject application for non-standard location until the required information or plats checked below (is)(are) submitted.

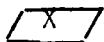

A plat must be submitted clearly showing the ownership of the offsetting leases.

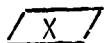

A statement must be submitted that offset owners have been notified of the application by certified mail.



A plat must be submitted fully identifying the topography necessitating the non-standard location.



Other:

Very truly yours

R. L. STAMETS
Technical Support Chief

RLS/dr