

NSL-1350

NSL-1350
Order (6) R-4493 Pool
Loco Hills
NE NE dedicated
No waiting

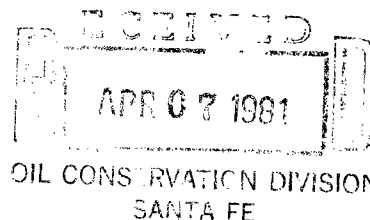

April 3, 1981



State of New Mexico
Energy and Minerals Department
Oil Conservation Division
P. O. Box 2088
Santa Fe, New Mexico 87501

Attention: Division Director

Dear Sir:

Anadarko Production Company respectfully requests administrative approval to drill the Ballard Grayburg San Andres Unit Well #5-15 at an unorthodox location 960 feet from the north line and 1130 feet from the east line of Section 8, Township 18 South, Range 29 East, Eddy County, New Mexico. This application was previously filed with a different well location of 865' from the north line and 1125' from the east line (letter dated March 18, 1981). Since then we found it necessary to restake the location at 960 feet from the north line and 1130 feet from the east line.

The Ballard Grayburg San Andres Unit waterflood was authorized March 16, 1973 by Order Number R-4493. Paragraph 6 of this order provides for administrative approval of such unorthodox locations.

The proposed well will be completed as a producer in the Grayburg zone. The location will be closer than 330 feet to an inner subdivision boundary, therefore making it unorthodox. It will, however be located further than 330 feet from the Unit boundary. A producing well is required in this area to produce waterflood oil not recoverable from existing wells.

Attached is a copy of form C-102 showing the proposed unorthodox location. Thank you for your consideration of this matter.

Yours very truly,

Cris G. Rhodes
Senior Production Engineer

CGR:tlf

Attachments

**NEW MEXICO OIL CONSERVATION COMMISSION
WELL LOCATION AND ACREAGE DEDICATION PLAT**

Form C-102
Supersedes C-128
Effective 1-1-65

All distances must be from the outer boundaries of the Section

Operator ANADARKO PRODUCTION COMPANY			Lease Ballard Grayburg SA Unit Tract 5		Well No. 15
Unit Letter 'A'	Section 8	Township 18 South	Range 29 East	County Eddy	
Actual Footage Location of Well: 960 feet from the North line and 1130 feet from the East line					
Ground Level Elev. 3516.1	Producing Formation Grayburg		Pool Loco Hills- Queen- Grayburg- San Andres		Dedicated Acreage: 40 Acres

1. Outline the acreage dedicated to the subject well by colored pencil or hatchure marks on the plat below.
2. If more than one lease is dedicated to the well, outline each and identify the ownership thereof (both as to working interest and royalty).
3. If more than one lease of different ownership is dedicated to the well, have the interests of all owners been consolidated by communitization, unitization, force-pooling, etc?

☒ Yes ☐ No If answer is "yes," type of consolidation unitization

If answer is "no," list the owners and tract descriptions which have actually been consolidated (Use reverse side of this form if necessary.) _____

No allowable will be assigned to the well until all interests have been consolidated (by communitization, unitization, forced-pooling, or otherwise) or until a non-standard unit, eliminating such interests, has been approved by the Commission.

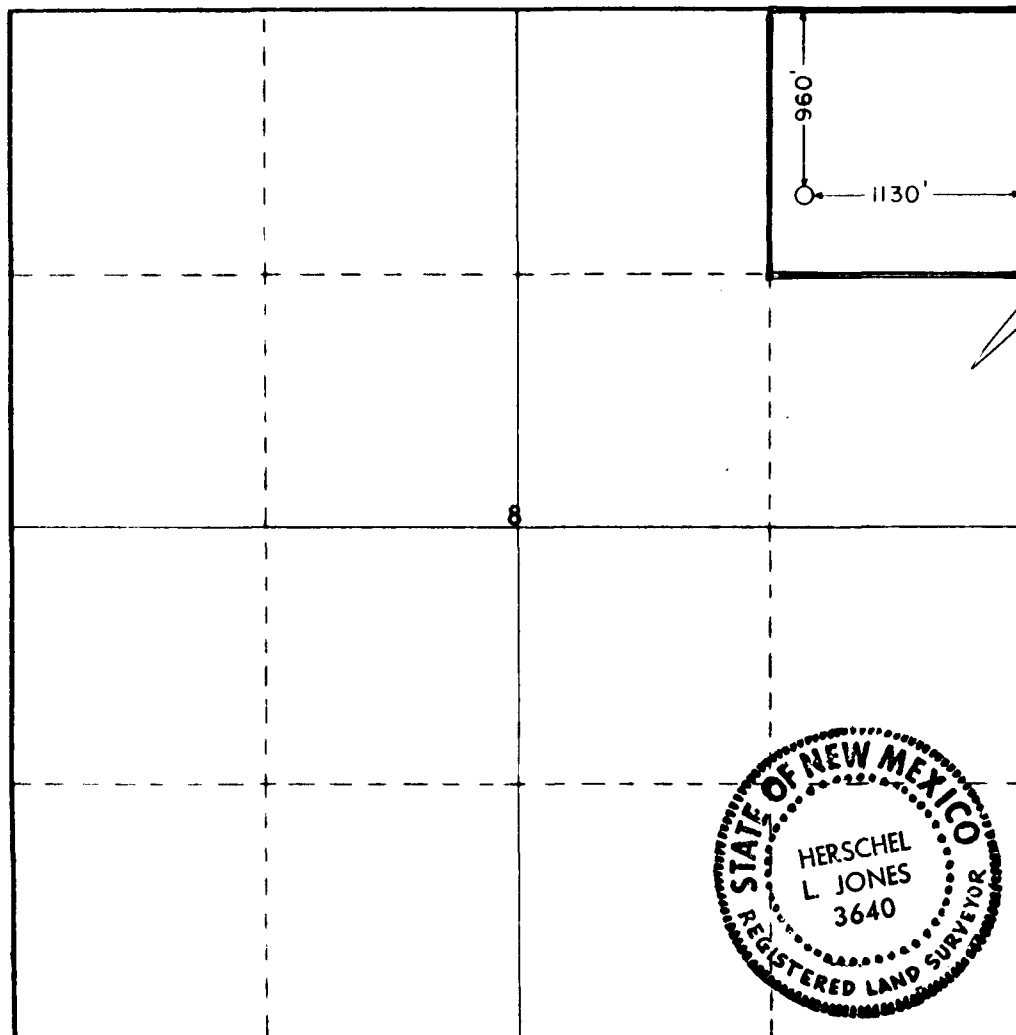

CERTIFICATION

I hereby certify that the information contained herein is true and complete to the best of my knowledge and belief

Jerry E. Buckles
Name

Jerry E. Buckles

Position

Area Supervisor

Company

Anadarko Production Co.

Date

I hereby certify that the well location shown on this plat was plotted from field notes of actual surveys made by me or under my supervision, and that the same is true and correct to the best of my knowledge and belief.

Date Surveyed

March 24, 1981

Registered Professional Engineer
and/or Land Surveyor

Herschel L. Jones
Certificate No.

3640

