



Amoco Production Company

Petroleum Center Building
501 Airport Drive
Farmington, New Mexico 87401
505-325-8841

R. W. Schroeder
District Superintendent

April 16, 1981

Mr. Joe D. Ramey
New Mexico Oil Conservation Division
P. O. Box 2088
Santa Fe, NM 87501

File: RWS-319-400.1

Dear Mr. Ramey:

Application for Unorthodox Location
Rosa Unit No. 86
Basin Dakota Field
Rio Arriba County, New Mexico

Amoco Production Company hereby requests approval of our Rosa Unit No. 86
at a location 1660' FNL and 700' FEL Section 28, T31N, R4W, Rio Arriba
County, New Mexico.

The attached Form C-102 illustrates the topographical problems encountered
in selecting a suitable well site. The selected location is only 700' from
the East line of Section 28.

A copy of this application is being sent to the offset lease holder, Trans
Delta Oil & Gas Company with the request they furnish you a waiver of
objection and return one copy of the same to me. There are no offset operators
of Dakota wells.

Yours very truly,

R. W. Schroeder

MDD/pbr
Attachments

_____ hereby waives objection to Amoco's
application for an unorthodox location as proposed above.

BY: _____

DATE: _____

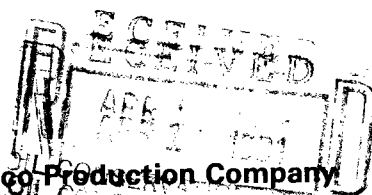

NSL - 1366
Rule 3 R1620
Basin Dakota Pool
5-24-81

Page 2
RWS-319-400.1
April 16, 1981

cc: Frank Chavez
New Mexico Oil Conservation Division
1000 Rio Brazos Road
Aztec, NM 87410

G. J. Ross - Denver

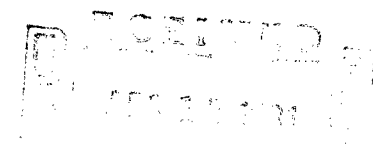

OIL & GAS DIVISION
Trans Delta Oil & Gas Company
Suite 1008 Ridgelea Bank Bldg.
6300 Ridgelea Place
Fort Worth, TX 77002

G. D. Ryan - Denver

STATE OF NEW MEXICO
ENERGY AND MINERALS DEPARTMENT

All distances must be from the outer boundaries of the Section.

Operator AMOCO PRODUCTION COMPANY			Lease ROSA UNIT			Well No. 86
Unit Letter H	Section 28	Township 31N	Range LW	County Rio Arriba		
Actual Footage Location of Well: 1660 feet from the North line and 700 feet from the East line						
Ground Level Elev. 6925	Producing Formation Dakota		Pool Basin Dakota		Dedicated Acreage: 320 Acres	

1. Outline the acreage dedicated to the subject well by colored pencil or hachure marks on the plat below.
2. If more than one lease is dedicated to the well, outline each and identify the ownership thereof (both as to working interest and royalty).
3. If more than one lease of different ownership is dedicated to the well, have the interests of all owners been consolidated by communitization, unitization, force-pooling, etc?

☒ Yes ☐ No If answer is "yes," type of consolidation Unitization

If answer is "no," list the owners and tract descriptions which have actually been consolidated. (Use reverse side of this form if necessary.)

No allowable will be assigned to the well until all interests have been consolidated (by communitization, unitization, forced-pooling, or otherwise) or until a non-standard unit, eliminating such interests, has been approved by the Commission.

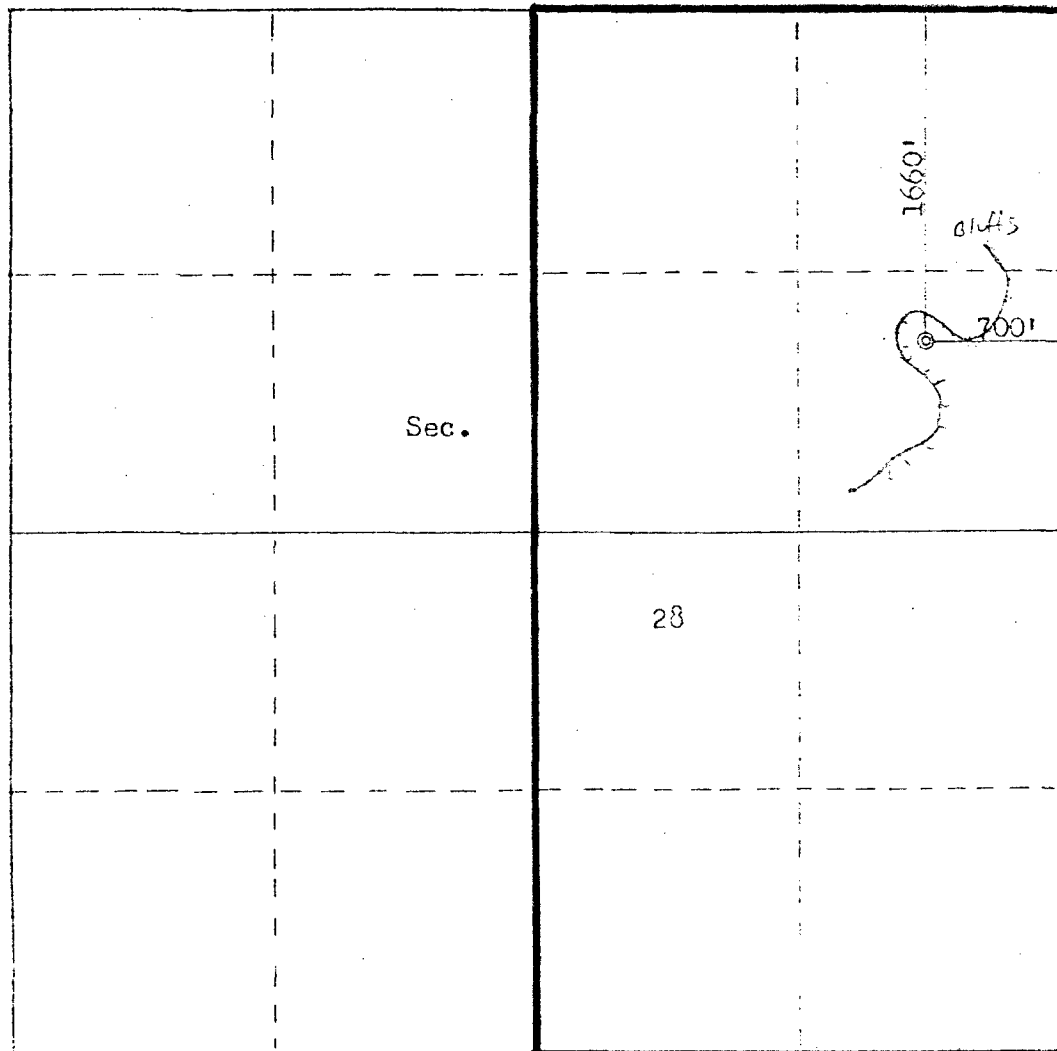

Scale: 1"=1000'

CERTIFICATION

I hereby certify that the information contained herein is true and complete to the best of my knowledge and belief.

Wayne L. Peterson

Name

W. L. PETERSON

Position

DISTRICT ENGINEER

Company

AMOCO PRODUCTION COMPANY

Date

3/31/81

I hereby certify that the well location shown on this plat was plotted from field notes of actual surveys made by me or under my supervision, and that the same is true and correct to the best of my knowledge and belief.

Date Surveyed

March 30, 1981

Registered Professional Engineer and Land Surveyor

Fred B. Kerr Jr.
Fred B. Kerr Jr.

Certificate No.

3950

R 4 W

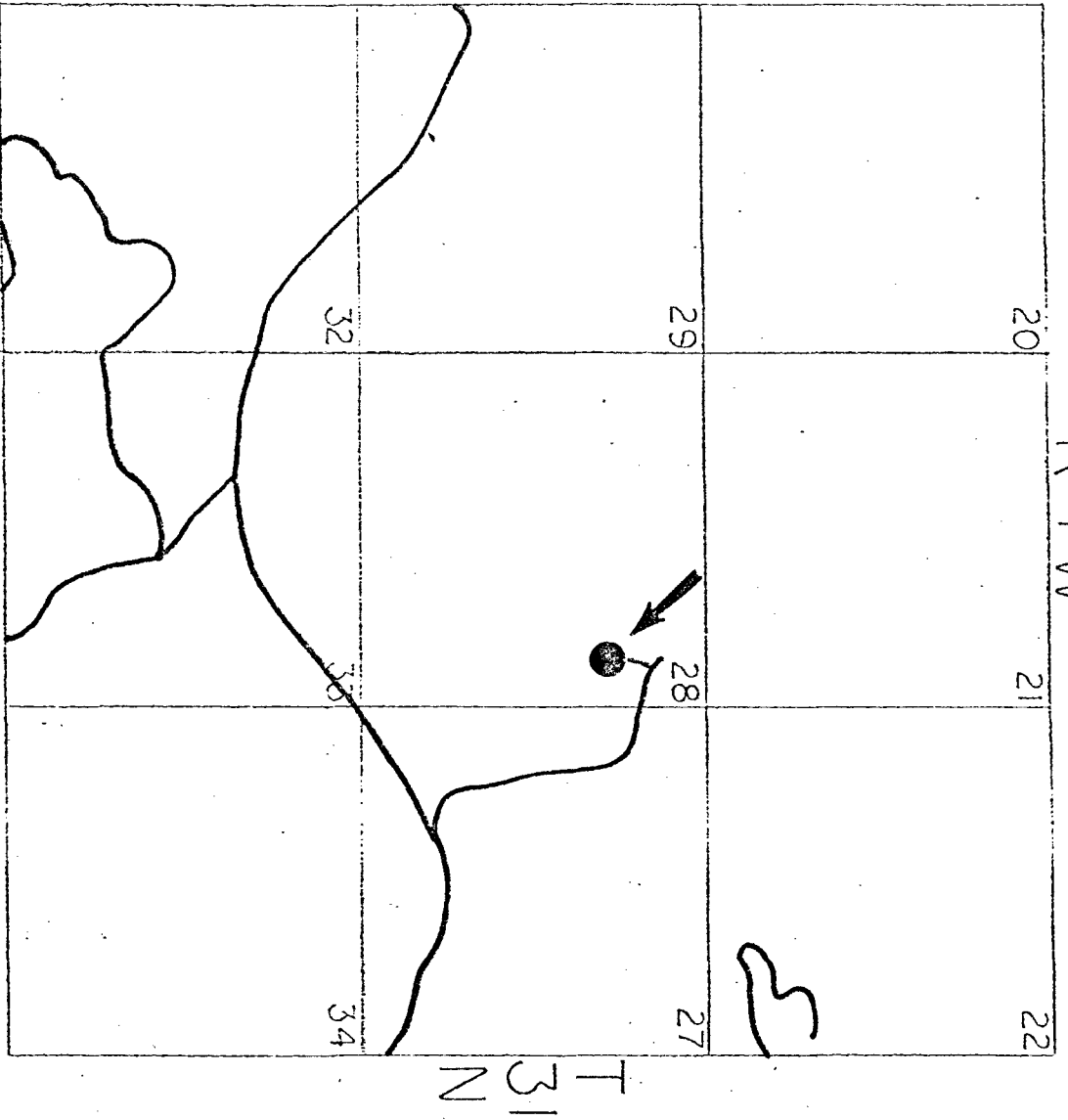

NO OFFSET BASIN DAKOTA WELLS



R. W. Schroeder
District Superintendent

March 22, 1982

Mr. Joe D. Ramey
New Mexico Oil Conservation Division
P. O. Box 2088
Santa Fe, NM 87501

File: RWS-290-986.511

Dear Mr. Ramey:

Rosa Unit No. 86
Section 28 - T31N - R4W
(1660' FNL & 700' FEL)
Administrative Order NSL-1366

Amoco Production Company hereby requests approval of the subject well, Administrative Order NSL-1366, to include the Wildcat Gallup Formation.

A copy of this application is being sent by Certified Mail to the offset leaseholder, Petro-Lewis Corporation, with the request they furnish you a waiver of objection, and return one copy of the same to me. There are no offset operators of Gallup wells.

Yours very truly,

R. W. Schroeder

DDM/eb
Attachments

PETRO LEWIS CORPORATION hereby waives objection to Amoco's request to amend Administrative Order NSL-1366 to include the Gallup Formation.

Signed William D. Fulton
Date 3/31/82

APR 07 1982

Amoco Production Company (USA)
Petroleum Center Building
501 Airport Drive
Farmington, New Mexico 87401
505-325-8841
SANTA FE

Page 2
March 22, 1982
File: RWS-290-986.511
Mr. Joe D. Ramey

cc: Mr. Frank Chavez
New Mexico Oil Conservation Division
1000 Rio Brazos Road
Aztec, NM 87410

CERTIFIED MAIL:

Petro-Lewis Corporation ✓
717 71st Street
Energy Center 1
Denver, CO 80201



Amoco Production Company

Petroleum Center Building
501 Airport Drive
Farmington, New Mexico 87401
505-325-8841

R. W. Schroeder
District Superintendent

April 30, 1981

Mr. Joe D. Ramey
New Mexico Oil Conservation Division
P. O. Box 2088
Santa Fe, NM 87501

File: RWS-349-400.1

Dear Mr. Ramey:

Application for Non-Standard Location
Rosa Unit No. 86
Basin Dakota Field
Rio Arriba County, New Mexico

Reference is made to your letter of April 23, 1981 in which you requested a plat showing all offset lease holders, and a statement that the lease holders have been notified of the application by certified mail.

A 9-Section plat is attached which illustrates that the only offset owner is Trans Delta Oil & Gas Co. which holds the rights to the base of the Dakota Formation on 20.38 acres in the SW/4 NW/4, Section 27, T31N, R4W.

A certified letter has been sent to Trans Delta Oil & Gas Co. informing them of the application for a non-standard location.

Yours very truly,

MDD/mjl

Attachments

All distances must be from the outer boundaries of the Section.

RECEIVED
MAY 04 1981
Form C-107
Revised 10-1-78

Operator AMOCO PRODUCTION COMPANY			Lease ROSA UNIT		
Unit Letter H	Section 28	Township 31N	Range 4W	County Rio Arriba	
Actual Footage Location of Well: 1660 feet from the North line and 700 feet from the East line					
Ground Level Elev. 6925	Producing Formation Dakota		Pool Basin Dakota		Dedicated Acreage: 320 Acres

1. Outline the acreage dedicated to the subject well by colored pencil or hatchure marks on the plat below.
2. If more than one lease is dedicated to the well, outline each and identify the ownership thereof (both as to working interest and royalty).
3. If more than one lease of different ownership is dedicated to the well, have the interests of all owners been consolidated by communitization, unitization, force-pooling, etc?

☒ Yes ☐ No If answer is "yes," type of consolidation Unitization

If answer is "no," list the owners and tract descriptions which have actually been consolidated. (Use reverse side of this form if necessary.)

No allowable will be assigned to the well until all interests have been consolidated (by communitization, unitization, forced-pooling, or otherwise) or until a non-standard unit, eliminating such interests, has been approved by the Commission.

Sec.		1660'	
		Bluffs	
		700'	
28			

Scale: 1"=1000'

CERTIFICATION

I hereby certify that the information contained herein is true and complete to the best of my knowledge and belief.

Wayne L. Peterson

Name

W. L. PETERSON

Position

DISTRICT ENGINEER

Company

AMOCO PRODUCTION COMPANY

Date

3/31/81

I hereby certify that the well location shown on this plat was plotted from field notes of actual surveys made by me or under my supervision, and that the same is true and correct to the best of my knowledge and belief.

Date Surveyed

March 30, 1981

Registered Professional Engineer
and Land Surveyor

Fred B. Kerr Jr.

Certificate No.

3950

ROSA UNIT #86

R 4 W

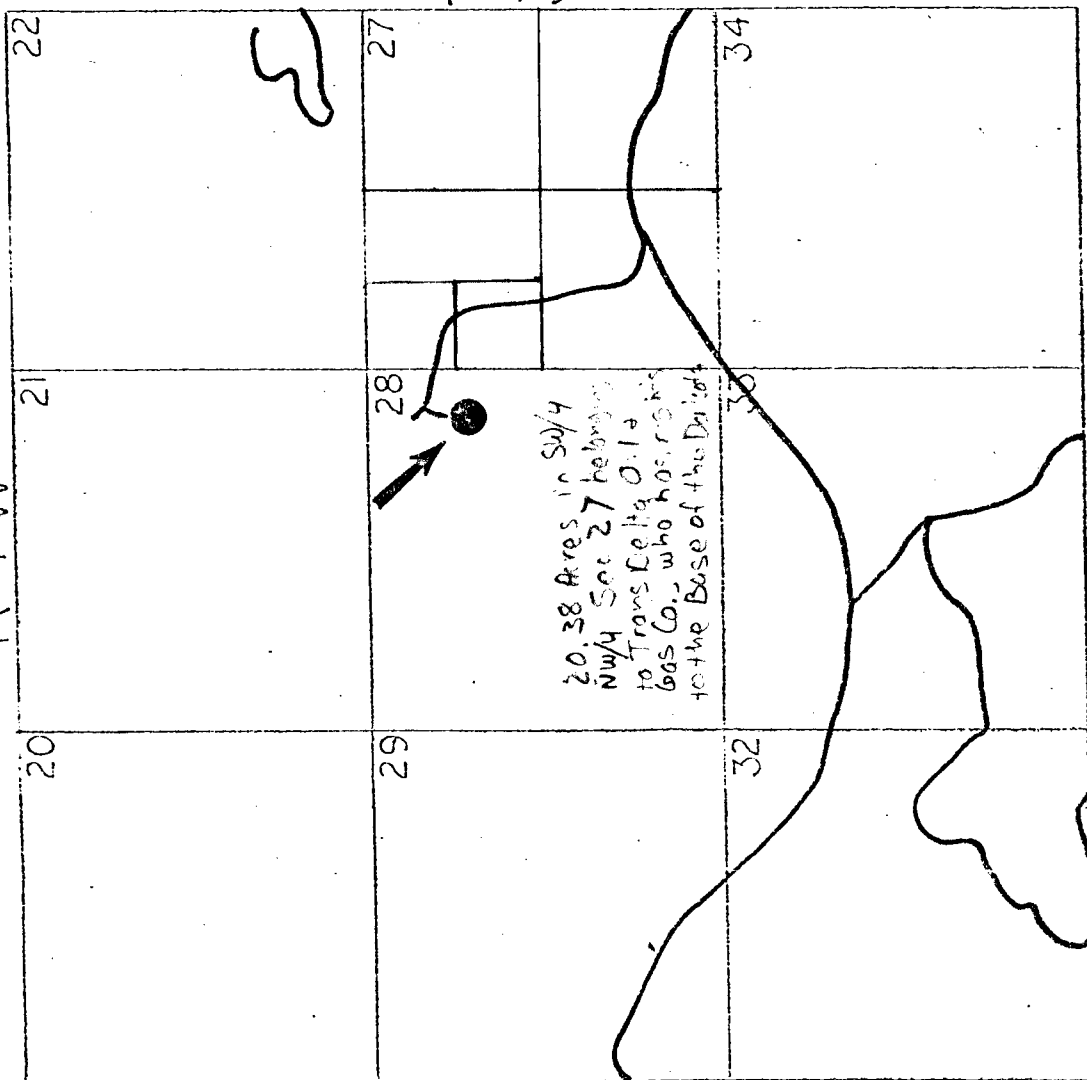

NO OFFSET BASIN DAKOTA WELLS

RECEIVED
MAY 04 1991
OIL & GAS DIVISION
DAKOTA



STATE OF NEW MEXICO
ENERGY AND MINERALS DEPARTMENT
OIL CONSERVATION DIVISION
AZTEC DISTRICT OFFICE

1000 RIO BRAZOS ROAD
AZTEC, NEW MEXICO 87410
(505) 334-6178

OIL CONSERVATION DIVISION
BOX 2088
SANTA FE, NEW MEXICO 87501

DATE 4-20-81

RE: Proposed MC _____
Proposed DHC _____
Proposed NSL 2 _____
Proposed SWD _____
Proposed WFX _____
Proposed PMX _____

RECEIVED
OIL CONSERVATION DIVISION
APR 22 1981
SANTA FE

366

Gentlemen:

I have examined the application dated 4-17-81
for the Amow Rosa Unit #86 H-28-31-4
Operator Lease and Well No. Unit, S-T-R

and my recommendations are as follows:

Approve

Yours truly,

Frank J. Chang



STATE OF NEW MEXICO
ENERGY AND MINERALS DEPARTMENT
OIL CONSERVATION DIVISION

April 23, 1981

BRUCE KING
GOVERNOR

LARRY KEHOE
SECRETARY

POST OFFICE BOX 2088
STATE LAND OFFICE BUILDING
SANTA FE, NEW MEXICO 87501
(505) 827-2434

Amoco Production Company
501 Airport Drive
Farmington, New Mexico 87401

Re: Application for Non-Standard
Location: Rosa Unit Well No. 86
Sec. 28, T-31-N, R-4-W, Rio
Arriba County

We may not process the subject application for non-standard location until the required information or plats checked below (is)(are) submitted.

- ☒ A plat must be submitted clearly showing the ownership of the offsetting leases. The plat submitted shows no offsets. Offsets include other lease holders in the same formation.
- ☒ A statement must be submitted that offset owners have been notified of the application by certified mail.
- ☐ A plat must be submitted fully identifying the topography necessitating the non-standard location.
- ☐ Other:

Very truly yours

R. L. STAMETS
Technical Support Chief

RLS/dr