

Tenneco Oil
Exploration and Production
A Tenneco Company



Rocky Mountain Division

P.O. Box 3249
Englewood, Colorado 80155
(303) 740-4800

Delivery Address:
6061 South Willow Drive
Englewood, Colorado

Certified Mail
Return Receipt Requested

September 30, 1981

*NSL-1439
Rule 5(c)(3) R1670
10-25-81*

New Mexico Oil Conservation Division
P.O. Box 2088
Santa Fe, NM 87501
Attn: Joe D. Ramey

New Mexico Oil Conservation Division
1000 Rio Brazos Road
Aztec, NM 87401
Attn: Frank Chavez

Re: Application for Unorthodox Location
Tenneco Hughes A-3E
540'FEL, 1635'FSL, Sec 28, T29N, R8W
San Juan County, New Mexico
Basin Dakota Gas Pool

Gentlemen:

Attached in duplicate (to each office) are a well location plat (C-102) with a sketch of the surrounding conditions and an ownership plat for the above referenced well.

Proximity of Cutter Dam and another existing well site make this location the only topographic and geologic site acceptable.

A copy of this application is being submitted to all offset operators by certified mail with a request that they furnish your Santa Fe office with a waiver of objection.

Pursuant to the authority of Rule 104-F we respectfully request your approval of an exemption to the standard well location requirements.

Yours very truly,

TENNECO OIL COMPANY

Don H. Morrison

Don H. Morrison
Production Analyst

DHM/lo
Enclosures

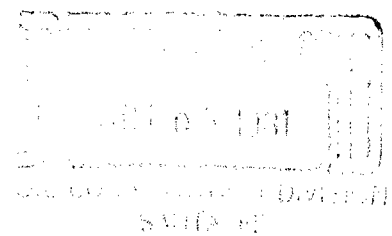

W A I V E R

_____ hereby waives objection to Tenneco Oil Company's
application for unorthodox location for their Tenneco Hughes A-3E proposed above.

BY: _____

DATE: _____

OIL CONSERVATION DIVISION

STATE OF NEW MEXICO

P. O. BOX 2088

Form C-107

Revised 10-1-78

ENERGY AND MINERALS DEPARTMENT

SANTA FE, NEW MEXICO 87501

All distances must be from the outer boundaries of the Section.

Operator TENNECO OIL COMPANY			Lease HUGHES "A"		Well No. 3E
Unit Letter I	Section 28	Township 29N	Range 8W	County San Juan	
Actual Footage Location of Well: 1635 feet from the South line and 540 feet from the East line					
Ground Level Elev: 6376	Producing Formation Dakota		Pool Basin Dakota		Dedicated Acreage: 320 Acres

1. Outline the acreage dedicated to the subject well by colored pencil or hachure marks on the plat below.
2. If more than one lease is dedicated to the well, outline each and identify the ownership thereof (both as to working interest and royalty).
3. If more than one lease of different ownership is dedicated to the well, have the interests of all owners been consolidated by communitization, unitization, force-pooling, etc?

☐ Yes ☐ No If answer is "yes," type of consolidation _____

If answer is "no," list the owners and tract descriptions which have actually been consolidated. (Use reverse side of this form if necessary.) _____

No allowable will be assigned to the well until all interests have been consolidated (by communitization, unitization, forced-pooling, or otherwise) or until a non-standard unit, eliminating such interests, has been approved by the Commission.

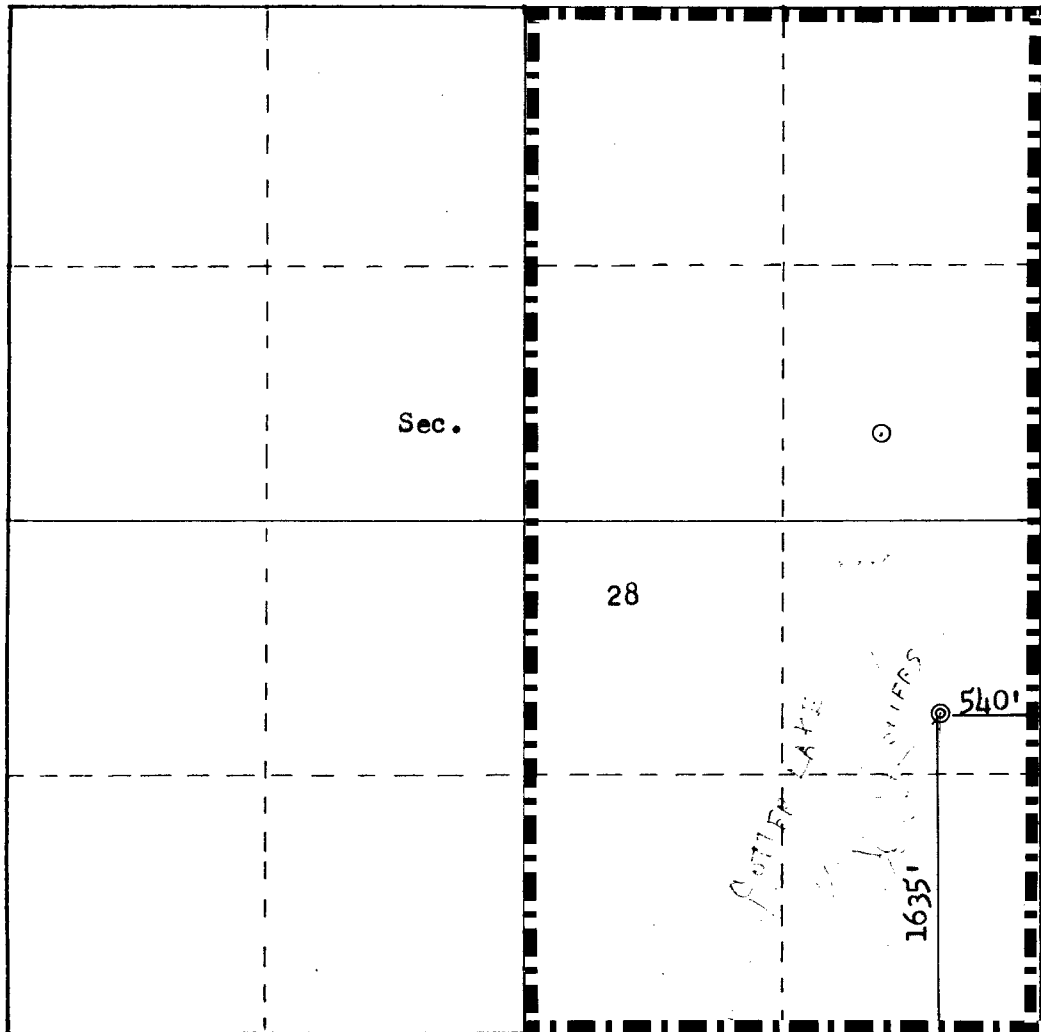

Scale: 1"=1000'

CERTIFICATION

I hereby certify that the information contained herein is true and complete to the best of my knowledge and belief.

Don H. Morrison

Name

Don H. Morrison

Position

Production Analyst

Company

Tenneco Oil Company

Date

July 22, 1981

I hereby certify that the well location shown on this plat was plotted from field notes of actual surveys made by me or under my supervision, and that the same is true and correct to the best of my knowledge and belief.

Date Surveyed

July 25, 1981

Registered Professional Engineer and Land Surveyor

Fred B. Kerr, Jr.

Certificate No. 3950

3950

Offset Operators to Unorthodox Location

El Paso Natural Gas
P.O. Box 990
Farmington, NM 87401

Attn: Carl E. Matthews

