

January 29, 1982

*NSL
Rule 104 F
2-27-82*

Joe D. Ramey, Director
New Mexico Oil Conservation Division
P. O. Box 2088
Santa Fe, New Mexico 87501

Dear Mr. Ramey,

Subject: Mesa Petroleum Co.
Crawford Federal #2
660' FSL & 2080' FEL
Sec 31, T7S, R26E
Chaves County, New Mexico

1760 Formation

Application is hereby made for an administrative approval for an unorthodox location for subject well.

This well was re-located from the original 660' x 1980' location by the Bureau of Land Management to prevent the destruction of a natural flood control levee lying along the eastern boundary of the drilling site. Exhibit I shows that the location is within the flood plain of the Pecos River and subject to special stipulations. Exhibit II is a topographic plat and Exhibit III is an acreage dedication plat and Exhibit IV is an area land map showing offset operators notified by certified mail of this request.

Expeditions handling of this request is appreciated.

Yours truly,

MESA PETROLEUM CO.

R. E. Mathis

R. E. MATHIS
REGULATORY COORDINATOR
PERMIAN BASIN DIVISION

xc: Yates Pet. Co., Union Texas, MTS, PLE

bxc: TLS, MEC, LAND, ROSWELL, REM, SJ

*Rec'd 3-2-81
DR*

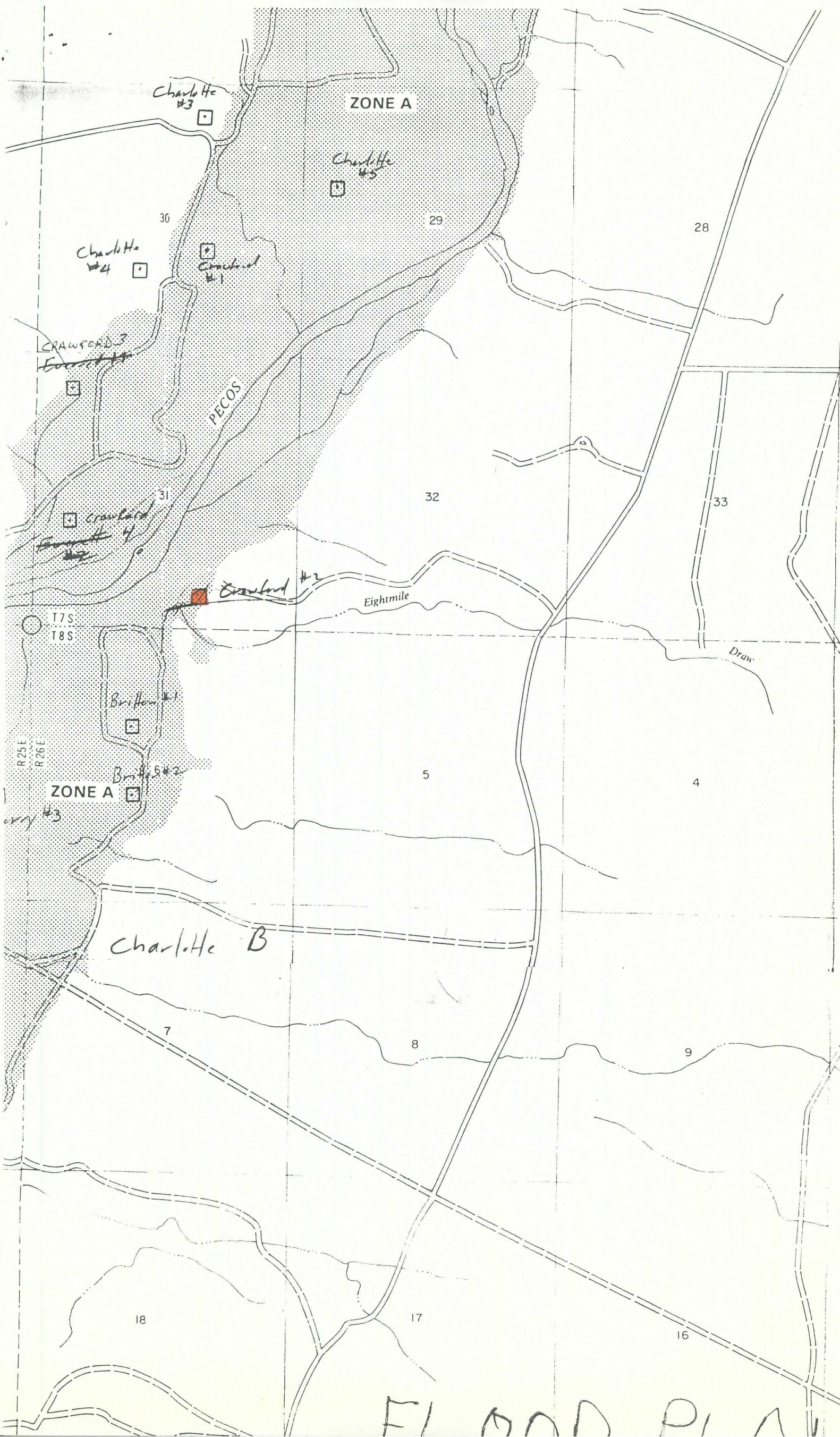

ZONE A

Charlotte #3

Charlotte #5

30

29

28

Charlotte #4

Crawford #1

CRAWFORD #3

PECOS

32

33

31

Crawford #4

Crawford #2

Eightmile

T7S
T8S

Briffon #1

R25E
R26E

5

4

ZONE A

Briffon #2

Briffon #3

Charlotte B

7

8

9

18

17

16

FLOOD PLAIN

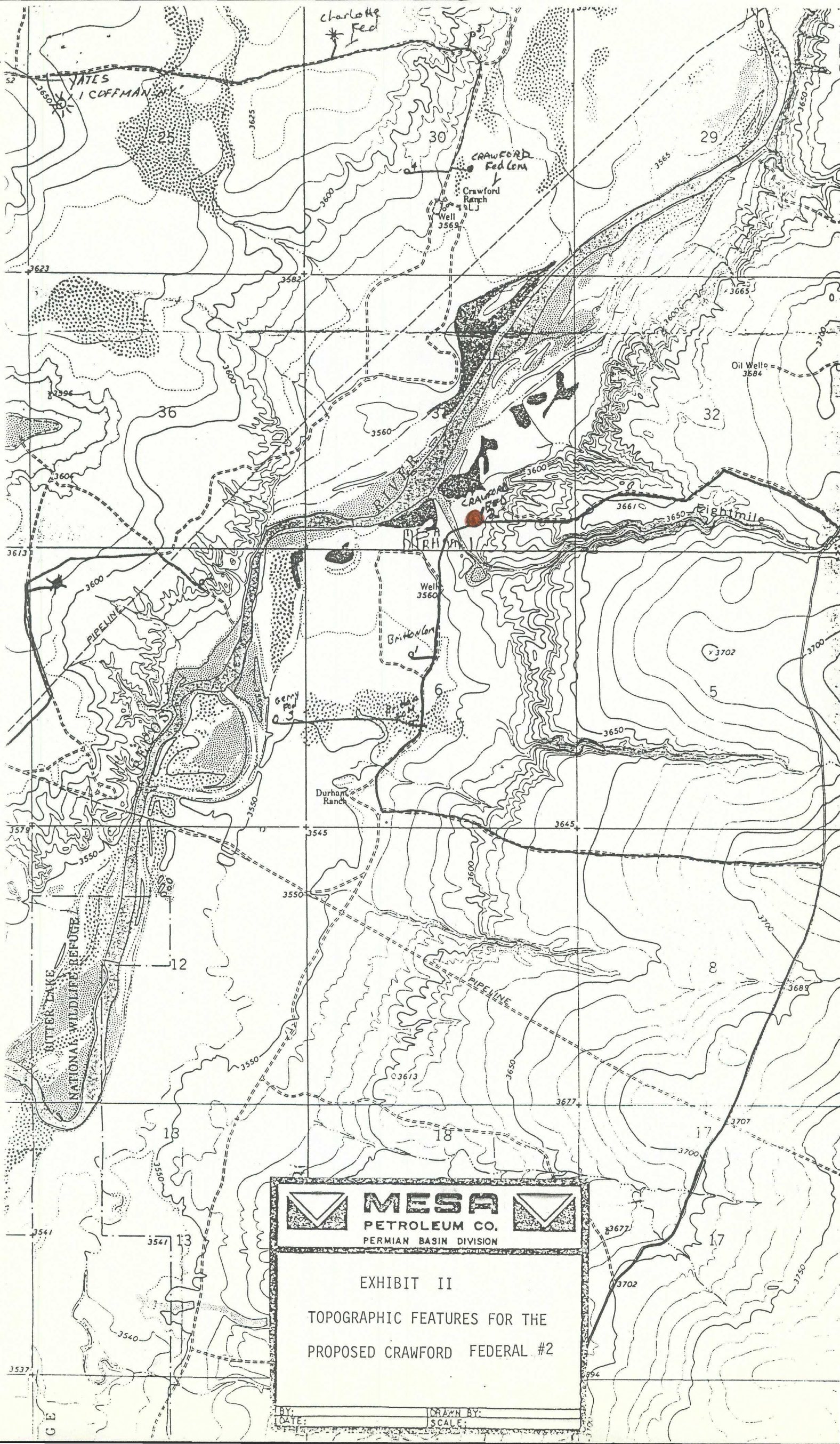

**MESA**
PETROLEUM CO.
PERMIAN BASIN DIVISION

EXHIBIT II
TOPOGRAPHIC FEATURES FOR THE
PROPOSED CRAWFORD FEDERAL #2

BY: _____
DATE: _____
DRAWN BY: _____
SCALE: _____

**NEW MEXICO OIL CONSERVATION COMMISSION
WELL LOCATION AND ACREAGE DEDICATION PLAT**

Form C-102
Supersedes C-128
Effective 1-1-65

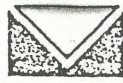
All distances must be from the outer boundaries of the Section.

Operator MESA PETROLEUM CO.			Lease CRAWFORD FEDERAL			Well No. 2		
Unit Letter 0	Section 31	Township 7 South	Range 26 East	County Chaves				
Actual Footage Location of Well: <div style="display: flex; justify-content: space-between;"> 2080 feet from the East line and 660 feet from the South line </div>								
Ground Level Elev. 3555.0	Producing Formation ABO		Pool UNDESIGNATED			Dedicated Acreage: SE 1/4 160 Acres		

1. Outline the acreage dedicated to the subject well by colored pencil or hachure marks on the plat below.
2. If more than one lease is dedicated to the well, outline each and identify the ownership thereof (both as to working interest and royalty).
3. If more than one lease of different ownership is dedicated to the well, have the interests of all owners been consolidated by communitization, unitization, force-pooling, etc?

☐ Yes ☐ No If answer is "yes," type of consolidation _____

If answer is "no," list the owners and tract descriptions which have actually been consolidated. (Use reverse side of this form if necessary.) _____

No allowable will be assigned to the well until all interests have been consolidated (by communitization, unitization, forced-pooling, or otherwise) or until a non-standard unit, eliminating such interests, has been approved by the Commission.

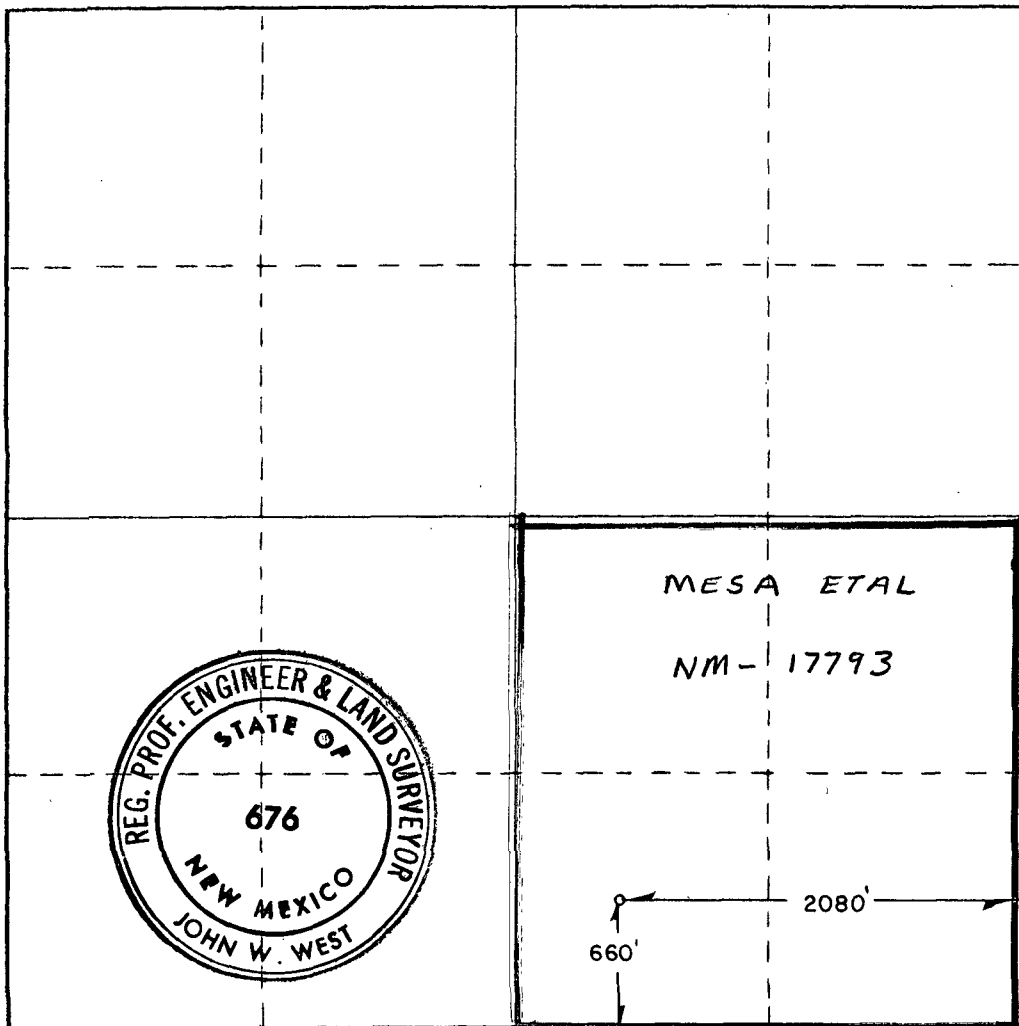

CERTIFICATION

I hereby certify that the information contained herein is true and complete to the best of my knowledge and belief.

R. E. Mathis

Name

R. E. MATHIS

Position

REGULATORY COORDINATOR

Company

MESA PETROLEUM Co

Date

1-29-82

I hereby certify that the well location shown on this plat was plotted from field notes of actual surveys made by me or under my supervision, and that the same is true and correct to the best of my knowledge and belief.

Date Surveyed

Dec. 15, 1981

Registered Professional Engineer and/or Land Surveyor

John W. West

Certificate No. **JOHN W. WEST 676**
PATRICK A. ROMERO 6863
Ronald J. Eidson 3239

0 330 660 990 1320 1650 1980 2310 2640 2000 1500 1000 500

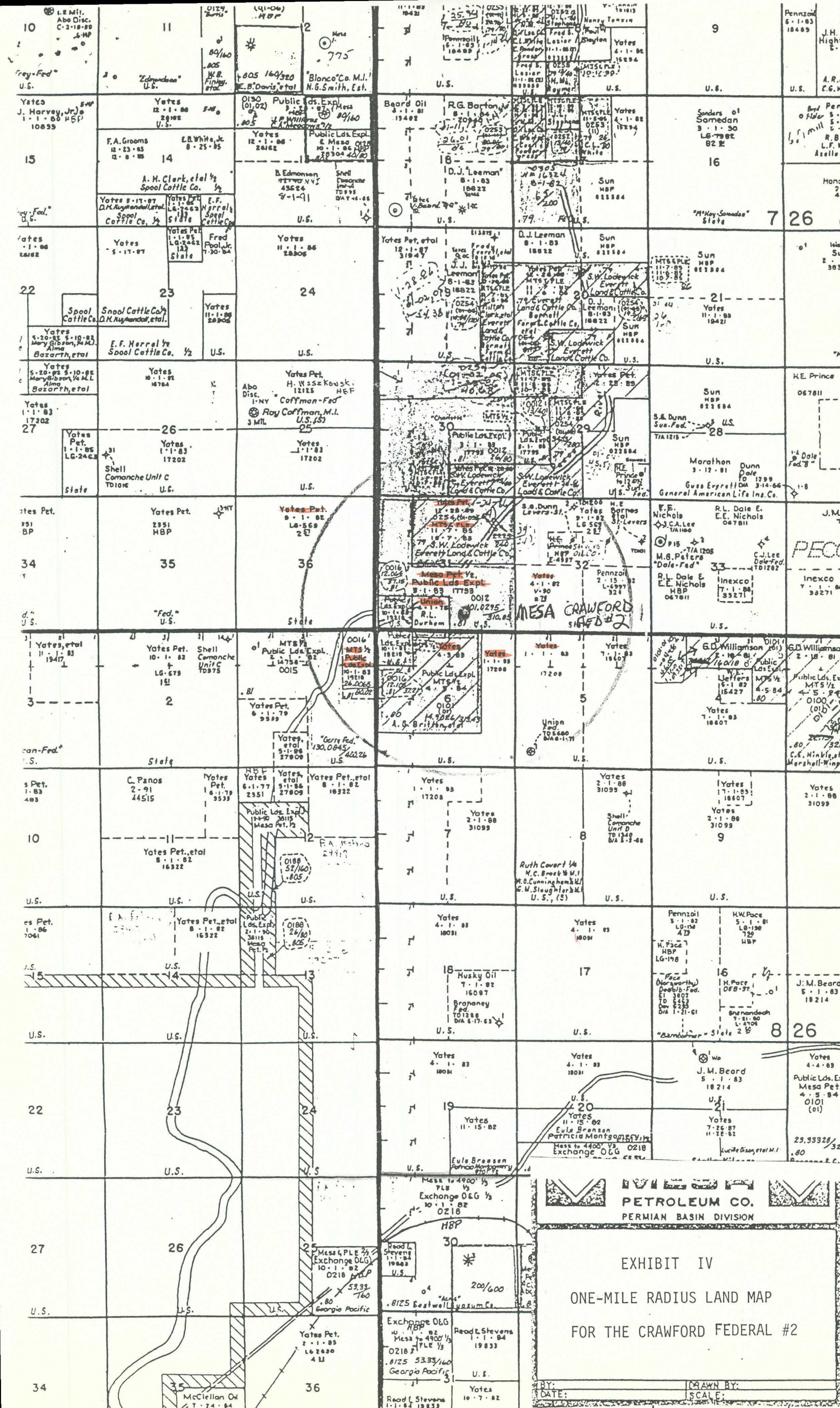

PETROLEUM CO.
PERMIAN BASIN DIVISION

EXHIBIT IV

ONE-MILE RADIUS LAND MAP
FOR THE CRAWFORD FEDERAL #2

DRAWN BY: _____
SCALE: _____