



R. W. Schroeder  
District Superintendent

October 11, 1982

Mr. Joe D. Ramey  
New Mexico Oil Conservation Division  
P. O. Box 2088  
Santa Fe, NM 87501

File: RWS-793-400.1

Dear Mr. Ramey:

Application for Unorthodox Location  
Jicarilla Apache A-118 No. 7  
Pictured Cliffs Field  
Rio Arriba County, New Mexico

Amoco Production Company hereby requests approval of our Jicarilla Apache A-118 No. 7 at a location 790' FSL and 2300' FWL, Section 25, T26N, R3W, Rio Arriba County, New Mexico.

The attached Form C-102 illustrates the topographical problems encountered in selecting a suitable well site. The selected location is only 790' from the south line of Section 25.

A copy of this application is being sent by certified mail to the offset lease holders, Mobil Oil Company, Northwest Pipeline Corporation, and Dome Petroleum with the request they furnish you a waiver of objection and return one copy of the same to me.

Very truly yours,

PJS/mp

Attachments

\_\_\_\_\_ hereby waives objection to  
Amoco's application for an unorthodox location as proposed above.

BY: \_\_\_\_\_

DATE: \_\_\_\_\_

NS L 1599  
Gravilam Pictured Cliffs  
NSL Rule 104F  
11-H-82

**Amoco Production Company (USA)**

Petroleum Center Building  
501 Airport Drive  
Farmington, New Mexico 87401  
505-325-8841

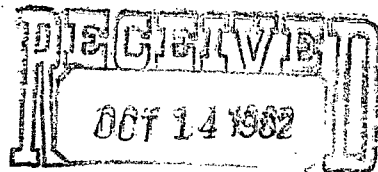

OIL CONSERVATION DIVISION  
SANTA FE



STATE OF NEW MEXICO  
ENERGY AND MINERALS DEPARTMENT  
OIL CONSERVATION DIVISION

BRUCE KING  
GOVERNOR

LARRY KEHOE  
SECRETARY

October 15, 1982

POST OFFICE BOX 2098  
STATE LAND OFFICE BUILDING  
SANTA FE, NEW MEXICO 87501  
(505) 827-2434

Amoco Production Company  
Petroleum Center Building  
501 Airport Drive  
Farmington, NM 87401

Re: Application for Non-Standard  
Location: Jicarilla Apache A-118  
Well No. 7, Sec. 25 - Township 26 North  
Range 3 West, Rio Arriba County, New  
Mexico

We may not process the subject application for non-standard location until the required information or plats checked below (is)(are) submitted.

- ☐ A plat must be submitted clearly showing the ownership of the offsetting leases.
- ☐ A statement must be submitted that offset owners have been notified of the application by certified mail.
- ☐ A plat must be submitted fully identifying the topography necessitating the non-standard location.
- ☒ Other: A copy of the archeological report requiring relocation of the well must be submitted.

Very truly yours,

R. L. STAMETS  
Technical Support Chief

RLS/dr



**Amoco Production Company (USA)**

Petroleum Center Building  
501 Airport Drive  
Farmington, New Mexico 87401  
505-325-8841

R. W. Schroeder  
District Superintendent

October 11, 1982

Mr. Joe D. Ramey  
New Mexico Oil Conservation Division  
P. O. Box 2088  
Santa Fe, NM 87501

File: RWS-793-400.1

Dear Mr. Ramey:

Application for Unorthodox Location  
Jicarilla Apache A-118 No. 7  
Pictured Cliffs Field  
Rio Arriba County, New Mexico

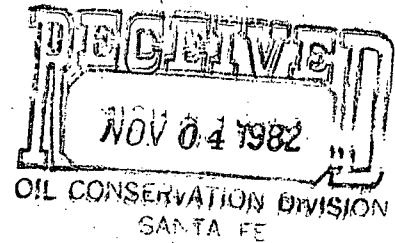

Amoco Production Company hereby requests approval of our Jicarilla Apache A-118 No. 7 at a location 790' FSL and 2300' FWL, Section 25, T26N, R3W, Rio Arriba County, New Mexico.

The attached Form C-102 illustrates the topographical problems encountered in selecting a suitable well site. The selected location is only 790' from the south line of Section 25.

A copy of this application is being sent by certified mail to the offset lease holders, Mobil Oil Company, Northwest Pipeline Corporation, and Dome Petroleum with the request they furnish you a waiver of objection and return one copy of the same to me.

Very truly yours,

Original Signed by  
R. W. SCHROEDER  
PJS/mp

Attachments

MOBIL PRODUCING TX & NM INC.

hereby waives objection to  
Amoco's application for an unorthodox location as proposed above.

BY: *Ja Morris*

DATE: 10/29/82

IS Land Map adequate

NSL-  
1599



**Amoco Production Company (USA)**

Petroleum Center Building  
501 Airport Drive  
Farmington, New Mexico 87401  
505-325-8841

R. W. Schroeder  
District Superintendent

11-9-82

October 11, 1982

NSL  
Rule 104 F

**NORTHWEST PIPELINE CORPORATION**

**OCT 15 1982**

**PRODUCTION AND DRILLING**

Mr. Joe D. Ramey  
New Mexico Oil Conservation Division  
P. O. Box 2088  
Santa Fe, NM 87501

File: RWS-793-400.1

Dear Mr. Ramey:

Application for Unorthodox Location  
Jicarilla Apache A-118 No. 7  
Pictured Cliffs Field  
Rio Arriba County, New Mexico

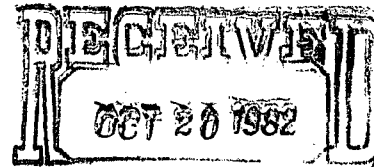

OIL CONSERVATION DIV.  
SANTA FE

Amoco Production Company hereby requests approval of our Jicarilla Apache A-118 No. 7 at a location 790' FSL and 2300' FWL, Section 25, T26N, R3W, Rio Arriba County, New Mexico.

The attached Form C-102 illustrates the topographical problems encountered in selecting a suitable well site. The selected location is only 790' from the south line of Section 25.

A copy of this application is being sent by certified mail to the offset lease holders, Mobil Oil Company, Northwest Pipeline Corporation, and Dome Petroleum with the request they furnish you a waiver of objection and return one copy of the same to me.

Very truly yours,

Original Signed by  
R. W. SCHROEDER

PJS/mp

Attachments

**NORTHWEST PIPELINE CORPORATION** hereby waives objection to Amoco's application for an unorthodox location as proposed above.

BY:

DATE: 10-18-82



R. W. Schroeder  
District Superintendent

October 11, 1982

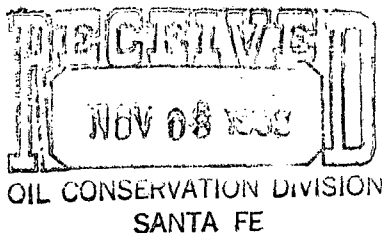

Mr. Joe D. Ramey  
New Mexico Oil Conservation Division  
P. O. Box 2088  
Santa Fe, NM 87501

File: RWS-793-400.1

Dear Mr. Ramey:

Application for Unorthodox Location  
Jicarilla Apache A-118 No. 7  
Pictured Cliffs Field  
Rio Arriba County, New Mexico

Amoco Production Company hereby requests approval of our Jicarilla Apache A-118 No. 7 at a location 790' FSL and 2300' FWL, Section 25, T26N, R3W, Rio Arriba County, New Mexico.

The attached Form C-102 illustrates the topographical problems encountered in selecting a suitable well site. The selected location is only 790' from the south line of Section 25.

A copy of this application is being sent by certified mail to the offset lease holders, Mobil Oil Company, Northwest Pipeline Corporation, and Dome Petroleum with the request they furnish you a waiver of objection and return one copy of the same to me.

Very truly yours,

Original Signed by  
R. W. SCHROEDER  
PJS/mp

Attachments



Dome Petroleum Corp. hereby waives objection to Amoco's application for an unorthodox location as proposed above.

BY: \_\_\_\_\_

Robert S. Kelley

DATE: \_\_\_\_\_

10/22/82

Amoco Production Company (USA)

Petroleum Center Building  
501 Airport Drive  
Farmington, New Mexico 87401  
505-325-8841

Page 2  
RWS-793-400.1  
October 11, 1982

cc: Frank Chavez  
New Mexico Oil Conservation Division  
1000 Rio Brazos Road  
Aztec, NM 87410

Mobil Oil Company  
P. O. Box 778  
Farmington, NM 87401

Northwest Pipeline Corporation  
P. O. Box 90  
Farmington, NM 87401

✓ Dome Petroleum  
501 Airport Drive  
Farmington, NM 87401

J.C. Burnside  
Denver, Colorado

## OIL CONSERVATION DIVISION

P. O. BOX 2088

SANTA FE, NEW MEXICO 87501

Form C-107  
Revised 10-1-7

STATE OF NEW MEXICO

ENERGY AND MINERALS DEPARTMENT

All distances must be from the outer boundaries of the Section.

Operator <b>AMOCO PRODUCTION COMPANY</b>			Lease <b>JICARILLA APACHE A118</b>		Well No. <b>7</b>
Unit Letter <b>N</b>	Section <b>25</b>	Township <b>26N</b>	Range <b>3W</b>	County <b>Rio Arriba</b>	
Actual Footage Location of Well: <b>790</b> feet from the <b>South</b> line and <b>2300</b> feet from the <b>West</b> line					
Ground Level Elev. <b>7524</b>	Producing Formation <b>Pictured Cliffs</b>		Pool <b>Gavilan Pictured Cliffs</b>	Dedicated Acreage: <b>160</b> Acres	

1. Outline the acreage dedicated to the subject well by colored pencil or hachure marks on the plat below.
2. If more than one lease is dedicated to the well, outline each and identify the ownership thereof (both as to working interest and royalty).
3. If more than one lease of different ownership is dedicated to the well, have the interests of all owners been consolidated by communitization, unitization, force-pooling, etc?

☐ Yes ☐ No If answer is "yes," type of consolidation \_\_\_\_\_

If answer is "no," list the owners and tract descriptions which have actually been consolidated. (Use reverse side of this form if necessary.) \_\_\_\_\_

No allowable will be assigned to the well until all interests have been consolidated (by communitization, unitization, forced-pooling, or otherwise) or until a non-standard unit, eliminating such interests, has been approved by the Commission.

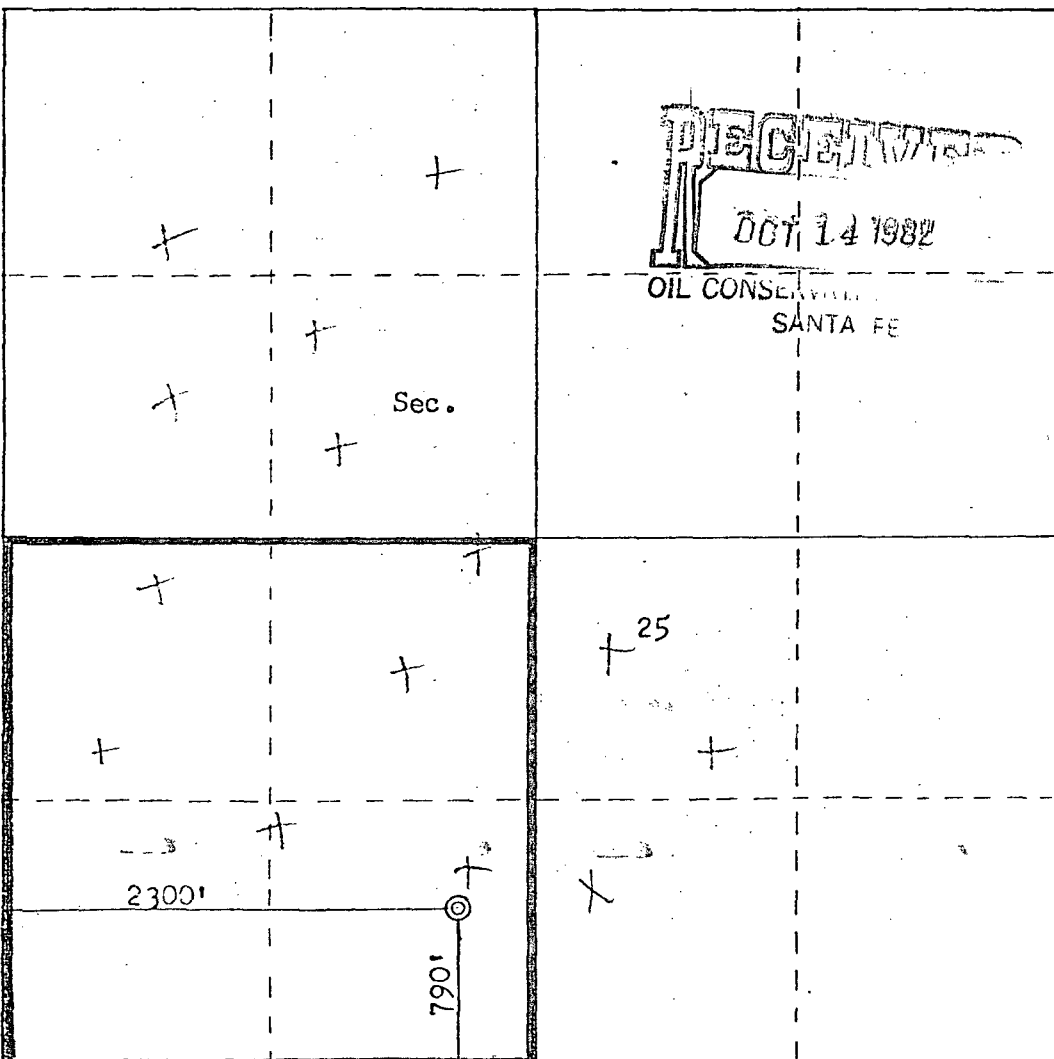

## CERTIFICATION

I hereby certify that the information contained herein is true and complete to the best of my knowledge and belief.

*Dale H. Shoemaker*

Name

Dale H. Shoemaker

Position

District Engineer

Company

Amoco Production Company

Date

September 9, 1982

I hereby certify that the well location shown on this plat was plotted from field notes of actual surveys made by me or under my supervision, and that the same is true and correct to the best of my knowledge and belief.

Date Surveyed

September 3, 1982

Registered Professional Engineer and Land Surveyor

*Fred B. Kerr Jr.*  
Fred B. Kerr Jr.

Certificate No.

3950

Scale: 1"=1000'

X denotes Archaeological sites

R3W

R2W

T  
26  
N

<p>Mobil Jicarilla D#8 23</p>	<p>Mobil Jicarilla D#10 24</p> <p>Mobil Jicarilla D#12 24</p>	<p>Mobil Federal #1 19</p>
<p>26</p> <p>Mobil Jicarilla D#5 25</p> <p>Mobil Jicarilla D#118 25</p>	<p>Mobil Jicarilla D#12 25</p> <p>Mobil Jicarilla D#12 25</p>	<p>30</p>
<p>35</p>	<p>Mobil Jicarilla D#12 36</p> <p>Mobil Jicarilla D#12 36</p>	<p>31</p>

● EXISTING GAVILAN PICTURED CLIFF WELLS

➔ ● PROPOSED WELL LOCATION

# Cultural Resources Management Program



**San Juan College**

An Archaeological Survey of  
Two Proposed Well Locations and Access Roads  
on the Jicarilla Apache Indian Reservation in  
Southwestern Rio Arriba County, New Mexico,  
Conducted for Amoco Production Company



Report 82-SJC-137

Federal Antiquities Permit No. 82-CO/NM-248 and  
Jicarilla Apache Tribal Resolution #82-314

September 22, 1982

Jicarilla Apache 102 ~~#31~~ 13R  
Jicarilla Apache A118 #7

## ABSTRACT

A Class III Pedestrian Archaeological Survey was conducted about 30 to 35 miles north/northwest of Cuba, New Mexico. The archaeologist, L. Jean Hooton, inspected two proposed well locations and access roads. One site area, SJC-836, was found at the original Jicarilla Apache A118 #7 location. An additional inspection by Ms. Hooton of that area indicated that, although there were no actual features on the proposed well location, the proximity of features to the perimeters of the project area would make their protection and avoidance nearly impossible. Secondary impacts related to the increased accessibility of the area are also very probable. It was recommended that the proposed well Jicarilla Apache A118 #7 be relocated to avoid Site SJC-836. The well was relocated twice thereafter. The second location could not be used as a drilling site because of high concentration of sherds and flakes and the possibility of subsurface features. Two sites, SJC-851 and SJC-855, were located during the inspection of the third location. These sites are outside the project easements, however, and will not be impacted by the proposed construction. Monitoring of the location is recommended given the intensity of occupation in this area and the possibility of buried deposits.

The approximate area inspected during the surveys, site areas and relocations totalled 48.28 acres.

The work was conducted by the:

Cultural Resources Management Program  
San Juan College  
4601 College Blvd.  
Farmington, NM 87401-4699  
Phone: 505/326-3311, Extension 344

The work was conducted under:

Federal Antiquities Permit No. 82-CO/NM-248 and  
Jicarilla Apache Tribal Resolution #82-314.

The work was conducted for:

Amoco Production Company  
Petroleum Center Building  
501 Airport Drive  
Farmington, NM 87401  
Phone: 505/325-8841

## TABLE OF CONTENTS

ABSTRACT	i.
LIST OF FIGURES	iii.
INTRODUCTION	1.
METHODOLOGY	2.
RECORDS SEARCH	2.
PROJECT LOCATIONS	3.
CULTURAL RESOURCES	10.
RECOMMENDATIONS	31.
BIBLIOGRAPHY	31.
APPENDIX: Isolated Artifact Form	32.

## LIST OF FIGURES

FIGURE 1	5.
FIGURE 1b - Nearby Sites (FOR BIA ARCHAEOLOGIST ONLY)	5a.
FIGURE 2	9.
FIGURE 2b - Nearby Sites (FOR BIA ARCHAEOLOGIST ONLY)	9a.
SITE SJC-836	16.
SITE SJC-851	23.
SITE SJC-855	29 & 30

## INTRODUCTION

On August 19, 1982 L. Jean Hooton, from the Cultural Resources Management Program, San Juan College, Farmington, New Mexico, conducted an archaeological survey at the request of Mr. Len Hughes, of Amoco Production Company. Present during the survey were Mr. Bob Inskeep and Mr. Rod Velarde, of Amoco Production Company; Mr. Bill Bingham, of Minerals Management Service; Mr. Dixon Sandoval, of Jicarilla Apache Indian Tribe; Mr. John Atencio and Ms. Mary Gody, of Bureau of Indian Affairs, Jicarilla Agency.

The proposed well locations and access roads will be on the Jicarilla Apache Indian Reservation and were surveyed under Federal Antiquities Permit 82-CO/NM-248 and Jicarilla Apache Tribal Resolution #82-314.

One site, SJC-836, was found at the proposed location for the Jicarilla Apache A118 #7 well. An additional inspection was conducted on August 16, 1982 by Ms. Hooton accompanied by Dr. Jim Mueller. Due to the proximity of features around the location it was recommended that the well location be moved in order to assure that no untoward disturbance of the site would occur.

The location, Jicarilla Apache A118 #7, was relocated. Mr. Gifford Velarde, of San Juan College's Cultural Resources Management Program, inspected the new location and additional access road on August 27, 1982, along with Mr. Bob Inskeep, of Amoco Production Company. Others present during inspection were Mr. Steve Shafran, of Minerals Management Service; Mr. Dixon Sandoval, of Jicarilla Tribal Oil and Gas Office, Jicarilla Apache Indian Tribe; and Mr. John Atencio, B.I.A., Realty Office, Jicarilla Agency.

On September 3, 1982 the third proposed well location for Jicarilla Apache A118 #7 was inspected by Dr. Richard P. Watson and Mr. Gifford Velarde, of San Juan College's Cultural Resources Management Program. Others present were Mr. Dixon Sandoval, Mr. Bob Inskeep, Mr. Steve Shafran and Mr. John Atencio.

## METHODOLOGY

The proposed well locations were surveyed by walking and marking the perimeters of the approximate 400' x 400' easements with yellow flagging. Then, parallel transects 30 to 50 feet apart were walked back and forth within the marked boundaries. Proposed access roads were surveyed by walking the flagged route to and from the proposed location covering an easement 50 feet wide.

## RECORDS SEARCH

A site survey records search was conducted at the Cultural Resources Management Program, San Juan College, and the Laboratory of Anthropology, Museum of New Mexico, prior to the field work. Several sites have been previously recorded within an approximate 1-mile radius of the project areas; however, all of these sites are sufficiently distant from the project areas and will not be disturbed. The sites are listed below and are shown on Figures 1b and 2b.

- LA #11492 - "Pablo Springs Site" - rocks, poles, sherds; recorded by U. S. Forest Service; speculated "fortified site". (No date, but probably aboriginal.)
  - LA #16303 - Pueblo I - 2 hearths, 2 mano fragments, one basin metate fragment, sherds; recorded by Division of Conservation Archaeology.
  - LA #16490 - Pueblo I - 1-room sandstone slab structure, sherds, flakes.
  - LA #4917 - Rosa Phase, disturbed, EPNG survey.
  - LA #4918 - Rosa Phase, EPNG survey.
  - LA #4925 - Pithouse village - Rosa gray (ceramics), EPNG survey.
- NOTE: The above-described Sites LA #4917, #4918 and #4925 may be Largo-Gallina sites incorrectly identified as Rosa Phase.
- LA #16873 - PII - Largo-Gallina Phase - 2 pithouses, one masonry wall (SJC-347, Report 78-SJC-200).

## PROJECT LOCATIONS

PROPOSED WELL: JICARILLA APACHE 102 #31. (Figure 1)

Land Jurisdiction: Jicarilla Apache Indian Reservation

Legal Location: The proposed location will be in the NW $\frac{1}{4}$  of the SE $\frac{1}{4}$  of the NE $\frac{1}{4}$  of Section 10, Township 26 North, Range 4 West, N.M.P.M., Rio Arriba County, New Mexico. The well will be 1520 feet from the north line and 800 feet from the east line of Section 10.

Elevation: G.L. 6844' ASL

UTM Coordinates:

Well Stake - Zone 13; 300,105 mE; 4,041,975 mN.

Access: 20 feet wide and approximately 150 feet long, approaching from an existing well location to the west.

Actual Project Area: 1.96 acres (275' x 300' well location + 20' x 150' road)

Surveyed Area: 3.85 acres (400' x 400' well easement + 50' x 150' road easement)

Physiography and Environment:

The proposed location and access road will be in the bottom of Cottonwood Canyon, a narrow, high-walled canyon. The location will be on relatively flat ground immediately adjacent to the primary arroyo channel. Drainage off the location is southeasterly into the south-flowing arroyo. Surface deposits are alluvial and soils are in the Vermejo-Galisteo Association (Maker, et al., 1973), and appear to be sandy clay loam. Vegetation is predominantly sagebrush, greasewood and rabbitbrush, and also includes grama, brome, slender wheat, crested wheat, squirreltail, prickly pear cactus, paintbrush, globe mallow and Russian thistle. The area is presently used for grazing and petroleum development.

Cultural Resources:

There were no cultural resources found on, or near, the location, or access road. A sparse amount of modern trash was observed and is probably associated with activities at the nearby existing well location and access road.

Recommendations:

Archaeological clearance is recommended for the well Jicarilla Apache 102  
#31.

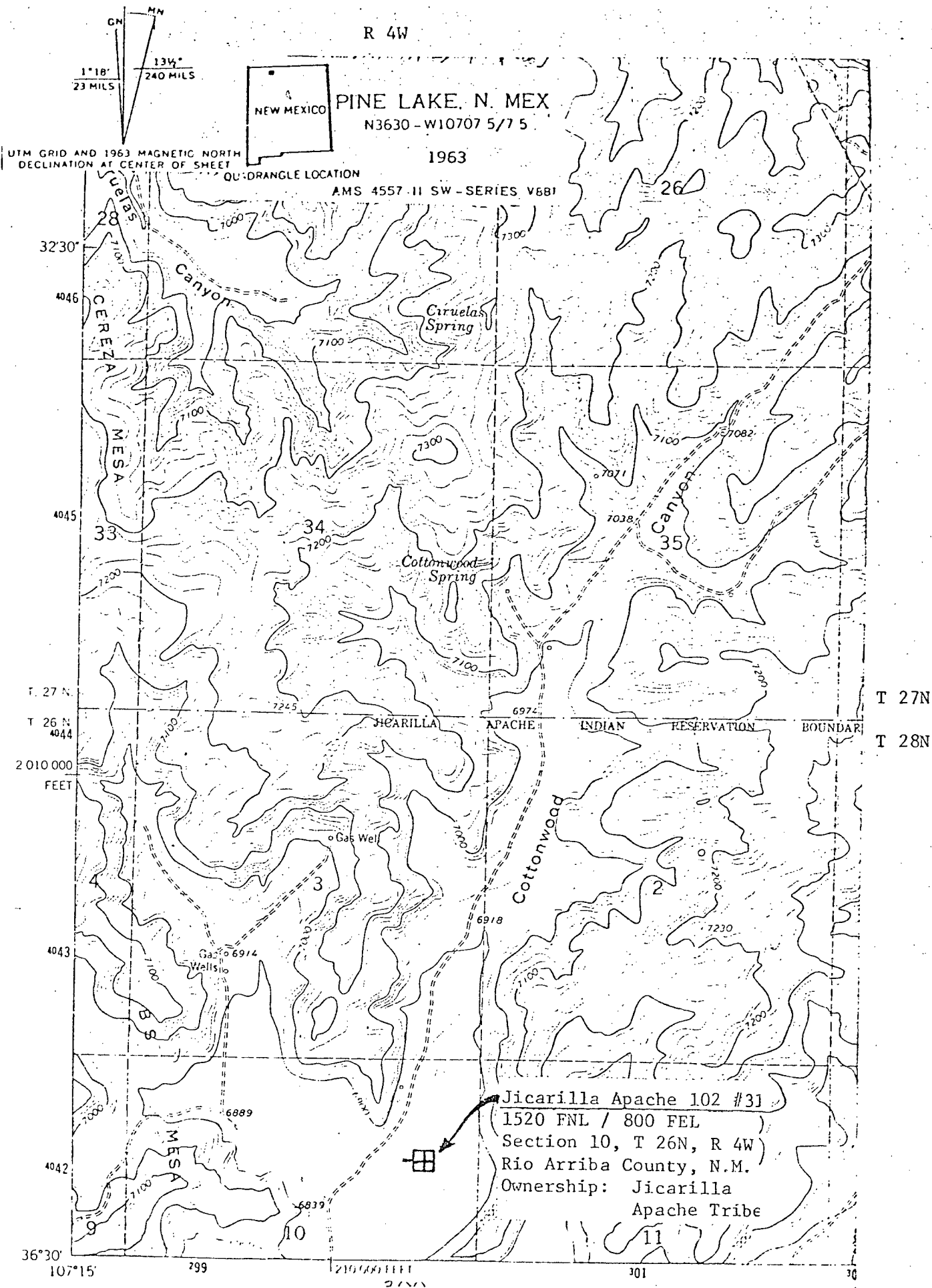

Figure 1

PROPOSED WELL: JICARILLA APACHE A118 #7 (Figure #2)

Land Jurisdiction: Jicarilla Apache Indian Reservation

Legal Location: The proposed location will be in the NE $\frac{1}{4}$  of the SE $\frac{1}{4}$  of the SW $\frac{1}{4}$  of Section 25, Township 25 North, Range 3 West, N.M.P.M., Rio Arriba County, New Mexico. The well will be 790 feet from the south line and 2300 feet from the west line of Section 25.

Elevation: GL 7524' ASL

UTM Coordinates:

Well Stake - Zone 13; 312,040 mE; 4,035,980 mN.

Access: 20 feet wide and approximately 1000 feet long, approaching from the south, turning into the northeast side of the location.

Actual Project Area: 2.34 acres (275' x 300' well location + 20' x 1000' road)

Surveyed Area: 48.28 acres (SJC-836 700' x 600' site area + (400' x 400')<sup>2</sup> well easements + 50' x 2350' road easements) (1000' x 600' = Second Inspection) (1200' x 400' = Third Inspection)

Physiography and Environment:

The proposed location was moved from its original location and will now be on a gentle slope with southeasterly drainage. Soils are in the Travessilla-Persayo-Rockland Association (Maker, et al., 1973) and appear to be sandy loam formed from alluvial surface deposits. Vegetation is predominantly pinon-juniper and sagebrush, but includes oakbrush, mountain mahogany, bitterbrush, prickly pear cactus, hedgehog, snakeweed, lupine, paintbrush, grama, crested wheat, squirreltail, purple asters and other annuals. The area is presently used for grazing and petroleum development.

Cultural Resources:

Site SJC-836 was found around the original well location. Due to the proximity of site features and the potential for disturbance of the site, it was recommended that the well be relocated entirely away from the area (see site form, map and description).

The inspection of the relocated well pad area disclosed an intense, but dispersed, distribution of cultural materials covering the slope on which the location was staked. Intensive colluviation and the possibility of buried features necessitated yet another relocation of the A118 #7 well location (Figure 2). It was suggested that a location farther east in the flatter portion of the drainage would be less likely to contain cultural materials.

The inspection of this second relocation revealed that this is the case. During this inspection cultural materials were located on the ridge and slope above the proposed location but virtually no material was found on the location. Two sites, SJC-851 - a surface structure and associated cultural debris - and SJC-855 - a hearth and scatter of lithic and ceramic materials, were located upslope of the proposed well pad. A single isolated carbonaceous stain interpreted to be a possible hearth was also located 80 feet northeast of the proposed well pad. A broad scatter of lithic debris and ceramics occurs on the slope above (north) of this location. The distribution of these materials in the small drainages indicates that they are predominantly in a derived context. The majority of these materials appear to be derived from Site SJC-851. This area above the project area has undergone intensive erosion and colluviation. The discovery of two eroding hearths near the base of the slope indicates that there is a potential for buried features in this area.

The actual project area has very few pieces of cultural material but is undoubtedly the recipient of colluvial sediments from the slope above. As a result, the possibility remains that there are buried cultural materials within the boundaries of the proposed project.

#### Recommendations:

Archaeological clearance is recommended for Jicarilla Apache A118 #7 with the stipulation that an archaeologist be present during the first stages of earth-

moving activities to monitor construction and protect a nonrenewable resource - that of antiquity.

R 3W

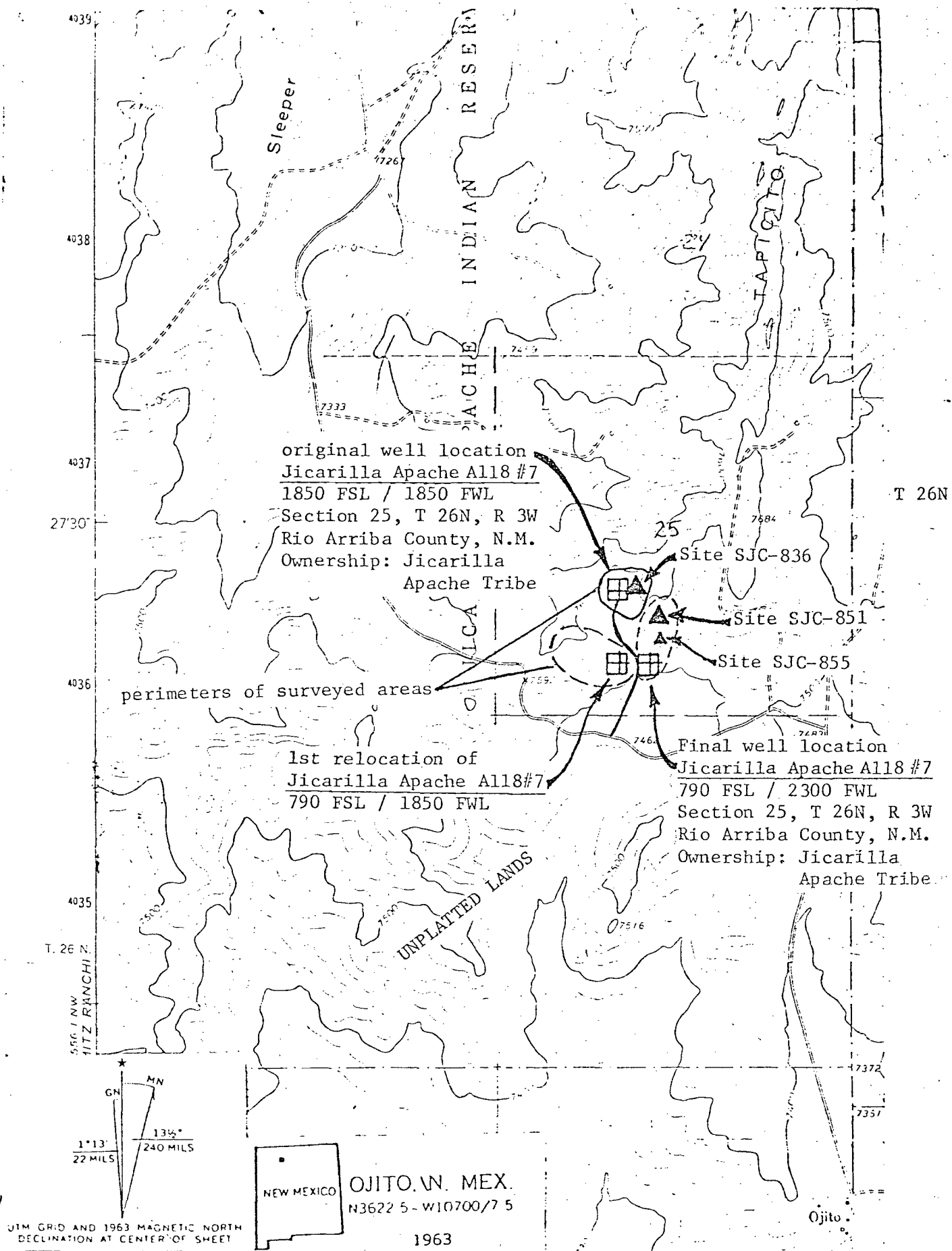

## CULTURAL RESOURCES

Site SJC-836

This site is probably a Largo-Gallina Phase site consisting of the remains of three or four single room structures, an ash/charcoal deposit containing sherds, flakes, burned bone and a chopper tool, and a sparse, general scatter of sherds and flakes.

The remains of the structures, H-1, H-2 and H-3, consisted of clusters of large sandstone cobbles and probably represent foundation rubble of jacal surface rooms. H-1 is approximately 10 or 12 feet in diameter and is a relatively dense cluster of rubble, although it is not a mound. H-2 is not as well defined but appears to have alignments, while H-3 has one very obvious alignment of stone. The structures are from 250 to 300 feet southeast of the original well stake for proposed well Jicarilla A118 #7. The fourth possible structure is about 300 feet south of the well stake along the access and is represented by a disarticulated scatter of large sandstone cobbles similar to the other structures.

The ash/charcoal deposit is about 8' x 15' and is on a small slope area and in a rivulet drainage approximately 200 feet southwest of the well stake and contains heavy bone fragments (probably artiodactyl), sherds (probably Gallina utility) and chipped stone, including one chopper. Depth of fill in this area is estimated to be about 30 cm.

A mineralized bone fragment was found and has been identified as a humeral head from a Coryphodon, a relatively large animal common during the Eocene Period (O'Neill, 1982).

A generally sparse artifact scatter was observed in the entire site area. Ceramics included carbon painted and utility sherds. Among these were rim sherds, both plain and filleted, and one handle. The painted sherd was a bowl sherd with painted interior. Chipped stone material included utilized flakes, thinning

flakes, shatter and unutilized flakes. Material types were chalcedony, chert, quartzite and what is also known as Pedernal chert. One small fragment of a sandstone metate was also found. A few battered rocks probably used for hammerstones were also observed.

No additional features were found in the area examined.

The area examined was approximately 700 feet long and 600 feet wide and cultural material was still present. It is suggested that additional features and sites are probably present on the ridge top areas north and west of this site area.

The site, SJC-836, was found during the predrill inspection of proposed well location Jicarilla Apache A118 #7 and due to the proximity of features and potential for disturbance it was recommended that the location be moved completely away from this area.

The site is on an eroded slope and low ridge in a woodland setting. Drainage and exposure of the area is southerly. Soils are in the Travessilla-Persayo-Rockland Association (Maker, et al., 1973) and are mostly sandy loam. Vegetation is predominantly pinon-juniper-oakbrush woodland, with western yellow pine (ponderosa) mountain mahogany, bitterbrush, sagebrush, snakeweed, prickly pear cactus, hedgehog, paintbrush, lupine, grama, squirreltail and other forbs and annuals. Evidence of the area's use by wildlife, deer and elk, was prevalent as bedding areas and profuse droppings were observed. The area is also used for domestic grazing and petroleum development occurs nearby as well.

The proposed well location, Jicarilla Apache A118 #7, has been moved approximately 1000 feet south and, therefore, direct and indirect impacts resulting from the project will be avoided. Secondary impacts from pedestrian traffic will probably be minimal due to the lack of collectibles on the site.

Archaeological clearance is recommended for the proposed relocated well, subject to the discretion of the Bureau of Indian Affairs Archaeologist.

LABORATORY OF ANTHROPOLOGY, MUSEUM OF NEW MEXICO  
ARCHAEOLOGICAL SITE SURVEY FORMLA No. \_\_\_\_\_ Site Name \_\_\_\_\_ Other Inst. # SJC-836 I.O. \_\_\_\_\_MMN Proj. # \_\_\_\_\_ UTM: Zone 13 E 3 1 2 0 0 0 N 4 0 3 6 2 8 0Legal Desc. T 26 N S R 3 E W Sec. 25CENTER of the NE  $\frac{1}{4}$  of the SW  $\frac{1}{4}$ Unplatted X Grant \_\_\_\_\_ Owner & Address Jicarilla Apache Tribe, Dulce, N.M.\*Map Reference: Osito, N.M. (U.S.G.S) Date: 1963 Scale: 7.5 MINUTESCounty Rio Arriba State New Mexico Nearest Named Drainage Cañon de los OsitosLocational Desc.: Recognized Landmarks VILLAGE OF OSITO APPROXIMATELY 2  
MILES SOUTH-SOUTHEAST, TAPICITO RIDGE ABOUT 1500 FEET EAST OF SITE.Site Type: HABITATIONSite Size: Length  $\frac{E}{W}$  700 FT. Width  $\frac{N}{S}$  600 FT. Elevation (# of Feet) 7600' ASLTopographic Setting (Location & Access): APPROX.  $\frac{1}{2}$  MILE NORTH OF ROAD J-25  
AND 2 MILES NORTH-NORTHWEST OF OSITO, N.M. ON SOUTH SIDE OF SOUTHWESTERN  
END OF TAPICITO RIDGE.

<input type="checkbox"/> arroyo/wash	<input type="checkbox"/> flood plain/	<input type="checkbox"/> plain/flat
<input type="checkbox"/> base of cliff	<input type="checkbox"/> valley bottom	<input type="checkbox"/> playa
<input type="checkbox"/> bench	<input type="checkbox"/> hill top	<input type="checkbox"/> ridge
<input type="checkbox"/> blowout	<input checked="" type="checkbox"/> hill slope	<input type="checkbox"/> saddle
<input type="checkbox"/> canyon rim	<input type="checkbox"/> low rise	<input type="checkbox"/> base talus slope
<input type="checkbox"/> cave	<input type="checkbox"/> mesa	<input type="checkbox"/> terrace
<input type="checkbox"/> cliff/scarp	<input type="checkbox"/> mountain	other (specify) _____
<input type="checkbox"/> constricted cyn	<input type="checkbox"/> mt. front/foothill	_____
<input type="checkbox"/> dune	<input type="checkbox"/> open canyon floor	_____

Local Vegetation PIÑON-JUNIPER, OAK BRUSH, MOUNTAIN MAHOGANY, BITTERBRUSH,  
WESTERN YELLOW PINE, SAGE, SNAKEWEED, PRICKLY PEAR, HEDGEHOG, PAINTBRUSH, LUPINE,  
GRAMA, SQUIRRELTAILEcological Zone: forest \_\_\_\_\_ woodland X scrubland \_\_\_\_\_ grassland \_\_\_\_\_  
desertscrub \_\_\_\_\_ marshland \_\_\_\_\_ other (specify) \_\_\_\_\_

\*Form must be accompanied by photocopy portion of USGS map showing T., R., scale and quad name.

Soil Type: rocky\_\_\_ gravelly\_\_\_ sandy X clayey\_\_\_ other ROCKLANDLocal Outcrops: sandstone X shale\_\_\_ limestone\_\_\_ basalt\_\_\_ tuff\_\_\_  
other (specify) \_\_\_\_\_Nature and Depth of Fill: estimated 0-30 cm. in ASH/CHARCOAL DEPOSIT.Arch. Status: Amount and Type of Work Past and Present \_\_\_\_\_  
\_\_\_\_\_  
\_\_\_\_\_  
\_\_\_\_\_

## National and/or State Register Status:

- ☐ On State Register  
☐ On National and State Register  
☐ Recommended for National by State, on State Register  
☐ Recommended for National and State Register  
☐ In District, National and State  
☐ In District, National  
☐ In District, State  
☐ Recommended and rejected  
☐ Insufficiently evaluated, potential unknown  
☒ Not nominated

Condition of Site: intact\_\_\_ grazed X eroded X mech. disturbance\_\_\_  
vandalized\_\_\_ other \_\_\_\_\_Mitigation: avoid X monitor\_\_\_ test\_\_\_ excavate\_\_\_ not required \_\_\_\_\_Surveyed for PROPOSED WELL LOCATION AND ACCESS ROADRecord Form: Surv. Forms X Excav. Forms\_\_\_ Sketch Map X Photos XLoc. of Forms, Maps, Photos CULTURAL RESOURCE MGT. PROG. - SAN JUAN COLLEGE,  
FARMINGTON, NEW MEXICO.Surface and/or Subsurface Collections: yes X no\_\_\_ Strategy GRAB1 MINERALIZED BONE FRAGMENT - HUMERAL HEAD OF CORYPHODON - EOCENE PERIOD.Location of Collected Artifacts SAN JUAN COLLEGE - CULTURAL RESOURCE MANAGEMENT  
PROGRAM - FARMINGTON, N.M.

Previous Collections?\_\_\_ When\_\_\_ Repository\_\_\_\_\_

Is there another site close by?\_\_\_ LA or Field Identif.# LA 4917, 4918,Artifact Density: 0, 10's, 100's, 1000's.SPARSE, LESS THAN 1/M<sup>2</sup> OVERALL.

Time Diagnostic Artifacts:

4925 ARE  
 APPROXIMATELY 1.2  
 MILES N OF THIS SITE

LARGO - GALLINA (950 - 1275 A.D.)

No. of Temporal Components 1

(Earliest to Latest)

Temporal Component (1)

Features 3 (possibly 4) STRUCTURES, PROBABLY SINGULAR SURFACE ROUNDS, CHARACTERIZED BY STONE RUBBLE FOUNDATION MATERIAL. ONE ASH/CHARCOAL DEPOSIT. LIGHT ARTIFACT SCATTER OVER AREA, FLAKES, SHARDS, ONE METAL FRAG,Culture ANASAZI Period PUEBLO Phase LARGO-GALLINASite Function: HABITATION Best Date 950-1275 A.D.Method of Date: CERAMICS

Temporal Component (2)

Features \_\_\_\_\_

Culture \_\_\_\_\_ Period \_\_\_\_\_ Phase \_\_\_\_\_

Site Function \_\_\_\_\_ Best Date \_\_\_\_\_

Method of Date \_\_\_\_\_

Temporal Component (3)

Features \_\_\_\_\_

Culture \_\_\_\_\_ Period \_\_\_\_\_

Phase \_\_\_\_\_

Site Function \_\_\_\_\_ Best Date \_\_\_\_\_

Method of Date \_\_\_\_\_

Additional Temporal Components

Published Reference:

Date AUGUST 1982Institution SAN JUAN COLLEGE - FARMINGTON, New Mexico.Author and Title L.J. HOOTON & R.P. WATSON - AN ARCHAEOLOGICAL SURVEY OFRemarks: TWO PROPOSED WELL LOCATIONS AND ACCESS ROADS ON THE JICARILLA  
APACHE INDIAN RESERVATION IN SOUTHWESTERN RIO ARriba COUNTY,  
NEW MEXICO CONDUCTED FOR AMOCO PRODUCTION COMPANY,REPORT 82-SJC-137, CULTURAL RESOURCE MANAGEMENT  
PROGRAM, SAN JUAN COLLEGE, FARMINGTON, New Mexico.Field Recorder L. J. HOOTONDate 8-16-82

Lab Recorder \_\_\_\_\_

Date \_\_\_\_\_

S - sherds  
F - flakes  
M - metate frag

16.

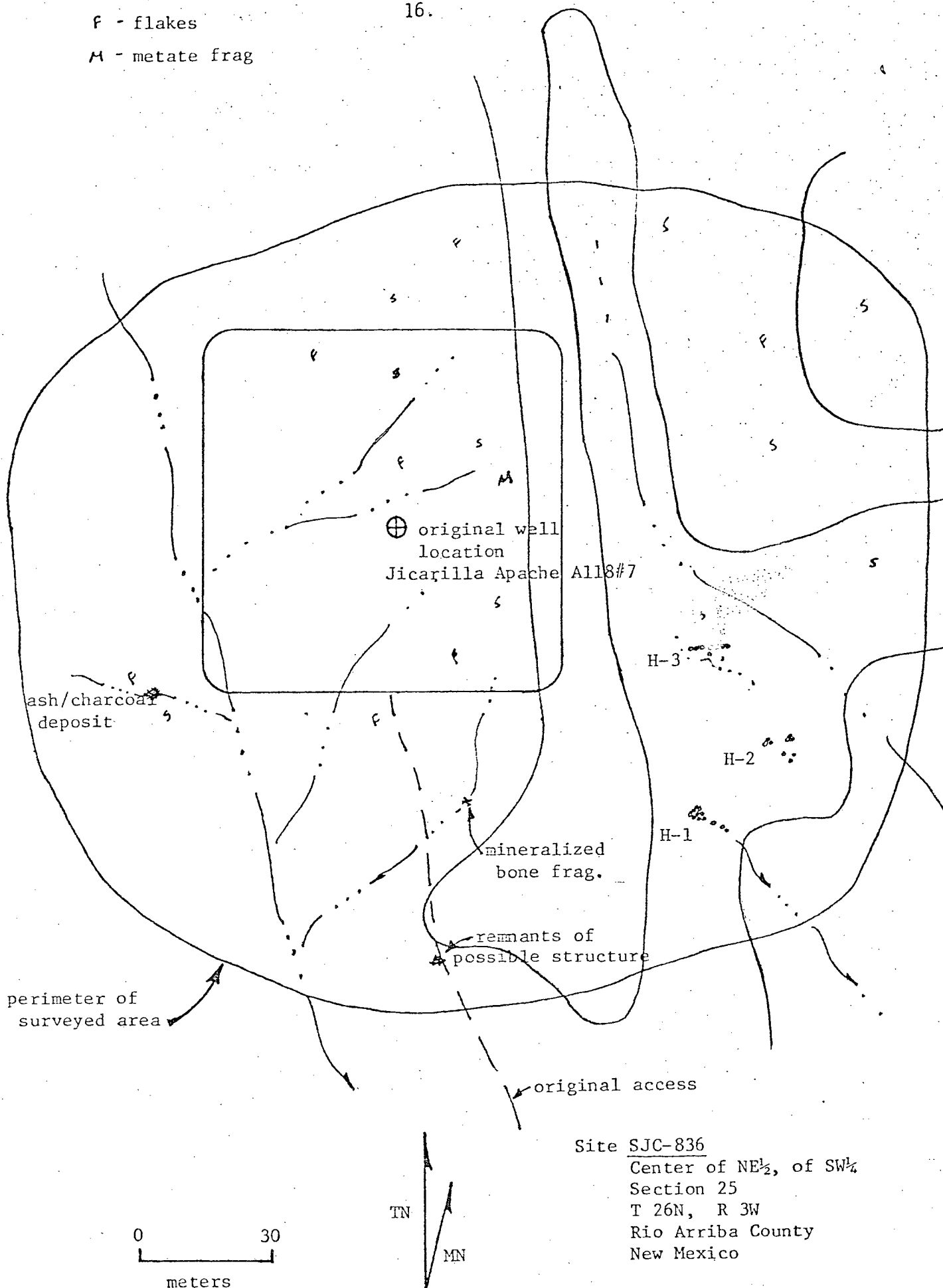

Site SJC-836  
Center of NE $\frac{1}{2}$ , of SW $\frac{1}{4}$   
Section 25  
T 26N, R 3W  
Rio Arriba County  
New Mexico

approximate scale

Report 82-SJC-137

Site SJC-851

This site was found during the relocation of Jicarilla Apache A118 #7. The site appears to be of the Largo-Gallina culture. The remains of what appears to be a surface house are situated on a high hill. A high concentration of carbon painted and utility sherds are nearby the surface structure. The house measures about three meters in diameter, on the basis of sandstone wall remnants.

Site limits are difficult to define because of the extensive colluviation which has served to distribute artifactual materials over a large area (125 m. north/south by 100 m. east/west). Virtually all of the artifacts found during the field inspection were in a derived context. The distribution of the artifacts is most likely the result of natural erosional processes and not cultural activities. The origin of much, if not all, of the cultural debris scattered across the inspected slope appears to have been Site SJC-851. The greatest concentrations of materials are found in the vicinity of the structure and along the upper ridge.

Evidence of the prehistoric use of the ridge slope to the south of the site occurs in the form of two hearths eroding from the colluvium. One hearth and an associated scatter of ceramics and lithic debris were designated SJC-855. The second hearth did not have any associated artifactual materials and was designated as an isolated occurrence. The possibility, therefore, remains that other areas of subsurface features may occur in this area.

Site SJC-851 appears to be a part of a much larger site complex associated with the ridges and slopes in this area. The cultural affiliation of these remains appears to be Largo-Gallina and may well be contemporary. If this is the case, then the site complex may well represent a hamlet, or dispersed village settlement. A broad range of activities appears to have taken place within this complex, as evidenced by the varied features and materials found.

Individually, it is doubtful that this site qualifies for inclusion on the National Register of Historic Places. As a part of a larger as yet incompletely

defined site complex, however, this and other associated sites could undoubtedly provide information important to the understanding of Largo-Gallina subsistence and settlement. Additional survey is necessary to define the limits of the site complex suggested here.

LABORATORY OF ANTHROPOLOGY, MUSEUM OF NEW MEXICO  
 ARCHEOLOGICAL SITE SURVEY FORM

LA No. \_\_\_\_\_ Site Name \_\_\_\_\_ Other Inst. # SJC-85 I.O. \_\_\_\_\_

MMN Proj. # \_\_\_\_\_ UTM: Zone 13E312075N4036180

Legal Desc. T26 N S R3 E W Sec. 25

SE 1/4 of the NE 1/4 of the SW 1/4

Unplatted X Grant \_\_\_\_\_ Owner & Address JICARILLA APACHE TRIBE, DULCE, N.M.

\*Map Reference: U.S.G.S., OJITO, N.M. Date: 1963 Scale: 1:24,000

County RIO ARriba State New Mexico Nearest Named Drainage CAÑON DE LOS OJITOS

Locational Desc.: Recognized Landmarks VILLAGE OF OJITO APPROXIMATELY 2 MILES SOUTH-SOUTHEAST, TAPACITO RIDGE APPROXIMATELY 1200 FEET NORTHEAST OF SITE

Site Type: HABITATION

Site Size: Length 125 m Width 100 m Elevation (# of Feet) 7560' ASL

Topographic Setting (Location & Access): \_\_\_\_\_

<input type="checkbox"/> arroyo/wash	<input type="checkbox"/> flood plain/	<input type="checkbox"/> plain/flat
<input type="checkbox"/> base of cliff	<input type="checkbox"/> valley bottom	<input type="checkbox"/> playa
<input type="checkbox"/> bench	<input type="checkbox"/> hill top	<input type="checkbox"/> ridge
<input type="checkbox"/> blowout	<input checked="" type="checkbox"/> hill slope	<input type="checkbox"/> saddle
<input type="checkbox"/> canyon rim	<input type="checkbox"/> low rise	<input type="checkbox"/> base talus slope
<input type="checkbox"/> cave	<input type="checkbox"/> mesa	<input type="checkbox"/> terrace
<input type="checkbox"/> cliff/scarp	<input type="checkbox"/> mountain	other (specify) _____
<input type="checkbox"/> constricted cyn	<input type="checkbox"/> mt. front/foothill	_____
<input type="checkbox"/> dune	<input type="checkbox"/> open canyon floor	_____

Local Vegetation PIÑON - JUNIPER, WESTERN YELLOW PINE (PONDEROSA), OAKBRUSH, MOUNTAIN MAHOGANY, BITTERBRUSH, SAGE, SNAKEWEED, PRICKLY PEAR, HEDGEHOG, LUPINE, PAINTBRUSH, GRAMA, SQUIRRELTAIL.

Ecological Zone: forest \_\_\_\_\_ woodland X scrubland \_\_\_\_\_ grassland \_\_\_\_\_

desertscrub \_\_\_\_\_ marshland \_\_\_\_\_ other (specify) \_\_\_\_\_

\*Form must be accompanied by photocopy portion of USGS map showing T., R., scale and quad name.

Soil Type: rocky\_\_\_ gravelly\_\_\_ sandy X clayey\_\_\_ other\_\_\_

Local Outcrops: sandstone X shale\_\_\_ limestone\_\_\_ basalt\_\_\_ tuff\_\_\_  
other (specify) \_\_\_\_\_

Nature and Depth of Fill: ESTIMATED 0-1 meters

Arch. Status: Amount and Type of Work Past and Present \_\_\_\_\_

National and/or State Register Status:

- ☐ On State Register
- ☐ On National and State Register
- ☐ Recommended for National by State, on State Register
- ☐ Recommended for National and State Register
- ☐ In District, National and State
- ☐ In District, National
- ☐ In District, State
- ☐ Recommended and rejected
- ☒ Insufficiently evaluated, potential unknown
- ☐ Not nominated

Condition of Site: intact\_\_\_ grazed X eroded X mech. disturbance\_\_\_  
vandalized\_\_\_ other \_\_\_\_\_

Mitigation: avoid\_\_\_ monitor X test\_\_\_ excavate\_\_\_ not required\_\_\_

Surveyed for PROPOSED WELL LOCATION

Record Form: Surv. Forms X Excav. Forms\_\_\_ Sketch Map\_\_\_ Photos\_\_\_

Loc. of Forms, Maps, Photos Cultural Resources Mgt. Proc - San Juan College  
FARMINGTON N.M.

Surface and/or Subsurface Collections: yes X no\_\_\_ Strategy pick-up

SEVERAL FLAKES OF OBSIDIAN & CHERT

Location of Collected Artifacts STC - CRMP

Previous Collections?\_\_\_ When\_\_\_ Repository\_\_\_

Is there another site close by? yes LA or Field Identif.# LA 4917

Artifact Density: 0, 10's, 100's, 1000's. 6/m<sup>2</sup>

Time Diagnostic Artifacts: \_\_\_\_\_

LARGO - CALLINA (950 - 1275) A.D.

LA 4918  
LA 4925  
STC-855

No. of Temporal Components 1

(Earliest to Latest)

Temporal Component (1)

Features 1 surface structureCulture Ames, 221 Period Piedmont Phase large. EMIANSite Function: Habitation Best Date 950-1275 A.D.Method of Date: Ceramics

Temporal Component (2)

Features \_\_\_\_\_

Culture \_\_\_\_\_ Period \_\_\_\_\_ Phase \_\_\_\_\_

Site Function \_\_\_\_\_ Best Date \_\_\_\_\_

Method of Date \_\_\_\_\_

Temporal Component (3)

Features \_\_\_\_\_

Culture \_\_\_\_\_ Period \_\_\_\_\_

Phase \_\_\_\_\_

Site Function \_\_\_\_\_ Best Date \_\_\_\_\_

Method of Date \_\_\_\_\_

Additional Temporal Components

Bibliographic Reference:

Institution \_\_\_\_\_

Author and Title \_\_\_\_\_

Project \_\_\_\_\_

Reviewer \_\_\_\_\_

Date \_\_\_\_\_

Reviewer \_\_\_\_\_

Date \_\_\_\_\_

S - SHERDS  
 F - FLAKE  
 M - MAUL  
 H - HEARTH  
 SH - SURFACE  
     HOUSE

Site SJC-851  
 NE $\frac{1}{4}$ , SE $\frac{1}{4}$ , SW $\frac{1}{4}$   
 SEC. 25, T-26 N,  
 R-3 W Rio Arriba  
 County, NM

surveyed area

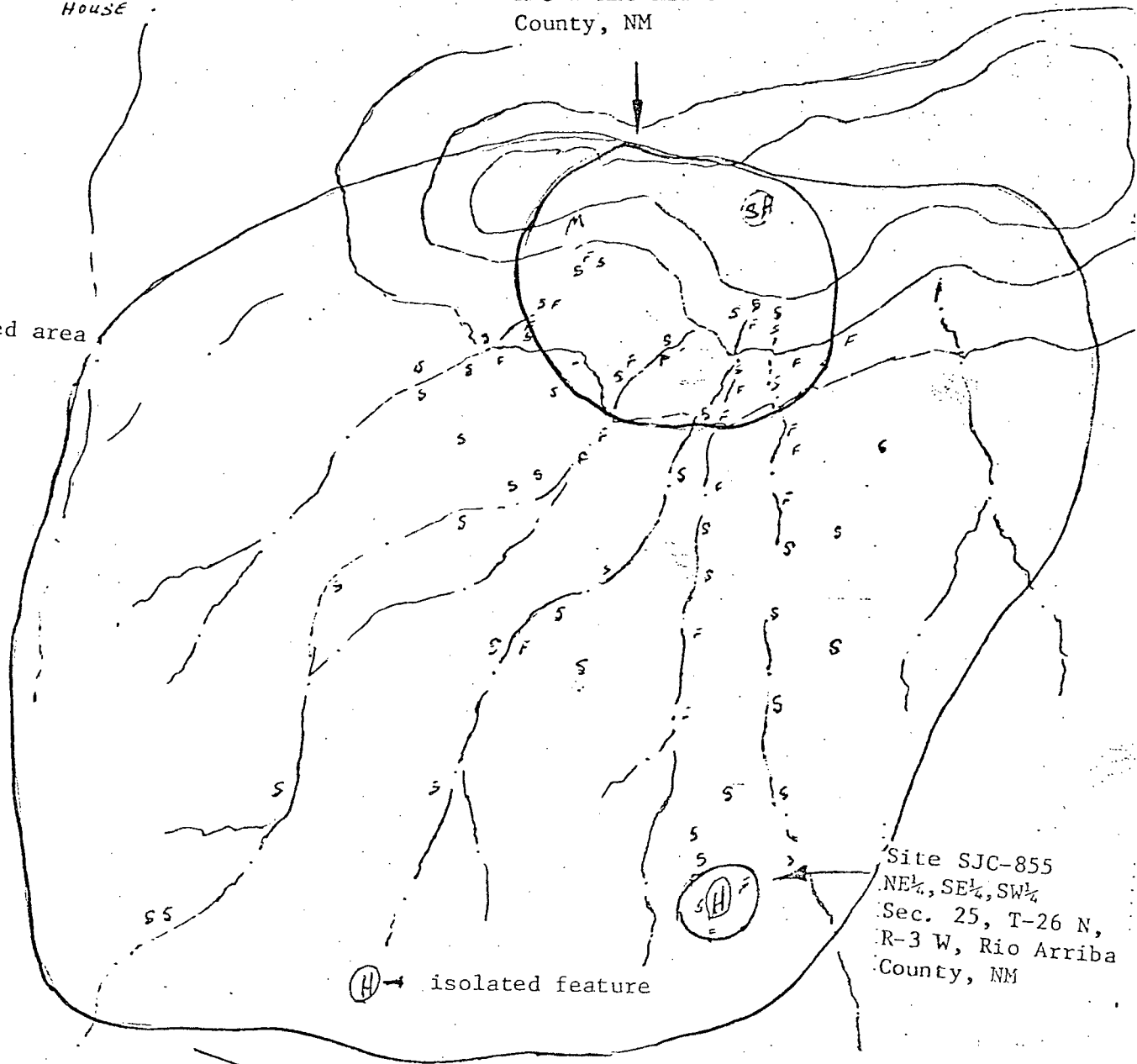

Site SJC-855  
 NE $\frac{1}{4}$ , SE $\frac{1}{4}$ , SW $\frac{1}{4}$   
 Sec. 25, T-26 N,  
 R-3 W, Rio Arriba  
 County, NM

NORTHEAST corner of  
 easement

1" = 20m

Site SJC-855 is a small hearth area and associated ceramics and lithics. The site measures approximately 8 meters by 8 meters. The primary feature of the site is a single hearth stain exposed by a small headward eroding drainage. A small area approximately 8 meters by 8 meters around the hearth stain contains a light scatter of lithic debris and ceramics.

Both painted and unpainted ceramics of the Largo-Gallina tradition occur on the site but in low frequencies. Lithic debris includes chalcedony, silicified wood and obsidian. Two fragments of a gray-veined lustrous chert corner-notched dartpoint were recovered as was the midsection of a pressure flaked obsidian biface.

A large, occupied ant hill occurs on the north edge of the hearth stain. The site is continuing to erode and cannot be expected to survive for too many more years.

This site appears to represent a small, single occupation hunting camp dating to the PII Period with a Largo-Gallina cultural affiliation. As such, the site represents an uninvestigated aspect of the Gallina settlement/subsistence system and merits avoidance. The entire site complex inspected for this location may well contain other similar examples of specialized use areas. An expanded and intensive survey of this area would probably indicate a much larger area of prehistoric use than has been described here. There is no doubt that the area was intensively occupied at least during the Largo-Gallina Phase and that this site is but one manifestation of a wide variety of activities which occurred.

LABORATORY OF ANTHROPOLOGY, MUSEUM OF NEW MEXICO  
 ARCHEOLOGICAL SITE SURVEY FORM

LA No. \_\_\_\_\_ Site Name \_\_\_\_\_ Other Inst. # SJC-855 I.O. \_\_\_\_\_

MMH Proj. # \_\_\_\_\_ UTM: Zone 13E312080N4036080

Legal Desc. T26 N/S R3 E W Sec. 25

NE 1/4 of the SE 1/4 of the SW 1/4

Unplatted X Grant \_\_\_\_\_ Owner & Address JICARUA APACHE INDIAN RESERVATION

\*Map Reference: OSITO, N.M., (U.S.G.S.) Date: 1963 Scale: 1:24000

County RIO ARriba State New Mexico Nearest Named Drainage \_\_\_\_\_

Locational Desc.: Recognized Landmarks \_\_\_\_\_

Site Type: ? CAMPSITE

Site Size: Length 5m Width 4m Elevation (# of Feet) \_\_\_\_\_

Topographic Setting (Location & Access): \_\_\_\_\_

<input type="checkbox"/> arroyo/wash	<input type="checkbox"/> flood plain/	<input type="checkbox"/> plain/flat
<input type="checkbox"/> base of cliff	<input type="checkbox"/> valley bottom	<input type="checkbox"/> playa
<input type="checkbox"/> bench	<input type="checkbox"/> hill top	<input type="checkbox"/> ridge
<input type="checkbox"/> blowout	<input checked="" type="checkbox"/> hill slope	<input type="checkbox"/> saddle
<input type="checkbox"/> canyon rim	<input type="checkbox"/> low rise	<input type="checkbox"/> base talus slope
<input type="checkbox"/> cave	<input type="checkbox"/> mesa	<input type="checkbox"/> terrace
<input type="checkbox"/> cliff/scarp	<input type="checkbox"/> mountain	other (specify) _____
<input type="checkbox"/> constricted cyn	<input type="checkbox"/> mt. front/foothill	_____
<input type="checkbox"/> dune	<input type="checkbox"/> open canyon floor	_____

Local Vegetation PIÑON - Juniper, western Yellow Pine, OAK BRUSH, MOUNTAIN  
MARLBERRY, SAGE, SNAKEWEED, HEDGEHOG CACTUS, PRICKLY PEAR, lupine

Ecological Zone: forest \_\_\_\_\_ woodland X scrubland \_\_\_\_\_ grassland \_\_\_\_\_  
 desertscrub \_\_\_\_\_ marshland \_\_\_\_\_ other (specify) \_\_\_\_\_

\*Form must be accompanied by photocopy portion of USGS map showing T., R., scale and quad name.

Soil Type: rocky\_\_\_ gravelly\_\_\_ sandy ☒ clayey\_\_\_ other\_\_\_

Local Outcrops: sandstone ☒ shale\_\_\_ limestone\_\_\_ basalt\_\_\_ tuff\_\_\_  
other (specify) \_\_\_\_\_

Nature and Depth of Fill: undetermined

Arch. Status: Amount and Type of Work Past and Present \_\_\_\_\_

National and/or State Register Status:

- ☐ On State Register
- ☐ On National and State Register
- ☐ Recommended for National by State, on State Register
- ☐ Recommended for National and State Register
- ☐ In District, National and State
- ☐ In District, National
- ☐ In District, State
- ☐ Recommended and rejected
- ☒ Insufficiently evaluated, potential unknown
- ☐ Not nominated

Condition of Site: intact\_\_\_ grazed ☒ eroded ☒ mech. disturbance\_\_\_  
vandalized\_\_\_ other \_\_\_\_\_

Mitigation: avoid\_\_\_ monitor ☒ test\_\_\_ excavate\_\_\_ not required\_\_\_

Surveyed for proposed well location

Record Form: Surv. Forms ☒ Excav. Forms\_\_\_ Sketch Map\_\_\_ Photos\_\_\_

Loc. of Forms, Maps, Photos Cultural Resource Mgt. Prog., San Juan College

FARMINGTON  
Surface and/or Subsurface Collections: yes ☒ no\_\_\_ Strategy search

2 bags of chert corner-notched dart points, midsection of obsidian knives

Location of Collected Artifacts SJC - CRMP

Previous Collections? ☒ When \_\_\_\_\_ Repository \_\_\_\_\_

Is there another site close by? yes LA or Field Identif.# SJC-651

Artifact Density: 0, 10's, 100's, 1000's. 2/m<sup>2</sup>

Time Diagnostic Artifacts: ceramics

large-bellied 950-1275

No. of Temporal Components 1

(Earliest to Latest)

Temporal Component (1)

Features HeARTH - lithic & SHERO SCATTERCulture ANASAZI Period Pueblo Phase Large Y. HingSite Function: Camp. ng Best Date 950 - 1275 ADMethod of Date: Ceramics

Temporal Component (2)

Features \_\_\_\_\_

Culture \_\_\_\_\_ Period \_\_\_\_\_ Phase \_\_\_\_\_

Site Function \_\_\_\_\_ Best Date \_\_\_\_\_

Method of Date \_\_\_\_\_

Temporal Component (3)

Features \_\_\_\_\_

Culture \_\_\_\_\_ Period \_\_\_\_\_

Phase \_\_\_\_\_

Site Function \_\_\_\_\_ Best Date \_\_\_\_\_

Method of Date \_\_\_\_\_

Additional Temporal Components

\_\_\_\_\_

stitution \_\_\_\_\_

Author and Title \_\_\_\_\_

marks: \_\_\_\_\_

Old Recorder \_\_\_\_\_ Date \_\_\_\_\_

Recorder \_\_\_\_\_ Date \_\_\_\_\_

S - SHERDS  
 F - FLAKE  
 M - MAUL  
 H - HEARTH  
 SH - SURFACE  
     HOUSE

Site SJC-851  
 NE $\frac{1}{4}$ , SE $\frac{1}{4}$ , SW $\frac{1}{4}$   
 SEC. 25, T-26 N,  
 R-3 W Rio Arriba  
 County, NM

surveyed area

(H) → isolated feature

Site SJC-855  
 NE $\frac{1}{4}$ , SE $\frac{1}{4}$ , SW $\frac{1}{4}$   
 Sec. 25, T-26 N,  
 R-3 W, Rio Arriba  
 County, NM

NORTHEAST corner of  
 easement

1" = 20 M

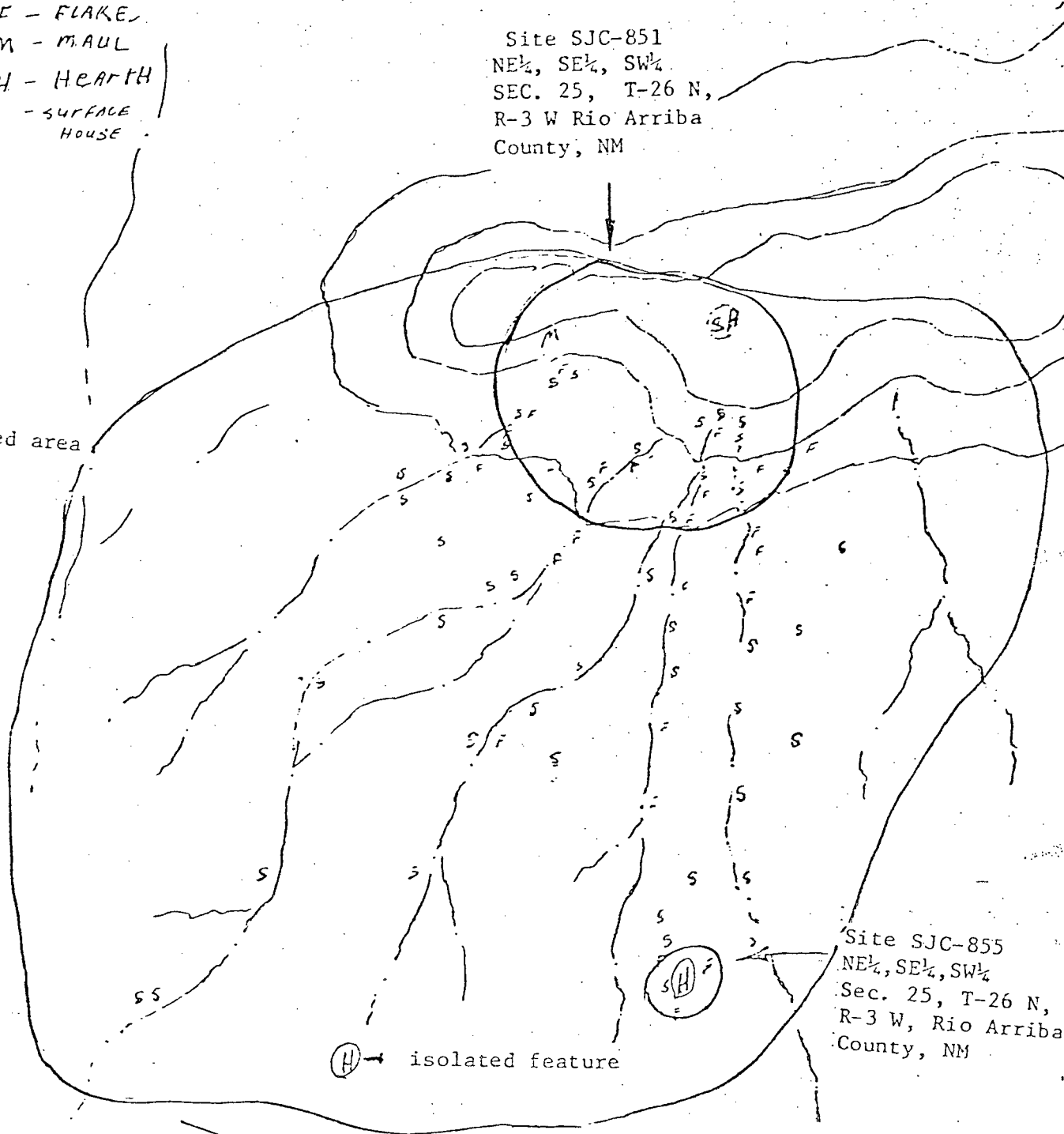

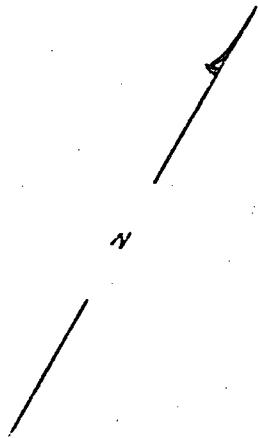

S  
S  
S

F  
S S  
F F  
S F

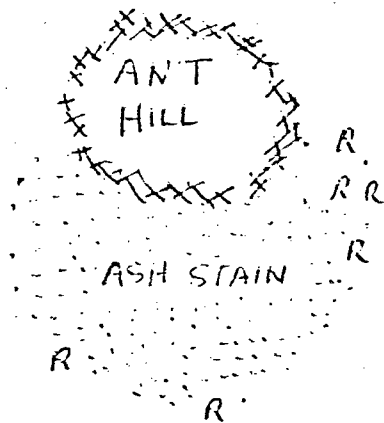

S - SHERDS  
F - FLAKE  
R - FIRE BURNED  
ROCK

S S  
S  
S

1" = 1 METRE

Site SJC-855  
NE $\frac{1}{4}$ , SE $\frac{1}{4}$ , SW $\frac{1}{4}$   
Sec. 25, T-26 N,  
R-3 E, Rio Arriba  
County, NM

## RECOMMENDATIONS

Archaeological clearance is recommended for Amoco Production wells Jicarilla Apache 102 #31 and Jicarilla Apache A118 #7, with the stipulation that an archaeologist be present during the construction of the Jicarilla Apache A118 #7.

## BIBLIOGRAPHY

- Maker, H.J., J.J. Folks, J.U. Anderson and V.G. Link  
1973 Soil Associations and Land Classification for Irrigation,  
Rio Arriba County, Agricultural Experiment Station, Research  
Report 254, New Mexico State University, Las Cruces.
- O'Neill, Mike  
1982 Personal communication, Bureau of Land Management, Farmington  
Resource Area Paleontologist.

APPENDIX

Isolated Artifact Form

Report Numbers (~~BLM~~)Survey: SJC-82-SJC-137

Mitigation/Study:

CULTURAL RESOURCES IDENTIFICATION RECORD  
ISOLATED ARTIFACT FORM

## I. REFERENCE DATA

- 1) ID # (BLM) \_\_\_\_\_ 2) PU ID (BLM) \_\_\_\_\_ 3) Other # 82-SJC-137  
 4) Location: NE 1/4 SE 1/4 SW 1/4, Sec 25 T 26 R 3 Map QUITO, N. MEX USGS  
 5) UTM: Zone 13 Easting x312050 Northing x4035980  
 6) Geographic Coordinates: Lat. North 0 " Long. West 0 "  
 7) # Associated Forms \_\_\_\_\_ 8) Artifact Collected: Yes \_\_\_\_\_ No X  
 9) Graphic File ID (BLM) \_\_\_\_\_ 10) Accession/Cat. ID (BLM) \_\_\_\_\_  
 11) Depository (BLM): Institution CRMP SAN JUAN College  
 City FARMINGTON N. Mex  
 State N. Mex

## II. ENVIRONMENTAL DATA

- 1) Habitat Zone (BLM) \_\_\_\_\_ 2) Vegetation WESTERN YELLOW PINE, PINON, SAGE.  
 3) Major Soil Class SANDY CLAY LOAM 4) Arable Land/Soils \_\_\_\_\_  
 5) Elevation \_\_\_\_\_ 6) Land Form SLOPE  
 7) Water Sources:

	P	I	F
<u>INDIAN LAKE - MAN-MADE RESERVOIR</u>		X	

8) Additional Comments:

## III. CULTURAL DATA

- 1) Cultural Affiliation LARSO-GALLERIA 2) Time Circa 950-1250 BC/AD  
 3) Feature/Artifact Type:

CHARCOAL STAIN - POSSIBLE HEARTH. APPROXIMATELY 80 METERS  
 NE OF WELL STAKE OR 25 METERS FROM NE CORNER OF  
 LOCATION. CHARCOAL STAIN APPROXIMATELY 50 CM. IN DIAMETER.

4) Inferred Function:

IV. NARRATIVE - NO CULTURAL MATERIAL OBSERVED ON SURFACE IN ASSOCIATION  
 WITH THIS FEATURE.

Field Observer/Recorder/Date

VELARDE / WATSON9/3/82Form ADO-6231-4  
(12/15/77)