

ARCO Oil and Gas Company
Permian District
Post Office Box 1610
Midland, Texas 79702
Telephone 915 684 0100

Process Immediately
NSL 1600
Rule 104F

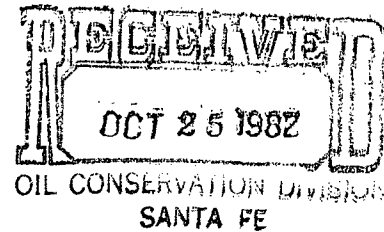

October 20, 1982



Mr. Joe D. Ramey
New Mexico Oil Conservation Commission
P. O. Box 2088
Santa Fe, New Mexico 87501

Dear Mr. Ramey:

2500 FN, 1575 FW
E-32-175-34E

Unorthodox Location
State Vacuum Unit No. 22
Lea County, New Mexico

ARCO Oil and Gas Company respectfully requests administrative approval to drill its State Vacuum Unit No. 22, a producing infill well in the active waterflood unit, at an unorthodox location of 2500' FNL and 1575' FWL, Section 32, Township 17 South, Range 34 East, Lea County. The well is to be drilled to a TD of 4840'. In ARCO's opinion, completion of the well at the proposed location will recover unswept secondary production that would otherwise be left behind due to premature water breakthrough in the unit. The offsetting proration units to the proposed location all fall within the State Vacuum Unit operated by ARCO and, therefore no offset operators were notified of the request. Attached for your information is a plat showing offset operators to the State Vacuum Unit as well as the proposed well location. Other pertinent data is also attached.

Your prompt approval of this request will be sincerely appreciated since we plan to spud the well by the end of October, 1982. Please advise if we can furnish any additional information concerning this request.

Sincerely yours,

J. A. Fraga
Engineer

JAF:dmm
Atts.

Xc: NMOCC - Hobbs Office

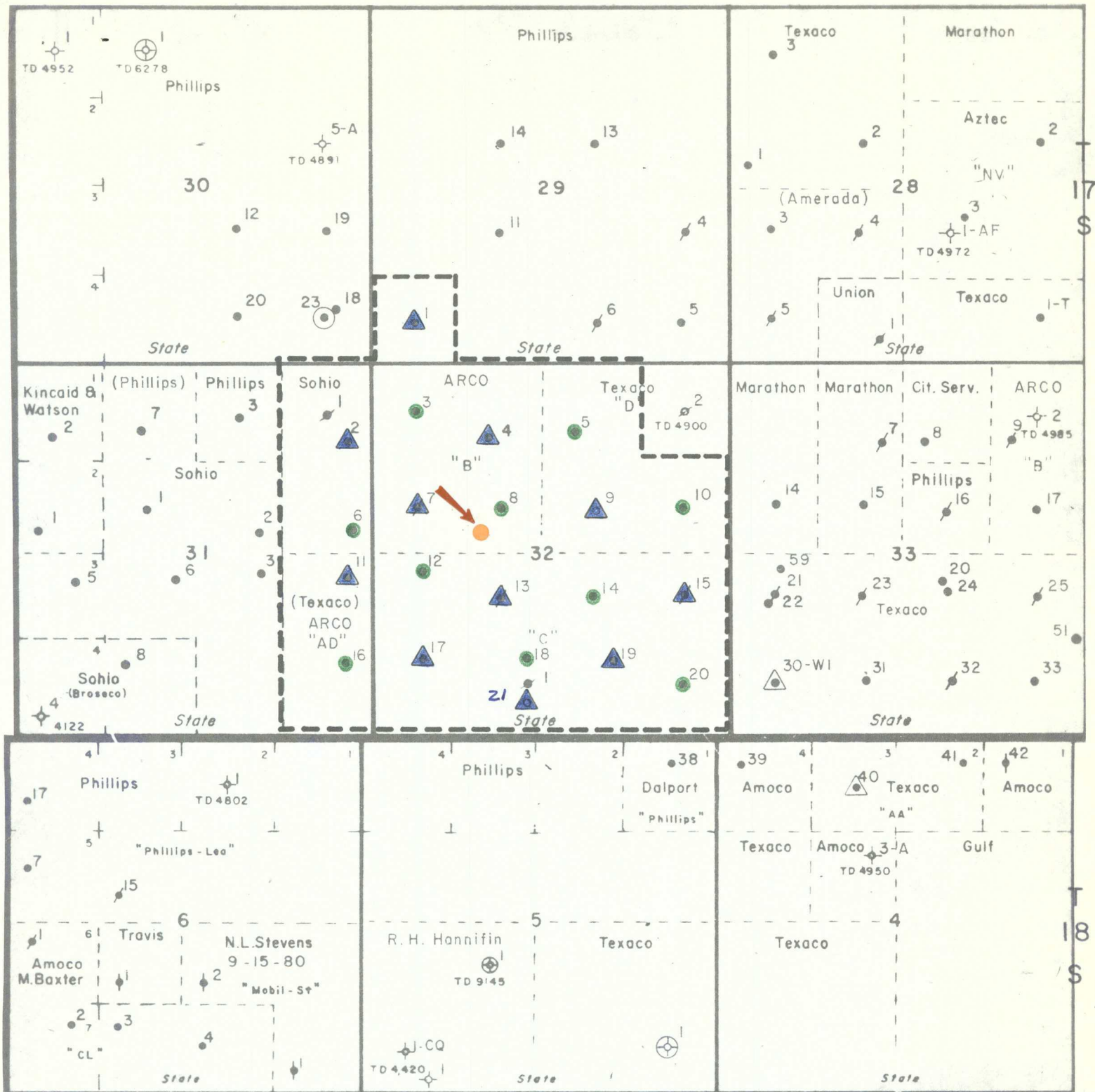

R 34 E

LEGEND

- UNIT BOUNDARY
- PRODUCER - SAN ANDRES
- ▲ INJECTOR - SAN ANDRES

ARCO Oil and Gas Company 
Division of Atlantic Richfield Company
Permian District Midland, Texas

VACUUM (GRBG.-S.A.) AREA
STATE VACUUM UNIT
 Lea County, New Mexico

Scale: 1" = 2000'

By J. A. Fraga	Drawn By TCB	Date 10-82
Date 10-20-82	Revised By	Date
Dept. West Engineering	Dwg. No.	

**NEW MEXICO OIL CONSERVATION COMMISSION
WELL LOCATION AND ACREAGE DEDICATION PLAT**

Form C-102
Supersedes C-128
Effective 1-1-65

All distances must be from the outer boundaries of the Section.

Operator ARCO OIL & GAS COMPANY			Lease STATE VACUUM UNIT		Well No. 22
Unit Letter F	Section 32	Township 17 SOUTH	Range 34 EAST	County LEA	
Actual Footage Location of Well: <div style="display: flex; justify-content: space-between;"> 2500 feet from the NORTH line and 1575 feet from the WEST line </div>					
Ground Level Elev. 4064.30	Producing Formation		Pool		Dedicated Acreage: Acres

1. Outline the acreage dedicated to the subject well by colored pencil or hachure marks on the plat below.
2. If more than one lease is dedicated to the well, outline each and identify the ownership thereof (both as to working interest and royalty).
3. If more than one lease of different ownership is dedicated to the well, have the interests of all owners been consolidated by communitization, unitization, force-pooling, etc?

☐ Yes ☐ No If answer is "yes," type of consolidation _____

If answer is "no," list the owners and tract descriptions which have actually been consolidated. (Use reverse side of this form if necessary.) _____

No allowable will be assigned to the well until all interests have been consolidated (by communitization, unitization, forced-pooling, or otherwise) or until a non-standard unit, eliminating such interests, has been approved by the Commission.

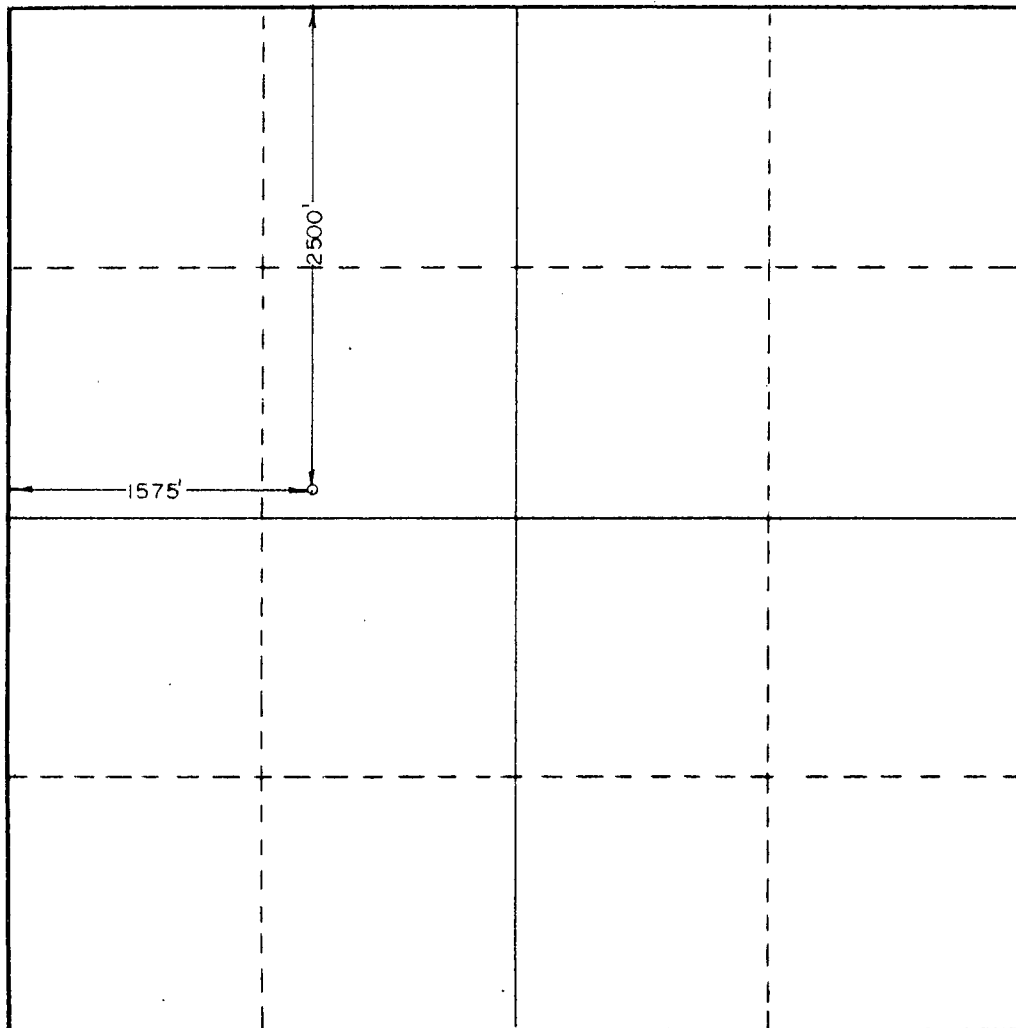

CERTIFICATION

I hereby certify that the information contained herein is true and complete to the best of my knowledge and belief.

Name _____

Position _____

Company _____

Date _____

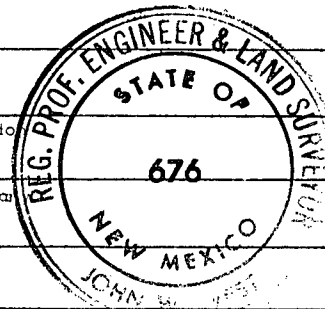

I hereby certify that the well location shown on this plat was plotted from field notes of actual surveys made by me or under my supervision, and that the same is true and correct to the best of my knowledge and belief.

Date Surveyed _____

10/13/82

Registered Professional Engineer
and/or Land Surveyor

John W. West

Certificate No. **JOHN W. WEST 676**
PATRICK A. ROMERO 6663
Ronald J. Eidson 3239

