

Mobil Producing Texas & New Mexico Inc.

NSL 1623
Rule 104 F
11-29-82
11-17-82

November 2, 1982

NINE GREENWAY PLAZA—SUITE 2700
HOUSTON, TEXAS 77046

State of New Mexico (3)
Energy and Minerals Department
Oil Conservation Division
P.O. Box 2088
Santa Fe, New Mexico 87501

Attn: Mr. Joe D. Ramsey

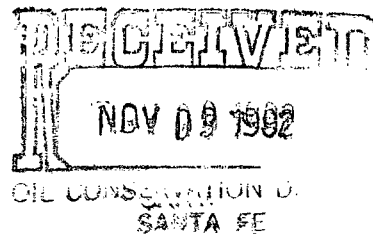

7.01

UNORTHODOX WELL LOCATION
MOBIL PRODUCING TX. & N.M. INC.
HUMPHREY QUEEN UNIT, WELL #31
LANGLIE-MATTIX POOL
LEA COUNTY, NEW MEXICO

Gentlemen:

Under the provisions of Rule 104 F.I. Mobil Producing TX & N.M. Inc. (MPTM) requests authority to drill the subject well as a water injection well at the following location:

In Proration Unit N,
1300 ft. from the South line,
1750 ft. from the West line
Sec. 3, T255, R37E
Lea County, New Mexico.

The Humphrey Queen unit was approved as a waterflood project by the Commission September 4, 1969 (Case #9204 - Order #R-3824) and has been active since that time. A well at the location shown above is necessary to complete the existing secondary recovery pattern, improve waterflood areal sweep, and to gain additional knowledge of reservoir parameters by obtaining log and core information.

In support of this request the following documents are submitted:

1. Plat of Humphrey Queen Unit showing offset information.
2. Form C-101
3. Form C-102

Mobil

State of New Mexico
November 2, 1982
Page 2

Gulf Oil Corporation is the only offset operator with a proration unit offsetting the unit on which the subject well is located. Gulf is being sent a copy of this letter and attachments, by certified mail, as their notice of this application and request for their waiver.

An application to inject water into this well will be filed at a later date.

Yours very truly,

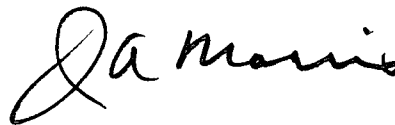

J. A. Morris

ADBond/sf

Attachments

cc: District 1-Hobbs (w/attach.)

Gulf Exploration and Production Co.
P.O. Box 1150
Midland, TX 79702

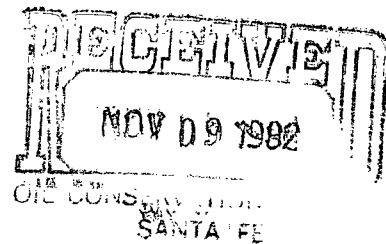

NSC
1423

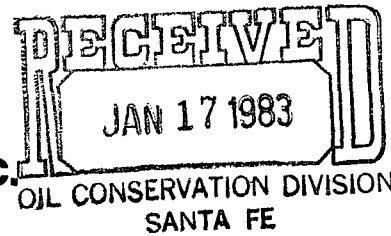

Mobil Producing Texas & New Mexico Inc.

January 6, 1983

NINE GREENWAY PLAZA—SUITE 2700
HOUSTON, TEXAS 77046

Gulf Exploration and Production Co.
P.O. Box 1150
Midland, TX 79702

Attention Mr. J.R. Frank

Waiver

7.01
UNORTHODOX WELL LOCATION
MOBIL PRODUCING TX. & N.M. INC.
HUMPRHEY QUEEN UNIT, WELL #31
LANGLIE-MATTIX QUEEN POOL
LEA COUNTY, NEW MEXICO

Gentlemen:

Gulf Exploration & Production Co. recently (Nov. 10, 1982) waived objection to Mobil Producing TX. & N.M. Inc. drilling the subject well as an injection well at an unorthodox location. The possibility exists (pending results of a swab test) that we will want to produce this well for an indefinite period of time, then convert it to an injector.

If Gulf has no objection to Mobil completing this well as a producer, as outlined, please sign in the space provided below as evidence of same.

Please return one copy to us and forward one copy to the Oil Conservation Division in Santa Fe. Addressed, stamped envelopes are enclosed for this purpose.

Location: 1300' FSL & 1750' FWL,
of Sec. 3, Unit N, T25S, R37E,
Lea County, New Mexico

Very truly yours,

J. A. Morris

ADB/ec

J.A. Morris
Regulatory Engineering Supervisor

cc: Oil Conservation Division - Santa Fe
Attn. Mr. Richard Stamets

No objection.

Gulf Oil Corporation

J. R. Frank
Signature
Chief Proration Engineer

January 14-1983

Date

**NEW MEXICO OIL CONSERVATION COMMISSION
WELL LOCATION AND ACREAGE DEDICATION PLAT**

Form C-102
Supersedes C-128
Effective 1-1-65

All distances must be from the outer boundaries of the Section.

Operator Mobil Producing Texas & New Mexico Inc			Lease Humphrey Queen Unit		Well No. 31
Unit Letter N	Section 3	Township 25S	Range 37E	County Lea	
Actual Footage Location of Well: 1300 feet from the South line and 1750 feet from the West line					
Ground Level Elev. 3140	Producing Formation Queen		Pool Langlie-Mattix		Dedicated Acreage: 40 acres (2 wells) <small>Acres</small>

1. Outline the acreage dedicated to the subject well by colored pencil or hachure marks on the plat below.
2. If more than one lease is dedicated to the well, outline each and identify the ownership thereof (both as to working interest and royalty).
3. If more than one lease of different ownership is dedicated to the well, have the interests of all owners been consolidated by communitization, unitization, force-pooling, etc?

☒ Yes ☐ No If answer is "yes," type of consolidation Unitization

If answer is "no," list the owners and tract descriptions which have actually been consolidated. (Use reverse side of this form if necessary.) _____

No allowable will be assigned to the well until all interests have been consolidated (by communitization, unitization, forced-pooling, or otherwise) or until a non-standard unit, eliminating such interests, has been approved by the Commission.

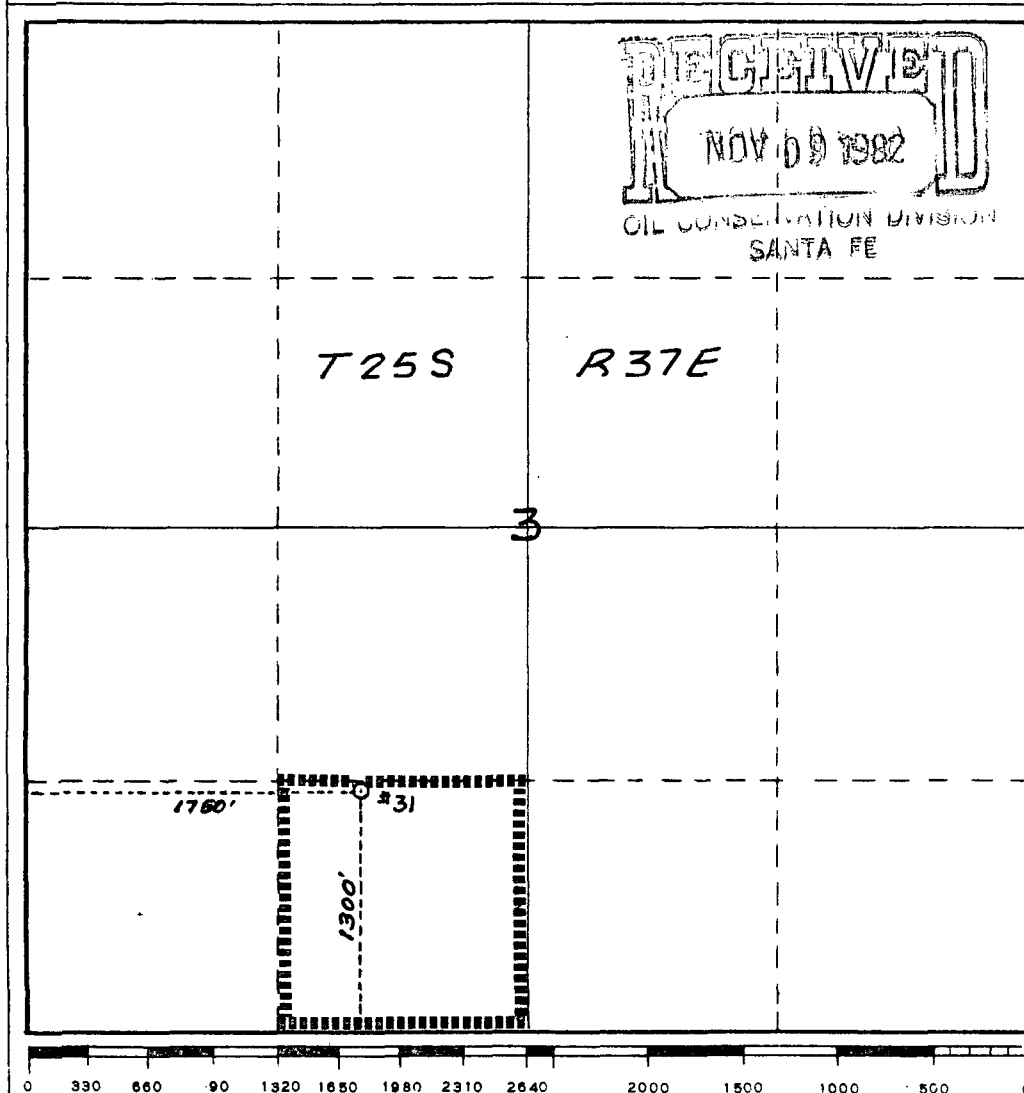

CERTIFICATION

I hereby certify that the information contained herein is true and complete to the best of my knowledge and belief.

A. D. Bond
 Name _____
 Position A. D. Bond
Regulatory Engineering Coordinator
 Company Mobil
Producing Texas & New Mexico Inc
 Date November 3, 1982

I hereby certify that the well location shown on this plat was plotted from field notes of actual surveys made by me or under my supervision, and that the same is true and correct to the best of my knowledge and belief.

H. A. Carson, Jr.
 Date Surveyed 11-1-82
 Registered Professional Engineer and/or Land Surveyor
H. A. Carson, Jr.

Certificate No. _____

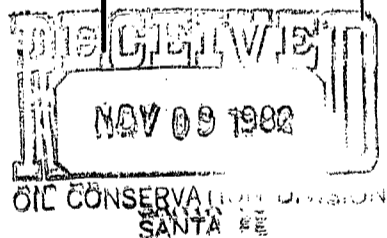
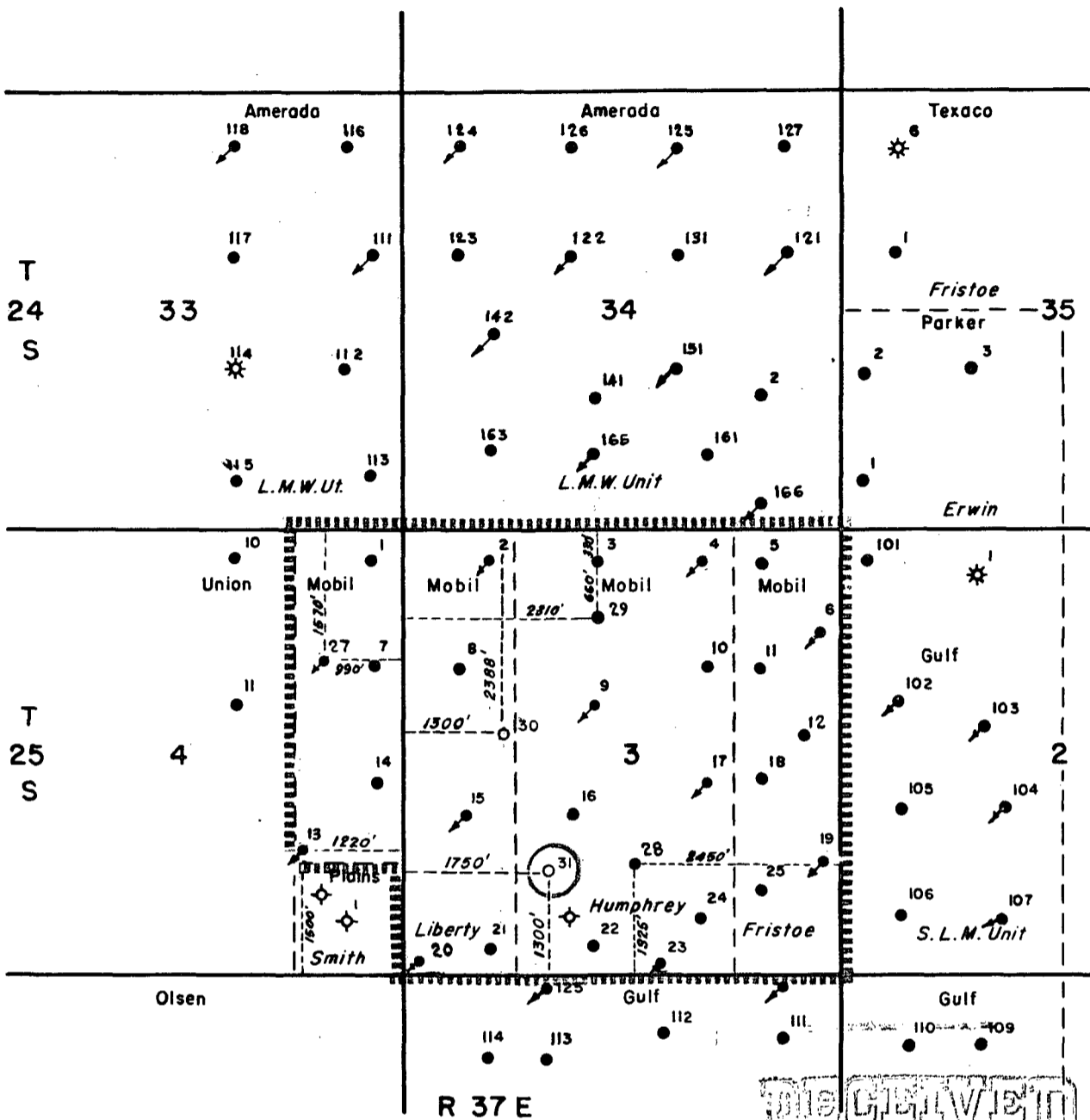

Reserve _____ Permit depth _____

Special Instructions _____

Date work is commenced _____ 19 _____ Supt. _____

Location approved by _____ Plat by _____ Surveyed by _____

THE STATE OF TEXAS
COUNTY OF MIDLAND

I hereby certify that this plat truly represents conditions as they actually exist on this lease; that said plat which is drawn to the scale indicated hereon, is to the best of my knowledge true and correct; that it accurately shows said lease with all wells on same; that number and locations of said wells are as indicated hereon; and that this plat correctly reflects all pertinent and required data.

AD Board 11-3-82

Mobil Producing Texas & New Mexico Inc. Houston, Texas

LEASE HUMPHREY QUEEN UNIT
WELL NO. *31* DATE _____ 19 _____
DIVISION _____ LEASE NO. NM _____
TOTAL ACRES IN LEASE 761.25 ACRES COVERED BY PLAT 761.25
DESCRIPTION All of Sec. 3, E/2 NE/4 & NE/4 SE/4 Sec. 4,
T25S, R37E

Lea County, New Mexico

DRAWN T. Ray DATE _____ FIELD Langlie-Mottix
SCALE 1" = 2000' FILE NO. 63

W A I V E R

State of New Mexico
Energy & Minerals Department
Oil Conservation Division
State Land Office Building
P. O. Box 2088
Santa Fe, New Mexico 87501

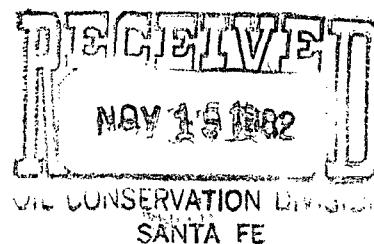

UNORTHODOX LOCATION
MOBIL PRODUCING TEXAS & NEW MEXICO INC.
HUMPHREY QUEEN UNIT, WELL #31
WATER INJECTION WELL
LANGLIE-MATTIX QUEEN POOL
LEA COUNTY, NEW MEXICO

Gentlemen:

Gulf Oil Exploration and Production Co. has been notified by Mobil Producing Texas & New Mexico Inc. (MPTM) of their application to drill the subject well as a water injection well at an unorthodox location. Please be advised that Gulf Oil Exploration and Production Co. as an offset operator to Mobil's Humphrey Queen Unit, has no objection to the New Mexico Oil Conservation Division approving MPTM's application to drill this well at the following location:

In Unit N, 1300 ft. from the south line, 1750 ft. from the west line, Sec. 3, T25S, R37E, Lea County, New Mexico.

Yours very truly,

GULF OIL CORPORATION

By JR Frank
J. R. Frank

Position
or Title Chief Proration Engineer

Date November 10, 1982