

OIL CONSERVATION DIVISION
SANTA FE

Amoco Production Company (USA)
Post Office Box 68
Hobbs, New Mexico 88240

S. J. Okerson
District Superintendent

April 20, 1983

File: SJ0-737-WF

Re: Request for Administrative Approval
Unorthodox Location
Heller Company Trust Com "A" Well No. 1
NW/4 Section 24, T-20-S, R-35-E
Lea County, New Mexico

*NSL 1689
NW/4 160-acre gas
dedication in Wolfcamp?
Rule 104 F
5-22-83*

State of New Mexico
Energy and Minerals Department
Oil Conservation Division
P. O. Box 2088
Santa Fe, NM 87501

Attention: Mr. Joe D. Ramey

Gentlemen:

Amoco Production Company hereby makes application for Administrative Approval of an unorthodox gas well location under the provisions stipulated in Statewide Rule 104(F). The following is presented in support thereof:

1. Amoco seeks approval of unorthodox gas well location for its Heller Company Trust Com "A" Well No. 1, which is proposed to be drilled 2180' FNI x 660' FWL of Section 24, Township 20-South, Range 35-East in Lea County, New Mexico.
2. The subject well is proposed as a dual completion to test the Southeast Lea-Wolfcamp Gas Formation and the Osudo, West Morrow Formation. This location is orthodox for the Morrow and we have received an approved permit to drill and complete in the Morrow. The Wolfcamp is unorthodox. *Pool*
3. Amoco proposes to dedicate the Northwest quarter of Section 24 to the subject well to form a uniform 160 acre proration unit.
4. The necessity of the subject location is due to topographical conditions which are presented on the attached Form C-102. An orthodox location is obstructed by a buried high pressure pipe line.

5. In support of this application, the following exhibits are attached:
 - a. Exhibit No. 1 is a plat depicting the ownership of all leases and wells completed offsetting the subject spacing proration lease.
 - b. Exhibit No. 2 is a certified Form C-102 showing the surveyed well location and proposed spacing.
 - c. Exhibit No. 3 is a list of all the operators of proration or spacing units offsetting the subject well.
6. Amoco, as Applicant, certifies that as of the date of this application, notification of the same was forwarded by certified mail to each offset operator listed in Exhibit No. 3. Therefore, the Applicant requests that action be taken on this application, if no objection is entered by an offset operator within 20 days of receipt.

In summary, Amoco Production Company hereby requests Administrative Approval for an unorthodox gas well location in the Northwest quarter of Section 24, Township 20-S, Range 35-E, of Lea County, New Mexico for a Southeast Lea-Wolfcamp test.

If there are any questions concerning this matter, please contact Charles Herring (505/393-1781) in our Hobbs Office.

Yours very truly,

D. J. O'Keefe *for*

Attachments

cc: State of New Mexico
Energy and Minerals Department
Oil Conservation Division
P. O. Box 1980
Hobbs, NM 88240

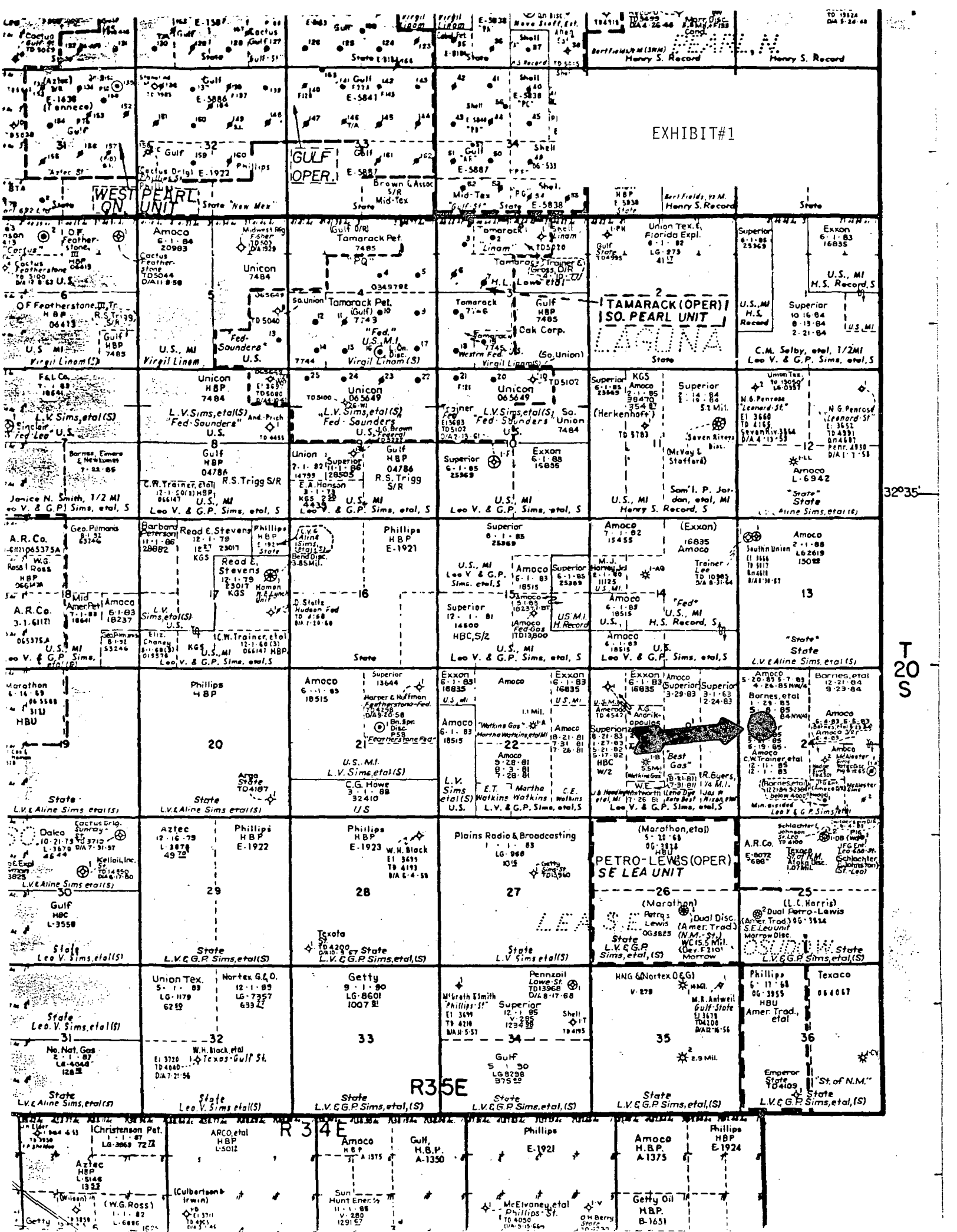

NEW MEXICO OIL CON
WELL LOCATION AND AI

EXHIBIT

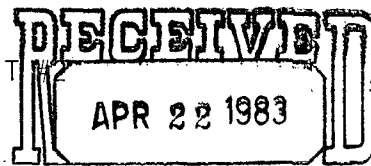

Form C-102
Supersedes C-128
Effective 1-1-65

All distances must be from the

Operator Amoco Production Co.		Lease Heller Co. Trust Com. SANTA FE		OIL CONSERVATION DIVISION 1
Unit Letter E	Section 24	Township 20 South	Range 35 East	County Lea
Actual Footage Location of Well: 2180 feet from the north line and 660 feet from the west line				
Ground Level Elev. 3666.8'	Producing Formation Wolfcamp	Pool Lea Wolfcamp, Southeast	Dedicated Acreage: 160 Acres	

1. Outline the acreage dedicated to the subject well by colored pencil or hachure marks on the plat below.
2. If more than one lease is dedicated to the well, outline each and identify the ownership thereof (both as to working interest and royalty).
3. If more than one lease of different ownership is dedicated to the well, have the interests of all owners been consolidated by communitization, unitization, force-pooling, etc?

☒ Yes ☐ No If answer is "yes," type of consolidation Communitization

If answer is "no," list the owners and tract descriptions which have actually been consolidated. (Use reverse side of this form if necessary.)

No allowable will be assigned to the well until all interests have been consolidated (by communitization, unitization, forced-pooling, or otherwise) or until a non-standard unit, eliminating such interests, has been approved by the Commission.

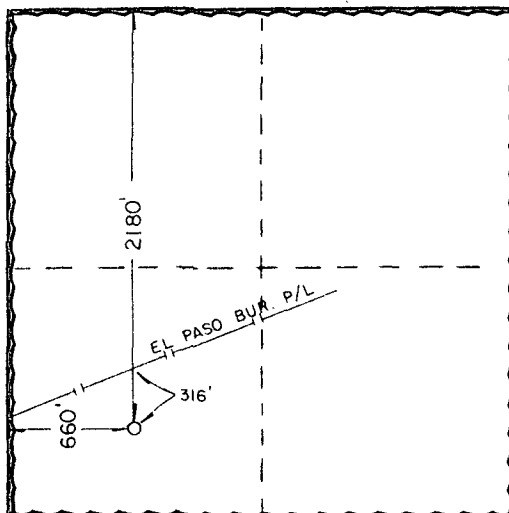

WORKING INTERESTS:
Amoco
Trainer
Superior
Barnes

NOTE: A 600' x 800' area encompassing this location was checked with an M-Scope. The only buried pipeline found is the one shown herein.

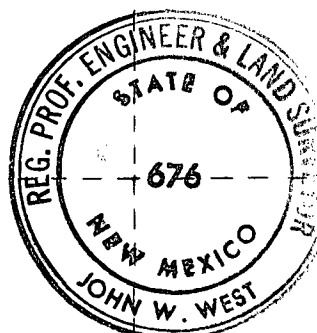

CERTIFICATION

I hereby certify that the information contained herein is true and complete to the best of my knowledge and belief.

Charles M. Herring
Position
Assist. Admin. Analyst

Company
Amoco Production Company

Date
April 14, 1983

I hereby certify that the well location shown on this plat was plotted from field notes of actual surveys made by me or under my supervision, and that the same is true and correct to the best of my knowledge and belief.

Date Surveyed
March 30, 1983

Registered Professional Engineer and/or Land Surveyor

Certificate No.
John W. West, NM L.S. 676

0 330 660 990 1320 1650 1980 2310 2640 2970 3300 3630 3960 4290 4620 4950 5280 5610 5940 6270 6600

Sam.

OFFSET OPERATORS

JFG Enterprises
P. O. Box 100
Artesia, NM 88210

Barnes, Eimers, and Newkumet
P. O. Box 3758
Midland, TX 79701

Superior Oil Company
P. O. Box 1900
Midland, TX 79702

P 267 164 368
RECEIPT FOR CERTIFIED MAIL

NO INSURANCE COVERAGE PROVIDED—
NOT FOR INTERNATIONAL MAIL
(See Reverse)

SENT TO		JFG Enterprises	
STREET AND NO.		P.O. Box 100	
P.O., STATE AND ZIP CODE		Artesia, NM 88210	
POSTAGE		\$.54	
CONSULT POSTMASTER FOR FEES	CERTIFIED FEE	.75¢	
	SPECIAL DELIVERY	¢	
	RESTRICTED DELIVERY	¢	
	OPTIONAL SERVICES		
	RETURN RECEIPT SERVICE		
	SHOW TO WHOM AND DATE DELIVERED	.60¢	
	SHOW TO WHOM, DATE, AND ADDRESS OF DELIVERY	¢	
SHOW TO WHOM AND DATE DELIVERED WITH RESTRICTED DELIVERY	¢		
SHOW TO WHOM, DATE AND ADDRESS OF DELIVERY WITH RESTRICTED DELIVERY	¢		
TOTAL POSTAGE AND FEES		\$ 1.89	
POSTMARK OR DATE			

PS Form 3800, Apr. 1976

P 267 164 367
RECEIPT FOR CERTIFIED MAIL

NO INSURANCE COVERAGE PROVIDED—
NOT FOR INTERNATIONAL MAIL
(See Reverse)

SENT TO		Superior Oil Company	
STREET AND NO.		P.O. Box 1900	
P.O., STATE AND ZIP CODE		Midland, TX 79702	
POSTAGE		\$.54	
CONSULT POSTMASTER FOR FEES	CERTIFIED FEE	.75¢	
	SPECIAL DELIVERY	¢	
	RESTRICTED DELIVERY	¢	
	OPTIONAL SERVICES		
	RETURN RECEIPT SERVICE		
	SHOW TO WHOM AND DATE DELIVERED	.60¢	
	SHOW TO WHOM, DATE, AND ADDRESS OF DELIVERY	¢	
SHOW TO WHOM AND DATE DELIVERED WITH RESTRICTED DELIVERY	¢		
SHOW TO WHOM, DATE AND ADDRESS OF DELIVERY WITH RESTRICTED DELIVERY	¢		
TOTAL POSTAGE AND FEES		\$ 1.89	
POSTMARK OR DATE			

PS Form 3800, Apr. 1976

P 267 164 366
RECEIPT FOR CERTIFIED MAIL

NO INSURANCE COVERAGE PROVIDED—
NOT FOR INTERNATIONAL MAIL
(See Reverse)

SENT TO		Barnes, Eimers, & Newkumet	
STREET AND NO.		P.O. Box 3758	
P.O., STATE AND ZIP CODE		Midland, TX 79701	
POSTAGE		\$.54	
CONSULT POSTMASTER FOR FEES	CERTIFIED FEE	.75¢	
	SPECIAL DELIVERY	¢	
	RESTRICTED DELIVERY	¢	
	OPTIONAL SERVICES		
	RETURN RECEIPT SERVICE		
	SHOW TO WHOM AND DATE DELIVERED	.60¢	
	SHOW TO WHOM, DATE, AND ADDRESS OF DELIVERY	¢	
SHOW TO WHOM AND DATE DELIVERED WITH RESTRICTED DELIVERY	¢		
SHOW TO WHOM, DATE AND ADDRESS OF DELIVERY WITH RESTRICTED DELIVERY	¢		
TOTAL POSTAGE AND FEES		\$ 1.89	
POSTMARK OR DATE			

PS Form 3800, Apr. 1976

J. D. Barnes
D. J. Eimers
A. W. Newkumet

BARNES, EIMERS & NEWKUMET

OIL & GAS EXPLORATION

P.O. BOX 3758

MIDLAND, TEXAS 79702

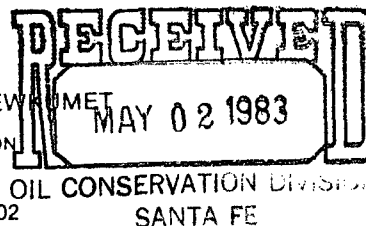

Telephone (915) 682-6231

April 27, 1983

Amoco Production Company (USA)
Post Office Box 68
Hobbs, New Mexico 88240

Attention: S. J. Okerson

Re: Heller Company Trust Fom "A" Well No. 1
Southeast Lea-Wolfcamp
2180' FNL & 660' FWL
Section 24, T-20-S, R-35-E
Lea County, New Mexico

Gentlemen:

Enclosed for your information is a copy of letter dated April 20, 1983, from you to us requesting approval of an unorthodox location at the above location. This letter has been signed by us and is returned to you for your further handling. Also enclosed are well information sheets.

Please note that a copy of same is being forwarded to each of the NMOCD offices listed in said letter.

Yours very truly,

Sheila A. Matlock

Sheila A. Matlock
Land Assistant

Enclosures

cc: NMOCD ✓
Box 2088
Santa Fe, NM 87501

NMOCD
1000 W. Broadway
Hobbs, NM 88240

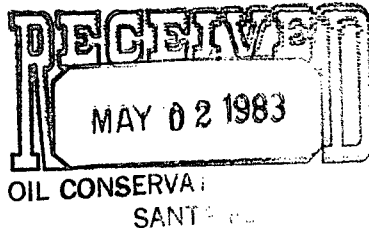

Amoco Production Company (USA)

Post Office Box 68
Hobbs, New Mexico 88240

S. J. Okerson
District Superintendent

April 20, 1983

OCD Copy

File: SJ0-738-WF

Re: Heller Company Trust Com "A" Well No. 1
Southeast Lea-Wolfcamp
2180' FNL x 660' FWL,
Section 24, T-20-S, R-35-E
Lea County, New Mexico

Barnes, Eimers, and Newkumet
P. O. Box 3758
Midland, TX 79701

Gentlemen:

As operator of the Heller Company Trust "A" Well No. 1, Amoco hereby notifies you that we have applied to the NMOC for Administrative Approval of an unorthodox location at the above location. The reason for an unorthodox location is due to topographical restrictions.

If you have no objections to the location of this well, sign below and forward one copy to the NMOC in Santa Fe, one copy to the NMOC in Hobbs, one copy to this office, and retain one copy for your own records. Addressed stamped envelopes have been provided for your convenience.

Yours very truly,

APPROVAL

S. J. Okerson HCR

Company: Barnes, Eimers & Newkumet

By: Wayne Newkumet

Date: 4/22/83

Attachment



Amoco Production Company (USA)

Post Office Box 68
Hobbs, New Mexico 88240

S. J. Okerson
District Superintendent

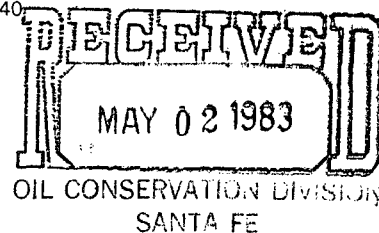

April 20, 1983

File: SJ0-738-WF

Re: Heller Company Trust Com "A" Well No. 1
Southeast Lea-Wolfcamp
2180' FNL x 660' FWL,
Section 24, T-20-S, R-35-E
Lea County, New Mexico

JFG Enterprises
P. O. Box 100
Artesia, NM 88210

Gentlemen:

As operator of the Heller Company Trust "A" Well No. 1, Amoco hereby notifies you that we have applied to the NMOCD for Administrative Approval of an unorthodox location at the above location. The reason for an unorthodox location is due to topographical restrictions.

If you have no objections to the location of this well, sign below and forward one copy to the NMOCD in Santa Fe, one copy to the NMOCD in Hobbs, one copy to this office, and retain one copy for your own records. Addressed stamped envelopes have been provided for your convenience.

Yours very truly,

APPROVAL

S. J. Okerson HCR

Company: JFG Enterprises

By: X. D. Fletcher

Date: 4-21-83

Attachment



hsl-
1689

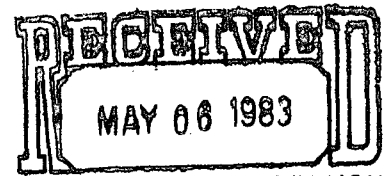

OIL CONSERVATION DIVISION

Amoco Production Company (USA)

Post Office Box 68
Hobbs, New Mexico 88240

S. J. Okerson
District Superintendent

April 20, 1983

File: SJ0-738-WF

Re: Heller Company Trust Com "A" Well No. 1
Southeast Lea-Wolfcamp
2180' FNL x 660' FWL,
Section 24, T-20-S, R-35-E
Lea County, New Mexico

Superior Oil Company
P. O. Box 1900
Midland, TX 79702

Gentlemen:

As operator of the Heller Company Trust "A" Well No. 1, Amoco hereby notifies you that we have applied to the NMOCD for Administrative Approval of an unorthodox location at the above location. The reason for an unorthodox location is due to topographical restrictions.

If you have no objections to the location of this well, sign below and forward one copy to the NMOCD in Santa Fe, one copy to the NMOCD in Hobbs, one copy to this office, and retain one copy for your own records. Addressed stamped envelopes have been provided for your convenience.

Yours very truly,

S. J. Okerson hsl

Attachment

APPROVAL

Company: THE Superior Oil Company

By: E. R. Morris

Date: 5/3/83



Amoco Production Company (USA)

Post Office Box 68
Hobbs, New Mexico 88240

S. J. Okerson
District Superintendent

April 20, 1983

File: SJ0-738-WF

Re: Heller Company Trust Com "A" Well No. 1
Southeast Lea-Wolfcamp
2180' FNL x 660' FWL,
Section 24, T-20-S, R-35-E
Lea County, New Mexico

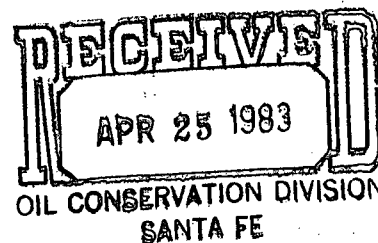

JFG Enterprises
P. O. Box 100
Artesia, NM 88210

Gentlemen:

As operator of the Heller Company Trust "A" Well No. 1, Amoco hereby notifies you that we have applied to the NMOCd for Administrative Approval of an unorthodox location at the above location. The reason for an unorthodox location is due to topographical restrictions.

If you have no objections to the location of this well, sign below and forward one copy to the NMOCd in Santa Fe, one copy to the NMOCd in Hobbs, one copy to this office, and retain one copy for your own records. Addressed stamped envelopes have been provided for your convenience.

Yours very truly,

APPROVAL

S. J. Okerson HOK

Company: JFG Enterprises

By: X. D. Fletcher

Date: 4-21-83

Attachment