



Amoco Production Company

Petroleum Center Building
501 Airport Drive
Farmington, New Mexico 87401
505-325-8841

W. J. Holcomb
District Manager

July 18, 1984

Mr. Joe D. Ramey
New Mexico Oil Conservation Division
P. O. Box 2088
Santa Fe, NM 87501

RECEIVED

JUL 20 1984

OIL CONSERVATION DIVISION

File: DDL-660-400.1

Application for Unorthodox Location
Abrams "L" No. 1

Blanco Mesaverde Field Pool
San Juan County, New Mexico

5/2 OF SEC. 26
Amoco Production Company hereby requests approval of an unorthodox well location for the Abrams "L" No. 1. The location is 330' FWL and 330' FSL of Section 26, T29N, R10W, San Juan County, New Mexico.

NSL-1861
RULE 104FI ~~AND RULE~~
~~2 OF ORDER NO. R-1670~~
Release Aug. 9, 1984

This well was originally drilled as a Gallup well and therefore the location was orthodox. Now, we would like to recompleate the Mesaverde, but the location is unorthodox for that field.

A copy of this application is being sent by certified mail to the offset lease holders, Southern Union and El Paso Natural Gas, with the request that they furnish you a waiver of objection and return one copy of the same to me.

Yours very truly,

KRJ/ct

Send to
Kathryn JONES

Attachments

cc: Mr. Ernie Bush
New Mexico Oil Conservation Division
1000 Rio Brazos Road
Aztec, NM 87410

Page 2

File: DDL-660-400.1

July 18, 1984

_____ hereby waives objection to Amoco's application
for an unorthodox location as proposed above.

BY: _____

DATE: _____

AM17

R10W

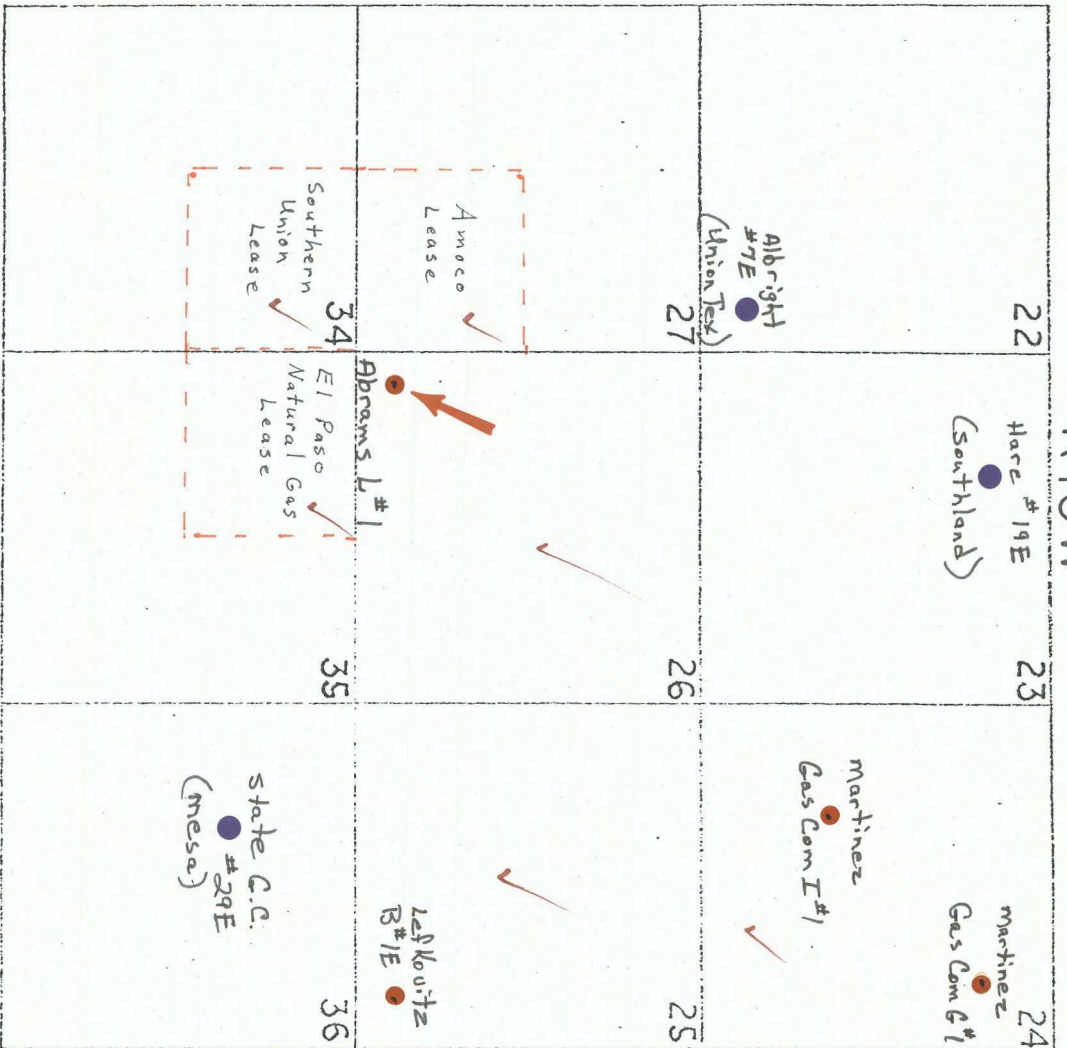

T 29 N

- PROPOSED DRILLING LOCATION
- AMOCO OPERATED
- OUTSIDE OPERATED

OIL CONSERVATION DIVISION

P. O. BOX 2088

Form C-107
Revised 10-1-7

STATE OF NEW MEXICO

SANTA FE, NEW MEXICO 87501

OIL AND MINERALS DEPARTMENT

All distances must be from the outer boundaries of the Section.

Operator AMOCO PRODUCTION COMPANY			Lease ABRAMS "L"		Well No. 1
Unit Letter M	Section 26	Township 29N	Range 10W	County San Juan	
Actual Footage Location of Well: 330 feet from the South line and 330 feet from the West line					
Ground Level Elev: 5543	Producing Formation Gallup		Pool Armenta Gallup + Blanco MV		Dedicated Acreage: 40 / 320 Acres

1. Outline the acreage dedicated to the subject well by colored pencil or hatchure marks on the plat below.
2. If more than one lease is dedicated to the well, outline each and identify the ownership thereof (both as to working interest and royalty).
3. If more than one lease of different ownership is dedicated to the well, have the interests of all owners been consolidated by communitization, unitization, force-pooling, etc?

☐ Yes ☐ No If answer is "yes," type of consolidation _____

If answer is "no," list the owners and tract descriptions which have actually been consolidated. (Use reverse side of this form if necessary.) _____

No allowable will be assigned to the well until all interests have been consolidated (by communitization, unitization, forced-pooling, or otherwise) or until a non-standard unit, eliminating such interests, has been approved by the Commission.

CERTIFICATION

I hereby certify that the information contained herein is true and complete to the best of my knowledge and belief.

Name

A. H. Shoemaker

Position

District Engineer

Company

Amoco Production Company

Date

April 14, 1983

I hereby certify that the well location shown on this plat was plotted from field notes of actual surveys made by me or under my supervision, and that the same is true and correct to the best of my knowledge and belief.

Date Surveyed

April 5, 1983

Registered Professional Engineer
and Land Surveyor

Fred B. Kerr Jr.

Certificate No.

3950

Scale: 1"=1000'



STATE OF NEW MEXICO
ENERGY AND MINERALS DEPARTMENT

OIL CONSERVATION DIVISION
AZTEC DISTRICT OFFICE

1000 RIO BRAZOS ROAD
AZTEC, NEW MEXICO 87410
(505) 334-6178

OIL CONSERVATION DIVISION
BOX 2088
SANTA FE, NEW MEXICO 87501

DATE

July 24, 1984

RE: Proposed MC _____
Proposed DHC _____
Proposed NSL X _____
Proposed SWD _____
Proposed WFX _____
Proposed PMX _____

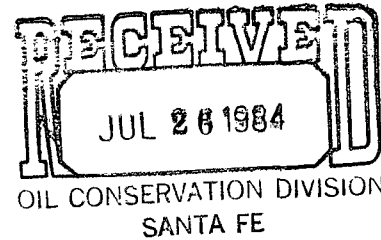

Gentlemen:

I have examined the application dated

July 18, 1984

for the

Amoco Prod. Co.

Abraha L #7

Operator

Lease and Well No.

M-26-29A-10W

Unit, S-T-R

and my recommendations are as follows:

Approve

Yours truly,

Eric S. Chy



Amoco Production Company

Petroleum Center Building
501 Airport Drive
Farmington, New Mexico 87401
505-325-8841

W. J. Holcomb
District Manager

July 18, 1984

Mr. Joe D. Ramey
New Mexico Oil Conservation Division
P. O. Box 2088
Santa Fe, NM 87501

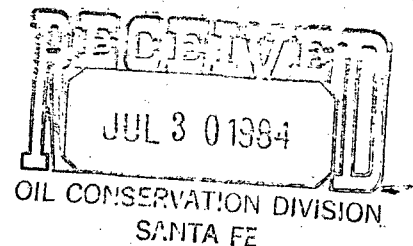

File: DDL-660-400.1

Application for Unorthodox Location
Abrams "L" No. 1
Blanco Mesaverde Field
San Juan County, New Mexico

Amoco Production Company hereby requests approval of an unorthodox well location for the Abrams "L" No. 1. The location is 330' FWL and 330' FSL of Section 26, T29N, R10W, San Juan County, New Mexico.

This well was originally drilled as a Gallup well and therefore the location was orthodox. Now, we would like to recomplete the Mesaverde, but the location is unorthodox for that field.

A copy of this application is being sent by certified mail to the offset lease holders, Southern Union and El Paso Natural Gas, with the request that they furnish you a waiver of objection and return one copy of the same to me.

Yours very truly,

Original Signed
W. J. Holcomb

KRJ/ct

Attachments

cc: Mr. Ernie Bush
New Mexico Oil Conservation Division
1000 Rio Brazos Road
Aztec, NM 87410



Page 2

File: DDL-660-400.1

July 18, 1984

El Paso Exploration Co., hereby waives objection to Amoco's application
for an unorthodox location as proposed above.

BY: Donald R. Reas

DATE: 7-26-84

AM17