

Gulf Oil Exploration and Production Company

R. C. Anderson
PRODUCTION MANAGER,
HOBBS AREA

July 12, 1984

P. O. Box 670
Hobbs, NM 88240

*State
DR*

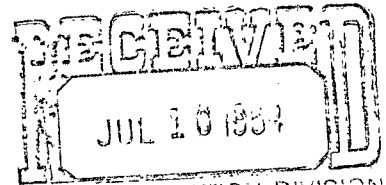

OIL CONSERVATION DIVISION
SANTA FE

Mr. R. L. Stamets, Technical Support Chief
Oil Conservation Division
P. O. Box 2088
Santa Fe, New Mexico 87501

*MSL-1863
Special Rule 104FF
Release Aug. 5, 1984
ORDER No. 8-2889*

Dear Sir:

*1/2 NE/4 of Sec. 16
dedicated*

Gulf Oil Corporation requests your administrative approval for a non-standard location for our Lea "TZ" State #5, located 1790' FNL and 900' FEL, Section 16, T19S, R35E, Lea County, NM, which Gulf proposed to complete in the Sharb Bone Springs Pool. In support of this application, the following information is submitted:

1. A plat showing the location of the well and the 80 acre proration unit (Administrative Order NSP-1210 dated 10-6-80).
2. A plat fully identifying the topography and location of an existing highway in close proximity to a standard location, thereby necessitating the moving of the location to that stated above.
3. A copy of this application has been furnished all offset operators by certified mail with the request they furnish waivers direct to your office providing they have no objection to the non-standard location.

*Scharb
dr*

If additional information is required, please advise.

Yours very truly,

R. C. Anderson
R. C. Anderson

bc:
Att'd

cc: Mesa Petroleum Co., Suite 100, Vaughn Bldg, Midland, TX 79701
J. P. Toles, Hinkle Building, Roswell, NM 88201
Depco, 1000 Petroleum Club Bldg., Denver, CO 80202
Proration Unit - Midland
Gene Cox - Midland
Oil Conservation Division, Drawer DD, Artesia, NM 88210



WELL LOCATION AND ACREAGE DEDICATION PLAT

FILE NO. 1000

All distances must be from the outer boundaries of the well.

Gulf Oil Corp.

LEA-STATE T2

5

H

16

19 SOUTH

35 EAST

LEA

1790' feet from North line and 900' from the East line

3784.0'

Bone Springs

Scharb Bone Springs

80

- Outline the acreage dedicated to the subject well by colored pencil or hatchure marks on the plat below.
- If more than one lease is dedicated to the well, outline each and identify the ownership thereof (such as to working interest and royalty).
- If more than one lease of different ownership is dedicated to the well, have the interests of all owners been consolidated by communitization, unitization, force-pooling, etc?

Yes ☐ No ☐ If answer is "yes" type of consolidation

If answer is "no" list the owners and tract descriptions which have actually been consolidated (Use reverse side of this form if necessary.)

No allowable will be assigned to the well until all interests have been consolidated (by communitization, unitization, forced-pooling, or otherwise) or until a non-standard unit, eliminating such interests, has been approved by the Commission.

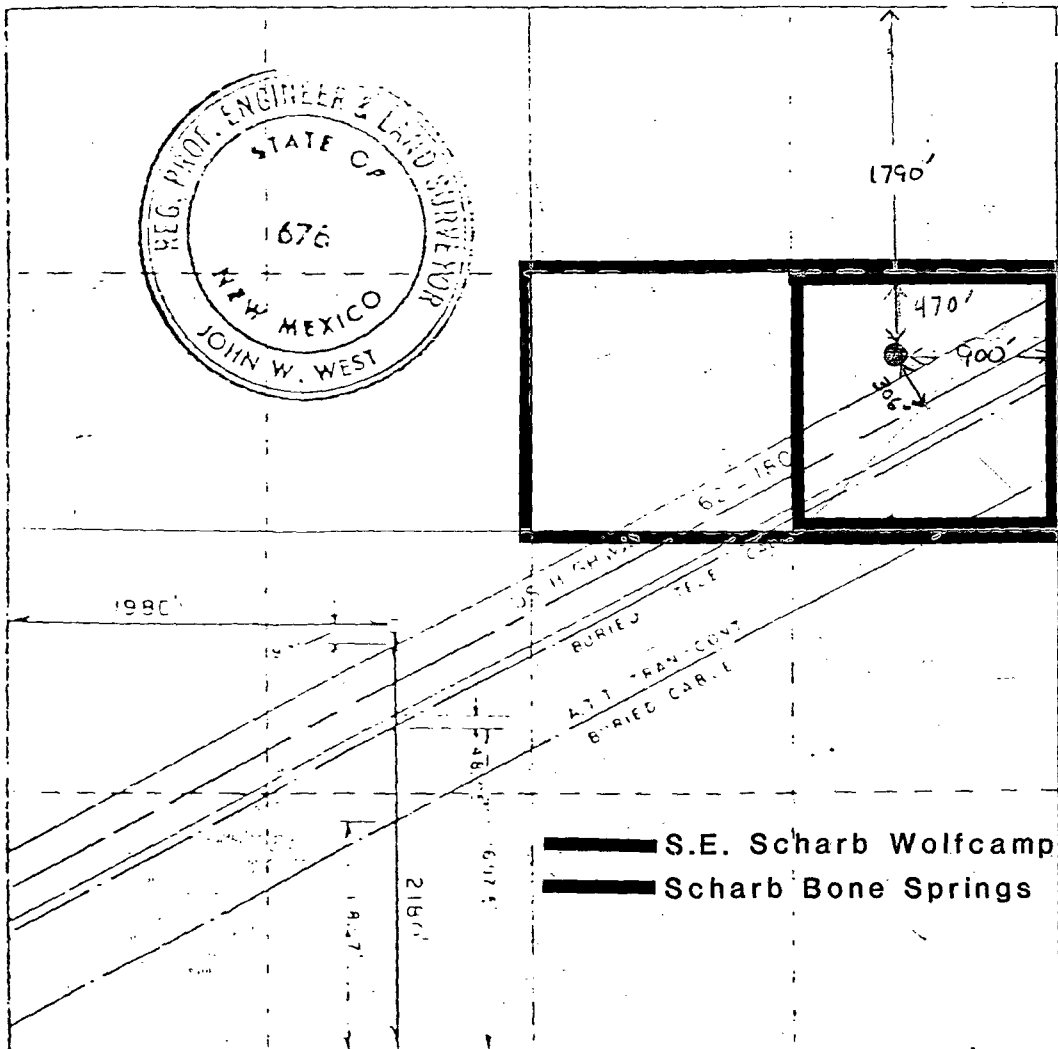

CERTIFICATION

I hereby certify that the information contained herein is true and complete to the best of my knowledge and belief.

R. C. Anderson

R. C. Anderson

Area Prod. Mgr.

Gulf Oil Corp.

7-12-84

I hereby certify that the information shown on this plat was plotted from field notes of actual surveys made by me or under my supervision and that the same is true and correct to the best of my knowledge and belief.

Date of Survey

October, 1983

Registered Professional Engineer

and Land Surveyor

John W. West

Certificate No. JOHN W. WEST.

676

RONALD J. EIDSON.

323

330 660 990 1320 1650 1980 2310 2640 2970 3300 3630 3960 4290 4620 4950 5280 5610 5940 6270 6600 6930 7260 7590 7920 8250 8580 8910 9240 9570 9900

Gulf Oil Exploration and Production Company

R. C. Anderson
PRODUCTION MANAGER,
HOBBS AREA

July 12, 1984

P. O. Box 670
Hobbs, NM 88240

CERTIFIED MAIL

Re: Application for Non-Standard
Location - Lea "TZ" #5

Amoco Production Co
Box 3092
Houston, TX 77001

Union Oil Co. of California
Box 3100
300 N Carrizo St.
Midland, TX 79701

Superior Oil Company
Box 3901
Midland, TX 79702

Gentlemen:

Attached are copies of Gulf's application for a non-standard location on subject well, together with a plat showing the area involved.

In order to expedite handling of this application by the New Mexico Oil Conservation Commission, it would be appreciated if you would sign and mail direct to the Commission one copy of the enclosed waiver. Also enclosed is a self-addressed, stamped envelope for your convenience.

Yours very truly,

R. C. ANDERSON

cc: New Mexico Oil Conservation Division
P. O. Box 2088
Santa Fe, NM 87501 - Attn: R. L. Stamets



A DIVISION OF GULF OIL CORPORATION

Mr. R. L. Stamets
Oil Conservation Division
P. O. Box 2088
Santa Fe, New Mexico 87501

WAIVER OF OBJECTION

We, as an offset operator to Gulf's Lea "TZ" #5 located 1790' FNL and 900' FEL of Section 16, 19S, R35E, Lea County, NM, do hereby waive any objection to this non-standard location.

Company

By

Title

Date

| | |
|------------------------|--|
| NO. OF COPIES RECEIVED | |
| DISTRIBUTION | |
| SANTA FE | |
| FILE | |
| U.S.G.S. | |
| LAND OFFICE | |
| OPERATOR | |

NEW MEXICO OIL CONSERVATION COMMISSION

Form C-101
Revised 1-1-65

| |
|--|
| 5A. Indicate Type of Lease STATE <input checked="" type="checkbox"/> FEE <input type="checkbox"/> |
| 5. State Oil & Gas Lease No. LG-1630 |

APPLICATION FOR PERMIT TO DRILL, DEEPEN, OR PLUG BACK

| | | | | |
|--|--|--|---|--------------------------------|
| 1a. Type of Work b. Type of Well OIL WELL <input checked="" type="checkbox"/> GAS WELL <input type="checkbox"/> OTHER <input type="checkbox"/> SINGLE ZONE <input checked="" type="checkbox"/> MULTIPLE ZONE <input type="checkbox"/> | | DRILL <input type="checkbox"/> DEEPEN <input type="checkbox"/> PLUG BACK <input checked="" type="checkbox"/> | | 7. Unit Agreement Name |
| 2. Name of Operator Gulf Oil Corp. | | 8. Farm or Lease Name Lea "TZ" State | | 9. Well No. 5 |
| 3. Address of Operator P. O. Box 670, Hobbs, NM 88240 | | 10. Field and Pool, or Wildcat Scharb Bone Springs | | |
| 4. Location of Well UNIT LETTER H LOCATED 1790 FEET FROM THE North LINE AND 900 FEET FROM THE East LINE OF SEC. 16 TWP. 19S RGE. 35E NMPM | | 12. County Lea | | |
| 21. Elevations (Show whether DP, RT, etc.) 3784.0 GLE | | 21A. Kind & Status Plug. Bond | 19. Proposed Depth 10,990 | 19A. Formation Bone Springs |
| | | 21B. Drilling Contractor Unknown | 22. Approx. Date Work will start Aug 1, 1984 | 20. Rotary or C.T. Rotary |

PROPOSED CASING AND CEMENT PROGRAM

| SIZE OF HOLE | SIZE OF CASING | WEIGHT PER FOOT | SETTING DEPTH | SACKS OF CEMENT | EST. TOP |
|--------------|----------------|-----------------|---------------|-----------------|----------|
| | | | | | |
| | | | | | |
| | | | | | |

If well/camp zone proves to be non-productive,
set CIBP at + or - 30' above well/camp
Dips and Cap with 35' Cement. Perf and
acidize Bone Springs.

IN ABOVE SPACE DESCRIBE PROPOSED PROGRAM; IF PROPOSAL IS TO DEEPEN OR PLUG BACK, GIVE DATA ON PRESENT PRODUCTIVE ZONE AND PROPOSED NEW PRODUCTIVE ZONE. GIVE BLOWOUT PREVENTER PROGRAM, IF ANY.

I hereby certify that the information above is true and complete to the best of my knowledge and belief.

Signed L. C. Anderson Title Area Prod. Mgr Date 7-12-84
(This space for State Use)

APPROVED BY _____ TITLE _____ DATE _____
CONDITIONS OF APPROVAL, IF ANY:

**NEW MEXICO OIL CONSERVATION COMMISSION
WELL LOCATION AND ACREAGE DEDICATION PLAT**

Form C-102
Supersedes C-128
Effective 1-1-65

All distances must be from the outer boundaries of the Section

| | | | | | |
|---|--|----------------------------|------------------------------------|---------------------------------------|----------------------|
| Operator GULF OIL CO. | | | Lease LEA TZ STATE | | Well No. 5 |
| Unit Letter H | Section 16 | Township 19SOUTH | Range 35 EAST | County LEA | |
| Actual Footage Location of Well: 1790 feet from the NORTH line and 900 feet from the EAST line | | | | | |
| Ground Level Elev. 3784.0 | Producing Formation <i>Bone Springs</i> | | Pool <i>Scharb Bone Springs</i> | Dedicated Acreage: 80 Acres | |

1. Outline the acreage dedicated to the subject well by colored pencil or hachure marks on the plat below.
2. If more than one lease is dedicated to the well, outline each and identify the ownership thereof (both as to working interest and royalty).
3. If more than one lease of different ownership is dedicated to the well, have the interests of all owners been consolidated by communitization, unitization, force-pooling, etc?

☐ Yes ☐ No If answer is "yes," type of consolidation _____

If answer is "no," list the owners and tract descriptions which have actually been consolidated. (Use reverse side of this form if necessary.) _____

No allowable will be assigned to the well until all interests have been consolidated (by communitization, unitization, forced-pooling, or otherwise) or until a non-standard unit, eliminating such interests, has been approved by the Commission.

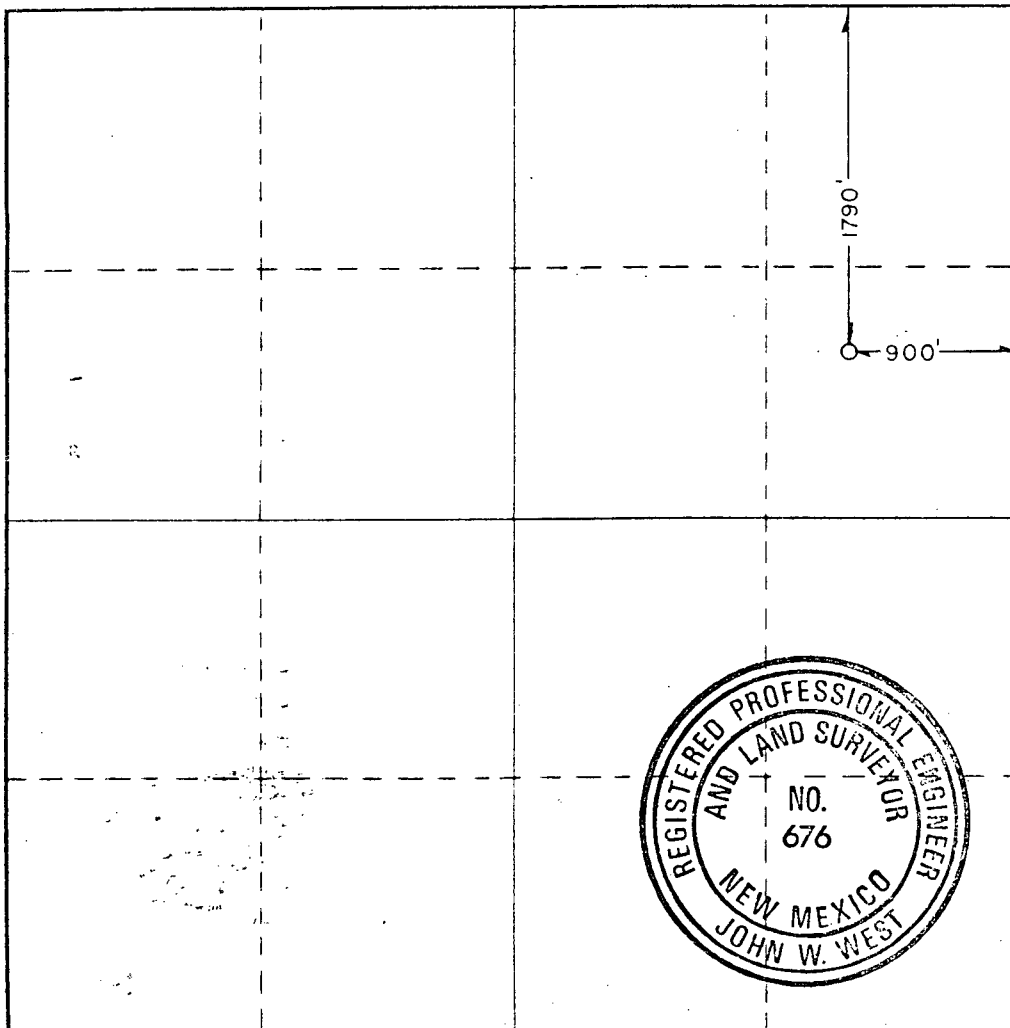

CERTIFICATION

I hereby certify that the information contained herein is true and complete to the best of my knowledge and belief.

R.C. Anderson

Name
R.C. ANDERSON
Position
Area Prod. Mgr.
Company
Gulf Oil Corp.
Date
7-12-84

I hereby certify that the well location shown on this plat was plotted from field notes of actual surveys made by me or under my supervision, and that the same is true and correct to the best of my knowledge and belief.

Date Surveyed
MARCH 21, 1984
Registered Professional Engineer and/or Land Surveyor

John W. West
Certificate No. **JOHN W. WEST, 676**
RONALD J. EIDSON, 3239

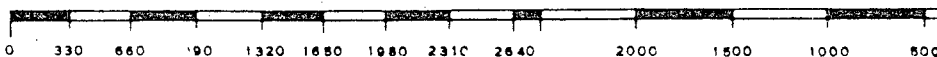

WELL LOCATION AND ACREAGE DEDICATION PLAT

Form No. 1 (Rev. 1-65)

All distances must be true to actual boundaries of the well.

Gulf Oil Corp.

LEA-STATE T2

5

H

16

19 SOUTH

35 EAST

LEA

1790' feet from North line and 900' from the East line

3784.0'

Bone Springs

Scharb Bone Springs

80

- Outline the acreage dedicated to the subject well by colored pencil or hatchure marks on the plat below.
- If more than one lease is dedicated to the well, outline each and identify the ownership thereof both as to working interest and royalty.
- If more than one lease of different ownership is dedicated to the well, have the interests of all owners been consolidated by communitization, unitization, force-pooling, etc?

Yes ☐ No ☐ If answer is "yes," type of consolidation

If answer is "no," list the owners and tract descriptions which have actually been consolidated (Use reverse side of this form if necessary.)

No allowable will be assigned to the well until all interests have been consolidated (by communitization, unitization, forced-pooling, or otherwise) or until a non-standard unit, eliminating such interests, has been approved by the Commission.

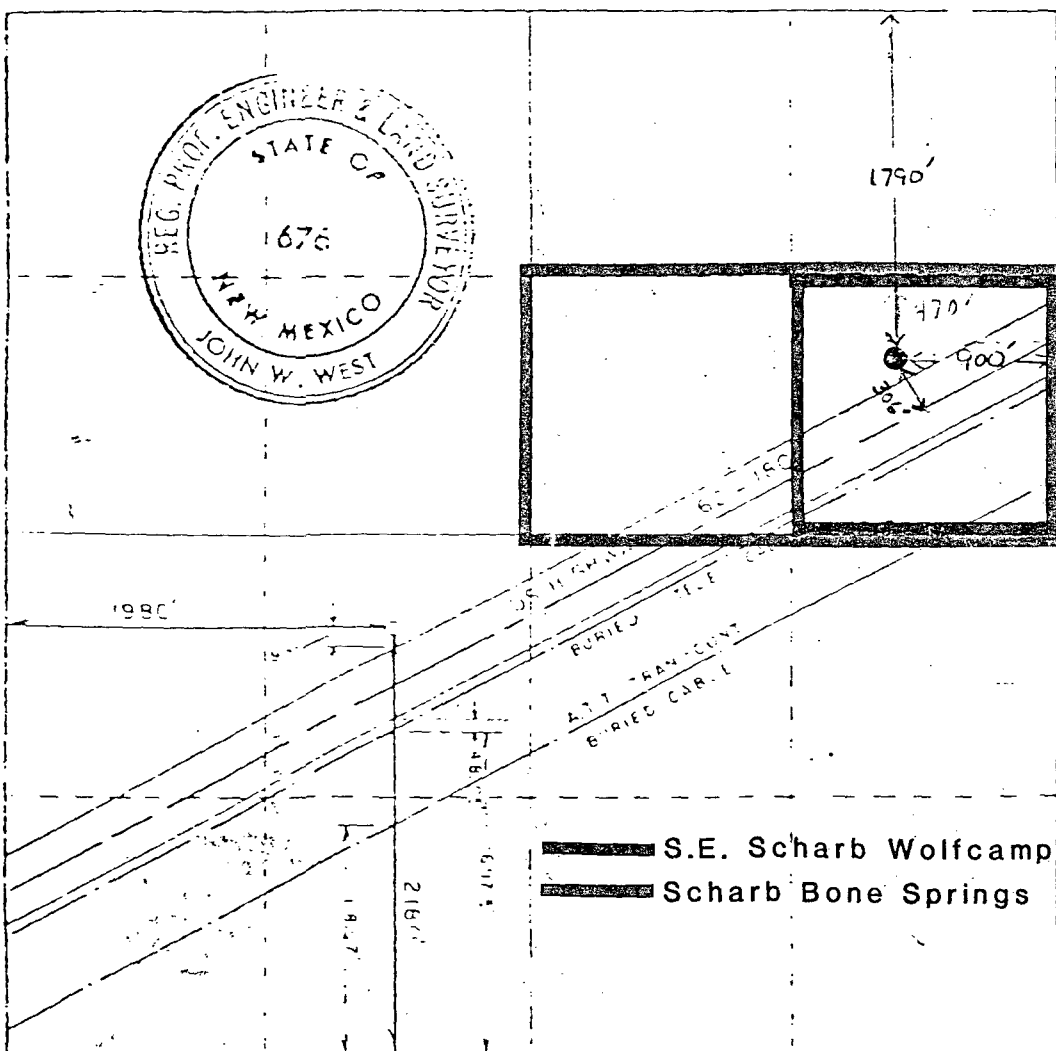

CERTIFICATION

I hereby certify that the information contained herein is true and complete to the best of my knowledge and belief.

R. C. Anderson

R. C. Anderson

Area Prod. Mgr.

Gulf Oil Corp.

7-12-84

I hereby certify that the well location shown on this plat was plotted from field notes of actual surveys made by me or under my supervision and that the same is true and correct to the best of my knowledge and belief.

October, 1983

Registered Professional Engineer

State of New Mexico

John W. West

Certificate No. JOHN W. WEST

671

RONALD J. EIDSON, 323



Amoco Production Company

Houston Region
501 WestLake Park Boulevard
Post Office Box 3092
Houston, Texas 77253

R. E. Ogden
Regional Engineering
Manager

July 25, 1984

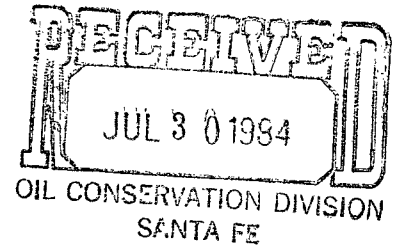

File: JCA-986.51-1338

Re: Non-Standard Location
Lea "TZ" Well No. 5
Scharb Bone Springs Pool
Lea County, New Mexico

Mr. R. L. Stamets
Oil Conservation Division
P. O. Box 2088
Santa Fe, New Mexico 87501

Gentlemen:

Gulf Oil Corp. has filed an application for a non-standard location for the subject well to be located 1790' FNL and 900' FEL of Section 16, T19S, R35E, Lea County, New Mexico.

As an offset operator, Amoco Production Company has no objection to this non-standard location.

Yours very truly,

MLC:lc

cc: Gulf Oil Corp.
P. O. Box 670
Hobbs, New Mexico 88240



July 18, 1984

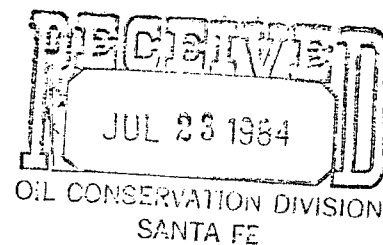

New Mexico Oil Conservation Division
P. O. Box 2088
Santa Fe NM 87501

Attention: Richard L. Stamets
Technical Support Chief

Gentlemen:

Subject: Waiver of Objection
Gulf Lea "TZ" State #5
Vacuum Prospect
Lea County, New Mexico
Mesa OP 05-NM-0946

Please let this serve as Mesa Petroleum Co. and MTS Limited Partnership's Waiver of Objection to the Unorthodox Location of Gulf Oil Corporation's referenced Bone Spring test to be located 1790' FNL and 900 FEL of Section 16-19S-35E, N.M.P.M.

Yours very truly,

A handwritten signature in cursive script, appearing to read 'Mark Hannifin'.

Mark Hannifin

as

xc: Gulf Oil Exploration & Production Company
Attn: R. C. Anderson
P. O. Box 670
Hobbs NM 88240