

**UNITED STATES  
DEPARTMENT OF THE INTERIOR  
BUREAU OF LAND MANAGEMENT**

(See other  
in-  
structions)

FOR APPROVED  
OMB NO. 1004-0137  
Expires: December 31, 1991

**WELL COMPLETION OR RECOMPLETION REPORT AND LOG\***

1a. TYPE OF WELL: OIL WELL <input type="checkbox"/> GAS WELL <input checked="" type="checkbox"/> DRY <input type="checkbox"/> OTHER <input type="checkbox"/>		200 OCT 24 AM 9:43	
b. TYPE OF COMPLETION: NEW WELL <input type="checkbox"/> WORK OVER <input type="checkbox"/> DEEP-EN <input type="checkbox"/> PLUG BACK <input checked="" type="checkbox"/> DIFF. RESVR. <input type="checkbox"/> OTHER <input type="checkbox"/>			
2. NAME OF OPERATOR Amoco Production Company		Attention: 070 FARMINGTON, NM Melissa Velasco	
3. ADDRESS AND TELEPHONE NO. P.O. Box 3092 Houston, TX		281-366-2548	
4. LOCATION OF WELL (Report location clearly and in accordance with any State requirements)* At surface 480' FSL  At top prod. interval reported  At total		10. FIELD AND POOL, OR WILDCAT Blanco Mesaverde	
14. PERMIT NO.		DATE ISSUED 04/28/2000	
15. DATE SPUDDED 10/19/1984		16. DATE T.D. REACHED 10/25/1984	
17. DATE COMPL. (Ready to prod.) 10/18/2000		18. ELEVATIONS (DF, RKB, RT, GR, ETC.) 5878 GR	
19. ELEV. CASINGHEAD		20. TOTAL DEPTH, MD & TVD 7090	
21. PLUG, BACK T.D., MD & TVD 5100' (New)		22. IF MULTIPLE COMPL., HOW MANY*	
23. INTERVALS DRILLED BY Rotary		24. ROTARY TOOLS Rotary	
25. WAS DIRECTIONAL SURVEY MADE NO		26. TYPE ELECTRIC AND OTHER LOGS RUN Gamma Ray	
27. WAS WELL CORED		28. CASING RECORD (Report all strings set in well)	
29. LINER RECORD		30. TUBING RECORD	
31. PERFORATION RECORD (Interval, size, and number)		32. ACID, SHOT, FRACTURE, CEMENT SQUEEZE, ETC.	
33. PRODUCTION		34. DISPOSITION OF GAS (Sold, used for fuel, vented, etc.)	
35. LIST OF ATTACHMENTS		36. I hereby certify that the foregoing and attached information is complete and correct as determined from all available records	

SIGNED Melissa Velasco TITLE Permitting Assistant DATE 10/23/2000

\*(See Instructions and Spaces for Additional Data on Reverse Side)

Title 18 U.S.C. Section 1001, makes it a crime for any person knowingly and willfully to make to any department or agency of the United States any false, fictitious or fraudulent statements or representations as to any matter within its jurisdiction.

NMOC

BY John J. Stone

**Florance 44E**  
**RECOMPLETION SUBSEQUENT REPORT**  
**10-23-00**

09/29/00 MIRUSU. NDWH & NU BOPs. Tally & TOH w/TBG. SDFN.

10/02/00 RU & TIH & set CIBP @ 6800'. Loaded hole w/water. Pressure tested to 1,000#. Held Ok. RU & spot CMT plug from 6800' to 5664'. TOH w/a TBG set 4.5" packer & set @ 2983'. Pressure tested to 4.5" CSG to 1,000# for 15 min. Held Ok. TOH w/4.5" packer. TIH w/7" packer & set @ 2980'. Just above the liner top @ 2985'. Tested 7" CSG to 1,000#. Held Ok. Pull out the hole with packer. SDFN.

10/3/00 TOH w/ 7" packer. TIH w/7" bridge plug. Set bridge plug @ 2970'. TOH w/setting tool & TIH w/7" packer. Set packer @ 65'. Tested 7" to 700#. Held Ok. Released packer & tested the total 7" CSG to 2,000#. Held Ok. Released packer & tested the total 7" CSG string to 2,500#. Held 15 min. Held Ok. CIRC hole for 1 hr. SDFN.

10/4/00 TOH w/ 7" packer. TIH w/Retrieving Head & released 7" bridge plug. TOH w/ 7" bridge plug. TDIH & found bridge plug @ 1250'. Latched on to bridge plug & TOH. SDFN.

10/5/00 TIH w/TGB set CIBP & set it @ 5794'. RU & spotted a 100' CMT plug on top of CIBP from 5794' to 5694'. TOH w/TBG & pressure tested CSG to 2,500#. Held Ok. RU & set CIBP for new PBTD of 5100'. Ran Gamma Ray Log.

RU & Perf 1<sup>st</sup> stage - Point Lookout & Lower Menefee formation as follows w/2 JSPF, 0.340 inch diameter, total shots 16:

4960'	4923'	4667'	4635'
4942'	4682'	4640'	4625'

RU & Perf 1<sup>st</sup> stage - Point Lookout & Lower Menefee formation as follows w/1 JSPF, 0.340 inch diameter, total shots 19:

4903'	4872'	4828'	4790'	4750'
4893'	4853'	4810'	4775'	4738'
4885'	4849'	4805'	4770'	4728'
4875'	4835'	4795'	4755'	

10/9/00 RU & Frac 1<sup>st</sup> Stage & pumped w/80,000# of 16/30 Arizona Sand & 70% N2 Foam. SDFN.

Florance 44E  
RECOMPLETION SUBSEQUENT REPORT  
10-23-00

10/10/00 RU & set cast iron bridge plug @ 4550'. Perf 2<sup>nd</sup> stage - Cliffhouse & Menefee formation as follows w/2 JSPF, 0.340 inch diameter, total shots 18:

4505'	4435'	4395'
4485'	4465'	4385'
4480'	4415'	4370'

Perf 2<sup>nd</sup> stage - Cliffhouse & Menefee formation as follows w/1 JSPF, 0.340 inch diameter, total shots 16:

4345'	4305'	4270'	4207'
4340'	4293'	4255'	4190'
4332'	4285'	4245'	4180'
4310'	4275'	4215'	4175'

RU & Frac 2<sup>nd</sup> Stage & pumped w/80,000# of 16/30 Arizona Sand & 70% N2 Foam. Flow back tree. Installed  $\frac{1}{4}$ " choke & flowed back frac to pit.

10/11/00 Well flowed through  $\frac{1}{4}$ " choke all night. Installed a  $\frac{1}{2}$ " choke & well make heavy foam & water. After 14:00 well flowing pressure was 180#. No sand & little foam. SDFN.

10/12/00 Put well on  $\frac{3}{4}$ " choke. Made no sand or water. TIH w/TBG & mill. Tag @ 4460'. CIRC hole clean to the top of CIBP & set @ 4550'. PU above perfs. Flowed well to the pit.

10/13/00 TIH & tag fill @ 4525'. RU & CIRC clean to the top of CIBP & set @ 4550'. TIH & clean out to 5100'. PU above perfs & SDFN.

10/16/00 RU & check for fill. Tag fill @ 5080'. CIRC hole clean to 5100'. PU above perfs & flowed well natural for 3 hrs. Checked for fill. Found none. Put well on  $\frac{3}{4}$ " choke. Flow test.

10/17/00 After 12 hrs. well was flowing @ 60#. Flow rate of 900 MCF. TIH & checked for fill. Found none. TOH layed down mill & bit sub. TIH w/production TBG & land @ 4950'. ND BOP's & NUWH. SDFN.

10/18/00 RU & pull TBG stop. Ran TBG stop.

RDMOSU Rig Released @ 08:00 hrs.

UNITED STATES  
DEPARTMENT OF THE INTERIOR  
BUREAU OF LAND MANAGEMENT

FORM APPROVED  
Budget Bureau No. 1004-0135  
Expires: September 30, 1990

SUNDRY NOTICES AND REPORTS ON WELLS

Do not use this form for proposals to drill or to deepen or reentry to a different reservoir.  
Use "APPLICATION FOR PERMIT—" for such proposals.

APR 21 AM 9:48

SUBMIT IN TRIPLICATE

070 FARMINGTON, NM

1. Type of Well

☐ OIL WELL ☒ GAS WELL ☐ OTHER

2. Name of Operator

Amoco Production Company

Mary Corley

3. Address and Telephone No.

P.O. Box 3092 Houston, TX 77253

4. Location of Well (Footage, Sec., T., R., M., or Survey Description)

480' FSL 340' FEL Sec. 31 T30N R8W Unit P

5. Lease Designation and Serial No.

SF - 079511 - A

6. If Indian, Allottee or Tribe Name

7. If Unit or CA, Agreement Designation

8. Well Name and No.

Florance 44E

9. API Well No.

30-045-26061

10. Field and Pool, or Exploratory Area

Blanco Mesaverde

11. County or Parish, State

San Juan New Mexico

12. CHECK APPROPRIATE BOX(s) TO INDICATE NATURE OF NOTICE, REPORT, OR OTHER DATA

TYPE OF SUBMISSION

- ☒ Notice of Intent  
☐ Subsequent Report  
☐ Final Abandonment Notice

TYPE OF ACTION

- ☐ Abandonment  
☒ Recompletion  
☐ Plugging Back  
☐ Casing Repair  
☐ Altering Casing  
☐ Other  
☐ Change of Plans  
☐ New Construction  
☐ Non-Routine Fracturing  
☐ Water Shut-Off  
☐ Conversion to Injection

(Note: Report results of multiple completion on Well Completion or Recompletion Report and Log form.)

13. Describe Proposed or Completed Operations. (Clearly state all pertinent details, and give pertinent dates, including estimated date of starting any proposed work. If well is directionally drilled, give subsurface locations and measured and true vertical depths for all markers and zones pertinent to this work.)\*

On July 21, 1999 Amoco Production Company received approval to permanently abandon the subject wellbore. After further review it has been determined that there is uphole potential, therefore, Amoco request permission to abandon the Dakota completion and recomplete the subject well into the Blanco Mesaverde formation as per attached procedure.

14. I hereby certify that the foregoing is true and correct

Signed

*Mary Corley*

Title Sr. Regulatory Analyst

Date 04/18/00

(This space for Federal or State office use)

Approved by

/s/ Charlie Beecham

Title

Date APR 28 2000

Conditions of approval, if any:

Title 18 U.S.C. Section 1001, makes it a crime for any person knowingly and willfully to make to any department or agency of the United States any false, fictitious or fraudulent statements or representations as to any matter within its jurisdiction.

\*See Instructions On Reverse Side

Hold c104 f/NSL CP

RM000

## Florance #44E Recompletion Procedure

---

### Procedure:

1. Check anchors. MIRU.
2. Check and record tubing, casing, and bradenhead pressures.
3. Blow down well. If necessary, kill with 2% KCL water.
4. Nipple down WH. NU BOPs. Pressure test to 500 psi.
5. Tally OH with 2-3/8" production tubing currently set at 7003'.
6. TIH with bit and scraper for 4-1/2" casing to 5100'.
7. TIH with tubing-set CIBP. Set CIBP at 6325'. Load hole with 2% KCL.
8. Spot 100' cmt plug from 6225' - 6325'. TOH to 6000'. Spot 100' cmt plug from 5900' - 6000' across Gallup formation (use 50% excess for balanced plug). TOH.
9. RU WL. Run CBL over MV interval (4050' - 5050') to ensure zonal isolation across the MV.
10. TIH with WL and set CIBP at 5100'.
11. Pressure test casing to 1500 psi.
12. RIH with 3-1/8" casing guns with Schlumberger's Prospector, select-fire charge. Perforate Lower Menefee/Point Lookout formation (correlate to GR log).  
4625', 4635', 4640', 4667', 4682', 4728', 4738', 4750', 4755', 4770', 4775', 4795', 4805',  
4810', 4828', 4835', 4849', 4853', 4875', 4885', 4893', 4903', 4923', 4942', 4960'
13. RU frac equipt & install wellhead isolation tool. Use 2% KCL/N2 foam in fracture stimulation.
14. Spearhead 500 gal 15% HCL, establish injection rate, & proceed with fracture stimulation.
15. Immediately after frac job, RU WL unit and lubricator.
16. RIH and set CIBP between Cliffhouse and Menefee at 4550'.
17. RIH with 3-1/8" casing guns with Schlumberger's Prospector, select-fire charge. Perforate Cliffhouse/Upper Menefee formation (correlate to GR log).  
4175', 4180', 4190', 4207', 4255', 4270', 4275', 4285', 4293', 4305', 4310', 4332', 4340',  
4345', 4370', 4385', 4395', 4415', 4435', 4465', 4480', 4485', 4505'
18. RU frac equipt & install wellhead isolation tool. Use 2% KCL/N2 foam in fracture stimulation.
19. Spearhead 500 gal 15% HCL, establish injection rate, and proceed with fracture stimulation.
20. Flowback frac immediately.
21. TIH with tubing and bit. Cleanout fill & drill bridge plug set at 4550'. Cleanout fill to 5100'.
22. TIH with 2-3/8" production tubing. Land production tubing at 4950'.
23. ND BOP's. NU WH. Return well to production.

**DISTRICT I**

P.O. Box 1980, Hobbs, NM 88240

**DISTRICT II**

311 South First., Artesia, NM 88210

**DISTRICT III**

1000 Rio Brazos Rd., Aztec, NM 87410

**DISTRICT IV**

2040 South Pacheco, Santa Fe, NM 87505

State of New Mexico  
Energy, Minerals and Natural Resources Department**OIL CONSERVATION DIVISION**2040 South Pacheco  
Santa Fe, New Mexico 87505

Form C-102

Revised October 18, 1994

Submit to Appropriate District Office

State Lease - 4 Copies

Fee Lease - 3 Copies

**WELL LOCATION AND ACREAGE DEDICATION PLAT**

API Number 30-045-26061	Pool Code 72319	Pool Name Blanco Mesaverde
Property Code 000518	Property Name Florance	Well Number 44
OGRID No. 000778	Operator Name AMOCO PRODUCTION COMPANY	Elevation 5878'

**Surface Location**

UL or lot no. UNIT P	Section 31	Township 30N	Range 8W	Lot. Idn	Feet from the 480'	North/South Line SOUTH	Feet from the 340'	East/West Line EAST	County San Juan
-------------------------	---------------	-----------------	-------------	----------	-----------------------	---------------------------	-----------------------	------------------------	--------------------

**Bottom Hole Location If Different From Surface**

UL or lot no.	Section	Township	Range	Lot. Idn	Feet from the	North/South Line	Feet from the	East/West Line	County
Dedicated Acreage: 220 297.11		Joint or Infill I	Consolidation Code		Order No.				

**NO ALLOWABLE WILL BE ASSIGNED TO THIS COMPLETION UNTIL ALL INTERESTS HAVE BEEN CONSOLIDATED  
OR A NON-STANDARD UNIT HAS BEEN APPROVED BY THE DIVISION**

	<b>OPERATOR CERTIFICATION</b> <i>I hereby certify that the information contained herein is true and complete to the best of my knowledge and belief</i> Signature Printed Name Mary Corley Position Sr. Business Analyst Date 04/18/2000
	<b>SURVEY CERTIFICATION</b> <i>I hereby certify that the well location shown on this plat was plotted from field notes of actual surveys made by me or under my supervision, and that the same is true and correct to the best of my knowledge and belief.</i> <div style="border: 1px solid black; padding: 5px; text-align: center;">On File</div> Date of Survey Signature & Seal of Professional Surveyor <div style="border: 1px solid black; height: 30px; width: 100%;"></div> Certificate No.

## Florance #44E

Sec 31, T30N, R8W

GL: 5878'

### History:

Completed in 12/84

- 6-1/4" OH drilled with air

without problems

### Original Dakota Perforations

63854' - 6877' 2 spf

7063' - 7073' 2 spf

est. TOC @ surf (circ 10 bbls)

9-5/8" 36# K55 ST&C @ 305'  
225 sxs cmt

est TOC @ 700' (temp surv)

DV tool @ 1625'

2nd stage: 265 sxs cmt

Top 4-1/2" liner @ 2985'

7" 23# K55 ST&C @ 3130'  
1st stage: 155 sxs cmt

Est TOC @ TOL

Tubing: 2-3/8" @ 7003'

4-1/2" 10.5# K55 ST&C @ 7087'  
note: btm 3 joints are 11.6 #/ft  
440 sxs cmt (rev'd 2-1/2 bbls)

PBTD: 7073'

### Notes:

- Good circulation throughout primary cmt job. 2-1/2 bbls were reversed off liner top

UNITED STATES  
DEPARTMENT OF THE INTERIOR  
BUREAU OF LAND MANAGEMENT

FORM APPROVED  
Budget Bureau No. 1004-0135  
Expires: March 31, 1993

SUNDRY NOTICES AND REPORTS ON WELLS

Do not use this form for proposals to drill or to deepen or reentry to a different reservoir.

Use "APPLICATION FOR PERMIT - " for such proposals

RECEIVED  
BLM

99 JUN -1 AM 10:03

5. Lease Designation and Serial No.

SF-079511-A

6. If Indian, Allottee or Tribe Name

7. If Unit or CA, Agreement Designation

070 FARMINGTON, NM

8. Well Name and No.

Fiorance

44E

9. API Well No.

30-045-26061

10. Field and Pool, or Exploratory Area

Basin Dakota

11. County or Parish, State

SAN JUAN

NEW MEXICO

1. Type of Well

☐ Oil Well ☒ Gas Well ☐ Other

2. Name of Operator

AMOCO PRODUCTION COMPANY

3. Address and Telephone No.

P.O. BOX 3092 HOUSTON TX 77253

281-366-4491

4. Location of Well (Footage, Sec., T., R., M., or Survey Description)

480' FSL

340' FEL

Sec. 31 T 30N R 8W

UNIT P

12. CHECK APPROPRIATE BOX(s) TO INDICATE NATURE OF NOTICE, REPORT, OR OTHER DATA

TYPE OF SUBMISSION

TYPE OF ACTION

- ☒ Notice of Intent  
☐ Subsequent Report  
☐ Final Abandonment Notice

- ☒ Abandonment  
☐ Recompletion  
☐ Plugging Back  
☐ Casing Repair  
☐ Altering Casing  
☐ Other

- ☐ Change of Plans  
☐ New Construction  
☐ Non-Routine Fracturing  
☐ Water Shut-Off  
☐ Conversion to Injection  
☐ Dispose Water

(Note: Report results of multiple completion on Well Completion or Recompletion Report and Log form.)

13. Describe Proposed or Completed Operations (Clearly state all pertinent details, and give pertinent dates, including estimated date of starting any proposed work. If well is directionally drilled, give subsurface locations and measured and true vertical depths for all markers and zones pertinent to this work.)

Amoco Production Company requests permission to plug and abandon the subject well as per the attached SJOET Well Work Procedure.

For technical assistance please contact Janet Ray @ 505-326-9281. For administrative assistance please contact Mary Corley @ 281-366-4491.

Reference letter NMSF-079511A (WC) 3162.3-2 (7100) and Sundry Notice dated 5/3/99.

14. I hereby certify that the foregoing is true and correct

Signed

Mary Corley

Title

Sr. Business Analyst

Date

06-28-1999

(This space for Federal or State office use)

Approved by

/S/ Duane W. Spencer

Title

Team Lead, Petroleum Management

Date

JUL 21 1999

Conditions of approval, if any:

Title 18 U.S.C. Section 1001, makes it a crime for any person knowingly and willfully to make to any department or agency of the United States any false, fictitious, or fraudulent statements or representations as to any matter within its jurisdiction.

\* See Instructions on Reverse

AMOCO



# SJOET Well Work Procedure

**Well Name:** Florance 44E  
**Version:** #1  
**Date:** 6/15/99  
**Budget:** DRA  
**Repair Type:** PXA  
**SAP Project:** X7-0007L (OARS #45438)

---

## Objectives:

1. To PXA the entire well.

---

## Pertinent Information:

<b>Location:</b>	480 FSL, 340 FEL Sec. 31, T30N-R8W	<b>Horizon:</b>	Basin Dakota
<b>County:</b>	San Juan	<b>API #:</b>	3004526061
<b>State:</b>	New Mexico	<b>Engr:</b>	James Dean
<b>Lease:</b>	SF-079511-A	<b>Phone:</b>	W (281) 366-5723
<b>Well Flac:</b>	979864		
<b>Lease Flac:</b>	698525		

---

## Economic Information:

**APC WI:** 57.47%  
**Estimated Cost:** \$20,000

---

## Formation Tops: (Estimated formation tops)

<b>San Jose:</b>	surface	<b>Menefee:</b>	4,350'
<b>Nacimiento:</b>	75'	<b>Point Lookout:</b>	4,738'
<b>Ojo Alamo:</b>	1,500'	<b>Mancos Shale:</b>	5,114'
<b>Kirtland Shale:</b>	1,577'	<b>Gallup:</b>	5,744'
<b>Fruitland:</b>	2,230'	<b>Graneros:</b>	
<b>Pictured Cliffs:</b>	2,538'	<b>Dakota:</b>	6,854'
<b>Lewis Shale:</b>	2,653'	<b>Morrison:</b>	
<b>Chacra:</b>	3,303'		
<b>Cliff House:</b>	4,171'		

---

## Bradenhead Test Information:

**Test Date:** 9/18/96   **Tubing:** 1297   **Casing:** 1310   **BH:** 0

Time	BH	CSG	INT	CSG
5 min				
10 min				
15 min				

---

**Comments:** Well is shut-in.

**Well Name: Florance 44E**

**Original Completion: 12/84**

**TD = 7,090' PBTD = 7,073'**

**Page 2 of 2**

1. Notify regulatory agencies (BLM, NMOCD, FIMO) 24 hours in advance of plugging activity. Contact BLM and indicate well is allotted (FIMO regulations effective April 1, 1997).
2. Check location for anchors. Install if necessary. Test anchors.
3. MIRUSU. Blow down well. Kill if necessary with fresh water. NDWH. NUBOP.
4. TOH with 2 3/8" tubing. Run in hole with tubing work string and CIBP, set CIBP at 6830'. Spot cement plug from 6830' to 6800' (4 sacks). TOH to 5,794', spot cement plug from 5794' to 5694' (12 sacks). TOH to 4221', spot cement plug from 4221' to 4121' (12 sacks). TOH to 2588', spot cement plug from 2588' to 2488' (28 sacks). TOH to 2280', spot cement plug from 2280' to 2180' (28 sacks). TOH to 1627', spot cement plug from 1627' to 1450' (49 sacks). TOH to 125', spot cement plug from 125' to surface (35 sacks).
5. NDBOP. Cut off casing and wellhead. Install PXA marker according to BLM or State requirements.
6. Contact FMC and ship surface equipment to yard or other location per instructions.
7. Provide workorder to Buddy Shaw for reclamation.
8. Rehabilitate location according to BLM or State requirements.

**Florance 44E**

**P31 T30N-R8W, 480 FSL, 340 FEL**

**API 3004526061**

**SF-079511-A**

**Proposed PXA Wellbore Schematic**

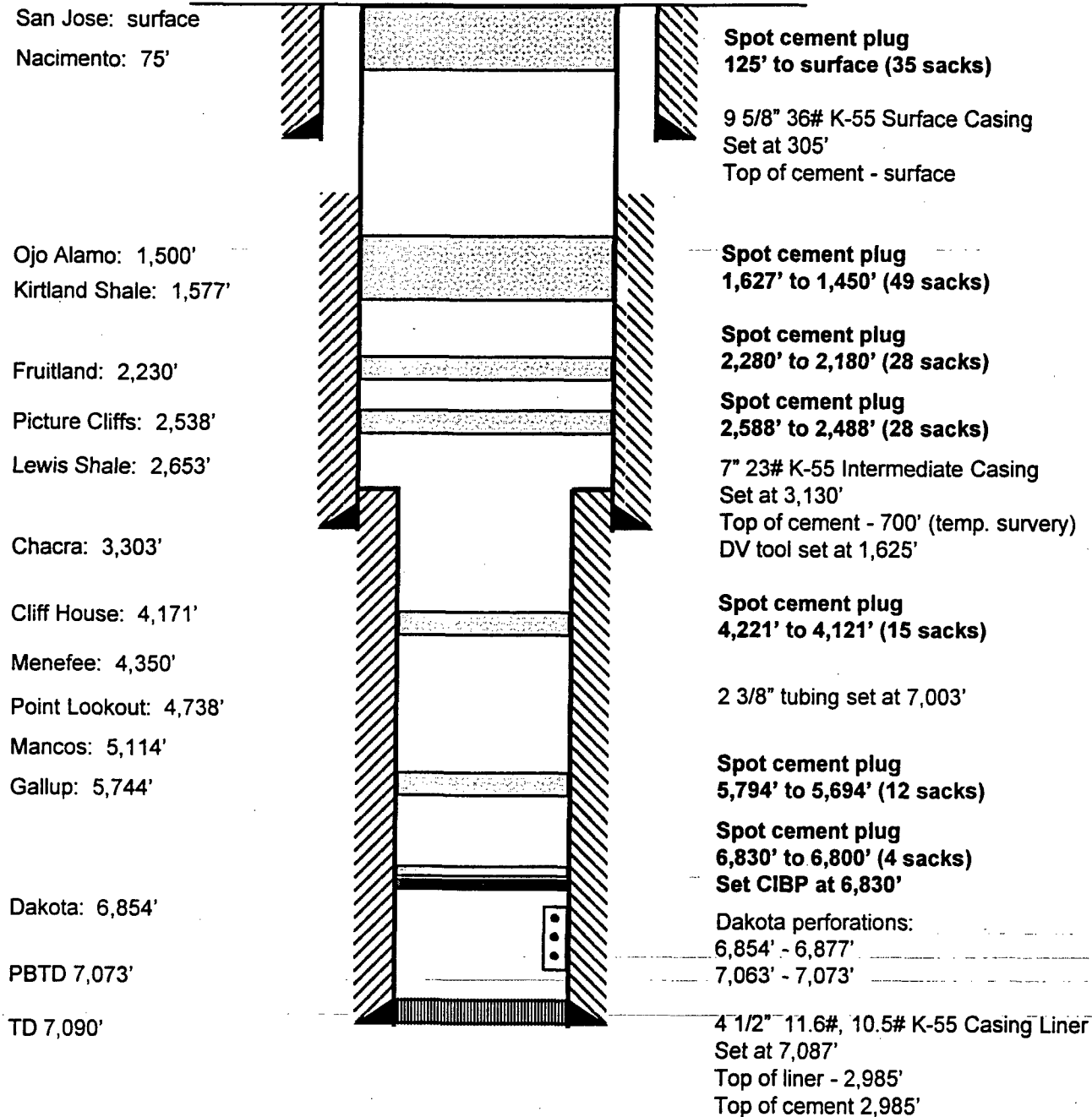

Not to scale

6/15/99  
jkr

UNITED STATES  
DEPARTMENT OF THE INTERIOR  
BUREAU OF LAND MANAGEMENT

FORM APPROVED  
Budget Bureau No. 1004-0135  
Expires: March 31, 1993

**SUNDRY NOTICES AND REPORTS ON WELLS**

Do not use this form for proposals to drill or to deepen or reentry to a different reservoir.  
Use "APPLICATION FOR PERMIT - " for such proposals

1. Type of Well  
☐ Oil Well ☒ Gas Well ☐ Other

2. Name of Operator  
AMOCO PRODUCTION COMPANY

3. Address and Telephone No.  
P.O. BOX 3092 HOUSTON, TX 77253

4. Location of Well (Footage, Sec., T., R., M., or Survey Description)  
480' FSL 340' FEL Sec. 31 T 30N R 8W UNIT P

RECEIVED  
MAY 12 1999  
OIL CON. DIV.  
281-386-4491  
DIST. 3

5. Lease Designation and Serial No.  
SF-079511-A

6. If Indian, Allottee or Tribe Name

7. If Unit or CA, Agreement Designation

8. Well Name and No.  
Florance 44E

9. API Well No.  
30-045-26061

10. Field and Pool, or Exploratory Area  
Basin Dakota

11. County or Parish, State  
SAN JUAN NEW MEXICO

12. CHECK APPROPRIATE BOX(s) TO INDICATE NATURE OF NOTICE, REPORT, OR OTHER DATA

TYPE OF SUBMISSION	TYPE OF ACTION
<input type="checkbox"/> Notice of Intent	<input type="checkbox"/> Abandonment
<input checked="" type="checkbox"/> Subsequent Report	<input type="checkbox"/> Recompletion
<input type="checkbox"/> Final Abandonment Notice	<input type="checkbox"/> Plugging Back
	<input type="checkbox"/> Casing Repair
	<input type="checkbox"/> Altering Casing
	<input checked="" type="checkbox"/> Other Letter Dated 03-03-1999
	<input type="checkbox"/> Change of Plans
	<input type="checkbox"/> New Construction
	<input type="checkbox"/> Non-Routine Fracturing
	<input type="checkbox"/> Water Shut-Off
	<input type="checkbox"/> Conversion to Injection
	<input type="checkbox"/> Dispose Water

(Note: Report results of multiple completion on Well Completion or Recompletion Report and Log form.)

13. Describe Proposed or Completed Operations (Clearly state all pertinent details, and give pertinent dates, including estimated date of starting any proposed work. If well is directionally drilled, give subsurface locations and measured and true vertical depths for all markers and zones pertinent to this work.)

Amoco Production Company has reviewed the Dakota production and recompletion potential in this wellbore and have concluded that compression would not substantially increase the Dakota production and the Mesaverde reservoir in this area is being adequately drained by offset wells. It is our intention to P&A the wellbore. P&A procedures are being prepared at this time and will be forwarded to your office upon completion.

Reference letter NMSF-079115A (WC)  
3162.3-2 (7100)

14. I hereby certify that the foregoing is true and correct

Signed Mary Corley Title Senior Business Analyst Date 05-03-1999

(This space for Federal or State office use)

Approved by \_\_\_\_\_ Title \_\_\_\_\_ Date \_\_\_\_\_  
Conditions of approval, if any:

Title 18 U.S.C. Section 1001, makes it a crime for any person knowingly and willfully to make to any department or agency of the United States any false, fictitious, or fraudulent statements or representations as to any matter within its jurisdiction.

\* See Instructions on Reverse

NMOCD

MAY 12 1999

281-386-4491  
SMN

UNITED STATES  
DEPARTMENT OF THE INTERIOR  
BUREAU OF LAND MANAGEMENTFORM APPROVED  
Budget Bureau No. 1004-0135  
Expires: March 31, 1993

## SUNDRY NOTICES AND REPORTS ON WELLS

Do not use this form for proposals to drill or to deepen or reentry to a different reservoir.

Use "APPLICATION FOR PERMIT - " for such proposals

5. Lease Designation and Serial No.

SF-079511-A

6. If Indian, Allottee or Tribe Name

Unit or CA, Agreement Designation

1. Type of Well

☐ Oil Well ☒ Gas Well ☐ Other

2. Name of Operator

AMOCO PRODUCTION COMPANY

Attention:

Pat Archuleta

3. Address and Telephone No.

P.O. BOX 800 DENVER, COLORADO 80201

(303) 830-5217

4. Location of Well (Footage, Sec., T., R., M., or Survey Description)

480' FSL

340' FEL

Sec. 31 T 30N R 8W

UNIT P

8. Well Name and No.

Florance

44E

9. API Well No.

3004526061

10. Field and Pool, or Exploratory Area

Basin Dakota

11. County or Parish, State

SAN JUAN

NEW MEXICO

12. CHECK APPROPRIATE BOX(s) TO INDICATE NATURE OF NOTICE, REPORT, OR OTHER DATA

## TYPE OF SUBMISSION

## TYPE OF ACTION

- ☐ Notice of Intent
- ☒ Subsequent Report
- ☐ Final Abandonment Notice

- ☐ Abandonment
- ☐ Recompletion
- ☐ Plugging Back
- ☐ Casing Repair
- ☐ Altering Casing
- ☒ Other Letter Dated 6/18/98

- ☐ Change of Plans
- ☐ New Construction
- ☐ Non-Routine Fracturing
- ☐ Water Shut-Off
- ☐ Conversion to Injection
- ☐ Dispose Water

(Note: Report results of multiple completion on Well Completion or Recompletion Report and Log form.)

13. Describe Proposed or Completed Operations (Clearly state all pertinent details, and give pertinent dates, including estimated date of starting any proposed work. If well is directionally drilled, give markers and zones pertinent to this work.)\*

subsurface locations and measured and true vertical depths for all

Amoco Production Company will install a wellhead compressor on this well for one month in the 1st quarter of 1999.

If well does not perform under well head compressor an evaluation will be made at that time to either recomplete or plug and abandon the well.

Reference NMNM-04202 et al (WC0  
3162.3-4 (7400))

THIS APPROVAL EXPIRES MAR 01 1999

14. I hereby certify that the foregoing is true and correct

Signed

Pat Archuleta

Title

Staff Assistant

Date

09-23-1998

(This space for Federal or State office use)

Approved by

/s/ Duane W. Spencer

Title

Date

SEP 28 1998

Conditions of approval, if any:

Title 18 U.S.C. Section 1001, makes it a crime for any person knowingly and willfully to make to any department or agency of the United States any false, fictitious, or fraudulent statements or representations as to any matter within its jurisdiction.

\* See Instructions on Reverse Side

NMOC

UNITED STATES  
DEPARTMENT OF THE INTERIOR  
BUREAU OF LAND MANAGEMENTFORM APPROVED  
Budget Bureau No. 1004-0135  
Expires: March 31, 1993

## SUNDRY NOTICES AND REPORTS ON WELLS

Do not use this form for proposals to drill or to deepen or reentry to a different reservoir.  
Use "APPLICATION FOR PERMIT - " for such proposals

1. Type of Well <input type="checkbox"/> Oil Well <input checked="" type="checkbox"/> Gas Well <input type="checkbox"/> Other		5. Lease Designation and Serial No. <b>SF-079511-A</b>
2. Name of Operator <b>AMOCO PRODUCTION COMPANY</b>		6. If Indian, Allottee or Tribe Name
3. Address and Telephone No. <b>P.O. BOX 800 DENVER, COLORADO 80201</b>		7. If Unit or CA, Agreement Designation
4. Location of Well (Footage, Sec., T., R., M., or Survey Description) <b>480' FSL 340' FEL Sec. 31 T 30N R 8W UNIT P</b>		8. Well Name and No. <b>Florance 44E</b>
		9. API Well No. <b>3004526061</b>
		10. Field and Pool, or Exploratory Area <b>Basin Dakota</b>
		11. County or Parish, State <b>SAN JUAN NEW MEXICO</b>

12. CHECK APPROPRIATE BOX(s) TO INDICATE NATURE OF NOTICE, REPORT, OR OTHER DATA	
TYPE OF SUBMISSION	TYPE OF ACTION
<input type="checkbox"/> Notice of Intent <input checked="" type="checkbox"/> Subsequent Report <input type="checkbox"/> Final Abandonment Notice	<input type="checkbox"/> Abandonment <input type="checkbox"/> Recompletion <input type="checkbox"/> Plugging Back <input type="checkbox"/> Casing Repair <input type="checkbox"/> Altering Casing <input checked="" type="checkbox"/> Other <u>Letter Dated 04/28/97</u> <input type="checkbox"/> Change of Plans <input type="checkbox"/> New Construction <input type="checkbox"/> Non-Routine Fracturing <input type="checkbox"/> Water Shut-Off <input type="checkbox"/> Conversion to Injection <input type="checkbox"/> Dispose Water
(Note: Report results of multiple completion on Well Completion or Recompletion Report and Log form.)	

13. Describe Proposed or Completed Operations (Clearly state all pertinent details, and give pertinent dates, including estimated date of starting any proposed work. If well is directionally drilled, give subsurface locations and measured and true vertical depths for all markers and zones pertinent to this work.)\*

Amoco Production Company requests permission to leave this well in a shut-in status for a 1 years evalutation period, with in this time frame we will submit our plans for this well.

Reference letter NMSF-078046 et al. (WC) 3162.3-2 (7400)

RECEIVED  
JUN - 5 1997OIL CON. DIV.  
DIST. 3

THIS APPROVAL EXPIRES JUN 01 1998

070 FARMINGTON, NM  
97 JUN - 2 PM 2:57

14. I hereby certify that the foregoing is true and correct		
Signed <u>Pat Archuleta</u>	Title <u>Staff Assistant</u>	Date <u>05-29-1997</u>

(This space for Federal or State office use)

Approved by /s/ Duane W. Spencer Title \_\_\_\_\_ Date JUN - 3 1997  
Conditions of approval, if any:

Title 18 U.S.C. Section 1001, makes it a crime for any person knowingly and willfully to make to any department or agency of the United States any false, fictitious, or fraudulent statements or representations as to any matter within its jurisdiction.

\* See Instructions on Reverse Side

NMOC

District I  
PO Box 1980, Hobbs, NM 88241-1930  
  
District II  
PO Drawer DD, Artesia, NM 88211-0719  
  
District III  
1000 Rio Brazos Rd., Aztec, NM 87410  
  
District IV  
PO Box 2088, Santa Fe, NM 87504-2088

State of New Mexico  
Energy, Minerals & Natural Resources  
Department  
  
OIL CONSERVATION DIVISION  
PO Box 2088  
Santa Fe, NM 87504-2088

97986401  
Form C-104  
Revised February 21, 1994  
Instructions on back  
Submit to Appropriate District Office  
5 Copies

☐ AMENDED REPORT

I. REQUEST FOR ALLOWABLE AND AUTHORIZATION TO TRANSPORT

<sup>1</sup> Operator name and Address  AMOCO PRODUCTION COMPANY 200 AMOCO COURT FARMINGTON, NM 87401		<sup>2</sup> OGRID Number 000778  <sup>3</sup> Reason for Filing Code CO
<sup>4</sup> API Number 300452606100	<sup>5</sup> Pool Name BASIN-DAKOTA-GAS	<sup>6</sup> Pool Code 071599
<sup>7</sup> Property Code 000518	<sup>8</sup> Property Name FLORANCE 44E	<sup>9</sup> Well Number 44E

II. <sup>10</sup>Surface Location

<sup>10</sup> UI or lot no. P	<sup>11</sup> Section 0031	<sup>12</sup> Township 030	<sup>13</sup> Range 008	<sup>14</sup> Lot.Idn	<sup>15</sup> Feet from the 480	<sup>16</sup> North/South Line S	<sup>17</sup> Feet from the 340	<sup>18</sup> East/West Line E	<sup>19</sup> County SAN JUAN
----------------------------------	-------------------------------	-------------------------------	----------------------------	-----------------------	------------------------------------	-------------------------------------	------------------------------------	-----------------------------------	----------------------------------

<sup>11</sup>Bottom Hole Location

<sup>10</sup> UI or lot no.	<sup>11</sup> Section	<sup>12</sup> Township	<sup>13</sup> Range	<sup>14</sup> Lot.Idn	<sup>15</sup> Feet from the	<sup>16</sup> North/South Line	<sup>17</sup> Feet from the	<sup>18</sup> East/West Line	<sup>19</sup> County
<sup>12</sup> Lse Code F	<sup>13</sup> Producing Method Code		<sup>14</sup> Gas Connection Date		<sup>15</sup> C-129 Permit Number		<sup>16</sup> C-129 Effective Date		<sup>17</sup> C-129 Expiration Date

III. Oil and Gas Transporters

<sup>18</sup> Transporter OGRID	<sup>19</sup> Transporter Name and Address	<sup>20</sup> POD	<sup>21</sup> O/G	<sup>22</sup> POD ULSTR Location and Description
9018	GIANT REFINING BOX 12999 SCOTTSDALE AZ 85267	0236610	O	
7057	EPNG P.O. BOX 4990 FARMINGTON NM 87499	0236630	G	

IV. Produced Water

<sup>23</sup> POD	<sup>24</sup> POD ULSTR Location and Description
-------------------	--

V. Well Completion Data

<sup>25</sup> Spud Date	<sup>26</sup> Ready Date	<sup>27</sup> TD	<sup>28</sup> PBTD	<sup>29</sup> Perforations
<sup>30</sup> Hole Size	<sup>31</sup> Casing & Tubing Size	<sup>32</sup> Depth Set	<sup>33</sup> Sacks Cement	

VI. Well Test Data

<sup>34</sup> Date New Oil	<sup>35</sup> Gas Delivery Date	<sup>36</sup> Test Date	<sup>37</sup> Test Length	<sup>38</sup> Tbg. Pressure	<sup>39</sup> Csg. Pressure
<sup>40</sup> Choke Size	<sup>41</sup> Oil	<sup>42</sup> Water	<sup>43</sup> Gas	<sup>44</sup> AOF	<sup>45</sup> Test Method
<sup>46</sup> I hereby certify that the rules of the Oil Conservation Division have been complied with and that the information given above is true and complete to the best of my knowledge and belief.  Signature: J. P. Shaheen Printed Name: J. P. SHAHEEN Title: SENIOR BUSINESS ANALYST Date: 9/27/95			OIL CONSERVATION DIVISION  Approved by: <i>J.P.S.</i> Title: SUPERVISOR DISTRICT #3 Approval Date: SEP 27 1995 Phone: (505) 326-9413		

# OIL CONSERVATION DIVISION

DISTRICT II  
P.O. Drawer DD, Artesia, NM 88210

P.O. Box 2088  
Santa Fe, New Mexico 87504-2088

DISTRICT III  
1000 Rio Brazos Rd., Aztec, NM 87410

## REQUEST FOR ALLOWABLE AND AUTHORIZATION TO TRANSPORT OIL AND NATURAL GAS

Operator <b>Amoco Production Company</b>		Well API No. <b>3004526061</b>
Address <b>1670 Broadway, P. O. Box 800, Denver, Colorado 80201</b>		
Reason(s) for Filing (Check proper box) <input type="checkbox"/> Other (Please explain)		
New Well <input type="checkbox"/>	Change in Transporter of: <input type="checkbox"/> Oil <input type="checkbox"/> Dry Gas <input type="checkbox"/>	
Recompletion <input type="checkbox"/>	Casinghead Gas <input type="checkbox"/> Condensate <input type="checkbox"/>	
Change in Operator <input checked="" type="checkbox"/>		
If change of operator give name and address of previous operator <b>Tenneco Oil E &amp; P, 6162 S. Willow, Englewood, Colorado 80155</b>		

### II. DESCRIPTION OF WELL AND LEASE

Lease Name <b>FLORANCE</b>	Well No. <b>44E</b>	Pool Name, Including Formation <b>BASIN (DAKOTA)</b>	FEDERAL	Lease No. <b>SF079511A</b>
Location				
Unit Letter <b>P</b>	<b>480</b>	Feet From The FSL	Line and <b>340</b>	Feet From The FEL
Section <b>31</b>	Township <b>30N</b>	Range <b>8W</b>	<b>NMPM, SAN JUAN</b>	County

### III. DESIGNATION OF TRANSPORTER OF OIL AND NATURAL GAS

Name of Authorized Transporter of Oil <input type="checkbox"/> or Condensate <input checked="" type="checkbox"/>	Address (Give address to which approved copy of this form is to be sent)	
Name of Authorized Transporter of Casinghead Gas <input type="checkbox"/> or Dry Gas <input checked="" type="checkbox"/>	Address (Give address to which approved copy of this form is to be sent)	
<b>EL PASO NATURAL GAS COMPANY</b>	<b>P. O. BOX 1492, EL PASO, TX 79978</b>	
If well produces oil or liquids, give location of tanks.	Unit	Sec.
	Twp.	Rge.
		Is gas actually connected? When?

If this production is commingled with that from any other lease or pool, give commingling order number:

### IV. COMPLETION DATA

Designate Type of Completion - (X)	Oil Well	Gas Well	New Well	Workover	Deepen	Plug Back	Same Res'v	Diff Res'v
Date Spudded	Date Compl. Ready to Prod.		Total Depth		P.B.T.D.			
Elevations (DF, RKB, RT, GR, etc.)	Name of Producing Formation		Top Oil/Gas Pay		Tubing Depth			
Perforations					Depth Casing Shoe			
TUBING, CASING AND CEMENTING RECORD								
HOLE SIZE	CASING & TUBING SIZE		DEPTH SET		SACKS CEMENT			

### V. TEST DATA AND REQUEST FOR ALLOWABLE

OIL WELL (Test must be after recovery of total volume of load oil and must be equal to or exceed top allowable for this depth or be for full 24 hours.)

Date First New Oil Run To Tank	Date of Test	Producing Method (Flow, pump, gas lift, etc.)	
Length of Test	Tubing Pressure	Casing Pressure	Choke Size
Actual Prod. During Test	Oil - Bbls.	Water - Bbls.	Gas - MCF

### GAS WELL

Actual Prod. Test - MCF/D	Length of Test	Bbls. Condensate/MMCF	Gravity of Condensate
Testing Method (pilot, back pr.)	Tubing Pressure (Shut-in)	Casing Pressure (Shut-in)	Choke Size

### VI. OPERATOR CERTIFICATE OF COMPLIANCE

I hereby certify that the rules and regulations of the Oil Conservation Division have been complied with and that the information given above is true and complete to the best of my knowledge and belief.

*J. L. Hampton*

Signature  
**J. L. Hampton** Sr. Staff Admin. Suprv.  
Printed Name  
**January 16, 1989** Title  
Date  
**303-830-5025** Telephone No.

### OIL CONSERVATION DIVISION

Date Approved **MAY 08 1989**

By *[Signature]*  
Title **SUPERVISION DISTRICT # 2**

INSTRUCTIONS: This form is to be filed in compliance with Rule 1104

- 1) Request for allowable for newly drilled or deepened well must be accompanied by tabulation of deviation tests taken in accordance with Rule 111.
- 2) All sections of this form must be filled out for allowable on new and recompleted wells.
- 3) Fill out only Sections I, II, III, and VI for changes of operator, well name or number, transporter, or other such changes.
- 4) Separate Form C-104 must be filed for each pool in multiply completed wells.



✓  
EL PASO NATURAL GAS COMPANY  
POST OFFICE BOX 990  
FARMINGTON, NEW MEXICO

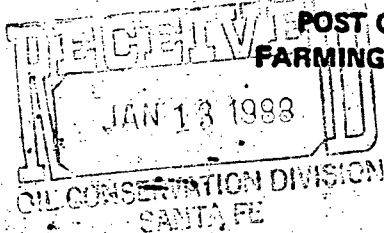

NOTICE OF GAS CONNECTION

DATE December 31, 1987

THIS IS TO NOTIFY THE OIL CONSERVATION COMMISSION THAT CONNECTION FOR PURCHASE OF

GAS FROM Tenneco Oil Florance #44-E  
Operator Well Name  
92-066-01 75247-51 P 31-30-8  
Meter Code Site Code Well Unit S-T-R  
Basin Dakota EL PASO NATURAL GAS  
Pool Name of Purchaser

WAS MADE ON October 15, 1987  
Date

FIRST DELIVERY December 8, 1987  
Date

AOF \_\_\_\_\_

CHOKE 809

EL PASO NATURAL GAS  
Purchaser

Sheri Underwood  
Representative

Clerk, Technical Support  
Title

CC: OPERATOR  
OIL CONSERVATION COMMISSION (2)  
PRODUCTION CONTROL - El Paso  
CONTRACT ADMINISTRATION - El Paso  
FILE

F  
045  
CST

JAN 03 1988

## MULTIPOINT AND ONE POINT BACK PRESSURE TEST FOR GAS WELL

Type Test <input checked="" type="checkbox"/> Initial <input type="checkbox"/> Annual <input type="checkbox"/> Special		Test Date 12/6/84	
Company Tenneco Oil Company		Connection	
Pool Basin		Formation Dakota	
Completion Date		Total Depth 7090	
Plug Back TD 7073		Elevation	
Csq. Size / 4 1/2		Well No. 44E	
Trq. Size 2 3/8		Unit P	
Sec. 31		Twp. 30	
Rye. 8		County San Juan	
Producing Thru		Reservoir Temp. °F p	
Mean Annual Temp. °F		Baro. Press. - P <sub>a</sub>	
State New Mexico		L H G <sub>g</sub> .700 % CO <sub>2</sub> % N <sub>2</sub> % H <sub>2</sub> S Prover Meter Run Taps	
FLOW DATA			
NO.	Prover Line Size	X	Orifice Size
SI			
1.	2 x 6 x .75		
2.			
3.			
4.			
5.			
TUBING DATA			
NO.	Press. p.s.i.g.	Temp. °F	Duration of Flow
1.	1385		3 hours
2.	48		
3.			
4.			
5.			
CASING DATA			
NO.	Press. p.s.i.g.	Temp. °F	Rate of Flow
1.	1385		809
2.	252	56	
3.			
4.			
5.			
RATE OF FLOW CALCULATIONS			
NO.	Coefficient (24 Hour)	$\sqrt{h_w P_m}$	Pressure P <sub>m</sub>
1.	11		60
2.			
3.			
4.			
5.			
NO.	Flow Temp. Factor Ft.	Gravity Factor F <sub>g</sub>	Super Compress. Factor, F <sub>pv</sub>
1.	1.004	1.195	1.0055
2.			
3.			
4.			
5.			
NO.	R <sub>f</sub>	Temp. °R	T <sub>f</sub>
1.	.09	516	1.31
2.			
3.			
4.			
5.			
Gas Liquid Hydrocarbon Ratio _____ Mcf/bbl.			
A.P.J. Gravity of Liquid Hydrocarbons _____ Deg.			
Specific Gravity Separator Gas _____			
Specific Gravity Flowing Fluid _____			
Critical Pressure _____ P.S.I.A.			
Critical Temperature _____ R			
P <sub>c</sub> 1397 P <sub>c</sub> <sup>2</sup> 1951609			
NO.	P <sub>i</sub> <sup>2</sup>	P <sub>w</sub>	P <sub>w</sub> <sup>2</sup>
1.		264	69696
2.			
3.			
4.			
5.			
(1) $\frac{P_c^2}{P_c^2 - P_w^2} = 1.0370$			
(2) $\left[ \frac{P_c^2}{P_c^2 - P_w^2} \right]^n = 1.0276$			
AOF = Q $\left[ \frac{P_c^2}{P_c^2 - P_w^2} \right]^n = 831$			
Absolute Open Flow 831 Mcfd @ 15.025 Angle of Slope θ Slope, n .75			
Remarks:			
Approved By Division Conducted By: Calculated By: Checked By:			

NO. OF COPIES RECEIVED	
DISTRIBUTION	
SANTA FE	
FILE	
U.S.G.S.	
LAND OFFICE	
TRANSPORTER	OIL
	GAS
OPERATOR	
PRORATION OFFICE	

NEW MEXICO OIL CONSERVATION COMMISSION  
REQUEST FOR ALLOWABLE  
AND  
AUTHORIZATION TO TRANSPORT OIL AND NATURAL GAS

Form C-104  
Supersedes Old C-104 and C-105  
Effective 1-1-65

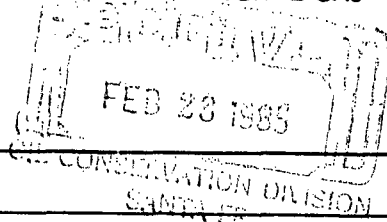

I. Operator  
Tenneco Oil Company

Address  
P. O. Box 3249, Englewood, CO 80155

Reason(s) for filing (Check proper box)

New Well	<input checked="" type="checkbox"/>	Change in Transporter of:	
Recompletion	<input type="checkbox"/>	Oil	<input type="checkbox"/>
Change in Ownership	<input type="checkbox"/>	Casinghead Gas	<input type="checkbox"/>
		Dry Gas	<input type="checkbox"/>
		Condensate	<input type="checkbox"/>

Other (Please explain)

If change of ownership give name and address of previous owner

II. DESCRIPTION OF WELL AND LEASE

Lease Name Florance	Well No. 44E	Pool Name, including Formation Basin Dakota	Kind of Lease USA State, Federal or Fee SF	Lease No. 079511A
Location Unit Letter <u>P</u> ; <u>480</u> Feet From The <u>South</u> Line and <u>340</u> Feet From The <u>East</u>				
Line of Section <u>31</u> Township <u>T30N</u> Range <u>8W</u> , NMPM, <u>San Juan</u> County				

III. DESIGNATION OF TRANSPORTER OF OIL AND NATURAL GAS

Name of Authorized Transporter of Oil <input type="checkbox"/> or Condensate <input checked="" type="checkbox"/> Conoco Inc. Surface Transportation	Address (Give address to which approved copy of this form is to be sent) P. O. Box 460, Hobbs, NM 88240	
Name of Authorized Transporter of Casinghead Gas <input type="checkbox"/> or Dry Gas <input checked="" type="checkbox"/> El Paso Natural Gas Co	Address (Give address to which approved copy of this form is to be sent) P. O. Box 4990, Farmington, NM 87499	
If well produces oil or liquids, give location of tanks.	Unit P	Sec. 31
	Twp. 30N	Rge. 8W
	Is gas actually connected? No	When ASAP

If this production is commingled with that from any other lease or pool, give commingling order number:

IV. COMPLETION DATA

Designate Type of Completion - (X)		Oil Well	Gas Well	New Well	Workover	Deepen	Plug Back	Same Res'v.	Diff. Res'v.
			X	X					
Date Spudded 10-19-84	Date Compl. Ready to Prod. 12-31-84		Total Depth 7090' KB		P.B.T.D. 7073' KB				
Elevations (DF, RKB, RT, GR, etc.) 5866' GR	Name of Producing Formation Dakota		Top Oil/Gas Pay 6854' KB		Tubing Depth 7003' KB				
Perforations 2JSPF 33', 66 holes 6854'-77', 7063'-73' KB				Depth Casing Shoe 7087' KB					
TUBING, CASING, AND CEMENTING RECORD									
HOLE SIZE	CASING & TUBING SIZE		DEPTH SET		SACKS CEMENT				
12 1/4"	9 5/8 csg		305' KB		225sx 265CF				
8 3/4"	7" csg		3130' KB		420sx 658CF				
6 1/4"	4 1/2" liner csg		2985' - 7087' KB		440sx 743CF				
--	2 3/8" tbq		7003' KB		--				

V. TEST DATA AND REQUEST FOR ALLOWABLE OIL WELL

(Test must be after recovery of total volume of load oil and must be equal to or exceed top allowable for this depth or be for full 24 hours)

Date First New Oil Run To Tanks	Date of Test	Producing Method (Flow, pump, gas lift, etc.)	
Length of Test	Tubing Pressure	Casing Pressure	Choke Size
Actual Prod. During Test	Oil-Bbls.	Water-Bbls.	Gas-MCF

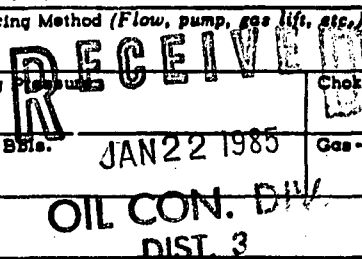

GAS WELL

Actual Prod. Test-MCF/D 809	Length of Test 3 hrs.	Bbls. Condensate/MMCF	Gravity of Condensate
Testing Method (pitot, back pr.) Back pressure	Tubing Pressure (Shut-in) 1385	Casing Pressure (Shut-in) 1385	Choke Size 3/4"

VI. CERTIFICATE OF COMPLIANCE

I hereby certify that the rules and regulations of the Oil Conservation Commission have been complied with and that the information given above is true and complete to the best of my knowledge and belief.

*Scott McKinnis*  
(Signature)

Sr. Regulatory Analyst

(Title)

January 11, 1985

(Date)

OIL CONSERVATION COMMISSION

FEB 15 1985

APPROVED

BY *[Signature]*

TITLE

SUPERVISOR DISTRICT # 3

This form is to be filed in compliance with RULE 1104.

If this is a request for allowable for a newly drilled or deepened well, this form must be accompanied by a tabulation of the deviation tests taken on the well in accordance with RULE 111.

All sections of this form must be filled out completely for allowable on new and recompleted wells.

Fill out only Sections I, II, III, and VI for changes of owner, well name or number, or transporter, or other such change of condition.

Separate Forms C-104 must be filed for each pool in multiply completed wells.

UNITED STATES  
DEPARTMENT OF THE INTERIOR  
BUREAU OF LAND MANAGEMENT

SUBMIT IN DUPLICATE\*

(See other instructions on reverse side)

Form approved.  
Budget Bureau No. 1004-0137  
Expires August 31, 1985

WELL COMPLETION OR RECOMPLETION REPORT AND LOG \*

1a. TYPE OF WELL:		OIL WELL <input type="checkbox"/>	GAS WELL <input checked="" type="checkbox"/>	DRY <input type="checkbox"/>	Other _____		
b. TYPE OF COMPLETION:							
NEW WELL <input checked="" type="checkbox"/> WORK OVER <input type="checkbox"/> DEEPEN <input type="checkbox"/> PLUG BACK <input type="checkbox"/> DIFF. RENVR. <input type="checkbox"/> Other _____							
2. NAME OF OPERATOR Tenneco Oil Company							
3. ADDRESS OF OPERATOR							
4. LOCATION OF WELL (Report location clearly and in accordance with BLM instructions) At surface 480' FSL 340' FEB 1 1985 At top prod. interval reported below At total depth OIL CONSERVATION DIVISION SANTA FE RECEIVED OIL CON. DIV. DIST. 3							
14. PERMIT NO.		DATE ISSUED		12. COUNTY OR PARISH		13. STATE	
30-045-26061		8-10-84		San Juan		NM	
15. DATE SPUDDED	16. DATE T.D. REACHED	17. DATE COMPL. (Ready to prod.)	18. ELEVATIONS (DF, RKB, RT, GR, ETC.)*	19. ELEV. CASINGHEAD			
10-19-84	10-25-84	12-31-84	5878' GR	5866 GR			
20. TOTAL DEPTH, MD & TVD	21. PLUG, BACK T.D., MD & TVD	22. IF MULTIPLE COMPL., HOW MANY*	23. INTERVALS DRILLED BY	ROTARY TOOLS	CABLE TOOLS		
7090' KB	7073' KB	---	→	0-TD			
24. PRODUCING INTERVAL(S), OF THIS COMPLETION—TOP, BOTTOM, NAME (MD AND TVD)*						25. WAS DIRECTIONAL SURVEY MADE	
6854' - 7073' KB Dakota						No	
26. TYPE ELECTRIC AND OTHER LOGS RUN						27. WAS WELL CORED	
Run #1 GR-SP-DILL, GR-CDL-CNL Caliper, Run #2 GR-DIL, GR-CDL- CALIPER						No	
28. CASING RECORD (Report all strings set in well)							
CASING SIZE	WEIGHT, LB./FT.	DEPTH SET (MD)	HOLE SIZE	CEMENTING RECORD		AMOUNT PULLED	
9 5/8"	36.0	305' KB	12 1/4"	225 sx 265CF B + 2% CACL2		+ 1/4#/sx cellofla	
7"	23.0	3130' KB	8 3/4"	1st Stg-55sx 101CF 65-35-6		+ 2% CACL2 + 1/4#	
				sx celloflakes. Tail w/ 100		100 sx 118CF B+2%	
				CACL2 + 1/4#/sx celloflakes.		2nd stg- *	
29. LINER RECORD				30. TUBING RECORD			
SIZE	TOP (MD)	BOTTOM (MD)	SACKS CEMENT*	SCREEN (MD)	SIZE	DEPTH SET (MD)	PACKER SET (MD)
4 1/2"	2985' KB	7087' KB	See Reverse		2 3/8"	7003' KB	
31. PERFORATION RECORD (Interval, size and number)				32. ACID, SHOT, FRACTURE, CEMENT SQUEEZE, ETC.			
2 JSPF 33', 66 holes 6854'-77' Dakota 7063'-73'				DEPTH INTERVAL (MD)			AMOUNT AND KIND OF MATERIAL USED
				6854'-7073' KB			Acidize w/1400 gals 15% wgt'd HCL.
							Frac w/62,300 gals 30# xlgel
							81,800# 20/40 sd.
33.* PRODUCTION							
DATE FIRST PRODUCTION		PRODUCTION METHOD (Flowing, gas lift, pumping—size and type of pump)			WELL STATUS (Producing or shut-in)		
11-14-84		Flowing			Shut-in		
DATE OF TEST	HOURS TESTED	CHOKE SIZE	PROD'N. FOR TEST PERIOD	OIL—BBL.	GAS—MCF.	WATER—BBL.	GAS-OIL RATIO
12-31-84	3 hrs.	3/4"	→		101.1		
FLOW, TUBING PRESS.	CASING PRESSURE	CALCULATED 24-HOUR RATE	OIL—BBL.	GAS—MCF.	WATER—BBL.	OIL GRAVITY-API (CORR.)	
48	252	→		809			
34. DISPOSITION OF GAS (Sold, used for fuel, vented, etc.)						TEST WITNESSED BY	
To be sold							
35. LIST OF ATTACHMENTS						ACCEPTED FOR RECORD	
To forward logs							
36. I hereby certify that the foregoing and attached information is complete and correct as determined from all available records							
SIGNED		TITLE			DATE		
John McKinney		Sr. Regulatory Analyst			JAN 23 1985 1-11-85		

\*(See Instructions and Spaces for Additional Data on Reverse Side)

Title 18 U.S.C. Section 1001, makes it a crime for any person knowingly and willfully to make to any department or agency of the United States any false, fictitious or fraudulent statements or representations as to any matter within its jurisdiction.

\* 190sx 350CF 65-35-6 + 2% CACL2 + 1/4#/sx celloflake. Tail w/75sx 89CF B+2% CACL2+1/4#/sx cel

\* 4½ Liner Cement Detail - 340 sx 625 ~~65-35-6~~ + .6% CF-10. Tail w/ 100 sx 118 CF B + .6% CF-10.

37. SUMMARY OF POROUS ZONES: (Show all important zones of porosity and contents thereof; cored intervals; and all drill-stem, tests, including depth interval tested, cushion used, time tool open, flowing and shut-in pressures, and recoveries):

FORMATION	TOP	BOTTOM	DESCRIPTION, CONTENTS, ETC.	GEOLOGIC MARKERS		
				NAME	MEAS. DEPTH	TRUE VERT. DEPTH
OJO Alamo	1540'	1600'	Sandstone & siltstone	Greenhorn	6755' KB	
Kirland	1600'	2265'	Shale w/ siltstone			
Fruitland	2265'	2538'	Shale, siltstone, & coal beds			
Pictured Cliffs	2538'	2650'	Shale, sandstone			
Lewis	2650'	4170'	Shale			
Cliffhouse	4170'	4350'	Siltstone & shale			
Menefee	4350'	4750'	Siltstone & shale			
Point Lookout	4750'	4930'	Sandstone & siltstone			
Mancos	4930'	6000'	Shale			
Gallup	6000'	6755'	Shale, siltstone			
Graneros	6870'	6850'	Shale			
Dakota	6850'	TD	Sandstone, siltstone & shale			

UNITED STATES  
DEPARTMENT OF THE INTERIOR  
BUREAU OF LAND MANAGEMENT

SUBMIT IN TRIPLICATE\*  
(Other instructions on re-  
verse side)

Form approved  
Budget Bureau No. 1004-0135  
Expires August 31, 1985

5. LEASE DESIGNATION AND SERIAL NO.

SF-079511-A

6. IF INDIAN, ALLOTTEE OR TRIBE NAME

7. UNIT AGREEMENT NAME

8. FARM OR LEASE NAME

Florance

9. WELL NO.

44E

10. FIELD AND POOL, OR WILDCAT

Basin Dakota

11. SEC., T., R., M., OR BLK. AND  
SURVEY OR AREA

Sec. 31, T30N, R8W

12. COUNTY OR PARISH 13. STATE

San Juan

NM

SUNDRY NOTICES AND REPORTS ON WELLS

(Do not use this form for proposals to drill or to deepen or plug back to a different reservoir.  
Use "APPLICATION FOR PERMIT—" for such proposals.)

1. OIL WELL ☐ GAS WELL ☒ OTHER

2. NAME OF OPERATOR

Tenneco Oil Company

3. ADDRESS OF OPERATOR

P. O. Box 3249, Englewood, CO 80155

4. LOCATION OF WELL (Report location clearly and in accordance with any State requirements.  
See also space 17 below.)  
At surface

480' FSL, 340' FEL

NOV 29 1984

14. PERMIT NO.

30-045-26061

15. ELEVATIONS (Show whether SF, ST, OR, etc.)

5866' GR

16. Check Appropriate Box To Indicate Nature of Notice, Report, or Other Data

NOTICE OF INTENTION TO:

TEST WATER SHUT-OFF

FRACURE TREAT

SHOOT OR ACIDIZING

REPAIR WELL

(Other)

PULL OR ALTER CASING

MULTIPLE COMPLETE

ABANDON\*

CHANGE PLANS

SUBSEQUENT REPORT OF:

WATER SHUT-OFF

FRACURE TREATMENT

SHOOTING OR ACIDIZING

(Other)

REPAIRING WELL

ALTERING CASING

ABANDONMENT\*

(Note: Report results of multiple completion on Well  
Completion or Recompletion Report and Log form.)

17. DESCRIBE PROPOSED OR COMPLETED OPERATIONS (Clearly state all pertinent details, and give pertinent dates, including estimated date of starting any  
proposed work. If well is directionally drilled, give subsurface locations and measured and true vertical depths for all markers and zones perti-  
nent to this work.)\*

11/12/84: MIRUSU. NDWH, NUBOP. RIH w/tbg, bit sub & 3-7/8 bit.

11/13/84: Tag cmt @6980. Drld to PBTD @7073. PT csg to 3500 psi, OK. Circ hole w/1% KCl.  
Spot 500 gal 7-1/2% DI HCl @7073.

11/14/84: Perf Dakota w/2 JSPF 6854-77, 7063-73 (33', 66 holes). Acidized w/1400 gal 15%  
wgtd HCL. Frac well w/62,300 gal 30## XL gel & 81,800# 20/40 sd. Well screened out w/12,300  
gal of 3#/gal sd on form.

11/15/84; RIH, tag sd fill @4500. Reversed out to PBTD. PU 2-3/8 tbg & land @7003. NDBOP,  
NUWH, RDMOSU. Kick well around w/N<sub>2</sub>.

RECEIVED

DEC 10 1984

OIL CON. DIV.  
DIST. 3

18. I hereby certify that the foregoing is true and correct

SIGNED

TITLE

Sr. Regulatory Analyst

DATE

11/20/84

(This space for Federal or State office use)

APPROVED BY

TITLE

DEC 06 1984

CONDITIONS OF APPROVAL, IF ANY:

FARMINGTON RESOURCE AREA

RV

SM

\*See Instructions on Reverse Side

NMOC

Title 18 U.S.C. Section 1001, makes it a crime for any person knowingly and willfully to make to any department or agency of the  
United States any false, fictitious or fraudulent statements or representations as to any matter within its jurisdiction.

Form approved  
Budget Bureau No. 1004-0135  
Expires August 31, 1985

## SUNDRY NOTICES AND REPORTS ON WELLS

(Do not use this form for proposals to drill or to deepen or plug back to a different reservoir.  
Use "APPLICATION FOR PERMIT—" for such proposals.)

1. OIL <input type="checkbox"/> GAS <input checked="" type="checkbox"/> OTHER <input type="checkbox"/> 2. NAME OF OPERATOR Tenneco Oil Company 3. ADDRESS OF OPERATOR P. O. Box 3249 4. LOCATION OF WELL (Report location clearly and in accordance with any State requirements. See also space 17 below.) At surface 480' FSL, 340' FEL RECEIVED NOV 13 1984 BUREAU OF LAND MANAGEMENT 14. PERMIT NO. 30-045-26061 15. ELEVATIONS (Show whether by, or on, old) 5866' GR		7. UNIT AGREEMENT NAME 8. FARM OR LEASE NAME Florance 9. WELL NO. 44E 10. FIELD AND POOL, OR WILDCAT Basin Dakota 11. SEC., T., R., M., OR B.L. AND SURVEY OR AREA Sec. 31, T30N, R8W 12. COUNTY OR PARISH San Juan 13. STATE NM	
--	--	---	--

**Check Appropriate Box To Indicate Nature of Notice, Report, or Other Data**

NOTICE OF INTENTION TO:		SUBSEQUENT REPORT OF:	
TEST WATER SHUT-OFF	<input type="checkbox"/> <input type="checkbox"/> <input type="checkbox"/> <input type="checkbox"/>	PULL OR ALTER CASING	<input type="checkbox"/> <input type="checkbox"/> <input type="checkbox"/> <input type="checkbox"/>
FRACTURE TREAT	<input type="checkbox"/> <input type="checkbox"/> <input type="checkbox"/> <input type="checkbox"/>	MULTIPLE COMPLETE	<input type="checkbox"/> <input type="checkbox"/> <input type="checkbox"/> <input type="checkbox"/>
SHOOT OR ACIDIZE	<input type="checkbox"/> <input type="checkbox"/> <input type="checkbox"/> <input type="checkbox"/>	ABANDON*	<input type="checkbox"/> <input type="checkbox"/> <input type="checkbox"/> <input type="checkbox"/>
REPAIR WELL	<input type="checkbox"/> <input type="checkbox"/> <input type="checkbox"/> <input type="checkbox"/>	CHANGE PLANS	<input type="checkbox"/> <input type="checkbox"/> <input type="checkbox"/> <input type="checkbox"/>
(Other)		(Other) <u>progress report</u> <small>(NOTE: Report results of multiple completion on Well Completion or Recompletion Report and Log form.)</small>	

17. DESCRIBE PROPOSED OR COMPLETED OPERATIONS (Clearly state all pertinent details, and give pertinent dates, including estimated date of starting any proposed work. If well is directionally drilled, give subsurface locations and measured and true vertical depths for all markers and zones pertinent to this work).\*

10/19/84: MIRURT. Spud well @1:15 PM w/4 Corners rig #7. Drill to 306. RU & run 7 jts  
293' 9-5/8 36# K-55 STC csg, set @305. Cmt w/225 sx (265CF) CL-B + 2% CaCl<sub>2</sub> + 1/4#/sx  
celloflake. PD @7:45 PM 10/19. Circ 10 bbls cmt to surf. WOC. PT BOPE to 1000 psi, OK.

10/22/84: RU & ran 81 jts (3162') 7" 23# K-55 STC csg, set @3130, FC @3090, DV @1625. Circ cmt w/55 sx (101CF) 65:35:6 + 2%  $\text{CaCl}_2$  + 1/4#/sx celloseal. Tailed w/100 sx (118CF) CL-B + 2%  $\text{CaCl}_2$  + 1/4#/sx celloseal. PD @10:30 AM 10/22. Cmt 2nd stg w/190sx (350CF) 65:35:6 + same additives. Tail w/75 sx (89CF) CL-B + same additives. PD @3 PM 10/22. WOC. NUBOPE & test to 1500 psi, OK. Drill out. Dry up & drill ahead. Ran temp survey, TOC @700.

10/25/84: Drill to TD @7090. Prep to run liner.

10/26/84: RU & ran 3 jts (125') 4-1/2, 11.6# K-55 STC & 93 jts (3964') 4-1/2 10.5# K-55 STC csg, set @7087, FC @7044), TOL @2985. Cmt w/340sx (625CF) 65:35:6 + .6% CF-10. Tail w/100sx (118CF) CL-B + .6% CF-10. PD @9:15AM 10/26. Circ 2.5 bbl cmt to surf. Rig released 1 PM 10/26/84.

RECEIVED

DEC 10 1984

OIL CON. DIV.

18. I hereby certify that the foregoing is true and correct.

**SIGNED**

**TITLE**

Sr. Regulatory Analyst

DATE \_\_\_\_\_

DATE 10/30/84

(This space for Federal or State office use)

**APPROVED BY**

**TITLE**

DATE \_\_\_\_\_

**CONDITIONS OF APPROVAL, IF ANY:**

DEC 06 1984

FARMINGTON RESOURCE AREA

RV

**\*See Instructions on Reverse Side**

# NMOCC

Title 18 U.S.C. Section 1001, makes it a crime for any person knowingly and willfully to make to any department or agency of the United States any false, fictitious or fraudulent statements or representations as to any matter within its jurisdiction.

UNITED STATES  
DEPARTMENT OF THE INTERIOR  
GEOLOGICAL SURVEY

30-045-36061

APPLICATION FOR PERMIT TO DRILL, DEEPEN, OR PLUG BACK

1a. TYPE OF WORK  
DRILL ☒ DEEPEN ☐ PLUG BACK ☐

b. TYPE OF WELL  
OIL WELL ☐ GAS WELL ☒ OTHER ☐ SINGLE ZONE ☒ MULTIPLE ZONE ☐

2. NAME OF OPERATOR  
Tenneco Oil Company

3. ADDRESS OF OPERATOR  
P.O. Box 3249, Englewood, CO 80155

4. LOCATION OF WELL (Report location clearly and in accordance with any State requirements.)  
At surface  
480' FSL, 340' FEL  
At proposed prod. zone

RECEIVED

APR 20 1984

14. DISTANCE IN MILES AND DIRECTION FROM NEAREST TOWN OR POST OFFICE\*  
8 mi NE of Blanco, NM

BUREAU OF LAND MANAGEMENT  
FARMINGTON RESOURCE AREA

15. DISTANCE FROM PROPOSED\*  
LOCATION TO NEAREST  
PROPERTY OR LEASE LINE, FT.  
(Also to nearest drlg. unit line, if any) 340'

16. NO. OF ACRES IN LEASE  
1273.88

18. DISTANCE FROM PROPOSED LOCATION\*  
TO NEAREST WELL, DRILLING, COMPLETED,  
OR APPLIED FOR, ON THIS LEASE, FT.

19. PROPOSED DEPTH  
7110'

21. ELEVATIONS (Show whether DF, RT, GR, etc.)  
5866' GR

DRILLING OPERATIONS AUTHORIZED ARE  
SUBJECT TO COMPLIANCE WITH ATTACHED  
"GENERAL REQUIREMENTS"

23. PROPOSED CASING AND CEMENTING PROGRAM

SIZE OF HOLE	SIZE OF CASING	WEIGHT PER FOOT	SETTING DEPTH
12-1/4"	9-5/8"	36#	± 300'
8-3/4"	7"	23#	± 3130'
6-1/4"	4-1/2"	10.5#	± 7000'
6-1/4"	4-1/2"	11.6#	± 7110'

17. NO. OF ACRES ASSIGNED  
TO THIS WELL  
E 297.10

20. ROTARY OR CABLE TOOLS  
Rotary

22. APPROX. DATE WORK WILL START\*  
ASAP after 6/30/84

This action is subject to administrative  
appeal pursuant to 30 CFR 290.  
QUANTITY OF CEMENT

Circulate to surface  
Circulate to surface - 2 stages  
Circulate to liner top  
Circulate to liner top

See Attached

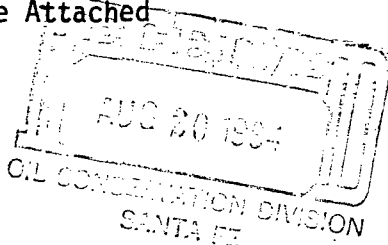

RECEIVED  
AUG 14 1984  
OIL CON. DIV.  
DIST. 3

IN ABOVE SPACE DESCRIBE PROPOSED PROGRAM: If proposal is to deepen or plug back, give data on present productive zone and proposed new productive zone. If proposal is to drill or deepen directionally, give pertinent data on subsurface locations and measured and true vertical depths. Give blowout preventer program, if any.

24. SIGNED [Signature] TITLE Production Analyst

(This space for Federal or State office use)

PERMIT NO. \_\_\_\_\_ APPROVAL DATE \_\_\_\_\_

APPROVED BY \_\_\_\_\_ TITLE \_\_\_\_\_

CONDITIONS OF APPROVAL, IF ANY:

NWH 583

alt

54-21104-1086 NMOCC

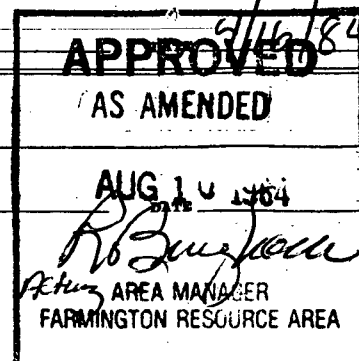



All distances must be from the outer boundaries of the Section.

Operator <b>Tenneco Oil Company</b>			Lease <b>Florance</b>		Well No. <b>111E</b>
Unit Letter <b>P</b>	Section <b>31</b>	Township <b>30N</b>	Range <b>8W</b>	County <b>San Juan</b>	
Actual Footage Location of Well: <b>480</b> feet from the <b>South</b> line and <b>340</b> feet from the <b>East</b> line					
Ground Level Elev. <b>5866 Gr.</b>	Producing Formation <b>Dakota</b>		Pool <b>Basin Dakota</b>		Dedicated Acreage: <b>297.10</b> Acres

1. Outline the acreage dedicated to the subject well by colored pencil or hatchure marks on the plat below.
2. If more than one lease is dedicated to the well, outline each and identify the ownership thereof (both as to working interest and royalty).
3. If more than one lease of different ownership is dedicated to the well, have the interests of all owners been consolidated by communitization, unitization, force-pooling, etc?

☐ Yes ☐ No If answer is "yes," type of consolidation \_\_\_\_\_

If answer is "no," list the owners and tract descriptions which have actually been consolidated. (Use reverse side of this form if necessary.) \_\_\_\_\_

No allowable will be assigned to the well until all interests have been consolidated (by communitization, unitization, forced-pooling, or otherwise) or until a non-standard unit, eliminating such interests, has been approved by the Commission.

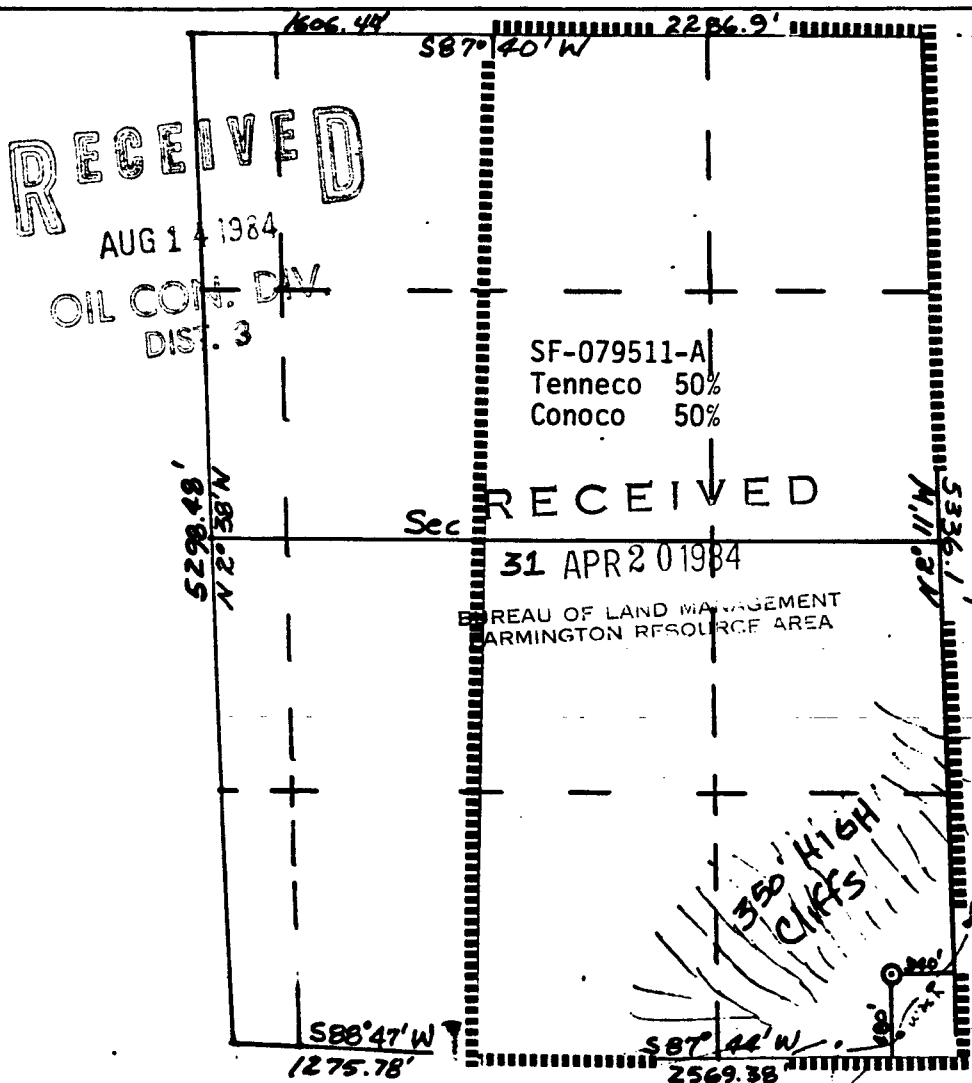

CERTIFICATION

I hereby certify that the information contained herein is true and complete to the best of my knowledge and belief.

*John Orr*

Name

John Orr

Position

Production Analyst

Company

Tenneco Oil Company

Date

April 16, 1984

I hereby certify that the well location shown on this plat was plotted from field notes of actual surveys made by me or under my supervision, and that the same is true and correct to the best of my knowledge and belief.

Date Surveyed

March 14, 1984

Registered Professional Engineer and Land Surveyor

*Fred E. Kerr Jr.*  
Fred E. Kerr Jr.

Certificate No.

3950

