



By DEC

Roger M. Kirk
Division Administrative-Manager
Production Department
Hobbs Division
North American Production

Conoco Inc.
P.O. Box 460
726 East Michigan
Hobbs, NM 88240
(505) 393-4141

October 25, 1984

NSL-1939
Rule-104 F II
Release 11-18-84

New Mexico Oil Conservation Division
P.O. Box 2088
Santa Fe, NM 87501

Attention Mr. Gilbert Quintana

Gentlemen:

Request for an Unorthodox Location on the Proposed Tuesday Federal No. 1,
810' FSL and 990' FWL, Section 34-19S-29E, Eddy County, New Mexico

Conoco respectfully requests approval of an unorthodox location for the subject well based upon the location's geology. The Tuesday Federal No. 1 is proposed as a dual gas well to the Strawn and Morrow horizons. Three zones are scheduled to be tested: the Strawn "A", Strawn "B", and the middle Morrow. Based upon the attached isopach maps, the successful testing of all three zones is greatly dependant on the porosity development at the location in question. As shown on the isopachs, the porosity pinches out rapidly toward the east, especially in the case of the Strawn "A" zone. Further, since the radial flow rate into the wellbore is directly proportional to pay thickness, it is imperative that each of the zones be penetrated at a location which has sufficient thickness to obtain commercial production rates.

The enclosed Well Location Plat (form C-102) reflects that the location meets the requirements for administrative approval because it is not closer than 660' to the nearest side boundary or closer than 990' to the nearest end boundary of the proration unit.

Attached is a letter sent by certified mail notifying all offset operators of this application. Also included is an ownership map showing the offset operators.

If you should have any questions, please contact Danny Powell of this office.

Yours very truly,

Roger M. Kirk

DDP:tr

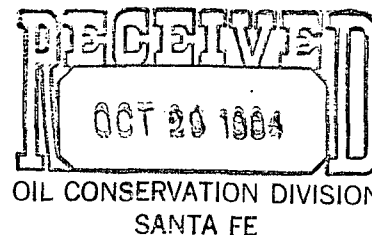

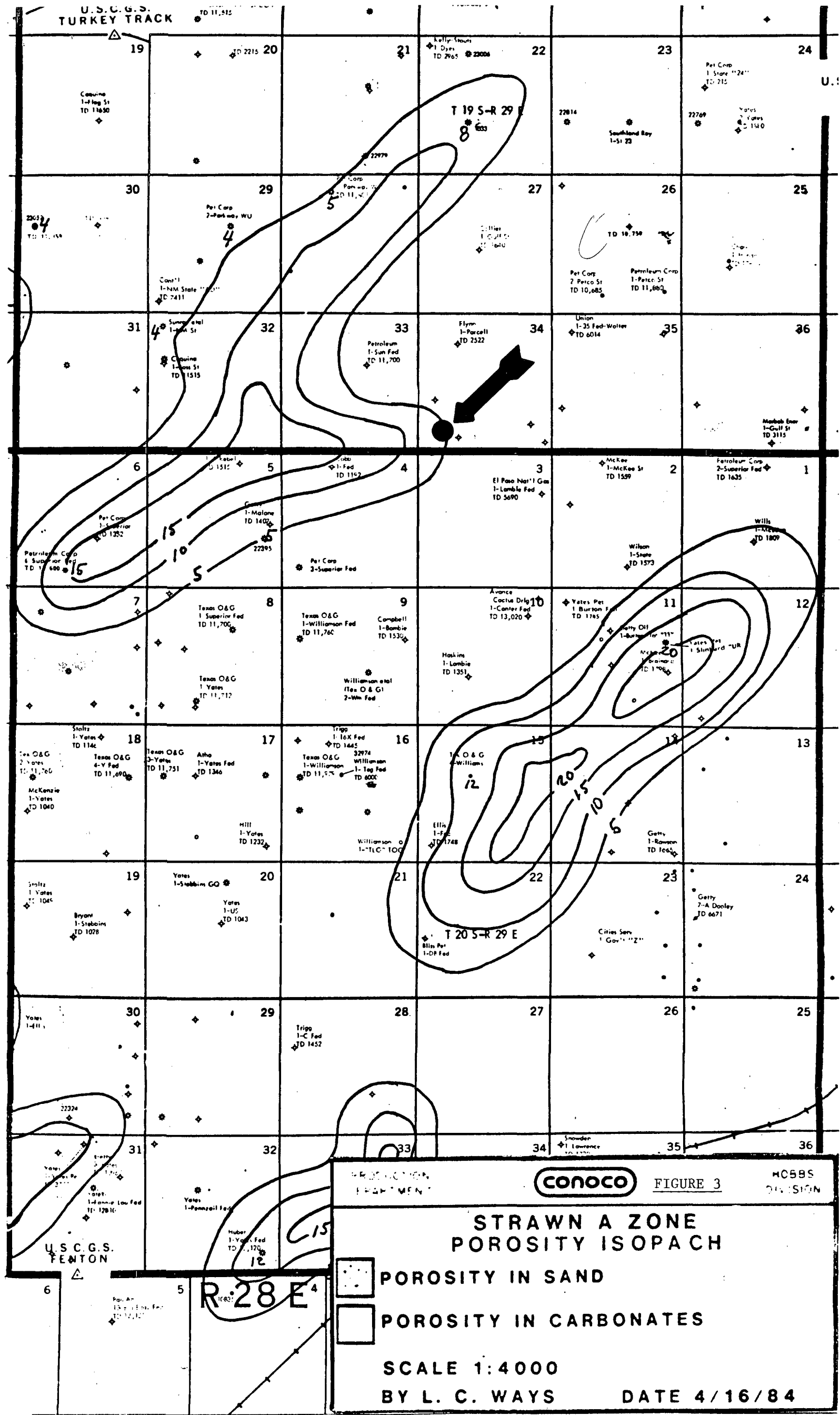

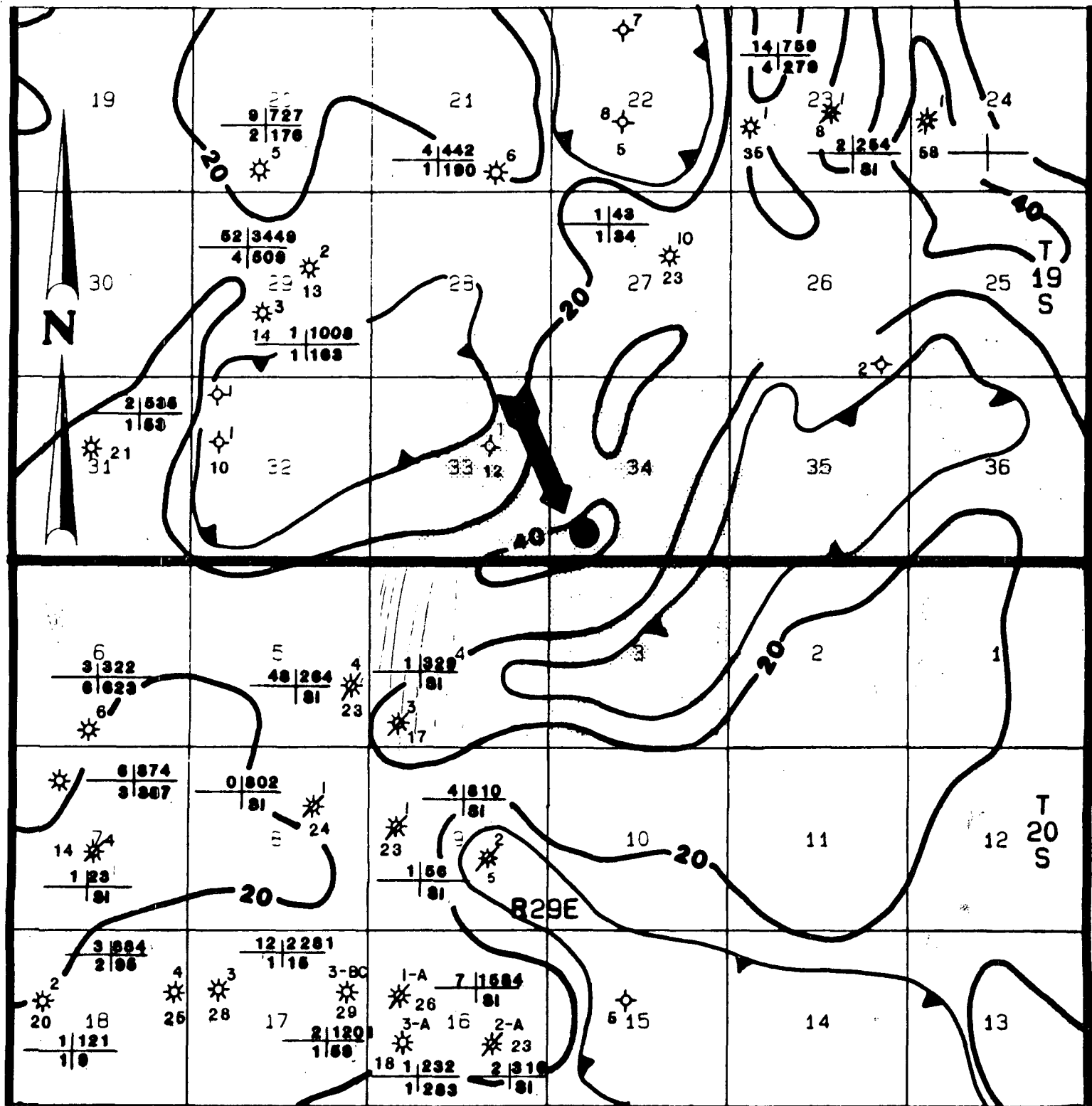

1-1-84

CUM MBO	MMCF
BOPD	MCFGPD

PRODUCTION DEPARTMENT	CONOCO	HOBBS DIVISION
<p>PROPOSED TUESDAY PROSPECT</p> <p>MIDDLE MORROW SAND ISOPACH</p> <p>CI: 20'</p> <p>EDDY COUNTY, NEW MEXICO</p>		
<p>SCALE</p> <p>0' 1000' 2000'</p>		

**NEW MEXICO OIL CONSERVATION COMMISSION
WELL LOCATION AND ACREAGE DEDICATION PLAT**

Form C-102
Supersedes C-128
Effective 1-1-85

All distances must be from the outer boundaries of the Section.

Operator CONOCO, INC.			Lease TUESDAY FEDERAL		Well No. 1
Unit Letter M	Section 34	Township 19S	Range 29E	County EDDY	
Actual Footage Location of Well: 810 feet from the SOUTH line and 990 feet from the WEST line					
Ground Level Elev. 3334.3	Producing Formation Strawn/Morrow		Pool Und. Strawn/Morrow	Dedicated Acreage: 320 Acres	

1. Outline the acreage dedicated to the subject well by colored pencil or hachure marks on the plat below.
2. If more than one lease is dedicated to the well, outline each and identify the ownership thereof (both as to working interest and royalty).
3. If more than one lease of different ownership is dedicated to the well, have the interests of all owners been consolidated by communitization, unitization, force-pooling, etc?

☐ Yes ☐ No If answer is "yes," type of consolidation _____

If answer is "no," list the owners and tract descriptions which have actually been consolidated. (Use reverse side of this form if necessary.) _____

No allowable will be assigned to the well until all interests have been consolidated (by communitization, unitization, forced-pooling, or otherwise) or until a non-standard unit, eliminating such interests, has been approved by the Commission.

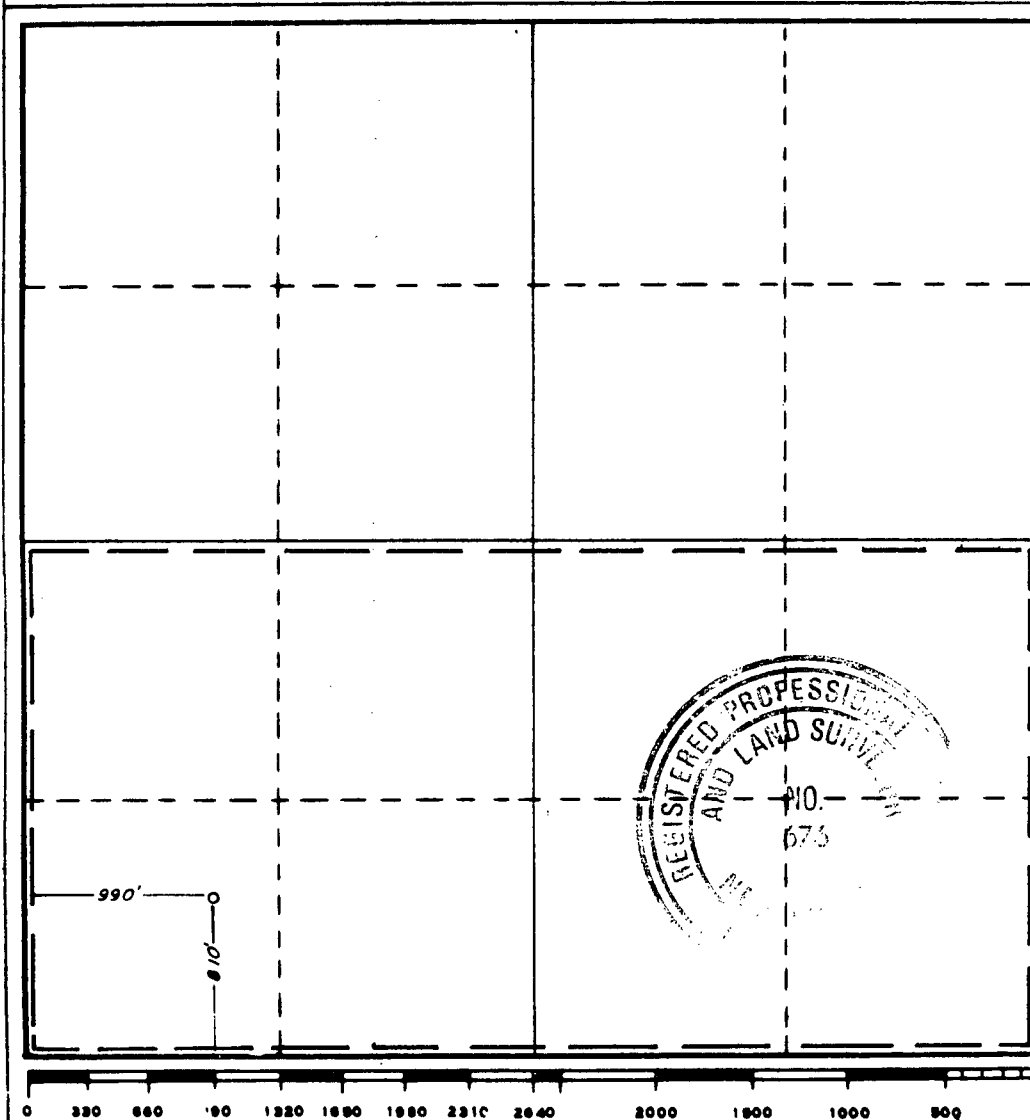

CERTIFICATION

I hereby certify that the information contained herein is true and complete to the best of my knowledge and belief.

Name *Robert M. Kuntz*
 Position *Division Administrative Manager*
 Company *Conoco Inc.*
 Date *10/26/84*

I hereby certify that the well location shown on this plat was plotted from field notes of actual surveys made by me or under my supervision, and that the same is true and correct to the best of my knowledge and belief.

Date Surveyed
10/23/84

Registered Professional Engineer and/or Land Surveyor

John W. West
 Certificate No. **JOHN W. WEST, 676**
RONALD J. EIDSON, 3239



Roger M. Kirk
Division Administrative Manager
Production Department
Hobbs Division
North American Production

Conoco Inc.
P.O. Box 460
726 East Michigan
Hobbs, NM 88240
(505) 393-4141

October 25, 1984

Southland Royalty Company
21 Desta Drive
Midland, Tx 79701

Gentlemen:

As required under Rule 104 (F) of the New Mexico Oil Conservation Division Rules and Regulations, this letter is your notification that Conoco is making application to the NMOCD for an unorthodox location on our Tuesday Federal No. 1, 810' FSL and 990' FWL, Section 34-19S-29E, Eddy County, New Mexico. A location plat is attached.

Yours very truly,

A handwritten signature in cursive script, appearing to read "Roger M. Kirk".

DDP:tr



Roger M. Kirk
Division Administrative Manager
Production Department
Hobbs Division
North American Production

Conoco Inc.
P.O. Box 460
726 East Michigan
Hobbs, NM 88240
(505) 393-4141

October 25, 1984

Petroleum Corporation of Delaware
3303 Lea Parkway
Dallas, TX 75219

Gentlemen:

As required under Rule 104 (F) of the New Mexico Oil Conservation Division Rules and Regulations, this letter is your notification that Conoco is making application to the NMOCD for an unorthodox location on our Tuesday Federal No. 1, 810' FSL and 990' FWL, Section 34-19S-29E, Eddy County, New Mexico. A location plat is attached.

Yours very truly,

A handwritten signature in cursive script that reads "Roger M. Kirk".

DDP:tr

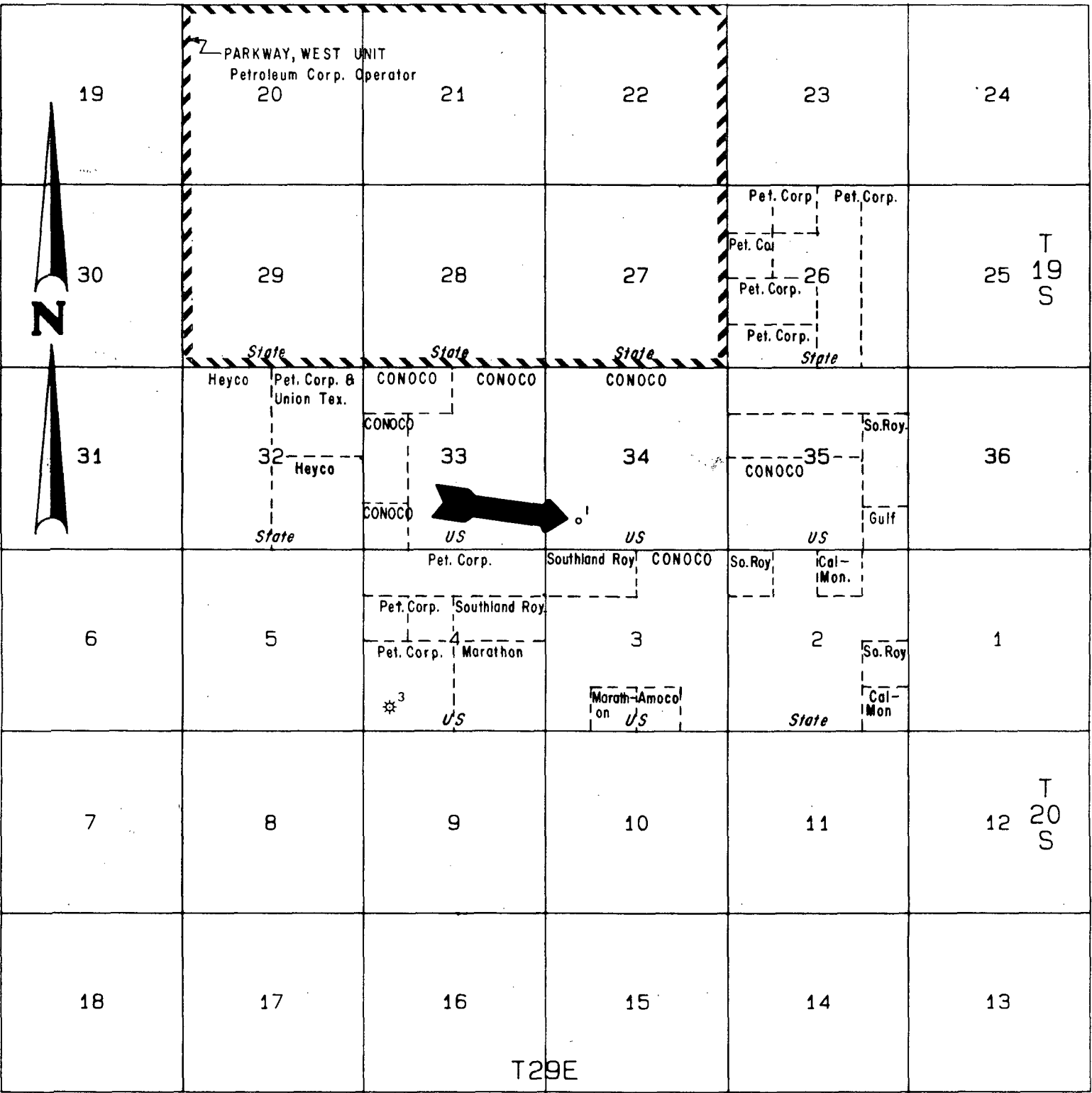

PRODUCTION
DEPARTMENT

CONOCO

NOBIS
DIVISION

EDDY COUNTY, NEW MEXICO

0 1000 2000