

*Release Nov 27, 1984*

*By DRC  
NSL-1944  
RULE 104 FLE)*

**El Paso**  
Exploration Company

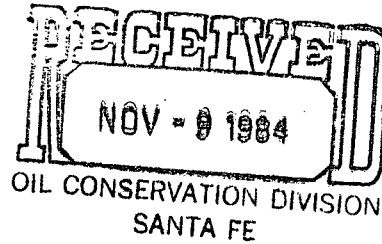

P. O. BOX 4289  
FARMINGTON, NEW MEXICO 87499-4289  
PHONE: 505-325-2841

November 7, 1984

Mr. Richard Stamets  
New Mexico Oil Conservation Division  
Post Office Box 2088  
Santa Fe, New Mexico 87501

Dear Mr. Stamets:

This is a request for administrative approval for an unorthodox gas well location in the Basin Dakota Pool.

It is intended to locate the El Paso Natural Gas Company's San Juan 30-6 Unit #22 at 2010' from the North line and 1960' from the East line of Section 9, T-30-N, R-6-W, Rio Arriba County, New Mexico.

The existence of Navajo Lake Reservoir in the Northwest corner of this section makes it impossible to build an orthodox gas well location.

A copy of this application is being submitted to all offset operators by certified mail with a request that they furnish your Santa Fe office with a Waiver of Objection, and return one copy to this office.

Plats showing the proposed well location and the lake in Section 9, along with an ownership plat, are attached.

Sincerely yours,

A handwritten signature in dark ink, appearing to read "G. W. Brink".

G. W. Brink  
Project Drilling Engineer

encl.

WAIVER

NorthWest Pipeline Company hereby waives objection to El Paso Natural Gas Company's application for an unorthodox location for their San Juan 30-6 Unit #22 as proposed above.

By: \_\_\_\_\_

Date: \_\_\_\_\_

UNITED STATES  
DEPARTMENT OF THE INTERIOR  
BUREAU OF LAND MANAGEMENT

APPLICATION FOR PERMIT TO DRILL, DEEPEN, OR PLUG BACK

1a. TYPE OF WORK

DRILL ☒

DEEPEN ☐

PLUG BACK ☐

b. TYPE OF WELL

OIL  
WELL ☐

GAS  
WELL ☒

OTHER

SINGLE  
ZONE ☒

MULTIPLE  
ZONE ☐

2. NAME OF OPERATOR

El Paso Natural Gas Company

3. ADDRESS OF OPERATOR

PO Box 4289, Farmington, NM 87499

4. LOCATION OF WELL (Report location clearly and in accordance with any State requirements.\*)

At surface

2010'N, 1960'E

At proposed prod. zone

14. DISTANCE IN MILES AND DIRECTION FROM NEAREST TOWN OR POST OFFICE\*

9 miles Northeast of Navajo City NM

15. DISTANCE FROM PROPOSED\*

LOCATION TO NEAREST

PROPERTY OR LEASE LINE, FT.

(Also to nearest drlg. unit line, if any) 1960'

16. NO. OF ACRES IN LEASE

Unit

17. NO. OF ACRES ASSIGNED  
TO THIS WELL

320.00

18. DISTANCE FROM PROPOSED LOCATION\*

TO NEAREST WELL, DRILLING, COMPLETED,

OR APPLIED FOR, ON THIS LEASE, FT. 5280'

19. PROPOSED DEPTH

7730'

20. ROTARY OR CABLE TOOLS

Rotary

21. ELEVATIONS (Show whether DF, RT, GR, etc.)

6237'GL

22. APPROX. DATE WORK WILL START\*

23.

PROPOSED CASING AND CEMENTING PROGRAM

SIZE OF HOLE	SIZE OF CASING	WEIGHT PER FOOT	SETTING DEPTH	QUANTITY OF CEMENT
12 1/4"	9 5/8"	36.0#	200'	130 cf circulated
8 3/4"	7"	20.0#	3370'	369 cf cover Ojo Alamo
6 1/4"	4 1/2"	11.6#	7730'	671 cf fill to inter.

Selectively perforate and sand water fracture the Dakota formation.

A 3000 psi WP and 6000 psi test double gate preventer equipped with blind and pipe rams will be used for blow out prevention on this well.

This gas is dedicated.

The N/2 of Section 9 is dedicated to this well.

IN ABOVE SPACE DESCRIBE PROPOSED PROGRAM: If proposal is to deepen or plug back, give data on present productive zone and proposed new productive zone. If proposal is to drill or deepen directionally, give pertinent data on subsurface locations and measured and true vertical depths. Give blowout preventer program, if any.

24.

SIGNED

*Dean Shadfield*

TITLE

Drilling Clerk

DATE

11-02-84

(This space for Federal or State office use)

PERMIT NO.

APPROVAL DATE

APPROVED BY

TITLE

DATE

CONDITIONS OF APPROVAL, IF ANY:

\*See Instructions On Reverse Side

## OIL CONSERVATION DIVISION

P. O. BOX 2088

SANTA FE, NEW MEXICO 87501

STATE OF NEW MEXICO  
OIL AND MINERALS DEPARTMENTForm C-107  
Revised 10-1

All distances must be from the outer boundaries of the Section.

Operator EL PASO NATURAL GAS COMPANY			Lease SAN JUAN 30-6 UNIT (NM 03416)		Well No. 22
Unit Letter G	Section 9	Township 30N	Range 6W	County Rio Arriba	
Actual Footage Location of Well: 2010 feet from the North line and 1960 feet from the East line					
Ground Level Elev. 6237	Producing Formation Dakota		Pool Basin	Dedicated Acreage: 320.00 Acres	

1. Outline the acreage dedicated to the subject well by colored pencil or hachure marks on the plat below.
2. If more than one lease is dedicated to the well, outline each and identify the ownership thereof (both as to working interest and royalty).
3. If more than one lease of different ownership is dedicated to the well, have the interests of all owners been consolidated by communitization, unitization, force-pooling, etc?

☒ Yes ☐ No If answer is "yes," type of consolidation Unitization

If answer is "no," list the owners and tract descriptions which have actually been consolidated. (Use reverse side of this form if necessary.)

No allowable will be assigned to the well until all interests have been consolidated (by communitization, unitization, forced-pooling, or otherwise) or until a non-standard unit, eliminating such interests, has been approved by the Commission.

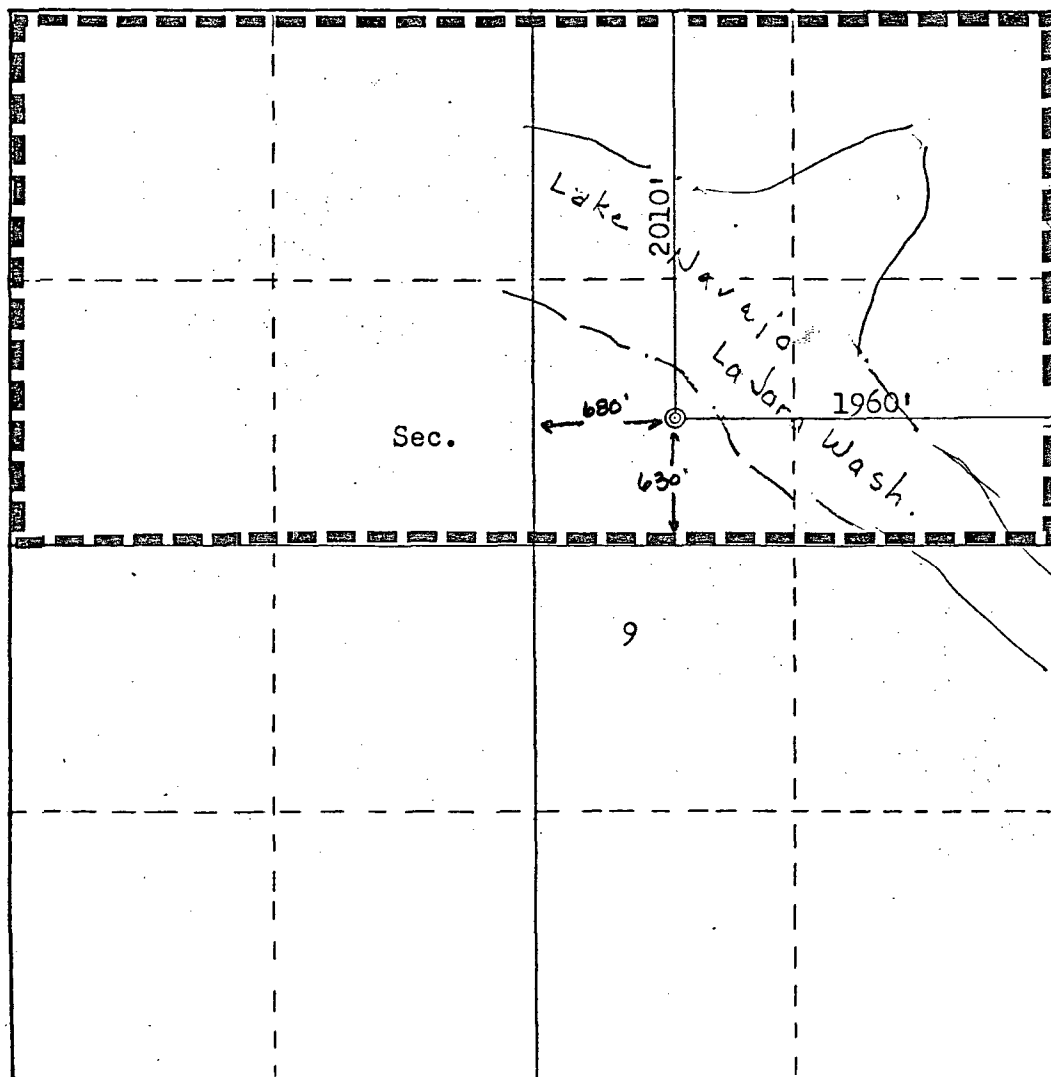

## CERTIFICATION

I hereby certify that the information contained herein is true and complete to the best of my knowledge and belief.

Name

Drilling Clerk

Position

El Paso Natural Gas Co

Company

Date

I hereby certify that the well location shown on this plat was plotted from field notes of actual surveys made by me or under my supervision, and that the same is true and correct to the best of my knowledge and belief.

Date Surveyed

October 22, 1984

Registered Professional Engineer and Land Surveyor

Fred B. Kern Jr.

Certificate No. 12345

# EL PASO NATURAL GAS COMPANY

Well Name San Juan 30-6 Unit #22, Basin Dakota

Footage---- 2010' FNL, 1960' FEL

## APPLICATION FOR NON-STANDARD LOCATION

County Rio Arriba State New Mexico Section 9 Township 30N Range 6W

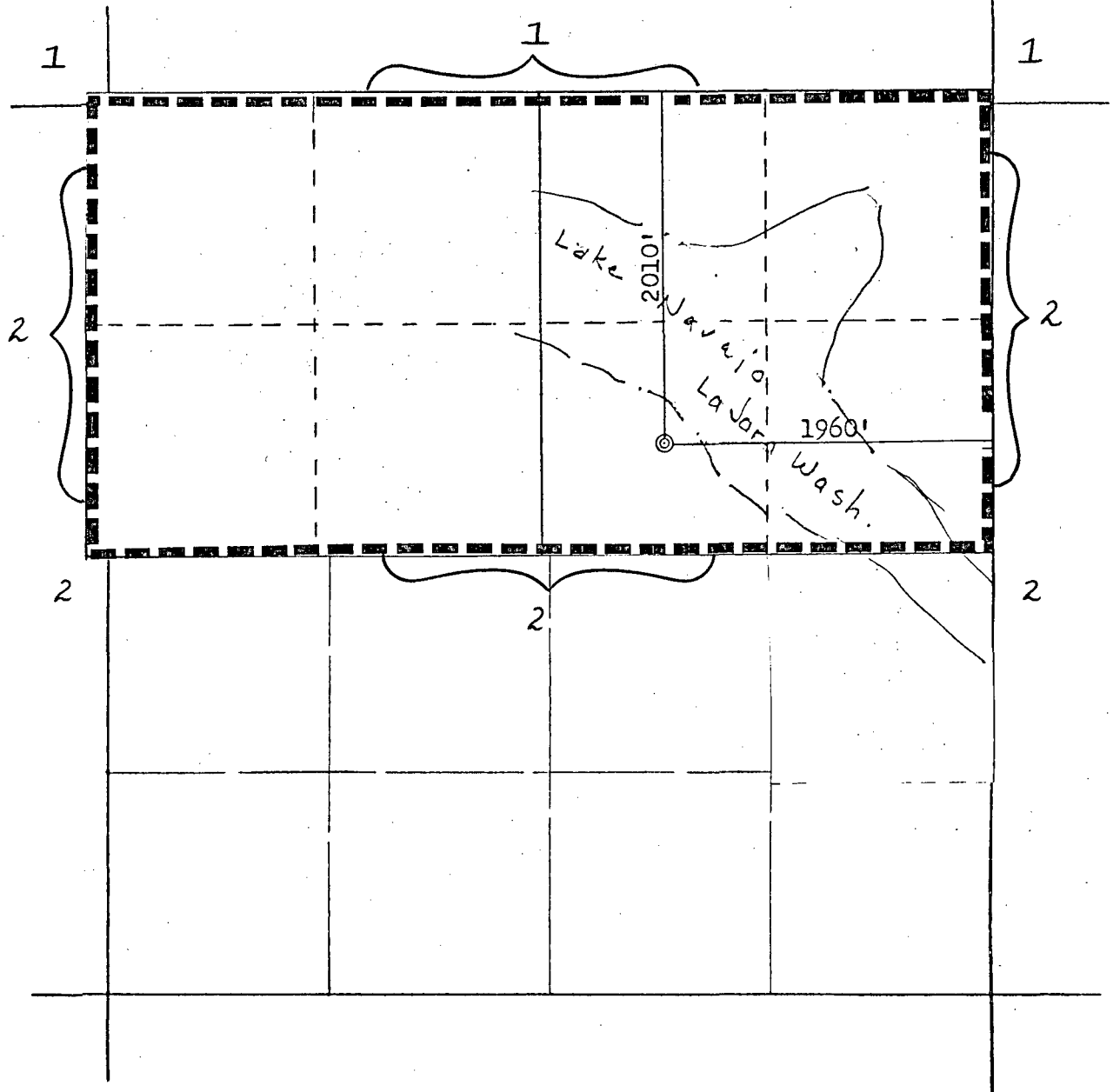

### REMARKS:

(1) Northwest Pipeline Corporation

(2) El Paso Natural Gas Company



STATE OF NEW MEXICO  
ENERGY AND MINERALS DEPARTMENT  
OIL CONSERVATION DIVISION  
AZTEC DISTRICT OFFICE

NSL-1944

1000 RIO BRAZOS ROAD  
AZTEC, NEW MEXICO 87410  
(505) 334-6178

OIL CONSERVATION DIVISION  
BOX 2088  
SANTA FE, NEW MEXICO 87501

DATE 11-16-84

RE: Proposed MC \_\_\_\_\_  
Proposed DHC \_\_\_\_\_  
Proposed NSL X \_\_\_\_\_  
Proposed SWD \_\_\_\_\_  
Proposed WFX \_\_\_\_\_  
Proposed PMX \_\_\_\_\_

RECEIVED  
NOV 23 1984  
OIL CONSERVATION DIVISION  
SANTA FE

Gentlemen:

I have examined the application dated 11-16-84  
for the EP Vaso Exploration Co. San Juan 30-6 Unit #22 G-9-30N-6W  
Operator Lease and Well No. Unit, S-T-R

and my recommendations are as follows:

Approved  
\_\_\_\_\_  
\_\_\_\_\_  
\_\_\_\_\_  
\_\_\_\_\_  
\_\_\_\_\_

Yours truly,

Eric Brund