

*No offsets
Release December 5, 1984*

By DEC

EXXON COMPANY, U.S.A.
POST OFFICE BOX 1600 • MIDLAND, TEXAS 79702-1600

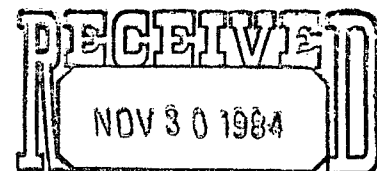

OIL CONSERVATION DIVISION

SANTA FE

NSL-1951

Rule-104F(I)

PRODUCTION DEPARTMENT
MIDCONTINENT DIVISION

November 27, 1984

Request for Approval of an
Unorthodox Location
Mary Federal Well No. 4
West Dark Canyon - Delaware
Eddy County, New Mexico

Mr. Richard L. Stamets, Director
Oil Conservation Commission
Energy and Minerals Department
P. O. Box 2088
Santa Fe, New Mexico 87501

SE/4 NE/4

Dear Mr. Stamets:

Exxon Corporation requests administrative approval of an unorthodox location for the subject well based upon topographic conditions. This location will be located nearer than 330 feet from the quarter - quarter section.

This location was chosen after considering several others. The well could not be drilled south of County Road 408 because of archeological findings and excessive mitigation requirements. The well also had to be a reasonable distance from County Road 408. The well could not be moved north or west because of the drainage. If the well was moved north of the drainage, it would end up on the flood plain of the Dark Canyon drainage. The best place for the well was between the drainage and the road. The well was moved to the east to avoid the gas pipe line and to allow for a wider area to build the location.

Exxon owns all acreage which offsets the unit so no offsets will be notified. Attached are a plat showing the road, pipe line, and drainage area and a plat of the area prepared by the archaeologist. Also, attached is a copy of the application for Permit to Drill and a plat New Mexico Form C102.

Please grant administrative approval to drill this well as an unorthodox location. If you need more information, please call me at (915) 686-4406.

Sincerely,

Melba Knipling

Melba Knipling
Unit Head
NGPA and Permits

MK/pl

xc: BLM, Carlsbad, NM
NMOCC, Artesia, NM

G.R.C Project:- R 8369.
 SITE:- GRGNM 120.

EXXON Company U.S.A.,
 Hanagan Undesignated Federal Well #1.
 T:23 S; R:25 E; Section 24, Centre, S $\frac{1}{2}$, SE $\frac{1}{4}$, NE $\frac{1}{4}$.
 (2071 F.N.L., 447 F.E.L), Eddy County, New Mexico.

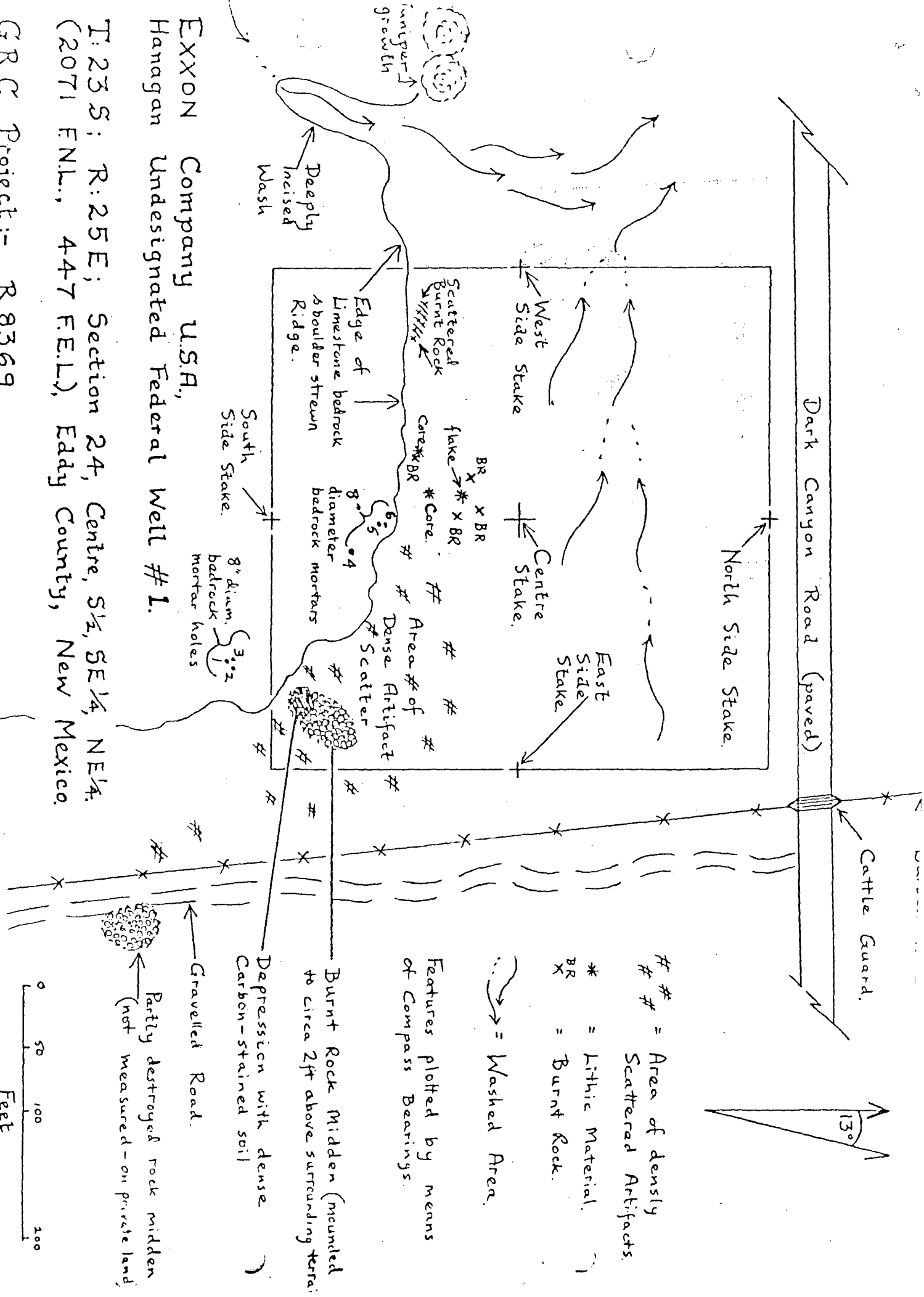

UNITED STATES
DEPARTMENT OF THE INTERIOR
GEOLOGICAL SURVEY

APPLICATION FOR PERMIT TO DRILL, DEEPEN, OR PLUG BACK

1a. TYPE OF WORK

DRILL ☒DEEPEN ☐PLUG BACK ☐

b. TYPE OF WELL

OIL
WELL ☒GAS
WELL ☐

OTHER

SINGLE
ZONE ☒MULTIPLE
ZONE ☐

2. NAME OF OPERATOR

Exxon Corporation

3. ADDRESS OF OPERATOR

P. O. Box 1600, Midland, TX 79702

4. LOCATION OF WELL (Report location clearly and in accordance with any State requirements.*)

At surface

1565' FNL & 200' FEL of Section

At proposed prod. zone

14. DISTANCE IN MILES AND DIRECTION FROM NEAREST TOWN OR POST OFFICE*

12 miles SW of Carlsbad

15. DISTANCE FROM PROPOSED*

LOCATION TO NEAREST
PROPERTY OR LEASE LINE, FT. 2400'
(Also to nearest drlg. unit line, if any) 200'

16. NO. OF ACRES IN LEASE

2520*

17. NO. OF ACRES ASSIGNED
TO THIS WELL

40

18. DISTANCE FROM PROPOSED LOCATION*

TO NEAREST WELL, DRILLING, COMPLETED,
OR APPLIED FOR, ON THIS LEASE, FT.

19. PROPOSED DEPTH

5400'

20. ROTARY OR CABLE TOOLS

Rotary

21. ELEVATIONS (Show whether DF, RT, GR, etc.)

3446' GR

22. APPROX. DATE WORK WILL START*

4th Quarter, 1984

23.

PROPOSED CASING AND CEMENTING PROGRAM

SIZE OF HOLE	SIZE OF CASING	WEIGHT PER FOOT	SETTING DEPTH	QUANTITY OF CEMENT
20"	16	65#	60'	Circ.
12-1/4"	8-5/8"	24#	1600' 1400'	Circ.
7-7/8"	5-1/2"	14, 15.5#	5400'	1000 sx.

BOP Program: 8-5/8" Type RRA 2000 psi See Spec's Attached.

Mud Program: 0 - 1600': FW Spud 8.4 - 8.6 ppg
1600 - 5400': CBW 8.8 - 9.2 ppg

*960 acres in Mary Federal lease.

A request is being made for approval of the unorthodox location from the NMOCC.

IN ABOVE SPACE DESCRIBE PROPOSED PROGRAM: If proposal is to deepen or plug back, give data on present productive zone and proposed new productive zone. If proposal is to drill or deepen directionally, give pertinent data on subsurface locations and measured and true vertical depths. Give blowout preventer program, if any.

24.

SIGNED

Melba Kripling

TITLE

Unit Head

DATE

11-16-84

(This space for Federal or State office use)

PERMIT NO.

APPROVAL DATE

APPROVED BY

TITLE

DATE

CONDITIONS OF APPROVAL, IF ANY:

Exxon Lease No. _____ NEW MEXICO OIL CONSERVATION COMMISSION
Lease No. _____ WELL LOCATION AND ACREAGE DEDICATION PLAT
Federal Lease No. _____ All distances must be from the outer boundaries of the Section.

Form C-102
Supersedes C-128
Effective 1-1-65

Operator Exxon Corporation			Lease MARY FEDERAL			Well No. 4		
Unit Letter H	Section 24	Township 23S	Range 25E	County EDDY				
Actual Footage Location of Well: 1565 feet from the NORTH line and 200 feet from the EAST line								
Ground Level Elev: 3446'		Producing Formation WEST, DARK CANYON-DELAWARE		Pool DELAWARE		Dedicated Acreage: 40 Acres		

1. Outline the acreage dedicated to the subject well by colored pencil or hatchure marks on the plat below.
2. If more than one lease is dedicated to the well, outline each and identify the ownership thereof (both as to working interest and royalty).
3. If more than one lease of different ownership is dedicated to the well, have the interests of all owners been consolidated by communitization, unitization, force-pooling, etc?

☐ Yes ☐ No If answer is "yes," type of consolidation _____

If answer is "no," list the owners and tract descriptions which have actually been consolidated. (Use reverse side of this form if necessary.) _____

No allowable will be assigned to the well until all interests have been consolidated (by communitization, unitization, forced-pooling, or otherwise) or until a non-standard unit, eliminating such interests, has been approved by the Commission.

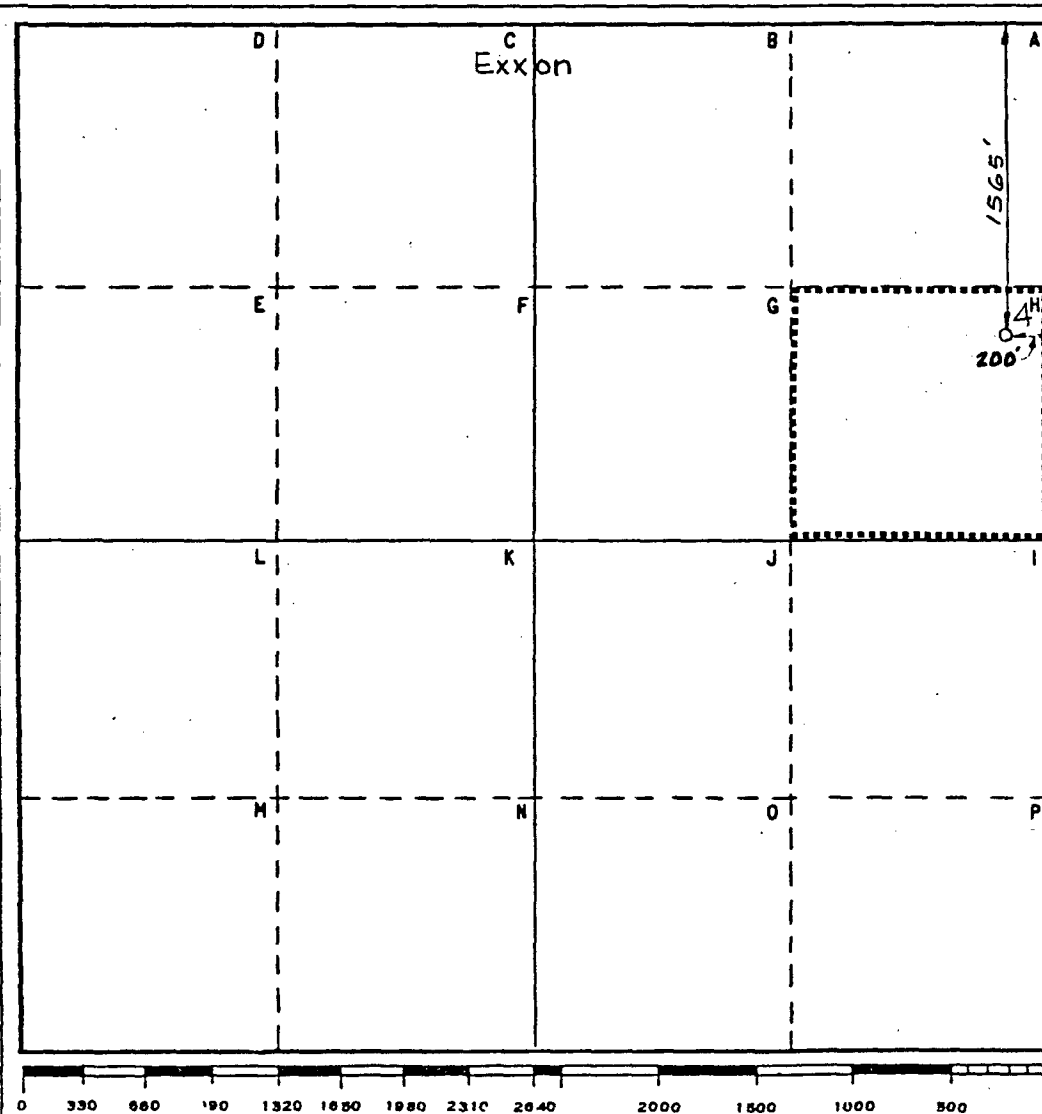

CERTIFICATION

I hereby certify that the information contained herein is true and complete to the best of my knowledge and belief.

Name
Melba Knippling
Position

UNIT HEAD

Company Exxon Corporation
Box 1600 Midland, Texas

Date
11-15-84

I hereby certify that the well location shown on this plat was plotted from field notes of actual surveys made by me or under my supervision, and that the same is true and correct to the best of my knowledge and belief.

Date Surveyed
11-09-84

Registered Professional Engineer
and/or Land Surveyor

Bruce R. Pennell
Certificate No.