

Release 1-21-85

By Dec

156-1972

RULE - 104F(2)



Amoco Production Company

Petroleum Center Building
501 Airport Drive
Farmington, New Mexico 87401
505-325-8841

W. J. Holcomb
District Manager

December 27, 1984

Mr. Gilbert Quintana
New Mexico Oil Conservation Division
P. O. Box 2088
Santa Fe, NM 87501

File: DDL-1309-400.1

Application for Unorthodox Location
Romero Gas Com "A" No. 1A
Otero Chacra and Blanco Mesaverde Fields
San Juan County, New Mexico

Amoco Production Company hereby requests approval of an unorthodox well location for the Romero Gas Com "A" No. 1A. The proposed location is 1430' FSL x 1645' FEL of Section 27, T29N, R10W, San Juan County, New Mexico.

This well was restaked in the unorthodox location indicated above in order to stay out of irrigated fields as requested by the surface owner.

A copy of this application is being sent by certified mail to the offset lease holders, Southern Union, Union Texas, El Paso Natural Gas, with the request that they furnish you a waiver of objection and return one copy of the same to me.

Sincerely,

KRJ/gw

Attachments

cc: Mr. Ernie Bush
New Mexico Oil Conservation Division
1000 Rio Brazos Road
Aztec, NM 87410

_____ hereby waives objection to Amoco's application for an unorthodox location as proposed above.

By: _____ Date: _____

DEC 31 1984 Dual Completion

RECEIVED Dedicated Acreage

Blanco Mesaverde - 320 Acres
S/2 of Section 27, T29N, R10W

Otero Chacra - 160 Acres

SE1/4 Section 27, T29N R10W

Fee land

RIOW

21	22	23
	<p>Union Texas ▲ Albright #25</p> <p>Union Texas Albright #7E</p>	<p>So. Royalty Hare #19E</p>
28	27	26
Amoco	<p>Amoco So. Union EPNG</p> <p>Amoco Romero A #1</p>	Amoco
33	34	35
<p>So. Union</p> <p>Union Texas Zachry #22</p> <p>Union Texas Zachry #20</p>	<p>So. Union</p> <p>Union Texas Zachry #27</p> <p>Union Texas Zachry #23</p>	<p>n/2 EPNG</p> <p>Union Texas Zachry #21</p> <p>Union Texas Zachry #17E</p>

T 29 N

▲ OTERO CHACRA
■ BLANCO MESAVERDE

All distances must be from the outer boundaries of the Section.

Operator AMOCO PRODUCTION COMPANY			Lease Romero Gas Com "A"		Well No. 1A
Unit Letter J	Section 27	Township 29N	Range 10W	County San Juan	
Actual Footage Location of Well: 1430 feet from the South line and 1645 feet from the East line					
Ground Level Elev. 5521	Producing Formation		Pool Otero Chacra & Blanco MV	Dedicated Acreage: 160/320	Acres

1. Outline the acreage dedicated to the subject well by colored pencil or hachure marks on the plat below.
2. If more than one lease is dedicated to the well, outline each and identify the ownership thereof (both as to working interest and royalty).
3. If more than one lease of different ownership is dedicated to the well, have the interests of all owners been consolidated by communitization, unitization, force-pooling, etc?

☒ Yes ☐ No If answer is "yes," type of consolidation Communitized

If answer is "no," list the owners and tract descriptions which have actually been consolidated. (Use reverse side of this form if necessary.)

No allowable will be assigned to the well until all interests have been consolidated (by communitization, unitization, forced-pooling, or otherwise) or until a non-standard unit, eliminating such interests, has been approved by the Commission.

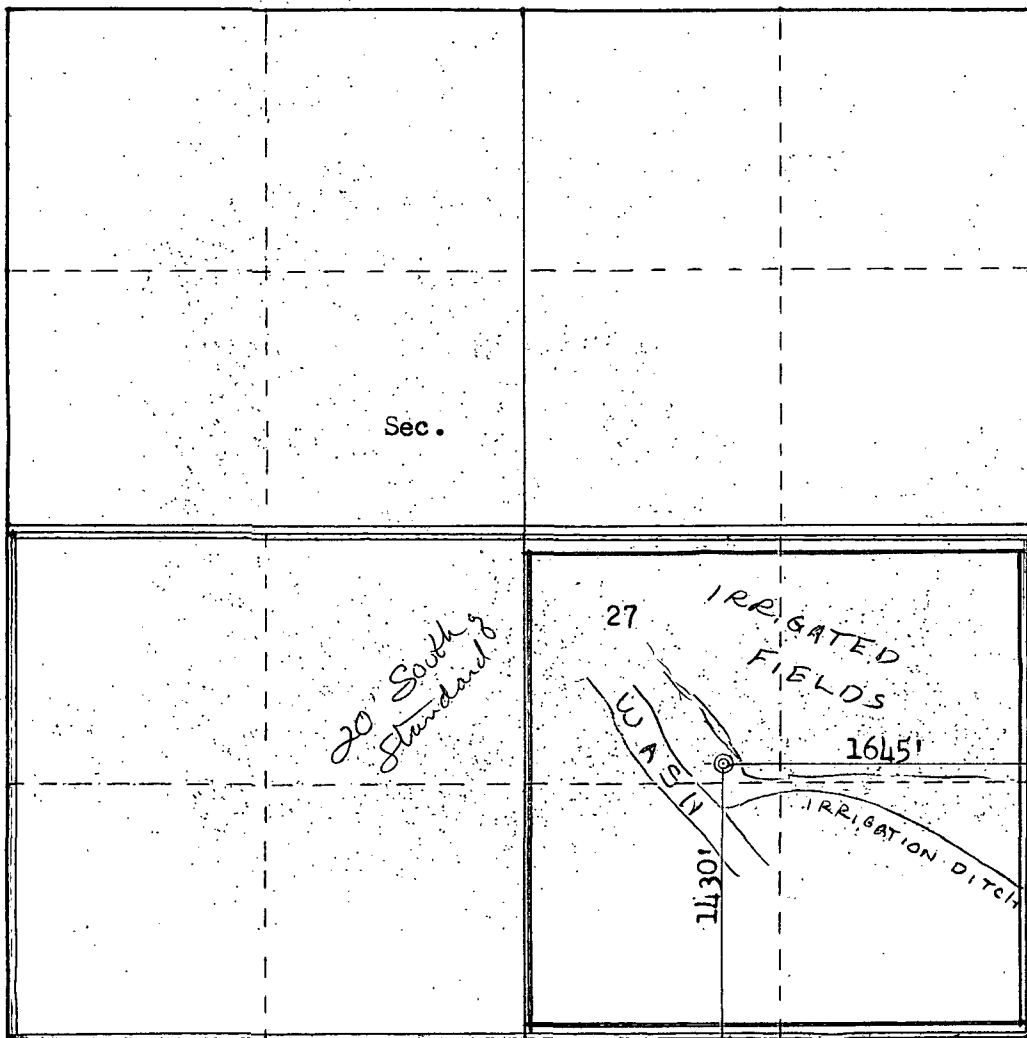

Scale: 1"=1000'

CERTIFICATION

I hereby certify that the information contained herein is true and complete to the best of my knowledge and belief.

Name
B. D. Shaw
Position
Adm. Supervisor
Company
Amoco Production Company
Date
12-21-84

I hereby certify that the well location shown on this plat was plotted from field notes of actual surveys made by me or under my supervision, and that the same is true and correct to the best of my knowledge and belief.

Date Surveyed
December 11, 1984
Registered Professional Engineer and Land Surveyor
Fred B. Kerr Jr.
Certificate No. **3950**

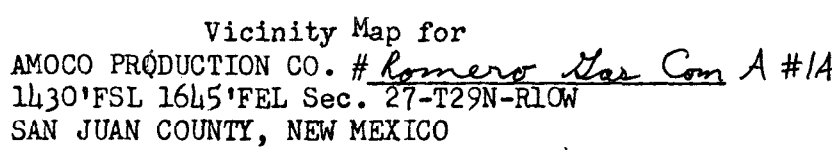



Donald W. Johnson
Division Manager
Production Department
Hobbs Division
North American Production

Conoco Inc.
P.O. Box 460
726 East Michigan
Hobbs, NM 88240
(505) 393-4141

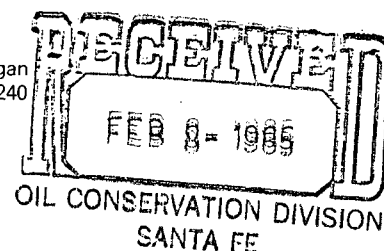

January 31, 1985

State of New Mexico
Energy and Minerals Department
Oil Conservation Division
P.O. Box 2088
Santa Fe, New Mexico 87501

Attention R. L. Stamets

Dear Mr. Stamets:

Conoco Inc., as operator of the State S-19 No. 2 Saltwater Disposal Well (SWD), requests a maximum surface pressure limitation increase from 441 psig to 500 psig.

The surface injection pressure increase is needed because:

1. Low capacity (Kh) of the State S-19 No. 2 SWD well has drastically reduced the injection rate of the State S-19 No. 2 SWD well as reservoir pressure increases. This reduced injection rate, which is necessary to maintain surface injection pressures below the allowed 441 psig, will require Conoco to haul and dispose of produced water. This additional cost will increase lease operating costs; thus, decreasing the economic life of the lease.

Conoco believes that the increased surface pressure will not cause migration of the injected fluid from the Seven Rivers-Grayburg-San Andres formation through the plugged and abandoned wells shown in finding No. (4) of Division Order No. R-7282 or in any other matter for the following reasons:

1. Calculated fracture gradient, based on the initial hydraulic fracture, is 1.2 PSI/FT (see figure No. 1 & calculation Sheet No. 1.)
2. Calculated reservoir radius is 1588' based on cumulative gas production (see calculation Sheet No. 2). Therefore, it is highly unlikely that water injected in the State S-19 No. 2 SWD well will migrate to wells approximately 2640 feet away.
3. Based on material balance and volumetric calculations 4,153,168 STBW can be injected into the State S-19 No. 2 SWD before initial reservoir pressure is reached. Therefore, we believe that fluid will not be able to migrate from the Seven-Rivers Queen-Grayburg-San Andres formations through the previously mentioned plugged and abandoned wells until a minimum cumulative volume of 4,153,168 STBW has been injected. At present injection rates, it is estimated that this will require at least 17 years of injection.

Conoco believes that increasing the injection pressure to 500 psi is the only means by which the State S-19 No. 2 SWD well can be used as an efficient saltwater disposal well because:

1. Calculated skin is - 2.01 and calculated capacity is only 93 md-ft, based on pressure fall off analysis.
2. The well was acidized in 1-13, 1984 with no improvement in injectivity.

Conoco, respectfully requests that immediate attention be given to this request. Please notify Mr. Hugh Ingram of your decision at the address above.

Thank you.



Donald W. Johnson

CDKD:bkw



#70

Calculation Sheet No. 1
Calculation of Fracture Gradient

ISIP from Figure No. 1 treatment report 1900 psig
Fluid used was 35° API gravity.

$$S.G. = \frac{141.5}{(131.5 + 35)} = 0.8498$$

$$\text{Hydrostatic head} = 2280 \times .8498 \times 0.433 = 839 \text{ psig.}$$

$$\text{Fracture Gradient} = \frac{[1900 + 839] \text{ PSI}}{2280 \text{ FT}} = 1.20 \text{ PSI/FT}$$

"Engineered Well Services"
GENERAL OFFICES - MIDLAND, TEXAS

Old Well ☐ New Well ☒ Contractor Denver Drilling Co. State 2-10-57

Section Treated Grayburg Total Depth (GWD) 2289 Type Treatment 9356 lease oil 1000# Adomite - 500 Special L.T.

Fmtn. Grayburg Co. or Parish Eddy Field Receipt No. 2551

Depth 2289 to 2299 No. of Pumps 12 x 6 Sand 9300

District Hobbs Date 7-2-57 Stage No. 1 this section

Operator Continental Oil Company Lease State S-19 Well No. 2

Field Wildcat County Eddy State N.M.

Depth TD/KB 2450 Size Tubing 2" elue Tbg. Perf. 2280 Type Pkr. Guib. KVA hct at 2280

Size Casing 4 1/2 Weight 9.5 Set at thru Size Hole Below

Size Liner Weight Set From to

Casing Perforations (show from, to, w/holes per foot) 2289 - 99 4/ft.

Production prior to this treatment no test - new well

Hole loaded with water No. pumps used 2 Type Fracmaster 1200

Misc. Info. to treat casing perforations below hookwall packer with 9356 gal. lease oil - 1000# adomite and 9300# 20/40 sand

Total Number Sealers to use 7000 In. stages Operator max. trng. press. 6000

Test Western Xns to 7000 psi Type recording chart used Electronic

Time	Treating Pressure	Bbl. Fluid pumped/ In. ftm.	Inl. Rate BBL/Min.	REMARKS
12:20	2500	1000	9.0	start oil to circulate water out of hole via casing
12:29	2500	1000	8.3	hole circulated - shut down to pull 5 joints tubing
1:24	2500	1000	8.2	set packer and pressure casing to 900
1:25	2500	1000	8.2	start acid to spot via tubing
1:27	2000	1200	12	formation break 2500 to 2200 - speed pump
1:29	4200	1100	21	all acid - start break down - both pumps
1:56	4200	1100	249	formation taking fluid at 4300 - start frac to spot
2:00	4000	1100	282	all frac - start flush and over flush
2:08	1900	1000		all flush and over flush - treatment complete
				shut in pressure

CALCULATION SHEET NO. 2

Calculation of Z Factor

Specific gravity of gas
0.70

BHT = 81°F
 $t_B = 60^\circ$ $P_B = 15.025$ PSIA

Initial pressure = 433.6 psia

From Figure 3-9

$T_{pc} = 385^\circ R$ $P_{pc} = 665$ psia

$T_{pr} = \frac{541}{385} = 1.4$

$P_{pr} = \frac{(433.6)}{665} = 0.651$

Figure 3-7 $Z = 0.930$

Properties of Gases

105

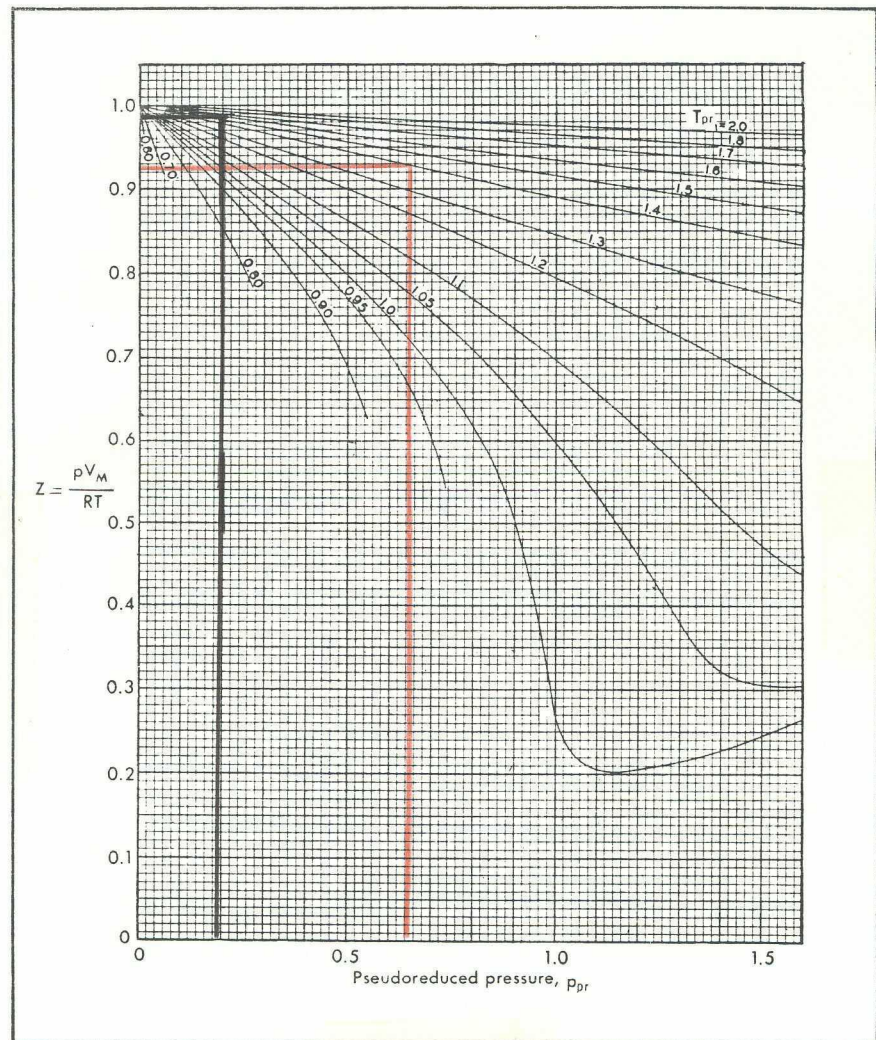

FIG. 3-7. Compressibility factors for natural gases at low reduced pressures. (Brown et al., *Natural Gasoline and the Volatile Hydrocarbons*, NGAA, 1948, 33, with permission).

Calculation of Z factor @ average reservoir pressure of 129.9

From figure 3-9

$$T_{pc} = 385$$

$$P_{pc} = 665 \text{ PSIA}$$

$$T_{pr} = \frac{541}{385} = 1.4$$

Estimated from SI fluid level

$$P_{pr} = \frac{129.9}{665} = 0.195$$

From figure 3-7 $Z = 0.98$

Calculation of reservoir pore volume based on cumulative production.

Given:

Initial pressure = 433.6 PSIA

Reservoir temperature = 81°F

Standard pressure = 15.025 PSIA

Standard temperature = 60°

Cumulative Production = 701 x 10⁶ SCF

Average Reservoir Pressure = 129.9 PSIA

Gas Deviation factor @ 433.6 = 0.93

Gas Deviation factor @ 129.9 = 0.98

$$\frac{P_{sc} C_P}{T_{sc}} = \frac{P_i V_i}{Z_i T} - \frac{P_f V_i}{Z_f T}$$

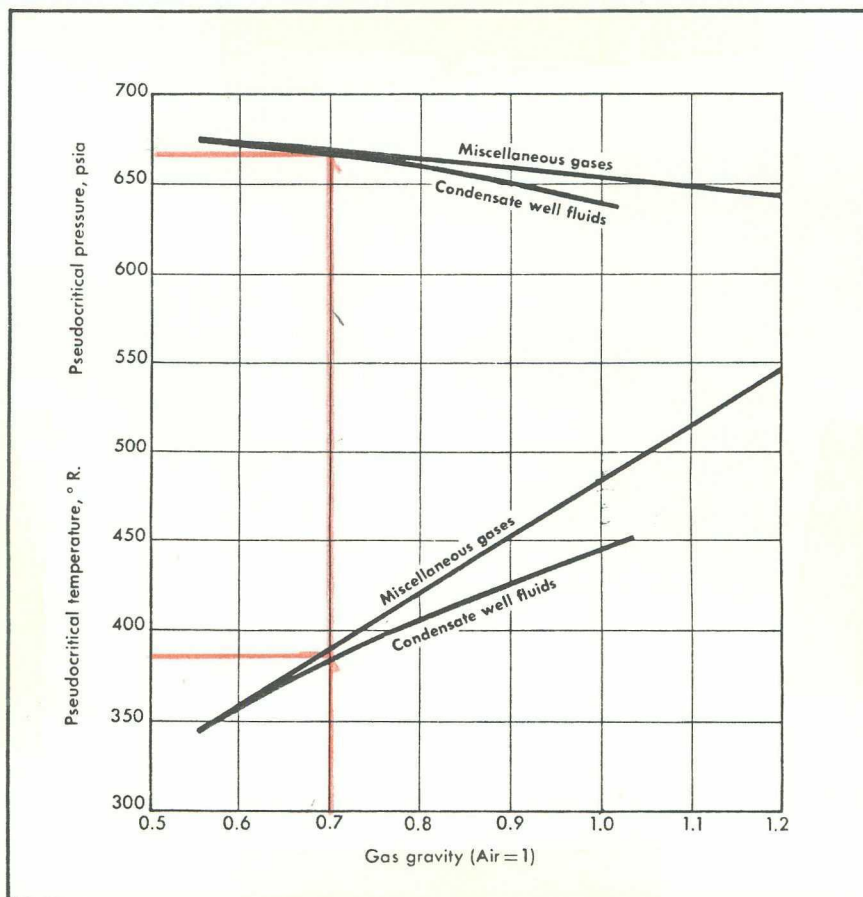

FIG. 3-9. Pseudocritical properties of natural gases. (Brown et al., *Natural Gasoline and the Volatile Hydrocarbons*, NGAA, 1948, 44, with permission).

$$\frac{15.025 (701 \times 10^6)}{520} = \frac{433.6 V_i}{0.93 (541)} - \frac{129.9 V_i}{0.98 (541)}$$

$$\begin{aligned} 2.0254856 \times 10^7 &= 0.86181 V_i - 0.245 V_i \\ 2.0254856 \times 10^7 &= 0.61681 V_i \end{aligned}$$

$$\begin{aligned} V_i &= 3.2838080 \times 10^7 \text{ CF} \\ V_i &= 5.8482778 \times 10^6 \text{ BBLs} \end{aligned}$$

$$\frac{1}{7758 \text{ bbl/acre ft}} \times 5.848278 \times 10^6 \text{ bbls} = 754 \text{ acre Ft}$$

Initial gas in place

$$\frac{P_i V_i}{Z_i T} \times \frac{T_{sc}}{P_{sc}} = G$$

$$\frac{433.6 (3.28 \times 10^7)}{0.93 (541)} \times \frac{520}{15.025} = 978 \text{ MMSCFG}$$

$$\text{Recovery factor} = \frac{701 \times 10^6}{978 \times 10^6} = 71\%$$

Water that can be injected:

Water that can be injected

$$7758 \text{ bbl/acre Ft} \times 754 \text{ acre Ft.} \times 0.71 \text{ recovery} = 4,153,168 \text{ bbls}$$

Calculation of Input Radius

Assume a uniform radial input

$$\text{NEP} = 37'$$

$$43560 \text{ FT}^2/\text{acre} \times \frac{754 \text{ Acre} - \text{FT}}{37 \text{ FT} \times 0.14 \times .8 \phi \times \text{Sat Gas}} = 7,925,734 \text{ FT}^2$$

$$r = \sqrt{\frac{7,925,734}{3.1416}} = 1,588.34 \text{ FT}$$



Amoco Production Company

Petroleum Center Building
501 Airport Drive
Farmington, New Mexico 87401
505-325-8841

W. J. Holcomb
District Manager

December 27, 1984

Mr. Gilbert Quintana
New Mexico Oil Conservation Division
P. O. Box 2088
Santa Fe, NM 87501

File: DDL-1309-400.1

Application for Unorthodox Location
Romero Gas Com "A" No. 1A
Otero Chacra and Blanco Mesaverde Fields
San Juan County, New Mexico

Amoco Production Company hereby requests approval of an unorthodox well location for the Romero Gas Com "A" No. 1A. The proposed location is 1430' FSL x 1645' FEL of Section 27, T29N, R10W, San Juan County, New Mexico.

This well was restaked in the unorthodox location indicated above in order to stay out of irrigated fields as requested by the surface owner.

A copy of this application is being sent by certified mail to the offset lease holders, Southern Union, Union Texas, El Paso Natural Gas, with the request that they furnish you a waiver of objection and return one copy of the same to me.

Sincerely,

Original Signed
W. J. Holcomb
by DDL

KRJ/gw

Attachments

cc: Mr. Ernie Bush
New Mexico Oil Conservation Division
1000 Rio Brazos Road
Aztec, NM 87410

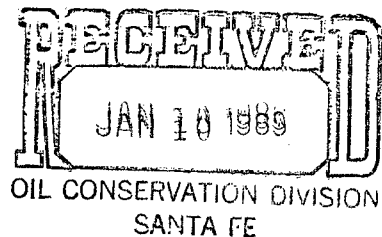

El Paso Exploration Company hereby waives objection to Amoco's application for an unorthodox location as proposed above.

By: *Ernie Bush*

Date: January 8, 1985

RETURN THIS COPY TO NMOC.



Amoco Production Company

Petroleum Center Building
501 Airport Drive
Farmington, New Mexico 87401
505-325-8841

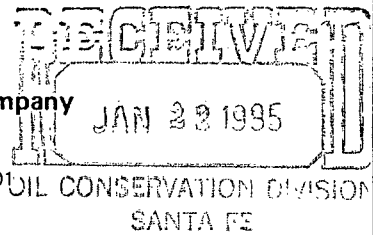

W. J. Holcomb
District Manager

December 27, 1984

Mr. Gilbert Quintana
New Mexico Oil Conservation Division
P. O. Box 2088
Santa Fe, NM 87501

File: DDL-1309-400.1

Application for Unorthodox Location
Romero Gas Com "A" No. 1A
Otero Chacra and Blanco Mesaverde Fields
San Juan County, New Mexico

Amoco Production Company hereby requests approval of an unorthodox well location for the Romero Gas Com "A" No. 1A. The proposed location is 1430' FSL x 1645' FEL of Section 27, T29N, R10W, San Juan County, New Mexico.

This well was restaked in the unorthodox location indicated above in order to stay out of irrigated fields as requested by the surface owner.

A copy of this application is being sent by certified mail to the offset lease holders, Southern Union, Union Texas, El Paso Natural Gas, with the request that they furnish you a waiver of objection and return one copy of the same to me.

Sincerely,

Original Signed
W. J. Holcomb
by DDL

KRJ/gw

Attachments

cc: Mr. Ernie Bush
New Mexico Oil Conservation Division
1000 Rio Brazos Road
Aztec, NM 87410

UNION TEXAS PETROLEUM hereby waives objection to Amoco's application for an unorthodox location as proposed above.

By: Will J. Hehe

Date: 1/15/85

DISTRICT MANAGER

RETURN THIS COPY TO NMOCD.



W. J. Holcomb
District Manager

April 15, 1985

Amoco Production Company

Petroleum Center Building
501 Airport Drive
Farmington, New Mexico 87401
505-325-8841

Amended NSL-1972

Mr. Gilbert Quintana
New Mexico Oil Conservation Division
P. O. Box 2088
Santa Fe, NM 87501

File: DDL-414-400.1

Application for Unorthodox Location
Romero Gas Com "A" No. 1A
Otero Chacra and Blanco Mesaverde Fields
San Juan County, New Mexico

Amoco Production Company hereby requests approval of an unorthodox well location for the Romero Gas Com "A" No. 1A. The proposed location is 1240' FSL x 700' FEL of Section 27, T29N, R10W, San Juan County, New Mexico.

This well was restaked a second time in the unorthodox location indicated above in order to avoid the surface owners' irrigation pipelines.

A copy of this application is being sent to the lease holders, Southern Union, Union, the request that they furnish you a copy of the same to me.

Sincerely,

Original Signed
W. J. Holcomb
by BDS
LJM/ct

Attachments

✓ cc: Mr. Ernie Bush
New Mexico Oil Conservation Divi
1000 Rio Brazos Road
Aztec, NM 87410

Reviewed 5-9-85
looks okay.
off okay.

Verbal from E. Busch
5-14-85

D
DIV.

J. D. Cutter
Denver

_____ hereby waives objection to Amoco's application for an unorthodox location as proposed above.

AM18

**NEW MEXICO OIL CONSERVATION COMMISSION
WELL LOCATION AND ACREAGE DEDICATION PLAT**

Form C-102
Supersedes C-100
Effective 1-1-65

All distances must be from the outer boundaries of the Section.

Operator MOGO PRODUCTION COMPANY			Lease ROMERO GAS COM "A"		Well No. 1A
Section 27	Township 29N	Range 10W	County San Juan		

Actual Footage Location of Well:
 240 feet from the South line and 700 feet from the East line
 and Level Elev: **525**
 Producing Formation: **Chacra/Mesaverde**
 Pool: **Otero Chacra/ Blanco MV**
 Dedicated Acreage: **160/320** Acres

1. Outline the acreage dedicated to the subject well by colored pencil or hatchure marks on the plat below.
2. If more than one lease is dedicated to the well, outline each and identify the ownership thereof (both as to working interest and royalty).
3. If more than one lease of different ownership is dedicated to the well, have the interests of all owners been consolidated by communitization, unitization, force-pooling, etc?

☒ Yes ☐ No If answer is "yes," type of consolidation communitized

If answer is "no," list the owners and tract descriptions which have actually been consolidated. (Use reverse side of this form if necessary.)

No allowable will be assigned to the well until all interests have been consolidated (by communitization, unitization, forced-pooling, or otherwise) or until a non-standard unit, eliminating such interests, has been approved by the Commission.

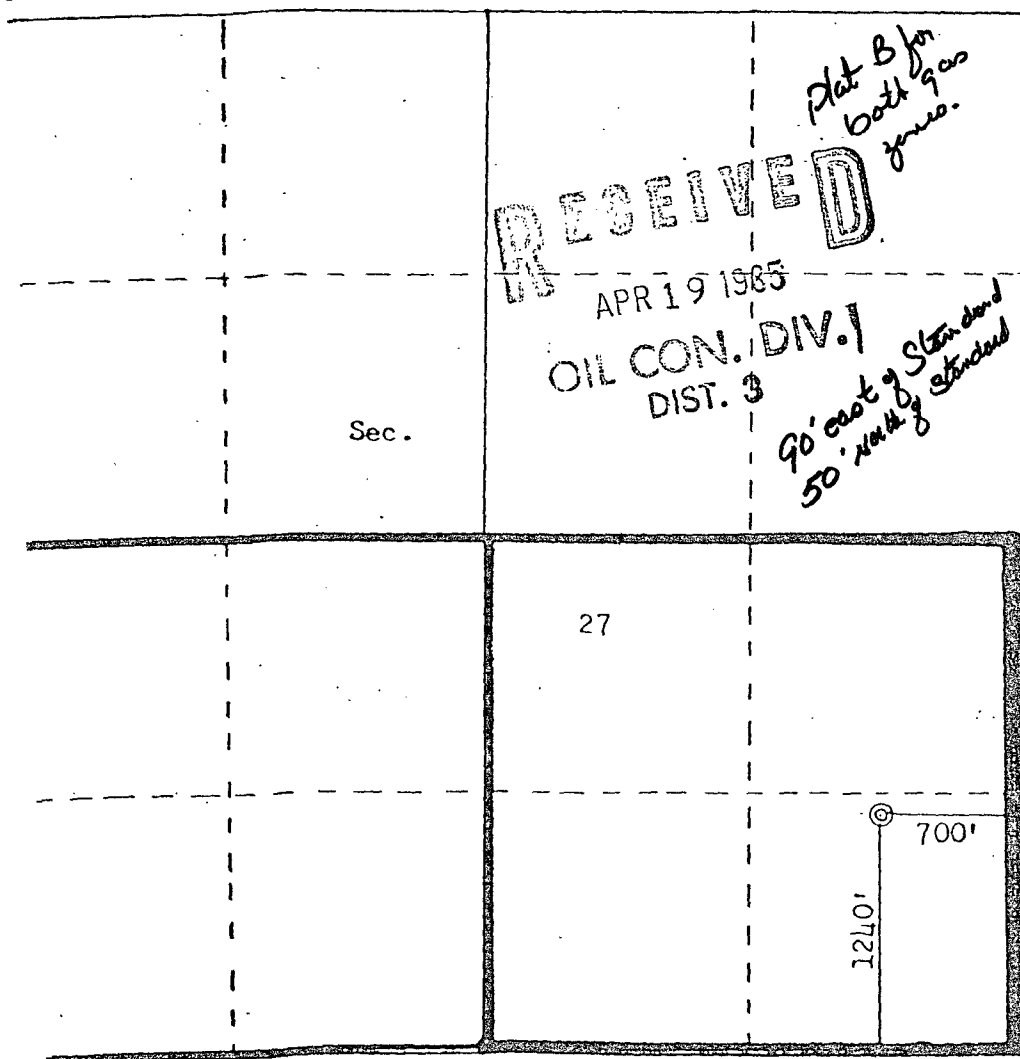

Scale: 1"=1000'

CERTIFICATION	
I hereby certify that the information contained herein is true and complete to the best of my knowledge and belief.	
<i>B. D. Shaw</i>	
Name	B. D. Shaw
Position	Adm. Supervisor
Company	Amoco Production Co.
Date	4/12/85
I hereby certify that the well location shown on this plat was plotted from field notes of actual surveys made by me or under my supervision, and that the same is true and correct to the best of my knowledge and belief.	
Date Surveyed	March 20, 1985
Registered Professional Engineer and Land Surveyor	<i>Fred B. Kerr Jr.</i>
Certificate No.	3950



STATE OF NEW MEXICO
ENERGY AND MINERALS DEPARTMENT

OIL CONSERVATION DIVISION
AZTEC DISTRICT OFFICE

NSC-1472

1000 RIO BRAZOS ROAD
AZTEC, NEW MEXICO 87410
(505) 334-6178

OIL CONSERVATION DIVISION
BOX 2088
SANTA FE, NEW MEXICO 87501

DATE 5-15-85

RE: Proposed MC _____
Proposed DHC _____
Proposed NSL X _____
Proposed SWD _____
Proposed WFX _____
Proposed PMX _____

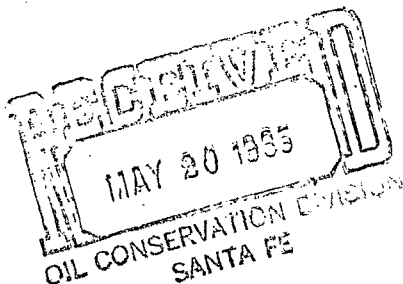

Gentlemen:

I have examined the application dated 4-17-85
for the Amoco Permian Coal Com "A" #1A P-27-29N-10W
Operator Lease and Well No. Unit, S-T-R

and my recommendations are as follows:

Approve

Yours truly,

Ed Bruch



Amoco Production Company

Petroleum Center Building
501 Airport Drive
Farmington, New Mexico 87401
505-325-8841

W. J. Holcomb
District Manager

April 15, 1985

Mr. Gilbert Quintana
New Mexico Oil Conservation Division
P. O. Box 2088
Santa Fe, NM 87501

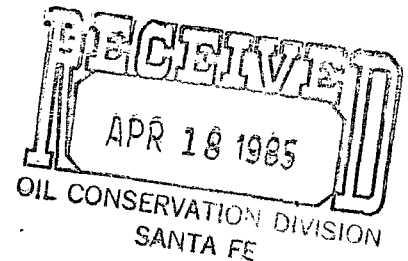

File: DDL-414-400.1

Application for Unorthodox Location
Romero Gas Com "A" No. 1A
Otero Chacra and Blanco Mesaverde Fields
San Juan County, New Mexico

Amoco Production Company hereby requests approval of an unorthodox well location for the Romero Gas Com "A" No. 1A. The proposed location is 1240' FSL x 700' FEL of Section 27, T29N, R10W, San Juan County, New Mexico.

This well was restaked a second time in the unorthodox location indicated above in order to avoid the surface owners irrigation pipelines.

A copy of this application is being sent by certified mail to the offset lease holders, Southern Union, Union Texas, and El Paso Natural Gas, with the request that they furnish you a waiver of objection and return one copy of the same to me.

Sincerely,

W. J. Holcomb *BSS*

LJM/ct

Attachments

cc: Mr. Ernie Bush
New Mexico Oil Conservation Division
1000 Rio Brazos Road
Aztec, NM 87410

cc: R. J. Criswell
Denver

J. D. Cutter
Denver

_____ hereby waives objection to Amoco's application for an unorthodox location as proposed above.

AM18

RETURN THIS COPY TO NMOCD.



W. J. Holcomb
District Manager

April 15, 1985

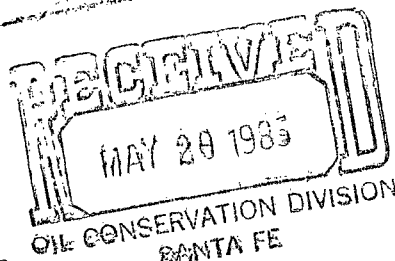

Mr. Gilbert Quintana
New Mexico Oil Conservation Division
P. O. Box 2088
Santa Fe, NM 87501

File: DDL-414-400.1

Application for Unorthodox Location
Romero Gas Com "A" No. 1A
Otero Chacra and Blanco Mesaverde Fields
San Juan County, New Mexico

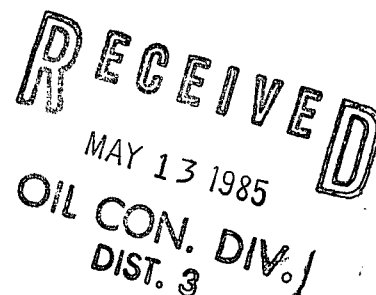

Amoco Production Company hereby requests approval of an unorthodox well location for the Romero Gas Com "A" No. 1A. The proposed location is 1240' FSL x 700' FEL of Section 27, T29N, R10W, San Juan County, New Mexico.

This well was restaked a second time in the unorthodox location indicated above in order to avoid the surface owners irrigation pipelines.

A copy of this application is being sent by certified mail to the offset lease holders, Southern Union, Union Texas, and El Paso Natural Gas, with the request that they furnish you a waiver of objection and return one copy of the same to me.

Sincerely,

Original Signed
W. J. Holcomb
by BDS

LJM/ct

Attachments

cc: Mr. Ernie Bush
New Mexico Oil Conservation Division
1000 Rio Brazos Road
Aztec, NM 87410

cc: R. J. Griswell
Denver
J. D. Cutter
Denver

_____ hereby waives objection to Amoco's application for an unorthodox location as proposed above.

AM18

BY Will W. Hulse DATE 5/9/85
UNICON PRODUCING COMPANY

RETURN THIS COPY TO NMOC.



Amoco Production Company

Petroleum Center Building
501 Airport Drive
Farmington, New Mexico 87401
505-325-8841

W. J. Holcomb
District Manager

April 15, 1985

Mr. Gilbert Quintana
New Mexico Oil Conservation Division
P. O. Box 2088
Santa Fe, NM 87501

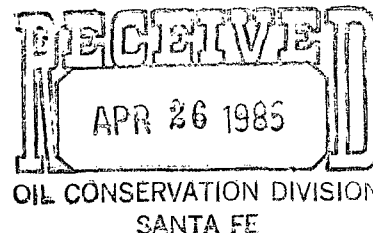

File: DDL-414-400.1

Application for Unorthodox Location
Romero Gas Com "A" No. 1A
Otero Chacra and Blanco Mesaverde Fields
San Juan County, New Mexico

Amoco Production Company hereby requests approval of an unorthodox well location for the Romero Gas Com "A" No. 1A. The proposed location is 1240' FSL x 700' FEL of Section 27, T29N, R10W, San Juan County, New Mexico.

This well was restaked a second time in the unorthodox location indicated above in order to avoid the surface owners irrigation pipelines.

A copy of this application is being sent by certified mail to the offset lease holders, Southern Union, Union Texas, and El Paso Natural Gas, with the request that they furnish you a waiver of objection and return one copy of the same to me.

Sincerely,

Original Signed
W. J. Holcomb
by BDS

LJM/ct

Attachments

cc: Mr. Ernie Bush
New Mexico Oil Conservation Division
1000 Rio Brazos Road
Aztec, NM 87410

cc: R. J. Criswell
Denver
J. D. Cutter
Denver

Meridian Oil Inc hereby waives objection to Amoco's application for an unorthodox location as proposed above.

AM18



STATE OF NEW MEXICO
ENERGY AND MINERALS DEPARTMENT
OIL CONSERVATION DIVISION
AZTEC DISTRICT OFFICE

1000 RIO BRAZOS ROAD
AZTEC, NEW MEXICO 87410
(505) 334-6178

OIL CONSERVATION DIVISION
BOX 2088
SANTA FE, NEW MEXICO 87501

DATE 1-16-85

RE: Proposed MC _____
Proposed DHC _____
Proposed NSL X _____
Proposed SWD _____
Proposed WFX _____
Proposed PMX _____

Gentlemen:

I have examined the application dated 12-28-84
for the AMOCO Romero Gas Com "A" #1A J-27-29N-10W
Operator Lease and Well No. Unit, S-T-R

and my recommendations are as follows:

Approved:

Yours truly,

Em. Kneul

