

Release
ASAP

El Paso
Exploration Company

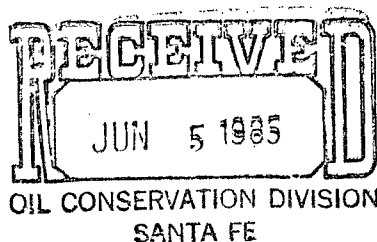

P. O. BOX 4289
FARMINGTON, NEW MEXICO 87499-4289
PHONE: 505-325-2841

June 4, 1985

~~2065~~ 2065
NSL - RULE 104 F(I)

Mr. Richard Stamets
New Mexico Oil Conservation Division
Post Office Box 2088
Santa Fe, New Mexico 87501

Dear Mr. Stamets:

This is a request for administrative approval for an unorthodox gas well location in the Blanco Mesa Verde Pool.

It is intended to locate the El Paso Natural Gas Company's Storey C #11A at 1000' from the North line and 635' from the West line of Section 34, T-28-N, R-9-W, San Juan County, New Mexico.

Extremely rough terrain in the form of steep cliffs in the northwest corner of this section makes it impossible to build an orthodox gas well location.

El Paso Natural Gas Company is the offsetting operator of the surrounding sections.

Plats showing the proposed well location and the terrain in Section 34, along with an ownership plat, are attached.

Sincerely yours,

G. W. Brink

G. W. Brink
Project Drilling Engineer

encl.

320 AC. DED.
N/2

EL PASO NATURAL GAS COMPANY

Well Name Storey C #11 A, Blanco Mesaverde

Footage----- 1000' FNL, 635' FWL

APPLICATION FOR NON-STANDARD LOCATION

County San Juan State New Mexico Section 34 Township 28N Range 9W

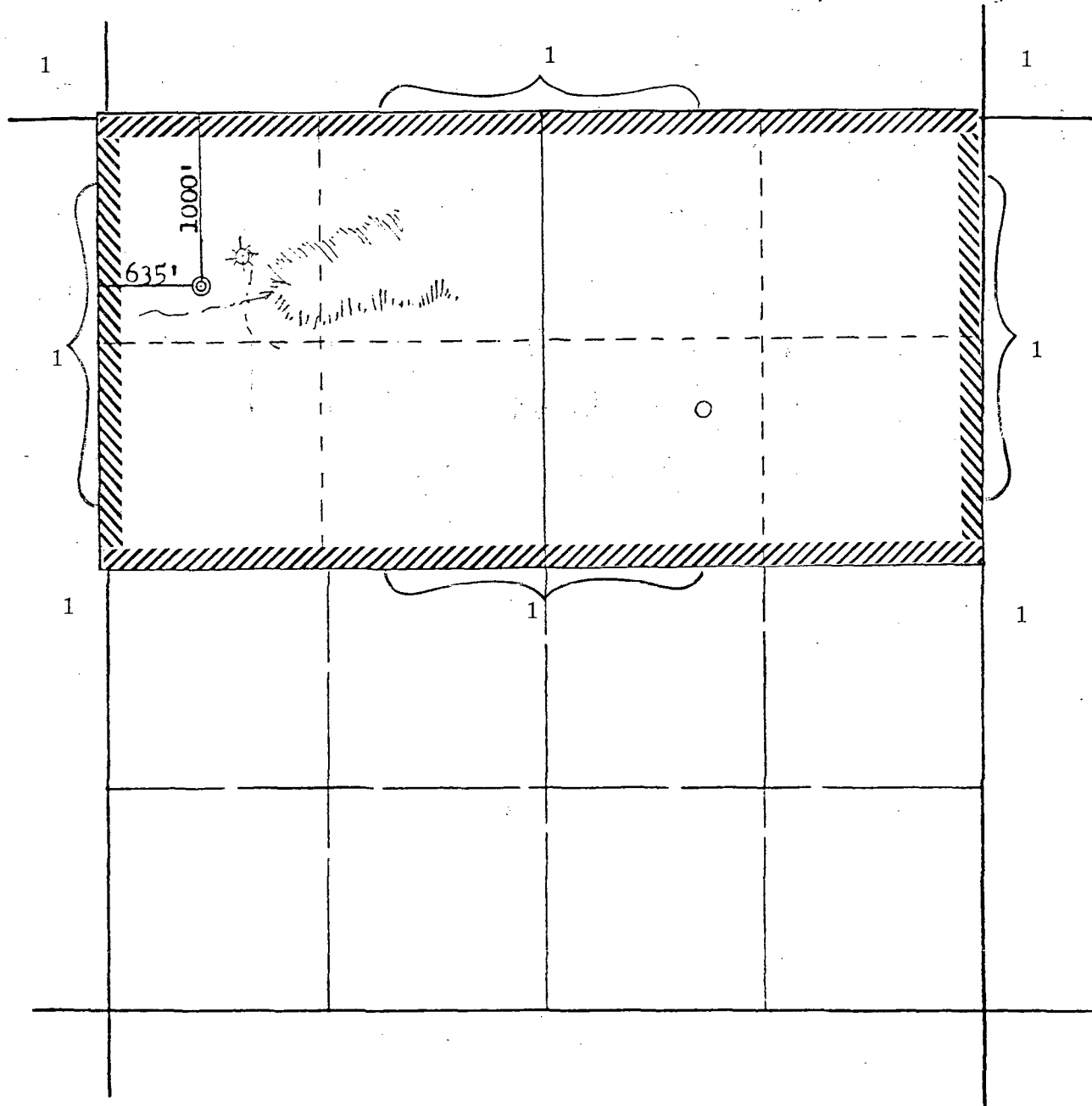

REMARKS:

(1) El Paso Natural Gas Company - Operator

EL PASO NATURAL GAS COMPANY

Well Name Storey C #11 A, Blanco Mesaverde

Footage----- 1000' FNL, 635' FWL

APPLICATION FOR NON-STANDARD LOCATION

County San Juan State New Mexico Section 34 Township 28N Range 9W

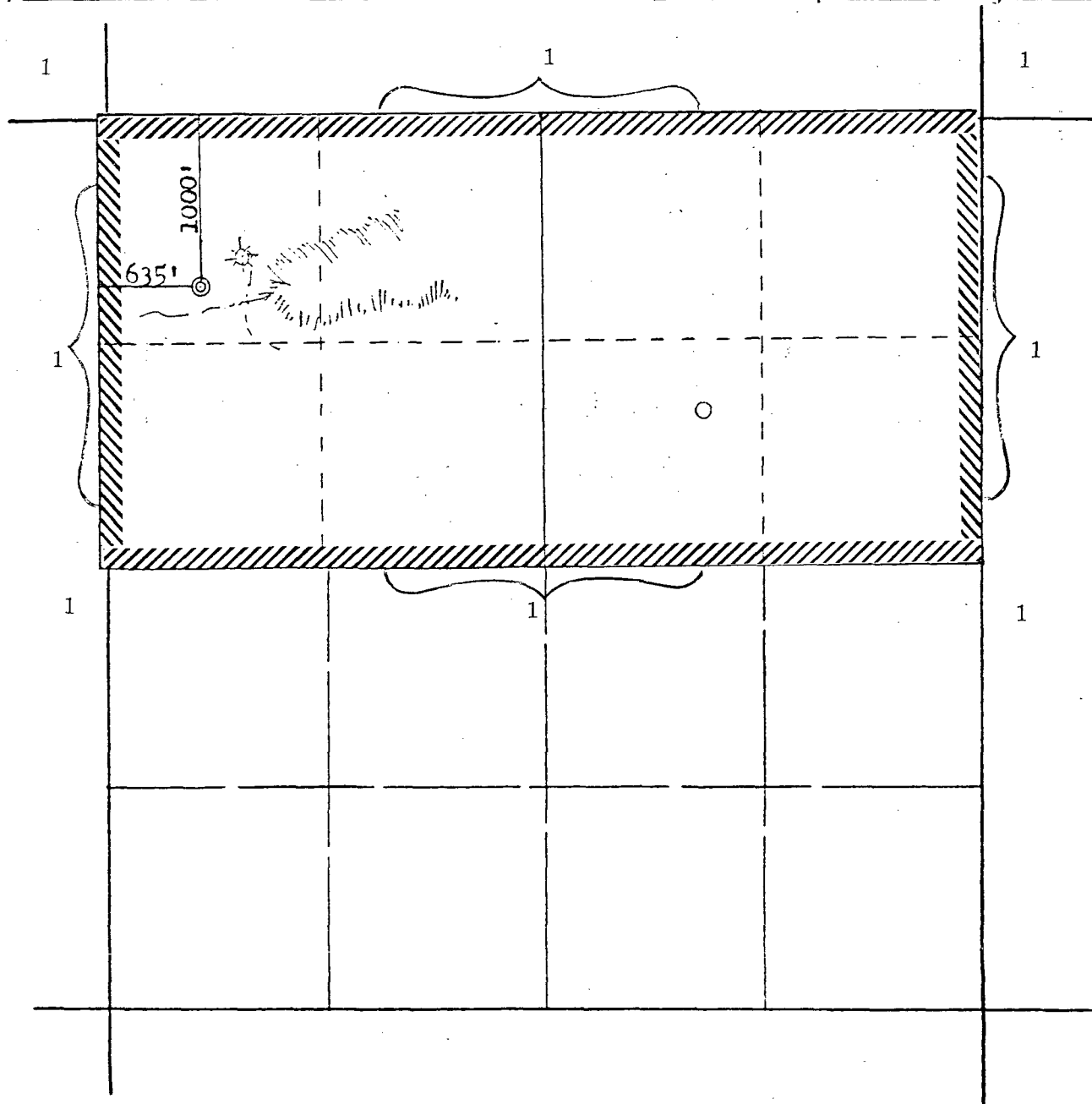

REMARKS:

(1) El Paso Natural Gas Company - Operator

and gas lease.
This information will be used to analyze and appraise.
Response to this request is mandatory only if the lessee elects to initiate unitization or
tations on an oil and gas lease.

WELL LOCATION AND ACREAGE DEDICATION PLAT

Form 1-1985
Supersedes 4-128
Effective 1-1-85

All distances must be from the outer boundaries of the Section.

Operator EL PASO NATURAL GAS COMPANY			Lease STOREY "C" (SF 077111)		Well No. 11A
Unit Letter D	Section 34	Township 28N	Range 9W	County San Juan	
Actual Footage Location of Well: 1000 feet from the North line and 635 feet from the West line					
Ground Level Elev: 6233	Producing Formation Mesa Verde		Pool Blanco	Dedicated Acreage: 3.20 Acres	

1. Outline the acreage dedicated to the subject well by colored pencil or hachure marks on the plat below.
2. If more than one lease is dedicated to the well, outline each and identify the ownership thereof (both as to working interest and royalty).
3. If more than one lease of different ownership is dedicated to the well, have the interests of all owners been consolidated by communitization, unitization, force-pooling, etc?

☐ Yes ☐ No If answer is "yes," type of consolidation _____

If answer is "no," list the owners and tract descriptions which have actually been consolidated. (Use reverse side of this form if necessary.) _____

No allowable will be assigned to the well until all interests have been consolidated (by communitization, unitization, forced-pooling, or otherwise) or until a non-standard unit, eliminating such interests, has been approved by the Commission.

CERTIFICATION

I hereby certify that the information contained herein is true and complete to the best of my knowledge and belief.

[Signature]
Name
Drilling Clerk
Position
El Paso Natural Gas
Company
June 3, 1985
Date

I hereby certify that the well location shown on this plat was plotted from field notes of actual surveys made by me or under my supervision, and that the same is true and correct to the best of my knowledge and belief.

Date Surveyed
May 3, 1985
Registered Professional Engineer
and Land Surveyor
[Signature]
Fred B. Kerr Jr.
Certificate No. 4422

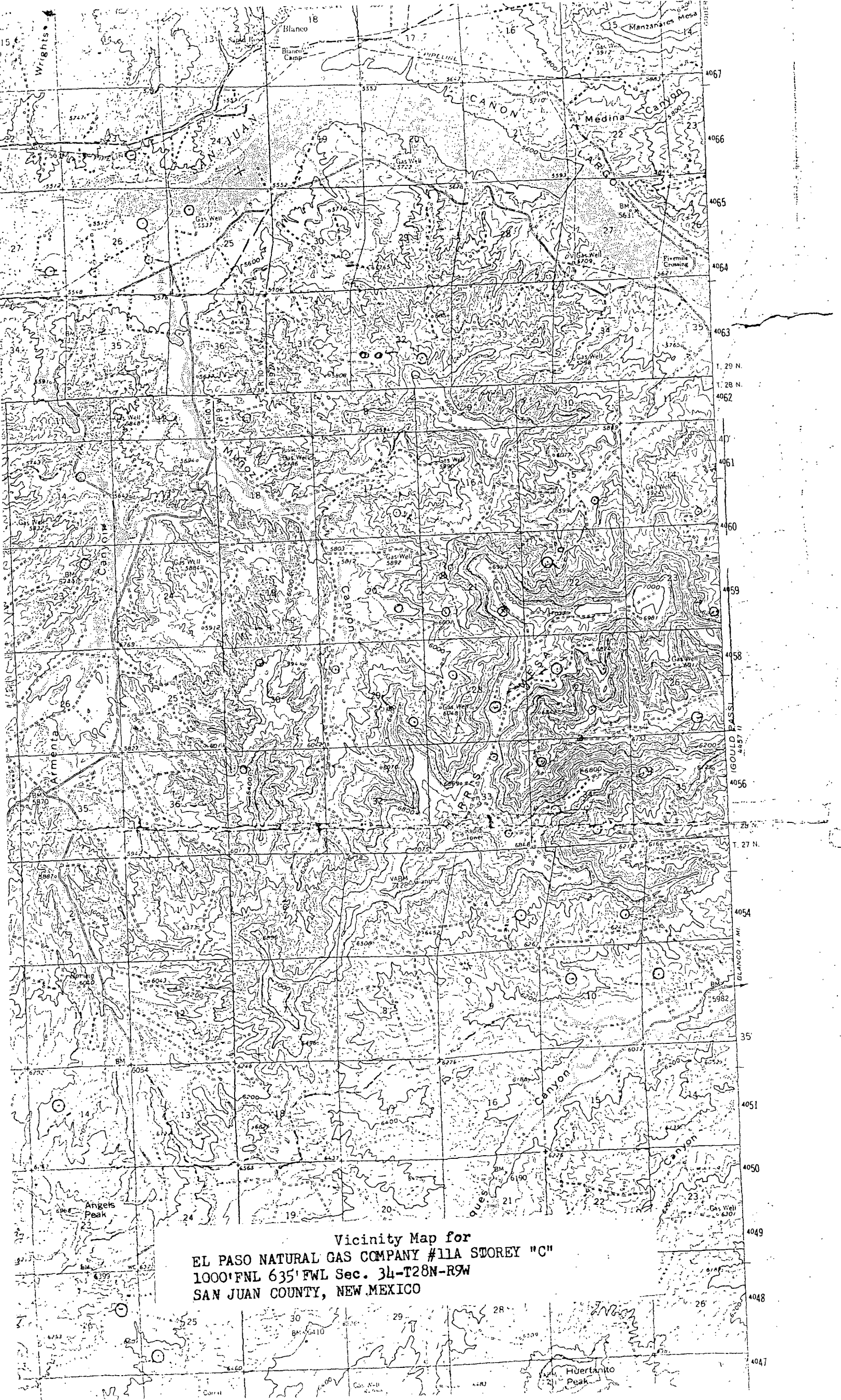



STATE OF NEW MEXICO
ENERGY AND MINERALS DEPARTMENT
OIL CONSERVATION DIVISION
AZTEC DISTRICT OFFICE

1000 RIO BRAZOS ROAD
AZTEC, NEW MEXICO 87410
(505) 334-6178

OIL CONSERVATION DIVISION
BOX 2088
SANTA FE, NEW MEXICO 87501

DATE 6-18-85

RE: Proposed MC _____
Proposed DHC _____
Proposed NSL X _____
Proposed SWD _____
Proposed WFX _____
Proposed PMX _____

2065
RECEIVED
JUN 24 1985
OIL CONSERVATION DIVISION
SANTA FE

Gentlemen:

I have examined the application dated 6-10-85
for the El Paso Expl. Co. Storey C #11A D-34-28N-9W
Operator Lease and Well No. Unit, S-T-R

and my recommendations are as follows:

[Signature]

Yours truly,

[Signature]