

Release October 21, 1985

By DRC

~~MERIDIAN OIL~~

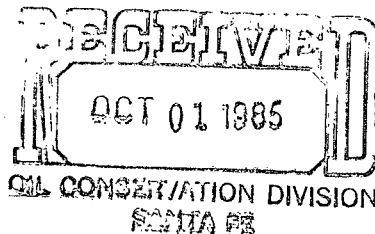

NSC-2175  
RULE-104F(I)  
September 26, 1985

Mr. Richard Stamets  
New Mexico Oil Conservation Division  
Post Office Box 2088  
Santa Fe, New Mexico 87501

320 Acres ded.  
w/2 Sec. 33

Dear Mr. Stamets:

This is a request for administrative approval for an unorthodox gas well location in the Basin Dakota Pool.

It is intended to locate the El Paso Natural Gas Company's Huerfano Unit #113E at 2050' from the South line and 1130' from the West line of Section 33, T-27-N, R-10-W, San Juan County, New Mexico.

Due to extremely rough terrain in the form of steep cliffs in the southwest corner of this section makes it impossible to build an orthodox location.

A copy of this application is being submitted to all offset operators by certified mail with a request that they furnish your Santa Fe office with a Waiver of Objection, and return one copy to this office.

Plats showing the proposed well location and the terrain in Section 33, along with an ownership plat, are attached.

Sincerely yours,

A handwritten signature in cursive script, appearing to read "G. W. Brink".

G. W. Brink  
Project Drilling Engineer

encl.

WAIVER

\_\_\_\_\_ hereby waives objection to El Paso Natural Gas Company's application for an unorthodox location for their Huerfano Unit #113E as proposed above.

By: \_\_\_\_\_

Date: \_\_\_\_\_

cc: Amoco Production Co.

okay Uebel  
E.B.  
10-23-85

# EL PASO NATURAL GAS COMPANY

Well Name Huerfano Unit #113 E, Basin Dakota

Footage---- 2050' FSL, 1130' FWL

## APPLICATION FOR NON-STANDARD LOCATION

County San Juan State New Mexico Section 33 Township 27N Range 10W

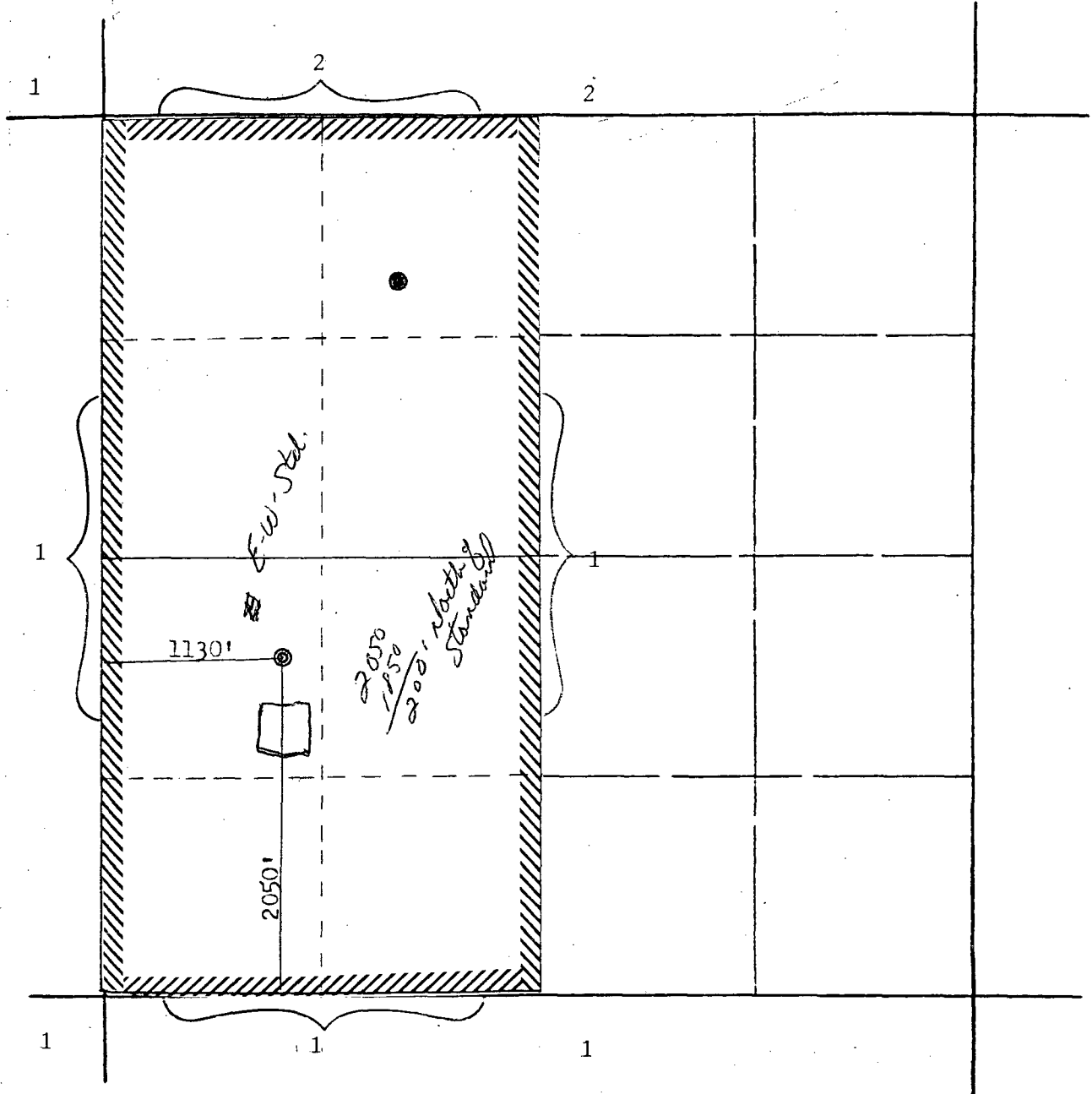

### REMARKS:

(1) El Paso Natural Gas Company

(As Huerfano Unit Operator)

(2) Amoco Production Company

(10)

NEW MEXICO OIL CONSERVATION COMMISSION  
WELL LOCATION AND ACREAGE DEDICATION PLAT

Form C-102  
Supersedes C-128  
Effective 1-1-65

All distances must be from the outer boundaries of the Section.

Operator <b>EL PASO NATURAL GAS COMPANY</b>			Lease <b>HUERFANO UNIT (NM 02516)</b>		Well No. <b>113E</b>
Unit Letter <b>L</b>	Section <b>33</b>	Township <b>27N</b>	Range <b>10W</b>	County <b>San Juan</b>	
Actual Footage Location of Well: <b>2050</b> feet from the <b>South</b> line and <b>1130</b> feet from the <b>West</b> line					
Ground Level Elev. <b>6118</b>	Producing Formation <b>Dakota</b>		Pool <b>Basin</b>	Dedicated Acreage: <b>320.00</b> Acres	

1. Outline the acreage dedicated to the subject well by colored pencil or hachure marks on the plat below.
2. If more than one lease is dedicated to the well, outline each and identify the ownership thereof (both as to working interest and royalty).
3. If more than one lease of different ownership is dedicated to the well, have the interests of all owners been consolidated by communitization, unitization, force-pooling, etc?

☒ Yes ☐ No If answer is "yes," type of consolidation Unitization

If answer is "no," list the owners and tract descriptions which have actually been consolidated. (Use reverse side of this form if necessary.) \_\_\_\_\_

No allowable will be assigned to the well until all interests have been consolidated (by communitization, unitization, forced-pooling, or otherwise) or until a non-standard unit, eliminating such interests, has been approved by the Commission.

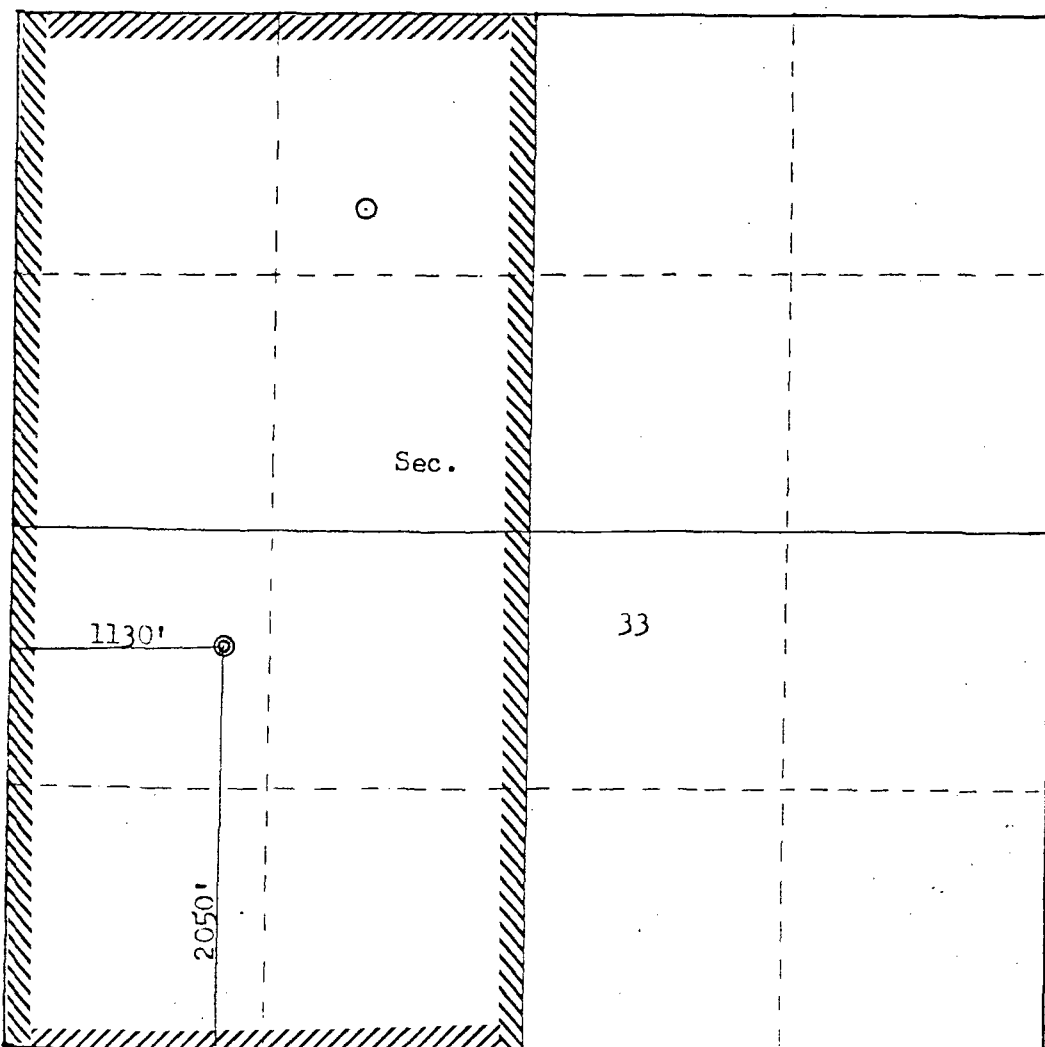

Scale: 1"=1000'

CERTIFICATION

I hereby certify that the information contained herein is true and complete to the best of my knowledge and belief.

*Peggy L. Doak*

Name  
Drilling Clerk

Position  
El Paso Natural Gas

Company  
**9-25-85**

Date

I hereby certify that the well location shown on this plat was plotted from field notes of actual surveys made by me or under my supervision, and that the same is true and correct to the best of my knowledge and belief.

Date Surveyed  
**September 19, 1985**

Registered Professional Engineer and Land Surveyor

*Fred B. Kerr Jr.*  
Fred B. Kerr Jr.

Certificate No. **3950**

