

1  
Release Immediately  
when in.

By DRC

# Mobil Producing Texas & New Mexico Inc.

January 21, 1986

P.O. BOX 633  
MIDLAND, TEXAS 79702

State of New Mexico  
Energy & Minerals Dept.  
Oil Conservation Commission  
Post Office Box 2088  
Santa Fe, New Mexico 87501

151-2224  
RULE-104 H(Z)

Attention: Mr. Dave Catanach

*East Avalon Bone Springs  
Pool.  
40 Ave dead.  
Unil better & dedicated to well.*

UNORTHODOX LOCATION  
GOVERNMENT "D" WELL NO. 12  
1600' FSL, 1040' FEL  
SECTION 1, T-21-S, R-27-E  
AVALON, EAST - BONE SPRING FIELD  
EDDY COUNTY, NEW MEXICO

Dear Dave:

Mobil Producing Tx. & N.M., Inc., as agent for The Superior Oil Company, is applying for approval on an unorthodox location on the Government "D" Well No. 12. The well was moved from a regular location because of artifacts found on that site. Had the location been moved in any other direction, chances of a good producer would have diminished, geologically.

Superior is the only affected offset operator to the unorthodox location. Bass Enterprises Production Company is an offset operator to the east, which is 1040' away from the subject well. Attached is a plat showing the offset operators and a copy of the drilling permit application.

We are requesting administrative approval on the unorthodox location as no offset operator is affected. If additional information is needed, please call Lorraine Maroney at (915) 688-1773.

Yours very truly,

*G. E. Tate*

G. E. Tate  
Env. & Reg. Manager

LLM/jp  
Attachments

UNITED STATES  
DEPARTMENT OF THE INTERIOR  
BUREAU OF LAND MANAGEMENT

APPLICATION FOR PERMIT TO DRILL, DEEPEN, OR PLUG BACK

1a. TYPE OF WORK <b>DRILL</b> <input checked="" type="checkbox"/> <b>DEEPEN</b> <input type="checkbox"/> <b>PLUG BACK</b> <input type="checkbox"/>			5. LEASE DESIGNATION AND SERIAL NO. NM-17095		
b. TYPE OF WELL OIL WELL <input checked="" type="checkbox"/> GAS WELL <input type="checkbox"/> OTHER <input type="checkbox"/> SINGLE ZONE <input checked="" type="checkbox"/> MULTIPLE ZONE <input type="checkbox"/>			6. IF INDIAN, ALLOTTEE OR TRIBE NAME		
2. NAME OF OPERATOR Superior Oil Company, The			7. UNIT AGREEMENT NAME		
3. ADDRESS OF OPERATOR Post Office Box 633, Midland, Texas 79702			8. FARM OR LEASE NAME Government "D"		
4. LOCATION OF WELL (Report location clearly and in accordance with any State requirements.) At surface 1600' FSL, 1040' FEL  At proposed prod. zone Same			9. WELL NO. 12		
14. DISTANCE IN MILES AND DIRECTION FROM NEAREST TOWN OR POST OFFICE* 8.5 miles NE from Carlsbad, N. M.			10. FIELD AND POOL, OR WILDCAT Avalon East - Bone Spring		
15. DISTANCE FROM PROPOSED* LOCATION TO NEAREST PROPERTY OR LEASE LINE, FT. (Also to nearest drilg. unit line, if any) 1040' None		16. NO. OF ACRES IN LEASE 776.2	17. NO. OF ACRES ASSIGNED TO THIS WELL 40		
18. DISTANCE FROM PROPOSED LOCATION* TO NEAREST WELL, DRILLING, COMPLETED, OR APPLIED FOR, ON THIS LEASE, FT. 1329'		19. PROPOSED DEPTH 5900	20. ROTARY OR CABLE TOOLS Rotary		
21. ELEVATIONS (Show whether DF, RT, GR, etc.) 3194' GR			22. APPROX. DATE WORK WILL START* 02-01-86		

23. PROPOSED CASING AND CEMENTING PROGRAM				
SIZE OF HOLE	SIZE OF CASING	WEIGHT PER FOOT	SETTING DEPTH	QUANTITY OF CEMENT
17-1/2"	13-3/8"	48# Conductor	80	Redi Mix to surface
12-1/4"	9-5/8"	47#	2450'±	2343 cu ft circ to surface
7-7/8"	5-1/2"	14#	5750' or TD	1919 cu ft circ to surface

CEMENTING PROGRAM:

9-5/8" csg to be cmted w/1242 sx TLW + 15-3/4#/sx salt + 1/4#/sx FC (Lead)  
100 sx Class C + 1/4#/sx FC

5-1/2" csg to be cmted w/415 sx TLW + 1/4#/sx FC (Lead)  
960 sx Class C + 1/4#/sx FC (Tail)

BOP PROGRAM:

3000# Series. See Attachment

IN ABOVE SPACE DESCRIBE PROPOSED PROGRAM: If proposal is to deepen or plug back, give data on present productive zone and proposed new productive zone. If proposal is to drill or deepen directionally, give pertinent data on subsurface locations and measured and true vertical depths. Give blowout preventer program, if any.

24. SIGNED G. E. Tate G. E. Tate TITLE Env. & Reg. Mgr. DATE 01/20/86  
As Agent for the Superior Oil Company  
(This space for Federal or State office use)

PERMIT NO. \_\_\_\_\_ APPROVAL DATE \_\_\_\_\_

APPROVED BY \_\_\_\_\_ TITLE \_\_\_\_\_ DATE \_\_\_\_\_  
CONDITIONS OF APPROVAL, IF ANY:

\*See Instructions On Reverse Side

## OIL CONSERVATION DIVISION

STATE OF NEW MEXICO  
ENERGY AND MINERALS DEPARTMENTP. O. BOX 2088  
SANTA FE, NEW MEXICO 87501Form C-102  
Revised 10-1-78

All distances must be from the outer boundaries of the Section.

Operator Superior Oil Company, The			Lease Government "D"		Well No. 12
Unit Letter Q	Section 1	Township 21 South	Range 27 East	County Eddy	
Actual Footage Location of Well: 1600 feet from the South line and 1040 feet from the East line					
Ground Level Elev. 3194	Producing Formation Bone Spring	Pool Avalon, East		Dedicated Acreage: 40 Acres	

1. Outline the acreage dedicated to the subject well by colored pencil or hatchure marks on the plat below.
2. If more than one lease is dedicated to the well, outline each and identify the ownership thereof (both as to working interest and royalty).
3. If more than one lease of different ownership is dedicated to the well, have the interests of all owners been consolidated by communitization, unitization, force-pooling, etc?

☐ Yes ☐ No If answer is "yes," type of consolidation \_\_\_\_\_

If answer is "no," list the owners and tract descriptions which have actually been consolidated. (Use reverse side of this form if necessary.) \_\_\_\_\_

No allowable will be assigned to the well until all interests have been consolidated (by communitization, unitization, forced-pooling, or otherwise) or until a non-standard unit, eliminating such interests, has been approved by the Division.

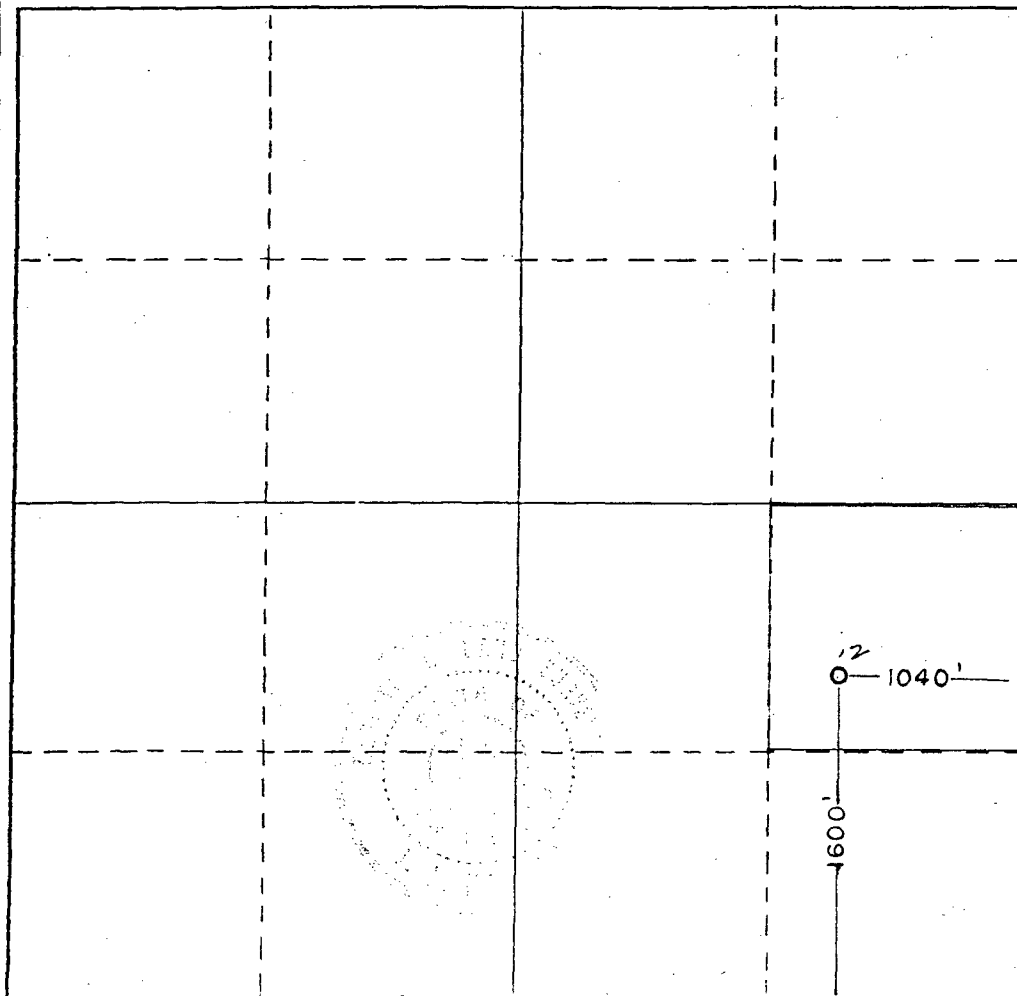

## CERTIFICATION

I hereby certify that the information contained herein is true and complete to the best of my knowledge and belief.

*G. E. Tate*  
Name G. E. Tate

As Agent for The Superior Oil C

Position

Env. & Reg. Manager

Company

Mobil Producing Tx. & N.M., Inc.

Date

January 20, 1986

I hereby certify that the well location shown on this plat was plotted from field notes of actual surveys made by me or under my supervision, and that the same is true and correct to the best of my knowledge and belief.

Date Surveyed

December 22, 1985

Registered Professional Engineer  
and/or Land Surveyor

*J. A. Newton*  
Certificate No.  
5109

0 330 660 990 1320 1650 1980 2310 2640 2970 3300 3630 3960 4290 4620 4950 5280 5610 5940 6270 6600

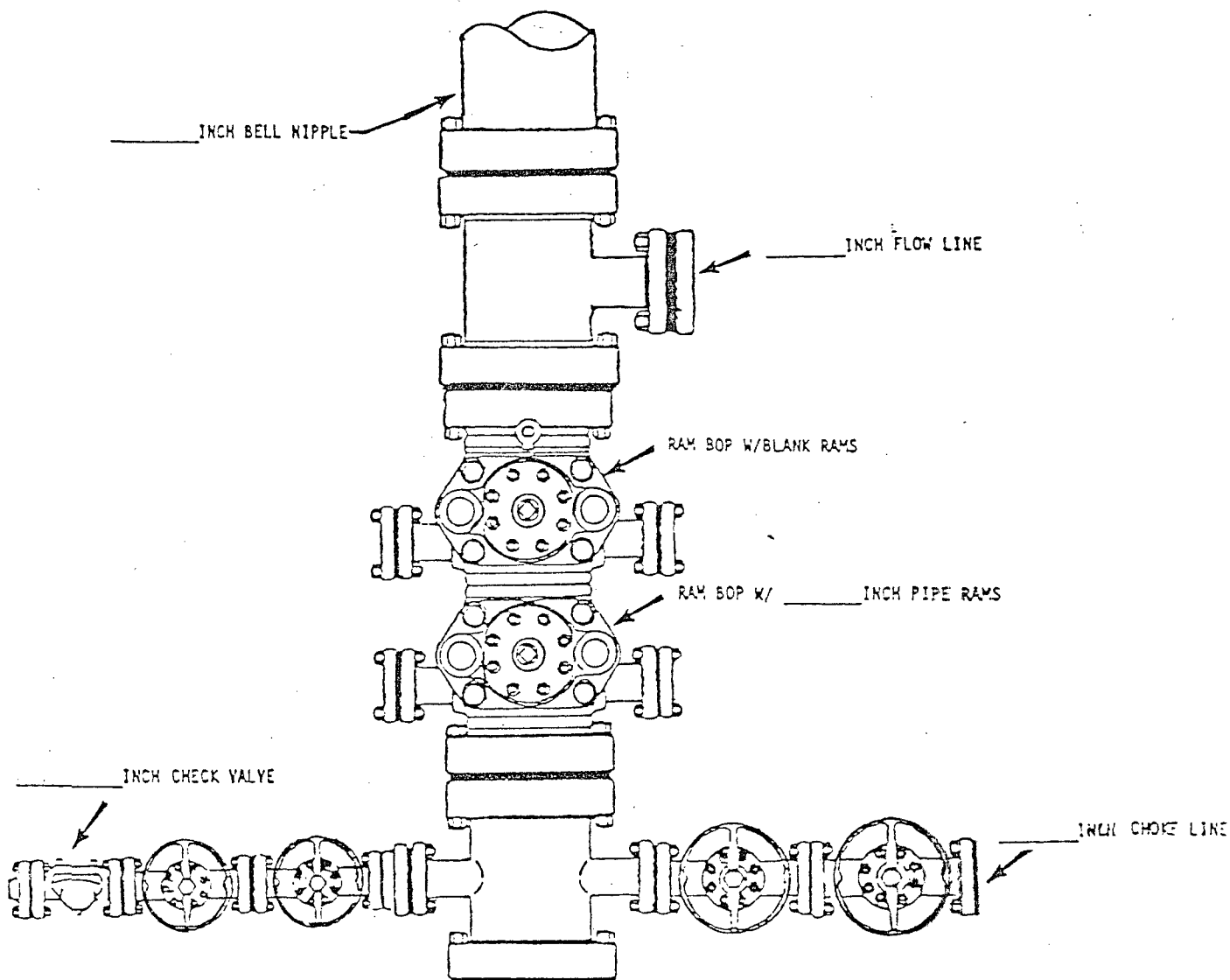

\*NOTE: ALL VALVES ARE METAL-TO-METAL SEAL AND FLANGED. ALL COMPONENTS MUST MEET ABOVE MINIMUM PRESSURE RATINGS. ALL COMPONENTS TO BE TESTED TO RATED PRESSURE AFTER ASSEMBLY AND BEFORE FURTHER DOWNHOLE OPERATIONS MAY BE CONDUCTED.

Mobil Producing Texas & New Mexico Inc. Houston, Texas		Scale
Well # <u>12</u> <u>Government "D"</u> (Lease)		Date
<u>Eddy</u> County, <u>DM</u> State		Drawn
Blowout Preventer Assembly		Checked
5" x 5 1/2 IN. 3000 PSI WP*)		Approved
		Revised

MOBIL PRODUCING TX. & N.M. INC.

LEASE: Government "D"

WELL: 12

FIELD: Avalon - Bone Spring, East

COUNTY: Eddy

STATE: N.M.

TEN POINT WELL CONTROL & RESOURCE PROTECTION DATA

1. The geologic name of the surface formation Quaternary.
2. The estimated tops of important geologic markers.

<u>Formation Name</u>	<u>Depth (Top)</u>
<u>Delaware</u>	<u>2900'</u>
<u>Bone Spring</u>	<u>5400'</u>
<u> </u>	<u> </u>
<u> </u>	<u> </u>

3. The estimated depth at which anticipated water, oil, gas or other mineral-bearing formations are expected to be encountered.

<u>Formation Name</u>	<u>Depth (Top)</u>	<u>Type of Mineral</u>
<u>Capitan Reef</u>	<u>700'</u>	<u>Water</u>
<u>Delaware</u>	<u>2900'</u>	<u>Oil/Water</u>
<u>Bone Spring</u>	<u>5400'</u>	<u>Oil/Gas</u>
<u> </u>	<u> </u>	<u> </u>

4. The proposed casing program, including the size, grade, and weight-per-foot of each string and whether new or used. (Shown on Form 9-331C)
5. The lessee's or operator's minimum specifications for pressure control equipment which is to be used, a schematic diagram thereof showing sizes, pressure ratings (or API series), and the testing procedures and testing frequency. (See attachment)
6. The type and characteristics of the proposed circulating medium or mediums to be employed for rotary drilling and the quantities and types of mud and weighting material to be maintained.

<u>Depth (Ft.)</u>	<u>Type</u>	<u>Weight</u>	<u>Viscosity</u>	<u>Water Loss</u>
<u>0 - 650'</u>	<u>Spud</u>	<u>8.8 - 9.4</u>	<u>34 - 40</u>	<u>NC</u>
<u>650 - 2650'</u>	<u>BW</u>	<u>9.6 - 10.0</u>	<u>28 - 36</u>	<u>NC</u>
<u>2650 - 5400'</u>	<u>FW</u>	<u>8.4 - 8.8</u>	<u>28 - 33</u>	<u>NC</u>
<u>5400 - TD</u>	<u>FW - Gel</u>	<u>8.6 - 9.2</u>	<u>30 - 38</u>	<u>20±</u>

7. The auxiliary equipment to be used, such as (1) kelly cocks, (2) floats at the bit, (3) monitoring equipment on the mud system, (4) a sub on the floor with a full opening valve to be stabbed into drill pipe when the kelly is not in the string.

A kelly cock and all safety valves will be utilized and tested in accordance with USGS regulations when necessary.

---

---

8. The testing, logging, mud, and coring programs to be followed with provision made for required flexibility. (See attached sheet)
9. Any anticipated abnormal pressures or temperatures expected to be encountered or potential hazards such as hydrogen sulfide gas, along with plans for mitigating such hazards.

No abnormal pressures are anticipated. 3-5% H<sub>2</sub>S anticipated in the Bone Spring formation.

---

---

10. The anticipated starting date and duration of the operations.

Starting Date: 02-01-86 Duration of Operations 15 Days.

Superior Oil Company, The  
Government "D"

Well No. 12  
Section 1, T-21-S, R-37-E  
Avalon - Bone Spring, East  
Eddy County, New Mexico

10 POINT WELL CONTROL AND RESOURCE PROTECTION DATA

Requirement No. 8

Drill Stem Tests:

None

Coring Program:

None

Logging Program:

CNL/LDT/GR - 2650 to TD  
DLL/MSFL - 2650 to TD  
BHC/SONIC/GR - 2650 to TD

Drilling Time and Sample Program:

Catch 10-foot samples and keep 10-foot drilling time from 2400' to TD.

MOBIL PRODUCING TEXAS & NEW MEXICO, INC.  
SURFACE USE AND OPERATIONS PLAN

GOVERNMENT "D" NO. 12  
1600' FSL & 1040' FEL  
SECTION 1 T-21-S R-27-E  
EDDY COUNTY, NEW MEXICO

Prepared by: H. A. Carson, Jr.  
December 21, 1985



## SURFACE USE AND OPERATION PLAN

### I. EXISTING ROADS

#### A. See Attached Government "D" Area Map

At a point in Section 17, T-21-S, R-28-E, leave Highway 62-180 and go north on a paved county road 243 for 1.2 miles, then turn west on a caliche lease road for 2.0 miles, turn north 0.5 miles and east 0.5 miles.

### II. PLANNED ACCESS ROAD

The planned access road will be approximately 2500 feet long with a cleared width of 30 feet and a 12 foot wide caliche surface. It is proposed that two 10 foot wide by 100 foot long turnouts will be constructed along the new road construction. The terrain crossed by this road is pasture land covered by typical desert area grasses and plants. The basic slope in this general area is to the east.

#### A. See attached Government "D" vicinity map

#### B. See attached proposed development plat

### III. LOCATION OF EXISTING WELLS

#### A. See attached Government "D" Well Map

#### B. See attached Government "D" Development plat

### IV. LOCATION OF TANK BATTERIES, PRODUCTION FACILITIES, AND PRODUCTION GATHERING AND SERVICE LINES

#### A. See attached development plat

Temporary production facilities will be located on the well pad. Once the well is completed, a flowline will be laid beside the existing road to the tank battery which is located on the east side of the north/south lease road and in the NE/4 of NW/4 of Section 12.

### V. LOCATION AND TYPE OF WATER SUPPLY

Water for drilling and construction purposes will be trucked from off lease sources.

VI. SOURCE OF CONSTRUCTION MATERIAL

It is proposed to construct the well pad and access road out of caliche. There is an existing caliche pit located in the NW/4 of Section 12, T-21-S, R-27-E, and it is proposed to use this caliche for construction.

VII. METHODS FOR HANDLING WASTE DISPOSAL

Waste will be buried, burned, and/or hauled from the well site. Buried waste will have a minimum cover of 5 feet. Septic tanks at trailer houses and chemical toilets will be cleaned periodically, and sewage hauled away for disposal at an off-lease location.

VIII. ANCILLARY FACILITIES

No ancillary facilities will be required at this time.

IX. WELL SITE LAYOUT

A. See attached Location Pad Layout Map

X. PLANS FOR RESTORATION OF THE SURFACE

The reserve pit shall be filled and reshaped to its original contour after pits have dried sufficiently to permit equipment operation. When all drilling and production operations have been completed, the road and pad will be reshaped to their original contour.

The lessee further covenants and agrees that all soil clean up and restoration activities shall be performed in a workmanlike manner and in strict conformity with this surface use plan.

XI. OTHER INFORMATION

The well site falls on sandy loam with a gentle downslope to the east with typical desert grasses and plants.

XII. LESSEES OR OPERATORS REPRESENTATIVE

G. P. Dalton  
Mobil Producing Texas & New Mexico, Inc.  
P. O. Box 633  
Midland, TX 79702  
(915) 688-2000

XIII. CERTIFICATION

I hereby certify that I or persons under my supervision have inspected the proposed drillsite; that I am familiar with the conditions that presently exist, that the statements made in this plan are, to the best of my knowledge, true and correct; and that the work associated with operations proposed herein will be performed by a reliable contractor in conformity with this plan and the terms and conditions under which it is approved.



G. P. Dalton  
Divisions Operations Manager  
Midland

H. A. Carson, Jr.

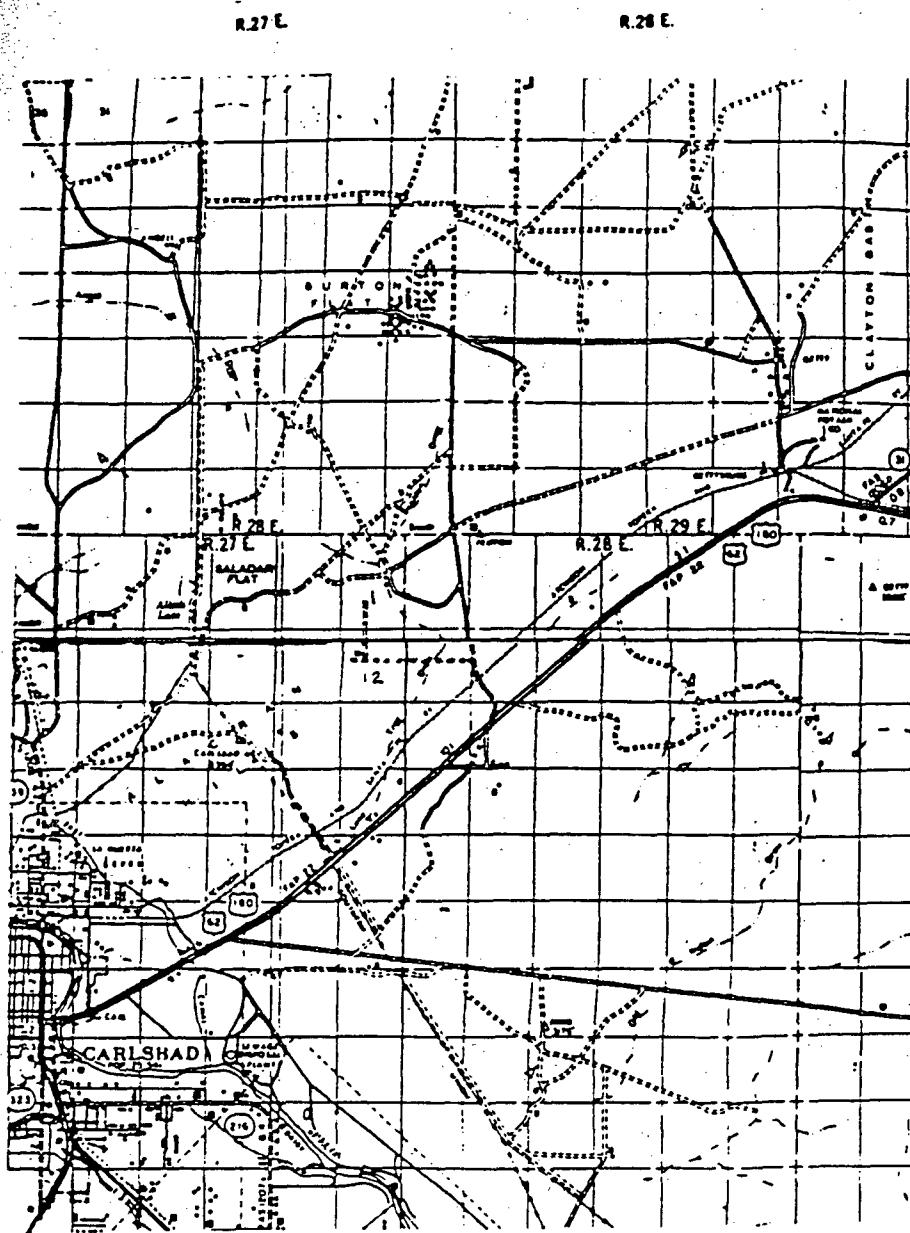

Scale  $\frac{1}{62500}$  or 1 Inch = 3 Miles  
 1 2 3 4  
 STATUTE MILES

## Mobil Producing Texas & New Mexico Inc.

Area Map Government D. Lease  
 Sections 1+12 T-21-S R-27-E  
 Eddy County, New Mexico

DRAWN JH/C	SCALE 1" = 3 m.
CHECKED	DATE 9-19-93
APPROVED	REVISED

R 27 E

R 28 E

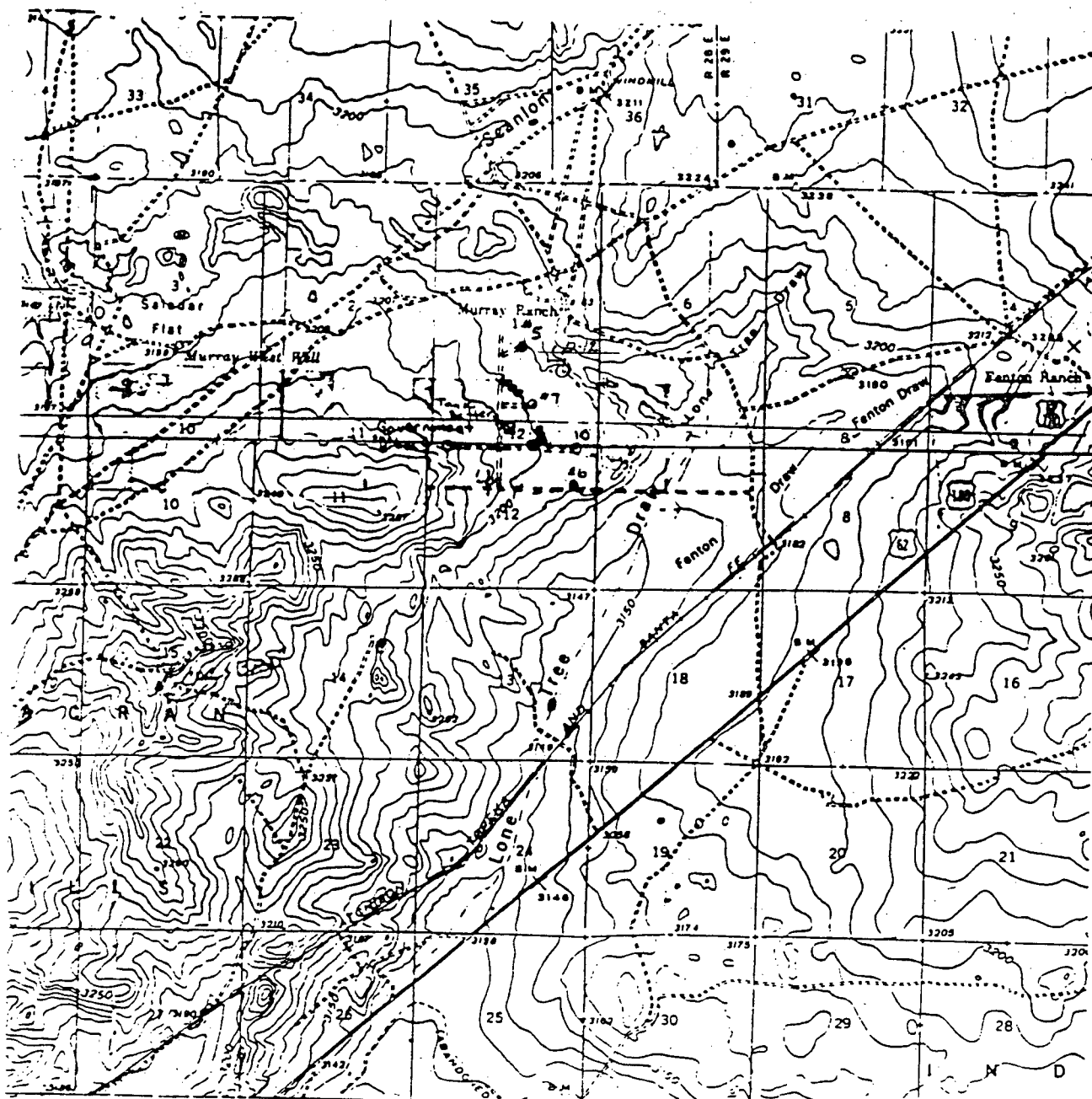

- Proposed well location
- Proposed Tank Battery
- Existing Road
- Proposed recovery well

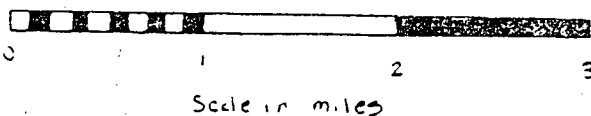

# Mobil Producing Texas & New Mexico Inc.

Vicinity Map of Government  
"D" LEASE - Section 12  
T-21-S R-27-E Eddy Co. N.M.

DRAWN 11/11/45	SCALE 1" = 1 m. c.
CHECKED	DATE 9-19-45
APPROVED	REVISED

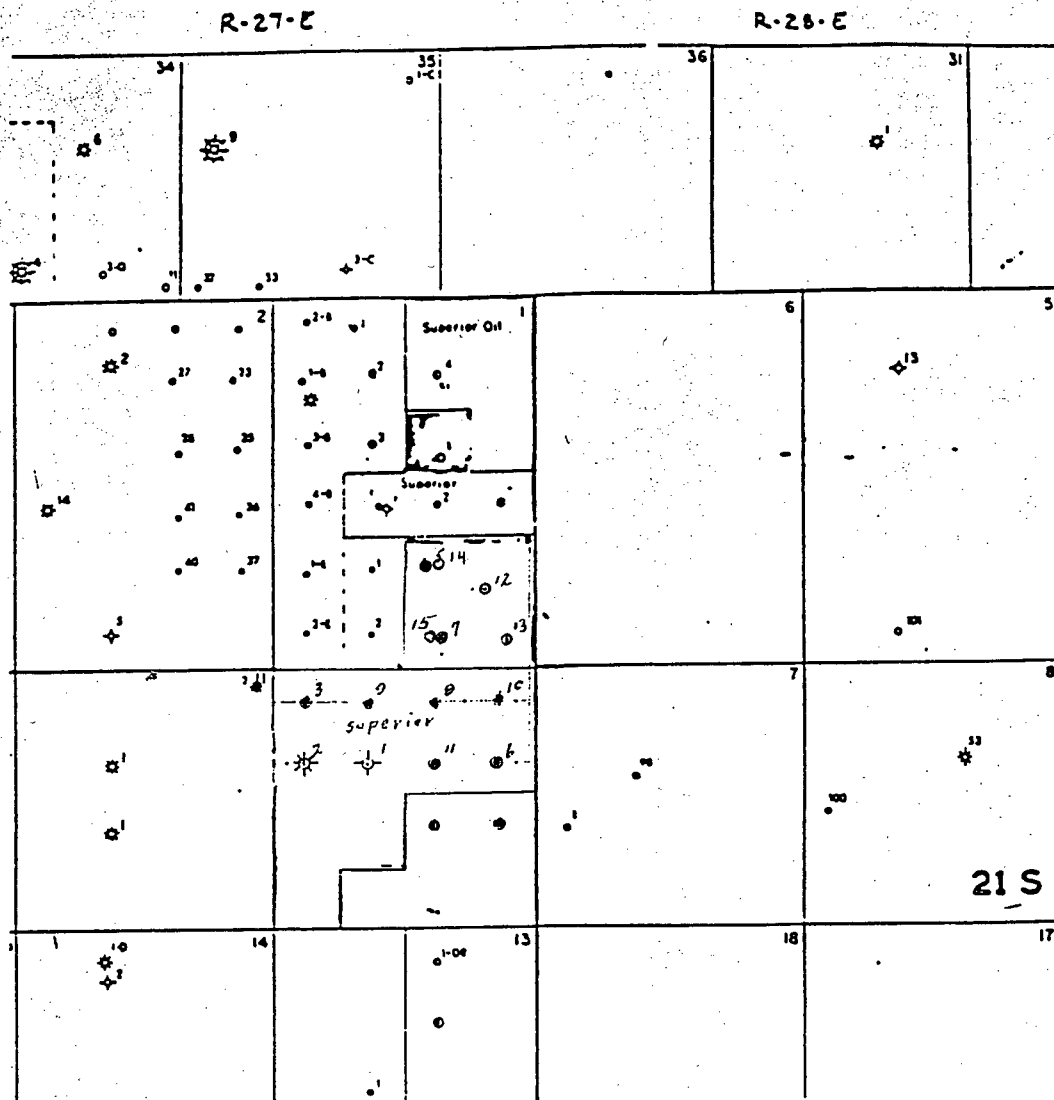

o Proposed well

o Proposed existing well  
in Section 12

**Mobil Producing  
Texas & New Mexico Inc.**

Government 'D' Well Map  
Sections 1+12 T-21-S R-27-E  
Eddy County, New Mexico

DRAWN HAD	SCALE
CHECKED	DATE 9-14-85
APPROVED	REVISED

T20S  
T21S

R27E  
R28E

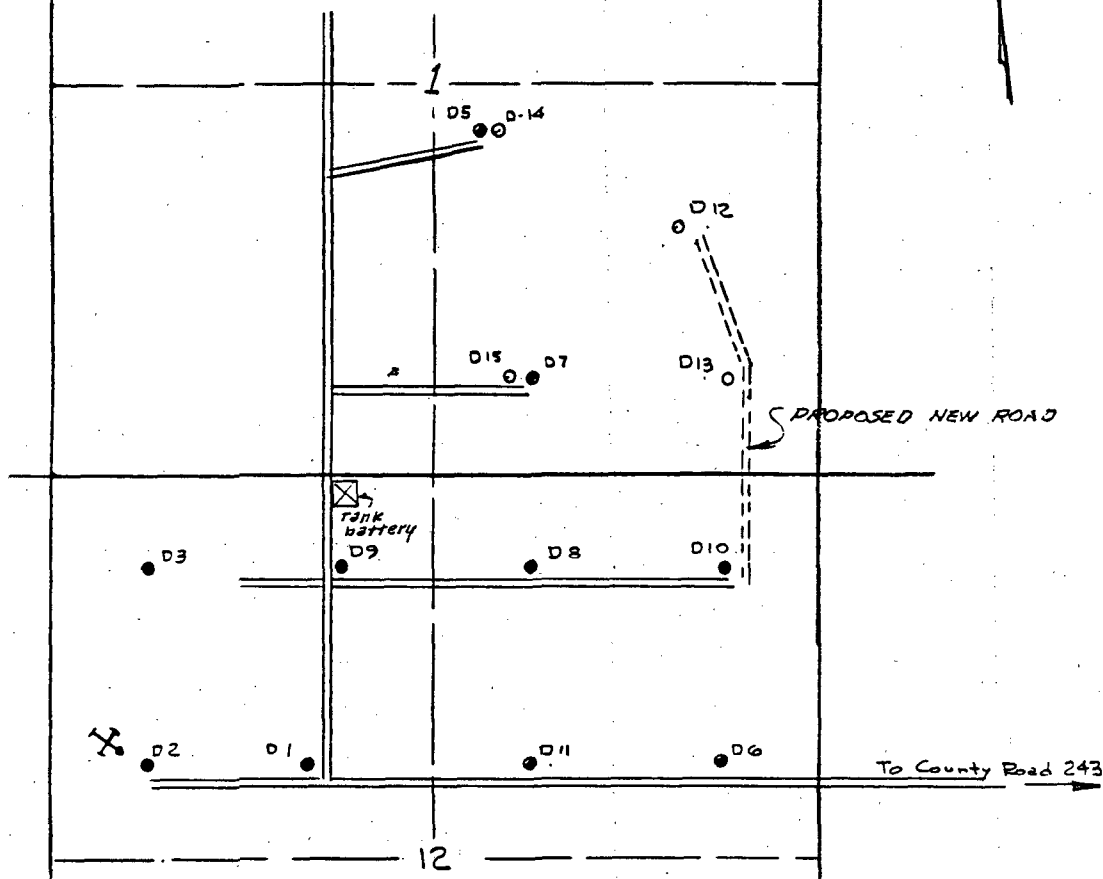

### LEGEND

- = Proposed Location
- = Existing Well
- == = Existing Road
- = Proposed Road

MOBIL PRODUCING TEXAS AND NEW MEXICO INC.

#### DEVELOPMENT PLAT

Sections 1 & 12, Township 21 South, Range  
27 East, N.M.P.M., Eddy County, New Mexico

**J.N. NEWTON & ASSOCIATES**

Land Surveying & Mapping  
SEMINOLE, TEXAS

Date: 12-13-85

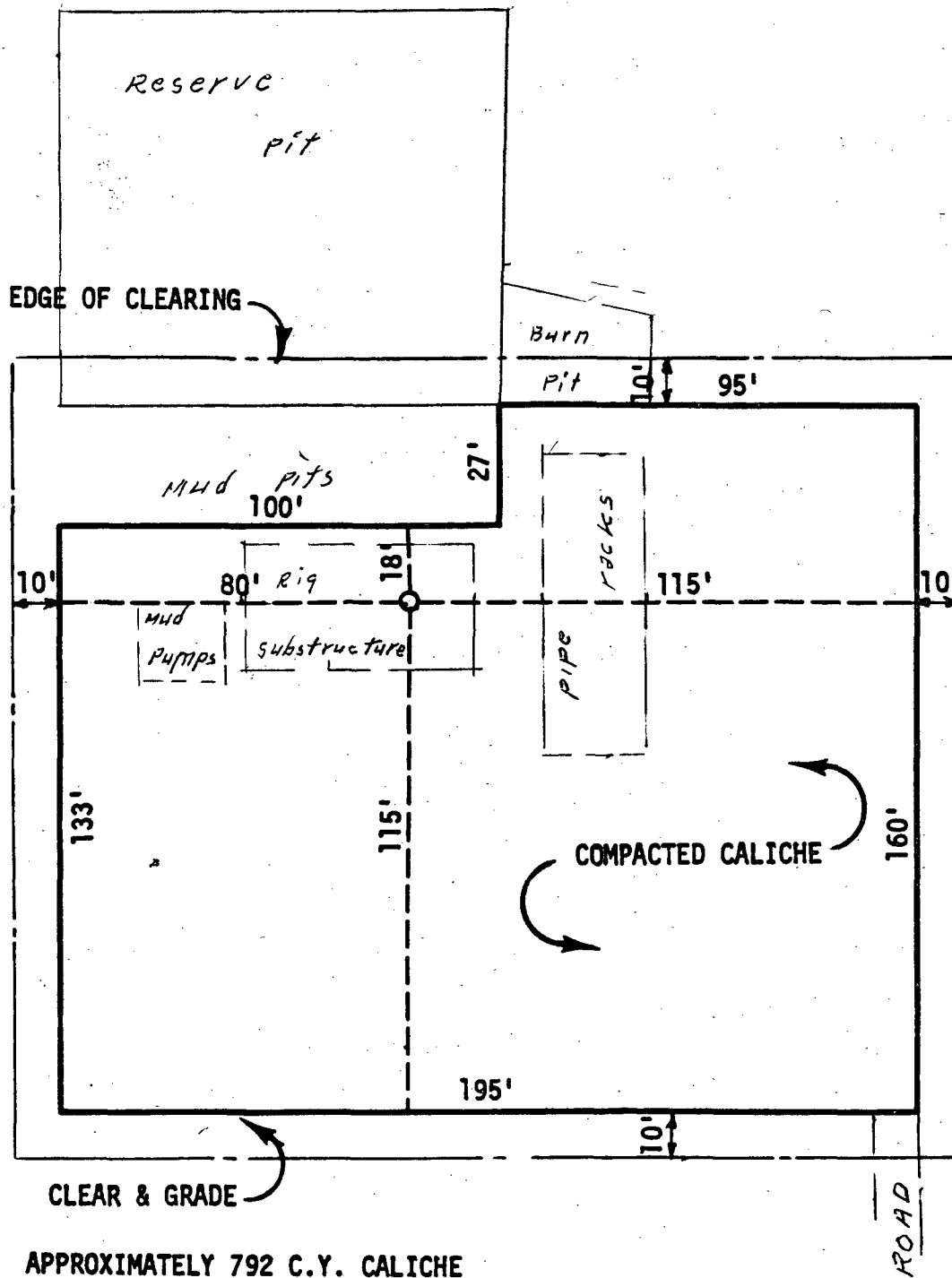

APPROXIMATELY 792 C.Y. CALICHE  
REQUIRED FOR 6" COMPACTED PAD

NO.	DATE	BY	ALTERATION
STANDARD LOCATION PLAN 5000'-7000' DEEP WELLS ON STABLE SOIL			
Mobil Producing Texas & New Mexico Inc.			
DRAWN	SCALE	1" = 40'	DWG. NO.
CHECKED	DATE		A 322



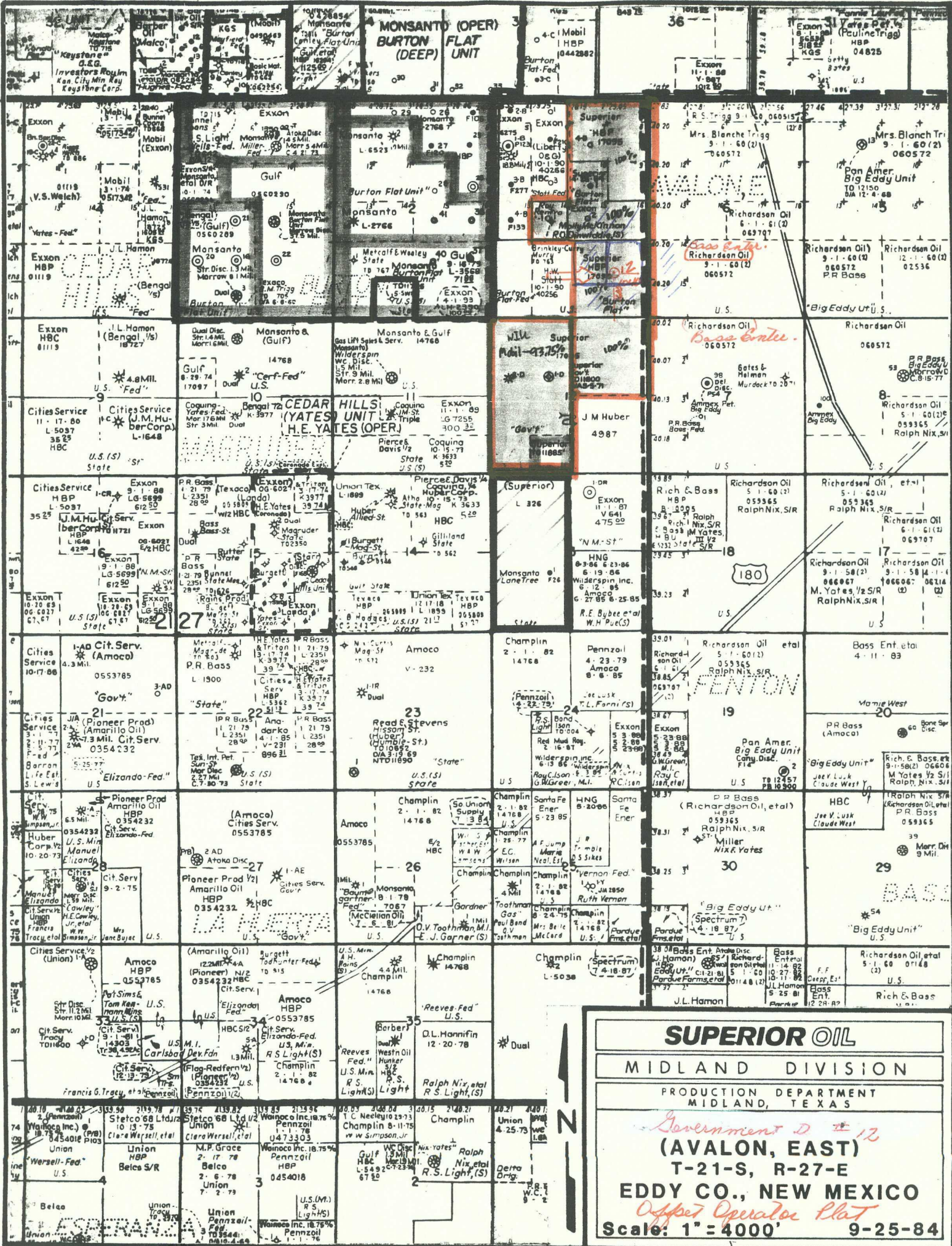

## SUPERIOR OIL

MIDLAND DIVISION

PRODUCTION DEPARTMENT  
MIDLAND, TEXAS

Government D # 12

(AVALON, EAST)

T-21-S, R-27-E

EDDY CO., NEW MEXICO

Officer Operator Plot

Scale: 1" = 4000' 9-25-84



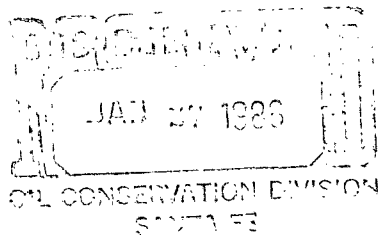

WAIVER

Bass Enterprises Production Company, offset operator to Mobil Producing Tx. & N.M., Inc., as agent for The Superior Oil Company, has no objection to the application to drill the Government "D" Well No. 12 at the following location:

1600' FSL and 1040' FEL  
Section 1, T-21-S, R-27-E  
Avalon, East-Bone Spring Field  
Eddy County, New Mexico

This waiver is granted by the undersigned provided the party or parties seeking the non-standard location by acceptance of this waiver do hereby agree that the said undersigned may drill an offsetting well at a like non-standard location without penalty if the said undersigned deems the drilling of such a well necessary to protect correlative rights.

Signed: Bass Enterprises Production Co.

Name:

  
J. E. Pullig

Title: Division Manager

Date: January 23, 1986

WAIVER

Bass Enterprises Production Company, offset operator to Mobil Producing Tx. & N.M., Inc., as agent for The Superior Oil Company, has no objection to the application to drill the Government "D" Well No. 12 at the following location:

1600' FSL and 1040' FEL  
Section 1, T-21-S, R-27-E  
Avalon, East-Bone Spring Field  
Eddy County, New Mexico

This waiver is granted by the undersigned provided the party or parties seeking the non-standard location by acceptance of this waiver do hereby agree that the said undersigned may drill an offsetting well at a like non-standard location without penalty if the said undersigned deems the drilling of such a well necessary to protect correlative rights.

Signed: Bass Enterprises Production Co.

Name: 

D. E. Pullig

Title: Division Manager

Date: January 23, 1986