

BURLINGTON RESOURCES

SAN JUAN DIVISION

March 25, 1997

Federal Express

Mr. Michael Stogner
New Mexico Oil Conservation Division
2040 South Pacheco Street
Santa Fe, New Mexico 87505

Re: Payne #3E
2155'FNL, 355'FEL, Section 20, T-32-N, R-10-W, San Juan County, NM
API #30-045-27543
NSL-2532

Dear Mr. Stogner:

This is a request for administrative approval for a non-standard gas well location in the Blanco Mesa Verde pool.

Burlington Resources Oil & Gas Company is planning to recomplete the Payne #3E in the Blanco Mesa Verde and plug and abandon the Dakota. Administrative Order NSL-2532 was issued June 21, 1988 for the Dakota. To comply with the New Mexico Oil Conservation Division rules, Burlington is submitting the following for your approval of this non-standard location:

1. C-102 plat showing location of the well;
2. Plat showing offset owners/operators;
3. Copy of Well Completion Log for original completion;
4. Affidavit of notification of offset owners/operators.

A copy of this application is being submitted to all offset owners/operators by certified mail with a request that they furnish your Santa Fe office with a Waiver of Objection, and return one copy to this office.

Sincerely yours,



Peggy Bradfield
Regulatory/Compliance Administrator

WAIVER

_____ hereby waives objection to Burlington Resource's application for non-standard location for the Payne #3E as proposed above.

By: _____ Date: _____

xc: Amoco Production
Conoco Inc.

District I
PO Box 1988, Hobbs, NM 88241-1988
District II
PO Drawer DD, Artesia, NM 88211-0719
District III
1000 Rio Bravo Rd., Aztec, NM 87410
District IV
PO Box 2088, Santa Fe, NM 87504-2088

State of New Mexico
Energy, Minerals & Natural Resources Department

OIL CONSERVATION DIVISION

PO Box 2088
Santa Fe, NM 87504-2088

Form
Revised February 2

Instructions

Submit to Appropriate District

State Lease -

Fee Lease -

☐ AMENDED F

WELL LOCATION AND ACREAGE DEDICATION PLAT

API Number	Pool Code	Pool Name
30-015-27543	72319/71599	Blanco Mesaverde/Basin Dakota
Property Code	Property Name	Well Name
7379	Payne	3E
OGRID No.	Operator Name	Elevation
14538	BURLINGTON RESOURCES OIL & GAS COMPANY	6328

10 Surface Location

UL or lot no.	Section	Township	Range	Lot Ida	Feet from the	North/South line	Feet from the	East/West line	County
H	20	32-N	10-W		2155	North	355	East	S.J

11 Bottom Hole Location if Different From Surface

UL or lot no.	Section	Township	Range	Lot Ida	Feet from the	North/South line	Feet from the	East/West line	County

12 Dedicated Acres 13 Joint or Infill 14 Consolidation Code 15 Order No.
XV-N/316.35
DK-N/316.35

NO ALLOWABLE WILL BE ASSIGNED TO THIS COMPLETION UNTIL ALL INTERESTS HAVE BEEN CONSOLIDATED OR A NON-STANDARD UNIT HAS BEEN APPROVED BY THE DIVISION

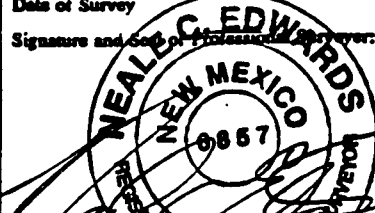
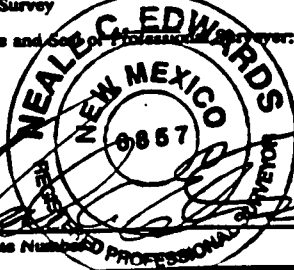
Not resurveyed, prepared from a plat by Cecil B. Tullis dated 5-31-89.	2155'	355'	20	17 OPERATOR CERTIFICATE
				I hereby certify that the information contained is true and complete to the best of my knowledge.
				 Signature Peggy Bradfield Printed Name Regulatory Administrator Title 3-6-97 Date
				18 SURVEYOR CERTIFICATE
				I hereby certify that the well location shown on this plat was plotted from field notes of actual surveys or under my supervision, and that the same is correct to the best of my belief.
				3/03/97 Date of Survey  Signature and Seal of Professional Surveyor  Certificate Number

BURLINGTON RESOURCES OIL AND GAS COMPANY

**Payne #3E
OFFSET OPERATOR \ OWNER PLAT
Nonstandard Location
Mesaverde Formation Well**

Township 32 North, Range 10 West

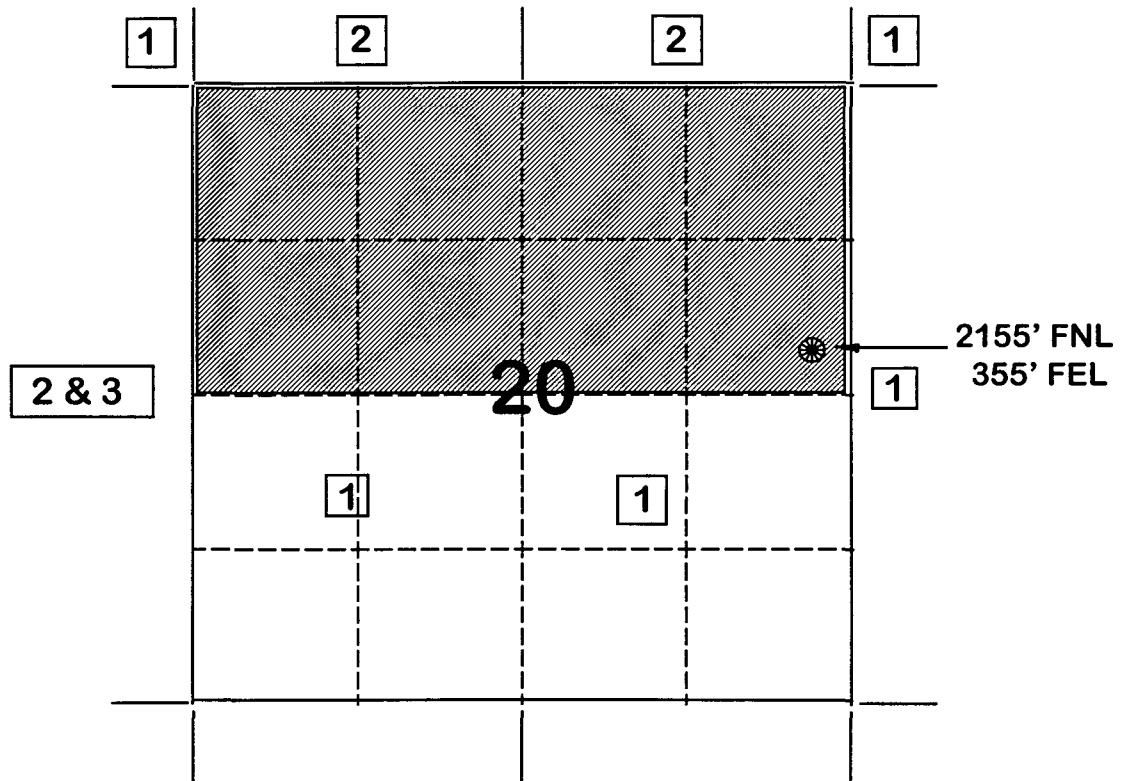

- 1) Burlington Resources Oil and Gas Company
- 2) Amoco Production Company
Attn: Bruce Zimney
P.O. Box 800
Denver, CO 80201
- 3) Conoco Inc.
10 Desta Drive, Suite 100W
Midland, TX 79705

983)
930)

UNITED STATES
DEPARTMENT OF THE INTERIOR
BUREAU OF LAND MANAGEMENT

SUBMIT IN DUPLICATE

(See cover instructions on reverse side)

Form approved.
Budget Bureau No. 1004-0137
Expires August 31, 1985

WELL COMPLETION OR RECOMPLETION REPORT AND LOG *

1. TYPE OF WELL: OIL WELL ☐ GAS WELL ☒ DRY ☐ Other _____
2. TYPE OF COMPLETION: NEW WELL ☒ WORK OVER ☐ DEEP-EN ☐ PLUG BACK ☐ DIFF. REMV. ☐ Other _____

3. NAME OF OPERATOR

Union Texas Petroleum Corp.

4. ADDRESS OF OPERATOR

P.O. Box 2120 Houston, TX 77252-2120

5. LOCATION OF WELL (Report location clearly and in accordance with any State requirements)*

At surface

2155 FNL, 355 FEL

At top prod. interval reported below

At total depth

14. PERMIT NO.

DATE ISSUED

30-045-27543

11-20-89

12. COUNTY OR PARISH

San Juan

13. STATE

NM

15. DATE SPUDDED

12-21-89

16. DATE T.D. REACHED

12-12-90

17. DATE COMPL. (Ready to prod.)

4-3-90

18. ELEVATIONS (OF. RKB. RT. GR. ETC.)*

6328 GR

19. ELEV. CASINGHEAD

20. TOTAL DEPTH, MD & TVD

7900 TVD & MD

21. PLUG. BACK T.D., MD & TVD

7858 TVD & MD

22. IF MULTIPLE COMPL., HOW MANY*

23. INTERVALS DRILLED BY

ROTARY TOOLS

X

CABLE TOOLS

24. PRODUCING INTERVAL(S). OF THIS COMPLETION—TOP, BOTTOM, NAME (MD AND TVD)*

7644-7794; 7695-7787

25. WAS DIRECTIONAL SURVEY MADE

No

26. TYPE ELECTRIC AND OTHER LOGS RUN

DIL; GR-CAL

27. WAS WELL CORED

No

28. CASING RECORD (Report all strings set in well)

CASING SIZE	WEIGHT, LB./FT.	DEPTH SET (MD)	HOLE SIZE	CEMENTING RECORD	AMOUNT PULLED
10 3/4	40.5	670	14 1/2	565	None
7 5/8	26.4	3599	9 7/8	605	"

29. LINER RECORD

SIZE	TOP (MD)	BOTTOM (MD)	SACKS CEMENT*	SCREEN (MD)
5 1/2	3353	7893	425	

30. TUBING RECORD

SIZE	DEPTH SET (MD)	PACKER SET (MD)
2 3/8	7781	7770

31. PERFORATION RECORD (Interval, size and number)

1JSPF 0.32"-23 7644-7794
" " -06 7695-7787

32. ACID. SHOT. FRACTURE. CEMENT SQUEEZE, ETC.

DEPTH INTERVAL (MD)	AMOUNT AND KIND OF MATERIAL USED
7644-7794	Acid 1750 gal 15% HCL
" "	Frac 69,887 Gal 1% X-L Gel
7695-7787	Acid 1000 gal 15% HCL
" "	Frac 87,365 gal 30# X-L gel
" "	Acid 9,000 gal 15% HCL NEFE

33.* PRODUCTION RECORD

DATE FIRST PRODUCTION		PRODUCTION METHOD (Flowing, gas lift, pumping—size and type of pump)				WELL STATUS (Producing or shut-in)	
3-27-90		Flowing				Shut-in	
DATE OF TEST	HOURS TESTED	CHOKE SIZE	PROD'N. FOR TEST PERIOD	OIL—BSL.	GAS—MCF.	WATER—BSL.	GAS-OIL RATIO
5-19-90	1	3/4"	→	--	600	11	ACCEPTED FOR RECORD
FLOW. TUBING PRESS.	CASING PRESSURE	CALCULATED 24-HOUR RATE	OIL—BSL.	GAS—MCF.	WATER—BSL.	OIL GRAVITY-API (CORR.)	
80	700	→				JUN 27 1990	

34. DISPOSITION OF GAS (Sold, used for fuel, vented, etc.)

Vented - no sales line hook-up.

35. LIST OF ATTACHMENTS

36. I hereby certify that the foregoing and attached information is complete and correct as determined from all available records

SIGNED

John White

TITLE

Reg. Permit Coord.

DATE

6-07-90

*(See Instructions and Spaces for Additional Data on Reverse Side)

Title 18 U.S.C. Section 1001, makes it a crime for any person knowingly and willfully to make to any department or agency of the United States any false, fictitious or fraudulent statements or representations as to any matter within its jurisdiction.

Re: Payne #3E
2155'FNL, 355'FEL, Section 20, T-32-N, R-10-W, San Juan County, NM
API #30-045-27543
NSL-2532

Amoco Production Company
Att: Bruce Zimney
PO Box 800
Denver, CO 80201

Conoc Inc.
10 Desta Drive, Suite 100W
Midland, TX 79705

I hereby certify that the following offset owners/operators have been notified by certified mail of our application for administrative approval for non-standard well location of the above well.

Peggy Bradfield
Regulatory/Compliance Administrator

ONGARD
INQUIRE LAND BY SECTION

Sec : 20 Twp : 32N Rng : 10W Section Type : NORMAL

D 40.00	C 40.00	2 39.29	1 39.23
Fee owned	Fee owned	Federal owned	Federal owned
A		A	
E 40.00	3 39.35	4 39.27	5 39.21
Fee owned	Federal owned	Federal owned	Federal owned
			A

PF06
PF12

$$\begin{array}{r} 80.00 \\ 79.35 \\ \hline 159.35 \\ 78.56 \\ \hline 237.91 \\ 78.44 \\ \hline 316.35 \end{array}$$

CMD :
OG5SECT

ONGARD
INQUIRE LAND BY SECTION

04/16/97 01:07:16
OGOMES -EMD7
PAGE NO: 2

Sec : 20 Twp : 32N Rng : 10W Section Type : NORMAL

L 40.00 Federal owned A	8 39.36 Federal owned	7 39.29 Federal owned	6 39.25 Federal owned
M 40.00 Fee owned A	9 39.35 Federal owned	10 39.30 Federal owned	11 39.26 Federal owned A

PF01 HELP
PF07 BKWD

PF02
PF08 FWD

PF03 EXIT
PF09 PRINT

PF04 GoTo
PF10 SDIV

PF05
PF11

PF06
PF12