

MOBIL EXPLORATION & PRODUCING U.S. INC.

P. O. Box 5444
Denver, Colorado 80217-5444

October 12, 1988

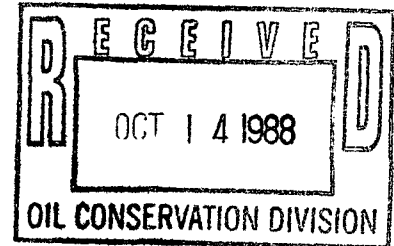

State of New Mexico
Energy and Minerals Department
Oil Conservation Division
P. O. Box 2088
Santa Fe, New Mexico 87504-2088

APPLICATION FOR EXCEPTION
UNORTHODOX LOCATION
HARRINGTON FEDERAL NO. 28-1
RIO ARRIBA COUNTY, NEW MEXICO

Gentlemen:

Mobil Producing Texas & New Mexico, Inc. requests administrative exception for the unorthodox location 2285' FNL and 2130' FEL of section 28, T24N, R1W, Rio Arriba County, New Mexico. This unorthodox location is required for the preservation of antiquities found in the proximity of any normal location for ~~Salt~~ and Basin Dakota completion. The archeological survey is submitted herewith.

Copies of the original C-102, Survey plat and the archeological survey of the location are enclosed along with copies of offset operators approval of this location.

If you have any questions regarding this request, please contact Bill Landry at the above address or telephone (303) 298-2620.

Yours truly,

Bill Landry
R L Buehler for (303)
B R Maynard
B. R. Maynard
Regulatory Compliance Manager

*E/2 - 320
Basin Dakota*

WEL:Enclosures

cc: N. M. Oil conservation Division, Aztec

- West Puerto Chiquito Manor

*call when
advised*

(270 area)

MOBIL EXPLORATION & PRODUCING U.S. INC.

P. O. Box 5444
Denver, Colorado 80217-5444

October 12, 1988

CERTIFIED MAIL
RETURN RECEIPT REQUESTED

BHP Production Company Inc.
5613 DTC Parkway, Suite 600
Englewood, Colorado 80111
Attention: Donald Reinhaedt

APPLICATION FOR EXCEPTION
UNORTHODOX LOCATION
HARRINGTON FEDERAL NO. 28-1
RIO ARriba COUNTY, NEW MEXICO

Gentlemen:

Mobil Producing Texas & New Mexico, Inc. has requested administrative exception for the unorthodox location 2285' FNL and 2130' FEL of section 28, T24N, R1W, Rio Arriba County, New Mexico. This unorthodox location is required for the preservation of antiquities found in the proximity of any normal location for Gallup and Basin Dakota completion. The archeological survey is submitted herewith.

Indication of your approval of this exception is requested. Please return a signed approved copy of this letter to Mobil Exploration & Producing U. S. Inc. in the enclosed envelope.

If you have any questions regarding this request, please contact Bill Landry at (303) 298-2620.

Yours very truly,

RL Briabin for
B R Maynard
B. R. Maynard
Regulatory Compliance Manager

WEL

APPROVED

J. C. McJury
TITLE: Operations Manager
COMPANY: BHP Petroleum (Americas) Inc.
DATE: 10/12/88

MOBIL EXPLORATION & PRODUCING U.S. INC.

P. O. Box 5444
Denver, Colorado 80217-5444

October 12, 1988

CERTIFIED MAIL
RETURN RECEIPT REQUESTED

A. G. Hill, Oil Producer
5000 Thanksgiving Tower
Dallas, Texas 75201
Attention: Gregg Ewing

APPLICATION FOR EXCEPTION
UNORTHODOX LOCATION
HARRINGTON FEDERAL NO. 28-1
RIO ARriba COUNTY, NEW MEXICO

Gentlemen:

Mobil Producing Texas & New Mexico, Inc. has requested administrative exception for the unorthodox location 2285' FNL and 2130' FEL of section 28, T24N, R1W, Rio Arriba County, New Mexico. This unorthodox location is required for the preservation of antiquities found in the proximity of any normal location for Gallup and Basin Dakota completion. The archeological survey is submitted herewith.

Indication of your approval of this exception is requested. Please return a signed approved copy of this letter to Mobil Exploration & Producing U. S. Inc. in the enclosed envelope.

If you have any questions regarding this request, please contact Bill Landry at (303) 298-2620.

Yours very truly,

*RL Brubaker for
B R Maynard*

B. R. Maynard
Regulatory Compliance Manager

WEL

APPROVED

TITLE: _____
COMPANY: _____
DATE: _____

MOBIL EXPLORATION & PRODUCING U.S. INC.

P. O. Box 5444
Denver, Colorado 80217-5444

October 12, 1988

CERTIFIED MAIL
RETURN RECEIPT REQUESTED

Billie S. Werntz
606 Lomalinda Place SE
Albuquerque, N. M. 87108

APPLICATION FOR EXCEPTION
UNORTHODOX LOCATION
HARRINGTON FEDERAL NO. 28-1
RIO ARriba COUNTY, NEW MEXICO

Gentlemen:

Mobil Producing Texas & New Mexico, Inc. has requested administrative exception for the unorthodox location 2285' FNL and 2130' FEL of section 28, T24N, R1W, Rio Arriba County, New Mexico. This unorthodox location is required for the preservation of antiquities found in the proximity of any normal location for Gallup and Basin Dakota completion. The archeological survey is submitted herewith.

Indication of your approval of this exception is requested. Please return a signed approved copy of this letter to Mobil Exploration & Producing U. S. Inc. in the enclosed envelope.

If you have any questions regarding this request, please contact Bill Landry at (303) 298-2620.

Yours very truly,

RL Brinkman
B.R. Maynard 10/13/88
B. R. Maynard
Regulatory Compliance Manager

WEL

APPROVED

TITLE: _____
COMPANY: _____
DATE: _____

MOBIL EXPLORATION & PRODUCING U.S. INC.

P. O. Box 5444
Denver, Colorado 80217-5444

October 12, 1988

CERTIFIED MAIL
RETURN RECEIPT REQUESTED

J. Hiram Moore Trust
c/o Michael Harrison Moore
P. O. Box 1733
Midland, Texas 79701

APPLICATION FOR EXCEPTION
UNORTHODOX LOCATION
HARRINGTON FEDERAL NO. 28-1
RIO ARriba COUNTY, NEW MEXICO

Gentlemen:

Mobil Producing Texas & New Mexico, Inc. has requested administrative exception for the unorthodox location 2285' FNL and 2130' FEL of section 28, T24N, R1W, Rio Arriba County, New Mexico. This unorthodox location is required for the preservation of antiquities found in the proximity of any normal location for Gallup and Basin Dakota completion. The archeological survey is submitted herewith.

Indication of your approval of this exception is requested. Please return a signed approved copy of this letter to Mobil Exploration & Producing U. S. Inc. in the enclosed envelope.

If you have any questions regarding this request, please contact Bill Landry at (303) 298-2620.

Yours very truly,

R L Brubaker for
B R Maynard 10/13/88

B. R. Maynard
Regulatory Compliance Manager

WEL

APPROVED

TITLE: _____
COMPANY: _____
DATE: _____

MOBIL EXPLORATION & PRODUCING U.S. INC.

P. O. Box 5444
Denver, Colorado 80217-5444

October 12, 1988

CERTIFIED MAIL
RETURN RECEIPT REQUESTED

Charles B. Read
P. O. Box 1518
Roswell, New Mexico 88201

APPLICATION FOR EXCEPTION
UNORTHODOX LOCATION
HARRINGTON FEDERAL NO. 28-1
RIO ARriba COUNTY, NEW MEXICO

Gentlemen:

Mobil Producing Texas & New Mexico, Inc. has requested administrative exception for the unorthodox location 2285' FNL and 2130' FEL of section 28, T24N, R1W, Rio Arriba County, New Mexico. This unorthodox location is required for the preservation of antiquities found in the proximity of any normal location for Gallup and Basin Dakota completion. The archeological survey is submitted herewith.

Indication of your approval of this exception is requested. Please return a signed approved copy of this letter to Mobil Exploration & Producing U. S. Inc. in the enclosed envelope.

If you have any questions regarding this request, please contact Bill Landry at (303) 298-2620.

Yours very truly,

R L Brubaker for
B R Maynard 10/13/88

B. R. Maynard
Regulatory Compliance Manager

WEL

APPROVED

TITLE: _____
COMPANY: _____
DATE: _____

**NEW MEXICO OIL CONSERVATION COMMISSION
WELL LOCATION AND ACREAGE DEDICATION PLAT**

Form C-102
Supersedes C-128
Effective 1-1-65

All distances must be from the outer boundaries of the Section.

Operator BHP PETROLEUM (AMERICAS) INC.			Lease SF 079352 A		Well No. Crane Fed...7-28-
Unit Letter G	Section 28	Township 24 N	Range 1 W	County RIO ARRIBA	
Actual Footage Location of Well: <div style="display: flex; justify-content: space-between;"> 2285 feet from the North line and 2130 feet from the East line </div>					
Ground Level Elev. 7380	Producing Formation Niobrara	Pool	Dedicated Acreage: 640 Acres		

1. Outline the acreage dedicated to the subject well by colored pencil or hachure marks on the plat below.
2. If more than one lease is dedicated to the well, outline each and identify the ownership thereof (both as to working interest and royalty).
3. If more than one lease of different ownership is dedicated to the well, have the interests of all owners been consolidated by communitization, unitization, force-pooling, etc?

☐ Yes ☒ No If answer is "yes," type of consolidation _____

If answer is "no," list the owners and tract descriptions which have actually been consolidated. (Use reverse side of this form if necessary.) N¹/₂ SW¹/₄, NW¹/₄ SE¹/₄ and NE¹/₄ SE¹/₄, S¹/₂ S¹/₂ both owned by BHP Petroleum Company,
 No allowable will be assigned to the well until all interests have been consolidated (by communitization, unitization, forced-pooling, or otherwise) or until a non-standard unit, eliminating such interests, has been approved by the Commission.

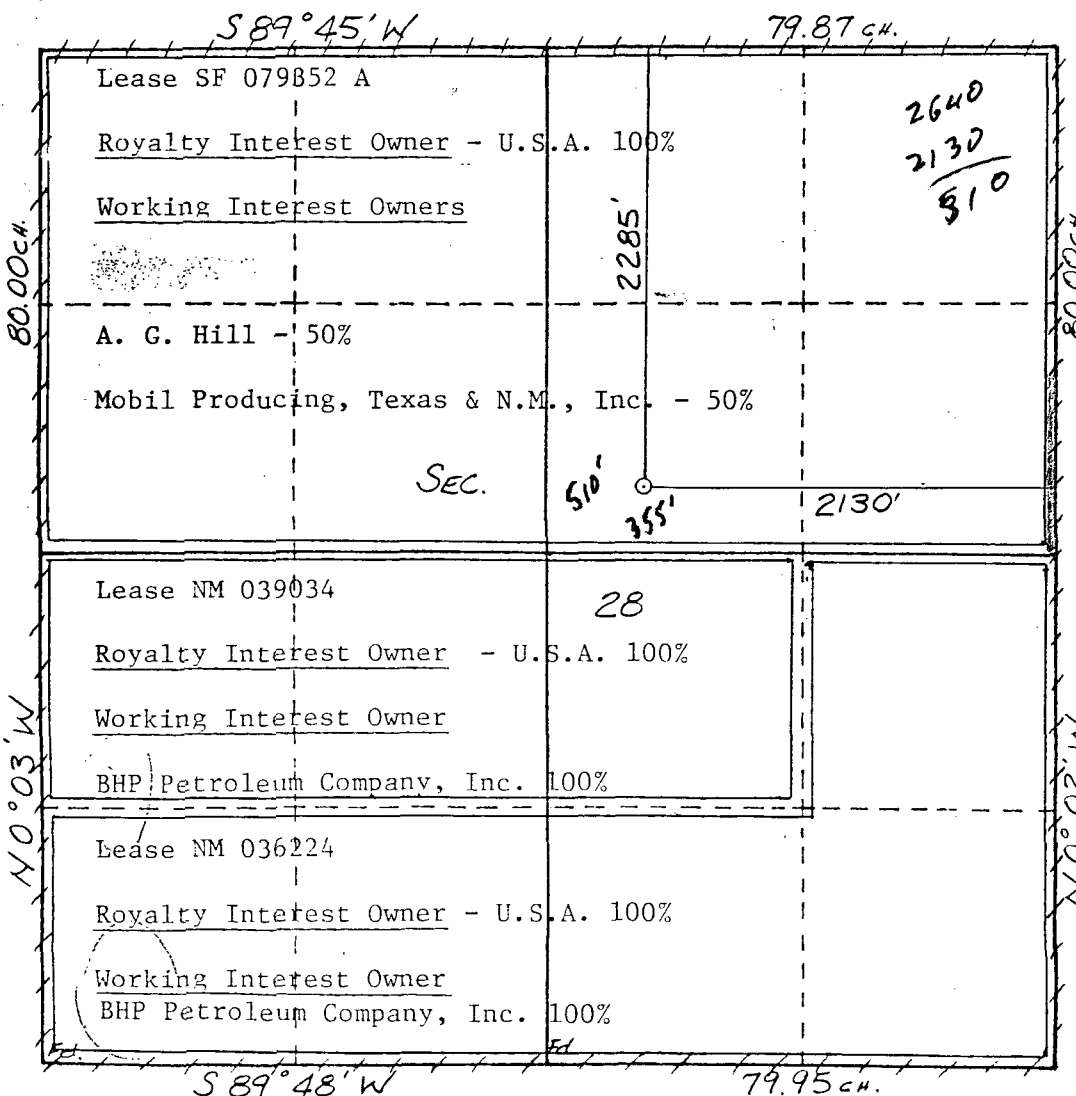

2285 355 2640 2130 310		CERTIFICATION I hereby certify that the information contained herein is true and complete to the best of my knowledge and belief. <i>Chuck Williams</i> Chuck Williams
Name Administrator, Field Services		
Position BHP Petroleum (Americas) Inc.		
Company August 31, 1988		
Date		
I hereby certify that the well location shown on this plat was plotted from field notes of actual surveys made by me or under my supervision, and that the same is true and correct to the best of my knowledge and belief.		
Date Surveyed William H. Markke II		
Registered Professional Engineer and/or Land Surveyor #8466		
Certificate No. 8466		

Project No. 105-88-C

Cultural Resource Use Permit
7-2920-87-D (NM BLM)

An Archaeological Survey of
Two Proposed Well Locations Near Almagre Arroyo,
Rio Arriba County, New Mexico

for

BHP Petroleum (Americas) Inc.

Crane Fed 7-28

Crane Fed 7-29

by

Jerry D. William
Supervisory Archaeologist

Submitted by

Byron P. Johnson
Director

DIVISION OF CONSERVATION ARCHAEOLOGY

Technical Report No. 1387
San Juan County Archaeological Research Center and Library

August 31, 1988

ABSTRACT

On August 22, 1988, the Division of Conservation Archaeology of the San Juan County Museum Association completed an archaeological survey of two proposed well locations for BHP Petroleum (Americas) Inc. The survey area is located in T24N, R1W, Sections 28 and 29, Rio Arriba County, New Mexico and is under the jurisdiction of the Bureau of Land Management. Approximately 23.02 acres were intensively inventoried.

Seven isolates and one site were recorded. The site is in the north and east buffer zones of Crane Fed 7-29. The documentation of the isolates in the field has exhausted their research potential. The Crane Fed 7-28 location is recommended for clearance. The Crane Fed 7-29 location is recommended for clearance with the stipulations as discussed in the report.

INTRODUCTION

On August 22, 1988, the Division of Conservation Archaeology (DCA) of the San Juan County Museum Association conducted an archaeological survey for BHP Petroleum (Americas) Inc. Englewood, Colorado. Chuck Williams of BHP Petroleum Inc. requested the survey and administered the project. Byron P. Johnson administered the project for DCA.

In recognition of the limited, nonrenewable nature of archaeological remains, the federal government has enacted legislation that is designed to conserve and protect these resources. The principal legislation includes the Antiquities Act of 1906 (PL 52-209), the Historic Preservation Act of 1966 (PL 89-665) and, as amended (PL 96-515), the National Environmental Policy Act of 1969 (PL 91-852), the 1971 Executive Order No. 11593, the Archaeological and Historical Conservation Act of 1974 (PL 93-291), and the Archaeological Resources Protection Act of 1979 (PL 96-95). In addition, the Navajo Nation and the states of Arizona, New Mexico, Utah, and Colorado have enacted laws to ensure compliance with federal legislation and to protect archaeological resources within their jurisdiction. Work undertaken in the course of this project is intended to comply with these statutes and is governed by the stipulations of Cultural Resource Use Permit No. 7-2920-87-D (NM BLM).

Jerry D. William, DCA archaeologist, surveyed the project area for cultural remains.

METHODS

The well pads and pad buffer zones were surveyed by an archaeologist (J. D. William) walking parallel transects 12-15m apart across the locations. Access roads were surveyed by walking a zigzag pattern across the road and buffer zones along the length of the proposed roadway. A buffer zone of 150 ft on each side of the well pads was included in the survey as well as a 50 ft buffer zone on each side of the access roads. All cultural remains were recorded. Those whose information potential exceeded what could be extracted during the survey phase were assigned site status. Other cultural remains were documented as isolated finds (IF). Pertinent environmental data were also recorded.

In addition to field inspection, the archaeologist conducted a search of the records at the DCA and the Bureau of Land Management (BLM), Farmington Resource Area offices to determine if any sites had been recorded in the project area. Site and project records required by the BLM and the New Mexico Historic Preservation Division were completed.

Previously Recorded Sites: Four previously recorded sites are located within a one mile radius of the project areas (see BLM Supplement #1, provided only to BLM). These sites are LA numbers 11848, 11849, 11850, and 32229. No information is available for these sites.

PROJECT DESCRIPTION

Crane Fed 7-28

Legal Description: T24N, R1W, Section 28, NW 1/4 SW 1/4 NE 1/4
S 1/2 SW 1/4 NE 1/4
2285' F/NL, 2130' F/EL
N.M.P.M., Rio Arriba County, New Mexico

Map Source: U.S.G.S. 7.5' Laguna Gurule (Provisional Edition 1983)

Land Jurisdiction: Bureau of Land Management

Project Area: 300' x 270' (well pad)
500' x 50' (access road)

Surveyed Area: 600' x 570' (well pad with buffer)
500' x 150' (access road with buffer)
9.57 Acres

Description: The proposed location for well Crane Fed 7-28 is in the valley bottom of a south draining tributary to Almagre Arroyo (Figure 1). High, narrow, steep-sided ridges are present to the north and west of the location. The tops of these ridges are generally so eroded that they form an inverted V and provide no flat surface for vegetation. A small, sandstone boulder strewn hill lies just to the east of the survey area. The project area is cut by several small drainage channels which trend generally from the northwest to the southeast. A substantial channel occurs along the west edge of the survey area and cuts to the southeast through the south buffer zone.

The area is currently privately owned and used for grazing of livestock. Erosion has occurred over part of the area, but it is generally in good condition. The area is in scrubland with the vegetation consisting primarily of sagebrush (Artemisia tridentata), various grasses, and snakeweed (Gutierrezia sarothrae). Other types of vegetation present include pinyon pine (Pinus edulis) and prickly pear cactus (Opuntia sp.). The vegetation covers only ca. 10% of the ground surface.

Cultural Resources: Five artifacts were found and recorded as isolated finds (IFs). All of these were in the buffer zone areas (Figure 2). Table 1 presents information concerning these artifacts.

Recommendations: The impact to cultural resources in this proposed well pad area are judged to have been mitigated through the recording of their presence, type, and location. Archaeological clearance is recommended. The Bureau of Land Management will make the final clearance determination after review of this report.

Table 1. Isolated Find Descriptions

IF#	T	Legal Description					UTM Coordinates (Zone 13)	Land- form*	Description
		R	Sec.	1/4	1/4	1/4			
<u>Crane 7-28</u>									
1	24N	1W	28	SW	SW	SW	4016880N, 325170E	V	unidentified grayware sherd (badly eroded)
2	24N	1W	28	SW	SW	SW	4016905N, 325150E	V	large secondary decortication flake, quartzite; 8.0 x 2.4 x 1.8cm
3	24N	1W	28	SW	SW	SW	4016850N, 325305E	V	tested quartzite cobble
4	24N	1W	28	SW	SW	SW	4016925N, 325200E	V	medium secondary decortication flake quartzite; 3.2 x 3.1 x 0.8cm
5	24N	1W	28	SW	SW	SW	4016935N, 325300E	V	Gallina B/G neck sherd
<u>Crane 7-29</u>									
1	24N	1W	29	SW	SW	NE	4017945N, 323620E	V	Gallina B/G pot break five sherds
2	24N	1W	29	SW	SW	NE	4017955N, 323780E	V	large secondary decortication flake, chalcedony; 7.4 x 3.2 x 0.6cm

* V = valley floor

Crane Fed 7-29

Legal Description: T24N, R1W, Section 29, SW 1/4 NE 1/4
2080' F/NL, 2150' F/EL
N.M.P.M., San Juan County, New Mexico

Map Source: U.S.G.S. 7.5' Laguna Gurule (Provisional Edition 1983)

Land Jurisdiction: Bureau of Land Management

Project Area: 300' x 270' (well pad)
1625' x 50' (access road)

Surveyed Area: 600' x 570' (well pad with buffer)
1625' x 150' (access road with buffer)
13.45 Acres

Description: The proposed location for well Crane Fed 7-29 is in the valley bottom in the upper reaches of Almagre Arroyo (see Figure 1). The ridge line of the Continental Divide lies just 450m to the west of the project area. High, narrow, steep-sided ridges are present to the north, west, and south of the location. The tops of these ridges are generally so eroded that they form an inverted V and provide no flat surface for vegetation. A similar ridge is present ca. 1.0km to the east. The project area is cut by several small drainage channels which trend generally from the north to the south, but near the north edge of the pad channels converge from the east and west into a south flowing channel. A substantial channel flows parallel with the west edge of the location then cuts to the east through the south buffer zone.

The area is currently privately owned and used for grazing of livestock. Erosion has occurred over part of the area especially near the north end of the pad and within the north buffer zone. The area is in scrubland with the vegetation consisting primarily of sagebrush, various grasses, and snakeweed. Other types of vegetation present include juniper (Juniperus sp.), pinyon pine, rabbitbrush (Chrysothamnus nauseosus), and club cholla (Opuntia clavata), prickly pear, and small Echinocereus sp. cactus. A woodland area begins in the east buffer zone and this is the location where most of the pinyon and juniper trees are located. The vegetation covers ca. 40% of the ground surface.

Cultural Resources: Two isolated finds and one site were recorded during the archaeological survey of this pad location. The isolated finds are briefly defined in Table 1 and their locations shown in Figure 3. The site is located in the north and east buffer zones and beyond the proposed project area. Artifacts displaced from the site area by erosion occur scattered throughout the drainage in the east portion of the project area.

Site DCA-88-185: This site currently consists of a scatter of cultural material in and along a drainage in the north and east buffer zones and beyond the buffer zones to the east (Figure 4). A trash midden is located just beyond the east buffer zone. Most of this site was originally located on the top of a ridge, with apparently the only portion of the site on the valley floor being the trash midden. The level portion of the ridge top has been completely eroded away, destroying that portion of the site. Artifacts are

present from the thin ridge top to the bottom of the very steep ridge walls and are scattered well down the drainage to within the project area. Very small pieces of blue flagging tape around the site suggest that the site has been identified previously, but no record of this is present.

The trash midden is to the east of the project area. This midden is currently identified as a mound of soil and cultural material existing as an island within the drainage on the east edge of the project area. The cultural material is eroding out of the mound especially along the west side. A two-track runs across the drainage from east to west and alongside the midden.

Cultural material is very dense on the east and north sides of the ridge line. Artifact types include ceramics, chipped stone, groundstone, and bone. It is likely that other types of materials are present given the density of the cultural material. Diagnostic bone elements are present.

A short, broad, side-notched arrowpoint manufactured from a glossy black chert was present at the site. The distal tip of the point had been broken off during manufacture. It is plano-convex in cross section with the ventral face of the original flake blank being the plano surface. The point is 1.9cm (estimated) long, 1.4cm wide, and 0.5cm thick.

A second biface noted at the site is a large thin biface manufactured from a low quality chalcedony. The material has been heat-treated causing a reddish discoloration and a glassy texture over nonresharpened portions of the artifact. The point is slightly asymmetrical probably because of resharpening. It is triangular with side notches and a small, very shallow basal indentation. The distal end has been removed through a lateral snap. The point is probably a recycled Archaic point. It is 4.7cm long with a maximum blade width of 2.5cm and a basal width of 2.6cm. The point is biconvex in cross section with a maximum thickness of 0.8cm.

Ceramic material on the site included brownwares, graywares, and Gallina black-on-gray sherds. Ceramics at the site are estimated to number in the tens of thousands. Chipped stone is estimated to number in the thousands.

Recommendations: Although most of the cultural material in this site has been redeposited, the quantity and variety of materials present can provide information concerning site function, subsistence, and period of occupation. The midden contains intact cultural deposits. Clearance is recommended for this proposed well pad with the following stipulations:

1. The ridge line in the north buffer zone be left intact.
2. The site area, as identified in Figure 4, north and east of the right rear corner survey stake will be fenced to ensure that the site is not impacted by construction activities.

Final clearance determination will be made by the Bureau of Land Management after review of this report.

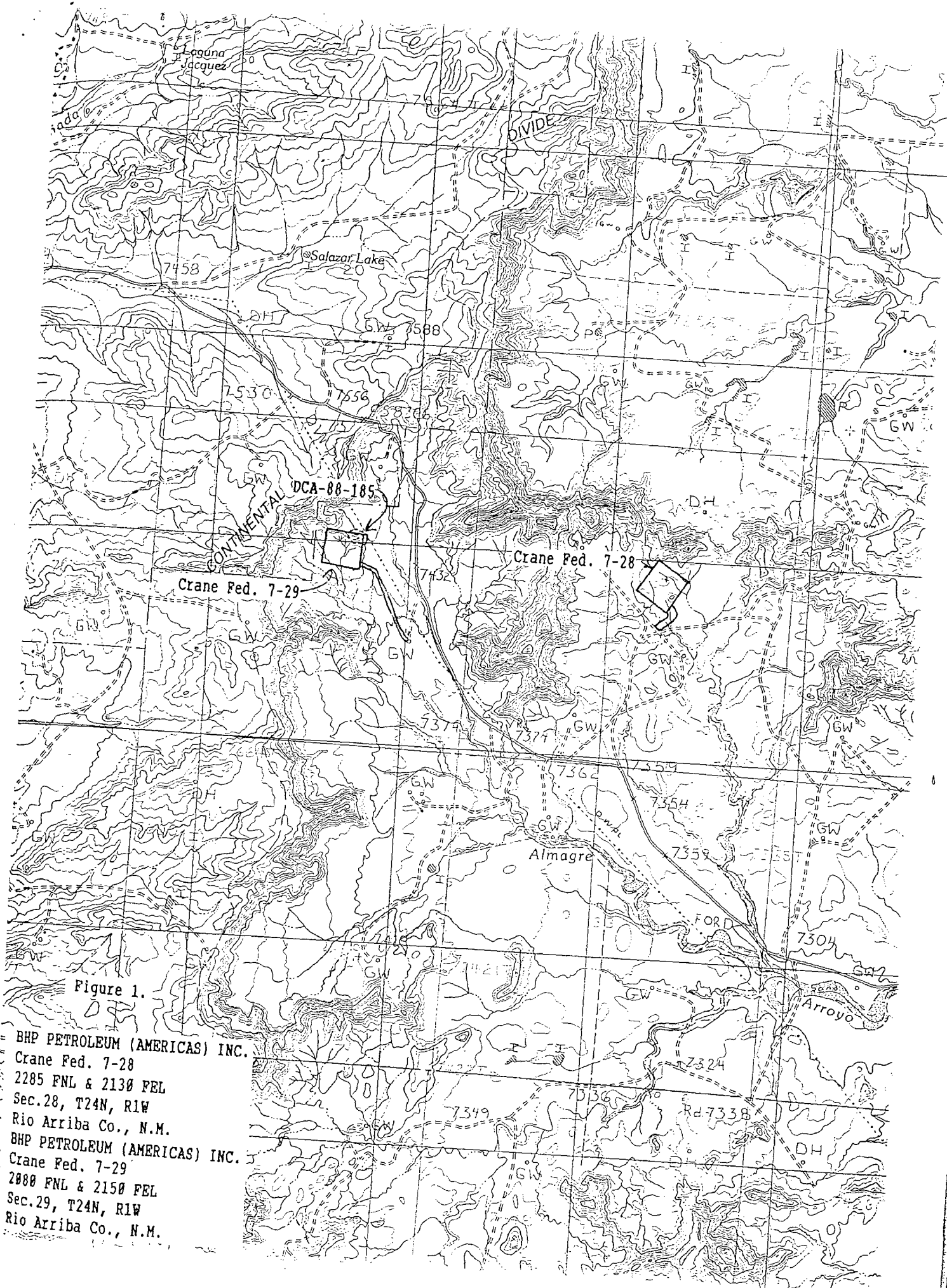

Figure 1.

BHP PETROLEUM (AMERICAS) INC.
 Crane Fed. 7-28
 2285 FNL & 2130 FEL
 Sec. 28, T24N, R1W
 Rio Arriba Co., N.M.
 BHP PETROLEUM (AMERICAS) INC.
 Crane Fed. 7-29
 2080 FNL & 2150 FEL
 Sec. 29, T24N, R1W
 Rio Arriba Co., N.M.

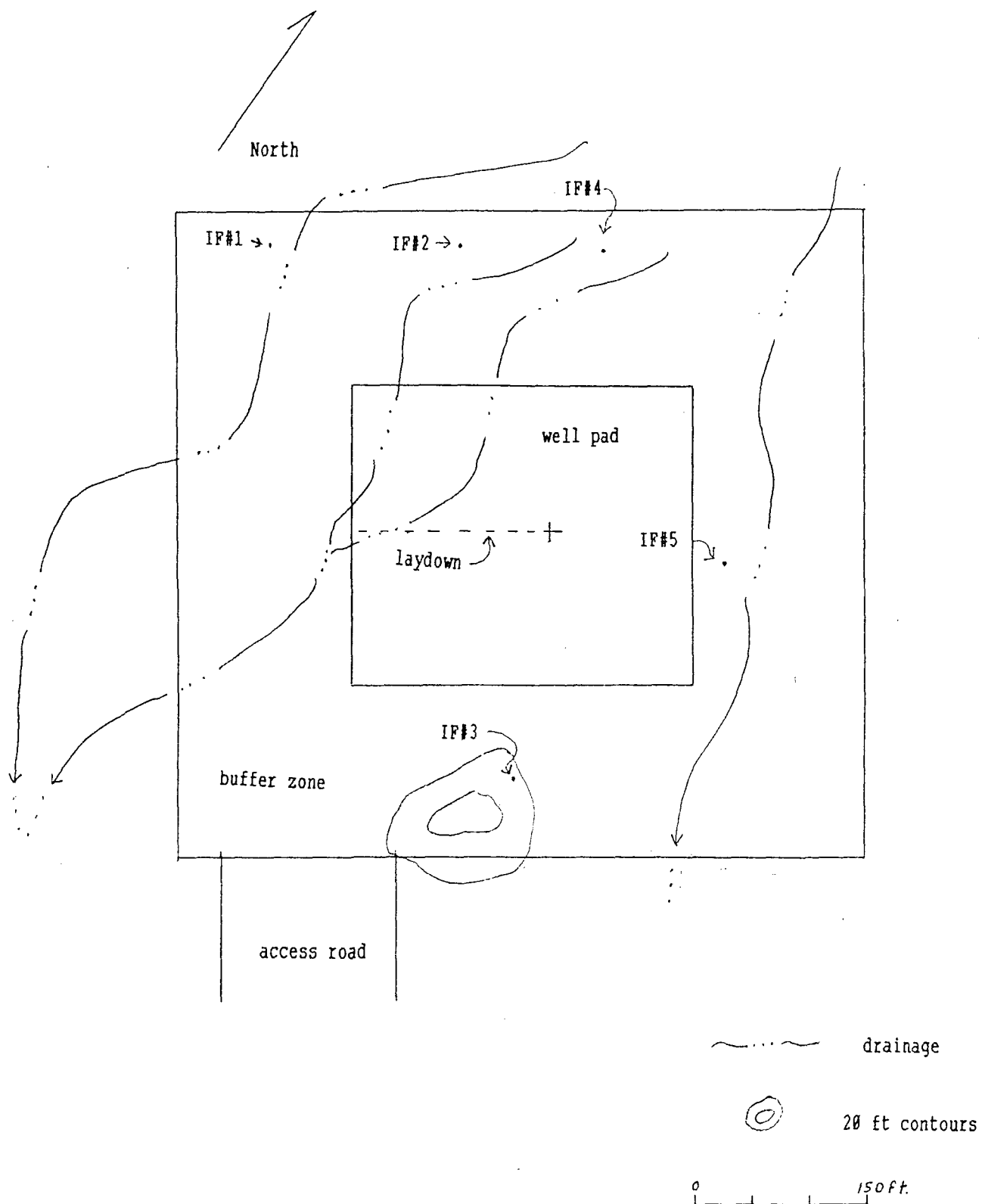

Figure 2. Crane 7-28 survey area map.

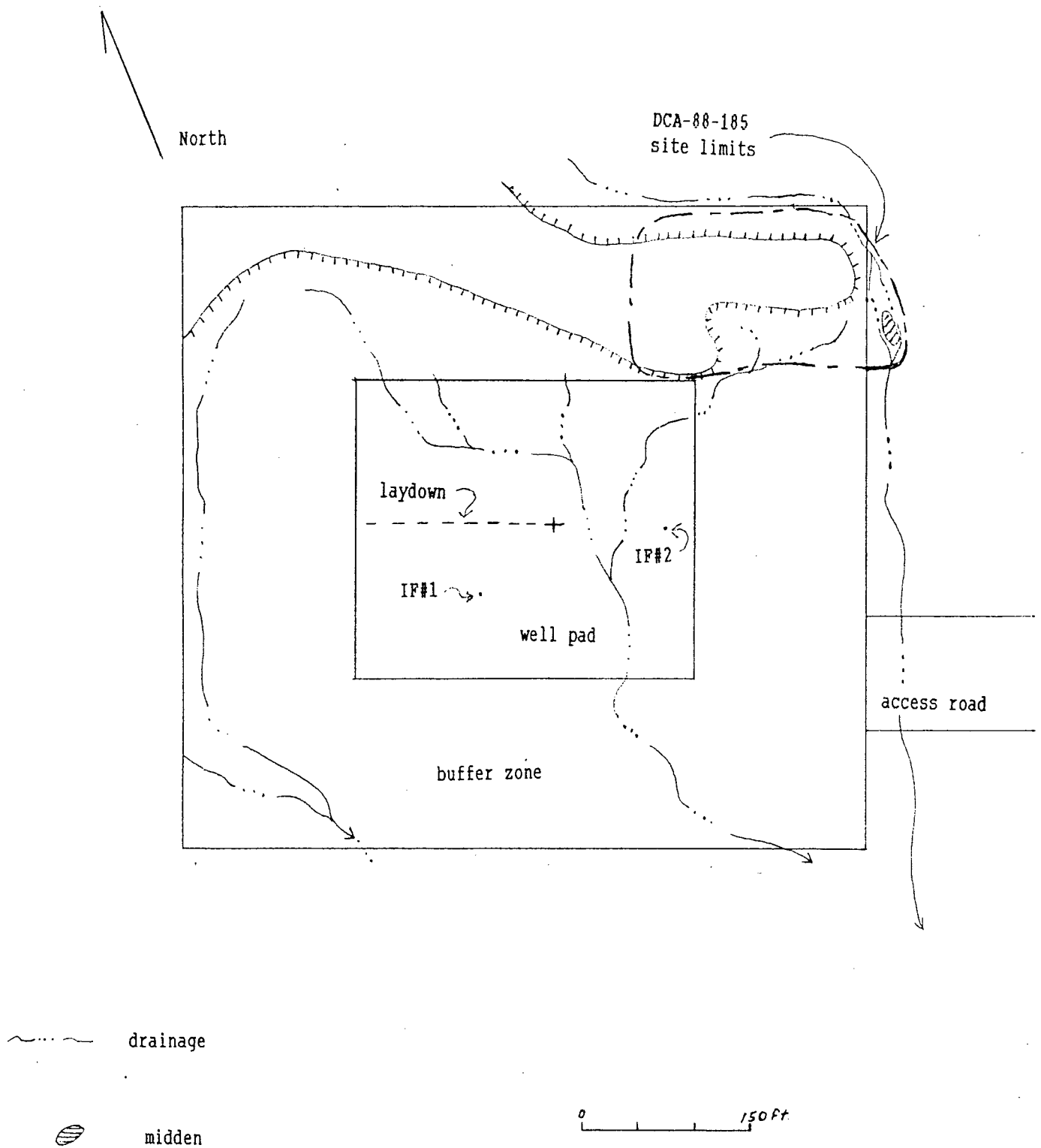

Figure 3. Crane 7-29 survey area map.

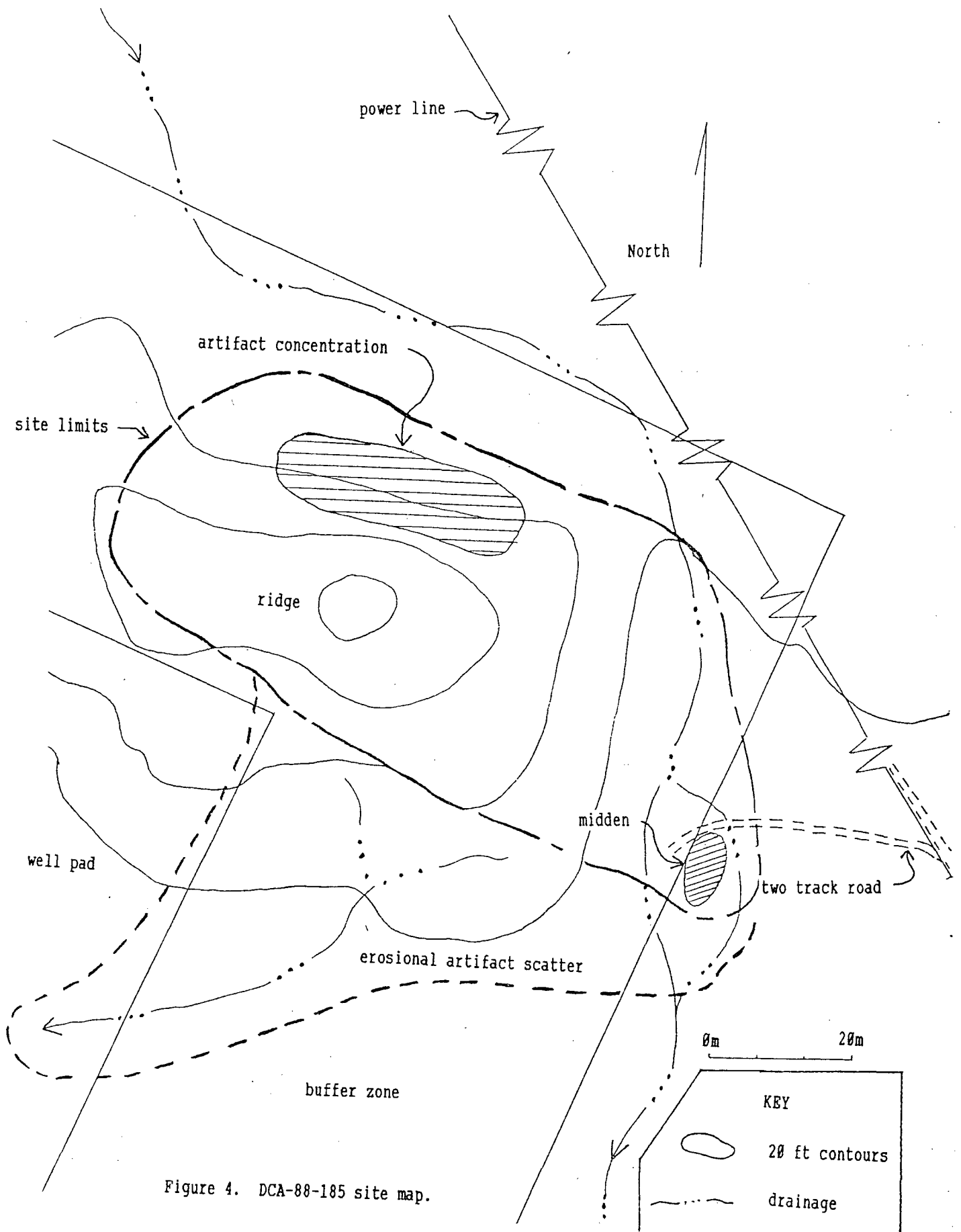

Figure 4. DCA-88-185 site map.

MOBIL EXPLORATION & PRODUCING U.S. INC.

P. O. Box 5444
Denver, Colorado 80217-5444

November 8, 1988

State of New Mexico
Energy and Minerals Department
Oil Conservation Division
310 Old Santa Fe Trail, Room 206
Santa Fe, New Mexico 87503
Attention: Michael E. Stogner

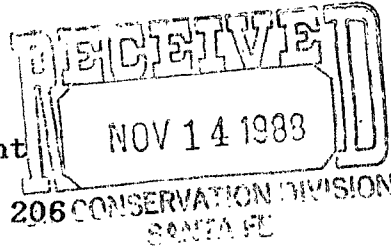

APPLICATION FOR EXCEPTION
UNORTHODOX LOCATION
HARRINGTON FEDERAL NO. 28-1
RIO ARriba COUNTY, NEW MEXICO

Gentlemen:

Enclosed please find the approved letter of notification of subject Application for Exception executed by BHP Petroleum (Americas) Inc., as furnished with the original application, the letter approval of A. G. Hill, Oil Producer and copies of the certified mail receipts of Charles B. Read, and J. Hiram Moore Trust. These are the offset operators of record along with Billie S. Werntz who acknowledged receipt of the letter by telephone but did not sign the approval and whose certified mail receipt has not been received.

Also enclose are the lease map of the area and copy of the C-102 designating the East half of Section 28 as the 320-acre Dakota *Basin* *Dakota* ~~proration unit permitting a second Dakota~~ well in the section with equal working interest in both wells and reservoirs. The entire section is to be dedicated to West Puerto Chiquito - Mancos production.

Sincerely,

B. R. Maynard
Regulatory Compliance Manager

WEL/enclosures
cc; Files 5B

MOBIL EXPLORATION & PRODUCING U.S. INC.

P. O. Box 5444
Denver, Colorado 80217-5444

October 12, 1988

CERTIFIED MAIL
RETURN RECEIPT REQUESTED

BHP Production Company Inc.
5613 DTC Parkway, Suite 600
Englewood, Colorado 80111
Attention: Donald Reinhaedt

APPLICATION FOR EXCEPTION
UNORTHODOX LOCATION
HARRINGTON FEDERAL NO. 28-1
RIO ARRIBA COUNTY, NEW MEXICO

Gentlemen:

Mobil Producing Texas & New Mexico, Inc. has requested administrative exception for the unorthodox location 2285' FNL and 2130' FEL of section 28, T24N, R1W, Rio Arriba County, New Mexico. This unorthodox location is required for the preservation of antiquities found in the proximity of any normal location for Gallup and Basin Dakota completion. The archeological survey is submitted herewith.

Indication of your approval of this exception is requested. Please return a signed approved copy of this letter to Mobil Exploration & Producing U. S. Inc. in the enclosed envelope.

If you have any questions regarding this request, please contact Bill Landry at (303) 298-2620.

Yours very truly,

*R L Brieabin for
B R Maynard*

B. R. Maynard
Regulatory Compliance Manager

WEL

APPROVED

J. C. McRay

TITLE: Operations Manager
COMPANY: BHP Petroleum (Americas) Inc.
DATE: 10/12/88

A. G. HILL
OIL PRODUCER
5000 THANKSGIVING TOWER
DALLAS, TEXAS 75201

October 19, 1988

Mobil Exploration & Producing U.S. Inc.
P.O. Box 5444
Denver, Colorado 80217-5444

Attn: Mr. Jeffrey Maisch

RE: APPLICATION FOR EXCEPTION
UNORTHODOX LOCATION
HARRINGTON FEDERAL NO. 28-1
RIO ARriba COUNTY, NEW MEXICO

Gentlemen:

The Estate of A. G. Hill has reviewed your letter of October 12, 1988 wherein you request our approval for the exception for the unorthodox location 2285' FNL and 2130' FEL of Section 28, T24N-R1W, Rio Arriba County, New Mexico.

The Estate of A. G. Hill is in agreement and approves your request for exception subject to Mobil and the Estate of A. G. Hill executing the formal agreement. We have incorporated your request in our formal agreement, (the first page of said agreement attached hereto). We are presently circulating the agreement for in-house approval and once it is signed by the Estate we will transmit for Mobil's execution.

Should there be any questions or the need for more assistance in your administrative exception, please advise.

Very truly yours,

Gregg Ewing

GE/cc

cc: Virgil St. Clair
Mike Nugent
Work file

PS Form 3811, July 1983 447-845

DOMESTIC RETURN RECEIPT

<p>SENDER: Complete items 1, 2, 3 and 4.</p> <p>Put your address in the "RETURN TO" space on the reverse side. Failure to do this will prevent this card from being returned to you. <u>The return receipt fee will provide you the name of the person delivered to and the date of delivery.</u> For additional fees the following services are available. Consult postmaster for fees and check box(es) for service(s) requested.</p>	
<p>1. <input type="checkbox"/> Show to whom, date and address of delivery.</p> <p>2. <input type="checkbox"/> Restricted Delivery.</p>	
<p>3. Article Addressed to:</p> <p>Charles B. Read P. O. Box 1518 Roswell, N. M. 88201</p>	
<p>4. Type of Service:</p> <p><input type="checkbox"/> Registered <input type="checkbox"/> Insured <input checked="" type="checkbox"/> Certified <input type="checkbox"/> COD <input type="checkbox"/> Express Mail</p>	<p>Article Number</p> <p>P-564-601-707</p>
<p>Always obtain signature of addressee or agent and DATE DELIVERED.</p>	
<p>5. Signature - Addressee</p> <p>X</p>	
<p>6. Signature - Agent</p> <p>X <i>[Signature]</i></p>	
<p>7. Date of Delivery</p> <p>10-17-88</p>	
<p>8. Addressee's Address (ONLY if requested and fee paid)</p>	

PS Form 3811, July 1983 447-845

DOMESTIC RETURN RECEIPT

<p>SENDER: Complete items 1, 2, 3 and 4.</p> <p>Put your address in the "RETURN TO" space on the reverse side. Failure to do this will prevent this card from being returned to you. <u>The return receipt fee will provide you the name of the person delivered to and the date of delivery.</u> For additional fees the following services are available. Consult postmaster for fees and check box(es) for service(s) requested.</p>	
<p>1. <input type="checkbox"/> Show to whom, date and address of delivery.</p> <p>2. <input type="checkbox"/> Restricted Delivery.</p>	
<p>3. Article Addressed to:</p> <p>U. Hiram Moore Trust Michael Harrison Moore P. O. Box 1733 Midland, TX 79701</p>	
<p>4. Type of Service:</p> <p><input type="checkbox"/> Registered <input type="checkbox"/> Insured <input checked="" type="checkbox"/> Certified <input type="checkbox"/> COD <input type="checkbox"/> Express Mail</p>	<p>Article Number</p> <p>P-564-601-706</p>
<p>Always obtain signature of addressee or agent and DATE DELIVERED.</p>	
<p>5. Signature - Addressee</p> <p>X</p>	
<p>6. Signature - Agent</p> <p>X <i>[Signature]</i></p>	
<p>7. Date of Delivery</p> <p>OCT 17 1988</p>	
<p>8. Addressee's Address (ONLY if requested and fee paid)</p>	

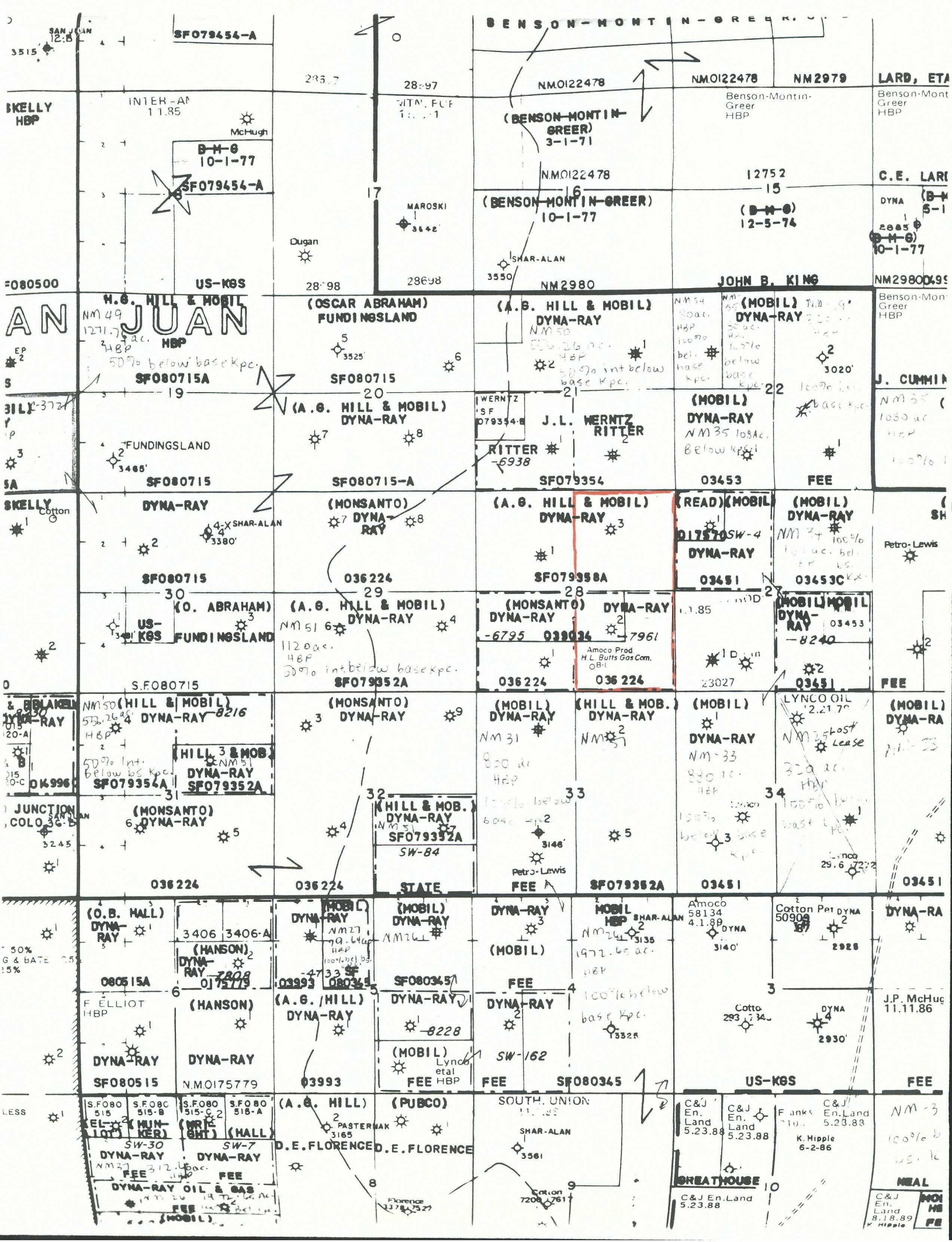

Form C-102
Supersedes C-128
Effective 1-1-65

Operator BHP PETROLEUM (AMERICAS) INC.		Lease SF 079352 A		Well No. Crane Fed. 7-28
Unit Letter G	Section 28	Township 24 N	Range 1 W	County RIO ARRIBA
Actual Footage Location of Well: 2285 feet from the North line and 2130 feet from the East line				
Ground Level Elev. 7380	Producing Formation Niobrara	Pool	Dedicated Acreage: 640 Acres	

- ☐ Yes ☒ No If answer is "yes," type of consolidation _____

No allowable will be assigned to the well until all interests have been consolidated (by communitization, unitization, forced-pooling, or otherwise) or until a non-standard unit, eliminating such interests, has been approved by the Commission.

S 89° 45' W 79.87 CH.

Lease SF 079852 A

Royalty Interest Owner - U.S.A. 100%

Working Interest Owners

A. G. Hill - 50%

Mobil Producing, Texas & N., Inc. - 50%

SEC.

28

Lease NM 039034

Royalty Interest Owner - U.S.A. 100%

Working Interest Owner

BHP Petroleum Company, Inc. 100%

28

Lease NM 036224

Royalty Interest Owner - U.S.A. 100%

Working Interest Owner

BHP Petroleum Company, Inc. 100%

CERTIFICATION

I hereby certify that the information contained herein is true and complete to the best of my knowledge and belief.

Chuck Williams
Chuck Williams

Name
Administrator, Field Services

Position
BHP Petroleum (Americas) Inc.

Company
August 31, 1988

Date

I hereby certify that the well location shown on this plat was plotted from field notes of actual surveys made by me or under my supervision, and that the same is true and correct to the best of my knowledge and belief.

Date Surveyed
Willard W. Mahnik

Registered Professional Engineer and/or Land Surveyor #8466

Certificate No. 8466

S 89° 48' W 79.95 CH.

8-31-88

COUNTY Rio Arriba POOL West Puerto Chiquito-Mancoes Oil
TOWNSHIP 24 North RANGE 1 West NMPM

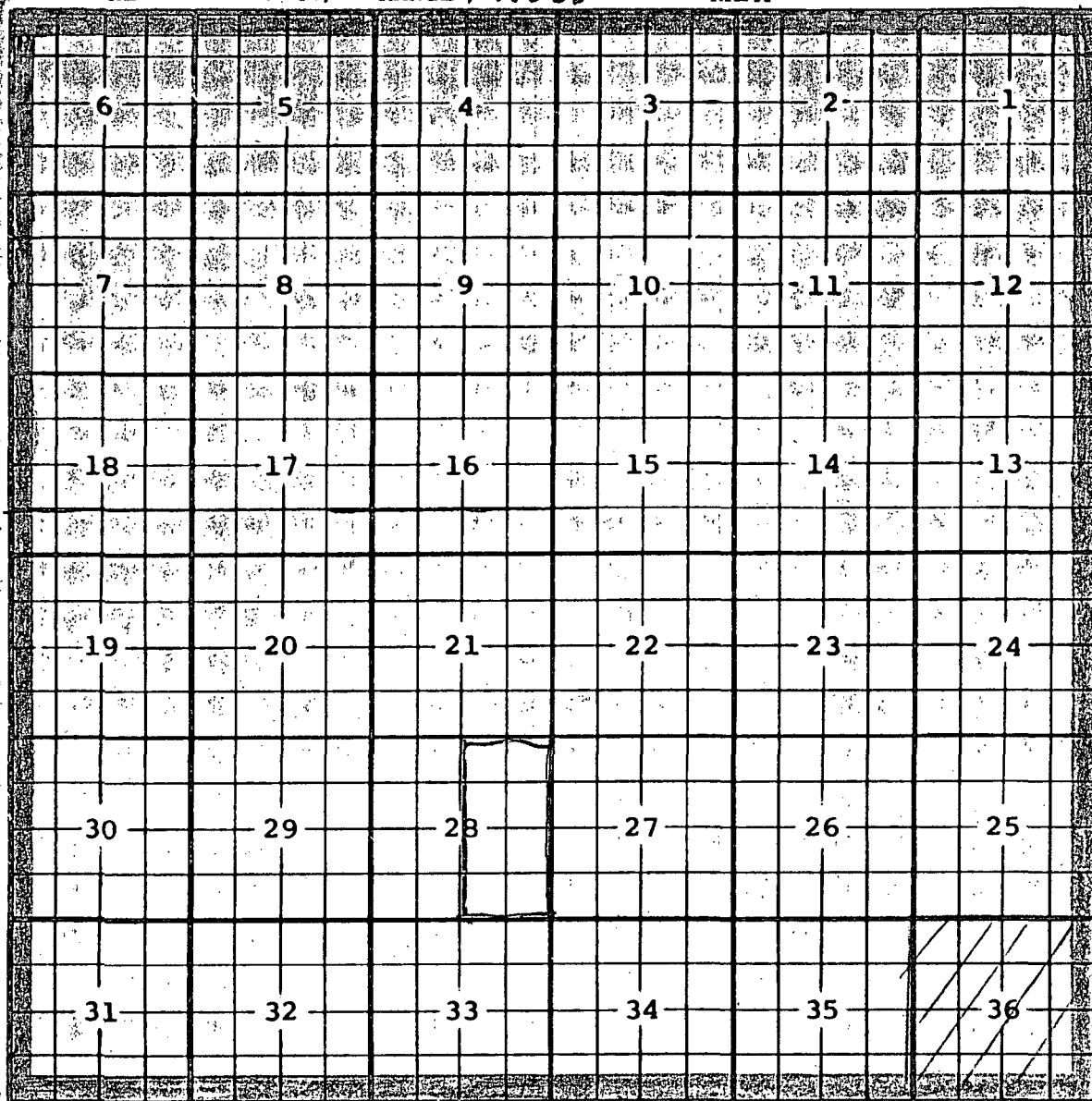

Ext: All Secs. 1 thru 36 (R-3994.7-15-70)

DELE SEC. 36 (R-6748, 8/1/81)



STATE OF NEW MEXICO
ENERGY AND MINERALS DEPARTMENT

OIL CONSERVATION DIVISION
AZTEC DISTRICT OFFICE

1000 RIO BRAZOS ROAD
AZTEC, NEW MEXICO 87410
(505) 334-6178

OIL CONSERVATION DIVISION
BOX 2088
SANTA FE, NEW MEXICO 87501

DATE 10-24-88

RE: Proposed MC _____
Proposed DIIC _____
Proposed NSL X _____
Proposed SWD _____
Proposed WFX _____
Proposed PMX _____

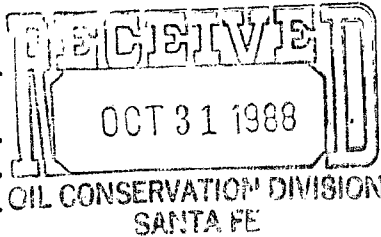

Gentlemen:

I have examined the application dated 10-17-88
for the MOBIL EXPLOR PROD US INC. HARRINGTON
Operator Lease and Well No. G-28-24N-1W Unit, S-T-R

and my recommendations are as follows:

APPROVE FOR THE BASIN DAKOTA- WIOBANA
EXCEPTION IS NOT NEEDED

Yours truly,

E. Bruch