

H. L. BROWN, JR.  
POST OFFICE BOX 2237  
MIDLAND, TEXAS 79702-2237

January 26, 1989

State of New Mexico  
Oil Conservation Division  
P. O. Box 2088  
Santa Fe, New Mexico 87501

Attention: Division Director

RE: H. L. Brown, Jr.  
Application for Permit to Drill a Non-Standard Location  
State Com "8" No. 1  
1550' FSL, 660' FWL, Sec. 8, T-21S, R-27E  
Eddy County, New Mexico

Gentlemen:

H. L. Brown, Jr. respectively requests administrative approval for the State Com "8" No. 1 to be drilled on a "non-standard" location at 1550' FSL, 660' FWL, Section 8, T-21S, R-27E Eddy County, New Mexico, this lease being situated on U. S. Government surface and State of New Mexico minerals.

The proposed drillsite is a non-standard location as described by NMOCD Rule 104 (c) (II) (a) because of the necessity to move 250' south of our preferred location due to an archeological sighting. The attached ownership map and Form C-102 indicate the location of the proposed well in relation to lease lines and offset operators. The proposed location will not infringe upon the correlative rights of any offsetting property since the well is still 660' from the nearest "lease" line and greater than 1320' from the closest completed well in this pool.

We have informed each offset operator of this application in writing and have requested that executed waivers be mailed directly to your office. Since this location is not unorthodox with respect to lease boundaries, we do not anticipate any objections to the drilling and completion of this well by any

State of New Mexico  
January 26, 1989  
Page Two

offset operators. Therefore, we request administrative approval to drill and complete this well at this non-standard location. Due to obligations contained in our lease agreements we must commence drilling before February 4, 1989. We, therefore, respectfully request you expeditious approval of this application.

Sincerely,

H. L. BROWN, JR.

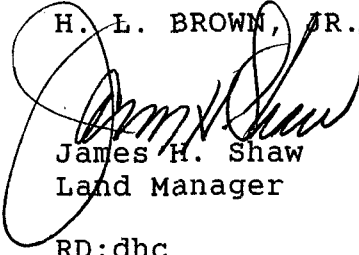

James H. Shaw  
Land Manager

RD:dhc  
Enclosures

**NEW MEXICO OIL CONSERVATION COMMISSION  
WELL LOCATION AND ACREAGE DEDICATION PLAT**

Form C-102  
Supersedes C-128  
Effective 1-1-65

All distances must be from the outer boundaries of the Section.

Operator <b>H.L. BROWN, JR.</b>			Lease <b>STATE COM 8</b>		Well No. <b>1</b>
Unit Letter <b>L</b>	Section <b>8</b>	Township <b>21-SOUTH</b>	Range <b>27-EAST</b>	County <b>EDDY</b>	
Actual Footage Location of Well: <b>1600 1560</b> feet from the <b>SOUTH</b> line and <b>660</b> feet from the <b>WEST</b> line					
Ground Level Elev. <b>3225.4'</b>	Producing Formation <b>Cherry Canyon</b>		Pool	Dedicated Acreage: <b>160</b> Acres	

1. Outline the acreage dedicated to the subject well by colored pencil or hachure marks on the plat below.
2. If more than one lease is dedicated to the well, outline each and identify the ownership thereof (both as to working interest and royalty). Royalty is the State of New Mexico
3. If more than one lease of different ownership is dedicated to the well, have the interests of all owners been consolidated by communitization, unitization, force-pooling, etc?

☒ Yes    ☐ No    If answer is "yes," type of consolidation Communitization

If answer is "no," list the owners and tract descriptions which have actually been consolidated. (Use reverse side of this form if necessary.) \_\_\_\_\_

No allowable will be assigned to the well until all interests have been consolidated (by communitization, unitization, forced-pooling, or otherwise) or until a non-standard unit, eliminating such interests, has been approved by the Commission.

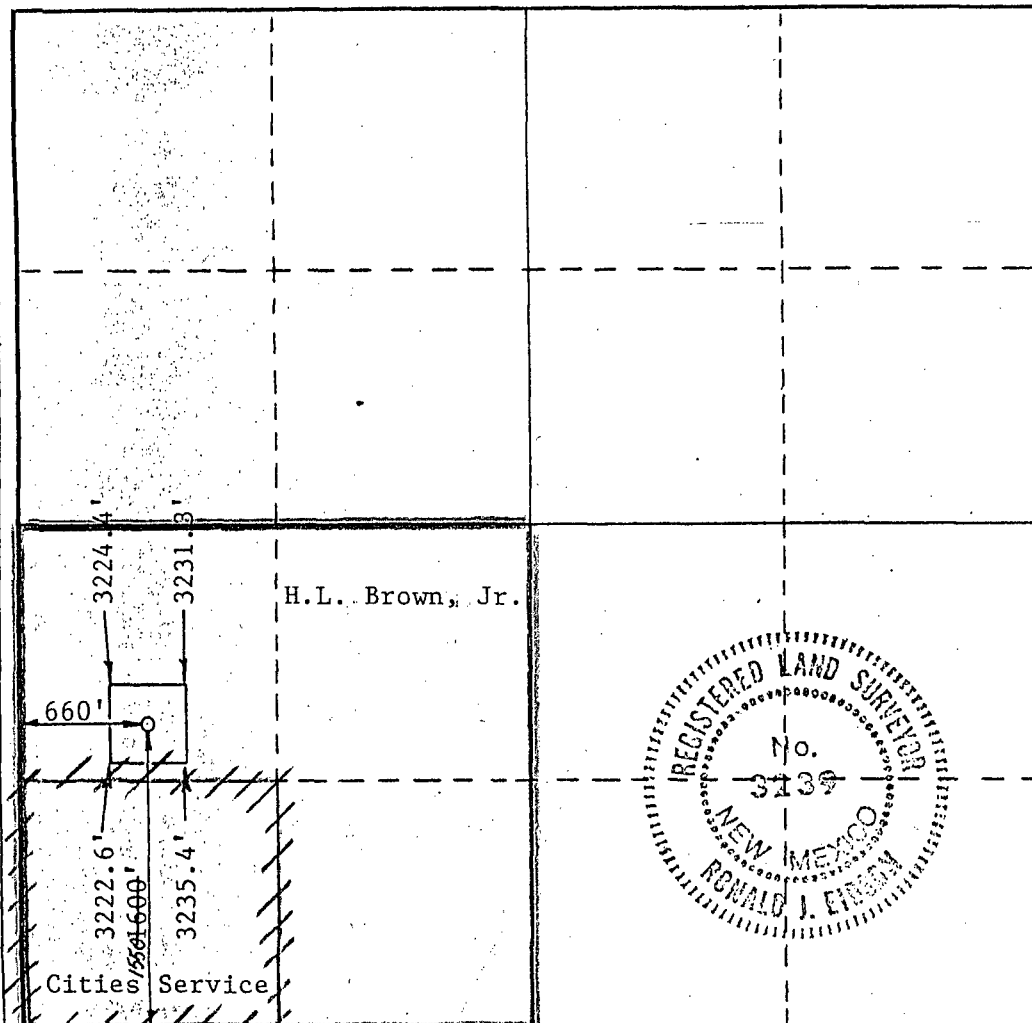

**CERTIFICATION**

I hereby certify that the information contained herein is true and complete to the best of my knowledge and belief.

*Ron Divine*

Name <b>Ron Divine</b>
Position <b>Production Engineer</b>
Company <b>H. L. Brown, Jr.</b>
Date <b>January 10, 1989</b>

I hereby certify that the well location shown on this plat was plotted from field notes of actual surveys made by me or under my supervision, and that the same is true and correct to the best of my knowledge and belief.

Date Surveyed <b>1-7-89</b>
Registered Professional Engineer and/or Land Surveyor

*Ronald J. Eidson*

Certificate No. <b>JOHN W. WEST, 676</b>
<b>RONALD J. EIDSON, 3239</b>



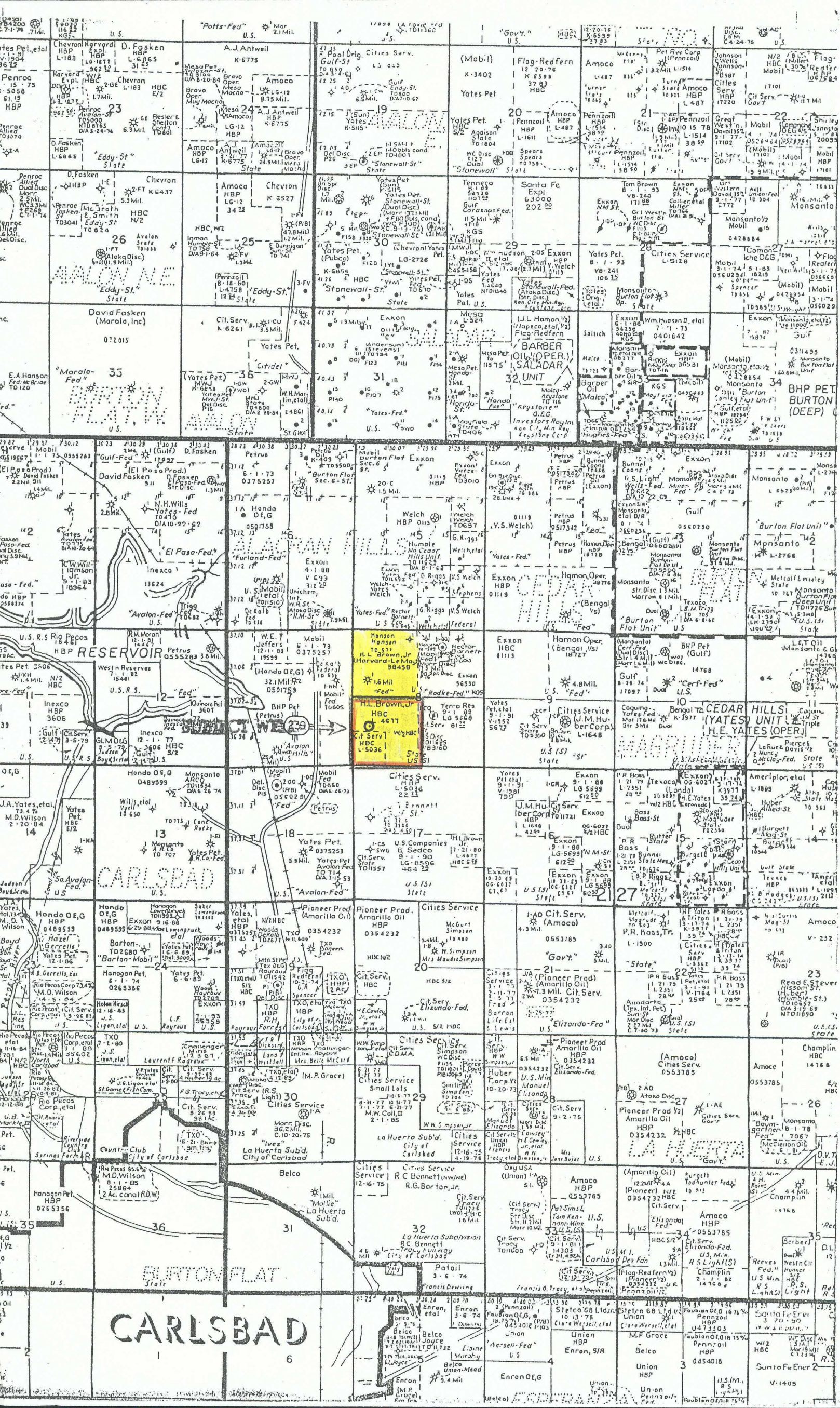



H. L. BROWN, JR.  
POST OFFICE BOX 2237  
MIDLAND, TEXAS 79702-2237

January 25, 1989

TO: All Offset Operators

RE: H. L. Brown, Jr.  
Application for Permit to Drill  
A Non-Standard Location  
State Com "8" No. 1  
1550' FSL, 660' FWL, Section 8, T-21S, R-27E  
Eddy County, New Mexico

Gentlemen:

H. L. Brown, Jr. plans to drill the captioned well at a location 1550' FSL, 660' FWL of Section 8, T-21S, R-27E of Eddy County, New Mexico. This location was moved 250' south due to BLM requirements because of an archeological sighting. At our preferred site this new location is a non-standard location as described by NMOCD Rule 104 (c) (II) (a) which state "...a well can be no closer than 330' to any quarter-quarter section or subdivision inner boundary...". Our location is 230' from the quarter-quarter section and thus is designated a non-standard location, requiring approval by the State of New Mexico Oil Conservation Division. You will note that the location is still 660' from the nearest lease line.

H. L. Brown, Jr. respectfully requests your assistance in obtaining the necessary administrative approval and permit to drill and complete the above named well by signing the enclosed "waiver of objection" and mailing directly to the Oil Conservation Division Office in Santa Fe, New Mexico.

Your expeditious attention to this matter will be greatly appreciated.

Sincerely,

H. L. BROWN, JR.

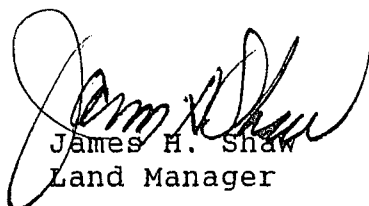

James H. Shaw  
Land Manager

RD:dhc

January 25, 1989

State of New Mexico  
Oil Conservation Division  
Box 2088  
Santa Fe, New Mexico 87501

RE: H. L. Brown, Jr.  
State Com "8" No. 1  
Application for Permit to Drill  
A Non-Standard Location  
1550' FSL, 660' FWL, Sec. 8, T-21S, R-27E  
Eddy County, New Mexico

Gentlemen:

The undersigned has been advised of the application by H. L. Brown, Jr. for administrative approval for the captioned well. All pertinent information has been received and we hereby advise that we have no objections to this location. We hereby waive objection and notice of hearing in this matter.

Sincerely,

BY: \_\_\_\_\_

OPERATOR: \_\_\_\_\_

RD:dhc

DISTRIBUTION:

1/25/89

Exxon  
P. O. Box 1600  
Midland, Texas 79702

✓ BHP Petroleum, Inc.  
6 Desta Drive, Suite 3200  
Midland, Texas 79705

Hondo Oil & Gas Company  
P. O. Box 2208  
Roswell, New Mexico 88202

J Mobil Exploration & Production US, Inc.  
P. O. Box 633  
Midland, Texas 79702  
Attn: Mr. Glen Cox

✓ Oxy USA, Inc.  
110 West 7th Street  
P. O. Box 300  
Tulsa, Oklahoma 74119

J Yates Petroleum  
105 S. 4th Street  
Artesia, New Mexico 88210

COUNTY

Eddy

POOL

Carlshad-Delaware

TOWNSHIP

21 South

RANGE

27 East

NMPM

6	5	4	3	2	1
7	8	9	10	11	12
18	17	16	15	14	13
19	20	21	22	23	24
30	29	28	27	26	25
31	32	33	34	35	36

Ext: All Sec. 18,  $N/2$  Sec. 19 (A-7668, 9-21-84)



January 25, 1989

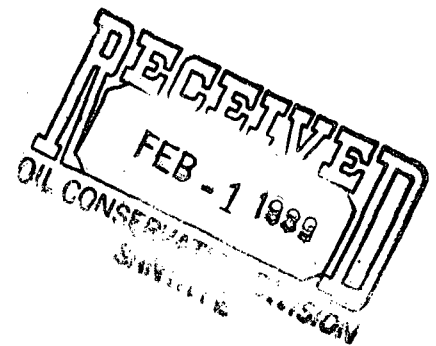

State of New Mexico  
Oil Conservation Division  
Box 2088  
Santa Fe, New Mexico 87501

RE: H. L. Brown, Jr.  
State Com "8" No. 1  
Application for Permit to Drill  
A Non-Standard Location  
1550' FSL, 660' FWL, Sec. 8, T-21S, R-27E  
Eddy County, New Mexico

Gentlemen:

The undersigned has been advised of the application by H. L. Brown, Jr. for administrative approval for the captioned well. All pertinent information has been received and we hereby advise that we have no objections to this location. We hereby waive objection and notice of hearing in this matter.

Sincerely,  
BHP PETROLEUM COMPANY INC.



BY: Senior Landman

\_\_\_\_\_  
OPERATOR:

RD:dhc

January 25, 1989

State of New Mexico  
Oil Conservation Division  
Box 2088  
Santa Fe, New Mexico 87501

RE: H. L. Brown, Jr.  
State Com "8" No. 1  
Application for Permit to Drill  
A Non-Standard Location  
1550' FSL, 660' FWL, Sec. 8, T-21S, R-27E  
Eddy County, New Mexico

Gentlemen:

The undersigned has been advised of the application by H. L. Brown, Jr. for administrative approval for the captioned well. All pertinent information has been received and we hereby advise that we have no objections to this location. We hereby waive objection and notice of hearing in this matter.

Sincerely,

  
BY: Conrad Joseph  
Exploitation Manager

OXY USA Inc.

OPERATOR:

RD:dhc

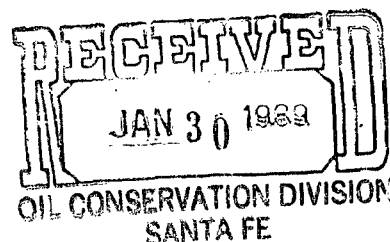

January 25, 1989

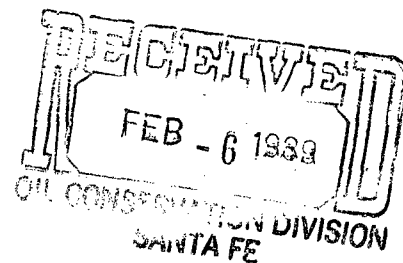

State of New Mexico  
Oil Conservation Division  
Box 2088  
Santa Fe, New Mexico 87501

RE: H. L. Brown, Jr.  
State Com "8" No. 1  
Application for Permit to Drill  
A Non-Standard Location  
1550' FSL, 660' FWL, Sec. 8, T-21S, R-27E  
Eddy County, New Mexico

Gentlemen:

The undersigned has been advised of the application by H. L. Brown, Jr. for administrative approval for the captioned well. All pertinent information has been received and we hereby advise that we have no objections to this location. We hereby waive objection and notice of hearing in this matter.

Sincerely,

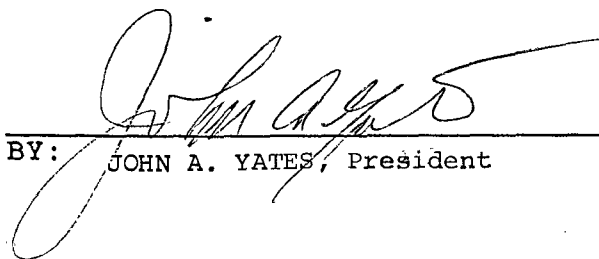
  
BY: JOHN A. YATES, President (Kc)

YATES PETROLEUM CORPORATION  
OPERATOR:

RD:dhc

January 25, 1989

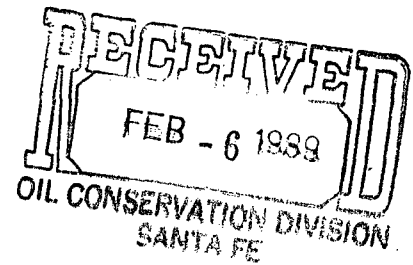

State of New Mexico  
Oil Conservation Division  
Box 2088  
Santa Fe, New Mexico 87501

RE: H. L. Brown, Jr.  
State Com "8" No. 1  
Application for Permit to Drill  
A Non-Standard Location  
1550' FSL, 660' FWL, Sec. 8, T-21S, R-27E  
Eddy County, New Mexico

Gentlemen:

The undersigned has been advised of the application by H. L. Brown, Jr. for administrative approval for the captioned well. All pertinent information has been received and we hereby advise that we have no objections to this location. We hereby waive objection and notice of hearing in this matter.

Sincerely,

  
BY: John T. MacKenzie  
Environmental Compliance Manager  
2/2/89

OPERATOR: Mobil Exploration & Producing U.S. Inc.  
as Agent for  
Mobil Producing Texas & New Mexico Inc.

RD:dhc