



T. D. Autry
Division Production Manager

Amoco Production Company

Southern Division
1670 Broadway
P.O. Box 800
Denver, Colorado 80201
303-830-4040

July 17, 1989

New Mexico Oil Conservation Division
310 Old Santa Fe Trail Road
P.O. Box 2088
Santa Fe, New Mexico 87504

Attention: Mr. William LeMay

Waiver of Objection for Unorthodox Location
San Juan 28-6 Unit #406
SW/4 Section 19-T28N-R6W
Rio Arriba County, New Mexico

This is in response to Meridian's request for Waiver of Objection for an unorthodox well location in the Basin Fruitland Coal Pool.

Enclosed is a copy of Meridian's waiver request, approved by Amoco Production Company, successor in interest to Tenneco Oil Company, for the subject well.

T. D. Autry KSD

89006.JLS/cs

Enclosure

cc: Meridian Oil Inc.
Bill Hawkins - Building

RECEIVED
JUL 21 1989
OIL CONSERVATION DIV.
SANTA FE

MERIDIAN OIL

June 6, 1989

RECEIVED

JUN - 8 1989

OIL CONSERVATION DIV.
SANTA FE

Mr. William LeMay
New Mexico Oil Conservation Division
Post Office Box 2088
Santa Fe, New Mexico 87504

Dear Mr. LeMay:

This is a request for administrative approval for an unorthodox gas well location in the Basin Fruitland Coal Pool.

It is intended to locate the El Paso Natural Gas Company San Juan 28-6 Unit #406 at 680' from the South line and 1140' from the West line of Section 19, T-28-N, R-6-W, Rio Arriba County, New Mexico.

This non-standard location is necessary because of archaeology and terrain.

A copy of this application is being submitted to all offset operators by certified mail with a request that they furnish your Santa Fe office with a Waiver of Objection, and return one copy to this office.

Plats showing the proposed well location and the terrain in Section 19, along with an ownership plat, are attached.

Sincerely yours,

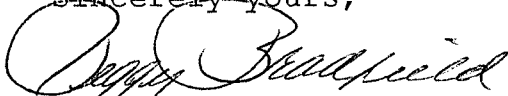

Peggy Bradfield

encl.

WAIVER

Amoco Production hereby waives objection to El Paso Natural Gas application for an unorthodox location for their San Juan 28-6 Unit #406 as proposed above.

By: _____ Date: _____

xc: Amoco Production

326-9727

MERIDIAN OIL

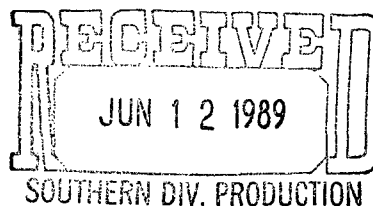

June 6, 1989

Mr. William LeMay
New Mexico Oil Conservation Division
Post Office Box 2088
Santa Fe, New Mexico 87504

Dear Mr. LeMay:

This is a request for administrative approval for an unorthodox gas well location in the Basin Fruitland Coal Pool.

It is intended to locate the El Paso Natural Gas Company San Juan 28-6 Unit #406 at 680' from the South line and 1140' from the West line of Section 19, T-28-N, R-6-W, Rio Arriba County, New Mexico.

This non-standard location is necessary because of archaeology and terrain.

A copy of this application is being submitted to all offset operators by certified mail with a request that they furnish your Santa Fe office with a Waiver of Objection, and return one copy to this office.

Plats showing the proposed well location and the terrain in Section 19, along with an ownership plat, are attached.

Sincerely yours,

A handwritten signature in cursive script, appearing to read "Peggy Bradfield".

Peggy Bradfield

encl.

WAIVER

Amoco Production hereby waives objection to El Paso Natural Gas application for an unorthodox location for their San Juan 28-6 Unit #406 as proposed above.

By: Dr. S. Durr

Date: 7/17/89

xc: Amoco Production

All distances must be from the outer boundaries of the Section.

Operator El Paso Natural Gas			Lease San Juan 28-6 Unit(SF-080430H)		Well No. 406
Unit Letter N	Section 19	Township 28 North	Range 6 West	County Rio Arriba	
Actual Footage Location of Wells: 680 feet from the South line and 1140 feet from the West line					
Ground Level Elev. 6595'	Producing Formation Fruitland Coal		Pool Basin		Dedicated Acreage:

1. Outline the acreage dedicated to the subject well by colored pencil or hachure marks on the plat below.
2. If more than one lease is dedicated to the well, outline each and identify the ownership thereof (both as to work interest and royalty).
3. If more than one lease of different ownership is dedicated to the well, have the interests of all owners been consolidated by communitization, unitization, force-pooling, etc?

☒ Yes ☐ No If answer is "yes," type of consolidation unitization

If answer is "no," list the owners and tract descriptions which have actually been consolidated. (Use reverse side of this form if necessary.)

No allowable will be assigned to the well until all interests have been consolidated (by communitization, unitization, forced-pooling, or otherwise) or until a non-standard unit, eliminating such interests, has been approved by the Division.

* Non-standard due to archaeology and terrain.

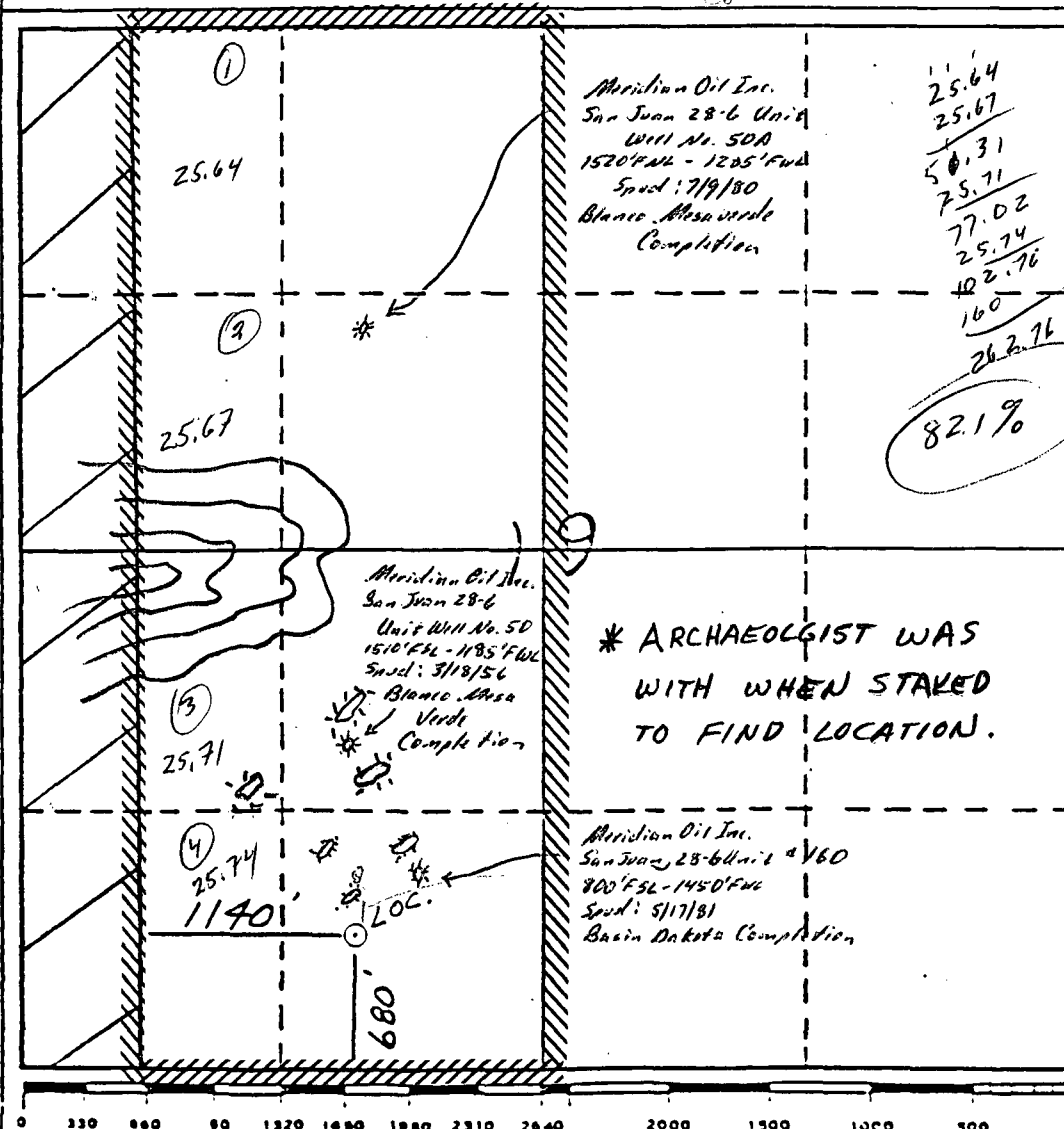

CERTIFICATION

I hereby certify that the information contained herein is true and complete to the best of my knowledge and belief.

Name
Regulatory Affairs
Position
El Paso Natural Gas
Company
Date

I hereby certify that the well location shown on this plat was plotted from notes of actual surveys made by me under my supervision, and that the same is true and correct to the best of my knowledge and belief.

Date Surveyed
11-10-88
Registered Professional Engineer and/or Land Surveyor

Neale C. Edward

Certificate No. 6857

EL PASO NATURAL GAS COMPANY

Well Name San Juan 28-6 Unit #406, Basin Fruitland

Footage----- 680' FSL, 1140' FWL

APPLICATION FOR NON-STANDARD LOCATION

County Rio Arriba State New Mexico Section 19 Township 28N Range 6W

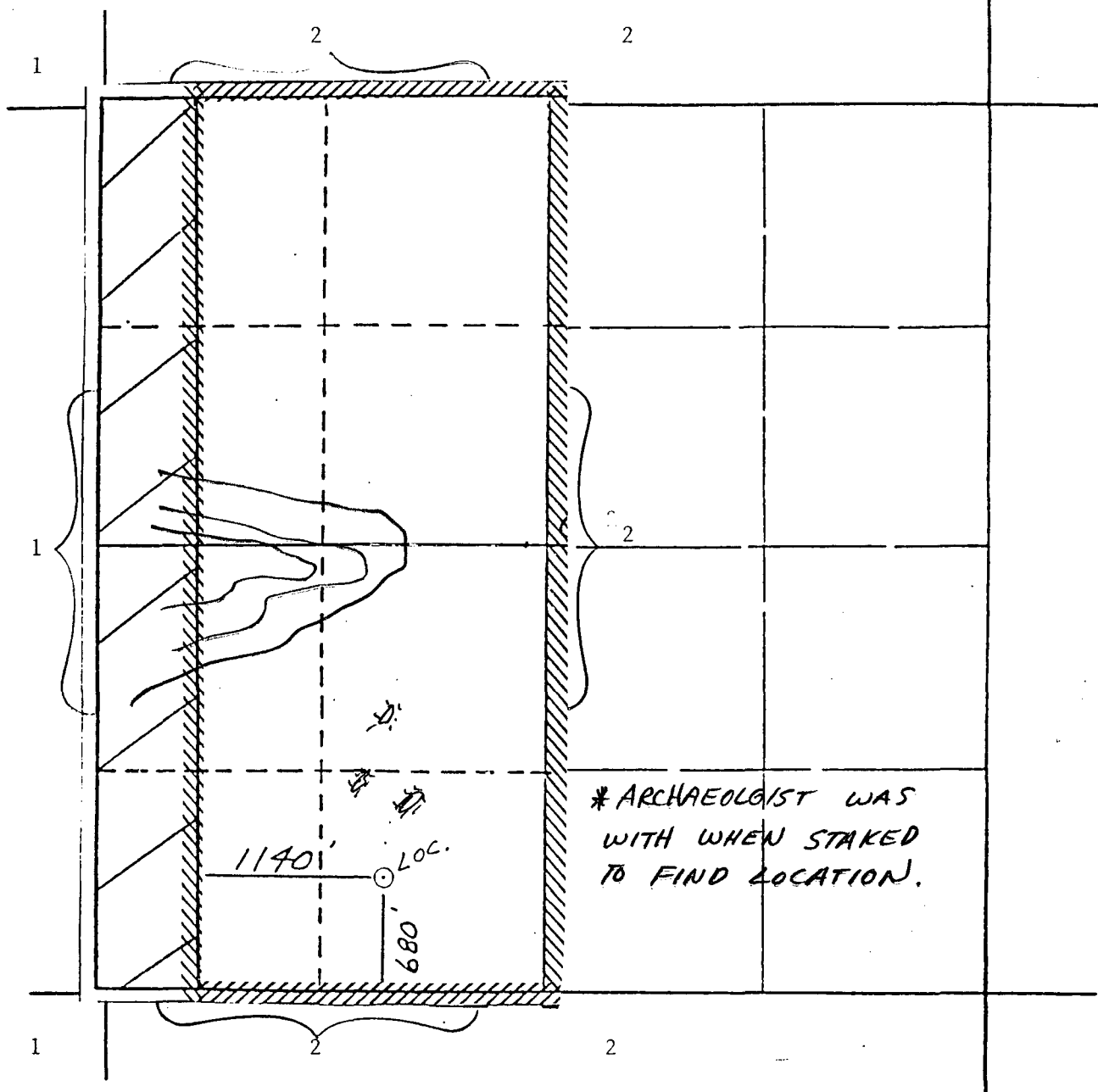

REMARKS:

- (1) Amoco Production Company, as Interim Successor Operator of San Juan 28-7 Unit
- (2) El Paso Natural Gas Company, San Juan 28-6 Unit

CO

SAN JUAN 28-6

RIO ARRIBA COUNTY
NEW MEXICO

No. 14-08-001-1051 EFFECTIVE 8-31-53

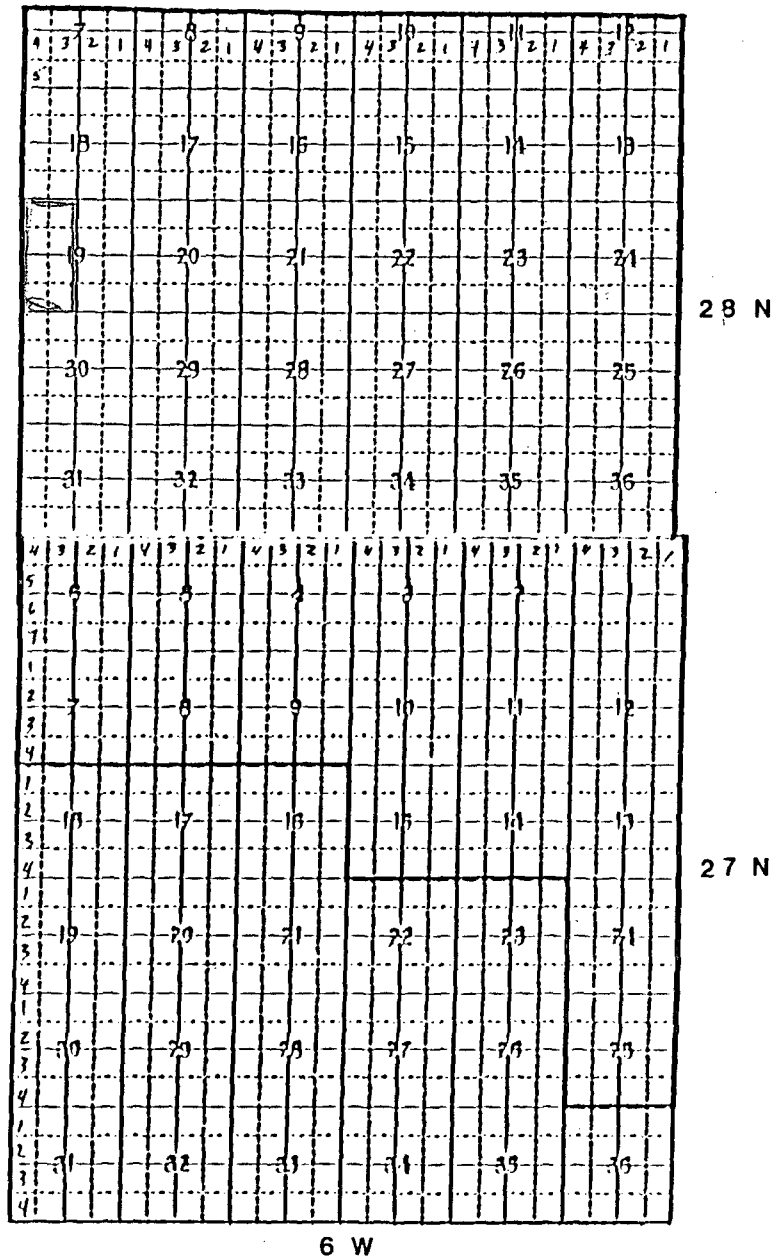

gulram, inc.

petroleum engineering and government regulation consultants

1-1-87

INTENTIONAL OMISSIONS

The following document(s) have been intentionally omitted from this file due to the indicated reasons.

FILE # NSL 2678

DESCRIPTION OF OMITTED DOCUMENTS

OMITTED DOCUMENT

REASON OMITTED

Telecopier copy - 11 pages

TOO Light to copy

To Mike Stagner from Peggy dated 7-14-89. Letter +
"Archaeological Survey of Two Proposed Well Pads San Juan 28-6
Unit No. 405 and Access Road and San Juan 28-6 Unit No. 406
Near Delgadita Mesa, Rio Arriba County, NM"