

NSL 4/16/97

BURLINGTON RESOURCES

SAN JUAN DIVISION

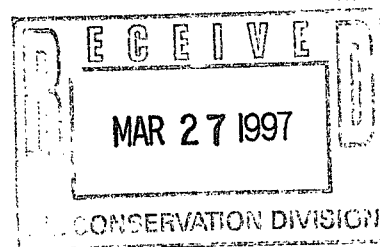

March 25, 1997

Federal Express

Mr. Michael Stogner
New Mexico Oil Conservation Division
2040 South Pacheco Street
Santa Fe, New Mexico 87505

Re: Payne #3E
2155' FNL, 355' FEL, Section 20, T-32-N, R-10-W, San Juan County, NM
API #30-045-27543
NSL-2532

Dear Mr. Stogner:

This is a request for administrative approval for a non-standard gas well location in the Blanco Mesa Verde pool.

Burlington Resources Oil & Gas Company is planning to recomplete the Payne #3E in the Blanco Mesa Verde and plug and abandon the Dakota. Administrative Order NSL-2532 was issued June 21, 1988 for the Dakota. To comply with the New Mexico Oil Conservation Division rules, Burlington is submitting the following for your approval of this non-standard location:

1. C-102 plat showing location of the well;
2. Plat showing offset owners/operators;
3. Copy of Well Completion Log for original completion;
4. Affidavit of notification of offset owners/operators.

A copy of this application is being submitted to all offset owners/operators by certified mail with a request that they furnish your Santa Fe office with a Waiver of Objection, and return one copy to this office.

Sincerely yours,

A handwritten signature in cursive script, appearing to read "Peggy Bradfield".

Peggy Bradfield
Regulatory/Compliance Administrator

WAIVER

_____ hereby waives objection to Burlington Resource's application for non-standard location for the Payne #3E as proposed above.

By: _____ Date: _____

xc: Amoco Production
Conoco Inc.

District I
PO Box 1980, Hobbs, NM 88241-1980
District II
PO Drawer DD, Artesia, NM 88211-0719
District III
1000 Rio Brazos Rd., Aztec, NM 87410
District IV
PO Box 2088, Santa Fe, NM 87504-2088

State of New Mexico
Energy, Minerals & Natural Resources Department

OIL CONSERVATION DIVISION

PO Box 2088
Santa Fe, NM 87504-2088 PM 3:01

Form C
Revised February 21,
Instructions on
Submit to Appropriate District C
State Lease - 4 C
Fee Lease - 3 C

☐ AMENDED REF

WELL LOCATION AND ACREAGE DEDICATION PLAT

API Number	Pool Code	Pool Name
30-045-27543	72319/71599	Blanco Mesaverde/Basin Dakota
Property Code	Property Name	Well Number
7379	Payne	3E
OCRID No.	Operator Name	Elevation
14538	BURLINGTON RESOURCES OIL & GAS COMPANY	6328'

10 Surface Location

UL or lot no.	Section	Township	Range	Lot Idn	Feet from the	North/South line	Feet from the	East/West line	County
H	20	32-N	10-W		2155	North	355	East	S.J.

11 Bottom Hole Location If Different From Surface

UL or lot no.	Section	Township	Range	Lot Idn	Feet from the	North/South line	Feet from the	East/West line	County

12 Dedicated Acreage 13 Joint or Infill 14 Consolidation Code 15 Order No.
MV-N/316.85
DK-N/316.85

NO ALLOWABLE WILL BE ASSIGNED TO THIS COMPLETION UNTIL ALL INTERESTS HAVE BEEN CONSOLIDATED
OR A NON-STANDARD UNIT HAS BEEN APPROVED BY THE DIVISION

Not resurveyed, prepared from a plat by Cecil B. Tullis dated 5-31-89.	2155'	355'	20	17 OPERATOR CERTIFICATE
				I hereby certify that the information contained here true and complete to the best of my knowledge and
				Signature Peggy Bradfield Printed Name Regulatory Administrator Title 3-6-97 Date
				18 SURVEYOR CERTIFICATE
				I hereby certify that the well location shown on this was plotted from field notes of actual surveys made or under my supervision, and that the same is true correct to the best of my belief.
				3/03/97 Date of Survey Signature and Seal of Professional Surveyor NEALE C. EDWARDS NEW MEXICO 6857 Certificate Number

BURLINGTON RESOURCES OIL AND GAS COMPANY

**Payne #3E
OFFSET OPERATOR \ OWNER PLAT
Nonstandard Location
Mesaverde Formation Well**

Township 32 North, Range 10 West

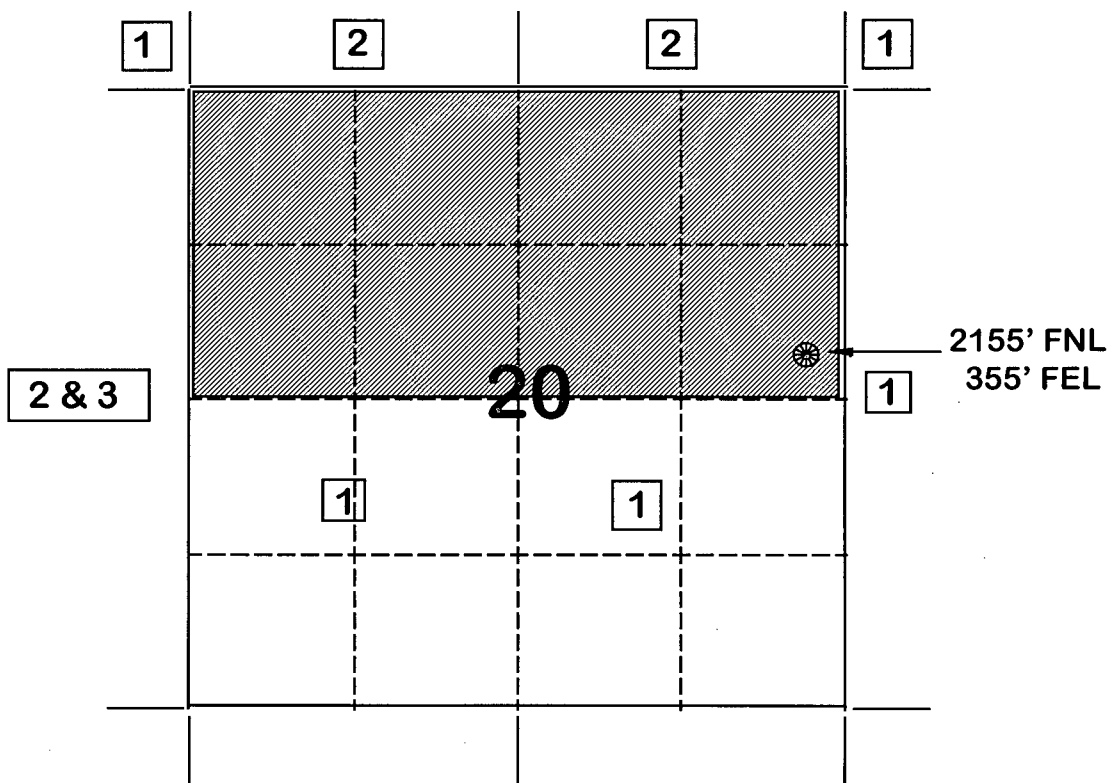

- 1) Burlington Resources Oil and Gas Company
- 2) Amoco Production Company
Attn: Bruce Zimney
P.O. Box 800
Denver, CO 80201
- 3) Conoco Inc.
10 Desta Drive, Suite 100W
Midland, TX 79705

983)
930)UNITED STATES
DEPARTMENT OF THE INTERIOR
BUREAU OF LAND MANAGEMENT

SUBMIT IN DUPLICATE

(See instructions on
reverse side)Form approved.
Budget Bureau No. 1004-0137
Expires August 31, 1985

WELL COMPLETION OR RECOMPLETION REPORT AND LOG *

1. TYPE OF WELL: OIL WELL <input type="checkbox"/> GAS WELL <input checked="" type="checkbox"/> DRY <input type="checkbox"/> Other _____		2. NAME OF OPERATOR <u>Union Texas Petroleum Corp.</u>	
3. TYPE OF COMPLETION: NEW WELL <input checked="" type="checkbox"/> WORK OVER <input type="checkbox"/> DEEP-EN <input type="checkbox"/> PLUG BACK <input type="checkbox"/> DIFF. REMVR. <input type="checkbox"/> Other _____		4. ADDRESS OF OPERATOR <u>P.O. Box 2120 Houston, TX 77252-2120</u>	
5. LOCATION OF WELL (Report location clearly and in accordance with any State requirements)* At surface <u>2155 FNL, 355 FEL</u> At top prod. interval reported below _____ At total depth _____		6. PERMIT NO. <u>30-045-27543</u> DATE ISSUED <u>11-20-89</u>	
7. DATE SPUDDED <u>12-21-89</u>		8. DATE T.D. REACHED <u>12-12-90</u>	
9. DATE COMPL. (Ready to prod.) <u>4-3-90</u>		10. ELEVATIONS (DP, RKB, RT, GR, ETC.)* <u>6328 GR</u>	
11. TOTAL DEPTH, MD & TVD <u>7900 TVD & MD</u>		12. PLUG, BACK T.D., MD & TVD <u>7858 TVD & MD</u>	
13. IF MULTIPLE COMPL. HOW MANY* _____		14. INTERVALS DRILLED BY <u>X</u>	
15. PRODUCING INTERVAL(S). OF THIS COMPLETION—TOP, BOTTOM, NAME (MD AND TVD)* <u>7644-7794; 7695-7787</u>		16. WAS DIRECTIONAL SURVEY MADE <u>No</u>	
17. TYPE ELECTRIC AND OTHER LOGS RUN <u>DIL; GR-CAL</u>		18. WAS WELL CORED <u>No</u>	
19. CASING RECORD (Report all strings set in well)			
CASINO SIZE		WEIGHT, LB./FT.	
10 3/4		40.5	
7 5/8		26.4	
DEPTH SET (MD)		HOLE SIZE	
670		14 1/2	
3599		9 7/8	
CEMENTING RECORD		AMOUNT PULLED	
565		None	
605		"	
20. LINER RECORD			
SIZE		TOP (MD)	
5 1/2		3353	
BOTTOM (MD)		BACKS CEMENT*	
7893		425	
SCREEN (MD)		TUBING RECORD	
		SIZE	
		2 3/8	
		DEPTH SET (MD)	
		7781	
		PACKER SET (MD)	
		7770	
21. PERFORATION RECORD (Interval, size and number)			
1JSPF 0.32"-23		7644-7794	
" " -06		7695-7787	
22. ACID, SHOT, FRACTURE, CEMENT SQUEEZE, ETC.			
DEPTH INTERVAL (MD)		AMOUNT AND KIND OF MATERIAL USED	
7644-7794		Acid 1750 gal 15% HCL	
" "		Frac 69,887 Gal 1% X-L Gel	
7695-7787		Acid 1000 gal 15% HCL	
" "		Frac 87,365 gal 30# X-L gel	
		Acid 9,000 gal 15% HCL NEFE	
23. PRODUCTION RECORD			
DATE FIRST PRODUCTION		PRODUCTION METHOD (Flowing, gas lift, pumping—size and type of pump)	
3-27-90		Flowing	
WELL STATUS (Producing or shut-in)		Shut-in	
DATE OF TEST		HOURS TESTED	
5-19-90		1	
CHOKES SIZE		PROD'N. FOR TEST PERIOD	
3/4"		OIL—BBL. GAS—MCF. WATER—BBL. GAS-OIL RATIO	
FLOW. TUBING PRESS. CASINO PRESSURE CALCULATED 24-HOUR RATE		OIL—BBL. GAS—MCF. WATER—BBL. OIL GRAVITY-API (CORR.)	
80 700		600 11	
24. DISPOSITION OF GAS (Sold, used for fuel, vented, etc.) <u>Vented - no sales line hook-up.</u>			
25. LIST OF ATTACHMENTS <u>It is required that a Sunday Notice be submitted for the 5 1/2" Liner</u>			
26. I hereby certify that the foregoing and attached information is complete and correct as determined from all available records			
SIGNED <u>John White</u>		TITLE <u>Reg. Permit Coord.</u>	
DATE <u>6-07-90</u>			

*(See Instructions and Spaces for Additional Data on Reverse Side)

Title 18 U.S.C. Section 1001, makes it a crime for any person knowingly and willfully to make to any department or agency of the United States any false, fictitious or fraudulent statements or representations as to any matter within its jurisdiction.

Re: Payne #3E
2155'FNL, 355'FEL, Section 20, T-32-N, R-10-W, San Juan County, NM
API #30-045-27543
NSL-2532

Amoco Production Company
Att: Bruce Zimney
PO Box 800
Denver, CO 80201

Conoc Inc.
10 Desta Drive, Suite 100W
Midland, TX 79705

I hereby certify that the following offset owners/operators have been notified by certified mail of our application for administrative approval for non-standard well location of the above well.

Peggy Bradford 3-25-97
Regulatory/Compliance Administrator

CMD :
OG5SECT

ONGARD
INQUIRE LAND BY SECTION

04/16/97 01:07:07
OGOMES -EMD7
PAGE NO: 1

Sec : 20 Twp : 32N Rng : 10W Section Type : NORMAL

D 40.00	C 40.00	2 39.29	1 39.23
Fee owned A	Fee owned	Federal owned A	Federal owned
E 40.00	3 39.35	4 39.27	5 39.21
Fee owned	Federal owned	Federal owned	Federal owned A

PF01 HELP PF02 PF03 EXIT PF04 GoTo PF05 PF06
PF07 BKWD PF08 FWD PF09 PRINT PF10 SDIV PF11 PF12

80.00
79.35
159.35
78.56
237.91
78.44
316.35

79.35 78.56 78.44

CMD :
OG5SECT

ONGARD
INQUIRE LAND BY SECTION

04/16/97 01:07:16
OGOMES -EMD7
PAGE NO: 2

Sec : 20 Twp : 32N Rng : 10W Section Type : NORMAL

L 40.00 Federal owned A	8 39.36 Federal owned	7 39.29 Federal owned	6 39.25 Federal owned
M 40.00 Fee owned A	9 39.35 Federal owned	10 39.30 Federal owned	11 39.26 Federal owned A

PF01 HELP	PF02	PF03 EXIT	PF04 GoTo	PF05	PF06
PF07 BKWD	PF08 FWD	PF09 PRINT	PF10 SDIV	PF11	PF12