

MEWBOURNE OIL COMPANY

500 W. TEXAS, SUITE 1020

MIDLAND, TEXAS 79701

915/682-3715

September 21, 1989

RECEIVED

SEP 28 1989

OIL CONSERVATION DIV.
SANTA FE

Mr. Michael Stogner
New Mexico Oil Conservation Division
P. O. Box 2088
Santa Fe, New Mexico 87504

Re: Avalon Prospect
W/2 of Section 28,
T20S, R27E,
Eddy County, New Mexico

Dear Mr. Stogner:

Mewbourne Oil Company feels it is necessary to apply for and receive an unorthodox location drilling permit to drill a well on its Avalon Prospect located in Section 28, T20S, R27E, Eddy County, New Mexico. A location 660'FWL (nearest side boundary) and 990' FSL (nearest end boundary) in the W/2 of Section 28 would give Mewbourne Oil Company a greater likelihood of encountering a thickness of Middle Morrow net sand sufficient to make a commercial well. The enclosed net sand isopach and structure map shows the northwest to southeast trend of the Middle Morrow. Cross Section A-A' enclosed herewith also illustrates this sand trend. The ARCO Conley Federal #1 (location O Section 33) has 22' of net Middle Morrow sand. The Maralo Hanson Federal #3 (location G Section 33) has 0' of net Middle Morrow sand. The geologic mapping tends to support our view that the proposed unorthodox location (shown with open circle) instead of the standard location (marked by X) is reasonable and necessary to drill for Middle Morrow sand in this proration unit.

The unorthodox location, which Mewbourne seeks, is not moving toward nearby wells presently producing from the Morrow Formation. The nearest well, the Holly Energy Avalon Federal "32"#1 (location A, Section 32), is a nearly depleted Strawn producer.

Mewbourne Oil Company has notified the offset operators and unleased mineral owners of our intention to apply for the unorthodox location drilling permit pursuant to Division Rule 104 (F).

Sincerely,

MEWBOURNE OIL COMPANY

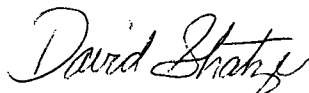

David Shatzer
Geologist

DS/lw

enclosures: Sand Isopach-Structure Map
Cross Section A-A'

ADDRESS LIST

- 1) Oxy USA Inc.
Box 300
Tulsa, Oklahoma 74102
- 2) David Fasken Estate
608 First National Bank Bldg
Midland, Texas 79701
- 3) Commissioner of Public Lands,
State of New Mexico
P.O. Box 1148
Santa Fe, New Mexico 87504-1148
- 4) Hanson-McBride Petroleum Co.
P.O. Box 1515
Roswell, New Mexico 88202-1515
Attn: Kenton A. Hammonds
- 5) Quinoco Petroleum, Inc.
4582 So. Ulster Parkway
Denver, Colo. 80237
- 6) Mr. & Mrs. Donald Fanning
52 Fanning Road
Artesia, New Mexico 88210
- 7) Patricia B. Young
P.O. Box 1639
Solano Beach, Calif. 92075
- 8) Iva B. Rascoe Pallerine
c/o Mildred Rascoe Whitson
24220 Ocean Ave.
Torrance, Calif. 90505
- 9) Robert F. Rascoe
c/o Mildred Rascoe Whitson
24220 Ocean Ave.
Torrance, Calif. 90505
- 10) Mildred Rascoe Whitson
24220 Ocean Ave.
Torrance, Calif. 90505
- 11) Lola May Rascoe Helm
1574 Silver Trail
Napa, Calif. 94558

- 12) U.S. Department of the Interior
Bureau of Land Management
P.O. Box 1449
Santa Fe, New Mexico 87501
- 13) Maralo, Inc.
P.O. Box 832
Midland, Texas 79702-0832
Attn: Mark Wheeler
- 14) Ernest A. Hanson Estate
P.O. Box 1515
Roswell, New Mexico 88202-1515
Attn: Kenton A. Hammonds
- 15) Erma Lowe
4600 Post Oak Place #307
Houston, Texas 77027
- 16) Coquina Oil Corp.
Box 2960
Midland, Texas 79701

COUNTY Eddy

POOL Avalon - Morrow Gas

TOWNSHIP 20 South

RANGE 27 East

NMFM

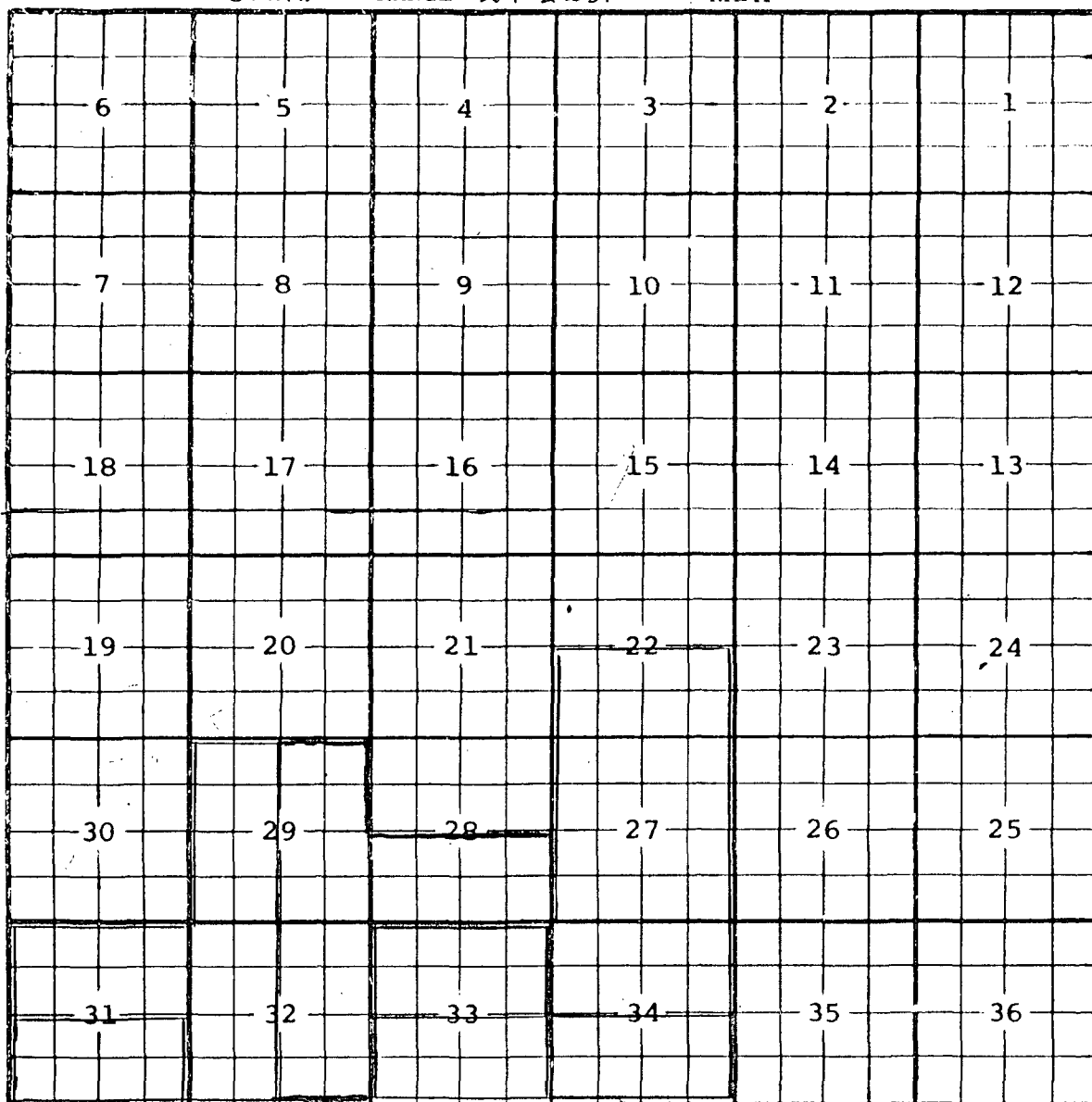

Description: $\frac{5}{2}$ Sec 33 (R-4861, 11-1-74)

Ext: $\frac{5}{2}$ Sec 31 (R-5102, 10-1-75) Ext: $\frac{W}{2}$ Sec 29, $\frac{N}{2}$ Sec 31, -
 $\frac{W}{2}$ Sec 32 (R-5131, 1-1-76) Ext: $\frac{N}{2}$ Sec 33, (R-5252, 9-1-76)

Ext: $\frac{5}{2}$ Sec 34 (R-5361, 3-1-77), Ext: $\frac{5}{2}$ Sec 22, All Sec 27 -

$\frac{N}{2}$ Sec 34 (R-5534, 10-1-77) Ext: $\frac{5}{2}$ sec 28, $\frac{E}{2}$ sec 29, $\frac{E}{2}$ sec 32,
 (R-6876, 1-22-82)

STATE OF NEW MEXICO

ENERGY, MINERALS AND NATURAL RESOURCES DEPARTMENT

OIL CONSERVATION DIVISION



BRUCE KING
GOVERNOR

POST OFFICE BOX 2088
STATE LAND OFFICE BUILDING
SANTA FE, NEW MEXICO 87504
(505) 827-5800

Mewbourne Oil Company
c/o James Bruce
500 Marquette N.W., Suite 800
Albuquerque, New Mexico 87102-2121

Attention: James Bruce

RE: Application to Amend Division Administrative Order NSL-2702, Eddy County, New Mexico.

Dear Mr. Davis:

We may not process the subject application for non-standard gas well location until the required information or plats checked below (is)(are) submitted.

- ☒ A plat must be submitted clearly showing the ownership of all offsetting leases.
- ☒ A statement must be submitted that all offset operators have been notified of the application by certified mail.
- ☐ A plat must be submitted fully identifying the topography necessitating the non-standard location.
- ☐ OTHER: _____

Sincerely,

A handwritten signature in black ink, appearing to read "Michael E. Stogner".

Michael E. Stogner
Chief Hearing Officer/Engineer

MES/jc

MEWBOURNE OIL COMPANY

500 W. TEXAS, SUITE 1020
MIDLAND, TEXAS 79701

915 / 682-3715

OIL CONSERVATION DIVISION

RECEIVED

'89 OCT 12 AM 9 10

September 21, 1989

Certified Mail

Mr. Michael Stogner
New Mexico Oil Conservation Division
P.O. Box 2088
Santa Fe, New Mexico 87501

RE: Application for Unorthodox
Location Drilling Permit
Federal "Q" #1 Well
W/2 of Section 28,
T20S, R27E
Eddy County, New Mexico

Gentlemen:

Erma Lowe, as an offset operator or offset unleased mineral owner, has been advised of Mewbourne Oil Company's intent to drill the above referenced well at a location 660' FWL & 990' FSL of Section 28, T20S, R27E, Eddy County, New Mexico.

This letter is to advise that Erma Lowe has no objection to the granting of a permit to drill at this location and hereby waives objection and notice of hearing on this application.

Sincerely,

MEWBOURNE OIL COMPANY

D. Paul Haden
Landman

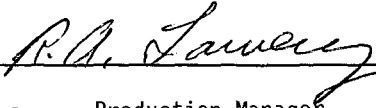
BY: 

Title: Production Manager

Date: 10/2/89

MEWBOURNE OIL COMPANY

500 W. TEXAS, SUITE 1020
MIDLAND, TEXAS 79701

915/682-3715

OIL CONSERVATION DIVISION
RECEIVED

'89 OCT 12 AM 9 10

September 21, 1989

Certified Mail

Mr. Michael Stogner
New Mexico Oil Conservation Division
P.O. Box 2088
Santa Fe, New Mexico 87501

RE: Application for Unorthodox
Location Drilling Permit
Federal "Q" #1 Well
W/2 of Section 28,
T20S, R27E
Eddy County, New Mexico

Gentlemen:

Patricia B. Young, as an offset operator or offset unleased mineral owner, has been advised of Mewbourne Oil Company's intent to drill the above referenced well at a location 660' FWL & 990' FSL of Section 28, T20S, R27E, Eddy County, New Mexico.

This letter is to advise that Patricia B. Young has no objection to the granting of a permit to drill at this location and hereby waives objection and notice of hearing on this application.

Sincerely,

MEWBOURNE OIL COMPANY

D. Paul Haden

D. Paul Haden
Landman

BY: *Patricia B. Young*

Title: *Owner*

Date: *September 23, 1989*

*(Jim Bruce
768-1500)*

MEWBOURNE OIL COMPANY

500 W. TEXAS, SUITE 1020 OIL CONSERVATION DIVISION
MIDLAND, TEXAS 79701 RECEIVED

915 / 682-3715

'89 OCT 16 AM 9 53

September 21, 1989

Certified Mail

Mr. Michael Stogner
New Mexico Oil Conservation Division
P.O. Box 2088
Santa Fe, New Mexico 87501

RE: Application for Unorthodox
Location Drilling Permit
Federal "Q" #1 Well
W/2 of Section 28,
T20S, R27E
Eddy County, New Mexico

Gentlemen:

Oxy USA Inc., as an offset operator or offset unleased mineral owner, has been advised of Mewbourne Oil Company's intent to drill the above referenced well at a location 660' FWL & 990' FSL of Section 28, T20S, R27E, Eddy County, New Mexico.

This letter is to advise that Oxy USA Inc. has no objection to the granting of a permit to drill at this location and hereby waives objection and notice of hearing on this application.

Sincerely,

MEWBOURNE OIL COMPANY

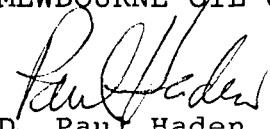
D. Paul Haden
Landman

BY: 

D. Paul Haden
District Manager Production
Title: OXY USA Inc.

Date: 10/9/89

HINKLE, COX, EATON, COFFIELD & HENSLEY

ATTORNEYS AT LAW

500 MARQUETTE N.W., SUITE 740

ALBUQUERQUE, NEW MEXICO 87102-2121

(505) 768-1500

700 UNITED BANK PLAZA

POST OFFICE BOX 10

ROSWELL, NEW MEXICO 88202

(505) 622-6510

2800 CLAYDESTA NATIONAL BANK BUILDING

POST OFFICE BOX 3580

MIDLAND, TEXAS 79702

(915) 683-4691

1700 TEXAS AMERICAN BANK BUILDING

POST OFFICE BOX 9238

AMARILLO, TEXAS 79105

(806) 372-5569

218 MONTEZUMA

POST OFFICE BOX 2068

SANTA FE, NEW MEXICO 87504

(505) 982-4554

LEWIS C. COX
PAUL W. EATON
CONRAD E. COFFIELD
HAROLD L. HENSLEY, JR.
STUART D. SHANOR
C. D. MARTIN
PAUL J. KELLY, JR.
OWEN M. LOPEZ
DOUGLAS L. LUNSFORD
JOHN J. KELLY
T. CALDER EZZELL, JR.
WILLIAM B. BURFORD*
RICHARD E. OLSON
RICHARD R. WILFONG*
STEVEN D. ARNOLD
JAMES J. WECHSLER
NANCY S. CUSACK
JEFFREY L. FORNACIARI
JEFFREY D. HEWETT*
JAMES BRUCE
JERRY F. SHACKELFORD*
JEFFREY W. HELLBERG*
ALBERT L. PITTS
THOMAS M. HNASKO
JOHN C. CHAMBERS*
THOMAS D. HAINES, JR.
FRANKLIN H. MCCALLUM*
GREGORY J. NIBERT

DAVID T. MARKETTE*
MARK C. DOW
KAREN M. RICHARDSON*
FRED W. SCHWENDIMANN
DAVID MORAN
JAMES R. MCADAMS*
JAMES M. HUDSON
MACDONNELL GORDON
REBECCA NICHOLS JOHNSON
PAUL R. NEWTON
WILLIAM R. JOHNSON
ELLEN S. CASEY
MARGARET C. LUDEWIG
PATRICIA A. WATTS*
MARTIN MEYERS
GREGORY S. WHEELER
ANDREW J. CLOUTIER
IWANA RADEMAEKERS*
S. BARRY PAISNER
W. CRAIG BARLOW*
ROBERT W. CASE*
JAMES A. GILLESPIE
KAREN L. COLLIER*
GARY W. LARSON
STEPHANIE LANDRY

OF COUNSEL
O. M. CALHOUN
MACK EASLEY
JOE W. WOOD
STEPHEN L. ELLIOTT

CLARENCE E. HINKLE (1901-1985)
W. E. BONDURANT, JR. (1913-1973)
ROY C. SNODGRASS, JR. (1914-1967)

*NOT LICENSED IN NEW MEXICO

Mr. Michael Stogner
New Mexico Oil Conservation
Division
P. O. Box 2088
Santa Fe, New Mexico 87504

Dear Mr. Stogner:

Enclosed is an application by Mewbourne Oil Company, in triplicate, requesting administrative approval of an unorthodox gas well location for a well to be drilled to the Morrow formation. All offset operators, lessees, or unleased mineral interest owners have been notified of the application by certified mail. I have copies of the notice letters in my file in case you need copies. Please call me if you have any questions on this application.

Very truly yours,

HINKLE, COX, EATON, COFFIELD &
HENSLEY

By: James Bruce

JB:le
Enclosure

R 27 E

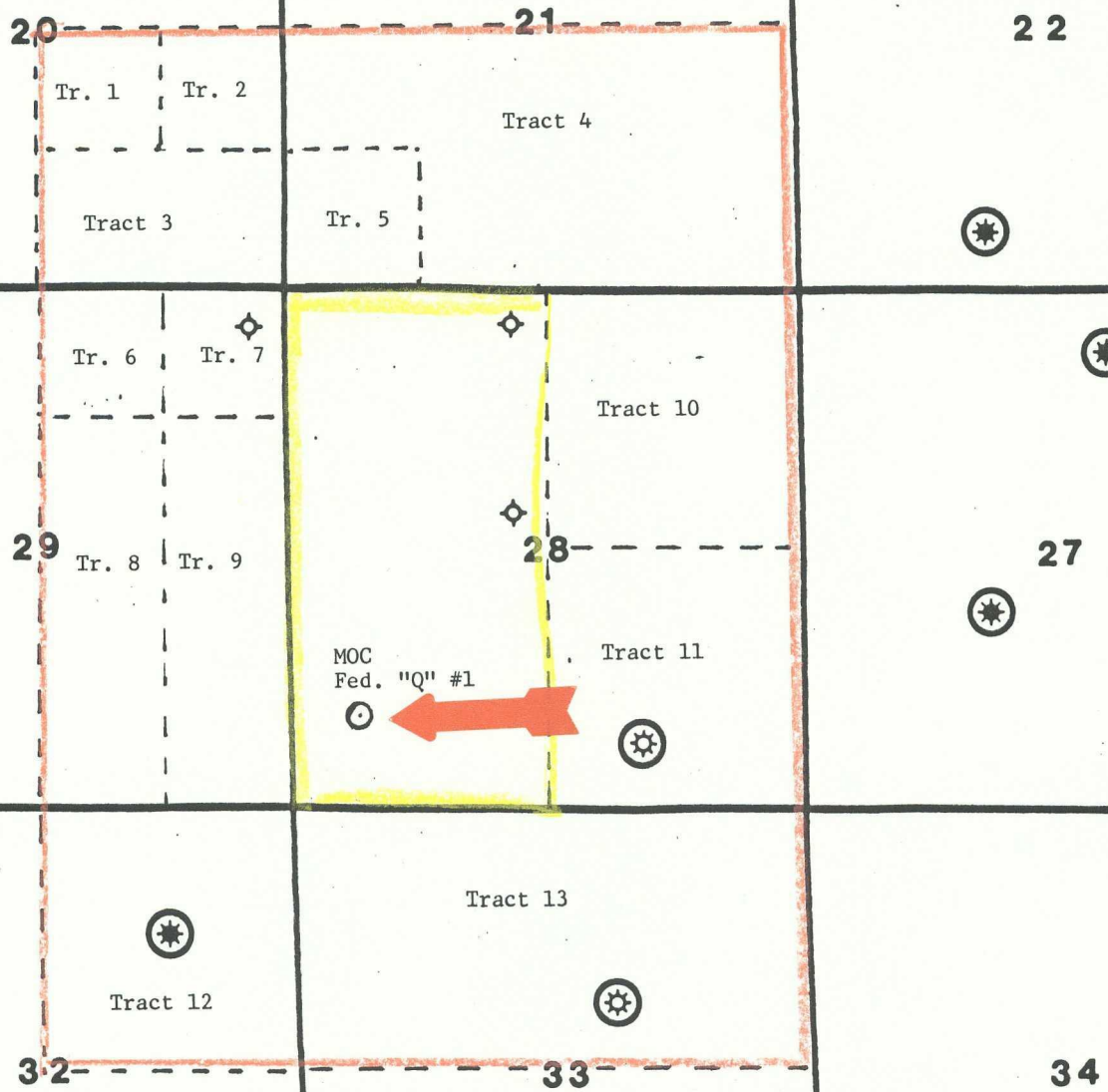

R 26 E

5

4

3

2

OFFSET OWNERS

Tract 1:

- 1) Iva B. Rascoe Pallerine (Unleased)
- 2) Robert F. Rascoe (Unleased)
- 3) Mildred Iva Rascoe Whitson (Unleased)
- 4) Lola May Rascoe Helm (Unleased)

Tract 2:

- 1) Oxy USA, Inc.
- 2) David Fasken Estate

Tract 3:

- 1) Patricia B. Young (Unleased)
- 2) Donald Fanning, (Unleased)
et ux Kathryn B. Fanning

Tract 4:

- 1) State of New Mexico

Tract 5:

- 1) Patricia B. Young (Unleased)
- 2) Donald Fanning, (Unleased)
et ux Kathryn B. Fanning

Tract 6:

- 1) Coquina Oil Corp.
- 2) Department of the Interior
Bureau of Land Management (Unleased ?)

Tract 7:

- 1) Mewbourne Oil Company

Tract 8:

- 1) Oxy USA, Inc.
- 2) Mewbourne Oil Company

Tract 9:

- 1) Coquina Oil Corp.
- 2) Department of the Interior
Bureau of Land Management (Unleased ?)

Tract 10:

- 1) Maralo, Inc.

Tract 11:

- 1) Erma Lowe
- 2) Maralo, Inc.
- 3) Hanson-McBride Petroleum Co.

Tract 12:

- 1) Quinoco Petroleum, Inc.

Tract 13:

- 1) Erma Lowe
- 2) Maralo, Inc.
- 3) Ernest A. Hanson Estate