

**OXY USA WTP LP
BIG WALT
CENTRAL TANK BATTERY (CTB)
Work Plan
Section 2, Township 22S, Range 24E
Eddy County, New Mexico
30-015-27509**

October 24, 2007

Prepared for:

US Dept. of the Interior
Bureau of Land Management
620 E. Greene Street
Carlsbad, NM 88220

State of New Mexico
Oil Conservation Division
1301 W. Grand Avenue
Artesia, NM 88210

By:

*OXY USA WTP LP
102 S. Main St.
Carlsbad, NM 88220
575-887-8337*

Guye, Gerry, EMNRD

From: Guye, Gerry, EMNRD
Sent: Monday, October 29, 2007 12:24 PM
To: 'Rick_Kerby@oxy.com'
Cc: Bratcher, Mike, EMNRD; 'James_Amos@nm.blm.gov'
Subject: Work Plan for Oxy Big Walt CTB

Rick

I have gone over your proposed work plan for this battery and have approved it with the following stipulations:

The diagram you sent did not indicate the depth of the samples so I am assuming the samples were taken only at surface level. Hence the high TPH levels.

Use of micro-blasé is authorized outside of the fenced area only. All contaminated soils will be removed from inside the fenced area, as indicated in your work plan, and a new series of samples taken in that area, sent to OCD for approval before any back fill. A diagram must be submitted with the samples showing where the sample was taken and at what depth.

The area outside the fenced area will be monitored for 60 days after spreading of the micro-blasé then new samples will be lab - tested and submitted to the OCD for approval prior to any further action.

Please be advised that OCD approval of this plan does not relieve your company of liability should their operations have failed to adequately investigate and remediate contamination that may pose a threat to ground water, surface water, human health or the environment. In addition, OCD approval does not relieve your company of responsibility for compliance with any other applicable **federal**, state, local laws and/or regulations.

Gerry Guye

Compliance Officer

NMDCD - Artesia

Office (505)748-1283x105

Mobile (505)626-0843

E-Mail: gerry.guye@state.nm.us

10/29/2007

TABLE OF CONTENTS

I.	COMPANY CONTACTS	1
II.	BACKGROUND	1
III.	DRIVING DIRECTIONS TO LOCATION	1
IV.	SURFACE AND GROUND WATER	1
V.	SOILS	1
VI.	DELINEATION PLAN	1
VII.	WORK DONE	1
VIII.	FIGURES & APPENDICES	
	Figure 1 – Vicinity Map	2
	Appendix A – Form C-141	4
	Appendix B – Site Photos	6
	Appendix C – Soil Samples	8

I. Company Contact(s)

NAME	Company	Telephone	E-mail
Rick Kerby	Oxy	505-887-8337	rick_kerby@oxy.com

II. Background

The subject site is a release, which occurred on October 4, 2007. This release was caused by an air compressor which failed to work properly, causing the dump valves to the gun barrel to remain open. This caused the piping and the bottom of the tank to be blown out. Approximately 750 barrels of produced water and 12 barrels of oil were released, of which 500 barrels of the produced water was recovered.

III. Driving Directions to Location

Leaving Carlsbad and US 285 North, turn west (left) onto NM 137. Proceed straight on NM 137 approximately 6.3 miles. Turn south (left) onto lease road and proceed approximately 4.3 miles to location.

III. Surface and Ground Water

The closest groundwater of record was listed with the Office of the State Engineer. This well is located in Section 2, Township 22 South, Range 24 East. The depth of water is greater than 50', giving this well a ranking of 10.

IV Soils

(need soil information).

V. Delineation Plan

Safety and Environmental Solutions, Inc. (SESI) took samples of soils for testing. The results are listed in Appendix C – Chloride Samples.

VI. Work Plan

Knapf was used to soak up excess fluids and other hydrocarbons around tank and in the pasture. Contaminated surface soil below dike and inside fenced area will be excavated and hauled to disposal. Plastic will be laid between dike and fenced area, and a secondary containment dike will be added inside the fence, to act as a collection site. The dike will be kept empty. Micro-blasé microbes will be sprayed on contaminated areas and maintained. Area will be inspected periodically and microbes added as needed. Pictures will be used to document recovery process of pasture. (History has proven that disruption to native plant life by mechanical means only adds to damage done to pastures.)

VII. Figures & Appendices

Figure 1 – Vicinity Map

Appendix A – C-141

Appendix B – Site Photos

Appendix C – Chloride Samples

Figure 1
Vicinity Map

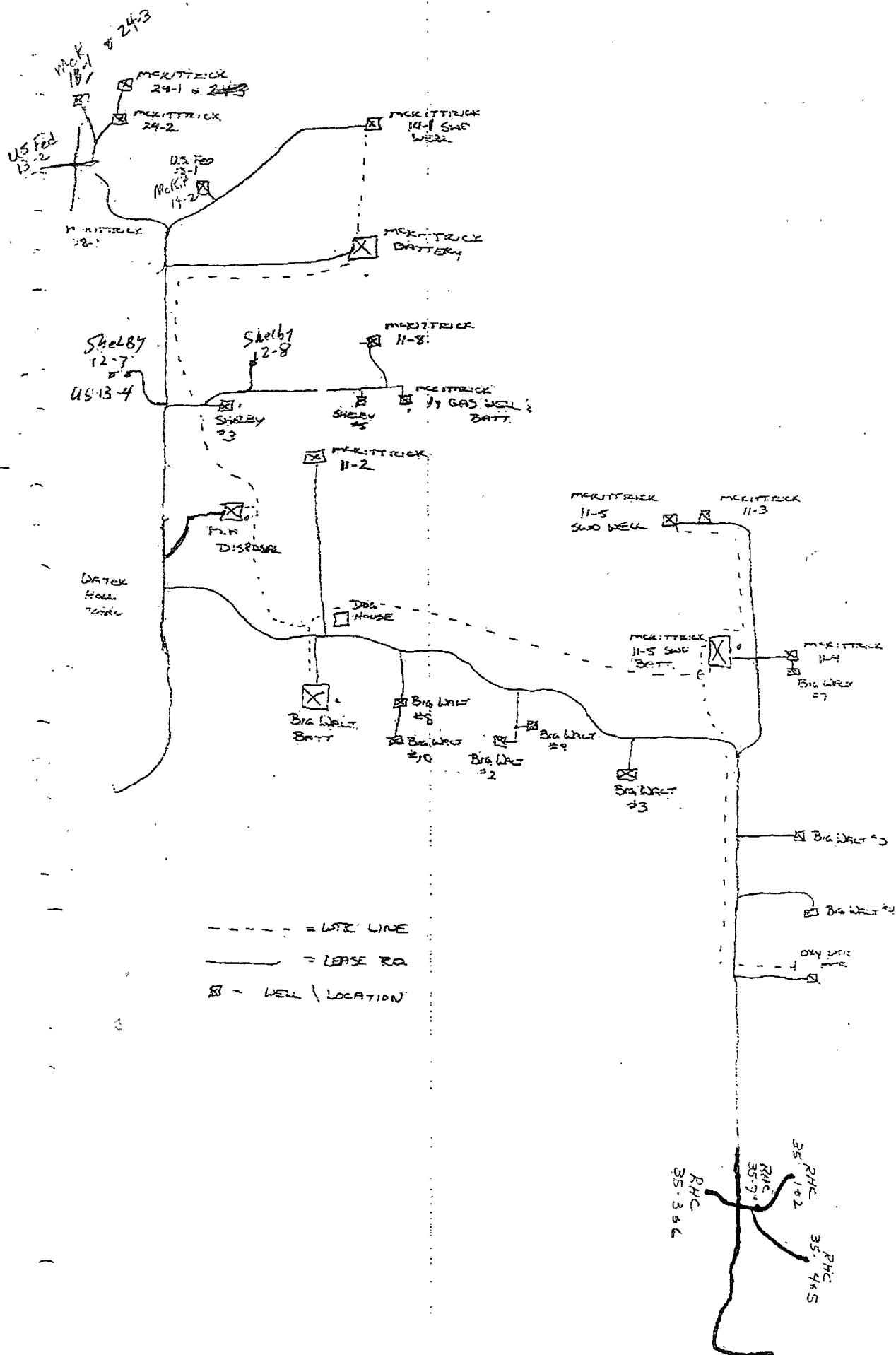

Appendix A

C-141

District I
1625 N French Dr , Hobbs, NM 88240
District II
1301 W Grand Avenue, Artesia, NM 88210
District III
1000 Rio Brazos Road, Aztec, NM 87410
District IV
1220 S St Francis Dr., Santa Fe, NM 87505

State of New Mexico
Energy Minerals and Natural Resources
Oil Conservation Division
1220 South St. Francis Dr.
Santa Fe, NM 87505

Form C-141
Revised October 10, 2003

Submit 2 Copies to appropriate
District Office in accordance
with Rule 116 on back
side of form

Release Notification and Corrective Action

OPERATOR

☒ Initial Report ☐ Final Report

Name of Company OXY USA WTP LP	Contact RICK KERBY, HES SPECIALIST
Address 102 S. Main St., POB 1988, Carlsbad, NM 88220	Telephone No. 505-887-8337
Facility Name Big Walt	Facility Type Central Tank Battery

Surface Owner BLM	Mineral Owner	Lease No.
--------------------------	---------------	-----------

LOCATION OF RELEASE

Unit Letter	Section	Township	Range	Feet from the	North/South Line	Feet from the	East/West Line	County
	2	22 South	24 East					Eddy

Latitude _____ Longitude _____

NATURE OF RELEASE

Type of Release Water/Oil	Volume of Release 750 bbls wtr 12 bbls oil	Volume Recovered 500 bbls oil-water
Source of Release Leak on Gun Barrel	Date and Hour of Occurrence 10/04/07 09:30a.m.	Date and Hour of Discovery 10/04/07 10:30a.m.
Was Immediate Notice Given? <input type="checkbox"/> Yes <input checked="" type="checkbox"/> No <input type="checkbox"/> Not Required	If YES, To Whom?	
By Whom?	Date and Hour	
Was a Watercourse Reached? <input type="checkbox"/> Yes <input checked="" type="checkbox"/> No	If YES, Volume Impacting the Watercourse.	

If a Watercourse was Impacted, Describe Fully.*

Not applicable

Describe Cause of Problem and Remedial Action Taken.*

Air compressor failed, so dump valves to gun barrel hung open, which blew piping and bottom out of tank. Vacuum truck called and picked up what it could before water soaked into ground.

Describe Area Affected and Cleanup Action Taken *

Most of fluid stayed on location. Ground will be allowed to dry, soil samples will be collected, and a work plan will be formulated and submitted to NMOCD.

I hereby certify that the information given above is true and complete to the best of my knowledge and understand that pursuant to NMOCD rules and regulations all operators are required to report and/or file certain release notifications and perform corrective actions for releases which may endanger public health or the environment. The acceptance of a C-141 report by the NMOCD marked as "Final Report" does not relieve the operator of liability should their operations have failed to adequately investigate and remediate contamination that pose a threat to ground water, surface water, human health or the environment. In addition, NMOCD acceptance of a C-141 report does not relieve the operator of responsibility for compliance with any other federal, state, or local laws and/or regulations

OIL CONSERVATION DIVISION

Signature:

Printed Name: **Rick Kerby**

Approved by District Supervisor:

Title: **HES Specialist**

Approval Date

Expiration Date:

E-mail Address: **rick_kerby@oxy.com**

Conditions of Approval:

Attached ☐

Date **10/11/2007**

Phone: **505-887-8337 (O)
505-390-8639 (C)**

* Attach Additional Sheets If Necessary

Appendix C

Soil Samples

Soil Samples

Sample Point	Chlorides	Benzene	Toluene	Ethyl Benzene	Xyolene	TPH
#1	300	ND	19	6.1	69	75,000
#2	130	ND	6.8	2.6	36	51,000
#3	200	ND	9.9	3.6	36	48,000
#4	560	ND	1.1	0.80	6.5	28,000
#5	92	ND	93	27	300	87,000
Background	ND	ND	ND	ND	ND	ND

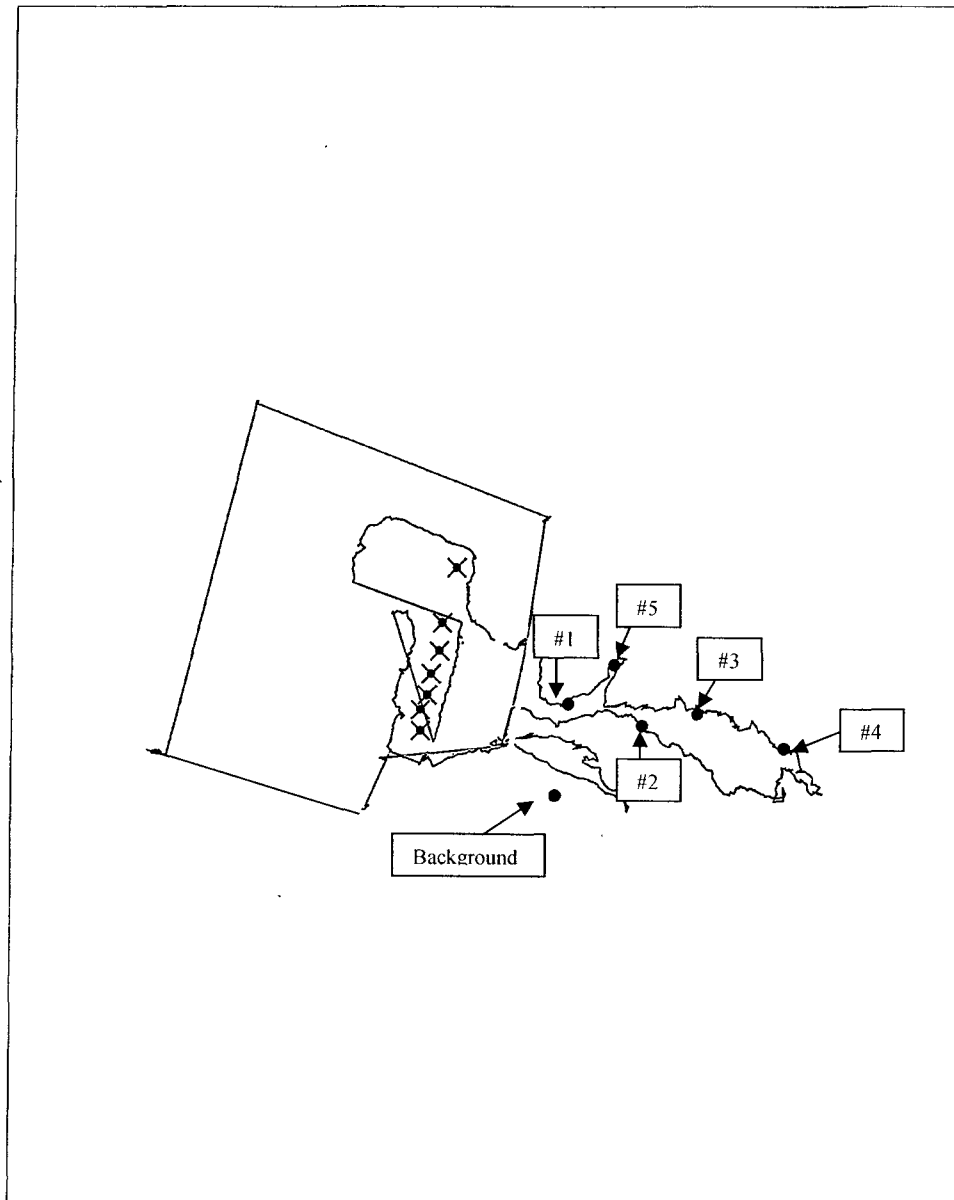

Big Walt Battery

Lat/Long
WGS 1984



Scale 1:2,000
0 250.0
Feet

Multiple Files
10/11/2007
GPS Pathfinder[®] Office
 **Trimble**[™]