

<p>④ 37.19</p> <p>Southland Royalty Greiner No. 184 1415' FSL - 1530' FWL Basin Fruitland Coal Drilling w/ B Dedication</p>	<p>③ 37.34</p> <p>Southland Royalty Greiner No. 184 1415' FSL - 1530' FWL Basin Fruitland Coal Drilling w/ B Dedication</p>	<p>② 36.61</p> <p>Southland Royalty Greiner No. 105 1795' FSL - 1715' FEL Basin Fruitland Coal Gas Drilling w/ B Dedication</p>	<p>① 36.95</p> <p>Southland Royalty Greiner No. 105 1795' FSL - 1715' FEL Basin Fruitland Coal Gas Drilling w/ B Dedication</p>
<p>Southland Royalty Greiner No. 21 11650' FS + WL Spud - 7/19/69 T.D. - 2730' Oxytec P.C. Producing</p>	<p>Southland Royalty Greiner No. 11E 1075' FSL - 1850' FWL Spud - 10/6/79 T.D. - 7340' Glades Fruitland Sand Producing</p>	<p>Southland Royalty Greiner No. 18 1550' FSL - 1840' FEL Spud - 3/22/69 T.D. - 2790' Oxytec P.C. Producing Subject well</p>	<p>Southland Royalty Greiner No. 12 790' FS + EL Spud - 7/15/62 T.D. - 7305' Basin Dakota Producing</p>

38.1  
38.54  
6.64  
78  
136.69  
16  
31 6.69

SECTION 13

TOWNSHIP 31N

RANGE 12W

San Juan Co.

UNITED STATES  
DEPARTMENT OF THE INTERIOR  
BUREAU OF LAND MANAGEMENT

OIL CONSERVATION DIVISION  
RECEIVED

RECEIVED

APPLICATION FOR PERMIT TO DRILL, DEEPEN, OR PLUG BACK

1a. TYPE OF WORK PLUG BACK		MAY 4 1990		5. LEASE NUMBER SF-078115	
1b. TYPE OF WELL GAS		BUREAU OF LAND MANAGEMENT FARMINGTON RESOURCE AREA		6. IF INDIAN, ALL. OR TRIBE NAME	
2. OPERATOR SOUTHLAND ROYALTY COMPANY				7. UNIT AGREEMENT NAME	
3. ADDRESS & PHONE NO. OF OPERATOR P.O. BOX 4289 FARMINGTON, NM 87499 (505) 326-9700				8. FARM OR LEASE NAME GRENIER	
4. LOCATION OF WELL 1550' FSL; 1840' FEL				9. WELL NO. #18	
14. DISTANCE IN MILES FROM NEAREST TOWN				10. FIELD, POOL, OR WILDCAT BASIN FRUITLAND COAL	
15. DISTANCE FROM PROPOSED LOCATION TO NEAREST PROPERTY OR LEASE LINE.				11. SEC. T. R. M OR BLK. J SEC. 13, T31N, R12W	
16. ACRES IN LEASE				12. COUNTY SAN JUAN	
17. ACRES ASSIGNED TO WELL (S/316.64)				13. STATE NM	
18. DISTANCE FROM PROPOSED LOCATION TO NEAREST WELL DR. COMPL., OR APPLIED FOR ON THIS LEASE.				20. ROTARY OR CABLE TOOLS	
21. ELEVATIONS (DF, FT, GR, ETC.) 6114' GL				22. APPROX. DATE WORK WILL START	

23. PROPOSED CASING AND CEMENTING PROGRAM

\*SEE OPERATIONS PLAN

24. AUTHORIZED BY: Diana Bradfield (CJS)  
REGULATORY AFFAIRS

5-3-90  
DATE

PERMIT NO. \_\_\_\_\_ APPROVAL DATE \_\_\_\_\_

APPROVED BY \_\_\_\_\_ TITLE \_\_\_\_\_ DATE \_\_\_\_\_

NOTE: THIS FORMAT IS ISSUED IN LIEU OF US BLM FORM 3160-3.  
(NO ADDITIONAL DIRT WORK WILL BE REQUIRED)

RECEIVED

MAY 14 1990

OIL CON. DIV.

DIST. 3

NMOCD

APPROVED

MAY 09 1990  
Ken Townsend

FOR AREA MANAGER

Hold on 104 For USL & N 5 p & Cancel Greiner #104 & #105  
(E)

30-045-27559

UNITED STATES  
DEPARTMENT OF THE INTERIOR  
BUREAU OF LAND MANAGEMENT

OIL CONSERVATION DIVISION  
RECEIVED  
30 JAN 8 AM 9 33

RECEIVED  
BLM MAIL ROOM

89 OCT 27 AM 10:14

APPLICATION FOR PERMIT TO DRILL, DEEPEN, OR PLUG BACK

1a. TYPE OF WORK DRILL	<b>RECEIVED</b> DEC 26 1989	5. LEASE NUMBER SF-078115
1b. TYPE OF WELL GAS		6. IF INDIAN, ALL. OR TRIBE NAME
2. OPERATOR SOUTHLAND ROYALTY DIST. 3	<b>OIL CON. DIV</b>	7. UNIT AGREEMENT NAME
3. ADDRESS & PHONE NO. OF OPERATOR P O BOX 4289 FARMINGTON, NM 87499		8. FARM OR LEASE NAME GRENIER
4. LOCATION OF WELL <del>2475' N 790' E</del> 1745' 000' & 1715' 000'		9. WELL NO. 105
10. FIELD, POOL, OR WILDCAT BASIN FRUITLAND COAL		11. SEC. T. R. M OR BLK. C SEC. 13 T31N R12W NMPM
14. DISTANCE IN MILES FROM NEAREST TOWN 5 MILES FROM AZTEC	12. COUNTY SAN JUAN	13. STATE NM
15. DISTANCE FROM PROPOSED LOCATION 790' TO NEAREST PROPERTY OR LEASE LINE.	16. ACRES IN LEASE	17. ACRES ASSIGNED TO WELL 307.78
18. DISTANCE FROM PROPOSED LOCATION TO NEAREST WELL DR. 700' COMPL., OR APPLIED FOR ON THIS LEASE.	19. PROPOSED DEPTH 2694'	20. ROTARY OR CABLE TOOLS ROTARY
21. ELEVATIONS (DF, FT, GR, ETC.) 6183' GL 6175'	This action is subject to technical and procedural review pursuant to 43 CFR 3185.3 and appeal pursuant to 43 CFR 3185.4.	
22. APPROX. DATE WORK WILL START		
23. PROPOSED CASING AND CEMENTING PROGRAM		

\*SEE OPERATIONS PLAN

DRILLING OPERATIONS AUTHORIZED ARE  
SUBJECT TO COMPLIANCE WITH ATTACHED  
"GENERAL REQUIREMENTS".

24. AUTHORIZED BY: J. D. Zylke  
REGULATORY AFFAIRS

10/21/89  
DATE

PERMIT NO. \_\_\_\_\_ APPROVAL DATE \_\_\_\_\_  
APPROVED BY \_\_\_\_\_ TITLE \_\_\_\_\_

**APPROVED  
AS AMENDED**

NOTE: THIS FORMAT IS ISSUED IN LIEU OF US BLM FORM 3160-

OK  
②

HMCOO

DEC 21 1989  
John Skellern  
AREA MANAGER

Submit to Appropriate  
District Office  
State Leases - 4 copies  
Fee Leases - 3 copies

State of New Mexico  
Energy, Minerals and Natural Resources Department

Form C-102  
Revised 1-1-89

OIL CONSERVATION DIVISION

P.O. Box 2088  
Santa Fe, New Mexico 87504-2088

DISTRICT I  
P.O. Box 1980, Hobbs, NM 88240

DISTRICT II  
P.O. Drawer DD, Artesia, NM 88210

DISTRICT III  
1000 Rio Brazos Rd., Aztec, NM 87410

WELL LOCATION AND ACREAGE DEDICATION PLAT

All Distances must be from the outer boundaries of the section

Operator Southland Royalty Company			Lease Grenier (SF-078115)		Well No. 105
Unit Letter G	Section 13	Township 31 North	Range 12 West	County San Juan	
Actual Footage Location of Well: 1795 feet from the North line and 1715 feet from the East line					
Ground level Elev. 6195'	Producing Formation Fruitland Coal		Pool Basin	Dedicated Acreage: 307.78 Acres	

- Outline the acreage dedicated to the subject well by colored pencil or hectare marks on the plat below.
- If more than one lease is dedicated to the well, outline each and identify the ownership thereof (both as to working interest and royalty).
- If more than one lease of different ownership is dedicated to the well, have the interest of all owners been consolidated by communitization, unitization, force-pooling, etc.?  
☐ Yes ☐ No If answer is "yes" type of consolidation \_\_\_\_\_

If answer is "no" list the owners and tract descriptions which have actually been consolidated. (Use reverse side of this form if necessary.) \_\_\_\_\_

No allowable will be assigned to the well until all interests have been consolidated (by communitization, unitization, forced-pooling, or otherwise) or until a non-standard unit, eliminating such interest, has been approved by the Division.

OPERATOR CERTIFICATION

I hereby certify that the information contained herein is true and complete to the best of my knowledge and belief.

Signature  
Peggy Bradfield  
Printed Name  
Regulatory Affairs  
Position  
Southland Royalty Co  
Company  
11-27-89  
Date

SURVEYOR CERTIFICATION

I hereby certify that the well location shown on this plat was plotted from field notes or actual surveys made by me or under my supervision, and that the same is true and correct to the best of my knowledge and belief.

Date Surveyed  
Neal C. Edwards  
Signature of Sealer  
Professional Surveyor  
857

Certificate No.

6857

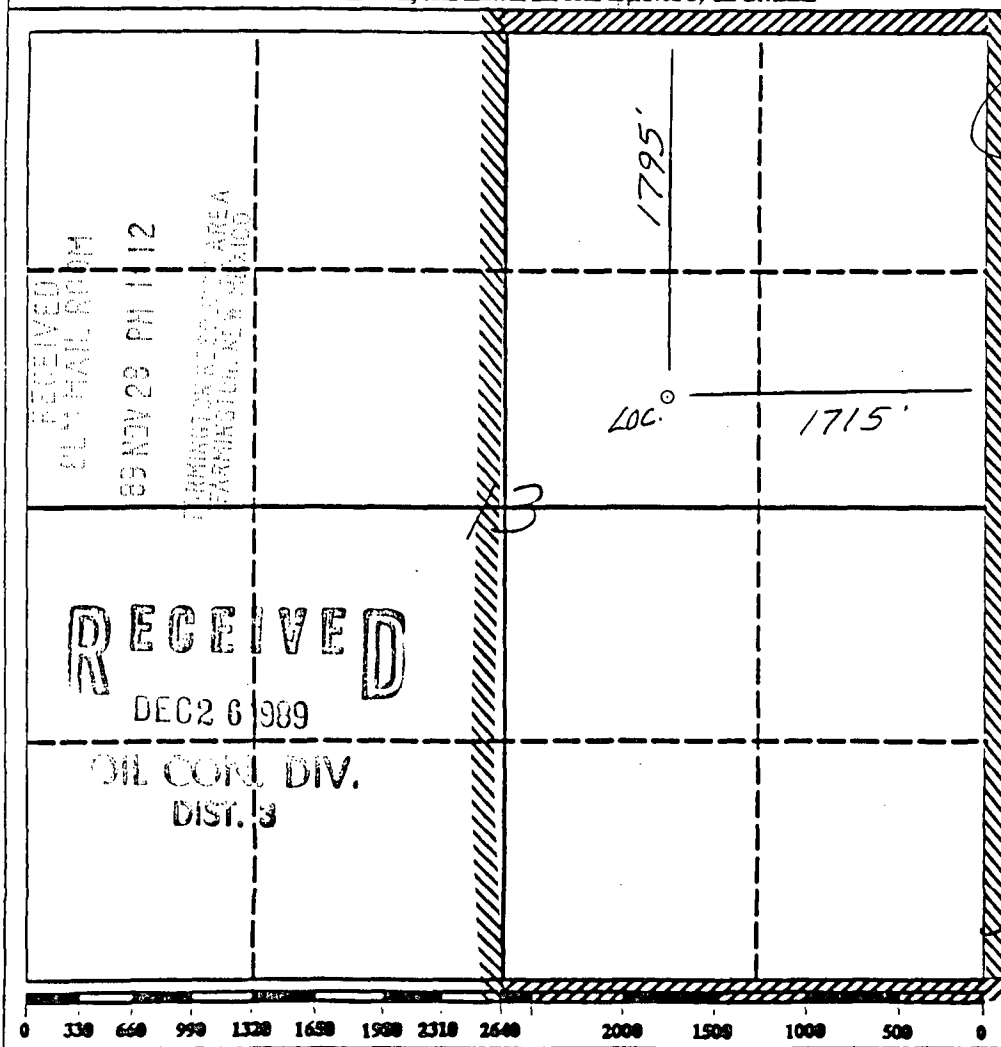

State of New Mexico  
Energy, Minerals and Natural Resources Department

Form C-103

OIL CONSERVATION DIVISION  
P.O. Box 2088  
Santa Fe, New Mexico 87504-2088

SUNDRY NOTICES AND REPORTS ON WELLS		API NO. (assigned by OCD on new wells) 30-045-27249	
-----		5. Indicate Type of Lease FEE	
1a. Type of Well GAS		6. State Oil & Gas Lease No. SF-078115	
2. Name of Operator SOUTHLAND ROYALTY CO.		7. Lease Name or Unit Agreement Name GRENIER	
3. Address of Operator PO Box 4289, Farmington, NM 87499		8. Well No. 104	
4. Well Location Unit letter      1415'S      1535'W Section 13      T31N      R12W      NMPM      SAN JUAN      COUNTY		9. Pool Name or Wildcat BASIN      FRUITLAND COAL	
10. Elevation 6114'			
11. SUBSEQUENT REPORT OF: Permit to Drill Extension			
12. Describe proposed or completed operations			

It is anticipated that the Permit to Drill will expire on 03/17/90 before this well can be spudded, therefore an extension is requested.

**RECEIVED**  
MAR 07 1990  
OIL CON. DIV.,  
DIST. 3

APPROVAL EXPIRES 9-17-90  
UNLESS DRILLING IS COMMENCED.  
SPUD NOTICE MUST BE SUBMITTED  
WITHIN 10 DAYS.

OIL CONSERVATION DIVISION  
RECEIVED

90 MAR 20 AM 8 47

SIGNATURE [Signature] TITLE Reg. Drilling Engr. DATE 3/5/90

(This space for State Use)

APPROVED BY [Signature] TITLE SUPERVISOR DISTRICT # 1 DATE MAR 17 1990  
Conditions of approval, if any:

OIL CONSERVATION DIVISION  
P. O. BOX 2088  
SANTA FE, NEW MEXICO 87501

Form C-103  
Revised 10-

NO. OF COPIES RECEIVED	
DISTRIBUTION	
SANTA FE	
FILE	
U.S.G.S.	
LAND OFFICE	
OPERATOR	

5a. Indicate Type of Lease  
State ☐ Fee ☒

5. State Oil & Gas Lease No.

## SUNDRY NOTICES AND REPORTS ON WELLS

(DO NOT USE THIS FORM FOR PROPOSALS TO DRILL OR TO DEEPEN OR PLUG BACK TO A DIFFERENT RESERVOIR.  
USE "APPLICATION FOR PERMIT - FORM C-101" FOR SUCH PROPOSALS.)

OIL WELL <input type="checkbox"/>	GAS WELL <input checked="" type="checkbox"/>	OTHER <input type="checkbox"/>	7. Unit Agreement Name
Name of Operator Southland Royalty Company			8. Farm or Lease Name Grenier
Address of Operator P.O. Box 4289, Farmington, New Mexico 87499			9. Well No. 104
Location of Well UNIT LETTER <u>K</u> <u>1415</u> FEET FROM THE <u>South</u> LINE AND <u>1535</u> FEET FROM THE <u>West</u> LINE, SECTION <u>13</u> TOWNSHIP <u>31N</u> RANGE <u>12W</u> NMPM.			10. Field and Pool, or adjacent Basin Fruitland Coal
15. Elevation (Show whether DF, RT, GR, etc.) 6114' GL			12. County San Juan

Check Appropriate Box To Indicate Nature of Notice, Report or Other Data

NOTICE OF INTENTION TO: SUBSEQUENT REPORT OF:

PERFORM REMEDIAL WORK <input type="checkbox"/>	PLUG AND ABANDON <input type="checkbox"/>	REMEDIAL WORK <input type="checkbox"/>	ALTERING CASING <input type="checkbox"/>
TEMPORARILY ABANDON <input type="checkbox"/>	CHANGE PLANS <input type="checkbox"/>	COMMENCE DRILLING OPNS. <input type="checkbox"/>	PLUG AND ABANDONMENT <input type="checkbox"/>
PULL OR ALTER CASING <input type="checkbox"/>	OTHER <u>Permit to Drill Extension</u> <input checked="" type="checkbox"/>	CASING TEST AND CEMENT JOB <input type="checkbox"/>	OTHER <input type="checkbox"/>

7. Describe Proposed or Completed Operations (Clearly state all pertinent details, and give pertinent dates, including estimated date of starting any proposed work) SEE RULE 1703.

It is anticipated that the "Permit to Drill" will expire before this well can be spudded; Therefore, an extension is requested.

APPROVAL EXPIRES 3-17-90  
UNLESS DRILLING IS COMMENCED.  
SPUD NOTICE MUST BE SUBMITTED  
WITHIN 10 DAYS.

RECEIVED  
SEP 28 1989  
OIL CON. DIV  
DIST. 3

8. I hereby certify that the information above is true and complete to the best of my knowledge and belief.

ISSUED <u>[Signature]</u>	TITLE <u>Regulatory Affairs</u>	DATE <u>9-26-89</u>
APPROVED BY <u>[Signature]</u>	TITLE <u>SUPERVISOR DISTRICT # 3</u>	DATE <u>SEP 28 1989</u>
CONDITIONS OF APPROVAL, IF ANY:		

Submit to Appropriate  
District Office  
State Lease - 6 copies  
Fee Lease - 5 copies

State of New Mexico  
Energy, Minerals and Natural Resources Department

Form C-101  
Revised 1-1-89

OIL CONSERVATION DIVISION

DISTRICT I  
P.O. Box 1980, Hobbs, NM 88240

DISTRICT II  
P.O. Drawer DD, Artesia, NM 88210

DISTRICT III  
1000 Rio Brazos Rd., Aztec, NM 87410

P.O. Box 2088  
Santa Fe, New Mexico 87504-2088

API NO. (assigned by OCD on New Wells) <u>30-045-27249</u>	
5. Indicate Type of Lease STATE <input type="checkbox"/> FEE <input checked="" type="checkbox"/>	
6. State Oil & Gas Lease No.	
7. Lease Name or Unit Agreement Name  Grenier	
8. Well No. 104 (W/314.53)	9. Pool name or Wildcat Basin Fruitland Coal

APPLICATION FOR PERMIT TO DRILL, DEEPEN, OR PLUG BACK					
1a. Type of Work: DRILL <input checked="" type="checkbox"/> RE-ENTER <input type="checkbox"/> DEEPEN <input type="checkbox"/> PLUG BACK <input type="checkbox"/>					
b. Type of Well: OIL WELL <input type="checkbox"/> GAS WELL <input checked="" type="checkbox"/> OTHER <input type="checkbox"/> SINGLE ZONE <input checked="" type="checkbox"/> MULTIPLE ZONE <input type="checkbox"/>					
2. Name of Operator Southland Royalty Company			8. Well No. 104 (W/314.53)		
3. Address of Operator PO Box 4289, Farmington, NM 87499			9. Pool name or Wildcat Basin Fruitland Coal		
4. Well Location Unit Letter <u>K</u> : <u>1415</u> Feet From The <u>South</u> Line and <u>1535</u> Feet From The <u>West</u> Line Section <u>13</u> Township <u>31N</u> Range <u>12W</u> NMPM San Juan County					
10. Proposed Depth 2625'		11. Formation Fruitland Coal		12. Rotary or C.T. Rotary	
13. Elevations (Show whether DF, RT, GR, etc.) 6114' GL		14. Kind & Status Plug. Bond statewide		15. Drilling Contractor	
16. Approx. Date Work will start					
17. PROPOSED CASING AND CEMENT PROGRAM					
SIZE OF HOLE	SIZE OF CASING	WEIGHT PER FOOT	SETTING DEPTH	SACKS OF CEMENT	EST. TOP
12 1/4"	9 5/8"	32.3#	200'	125 cu.ft.	circ surf
8 3/4"	7"	20.0#	2375'	445 cu.ft.	cover O.A.
6 1/4"	5 1/2" liner	15.5#	2625'	do not cement	

APPROVAL EXPIRES 9-17-89  
UNLESS DRILLING IS COMMENCED.  
SPUD NOTICE MUST BE SUBMITTED  
WITHIN 10 DAYS.

The Fruitland Coal formation will be completed.

A 3000 psi WP and 6000 psi test double gate preventer equipped with blind and pipe rams will be used for blow out prevention on this well.

This gas is dedicated.

The W/2 of Section 13 is dedicated to this well.

RECEIVED  
MAR 17 1989  
OIL CON. DIV.  
DIST. 3

IN ABOVE SPACE DESCRIBE PROPOSED PROGRAM: IF PROPOSAL IS TO DEEPEN OR PLUG BACK, GIVE DATA ON PRESENT PRODUCTIVE ZONE AND PROPOSED NEW PRODUCTIVE ZONE. GIVE BLOWOUT PREVENTER PROGRAM, IF ANY.

I hereby certify that the information above is true and complete to the best of my knowledge and belief.

SIGNATURE [Signature] TITLE Regulatory Affairs DATE 3-16-89  
TYPE OR PRINT NAME \_\_\_\_\_ TELEPHONE NO. \_\_\_\_\_

(This space for State Use)

APPROVED BY [Signature] DEPUTY OIL & GAS INSPECTOR, DIST. #3 DATE MAR 17 1989  
CONDITIONS OF APPROVAL, IF ANY:



Appropriate  
Office  
size - 4 copies  
size - 3 copies

State of New Mexico  
Energy, Minerals and Natural Resources Department

Form C-102  
Revised 1-1-89

OIL CONSERVATION DIVISION

P.O. Box 2088  
Santa Fe, New Mexico 87504-2088

DISTRICT I  
P.O. Box 1980, Hobbs, NM 88240

DISTRICT II  
P.O. Drawer DD, Artesia, NM 88210

DISTRICT III  
1000 Rio Brazos Rd., Aztec, NM 87410

WELL LOCATION AND ACREAGE DEDICATION PLAT

All Distances must be from the outer boundaries of the section

Operator Southland Royalty Company			Lease Grenier		(Fee)	Well No. 104
Unit Letter K	Section 13	Township 31 North	Range 12 West	County San Juan		
Actual Footage Location of Well: 1415 feet from the South line and 1535 feet from the West line						
Ground level Elev. 6114'	Producing Formation Fruitland Coal		Pool Basin	Dedicated Acreage: 314.53 Acres		

- Outline the acreage dedicated to the subject well by colored pencil or hatchure marks on the plat below.
- If more than one lease is dedicated to the well, outline each and identify the ownership thereof (both as to working interest and royalty).
- If more than one lease of different ownership is dedicated to the well, have the interest of all owners been consolidated by communitization, unitization, force-pooling, etc?  
☐ Yes ☐ No If answer is "yes" type of consolidation \_\_\_\_\_  
If answer is "no" list the owners and tract descriptions which have actually been consolidated. (Use reverse side of this form if necessary.)  
No allowable will be assigned to the well until all interests have been consolidated (by communitization, unitization, forced-pooling, or otherwise) or until a non-standard unit, eliminating such interest, has been approved by the Division.

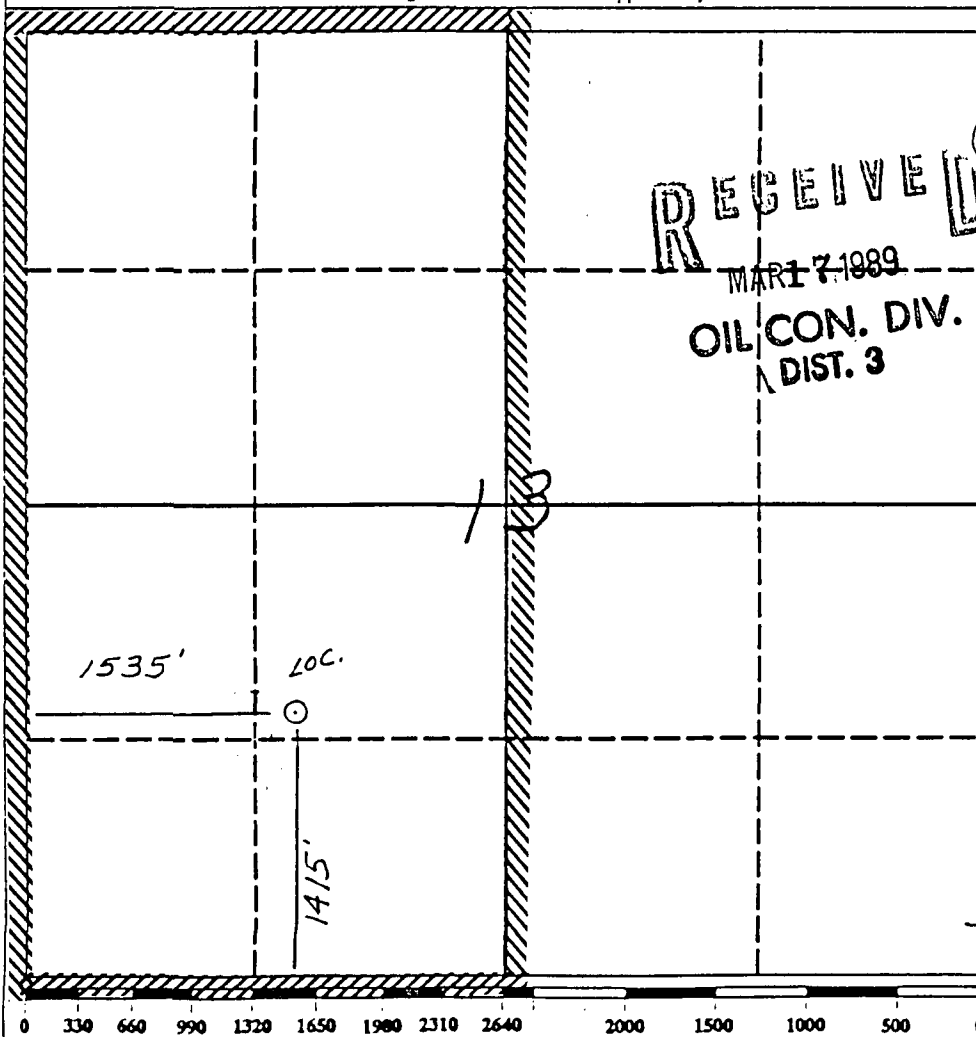

OPERATOR CERTIFICATION

I hereby certify that the information contained herein is true and complete to the best of my knowledge and belief.

Signature  
Peggy Bradfield

Printed Name  
Southland Royalty Co.

Position  
Regulatory Affairs

Company  
3-16-89

Date

SURVEYOR CERTIFICATION

I hereby certify that the well location shown on this plat was plotted from field notes of actual surveys made by me or under my supervision, and that the same is true and correct to the best of my knowledge and belief.

1-7-89

Date Surveyed

Neale C. Edwards

Signature of Professional Surveyor

Certificate No. 6857





STATE OF NEW MEXICO  
ENERGY AND MINERALS DEPARTMENT  
OIL CONSERVATION DIVISION  
AZTEC DISTRICT OFFICE

ARREY CARRUTHERS  
GOVERNOR

1000 RIO CHAZOS ROAD  
AZTEC, NEW MEXICO 87410  
(505) 334-6178

Date: 5-16-90

Oil Conservation Division  
P.O. Box 2088  
Santa Fe, NM 87504-2088

Re: Proposed MC \_\_\_\_\_  
Proposed DIIC \_\_\_\_\_  
Proposed NSL X \_\_\_\_\_  
Proposed SWD \_\_\_\_\_  
Proposed WFX \_\_\_\_\_  
Proposed PMX \_\_\_\_\_

Gentlemen:

I have examined the application dated 5-8-90  
for the Altavilla Oil Inc - Greiner #18  
Operator Lease & Well No.

J-13-31W-12W and my recommendations are as follows:  
Unit, S-T-R

Approve  
\_\_\_\_\_  
\_\_\_\_\_  
\_\_\_\_\_  
\_\_\_\_\_

Yours truly,

Emilio Burch

OIL CONSERVATION DIVISION  
RECEIVED  
90 MAY 18 AM 9 09