

MERIDIAN OIL

** ask for clarification
as to why this well
and not the
one at the Standard
location*

OIL CONSERVATION DIVISION
RECEIVED

August 8, 1990

30 AUG 9 AM 11 25

Federal Express

Mr. William LeMay
New Mexico Oil Conservation Division
Post Office Box 2088
Santa Fe, New Mexico 87503

RE: Reese Federal #1
1650'FSL, 1632'FEL
Section 17, T-27-N, R-09-W
San Juan, New Mexico

Dear Mr. LeMay:

This is a request for administrative approval for a non-standard gas well location in the Basin Fruitland Pool.

Meridian Oil intends to plugback and recomplete the Reese Federal #1 well from the Pictured Cliffs pool to the Basin Fruitland Coal Pool. The current location of this well is 1650'FSL, 1632'FEL, Section 17, T-27-N, R-09-W, San Juan, New Mexico. The well is considered non-standard due to the NE-SW dedicated pattern established for the Basin Fruitland Coal Pool. To comply with the New Mexico Oil Conservation Division rules, Meridian is submitting the following for your approval of this non-standard location:

1. C-102 plat showing location of the well;
2. Plat showing offset owners/operators;
3. Copy of Well Completion Log for original completion.

All surrounding lands are operated in the Fruitland coal formation by Meridian Oil Inc.

Sincerely yours,



Peggy Bradfield
encl.

E. Bosch

Submit to Appropriate
District Office
State Lease - 4 copies
Fee Lease - 3 copies

State of New Mexico
Energy, Minerals and Natural Resources Department

Form C-102
Revised 1-1-89

OIL CONSERVATION DIVISION

P.O. Box 2088
Santa Fe, New Mexico 87504-2088

DISTRICT I
P.O. Box 1980, Hobbs, NM 88240

DISTRICT II
P.O. Drawer DD, Artesia, NM 88210

DISTRICT III
1000 Rio Brazos Rd., Aztec, NM 87410

WELL LOCATION AND ACREAGE DEDICATION PLAT

All Distances must be from the outer boundaries of the section

Operator Meridian Oil Inc.		Lease (NM-011393) Reese Federal		Well No. 1
Unit Letter J	Section 17	Township 27 North	Range 9 West	County San Juan
Actual Footage Location of Well: 1650 feet from the South line and 1632 feet from the East line				
Ground level Elev. 6357'	Producing Formation Fruitland Coal		Pool Basin	Dedicated Acreage: 320 Acres

1. Outline the acreage dedicated to the subject well by colored pencil or hatchure marks on the plat below.
2. If more than one lease is dedicated to the well, outline each and identify the ownership thereof (both as to working interest and royalty).
3. If more than one lease of different ownership is dedicated to the well, have the interest of all owners been consolidated by communitization, unitization, force-pooling, etc.?
☐ Yes ☐ No If answer is "yes" type of consolidation _____
If answer is "no" list the owners and tract descriptions which have actually been consolidated. (Use reverse side of this form if necessary.)
No allowable will be assigned to the well until all interests have been consolidated (by communitization, unitization, forced-pooling, or otherwise) or until a non-standard unit, eliminating such interest, has been approved by the Division.

Not resurveyed. Taken
from plat by E.S.Oberly
dated 2-24-56

Meridian Oil Inc.

Proposed

Cleveland Well

No. 221

790' EWL

1485' EWL

Spud: 11/30/55

Basin Fruitland

Coal Gas

E/L dedication

Meridian Oil Inc.

Cleveland Well No. 1

795' EWL - 1134' EWL

Spud: 4/30/55

Fulcher Note

Pictured Cliffs

Completion

Mohil Producing Tr. & M.

Inc.

Huerfano Unit Well

No. 8

1190' EWL + E/L

Spud: 11/13/66

Basin Dakota Comp.

OPERATOR CERTIFICATION

I hereby certify that the information
contained herein is true and complete to the
best of my knowledge and belief.

Signature

Peggy Bradfield

Printed Name

Regulatory Affairs

Position

Meridian Oil Inc.

Company

Date

SURVEYOR CERTIFICATION

I hereby certify that the well location shown
on this plat was plotted from field notes of
actual surveys made by me or under my
supervision, and that the same is true and
correct to the best of my knowledge and
belief. 8-2-90

Date Surveyed

Signature of
Professional Surveyor



Certificate

Neale G. Edwards

0 330 660 990 1320 1650 1980 2310 2640 2000 1500 1000 500 0

MERIDIAN OIL INC

Well Name Reese Federal #1

Footage 1650' FSL; 1650' FEL

APPLICATION FOR NON-STANDARD LOCATION

County San Juan State New Mexico Section 21 Township 27N Range 9W

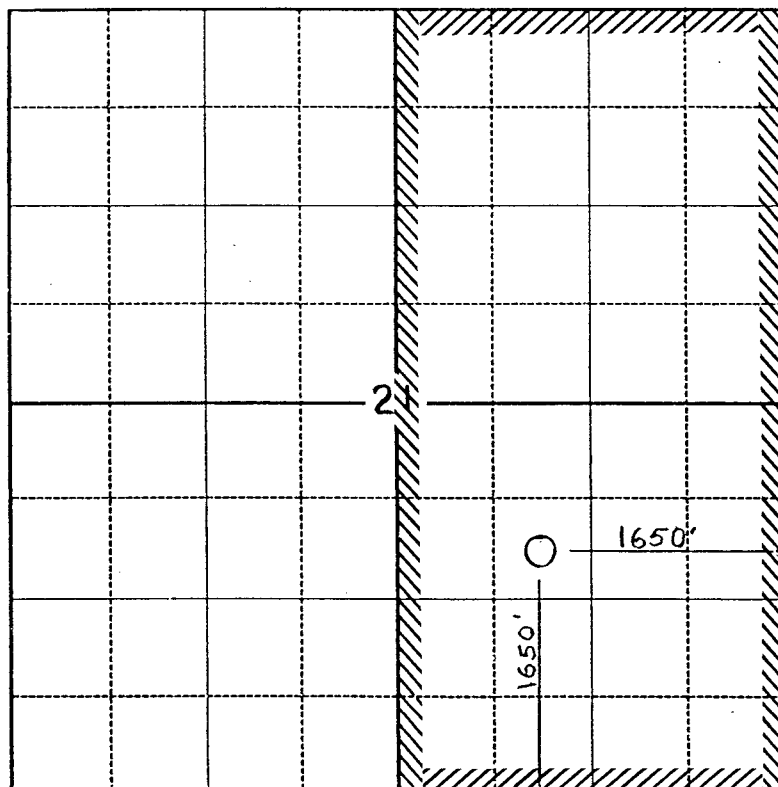

Remarks All surrounding lands are operated in the Fruitland coal
formation by Meridian Oil Inc.

U. S. LAND OFFICE New MexicoSERIAL NUMBER 011393

LEASE OR PERMIT TO PROSPECT

C O P Y

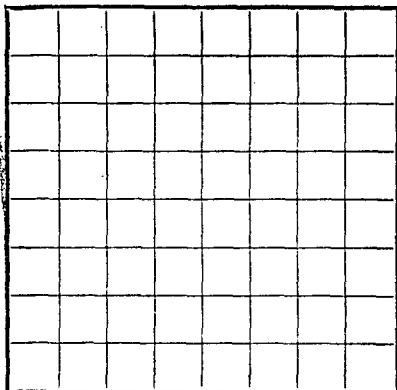

LOCATE WELL CORRECTLY

UNITED STATES
DEPARTMENT OF THE INTERIOR
GEOLOGICAL SURVEY

LOG OF OIL OR GAS WELL

Company Magnolia Petroleum Co. Address Box 633, Midland, Texas
 Lessor or Tract Reese-Federal Field Fulcher Kutz State New Mexico
 Well No. 1 Sec. 17 T. 27N R. 9W Meridian NMPM County San Juan
 Location 1650 ft. N. of S. Line and 1632 ft. W. of E. Line of Section 17 Elevation 6367
(Derrick floor relative to sea level)

The information given herewith is a complete and correct record of the well and all work done thereon so far as can be determined from all available records.

Signed (s) C. Beeson NealDate 3-31-53Title Agent in Farmington

The summary on this page is for the condition of the well at above date.

Commenced drilling 1-28-53, 19..... Finished drilling 2-18-53, 19.....

OIL OR GAS SANDS OR ZONES

(Denote gas by G)

No. 1, from 2260 G to 2315 G No. 4, from to
 No. 2, from to No. 5, from to
 No. 3, from to No. 6, from to

IMPORTANT WATER SANDS

No. 1, from Hauled water to location. No. 3, from to
 No. 2, from to No. 4, from to

CASING RECORD

Size casing	Weight per foot	Threads per inch	Make	Amount	Kind of shoe	Cut and pulled from	Perforated		Purpose
							From—	To—	
10 3/4"	25.75	8 VT	SBC	212	Howco				
6 5/8"	19.50	8 RT	Howco	2262	Howco				

MUDDING AND CEMENTING RECORD

Size casing	Where set	Number sacks of cement	Method used	Mud gravity	Amount of mud used
10 3/4"	212	150	Pump & Plug		
6 5/8"	2262	100	Pump & Plug		

MERIDIAN OIL

OIL CONSERVATION DIVISION
RECEIVED

'90 AUG 9 AM 11 25
August 8, 1990

Federal Express

Mr. William LeMay
New Mexico Oil Conservation Division
Post Office Box 2088
Santa Fe, New Mexico 87503

RE: Reese Federal #1
1650'FSL, 1632'FEL
Section 17, T-27-N, R-09-W
San Juan, New Mexico

Dear Mr. LeMay:

This is a request for administrative approval for a non-standard gas well location in the Basin Fruitland Pool.

Meridian Oil intends to plugback and recomplete the Reese Federal #1 well from the Pictured Cliffs pool to the Basin Fruitland Coal Pool. The current location of this well is 1650'FSL, 1632'FEL, Section 17, T-27-N, R-09-W, San Juan, New Mexico. The well is considered non-standard due to the NE-SW dedicated pattern established for the Basin Fruitland Coal Pool. To comply with the New Mexico Oil Conservation Division rules, Meridian is submitting the following for your approval of this non-standard location:

1. C-102 plat showing location of the well;
2. Plat showing offset owners/operators;
3. Copy of Well Completion Log for original completion.

All surrounding lands are operated in the Fruitland coal formation by Meridian Oil Inc.

Sincerely yours,



Peggy Bradfield
encl.

Submit to Appropriate
District Office
State Leases - 4 copies
Fee Leases - 3 copies

State of New Mexico
Energy, Minerals and Natural Resources Department

Form C-102
Revised 1-1-89

OIL CONSERVATION DIVISION

P.O. Box 2088

Santa Fe, New Mexico 87504-2088

DISTRICT I

P.O. Box 1980, Hobbs, NM 88240

DISTRICT II

P.O. Drawer DD, Artesia, NM 88210

DISTRICT III

1000 Rio Brazos Rd., Aztec, NM 87410

WELL LOCATION AND ACREAGE DEDICATION PLAT

All Distances must be from the outer boundaries of the section

Operator Meridian Oil Inc.			Lease Reese Federal (NM-011393)		Well No. 1
Unit Letter J	Section 17	Township 27 North	Range 9 West	County San Juan	
Actual Footage Location of Well: 1650 feet from the South line and 1632 feet from the East line					
Ground level Elev. 6357'	Producing Formation Fruitland Coal		Pool Basin		Dedicated Acreage: 320 Acres

1. Outline the acreage dedicated to the subject well by colored pencil or hatchure marks on the plat below.
2. If more than one lease is dedicated to the well, outline each and identify the ownership thereof (both as to working interest and royalty).
3. If more than one lease of different ownership is dedicated to the well, have the interest of all owners been consolidated by communitization, unitization, force-pooling, etc.?

☐ Yes ☐ No If answer is "yes" type of consolidation

If answer is "no" list the owners and tract descriptions which have actually been consolidated. (Use reverse side of this form if necessary.)

No allowable will be assigned to the well until all interests have been consolidated (by communitization, unitization, forced-pooling, or otherwise) or until a non-standard unit, eliminating such interest, has been approved by the Division.

Not resurveyed. Taken
from plat by E.S.Oberly
dated 2-24-56

OPERATOR CERTIFICATION

I hereby certify that the information contained herein is true and complete to the best of my knowledge and belief.

Signature

Peggy Bradfield

Printed Name

Regulatory Affairs

Position

Meridian Oil Inc.

Company

Date

SURVEYOR CERTIFICATION

I hereby certify that the well location shown on this plat was plotted from field notes or actual surveys made by me or under my supervision, and that the same is true and correct to the best of my knowledge and belief. 8-2-90

Date Surveyed

Signature
Professional Surveyor

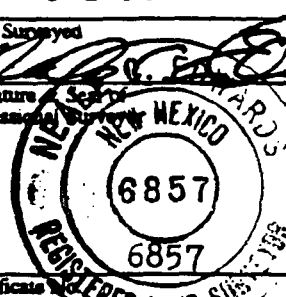

Certificate No.

Neale G. Edwards

0 330 660 990 1320 1650 1980 2310 2640 2000 1500 1000 500 0

MERIDIAN OIL INC

Well Name Reese Federal #1

Footage 1650' FSL; 1650' FEL

APPLICATION FOR NON-STANDARD LOCATION

County San Juan State New Mexico Section 21 Township 27N Range 9W

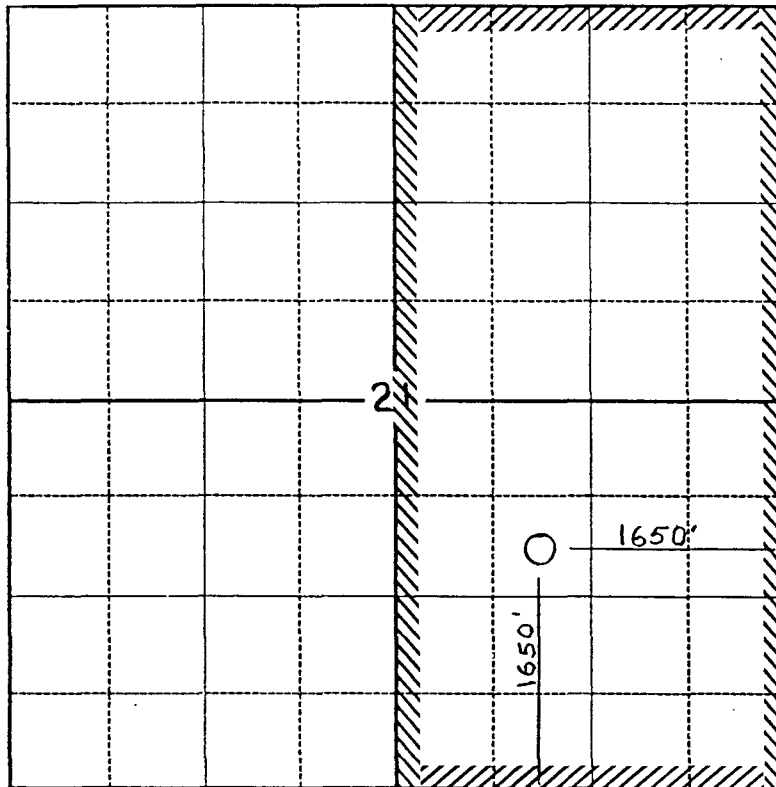

Remarks All surrounding lands are operated in the Fruitland coal
formation by Meridian Oil Inc.

C O P Y

U. S. LAND OFFICE New Mexico

SERIAL NUMBER 011393

LEASE OR PERMIT TO PROSPECT

UNITED STATES
DEPARTMENT OF THE INTERIOR
GEOLOGICAL SURVEY

LOG OF OIL OR GAS WELL

LOCATE WELL CORRECTLY

Company Magnolia Petroleum Co. Address Box 633, Midland, Texas
 Lessor or Tract Reese-Federal Field Fulcher Kutz State New Mexico
 Well No. 1 Sec. 17 T. 27N R. 9W Meridian NMPM County San Juan
 Location 1650 ft. N. of S. Line and 1632 ft. Box of E. Line of Section 17 Elevation 6367
(Derrick floor relative to sea level)

The information given herewith is a complete and correct record of the well and all work done thereon so far as can be determined from all available records.

Signed _____ (s) C. Beeson Neal

Date 3-31-53 Title Agent in Farmington

The summary on this page is for the condition of the well at above date.

Commenced drilling 1-28-53 1953 Finished drilling 2-18-53 1953

OIL OR GAS SANDS OR ZONES

(Denote gas by G)

No. 1, from 2260 G to 2315 G No. 4, from _____ to _____
 No. 2, from _____ to _____ No. 5, from _____ to _____
 No. 3, from _____ to _____ No. 6, from _____ to _____

IMPORTANT WATER SANDS

No. 1, from _____ to _____

No. 2, from _____ to _____

No. 3, from _____ to _____

No. 4, from _____ to _____

CASING RECORD

Size casing	Weight per foot	Threads per inch	Make	Amount	Kind of shoe	Cut and pulled from	Perforated		Purpose
							From—	To—	
10 3/4"	25.75	8 VT	SBC	212	Howco				
6 1/2" (8)	19.50	8 RT	HOWCO	2262	Howco				
<p>It is of the highest importance to have a complete history of the well. It is of the highest importance to have a complete history of the well. It is of the highest importance to have a complete history of the well.</p>									
<p>HISTORY OF OIL OR GAS WELL</p>									

MUDDING AND CEMENTING RECORD

Size casing	Where set	Number sacks of cement	Method used	Mud gravity	Amount of mud used
10 3/4	212	150	Pump & Plug		
6 5/8	2262	100	Pump & Plug		

MARK