

MERIDIAN OIL

OIL CONSERVATION DIVISION
RECEIVED

August 8, 1990

'90 AUG 9 AM 11 25

Federal Express

Mr. William LeMay
New Mexico Oil Conservation Division
Post Office Box 2088
Santa Fe, New Mexico 87503

RE: Huerfano Unit #253 NP
1050'FSL, 1090'FEL
Section 11, T-26-N, R-10-W
San Juan, New Mexico

Dear Mr. LeMay:

This is a request for administrative approval for a non-standard gas well location in the Basin Fruitland Pool.

Meridian Oil intends to plugback and recomplete the Huerfano Unit #253 NP well from the Pictured Cliffs pool to the Basin Fruitland Coal Pool. The current location of this well is 1050'FSL, 1090'FEL, Section 11, T-26-N, R-10-W, San Juan, New Mexico. The well is considered non-standard due to the NE-SW dedicated pattern established for the Basin Fruitland Coal Pool. To comply with the New Mexico Oil Conservation Division rules, Meridian is submitting the following for your approval of this non-standard location:

1. C-102 plat showing location of the well;
2. Plat showing offset owners/operators;
3. Copy of Well Completion Log for original completion.

All surrounding lands are located within the Huerfano Unit boundaries - El Paso Natural Gas Co. is the operator.

Sincerely yours,



Peggy Bradfield
encl.

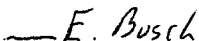

EL PASO NATURAL GAS COMPANY

Well Name Huerfano Unit #253 NP

Footage 1050 FSL; 1090' FEL

APPLICATION FOR NON-STANDARD LOCATION

County San Juan State New Mexico Section 11 Township 26N Range 10W

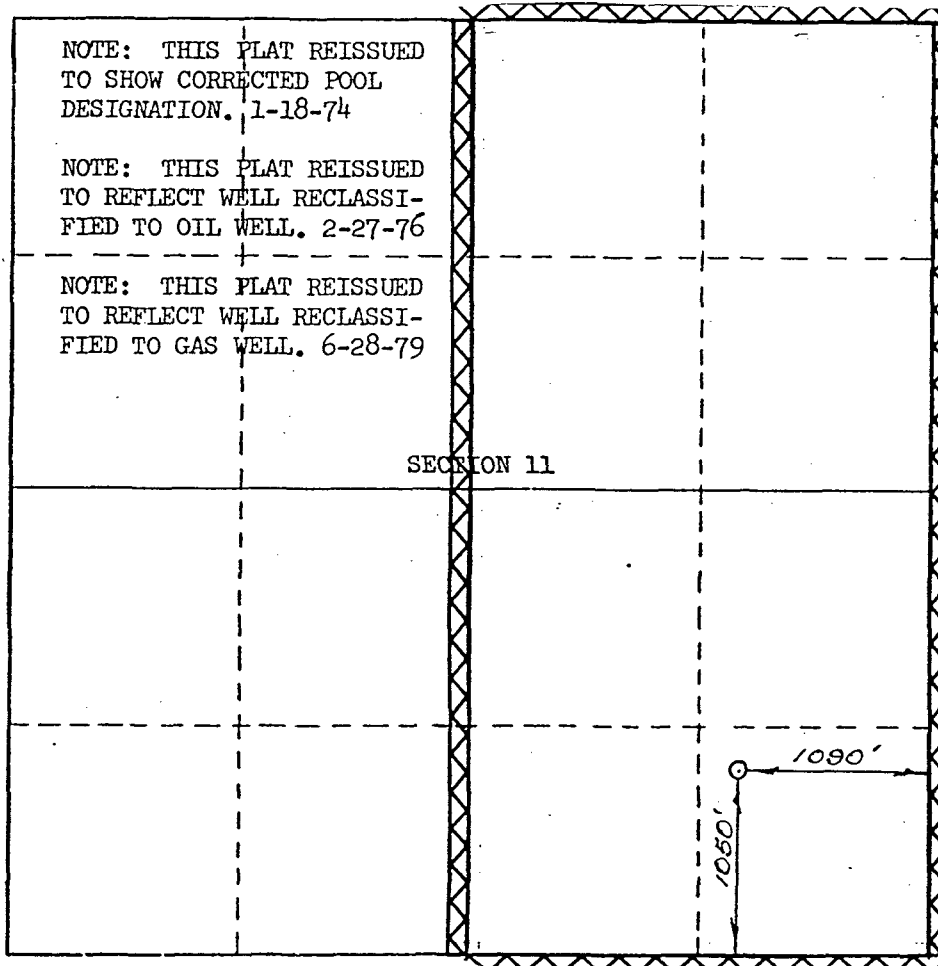

*Standard
640 acre
Section*

Remarks All surrounding lands are located within the Huerfano
Unit Boundries
El Paso Natural Gas Co., Operator

**NEW MEXICO OIL CONSERVATION COMMISSION
WELL LOCATION AND ACREAGE DEDICATION PLAT**

Form C-102
Supersedes C-128
Effective 1-1-65

All distances must be from the outer boundaries of the Section.

Operator EL PASO NATURAL GAS COMPANY			Lease HUERFANO UNIT (NM-01365)		Well No. 253 NP
Unit Letter P	Section 11	Township 26-N	Range 10-W	County SAN JUAN	
Actual Footage Location of Well: <div style="display: flex; justify-content: space-between;"> 1050 feet from the SOUTH line and 1090 feet from the EAST line </div>					
Ground Level Elev. 6648	Producing Formation Fruitland Coal		Pool Basin	Dedicated Acreage: 320.00 Acres	

1. Outline the acreage dedicated to the subject well by colored pencil or hachure marks on the plat below.
2. If more than one lease is dedicated to the well, outline each and identify the ownership thereof (both as to working interest and royalty).
3. If more than one lease of different ownership is dedicated to the well, have the interests of all owners been consolidated by communitization, unitization, force-pooling, etc?

☒ Yes ☐ No If answer is "yes," type of consolidation Unitization

If answer is "no," list the owners and tract descriptions which have actually been consolidated. (Use reverse side of this form if necessary.) _____

No allowable will be assigned to the well until all interests have been consolidated (by communitization, unitization, forced-pooling, or otherwise) or until a non-standard unit, eliminating such interests, has been approved by the Commission.

NOTE: THIS PLAT REISSUED
TO SHOW CORRECTED POOL
DESIGNATION. 1-18-74

NOTE: THIS PLAT REISSUED
TO REFLECT WELL RECLASSI-
FIED TO OIL WELL. 2-27-76

NOTE: THIS PLAT REISSUED
TO REFLECT WELL RECLASSI-
FIED TO GAS WELL. 6-28-79

SECTION 11

CERTIFICATION

I hereby certify that the information con-
tained herein is true and complete to the
best of my knowledge and belief.

Name

Peggy Bradfield

Position

Regulatory Affairs

Company

El Paso Natural Gas

Date

8-2-90

I hereby certify that the well location
shown on this plat was plotted from field
notes of actual surveys made by me or
under my supervision, and that the same
is true and correct to the best of my
knowledge and belief.

Date Surveyed

DECEMBER 18, 1973

Registered Professional Engineer
and/or Land Surveyor

**ORIGINAL SIGNED BY:
DAVID O. VILVEN**

Certificate No.

1760

0 330 660 990 1320 1650 1980 2310 2640 2970 3300 3630 3960 4290 4620 4950 5280 5610 5940 6270 6600 6930 7260 7590 7920 8250 8580 8910 9240 9570 9900

UNITED STATES DEPARTMENT OF THE INTERIOR
GEOLOGICAL SURVEY

(See other instructions on reverse side)

Form approved
Budget Bureau No. 47-14355-5

3. LEASE DESIGNATION AND SERIAL NO.

NM01565
4. IF INDIAN, ALLOTTEE OR TRIBE NAME

7. UNIT AGREEMENT NAME

Huerfano Unit

8. FARM OR LEASE NAME

Huerfano Unit

9. WELL NO.

253

10. FIELD AND POOL, OR WILDCAT

Angel Peak Gallup

11. SEC., T., R., M., OR BLOCK AND SURVEY OR AREA

Sec. 11, T-26-N, R-10-W
N.M.P.M.

12. COUNTY OR PARISH

San Juan

13. STATE

New Mexico

WELL COMPLETION OR RECOMPLETION REPORT AND LOG *

1a. TYPE OF WELL: OIL WELL ☐ GAS WELL ☒ DRY ☐ Other _____

b. TYPE OF COMPLETION: NEW WELL ☒ WORK OVER ☐ DEEP-EN ☐ PLUG BACK ☐ DIFF. RENVR. ☐ Other _____

2. NAME OF OPERATOR

El Paso Natural Gas Company

3. ADDRESS OF OPERATOR

P. O. Box 990, Farmington, NM 87401

4. LOCATION OF WELL (Report location clearly and in accordance with any State requirements)*

At surface 1050'S, 1090'E

At top prod. interval reported below

At total depth

14. PERMIT NO. DATE ISSUED

15. DATE SPUDDED 16. DATE T.D. REACHED 17. DATE COMPL. (Ready to prod.)

02-07-74 03-01-74 11-15-74

18. ELEVATIONS (DF, RKB, RT, GR, ETC.)*

6648' GL

20. TOTAL DEPTH, MD & TVD 21. PLUG, BACK T.D., MD & TVD 22. IF MULTIPLE COMPL., HOW MANY*

6178' 6153'

24. PRODUCING INTERVAL(S), OF THIS COMPLETION—TOP, BOTTOM, NAME (MD AND TVD)*

5836-6108' (GL)

26. TYPE ELECTRIC AND OTHER LOGS RUN

IEL; CDL-GR; Temp. Survey

28. CASING RECORD (Report all strings set in well)

CASING SIZE	WEIGHT, LB./FT.	DEPTH SET (MD)	HOLE SIZE	CEMENTING RECORD	AMOUNT PULLED
8 5/8"	24#	208' GL	12 1/4"	183 cu. ft.	
4 1/2"	10.5#	6178'	7 7/8"	1036 cu. ft.	

29. LINER RECORD

SIZE	TOP (MD)	BOTTOM (MD)	SACKS CEMENT*	SCREEN (MD)

31. PERFORATION RECORD (Interval, size and number)

5836', 5870', 5906', 5944', 6004', 6024', 6042', 6064', 6098', 6108' with 1 shot per zone.

32. ACID, SHOT, FRACTURE, CEMENT SQUEEZE, ETC.

DEPTH INTERVAL (MD) AMOUNT AND KIND OF MATERIAL USED

5836-6108' 110,000# sand, 112,560 gal wtr

33. PRODUCTION

DATE FIRST PRODUCTION PRODUCTION METHOD (Flowing, gas lift, pumping—size and type of pump)

Flowing

DATE OF TEST HOURS TESTED CHOKER SIZE PROD'N. FOR TEST PERIOD

11-15-74 3 hours 3/4" variable 13.5

FLOW. TUBING PRESS. CASING PRESSURE CALCULATED 24-HOUR RATE

SI 467 SI 572 161 MCF/D AOF

34. DISPOSITION OF GAS (Sold, used for fuel, vented, etc.)

TEST WITNESSED BY

Goodwin and Johnson

35. LIST OF ATTACHMENTS

36. I hereby certify that the foregoing and attached information is complete and correct as determined from all available records

SIGNED A. D. Duico TITLE Drilling Clerk

DATE 2 November 27, 1974

*(See Instructions and Spaces for Additional Data on Reverse Side)

S. GEOLOGICAL SURVEY
FARMINGTON, N. M.