



Chevron U.S.A. Inc.  
P.O. Box 1150, Midland, TX 79702

OIL DIVISION

Rec'd 10/29/90

Relined to  
12/17/90

OCT 23 1990  
October 23, 1990

NOTE: 12/17/90

Case 10153

See Case No. 10153  
for additional  
data for this  
matter.

ADMINISTRATIVE APPLICATION FOR  
NON-STANDARD PRORATION UNIT,  
UNORTHODOX GAS WELL LOCATION  
AND SIMULTANEOUS DEDICATION  
EUMONT YATES 7 RVRS QN (PRO GAS)  
1880' FSL AND 1980' FEL  
SECTION 29, T-20-S, R-37-E, NMPM  
LEA COUNTY, NEW MEXICO

M.S.

State Of New Mexico  
Energy, Minerals & Natural Resources Dept.  
Oil Conservation Division  
P. O. Box 2088  
Santa Fe, New Mexico 87504

Attention: Mr. William J. LeMay - Director

Gentlemen:

Chevron U.S.A. Inc. respectfully requests your approval of our administrative application for the subject Non-Standard Proration Unit, Unorthodox Gas Well Location and Simultaneous Dedication.

We are currently planning to drill the A. B. Reeves Well No. 4, and complete this well in the Eumont Yates 7 Rvrs Qn (Pro Gas) Pool. This well will be located 1880 feet FSL and 1980 feet FEL of Section 29, T-20-S, R-37-E, Lea County, New Mexico. This location will be within an existing 160-acre Eumont Gas Proration Unit currently dedicated to Chevron's existing A. B. Reeves Well No. 3 (NSP Order-1408). This location was chosen to avoid pipelines in the area and will be unorthodox in that it is less than 660 feet from the outer side boundary.

Chevron also desires to consolidate this 160-acre proration unit with the 160-acre proration unit currently dedicated to our A. B. Reeves Well Nos. 1 & 2 (S/2 NW/4 and N/2 SW/4, Section 29) to make a 320-acre proration

unit. This proposed 320-acre unit would comprise the S/2 N/2 and N/2 S/2 of Section 29 and be simultaneously dedicated to all four A. B. Reeves wells.

Please note that this same 320-acres was at one time (December 1, 1971) dedicated to A. B. Reeves Well Nos. 1 and 2 by Order No. R-4224. In 1983 when Well No. 3 was drilled and completed as a Eumont Gas well, the proration unit size for Well Nos. 1 and 2 was reduced to 160-acres comprising the N/2 SW/4 and S/2 NW/4 of Section 29. This left the remaining 160-acres comprising the S/2 NE/4 and N/2 SE/4 of Section 29 for dedication to Well No. 3. We now desire to re-consolidate the two 160-acre units to make one 320-acre unit and simultaneously dedicate all four wells.

In order to prevent waste, Chevron respectfully requests your approval of this administrative application under the provisions of Rule 104 (F). Attached are a map showing offset operators and a Form C-102. A copy of this letter with attachments are being furnished to the Offset Operators by Certified Mail, as their notice of this application.

Yours very truly,

*Alan W. Bohling*

A. W. BOHLING

awb  
Attachments  
Enclosures

cc: NMOCD - Hobbs

**CHEVRON U.S.A. INC.**  
**A. B. Reeves Lease**

Application For Non-Standard  
Proration Unit, Unorthodox  
Gas Well Location  
and  
Simultaneous Dedication of Acreage  
Eumont Yates 7 Rvrs Qn (Pro Gas)  
1880' FSL and 1980' FEL  
Section 29, T20S, R37E  
Lea County, New Mexico

**OFFSET OPERATORS**

Amerada Hess Corp.  
Entex Bldg.  
1200 Milam Street  
Houston, Texas 77002

Amoco Producing Co.  
P.O. Box 3092  
Houston, Texas 77253

ARCO Oil and Gas Co.  
P.O. Box 1610  
Midland, Texas 79702

Greenhill Petroleum Corp.  
16010 Barkers Point Lane  
Suite 325  
Houston, Texas 77079

Exxon Corp., U.S.A.  
P. O. Box 2180  
Houston, Texas 77001

William A. & Edward R. Hudson  
616 Texas Street  
Fort Worth, Texas 76102-4612

Doyle Hartman  
500 N. Main  
Midland, Texas 79702

Meridan Oil Inc.  
2919 Allen Parkway  
Suite 900  
Houston, Texas 77019

John H. Hendrix Corp.  
223 West Wall, Ste. 525  
Midland, Texas 79701

Phillips Petroleum Co.  
4001 Penbrook  
Odessa, Texas 79762

Texaco Producing Co.  
P. O. Box 3109  
Midland, Texas 79702

Oryx Energy Co.  
P. O. Box 1861  
Midland, Texas 79702

**CHEVRON U.S.A. INC.**  
**A. B. Reeves Lease**

Application For Non-Standard  
 Proration Unit, Unorthodox  
 Gas Well Location  
 and  
 Simultaneous Dedication of Acreage  
 Eumont Yates 7 Rvrs Qn (Pro Gas)  
 1880' FSL and 1980' FEL  
 Section 29, T20S, R37E  
 Lea County, New Mexico

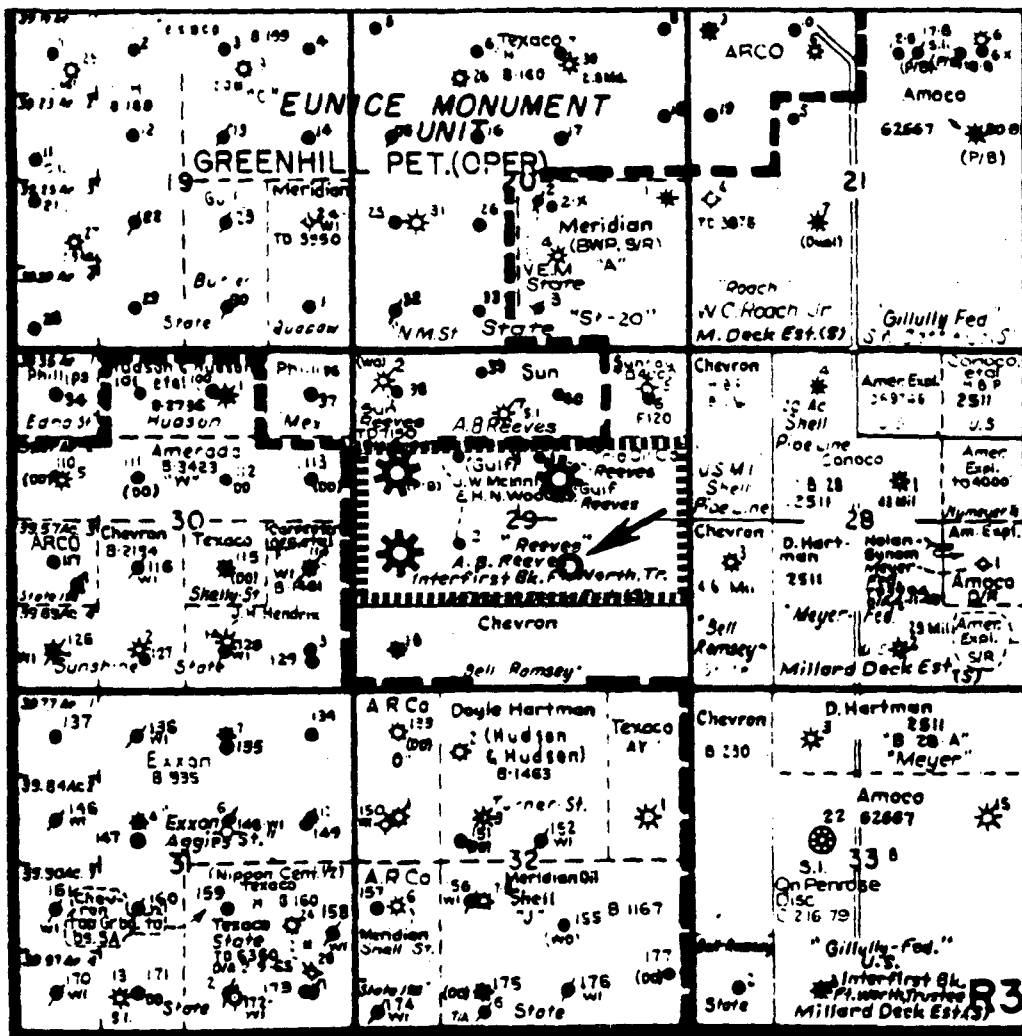

# OIL CONSERVATION DIVISION

**P.O. Box 2088**

**Santa Fe, New Mexico 87504-2088**

## DISTRICT I

P.O. Box 1900, Hobbs, NM 88240

## DISTRICT II

P.O. Drawer DD, Artesia, NM 88210

## DISTRICT II

**1000 Rio Bonito Rd., Aztec, NM 87410**

**WELL LOCATION AND ACREAGE DEDICATION PLAT**

**All Distances must be from the outer boundaries of the section**

Operator CHEVRON USA INC.		Lease A. B. Reeves		Well No. 4
Unit Letter J	Section 29	Township 20 South	Range 37 East NMFM	County Lea
Actual Footage Location of Well: 1880 feet from the South line and 1980 feet from the East line				
Ground level Elev. 3519.9	Producing Formation Queen/Penrose	Pool Eumont Gas	Dedicated Acreage: 320 Acres	

1. Outline the acreage dedicated to the subject well by colored pencil or hatchure marks on the plat below.
2. If more than one lease is dedicated to the well, outline each and identify the ownership thereof (both as to working interest and royalty).
3. If more than one lease of different ownership is dedicated to the well, have the interest of all owners been consolidated by communitization, unitization, force-pooling, etc.?
- ☐ Yes ☐ No If answer is "yes" type of consolidation \_\_\_\_\_

If answer is "no" list the owners and tract descriptions which have actually been consolidated. (Use reverse side of this form if necessary.)

No allowable will be assigned to the well until all interests have been consolidated (by communitization, unitization, forced-pooling, or otherwise) or until a non-standard unit, eliminating such interest, has been approved by the Division.

## OPERATOR CERTIFICATION

I hereby certify that the information contained herein is true and complete to the best of my knowledge and belief.

**Signature**

E.O. Doherty  
Printed Name

Printed Name \_\_\_\_\_

T.A. Delg

**Position**

CHEURON U.S.A. Inc  
Company

**D**

10/1/90

### SURVEYOR CERTIFICATION

I hereby certify that the well location shown on this plat was plotted from field notes of actual surveys made by me or under my supervision, and that the same is true and correct to the best of my knowledge and belief.

**Date Surveyed**

August 15, 1990

**Signature & Seal of  
Professional Surveyor**

 Certificate No. 12345 JOHN W. WEST  
 THOMAS D. FIDSON

676

3239

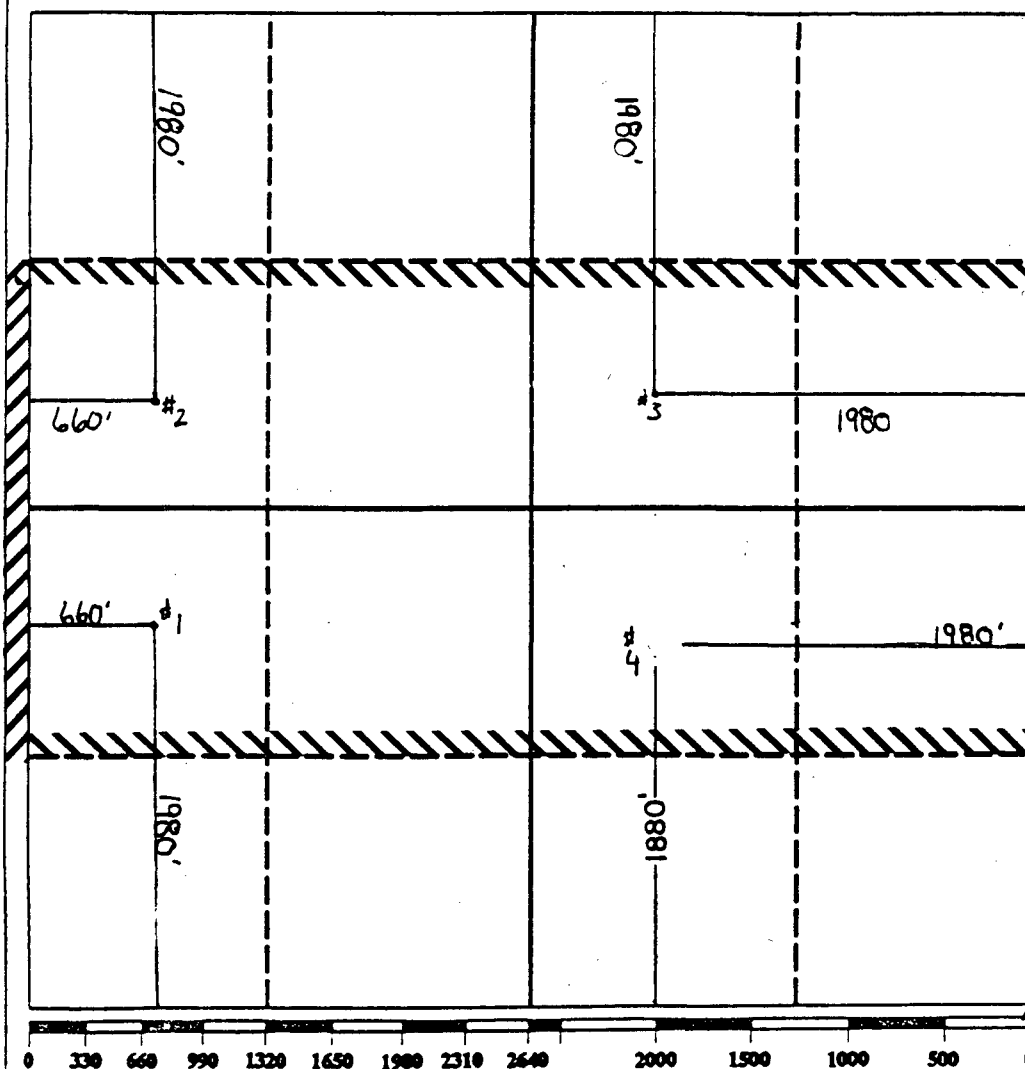
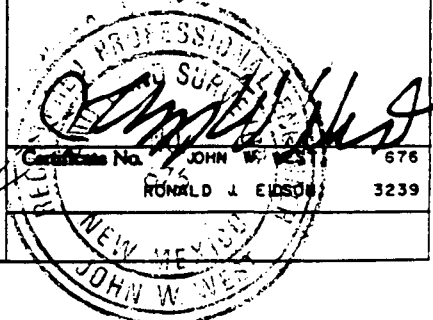

# A.B. REEVES #4



BURIED  
NORTHERN  
PIPELINE

MONUMENT

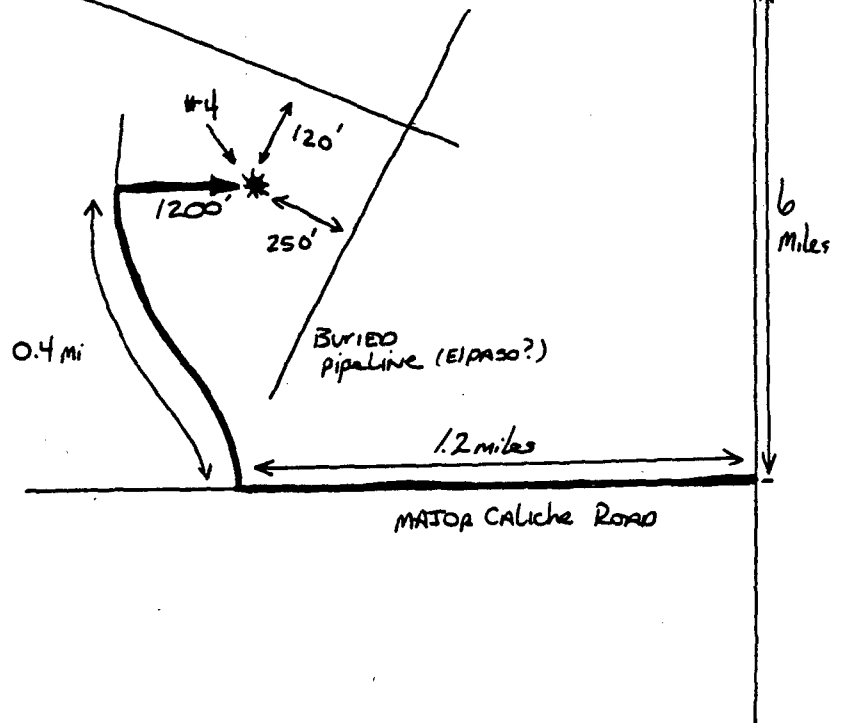

Improve 0.4 mi Road

Need 1200' New Road

V-Door West

Current Location:

1880' FSL, 1980' FEL