

# MERIDIAN OIL

June 5, 1990

*Handled by  
E. Branch  
12/11/90*

Certified Mail

Mr. William LeMay  
New Mexico Oil Conservation Division  
Post Office Box 2088  
Santa Fe, New Mexico 87503

*Case 10021*

RE: Kutz Deep Test #2  
990'FSL, 990'FEL  
Section 28, T-28-N, R-10-W  
San Juan County, New Mexico

Dear Mr. LeMay:

This is a request for administrative approval for a non-standard gas well location in the Basin Fruitland Pool.

Meridian Oil intends to plugback and recomplete the Kutz Deep Test #2 well from the Pictured Cliffs pool to the Basin Fruitland Coal Pool. The current location of this well is 990'FSL, 990'FEL, Section 28, T-28-N, R-10-W, San Juan County, New Mexico. The well is considered non-standard due to the NE-SW dedicated pattern established for the Basin Fruitland Coal Pool. To comply with the New Mexico Oil Conservation Division rules, Meridian is submitting the following for your approval of this non-standard location:

1. C-102 plat showing location of the well;
2. Plat showing offset owners/operators;
3. Affidavit of notification of offset owners/operators;
4. Copy of Well Completion Log for original completion.

A copy of this application is being submitted to all offset owners/operators by certified mail with a request that they furnish your Santa Fe office with a Waiver of Objection, and return one copy to this office.

Sincerely yours,



Peggy Bradfield  
encl.

## WAIVER

\_\_\_\_\_ hereby waives objection to Meridian Oil Inc.'s application for a non-standard location for their Kutz Deep Test #2 as proposed above.

By: \_\_\_\_\_ Date: \_\_\_\_\_

xc: Southland Royalty Company  
Amoco Production Company  
Breck Operating Company

Kutz Deep Test #2  
990'FSL, 990'FEL  
Section 28, T-28-N, R-10-W  
San Juan County, New Mexico

I hereby certify that the following offset owners/operators have been mailed notification of our application for administrative approval for non-standard gas well location for the plugback and recompletion of the above well.

Southland Royalty Company  
P.O. Box 4289  
Farmington, NM 87499

Amoco Production Company  
P.O. Box 800  
Denver, CO 80201

Breck Operating Company  
P.O. Box 911  
Breckenridge, TX 76024-0911



Peggy Bradfield  
June 5, 1990

San Juan County  
State of New Mexico

My commission expires August 17, 1992

Submit to Appropriate  
District Office  
State Lease - 4 copies  
Fee Lease - 3 copies

State of New Mexico  
Energy, Minerals and Natural Resources Department

Form C-102  
Revised 1-1-89

OIL CONSERVATION DIVISION

P.O. Box 2088

Santa Fe, New Mexico 87504-2088

DISTRICT I

P.O. Box 1980, Hobbs, NM 88240

DISTRICT II

P.O. Drawer DD, Artesia, NM 88210

DISTRICT III

1000 Rio Brazos Rd., Aztec, NM 87410

WELL LOCATION AND ACREAGE DEDICATION PLAT

All Distances must be from the outer boundaries of the section

Operator Meridian Oil Inc.		Lease (SF-077383A) Kutz Deep Test		Well No. 2
Unit Letter P	Section 28	Township 28 North	Range 10 West	County San Juan
Actual Footage Location of Well: 990 feet from the South line and 990 feet from the East line				
Ground level Elev. 5999.7	Producing Formation Fruitland Coal		Pool Basin	Dedicated Acreage: 320 Acres

1. Outline the acreage dedicated to the subject well by colored pencil or hatchure marks on the plat below.

2. If more than one lease is dedicated to the well, outline each and identify the ownership thereof (both as to working interest and royalty).

3. If more than one lease of different ownership is dedicated to the well, have the interest of all owners been consolidated by communitization, unitization, force-pooling, etc.?

☐ Yes

☐ No

If answer is "yes" type of consolidation communitization agreement will be

If answer is "no" list the owners and tract descriptions which have actually been consolidated. (Use reverse side of this form if necessary.)

obtained

No allowable will be assigned to the well until all interests have been consolidated (by communitization, unitization, forced-pooling, or otherwise) or until a non-standard unit, eliminating such interest, has been approved by the Division.

Prepared from a plat  
dated 8-17-51 by  
C. O. Walker.

OPERATOR CERTIFICATION

I hereby certify that the information contained herein is true and complete to the best of my knowledge and belief.

Signature

Peggy Bradfield

Printed Name

Regulatory Affairs

Position

Meridian Oil Inc.

Company

Date

SURVEYOR CERTIFICATION

I hereby certify that the well location shown on this plat was plotted from field notes of actual surveys made by me or under my supervision, and that the same is true and correct to the best of my knowledge and belief. 5-23-90

Date Surveyed

Signature

Professional Surveyor

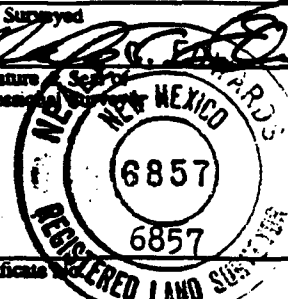

Certificate No.

Neale C. Edwards

0 330 660 990 1320 1650 1980 2310 2640 2000 1500 1000 500 0

MERIDIAN OIL INC.

Well Name Kutz Deep Test #2

Footage---- 990' FSL; 990' FEL

APPLICATION FOR NON-STANDARD PRORATION UNIT

County San Juan State New Mexico Section 28 Township 28N Range 10W

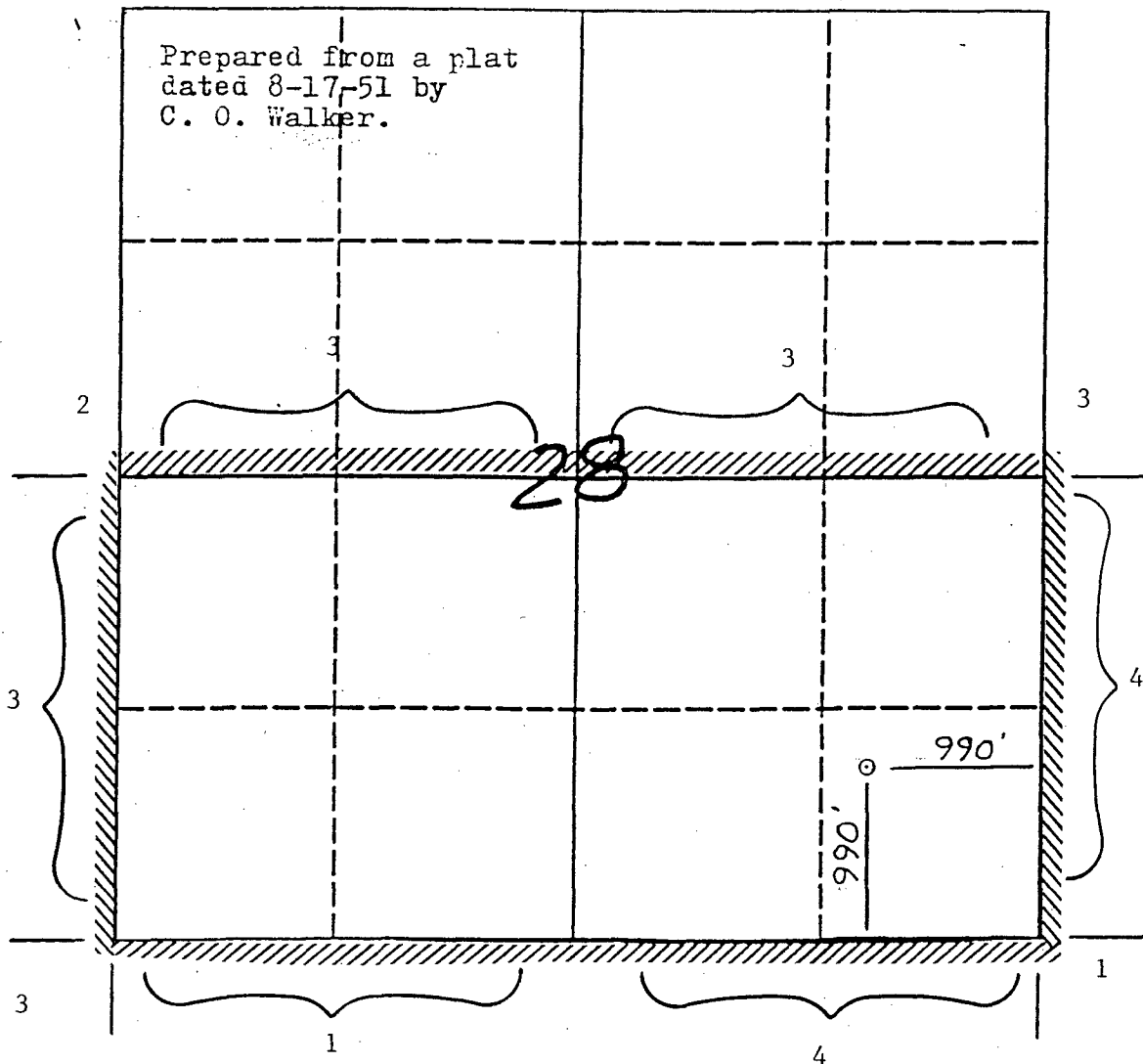

REMARKS: 1) Meridian Oil Inc.  
2) Southland Royalty Company  
3) Amoco Production Company  
4) Breck Operating Company  
PO Box 911  
Breckenridge, TX 76024-0911

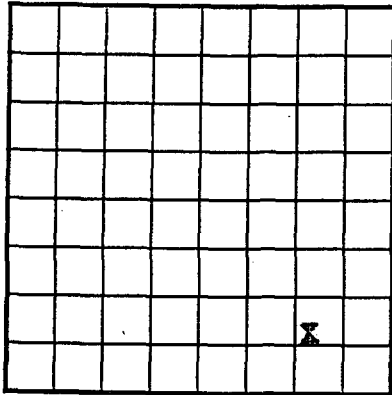
U. S. LAND OFFICE Santa FeSERIAL NUMBER 077383LEASE OR PERMIT TO PROSPECT Kutz Deep  
Test

LOCATE WELL CORRECTLY

**UNITED STATES**  
**DEPARTMENT OF THE INTERIOR**  
**GEOLOGICAL SURVEY**

**LOG OF OIL OR GAS WELL**

Company El Paso Natural Gas Co. Address P.O. Box 997, Farmington, New Mexico  
 Lessor or Tract Kutz Deep Test Field Fulcher-Kutz State New Mexico  
 Well No. 2 Sec. 28 T. 23N R. 10W Meridian NPM County San Juan  
 Location 990 ft. (N.) of 8 Line and 990 ft. (W.) of 2 Line of Sec. 28 Elevation 6995  
(Derrick floor relative to sea level)

The information given herewith is a complete and correct record of the well and all work done thereon so far as can be determined from all available records.

Signed ORIGINAL SIGNED E. J. COEL

Date November 20, 1951Title Petroleum Engineer

The summary on this page is for the condition of the well at above date.

Commenced drilling October 10, 1951 Finished drilling October 30, 1951

**OIL OR GAS SANDS OR ZONES**

(Denote gas by G)

No. 1, from 1977 to 2055 (G) No. 4, from \_\_\_\_\_ to \_\_\_\_\_  
 No. 2, from \_\_\_\_\_ to \_\_\_\_\_ No. 5, from \_\_\_\_\_ to \_\_\_\_\_  
 No. 3, from \_\_\_\_\_ to \_\_\_\_\_ No. 6, from \_\_\_\_\_ to \_\_\_\_\_

**IMPORTANT WATER SANDS**

No. 1, from 585 to 595 No. 3, from \_\_\_\_\_ to \_\_\_\_\_  
 No. 2, from \_\_\_\_\_ to \_\_\_\_\_ No. 4, from \_\_\_\_\_ to \_\_\_\_\_

**CASING RECORD**

Size casing	Weight per foot	Threads per inch	Make	Amount	Kind of shoe	Cut and pulled from	Perforated		Purpose
							From—	To—	
<u>8-5/8</u>	<u>24</u>	<u>8</u>	<u>Natl</u>	<u>129</u>	<u>HWCO</u>	<u>Surface</u>			<u>Surface</u>
<u>5-5/8</u>	<u>14.6</u>	<u>8</u>	<u>Natl</u>	<u>1977</u>	<u>HWCO</u>	<u>Production</u>			<u>Production</u>
<u>1</u>	<u>STD</u>	<u>8</u>	<u>Natl</u>	<u>2050</u>	<u>HWCO</u>	<u>Siphon</u>			<u>Siphon</u>
	<u>BLK</u>								

**MUDDING AND CEMENTING RECORD**

Size casing	Where set	Number sacks of cement	Method used	Mud gravity	Amount of mud used
<u>8-5/8</u>	<u>120</u>	<u>60</u>	<u>Circulated</u>		
<u>5-5/8</u>	<u>1983</u>	<u>150</u>	<u>Single Stage</u>		

**PLUGS AND ADAPTERS**

Heaving plug—Material \_\_\_\_\_ Length \_\_\_\_\_ Depth set \_\_\_\_\_  
 Adapters—Material \_\_\_\_\_ Size \_\_\_\_\_

# MERIDIAN OIL

June 5, 1990

Certified Mail

Mr. William LeMay  
New Mexico Oil Conservation Division  
Post Office Box 2088  
Santa Fe, New Mexico 87503

*Case 10021*

RE: Kutz Deep Test #2  
990'FSL, 990'FEL  
Section 28, T-28-N, R-10-W  
San Juan County, New Mexico

Dear Mr. LeMay:

This is a request for administrative approval for a non-standard gas well location in the Basin Fruitland Pool.

Meridian Oil intends to plugback and recompleate the Kutz Deep Test #2 well from the Pictured Cliffs pool to the Basin Fruitland Coal Pool. The current location of this well is 990'FSL, 990'FEL, Section 28, T-28-N, R-10-W, San Juan County, New Mexico. The well is considered non-standard due to the NE-SW dedicated pattern established for the Basin Fruitland Coal Pool. To comply with the New Mexico Oil Conservation Division rules, Meridian is submitting the following for your approval of this non-standard location:

1. C-102 plat showing location of the well;
2. Plat showing offset owners/operators;
3. Affidavit of notification of offset owners/operators;
4. Copy of Well Completion Log for original completion.

A copy of this application is being submitted to all offset owners/operators by certified mail with a request that they furnish your Santa Fe office with a Waiver of Objection, and return one copy to this office.

Sincerely yours,



Peggy Bradfield  
encl.

## WAIVER

Southland Royalty Company hereby waives objection to Meridian Oil Inc.'s application for a non-standard location for their Kutz Deep Test #2 as proposed above.

By:  Date: 6/6/90

xc: Southland Royalty Company  
Amoco Production Company  
Breck Operating Company

SENT BY: Meridian Oil, Inc. 8-3-90 2:57PM  
AUG-03-1990 15:58 FROM BRECK OPERATING CORP

5053269781- 5059888936: # 4  
TO 15053269781 P.05

## MERIDIAN OIL

June 5, 1990

Certified Mail

Mr. William LeMay  
New Mexico Oil Conservation Division  
Post Office Box 2088  
Santa Fe, New Mexico 87503

RE: Kutz Deep Test #2  
990'FSL, 990'FEL  
Section 28, T-28-N, R-10-W  
San Juan County, New Mexico

Dear Mr. LeMay:

This is a request for administrative approval for a non-standard gas well location in the Basin Fruitland Pool.

Meridian Oil intends to plugback and recomplate the Kutz Deep Test #2 well from the Pictured Cliffs pool to the Basin Fruitland Coal Pool. The current location of this well is 990'FSL, 990'FEL, Section 28, T-28-N, R-10-W, San Juan County, New Mexico. The well is considered non-standard due to the NE-SW dedicated pattern established for the Basin Fruitland Coal Pool. To comply with the New Mexico Oil Conservation Division rules, Meridian is submitting the following for your approval of this non-standard location:

1. C-102 plat showing location of the well;
2. Plat showing offset owners/operators;
3. Affidavit of notification of offset owners/operators;
4. Copy of Well Completion Log for original completion.

A copy of this application is being submitted to all offset owners/operators by certified mail with a request that they furnish your Santa Fe office with a Waiver of Objection, and return one copy to this office.

Sincerely yours,



Peggy Bradfield  
encl.

WAIVER  
Breck Operating Corp., Individually  
and on behalf of B.B.L., Ltd. hereby waives objection to Meridian Oil Inc.'s application for a non-standard location for their Kutz Deep Test #2 as proposed above.

Date: 8-3-90

BRECK OPERATING CORP.

cc: Southland Royalty Company  
Amoco Production Company  
Breck Operating Company

By:   
Fred R. Dueser, President

APPROVED  
AS TO FORM



STATE OF NEW MEXICO  
ENERGY AND MINERALS DEPARTMENT  
OIL CONSERVATION DIVISION  
AZTEC DISTRICT OFFICE

90 JUL 2 AM 10:17

1000 RIO BRAZOS ROAD  
AZTEC, NEW MEXICO 87410  
(505) 334-6178

OIL CONSERVATION DIVISION  
BOX 2088  
SANTA FE, NEW MEXICO 87501

DATE 6-15-90

Case 10021

RE: Proposed MC \_\_\_\_\_  
Proposed DHC \_\_\_\_\_  
Proposed NSL N \_\_\_\_\_  
Proposed SWD \_\_\_\_\_  
Proposed WFX \_\_\_\_\_  
Proposed PMX \_\_\_\_\_

Gentlemen:

I have examined the application dated 6-7-90  
for the Mission Oil Trm. Kutz Deep Test #1  
Operator Lease and Well No. Unit, \_\_\_\_\_

0-21-28N-10W

and my recommendations are as follows:

Approve  
\_\_\_\_\_  
\_\_\_\_\_  
\_\_\_\_\_  
\_\_\_\_\_

Yours truly,

Ernest Burch