

OIL CONSERVATION DIVISION  
RECEIVED



**Chevron**

December 22, 1993  
Midland, Texas

**Chevron U.S.A. Production Company**  
P.O. Box 1150  
Midland, TX 79702

Administrative Application for Simultaneous  
Dedication and Unorthodox Well Location  
Eumont TYS 7RVRS-QN (Pro Gas) Pool  
610' FSL and 660' FEL  
Section 27, T-21-S, R-36-E,  
Lea County, New Mexico

State of New Mexico  
Energy, Minerals & Natural Resources Dept.  
Oil Conservation Division  
P.O. Box 2088  
Santa Fe, New Mexico 87504

Attn: Mr. William J. LeMay - Director

Dear Mr. LeMay:

Chevron U.S.A. is planning to recomplete the **W.A. Ramsay (NCT-A) #29** in the Eumont YTS-7RVRS-QN (Pro Gas) Pool. The well, which is currently completed in the Eumont Oil (Queen) Pool, is located 610' FSL and 660' FEL in Section 27, T-21-S, R-36-E, Lea County, New Mexico.

The subject well is located on an existing, standard 640-acre Eumont gas spacing and proration unit (GPU) which comprises all of Section 27 according to Division Order R-4496, dated March 21, 1973. The same order authorized the simultaneous dedication of the W.A. Ramsay (NCT-A) Nos. 17 and 46. Subsequently, simultaneous dedication to the aforementioned GPU was also granted to the W.A. Ramsay (NCT-A) Nos. 35, 42, and 37 by Administrative Orders NSL-3000(SD), dated April 1, 1991, NSL-3000-A(SD), dated July 24, 1991, and NSL-3000-B (SD), dated May 26, 1993, respectively. We respectfully request that the production from the **W.A. Ramsay (NCT-A) #29** be simultaneously dedicated to the aforementioned GPU with these five wells.

Because the subject well is located less than 1650' from the boundary of the said 640-acre GPU, we also request your approval for an unorthodox well location.

A copy of this administrative application is being provided to our offset operators via Certified Mail. Attached is a commercial map, and Form C-102 Plats for all wells in the GPU. Also included is a copy of Division Order R-4496 and Administrative Orders NSL-3000(SD), NSL-3000-A(SD), and NSL - 3000-B(SD), as well as copies of the letters to our offset operators.

Eumont TYS-7RVRS-QN  
(Pro Gas) Pool  
Lea County, New Mexico

-2-

December 22, 1993

If you have any questions, or if you require further information, please contact Richard Black at (915) 687-7284.

Sincerely,

A handwritten signature in black ink, appearing to read "F. S. Godbold", written over the typed name.

F. S. Godbold  
Petroleum Engineering Supervisor  
New Mexico Area

REB/tmdr  
11364.DOC

Attachments

cc: NMOCD - Hobbs, New Mexico

CHEVRON U.S.A. INC.  
W.A. Ramsay (NCT-A) Lease  
Well No. 29

Administrative Application for  
Simultaneous Dedication and  
Unorthodox Well Location  
Eumont YTS-7RVRS-QN  
(Pro Gas) Pool  
610' FSL and 660' FEL  
Section 27, T-21-S, R-36-E  
Lea County, New Mexico

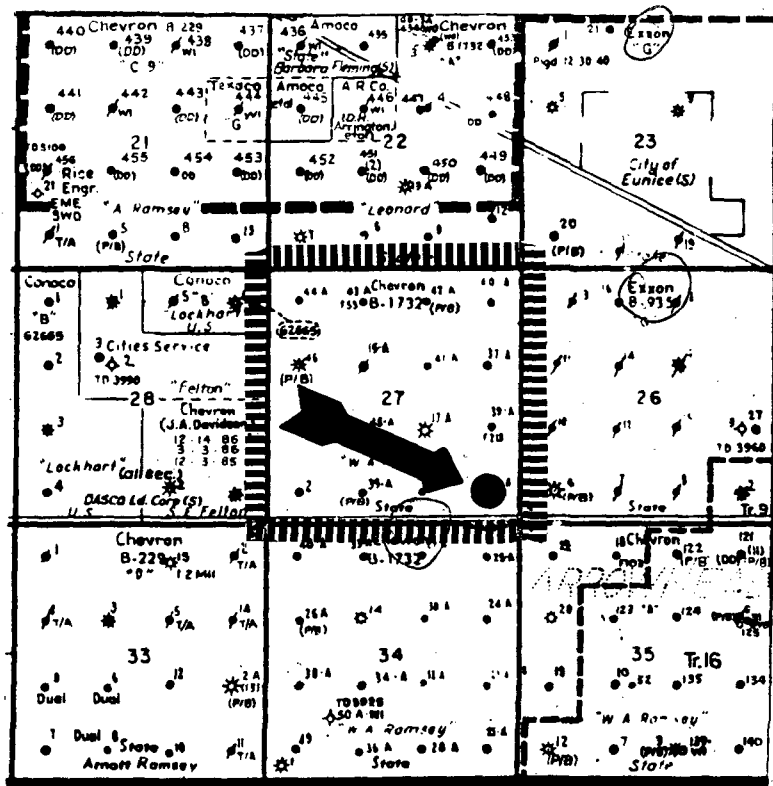

**CHEVRON U.S.A. INC.**  
W.A. Ramsay (NCT-A) Lease  
Well No. 29

Administrative Application for  
Simultaneous Dedication and  
Unorthodox Well Location  
Eumont YTS-7RVRS-QN  
(Pro Gas) Pool  
610' FSL and 660' FEL  
Section 27, T-21-S, R-36-E  
Lea County, New Mexico

**OFFSET OPERATORS**

Exxon U.S.A., Inc.  
P.O. Box 3116  
Midland, Texas 79702

Conoco Inc.  
10 Desta Drive  
Midland, Texas 79705

Oxy U.S.A. Inc.  
P.O. Box 50250  
Midland, TX 79710

## OIL CONSERVATION DIVISION

**DISTRICT I**  
P.O. Box 1980, Hobbs, NM 88240

**P.O. Box 2088**  
**Santa Fe, New Mexico 87504-2088**

**DISTRICT II**  
P.O. Drawer DD, Artesia, NM 88210

**DISTRICT III**  
1000 Rio Brazos Rd., Aztec, NM 87410

# WELL LOCATION AND ACREAGE DEDICATION PLAT

**All Distances must be from the outer boundaries of the section**

Operator <b>Chevron U.S.A. Inc.</b>		Lease <b>W.A. Ramsay (NCT-A)</b>		Well No. <b>17</b>
Unit Letter <b>J</b>	Section <b>27</b>	Township <b>21 S</b>	Range <b>36 E</b>	County <b>Lea</b>
Actual Footage Location of Well: <b>1980</b> feet from the <b>S</b> line and <b>1980</b> feet from the <b>E</b> line				
Ground level Elev. <b>3556</b>	Producing Formation <b>YTS/7RVRS/QN</b>	Pool <b>Eumont (Pro Gas)</b>	Dedicated Acreage: <b>640</b> Acres	

1. Outline the acreage dedicated to the subject well by colored pencil or hatchure marks on the plat below.
2. If more than one lease is dedicated to the well, outline each and identify the ownership thereof (both as to working interest and royalty).
3. If more than one lease of different ownership is dedicated to the well, have the interest of all owners been consolidated by communitization, unitization, force-pooling, etc.?
- ☐ Yes      ☐ No      If answer is "yes" type of consolidation \_\_\_\_\_
- If answer is "no" list the owners and tract descriptions which have actually been consolidated. (Use reverse side of this form if necessary). \_\_\_\_\_
- No allowable will be assigned to the well until all interests have been consolidated (by communitization, unitization, forced-pooling, or otherwise) or until a non-standard unit, eliminating such interest, has been approved by the Division.

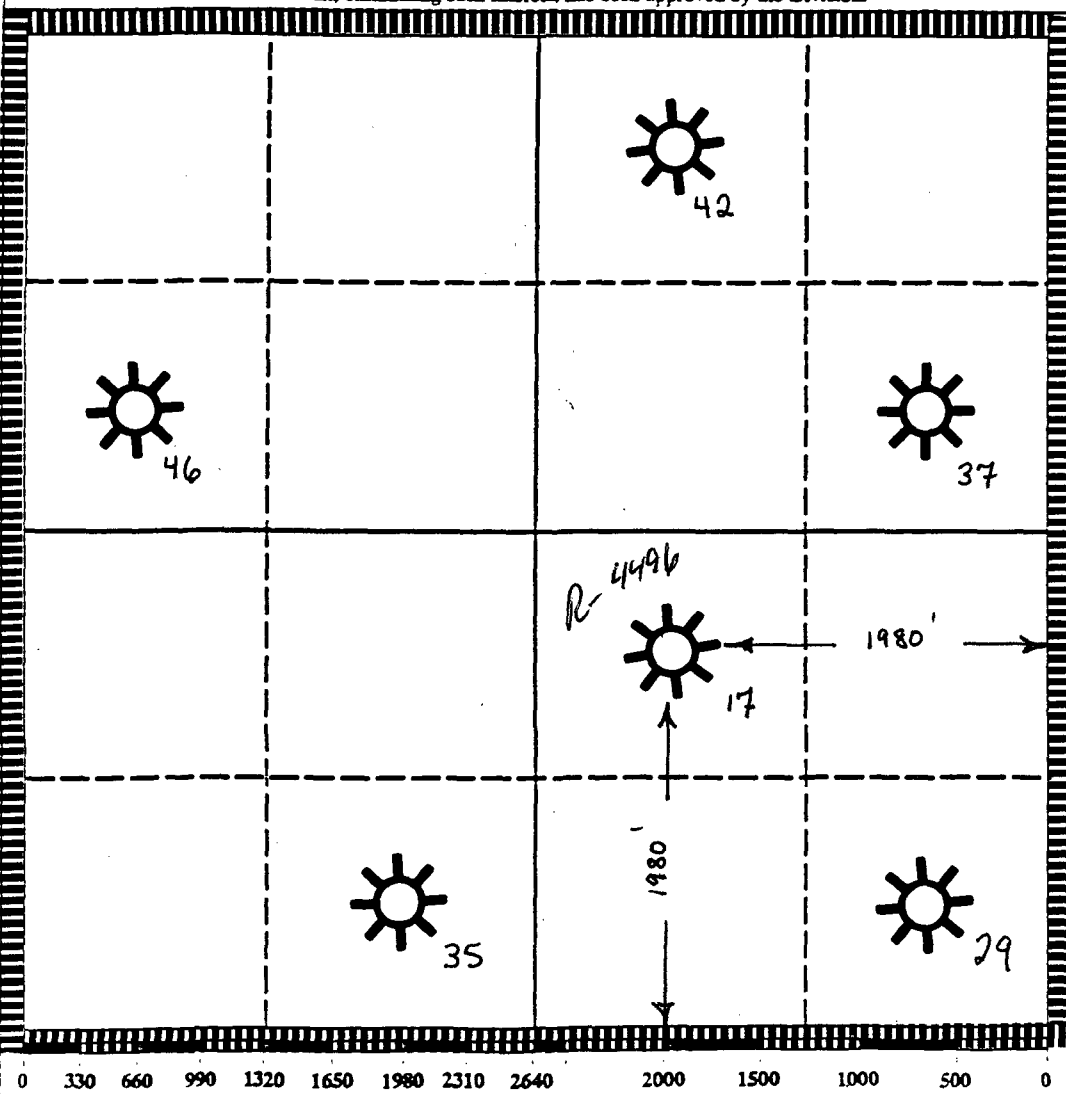

### OPERATOR CERTIFICATION

I hereby certify that the information contained herein is true and complete to the best of my knowledge and belief.

Signature Richard E. Blush

Printed Name  
Richard Black

Position	Petroleum Engineer
----------	--------------------

Company Chevron U.S.A. Inc.

Date 12/22/93

### SURVEYOR CERTIFICATION

I hereby certify that the well location shown on this plat was plotted from field notes of actual surveys made by me or under my supervision, and that the same is true and correct to the best of my knowledge and belief.

Date Surveyed

**Signature & Seal of  
Professional Surveyor**

**Certificate No.**

Submit to Appropriate  
District Office  
State Lease - 4 copies  
Fee Lease - 3 copies

State of New Mexico  
Energy, Minerals and Natural Resources Department

Form C-102  
Revised 1-1-89

OIL CONSERVATION DIVISION

P.O. Box 2088  
Santa Fe, New Mexico 87504-2088

DISTRICT I

P.O. Box 1980, Hobbs, NM 88240

DISTRICT II

P.O. Drawer DD, Artesia, NM 88210

DISTRICT III

1000 Rio Brazos Rd., Aztec, NM 87410

WELL LOCATION AND ACREAGE DEDICATION PLAT

All Distances must be from the outer boundaries of the section

Operator <b>Chevron U.S.A. Inc.</b>			Lease <b>W.A. Ramsay (NCT-A)</b>			Well No. <b>29</b>		
Unit Letter <b>P</b>	Section <b>27</b>	Township <b>21 S</b>	Range <b>36 E</b>	County <b>Lea</b>		NMPM		
Actual Footage Location of Well: <b>610</b> feet from the <b>S</b> line and <b>660</b> feet from the <b>E</b> line								
Ground level Elev. <b>3542</b>		Producing Formation <b>Yrs/7RVRS/QN</b>			Pool <b>Eumant (Pro Gas)</b>		Dedicated Acreage: <b>640</b> Acres	

- Outline the acreage dedicated to the subject well by colored pencil or hatchure marks on the plat below.
- If more than one lease is dedicated to the well, outline each and identify the ownership thereof (both as to working interest and royalty).
- If more than one lease of different ownership is dedicated to the well, have the interest of all owners been consolidated by communitization, unitization, force-pooling, etc.?  
☐ Yes ☐ No If answer is "yes" type of consolidation \_\_\_\_\_  
If answer is "no" list the owners and tract descriptions which have actually been consolidated. (Use reverse side of this form if necessary.) \_\_\_\_\_  
No allowable will be assigned to the well until all interests have been consolidated (by communitization, unitization, forced-pooling, or otherwise) or until a non-standard unit, eliminating such interest, has been approved by the Division.

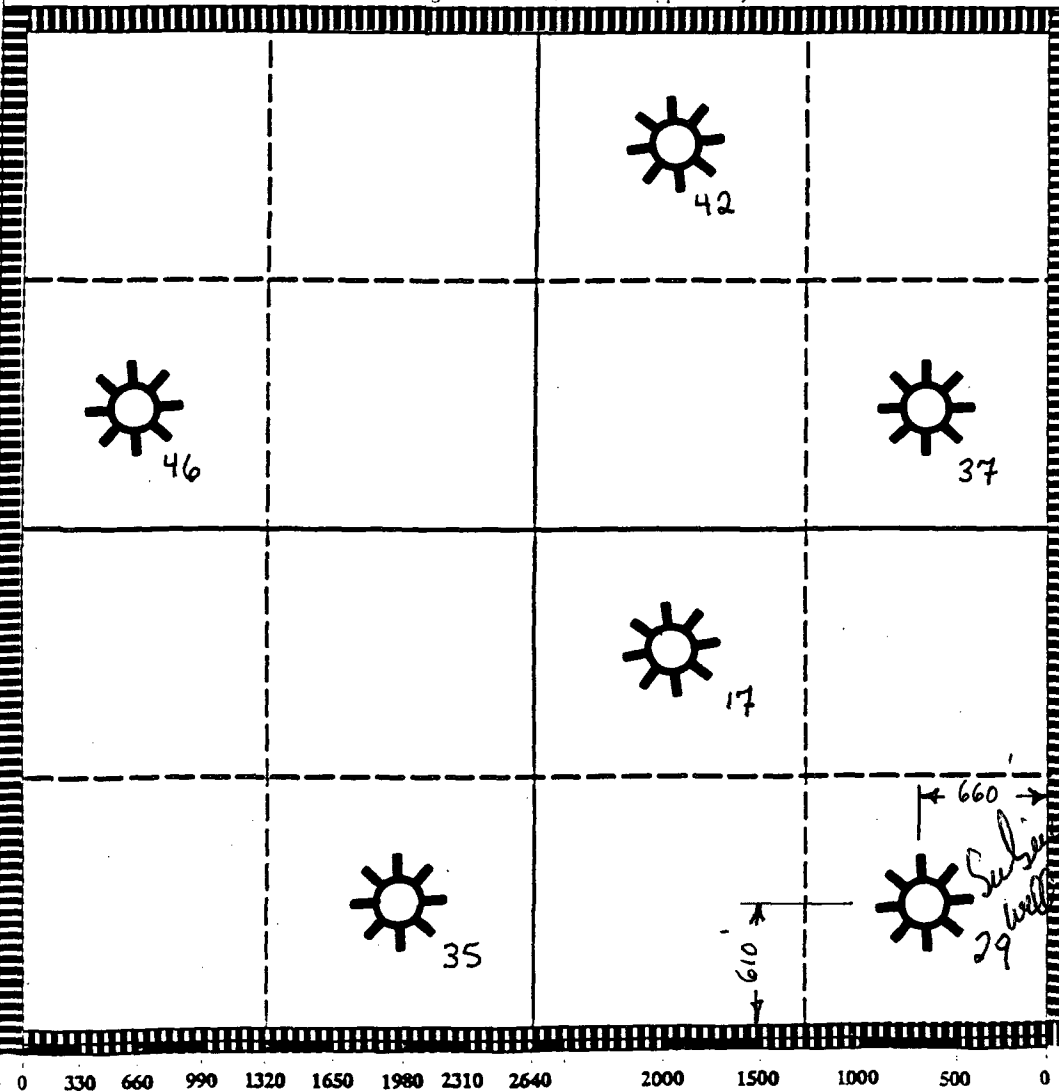

OPERATOR CERTIFICATION

I hereby certify that the information contained herein is true and complete to the best of my knowledge and belief.

Signature **Richard E. Black**  
Printed Name **Richard Black**  
Position **Petroleum Engineer**  
Company **Chevron U.S.A. Inc.**  
Date **12/22/93**

SURVEYOR CERTIFICATION

I hereby certify that the well location shown on this plat was plotted from field notes of actual surveys made by me or under my supervision, and that the same is true and correct to the best of my knowledge and belief.

Date Surveyed \_\_\_\_\_  
Signature & Seal of Professional Surveyor \_\_\_\_\_  
Certificate No. \_\_\_\_\_

Submit to Appropriate  
District Office  
State Lease - 4 copies  
Fee Lease - 3 copies

State of New Mexico  
Energy, Minerals and Natural Resources Department

Form C-102  
Revised 1-1-89

OIL CONSERVATION DIVISION

P.O. Box 2088  
Santa Fe, New Mexico 87504-2088

DISTRICT I  
P.O. Box 1980, Hobbs, NM 88240

DISTRICT II  
P.O. Drawer DD, Artesia, NM 88210

DISTRICT III  
1000 Rio Brazos Rd., Aztec, NM 87410

WELL LOCATION AND ACREAGE DEDICATION PLAT

All Distances must be from the outer boundaries of the section

Operator <b>Chevron U.S.A. Inc.</b>			Lease <b>W.A. Ramsay (NCT-A)</b>		Well No. <b>35</b>
Unit Letter <b>N</b>	Section <b>27</b>	Township <b>21 S</b>	Range <b>36 E</b>	County <b>Lea</b>	
Actual Footage Location of Well: <b>660'</b> feet from the <b>S</b> line and <b>1980</b> feet from the <b>W</b> line					
Ground level Elev. <b>3587</b>	Producing Formation <b>YTS / TRVRS / QN</b>		Pool <b>Eumont (Pro Gas)</b>	Dedicated Acreage: <b>640</b> Acres	

- Outline the acreage dedicated to the subject well by colored pencil or hatchure marks on the plat below.
- If more than one lease is dedicated to the well, outline each and identify the ownership thereof (both as to working interest and royalty).
- If more than one lease of different ownership is dedicated to the well, have the interest of all owners been consolidated by communization, unitization, force-pooling, etc.?  
☐ Yes ☐ No If answer is "yes" type of consolidation \_\_\_\_\_  
If answer is "no" list the owners and tract descriptions which have actually been consolidated. (Use reverse side of this form if necessary). \_\_\_\_\_  
No allowable will be assigned to the well until all interests have been consolidated (by communization, unitization, forced-pooling, or otherwise) or until a non-standard unit, eliminating such interest, has been approved by the Division.

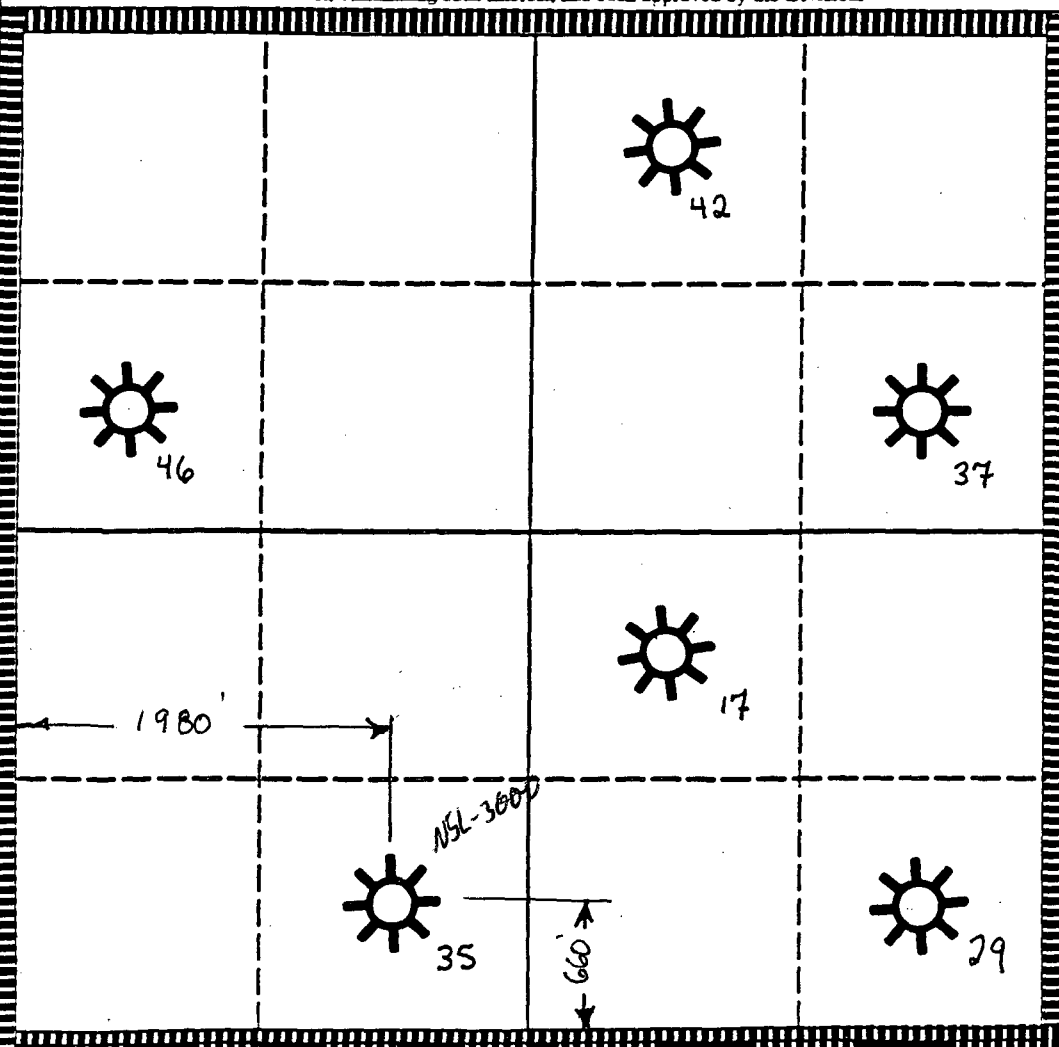

OPERATOR CERTIFICATION

I hereby certify that the information contained herein is true and complete to the best of my knowledge and belief.

Signature **Richard E. Black**  
Printed Name **Richard Black**  
Position **Petroleum Engineer**  
Company **Chevron U.S.A. Inc.**  
Date **12/22/93**

SURVEYOR CERTIFICATION

I hereby certify that the well location shown on this plat was plotted from field notes of actual surveys made by me or under my supervision, and that the same is true and correct to the best of my knowledge and belief.

Date Surveyed \_\_\_\_\_  
Signature & Seal of Professional Surveyor \_\_\_\_\_

Certificate No. \_\_\_\_\_

0 330 660 990 1320 1650 1980 2310 2640 2000 1500 1000 500 0

## OIL CONSERVATION DIVISION

**DISTRICT I**  
P.O. Box 1980, Hobbs, NM 88240

**P.O. Box 2088**  
**Santa Fe, New Mexico 87504-2088**

**DISTRICT II**  
P.O. Drawer DD, Artesia, NM 88210

**DISTRICT III**  
1000 Rio Brazos Rd., Aztec, NM 87410

# WELL LOCATION AND ACREAGE DEDICATION PLAT

**All Distances must be from the outer boundaries of the section**

Operator Chevron U.S.A. Inc.		Lease W.A. Ramsay (NCT-A)		Well No. 37
Unit Letter H	Section 27	Township 21 S	Range 36 E	County Lea
Actual Footage Location of Well: 1980 feet from the N line and 660 feet from the E line				
Ground level Elev. 3875	Producing Formation Yrs/7Rvrs/QN	Pool Eumont (Pro Gas)	Dedicated Acreage: 640 Acres	

1. Outline the acreage dedicated to the subject well by colored pencil or hatchure marks on the plat below.
2. If more than one lease is dedicated to the well, outline each and identify the ownership thereof (both as to working interest and royalty).
3. If more than one lease of different ownership is dedicated to the well, have the interest of all owners been consolidated by communitization, unitization, force-pooling, etc.?
- ☐ Yes      ☐ No      If answer is "yes" type of consolidation \_\_\_\_\_
- If answer is "no" list the owners and tract descriptions which have actually been consolidated. (Use reverse side of this form if necessary). \_\_\_\_\_
- No allowable will be assigned to the well until all interests have been consolidated (by communitization, unitization, forced-pooling, or otherwise) or until a non-standard unit, eliminating such interest, has been approved by the Division.

0 330 660 990 1320 1650 1980 2310 2640 2000 1500 1000 500 0

NSL-3000-B

1981

660

42

46

37

17

35

29

OPERATOR CERTIFICATION	
I hereby certify that the information contained herein is true and complete to the best of my knowledge and belief.	
Signature	<i>Richard E. Black</i>
Printed Name	Richard Black
Position	Petroleum Engineer
Company	Chevron U.S.A. Inc.
Date	12/22/93

SURVEYOR CERTIFICATION	
I hereby certify that the well location shown on this plat was plotted from field notes of actual surveys made by me or under my supervision, and that the same is true and correct to the best of my knowledge and belief.	
Date Surveyed	
Signature & Seal of Professional Surveyor	
Certificate No.	



Submit to Appropriate  
District Office  
State Lease - 4 copies  
Fee Lease - 3 copies

State of New Mexico  
Energy, Minerals and Natural Resources Department

Form C-102  
Revised 1-1-89

OIL CONSERVATION DIVISION

P.O. Box 2088  
Santa Fe, New Mexico 87504-2088

DISTRICT I  
P.O. Box 1980, Hobbs, NM 88240

DISTRICT II  
P.O. Drawer DD, Artesia, NM 88210

DISTRICT III  
1000 Rio Brazos Rd., Aztec, NM 87410

WELL LOCATION AND ACREAGE DEDICATION PLAT

All Distances must be from the outer boundaries of the section

Operator <b>Chevron U.S.A. Inc.</b>			Lease <b>W.A. Ramsay (NCT-A)</b>		Well No. <b>42</b>
Unit Letter <b>B</b>	Section <b>27</b>	Township <b>21 S</b>	Range <b>36 E</b>	County <b>Lea</b>	
Actual Footage Location of Well: <b>660</b> feet from the <b>N</b> line and <b>1980</b> feet from the <b>E</b> line					
Ground level Elev. <b>3564</b>	Producing Formation <b>YTS / TRVRS / QN</b>		Pool <b>Eumont (Pro Gas)</b>	Dedicated Acreage: <b>640</b> Acres	

1. Outline the acreage dedicated to the subject well by colored pencil or hatchure marks on the plat below.
2. If more than one lease is dedicated to the well, outline each and identify the ownership thereof (both as to working interest and royalty).
3. If more than one lease of different ownership is dedicated to the well, have the interest of all owners been consolidated by communitization, unitization, force-pooling, etc.?  
☐ Yes ☐ No If answer is "yes" type of consolidation \_\_\_\_\_  
If answer is "no" list the owners and tract descriptions which have actually been consolidated. (Use reverse side of this form if necessary). \_\_\_\_\_  
No allowable will be assigned to the well until all interests have been consolidated (by communitization, unitization, forced-pooling, or otherwise) or until a non-standard unit, eliminating such interest, has been approved by the Division.

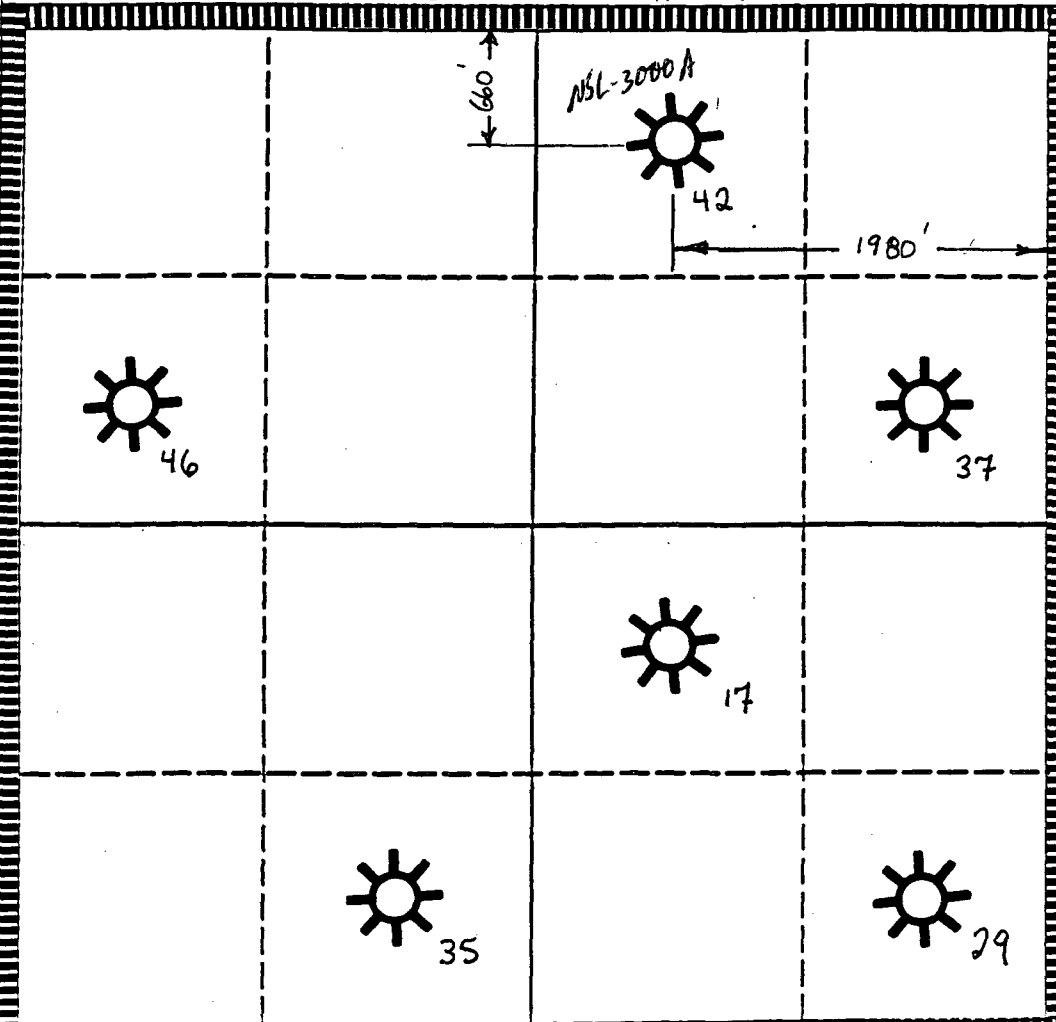

OPERATOR CERTIFICATION

I hereby certify that the information contained herein is true and complete to the best of my knowledge and belief.

Signature **Richard E. Black**  
Printed Name **Richard Black**  
Position **Petroleum Engineer**  
Company **Chevron U.S.A. Inc.**  
Date **12/22/93**

SURVEYOR CERTIFICATION

I hereby certify that the well location shown on this plat was plotted from field notes of actual surveys made by me or under my supervision, and that the same is true and correct to the best of my knowledge and belief.

Date Surveyed \_\_\_\_\_  
Signature & Seal of Professional Surveyor \_\_\_\_\_  
Certificate No. \_\_\_\_\_

0 330 660 990 1320 1650 1980 2310 2640 2000 1500 1000 500 0

Submit to Appropriate  
District Office  
State Lease - 4 copies  
Fee Lease - 3 copies

State of New Mexico  
Energy, Minerals and Natural Resources Department

Form C-102  
Revised 1-1-89

OIL CONSERVATION DIVISION

P.O. Box 2088  
Santa Fe, New Mexico 87504-2088

DISTRICT I  
P.O. Box 1980, Hobbs, NM 88240

DISTRICT II  
P.O. Drawer DD, Artesia, NM 88210

DISTRICT III  
1000 Rio Brazos Rd., Aztec, NM 87410

WELL LOCATION AND ACREAGE DEDICATION PLAT

All Distances must be from the outer boundaries of the section

Operator <b>Chevron U.S.A. Inc.</b>		Lease <b>W.A. Ramsay (NCT-A)</b>		Well No. <b>46</b>
Unit Letter	Section <b>27</b>	Township <b>21 S</b>	Range <b>36 E</b>	County <b>Lea</b>
Actual Footage Location of Well: <b>1980</b> feet from the <b>N</b> line and <b>660</b> feet from the <b>W</b> line				
Ground level Elev. <b>3569</b>	Producing Formation <b>YTS / TRVRS / QN</b>		Pool <b>Eumont (Pro Gas)</b>	Dedicated Acreage: <b>640</b> Acres

- Outline the acreage dedicated to the subject well by colored pencil or hatchure marks on the plat below.
- If more than one lease is dedicated to the well, outline each and identify the ownership thereof (both as to working interest and royalty).
- If more than one lease of different ownership is dedicated to the well, have the interest of all owners been consolidated by communitization, unitization, force-pooling, etc.?  
☐ Yes ☐ No If answer is "yes" type of consolidation \_\_\_\_\_  
If answer is "no" list the owners and tract descriptions which have actually been consolidated. (Use reverse side of this form if necessary).  
No allowable will be assigned to the well until all interests have been consolidated (by communitization, unitization, forced-pooling, or otherwise) or until a non-standard unit, eliminating such interest, has been approved by the Division.

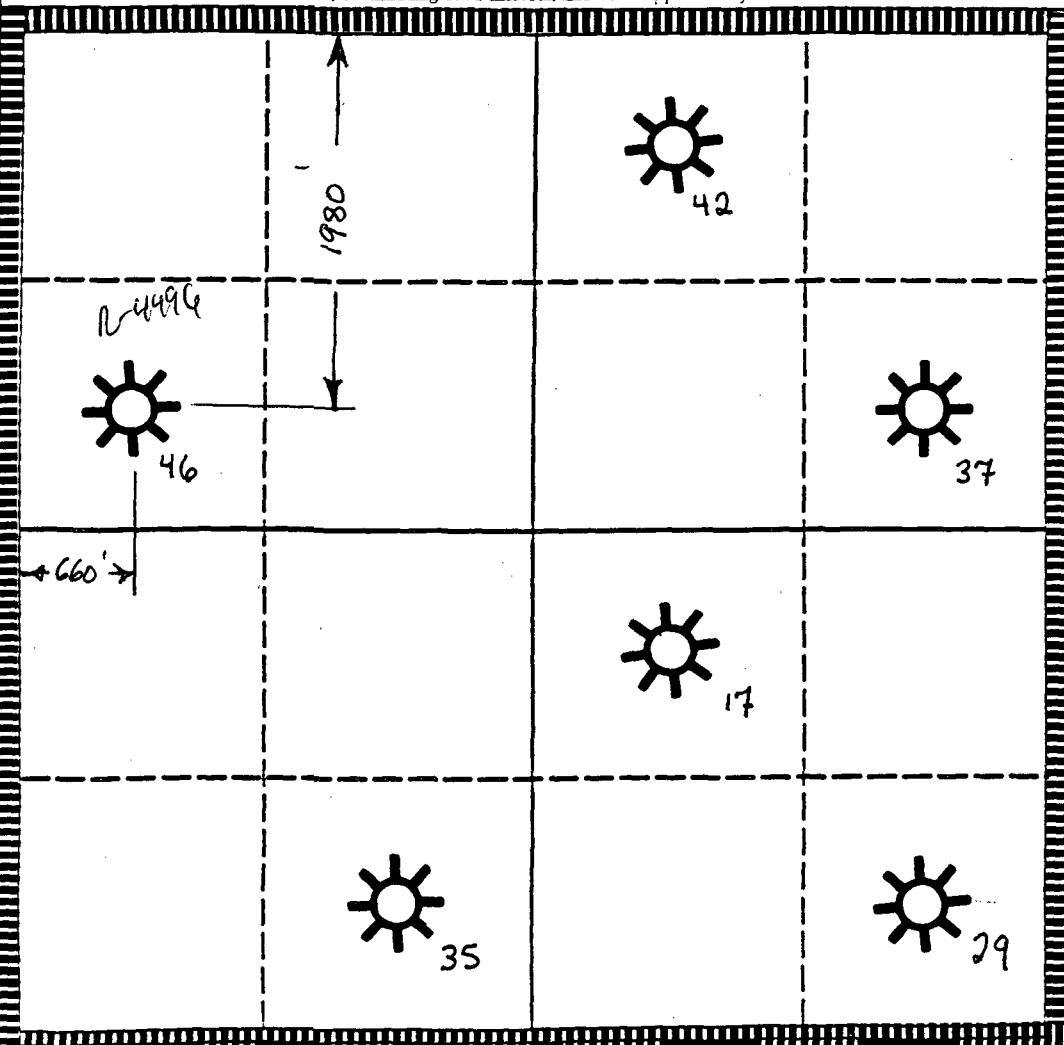

OPERATOR CERTIFICATION

I hereby certify that the information contained herein is true and complete to the best of my knowledge and belief.

Signature **Richard E. Black**  
Printed Name **Richard Black**  
Position **Petroleum Engineer**  
Company **Chevron U.S.A. Inc.**  
Date **12/22/93**

SURVEYOR CERTIFICATION

I hereby certify that the well location shown on this plat was plotted from field notes of actual surveys made by me or under my supervision, and that the same is true and correct to the best of my knowledge and belief.

Date Surveyed \_\_\_\_\_  
Signature & Seal of Professional Surveyor \_\_\_\_\_  
Certificate No. \_\_\_\_\_

0 330 660 990 1320 1650 1980 2310 2640 2000 1500 1000 500 0

BEFORE THE OIL CONSERVATION COMMISSION  
OF THE STATE OF NEW MEXICO

IN THE MATTER OF THE HEARING  
CALLED BY THE OIL CONSERVATION  
COMMISSION OF NEW MEXICO FOR  
THE PURPOSE OF CONSIDERING:

CASE NO. 4917  
Order No. R-4496

APPLICATION OF GULF OIL  
CORPORATION FOR A NON-STANDARD  
LOCATION, LEA COUNTY, NEW MEXICO.

ORDER OF THE COMMISSION

BY THE COMMISSION:

This cause came on for hearing at 9 a.m. on March 14, 1973,  
at Santa Fe, New Mexico, before Examiner Richard L. Stamets.

NOW, on this 21st day of March, 1973, the Commission,  
a quorum being present, having considered the testimony, the  
record, and the recommendations of the Examiner, and being  
fully advised in the premises,

FINDS:

(1) That due public notice having been given as required  
by law, the Commission has jurisdiction of this cause and the  
subject matter thereof.

(2) That the applicant, Gulf Oil Corporation, seeks  
authority to simultaneously dedicate a 640-acre standard gas  
proration unit, Eumont Gas Pool, to two wells, the W. A. Ramsay  
Well No. 17 at a standard location in Unit J, and W. A. Ramsay  
Well No. 46 at a non-standard location in Unit E, Section 27,  
Township 21 South, Range 36 East, NMPM, Lea County, New Mexico.

(3) That the applicant seeks to produce the allowable from  
said gas proration unit from either or both of said wells in  
any proportion.

(4) That the applicant further seeks the approval of the  
non-standard location of said W. A. Ramsay Well No. 46 located  
1980 feet from the North line and 660 feet from the West line of  
said Section 27, Eumont Gas Pool, Lea County, New Mexico.

(5) That approval of the subject application for simultaneous  
dedication and non-standard location will afford the applicant  
the opportunity to produce its just and equitable share of the  
gas in the subject pool, will prevent the economic loss caused by  
the drilling of unnecessary wells, avoid the augmentation of risk  
arising from the drilling of an excessive number of wells, and  
will otherwise prevent waste and protect correlative rights.

Copy to El Paso Nat Gas & Union Sub 3-28-73  
advised atty Wink 3-28-73  
Copy to Northern 7-30-73

-2-

Case No. 4917  
Order No. R-4496

IT IS THEREFORE ORDERED:

(1) That Gulf Oil Corporation, is hereby authorized to simultaneously dedicate a 640-acre standard gas proration unit, Eumont Gas Pool, to two wells, the W. A. Ramsay Well No. 17 at a standard location in Unit J, and W. A. Ramsay Well No. 46 at a non-standard location in Unit E, Section 27, Township 21 South, Range 36 East, NMPM, Lea County, New Mexico.

(2) That the allowable assigned to said proration unit plus the underage accrued from January through March, 1973, may be produced from either or both of said wells in any proportion.

(3) That the non-standard location of the applicant's W. A. Ramsay Well No. 46 located 1980 feet from the North line and 660 feet from the West line of said Section 27 in said pool is hereby approved.

(4) That the effective date of this order shall be April 1, 1973.

(5) That jurisdiction of this cause is retained for the entry of such further orders as the Commission may deem necessary.

DONE at Santa Fe, New Mexico, on the day and year hereinabove designated.

STATE OF NEW MEXICO  
OIL CONSERVATION COMMISSION

BRUCE KING, Chairman

ALEX J. ARMIJO, Member

A. L. PORTER, Jr., Member & Secretary

S E A L

dr/



December 22, 1993  
Midland, Texas

Chevron U.S.A. Production Company  
P.O. Box 1150  
Midland, TX 79702

Simultaneous Dedication and  
Unorthodox Gas Well Location  
Eumont YTS-7RVRS-QN  
(Pro Gas) Pool  
Lea County, New Mexico

Exxon U.S.A. Inc.  
P.O. Box 3116  
Midland, TX 79702

Dear Mr. Dixon:

Attached is a copy of an administrative application for NMOCD approval of an unorthodox well location and simultaneous dedication in the Eumont YTS-7RVRS-QN (Pro Gas) Pool.

Chevron U.S.A. is planning to plugback the W.A. Ramsay (NCT-A) #29 from the Eumont Oil Pool and complete said well in the Eumont Gas Pool. The well is located 610' FSL and 660' FEL in Section 27 of T-21-S, R-36-E, Lea County, New Mexico. We have requested that the NMOCD approve the simultaneous dedication of this well with the W.A. Ramsay (NCT-A) Nos. 17, 35, 37, 42, and 46 which produce on an existing 640-acre Eumont gas spacing and proration unit (GPU). This GPU comprises all of Section 27 in T-21-S, R-36-E. Because the subject well is located less than 1650' from the boundary of a 640-acre GPU, we have also requested NMOCD approval of an unorthodox well location.

If you have any questions about the application, please contact Richard Black at (915) 687-7284.

Sincerely,

A handwritten signature in cursive script, appearing to read "R.A. Godbold for".

F. S. Godbold  
Petroleum Engineering Supervisor  
New Mexico Area

REB/tmdr  
11364.DOC

Attachments



**Chevron**

December 22, 1993  
Midland, Texas

**Chevron U.S.A. Production Company**  
P.O. Box 1150  
Midland, TX 79702

**Simultaneous Dedication and  
Unorthodox Gas Well Location  
Eumont YTS-7RVRS-QN  
(Pro Gas) Pool  
Lea County, New Mexico**

Oxy U.S.A. Inc.  
P.O. Box 50250  
Midland, Texas 79710

**New Mexico Operations Director:**

Attached is a copy of an administrative application for NMOCD approval of an unorthodox well location and simultaneous dedication in the Eumont YTS-7RVRS-QN (Pro Gas) Pool.

Chevron U.S.A. is planning to plugback the W.A. Ramsay (NCT-A) #29 from the Eumont Oil Pool and complete said well in the Eumont Gas Pool. The well is located 610' FSL and 660' FEL in Section 27 of T-21-S, R-36-E, Lea County, New Mexico. We have requested that the NMOCD approve the simultaneous dedication of this well with the W.A. Ramsay (NCT-A) Nos. 17, 35, 37, 42, and 46 which produce on an existing 640-acre Eumont gas spacing and proration unit (GPU). This GPU comprises all of Section 27 in T-21-S, R-36-E. Because the subject well is located less than 1650' from the boundary of a 640-acre GPU, we have also requested NMOCD approval of an unorthodox well location.

If you have any questions about the application, please contact Richard Black at (915) 687-7284.

Sincerely,

*R. A. Hehn for*

F. S. Godbold  
Petroleum Engineering Supervisor  
New Mexico Area

REB/tmdr  
11364.DOC

Attachments



December 22, 1993  
Midland, Texas

Chevron U.S.A. Production Company  
P.O. Box 1150  
Midland, TX 79702

Simultaneous Dedication and  
Unorthodox Gas Well Location  
Eumont YTS-7RVRS-QN  
(Pro Gas) Pool  
Lea County, New Mexico

Conoco Inc.  
10 Desta Drive  
Midland, Texas 79705

New Mexico Operations Director:

Attached is a copy of an administrative application for NMOCD approval of an unorthodox well location and simultaneous dedication in the Eumont YTS-7RVRS-QN (Pro Gas) Pool.

Chevron U.S.A. is planning to plugback the W.A. Ramsay (NCT-A) #29 from the Eumont Oil Pool and complete said well in the Eumont Gas Pool. The well is located 610' FSL and 660' FEL in Section 27 of T-21-S, R-36-E, Lea County, New Mexico. We have requested that the NMOCD approve the simultaneous dedication of this well with the W.A. Ramsay (NCT-A) Nos. 17, 35, 37, 42, and 46 which produce on an existing 640-acre Eumont gas spacing and proration unit (GPU). This GPU comprises all of Section 27 in T-21-S, R-36-E. Because the subject well is located less than 1650' from the boundary of a 640-acre GPU, we have also requested NMOCD approval of an unorthodox well location.

If you have any questions about the application, please contact Richard Black at (915) 687-7284.

Sincerely,

A handwritten signature in cursive script that reads "F. S. Godbold for".

F. S. Godbold  
Petroleum Engineering Supervisor  
New Mexico Area

REB/tmdr  
11364.DOC

Attachments



STATE OF NEW MEXICO  
ENERGY, MINERALS AND NATURAL RESOURCES DEPARTMENT

OIL CONSERVATION DIVISION  
HOBBS DISTRICT OFFICE

BRUCE KING  
GOVERNOR

1-4-93

POST OFFICE BOX 1980  
HOBBS, NEW MEXICO 88241-1980  
(505) 393-6161

OIL CONSERVATION DIVISION  
P. O. BOX 2088  
SANTA FE, NEW MEXICO 87501

RE: Proposed:

MC	_____
DHC	_____
NSL	<u>X</u> _____ <u>SD</u>
NSP	_____
SWD	_____
WFX	_____
PMX	_____

Gentlemen:

I have examined the application for the:

Chevron USA Inc      W.A. Ramsay NCT-A      #29-A      27-21-36  
Operator      Lease & Well No.      Unit      S-T-R

and my recommendations are as follows:

\_\_\_\_\_  
\_\_\_\_\_  
\_\_\_\_\_  
\_\_\_\_\_

Yours very truly,

Jerry Sexton  
Supervisor, District 1

/ed