



GREENHILL PETROLEUM CORPORATION

11490 WESTHEIMER, SUITE 200
HOUSTON, TEXAS 77077
TELEPHONE (713) 589-8484
FAX (713) 589-9399

Incorporated in Delaware, U.S.A.

July 17, 1991

State of New Mexico
Energy, Minerals and Natural Resource Dept.
P.O. Box 2088
Santa Fe, NM 87504

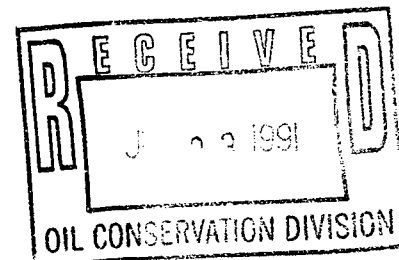

Attn: Mike Stogner

Re: Lovington Paddock Unit
Well No. 102
Lea County, NM

It is requested that Administrative Order NSL-3022 dated June 27, 1991 be amended to provide that the location for Well No. 102 be changed to:

2525 FEL and 290 FNL in Section 36, Unit B, T16S-R36E, Lea County, NM.

The wrong location as stated in the above referenced order is:

290 FNL and 2755 FWL in Section 36, Unit C, T16S-R36E.

Please advise in the event you need any additional information.

Sincerely,

Michael J. Newport
Michael J. Newport
Land Manager-Permian Basin

MJN:jb

7/24/91
Michael
Could you be more specific
as to the reason why this
well location was moved.
Thank.
Michael Stogner



STATE OF NEW MEXICO

ENERGY, MINERALS AND NATURAL RESOURCES DEPARTMENT

OIL CONSERVATION DIVISION

Example

BRUCE KING
GOVERNOR

March 7, 1991

POST OFFICE BOX 2088
STATE LAND OFFICE BUILDING
SANTA FE, NEW MEXICO 87504
(505) 827-5800

Greenhill Petroleum Corporation
12777 Jones Road
Suite 375
Houston, TX 77079

Attention: Michael J. Newport

Amended Administrative Order NSL-2980

Dear Mr. Newport:

Reference is made to your letter dated February 12, 1991 requesting to amend the location of the Lovington Paddock Unit Well No. 88 which was approved by Division Administrative Order NSL-2980, dated January 17, 1991, to be 1605 feet from the North line and 265 feet from the West line (Unit E) of Section 31, Township 16 South, Range 37 East, NMPM, Lovington Paddock Pool, Lovington Paddock Waterflood Project Area, Lea County, New Mexico.

It is our understanding that said amendment is at the request of the U.S. Bureau of Land Management, which is the surface management agency for this drilling tract. Therefore, by authority granted me under the provisions of General Rule 104.F.I., said order is hereby amended to reflect the location of the No. 88 well as "1642 feet from the North line and 302 feet from the West line."

All other provisions of said Administrative Order NSL-2980 shall remain in full force and effect until further notice.

Sincerely,

A handwritten signature in cursive script, appearing to read "William J. LeMay".

William J. LeMay
Director

cc: Oil Conservation Division - Hobbs
US Bureau of Land Management - Carlsbad



GREENHILL PETROLEUM CORPORATION

Incorporated in Delaware, U.S.A.

OIL CONSERVATION DIVISION
RECEIVED

11490 WESTHEIMER, SUITE 200
HOUSTON, TEXAS 77077
TELEPHONE (713) 589-8484
FAX. (713) 589-9399

'91 AUG 5 AM 9 19

July 30, 1991

State of New Mexico
Energy, Minerals and Natural Resource Department
P. O. Box 2088
Santa Fe, N.M. 87504

Attention: Mike Stogner

Re: Lovington Paddock Unit
Well No. 102
Lea County, N. M.

Reference is made to our attached request letter whereby it was requested that Administrative Order NSL-3022 be amended to provide that the location for Well No. 102 be moved. The reason the location had to be moved is because it is located in our pipe yard. We had to move the location away from the gasoline pump which is a semi-permanent installation. The actual location is still in our pipe yard but it is in a much better position.

Please contact me in the event you need additional information.

Sincerely,

Michael J. Newport
Land Manager, Permian Basin

MJN:sjs
enclosures



Attn: Michael J. Newport

GREENHILL PETROLEUM CORPORATION

Incorporated in Delaware, U.S.A.

11490 WESTHEIMER, SUITE 200
HOUSTON, TEXAS 77077
TELEPHONE (713) 589-8484
FAX (713) 589-9399

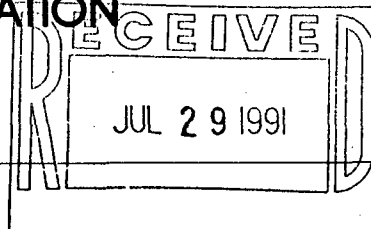

July 17, 1991

State of New Mexico
Energy, Minerals and Natural Resource Dept.
P.O. Box 2088
Santa Fe, NM 87504

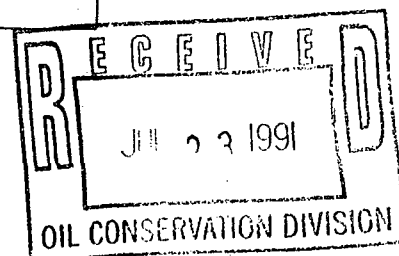

Attn: Mike Stogner

Re: Lovington Paddock Unit
Well No. 102
Lea County, NM

It is requested that Administrative Order NSL-3022 dated June 27, 1991 be amended to provide that the location for Well No. 102 be changed to:

2525 FEL and 290 FNL in Section 36, Unit B, T16S-R36E, Lea County, NM.

The wrong location as stated in the above referenced order is:

290 FNL and 2755 FWL in Section 36, Unit C, T16S-R36E.

Please advise in the event you need any additional information.

Sincerely,

Michael Newport

Michael J. Newport
Land Manager-Permian Basin

MJN:jb

7/24/91

*Michael
Could you be more specific
as to the reason why this
well location was moved.
Thank.
Michael Stogner*



GREENHILL PETROLEUM CORPORATION

12777 JONES ROAD, SUITE 375
HOUSTON, TEXAS 77070
TELEPHONE (713) 955-1146
FAX (713) 890-2405

Incorporated in Delaware, U.S.A.

June 17, 1991

Oil Conservation Division
State of New Mexico
Energy, Minerals and Natural Resources Dept.
P.O. Box 2088
Santa Fe, New Mexico 87504-2088

Attn: Mike Stogner

Re: Unorthodox Location and Drilling Permit
Proposed Well No. 102
Lovington Paddock
Lea County. New Mexico

Greenhill Petroleum Corporation respectfully requests the State of New Mexico Oil Conservation Division grant approval of the proposed unorthodox location and the attached permit to drill Well Number 102 in the Lovington Paddock Unit, located in Lea County, New Mexico.

The Lovington Paddock Unit is presently developed and being waterflooded utilizing a 40-acre well density. It is believed that infill development using a 20-acre well density will improve waterflood sweep efficiency and will increase secondary oil recovery. The proposed location for Well No. 102 is located in the interior of the unit and is not competitive with offset wells outside the unit. Information gathered as a result of drilling this infill well will be utilized in evaluating additional infill development potential in the unit and ultimately may be used to evaluate the feasibility of tertiary recovery.

Greenhill Petroleum Corporation wishes to commence drilling operations on the proposed well as soon as possible and would appreciate a response to this request at your earliest convenience.

Respectfully yours,

GREENHILL PETROLEUM CORPORATION

Michael J. Newport
Michael J. Newport
Landman

MJN:JB
Enclosures

OIL CONSERVATION DIVISION

P.O. Box 2088
Santa Fe, New Mexico 87504-2088

DISTRICT I
P.O. Box 1980, Hobbs, NM 88240

DISTRICT II
P.O. Drawer DD, Artesia, NM 88210

DISTRICT III
1000 Rio Brazos Rd., Aztec, NM 87410

WELL LOCATION AND ACREAGE DEDICATION PLAT

All Distances must be from the outer boundaries of the section

Operator GREENHILL PETROLEUM CORP.			Lease LOVINGTON PADDOCK UNIT		Well No. 102
Unit Letter C	Section 36	Township 16 SOUTH	Range 36 EAST	County LEA	
Actual Footage Location of Well:					

290 feet from the NORTH line and 2755 feet from the WEST line

Ground level Elev. 3841.9	Producing Formation Lovington Paddock	Pool Lovington Paddock Unit	Dedicated Acreage: 40 Acres
------------------------------	--	--------------------------------	--------------------------------

- Outline the acreage dedicated to the subject well by colored pencil or hatchure marks on the plat below.
- If more than one lease is dedicated to the well, outline each and identify the ownership thereof (both as to working interest and royalty).
- If more than one lease of different ownership is dedicated to the well, have the interest of all owners been consolidated by communitization, unitization, force-pooling, etc?
☒ Yes ☐ No If answer is "yes" type of consolidation Unitized
If answer is "no" list the owners and tract descriptions which have actually been consolidated. (Use reverse side of this form if necessary.)
No allowable will be assigned to the well until all interests have been consolidated (by communitization, unitization, forced-pooling, or otherwise) or until a non-standard unit, eliminating such interest, has been approved by the Division.

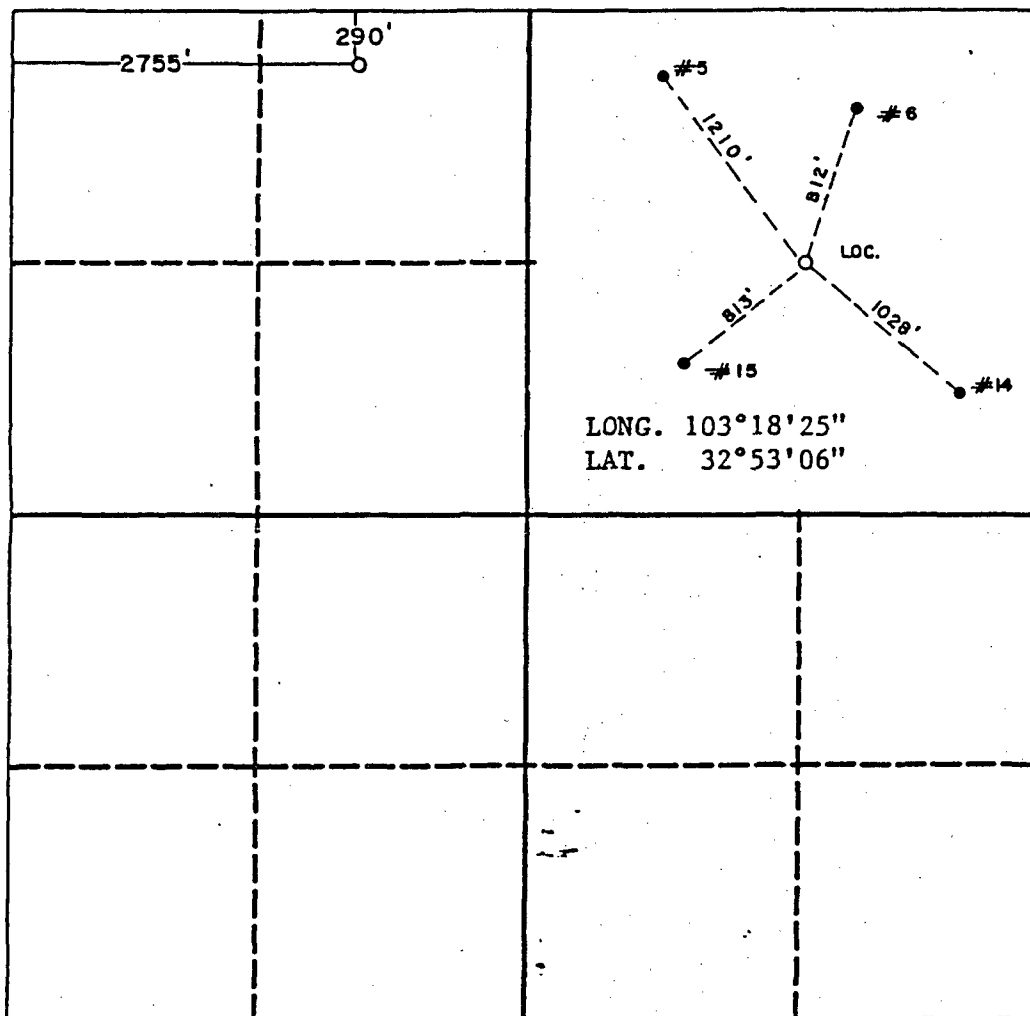

OPERATOR CERTIFICATION

I hereby certify that the information contained herein is true and complete to the best of my knowledge and belief.

Signature: Michael J. Newport
Printed Name: Michael J. Newport
Position: Landman
Company: Greenhill Petroleum Corp
Date: 6/17/91

SURVEYOR CERTIFICATION

I hereby certify that the well location shown on this plat was plotted from field notes of actual surveys made by me or under my supervision, and that the same is true and correct to the best of my knowledge and belief.

Date Surveyed: 6-1-91
Signature & Seal of Professional Surveyor: [Signature]
Certificate No. JOHN W. WEST 676
RONALD J. EIDSON 3239
NEW MEXICO

Submit to Appropriate
District Office
State Lease - 6 copies
Fee Lease - 5 copies

State of New Mexico
Energy, Minerals and Natural Resources Department

Form C-101
Revised 1-1-89

OIL CONSERVATION DIVISION

P.O. Box 2088
Santa Fe, New Mexico 87504-2088

DISTRICT I

P.O. Box 1980, Hobbs, NM 88240

DISTRICT II

P.O. Drawer DD, Artesia, NM 88210

DISTRICT III

1000 Rio Brazos Rd., Aztec, NM 87410

API NO. (assigned by OCD on New Wells)

5. Indicate Type of Lease

STATE ☒ FEE ☐

6. State Oil & Gas Lease No.

B2411

APPLICATION FOR PERMIT TO DRILL, DEEPEN, OR PLUG BACK					
1a. Type of Work: DRILL <input checked="" type="checkbox"/> RE-ENTER <input type="checkbox"/> DEEPEN <input type="checkbox"/> PLUG BACK <input type="checkbox"/>			7. Lease Name or Unit Agreement Name LOVINGTON PADDOCK UNIT		
b. Type of Well: OIL WELL <input checked="" type="checkbox"/> GAS WELL <input type="checkbox"/> OTHER <input type="checkbox"/>			8. Well No. 102		
2. Name of Operator GREENHILL PETROLEUM CORPORATION			9. Pool name or Wildcat LOVINGTON PADDOCK		
3. Address of Operator 11490 WESTHEIMER, STE., 200, HOUSTON, TX 77077					
4. Well Location Unit Letter <u>C</u> : <u>290</u> Feet From The <u>NORTH</u> Line and <u>2755</u> Feet From The <u>WEST</u> Line					
Section <u>36</u> Township <u>16S</u> Range <u>36E</u> NMMPM <u>LEA</u> County <u></u>					
10. Proposed Depth 6600		11. Formation PADDOCK		12. Rotary or C.T.	
13. Elevations (Show whether DF, RT, GR, etc.) 3841.9		14. Kind & Status Plug. Bond ON FILE		15. Drilling Contractor TBD	
16. Approx. Date Work will start					
17. PROPOSED CASING AND CEMENT PROGRAM					
SIZE OF HOLE	SIZE OF CASING	WEIGHT PER FOOT	SETTING DEPTH	SACKS OF CEMENT	EST. TOP
12 1/4	8 5/8	24	2050	900	SURFACE
7 7/8	5 1/2	15.5	6600	TO BE DETERMINED	SURFACE
BY FLD. CALIPER					

IN ABOVE SPACE DESCRIBE PROPOSED PROGRAM: IF PROPOSAL IS TO DEEPEN OR PLUG BACK, GIVE DATA ON PRESENT PRODUCTIVE ZONE AND PROPOSED NEW PRODUCTIVE ZONE. GIVE BLOWOUT PREVENTER PROGRAM, IF ANY.

I hereby certify that the information above is true and complete to the best of my knowledge and belief.

SIGNATURE Michael J. Newport TITLE LAND MANAGER-PERMIAN BASIN DATE 6-18-91

TYPE OR PRINT NAME MICHAEL J. NEWPORT

TELEPHONE NO. 955-114

(This space for State Use)

APPROVED BY _____ TITLE _____ DATE _____

CONDITIONS OF APPROVAL, IF ANY:

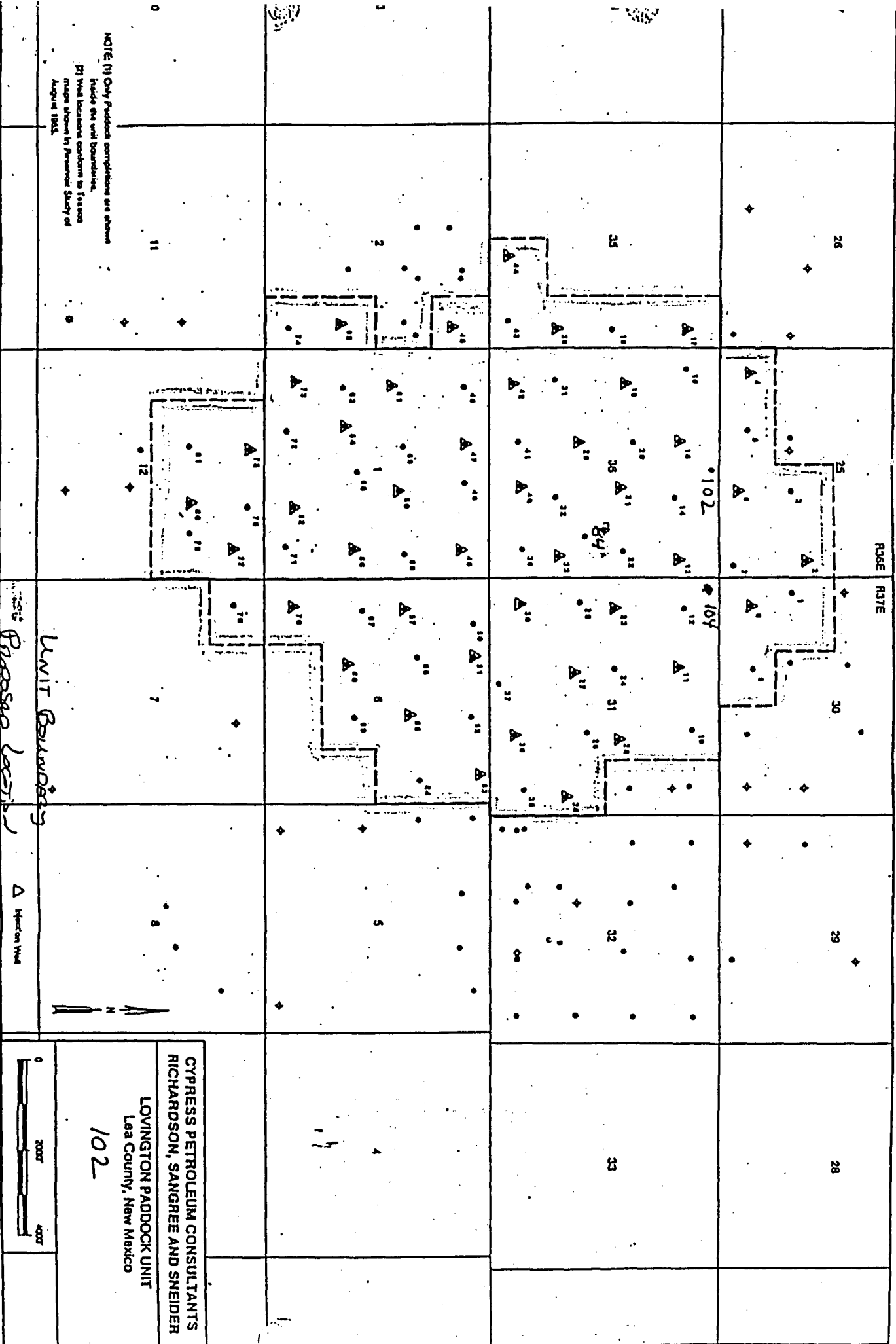

NOTE: (1) Only Paddock completions are shown.
 (2) Well locations conform to Texas maps shown in Petroleum Study of August 1965.

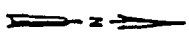

CYPRESS PETROLEUM CONSULTANTS
 RICHARDSON, SANGREE AND SNEIDER
 LOVINGTON PADDOCK UNIT
 Lea County, New Mexico
 102