

**MARSHALL Pipe & Supply Company**

Drilling

Producing

OIL CONSERVATION DIVISION  
RECEIVED

J. W. Marshall  
Dallas, Texas  
RESIDENCE  
(214) 239-7284

13423 FORESTWAY DRIVE  
DALLAS, TEXAS 75240  
(214) 239-7284  
Fax (214) 991-2731

'92 OCT 1 PM 8 53

September 29th, 1992

State of New Mexico  
Energy, Minerals and Natural Resources Department  
P.O. Box 2088  
Santa Fe, New Mexico 87501

Attn: Mr. Michael E. Stogner

Re: Stoltenberg #1 (Re-Entry)  
Unit F, Section 26, T2S, R29E  
Roosevelt County, New Mexico  
API No. 30-041-20809

Dear Mr. Stogner:

We made application, Form C-101, to Re-enter our Stoltenberg #1 well drilled in 1986 and plugged as a dry hole, plugged December 15th, 1986.

We enclose copy of our Form C-102 showing our Stoltenberg #1 on 320 acre spacing.

Upon receipt of approval to re-enter the Stoltenberg #1 dated August 24th, 1992, we re-entered this well and have a gas well at 2920 to 2930 in the Glorieta formation. Mrs. Evelyn Downs in your Hobbs office advises that this depth producing gas formation requires 160 acre spacing. This change places the Stoltenberg #1 in an unorthodox location.

May we respectfully request administrative procedure to approve this unorthodox location.

Marshall Pipe & Supply Company is offset Operator of all leases surrounding this location with 160 acres area.

We enclose seismic map showing location of the Stoltenberg #1, and all surrounding leases, showing names of leases and wells.

If you need additional information, please do not hesitate to phone or fax our office

Very truly yours,

MARSHALL PIPE & SUPPLY COMPANY

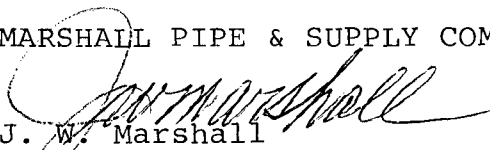
  
J. W. Marshall  
JWM;vlj  
encl:

cc: Oil Conservation Division  
P.O. Box 1980  
Hobbs, New Mexico 88241-1980  
Attn: Evelyn Downs

**MARSHALL Pipe & Supply Company**

Drilling

Producing

J. W. Marshall  
Dallas, Texas  
RESIDENCE  
(214) 239-7284

13423 FORESTWAY DRIVE  
DALLAS, TEXAS 75240  
(214) 239-7284  
Fax (214) 991-2731

September 29th, 1992

State of New Mexico  
Energy, Minerals and Natural Resources Department  
P.O. Box 2088  
Santa Fe, New Mexico 87501

Attn: Mr. Michael E. Stogner

Re: Stoltenberg #1 (Re-Entry)  
Unit F, Section 26, T2S, R29E  
Roosevelt County, New Mexico  
API No. 30-041-20809

Dear Mr. Stogner:

This is to advise that

MARSHALL PIPE & SUPPLY COMPANY

is the offset operator to all leases surrounding the Stoltenberg #1.

We approve of the location of this well, and will in no way protest same.

Our wells and acreage surrounding the Stoltenberg #1 are shown and detailed on the enclosed seismic map.

Thanking you, we are,

Very truly yours,

MARSHALL PIPE & SUPPLY COMPANY

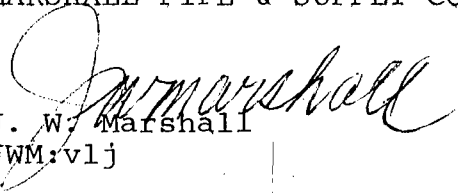
  
J. W. Marshall  
JWM:vlj



STATE OF NEW MEXICO  
ENERGY, MINERALS AND NATURAL RESOURCES DEPARTMENT

OIL CONSERVATION DIVISION

RECEIVED

OIL CONSERVATION DIVISION  
HOBBS DISTRICT OFFICE

'92 OCT 1 PM 8 53

BRUCE KING  
GOVERNOR

August 24, 1992

POST OFFICE BOX 1980  
HOBBS, NEW MEXICO 88241-1980  
(505) 393-6161

Marshall Pipe & Supply Company  
13423 Forestway Drive  
Dallas, TX 75240

Attn: Mr. J. W. Marshall

RE: Proposed Re-entry  
Stoltenberg #1  
Unit F, Sec.26, T2S, R29E  
Roosevelt County, NM

Gentlemen:

We have approved your intent to re-enter the above-referenced well and attempt a gas well completion in either the Yates or San Andres formations.

This is to advise that this approval is for re-entry work only. The Yates and San Andres gas well proration units are 160 acres with well location no nearer than 660 feet to the outer boundary of the 160 acre tract. Therefore, before this well can be produced as a gas well from either of these zones you must obtain approval of the unorthodox location.

You should be able to obtain approval of the unorthodox location by the administrative procedure since this is a re-entry of a well previously drill at a standard for the proposed targeted zone.

Should you have any questions, please contact Evelyn Downs or myself at (505) 393-6161.

Very truly yours,

OIL CONSERVATION DIVISION

Jerry Sexton  
Supervisor, District I

ed



Submit to Appropriate District Office.  
State Lease - 6 copies  
Fee Lease - 5 copies

State of New Mexico  
Energy, Minerals and Natural Resources Department

Form C-101  
Revised 1-1-89

**OIL CONSERVATION DIVISION**

P.O. Box 2088  
Santa Fe, New Mexico 87504-2088

DISTRICT I  
P.O. Box 1980, Hobbs, NM 88240

DISTRICT II  
P.O. Drawer DD, Artesia, NM 88210

DISTRICT III  
1000 Rio Brazos Rd., Aztec, NM 87410

API NO. (assigned by OCD on New Wells) <u>30-041-20809</u>
5. Indicate Type of Lease STATE <input type="checkbox"/> FEE <input checked="" type="checkbox"/>
6. State Oil & Gas Lease No.

<b>APPLICATION FOR PERMIT TO DRILL, DEEPEN, OR PLUG BACK</b>					
1a. Type of Work: DRILL <input type="checkbox"/> RE-ENTER <input checked="" type="checkbox"/> DEEPEN <input type="checkbox"/> PLUG BACK <input type="checkbox"/>	7. Lease Name or Unit Agreement Name Stoltenberg				
b. Type of Well: OIL WELL <input type="checkbox"/> GAS WELL <input checked="" type="checkbox"/> OTHER (Dry Hole - <u>Wanting to Re-Enter</u> ) SINGLE ZONE <input type="checkbox"/> MULTIPLE ZONE <input type="checkbox"/>	8. Well No. 1				
2. Name of Operator MARSHALL PIPE & SUPPLY COMPANY	9. Pool name or Wildcat Wildcat				
3. Address of Operator 13423 Forestway Dr., Dallas, Texas 75240					
4. Well Location Unit Letter <u>F</u> : <u>1650</u> Feet From The <u>North</u> Line and <u>2310</u> Feet From The <u>West</u> Line Section <u>26</u> Township <u>2S</u> Range <u>29E</u> NMPM <u>Roosevelt</u> County					
10. Proposed Depth 3500'	11. Formation San Andres/Yates				
12. Rotary or C.T. Rotary					
13. Elevations (Show whether DF, RT, GR, etc.) 4394 GL	14. Kind & Status Plug Bond Blanket #798G88				
15. Drilling Contractor LA United Drlg, Inc.	16. Approx. Date Work will start Sept. 9th, 1992				
17. The following Equip <u>PROPOSED CASING AND CEMENT PROGRAM</u> already set in this well					
SIZE OF HOLE	SIZE OF CASING	WEIGHT PER FOOT	SETTING DEPTH	SACKS OF CEMENT	EST. TOP
17-1/2	13-3/8	48#	331	250	circulated
11	8-5/8	24#	2128	500/200	circulated

We plan to re-enter this well, drill out the cement plugs. Set 4-1/2" 11.60# casing, LT&C, and test two zones, the San Andres at 2900' and Yates at 2460'.

Blow-Out Preventer will be utilized below 2300'.

IN ABOVE SPACE DESCRIBE PROPOSED PROGRAM: IF PROPOSAL IS TO DEEPEN OR PLUG BACK, GIVE DATA ON PRESENT PRODUCTIVE ZONE AND PROPOSED NEW PRODUCTIVE ZONE. GIVE BLOWOUT PREVENTER PROGRAM, IF ANY.

I hereby certify that the information above is true and complete to the best of my knowledge and belief.

SIGNATURE J. W. Marshall TITLE Partner/Operator DATE 8-20-92  
TYPE OR PRINT NAME J. W. Marshall TELEPHONE NO. 214-239-7284

(This space for State Use) ORIGINAL SIGNED BY JERRY SEXTON  
DISTRICT I SUPERVISOR

AUG 24 '92

APPROVED BY \_\_\_\_\_ TITLE \_\_\_\_\_ DATE \_\_\_\_\_

CONDITIONS OF APPROVAL, IF ANY:

Approved for RE-ENTRY work only--well cannot be produced as gas well from San Andres or Yates without approval of unorthodox location.

Permit Expires 6 Months From Approval Date Unless Drilling Underway.

Re-entry

All distances must be from the outer boundaries of the Section.

Operator Marshall Pipe & Supply		Lease Stoltenberg			Well No. 1
Unit Letter F	Section 26	Township 2 South	Range 29 East	County Roosevelt	
Actual Footage Location of Well: 1650 feet from the North line and 2310 feet from the West line					
Ground Level Elev. 4394	Producing Formation Montoya		Pool WC	Dedicated Acreage: 320 if gas Acres	

1. Outline the acreage dedicated to the subject well by colored pencil or hatchure marks on the plat below.
2. If more than one lease is dedicated to the well, outline each and identify the ownership thereof (both as to working interest and royalty).
3. If more than one lease of different ownership is dedicated to the well, have the interests of all owners been consolidated by communitization, unitization, force-pooling, etc.?

Yes  No If answer is "yes," type of consolidation Communitization

If answer is "no," list the owners and tract descriptions which have actually been consolidated. (Use reverse side of this form if necessary.) \_\_\_\_\_

No allowable will be assigned to the well until all interests have been consolidated (by communitization, unitization, forced-pooling, or otherwise) or until a non-standard unit, eliminating such interests, has been approved by the Division.

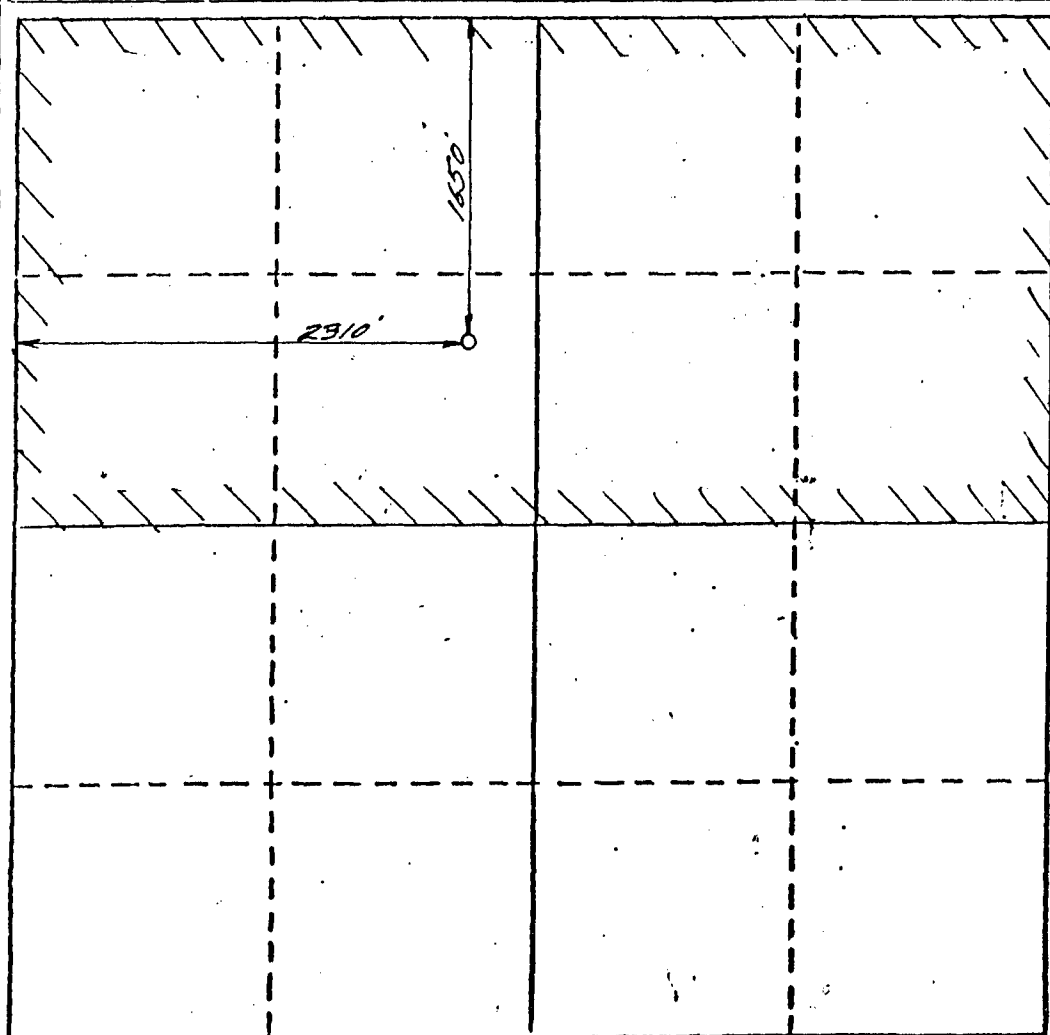

CERTIFICATION

I hereby certify that the information contained herein is true and complete to the best of my knowledge and belief.

*J. W. Marshall*  
Name J. W. Marshall  
Partner  
Position  
Marshall Pipe & Supply  
Company  
August 5th, 1986  
Date

I hereby certify that the well location shown on this plat was plotted from field notes of actual surveys made by me or under my supervision, and that the same is true and correct to the best of my knowledge and belief.

July 19, 1986  
Date Surveyed  
P. R. Patton  
Registered Professional Surveyor  
and/or Land Surveyor  
8112

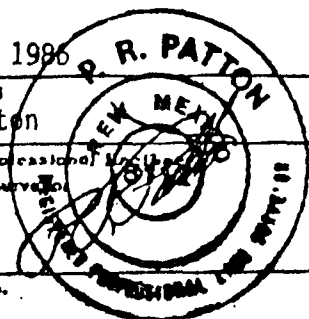

Certificate No.



# MARSHALL Pipe & Supply Company

Drilling

Producing

13423 FORESTWAY DRIVE

DALLAS, TEXAS 75240

(214) 239-7284

Fax (214) 991-2731

J. W. Marshall

Dallas, Texas

RESIDENCE

(214) 233-7881

August 20th, 1992

Re: STOLTENBERG #1 - Re-Entry  
Section 26, T2S, R29E  
Roosevelt County, New Mexico

## BLOW-OUT EQUIPMENT:

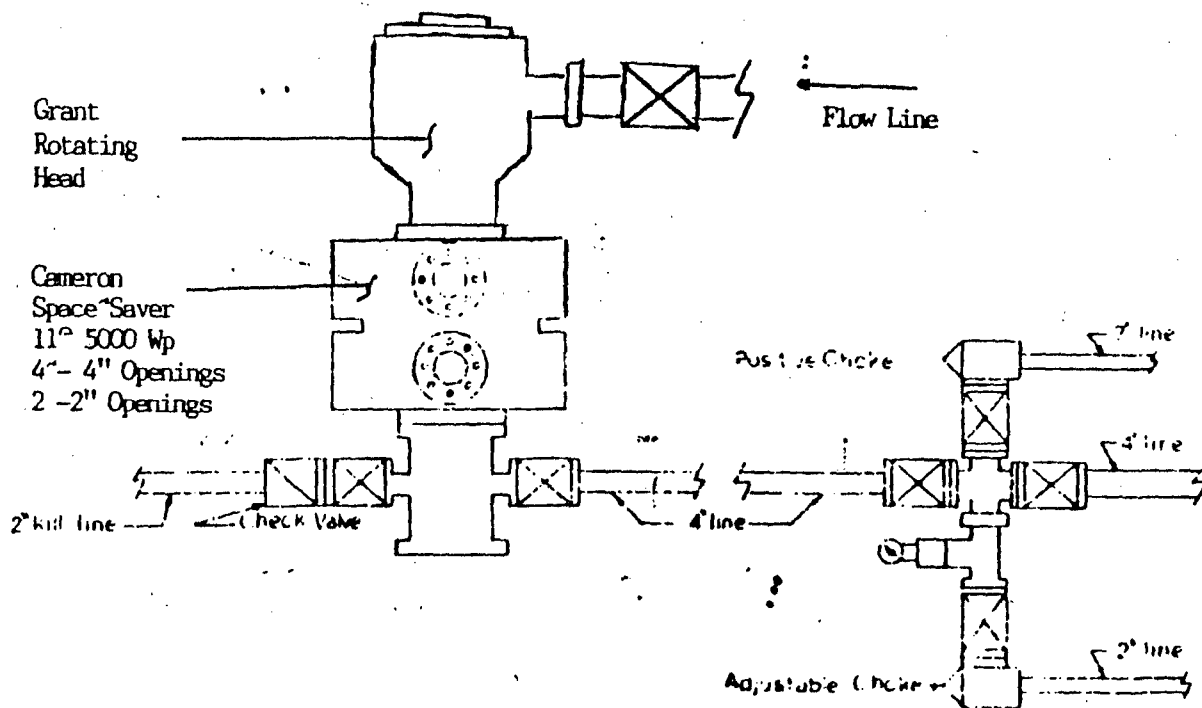











STATE OF NEW MEXICO

ENERGY, MINERALS AND NATURAL RESOURCES DEPARTMENT

RECEIVED

OIL CONSERVATION DIVISION  
HOBBS DISTRICT OFFICE

'92 OCT 5 PM 10 04

10-1-92

BRUCE KING  
GOVERNOR

POST OFFICE BOX 1980  
HOBBS, NEW MEXICO 88241-1980  
(505) 393-6161

NSL - 3174

OIL CONSERVATION DIVISION  
P. O. BOX 2088  
SANTA FE, NEW MEXICO 87501

RE: Proposed:

- MC \_\_\_\_\_
- DHC \_\_\_\_\_
- NSL  \_\_\_\_\_
- NSP \_\_\_\_\_
- SWD \_\_\_\_\_
- WFX \_\_\_\_\_
- PMX \_\_\_\_\_

Gentlemen:

I have examined the application for the:

Marshall Pipes & Supply Co. Stollenberg #1-F 26-28-29E  
Operator Lease & Well No. Unit P-T-R

and my recommendations are as follows:

OK  
\_\_\_\_\_  
\_\_\_\_\_  
\_\_\_\_\_

Yours very truly,

Jerry Sexton  
Supervisor, District 1

/ed