

T
17
S

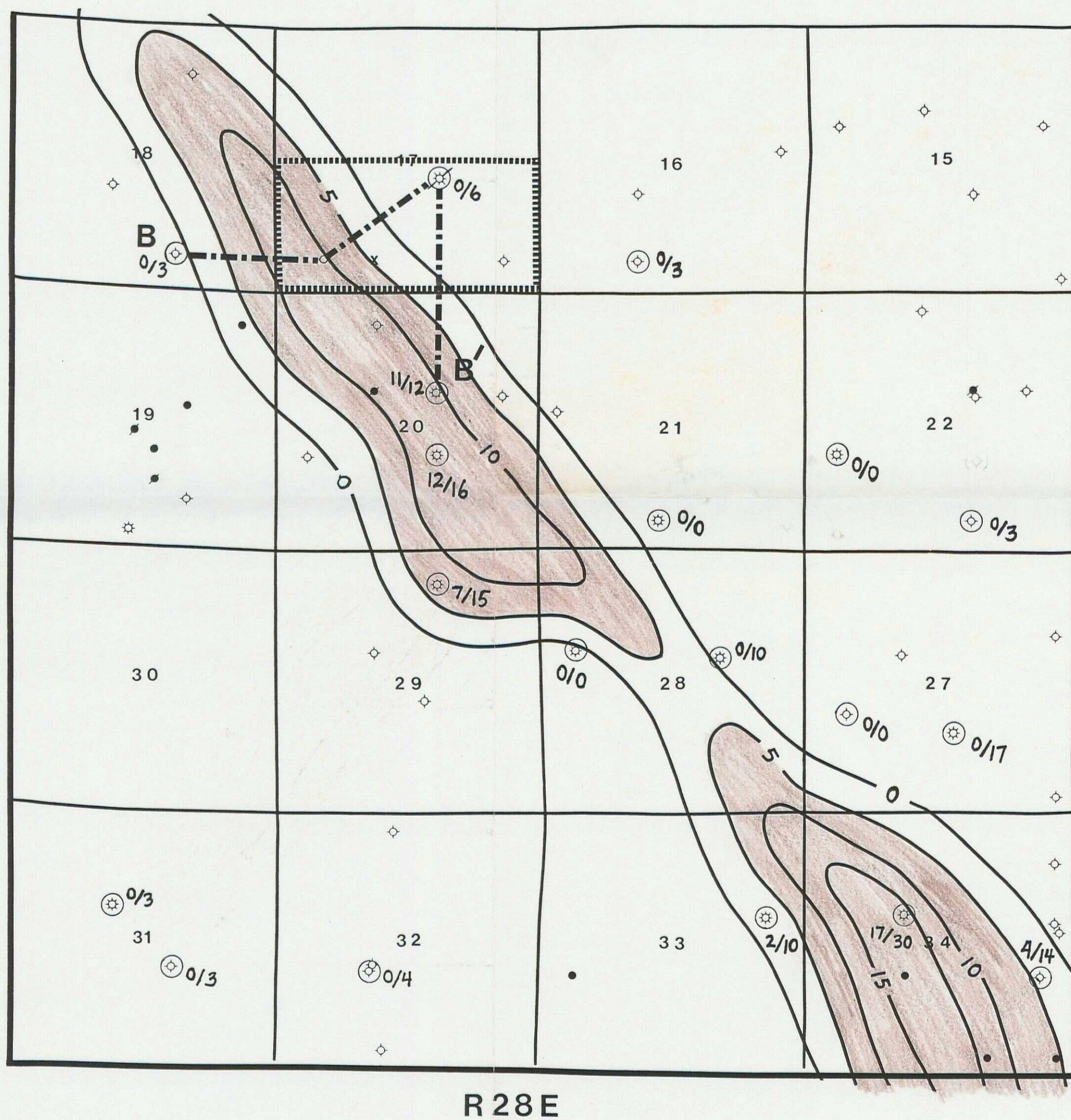

MEWBOURNE OIL COMPANY

MIDLAND, TEXAS DISTRICT

LOGAN DRAW PROSPECT
EDDY COUNTY, NEW MEXICO

LOWER MORROW "BROWN" ZONE
NET SAND ISOPACH

C.I. = 5'

NET 0' ≥ 7%
GROSS

OCTOBER 1989

MAP SCALE 1" = 2000'

DAVE SHATZER