



Chevron U.S.A. Production Company

P.O. Box 1150, Midland, TX 79702 DIVISION

RECEIVED

'93 JUN 28 AM 10 49

June 23, 1993

ADMINISTRATIVE APPLICATION FOR
UNORTHODOX GAS WELL LOCATION
AND SIMULTANEOUS DEDICATION
BLINEBRY OIL AND GAS POOL
J. N. CARSON NCT-A WELL # 7
810' FNL AND 2180' FEL
SECTION 33, T21S, R37E
LEA COUNTY, NEW MEXICO

State of New Mexico
Energy, Minerals & Natural Resources Dept.
Oil Conservation Division
P.O. Box 2088
Santa Fe, New Mexico 87504

Attention: Mr. William J. LeMay - Director

Gentlemen:

Chevron U.S.A. Inc. respectfully requests administrative approval for an unorthodox gas well location on the J. N. Carson NCT-A well # 7. This well is in an existing non-standard gas proration unit, which consists of 160 acres. Currently J. N. Carson wells # 9 and # 10 are simultaneously dedicated to this 160 acre proration unit. Well # 7 is being proposed to be abandoned in the current Drinkard zone and recompleted into the Blinebry Oil & Gas zone. All three wells are proposed to be simultaneously dedicated to this 160 acre proration unit. In support of this application, Chevron U.S.A. Inc. states the following facts:

- 1) The 160 acre gas proration unit is already approved.
- 2) Well # 9 produces approximately 0 bopd and 480 mcfpd and well # 10 produces approximately 4 bopd and 200 mcfpd. The allowable is set at approximately 1250 mcfpd, which leaves about 570 mcfpd available.

June 23, 1993

- 3) Chevron's J. N. Carson well no 7 is located 510' from the southern border and 460' from the western border of the proration unit. The closest Blinebry well is Mobil's E. O. Carson # 14, located at 731' FNL & 1909' FWL of Section 33, approximately 1100' west of well # 7.

Attached is a plat outlining the proration unit with the location of wells 7, 9, and 10, and a map showing all offset properties and wells.

Chevron U.S.A. Inc. has mailed, by certified mail, a copy of this application to the offset Operators.

In view of the facts submitted, Chevron U.S.A. Inc. requests that administrative approval of this request be granted. If additional information is required, please contact me at (915) 687-7152.

Sincerely,

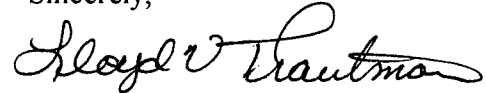
Lloyd V. Trautman
Sr. Petroleum Engineer

Attachments

cc: NMOCD - Hobbs
D.L. Lovell
F.S. Godbold / J.K. Ripley/PRU File
R.E. Green / D.C. Heese
O.G. Brown / J.A. Carter
J. Howard
M.W. Kamm / P.C. Harris
Central Files - Lease and Well Files

Submit to Appropriate
District Office
State Lease - 4 copies
Fee Lease - 3 copies

State of New Mexico
Energy, Minerals and Natural Resources Department

Form C-102
Revised 1-1-89

OIL CONSERVATION DIVISION

P.O. Box 2088

Santa Fe, New Mexico 87504-2088

DISTRICT I

P.O. Box 1980, Hobbs, NM 88240

DISTRICT II

P.O. Drawer DD, Artesia, NM 88210

DISTRICT III

1000 Rio Brazos Rd., Aztec, NM 87410

WELL LOCATION AND ACREAGE DEDICATION PLAT

All Distances must be from the outer boundaries of the section

Operator Chevron USA Inc			Lease J.N. Carson NCT-A		Well No. 7
Unit Letter B	Section 33	Township 21S	Range 37E	County Lea	

Actual Footage Location of Well:

810' feet from the North line and 2180' feet from the East line			
Ground level Elev. 3459	Producing Formation Blinberry Gas	Pool Blinberry Oil & Gas	Dedicated Acreage: 160 Acres

1. Outline the acreage dedicated to the subject well by colored pencil or hatchure marked the plat below.

2. If more than one lease is dedicated to the well, outline each and identify the ownership thereof (both as to working interest and royalty).

3. If more than one lease of different ownership is dedicated to the well, have the interest of all owners been consolidated by communitization, unitization, force-pooling, etc.?

☐ Yes

☐ No

If answer is "yes" type of consolidation

If answer is "no" list the owners and tract descriptions which have actually been consolidated. (Use reverse side of this form if necessary.)

No allowable will be assigned to the well until all interests have been consolidated (by communitization, unitization, forced-pooling, or otherwise) or until a non-standard unit, eliminating such interest, has been approved by the Division.

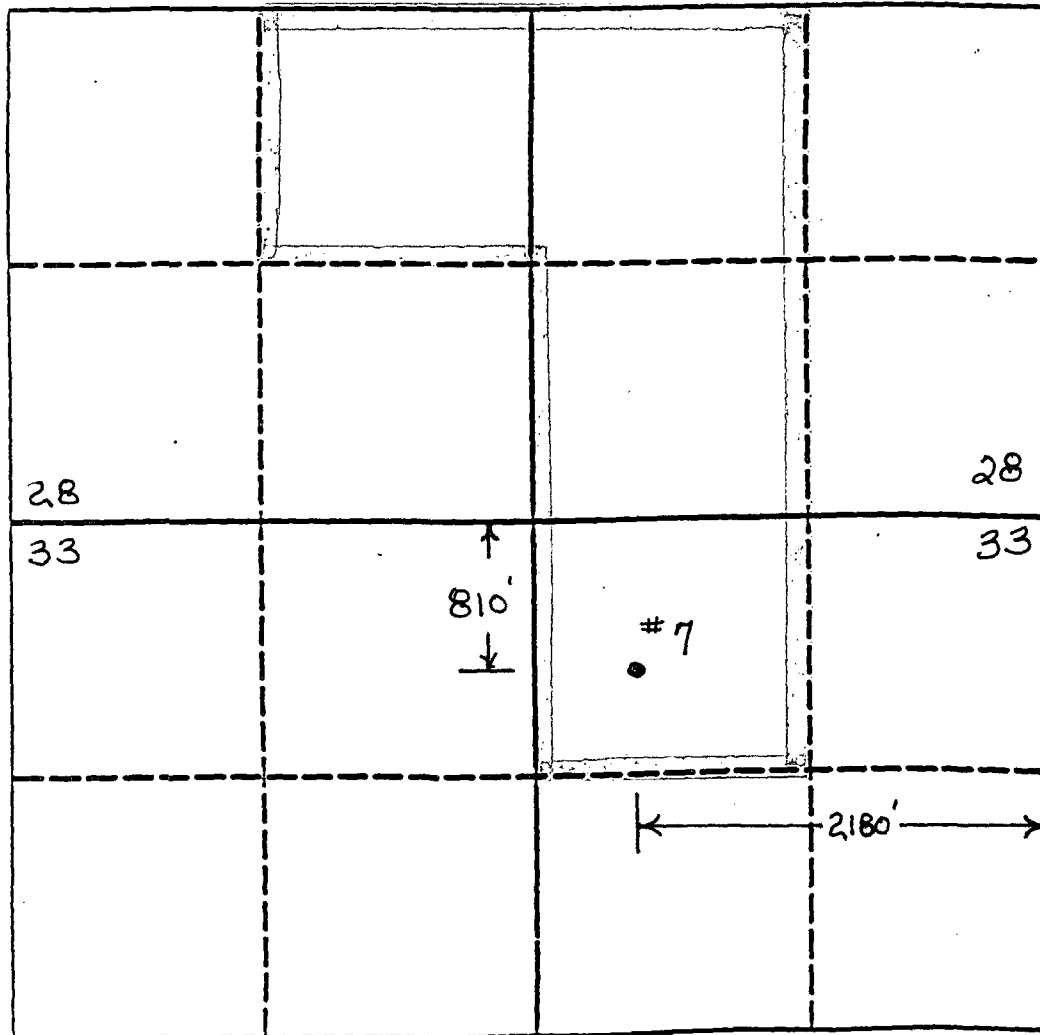

OPERATOR CERTIFICATION

I hereby certify that the information contained herein is true and complete to the best of my knowledge and belief.

Signature

Lloyd V. Trautman

Printed Name

Lloyd V. Trautman

Position

Sr. Petroleum Engineer

Company

Chevron USA

Date

6/21/93

SURVEYOR CERTIFICATION

I hereby certify that the well location shown on this plat was plotted from field notes of actual surveys made by me or under my supervision, and that the same is true and correct to the best of my knowledge and belief.

Date Surveyed

Signature & Seal of
Professional Surveyor

Certificate No.

0 330 660 990 1320 1650 1980 2310 2640 2000 1500 1000 500 0

OIL CONSERVATION DIVISION

DISTRICT I
P.O. Box 1980, Hobbs, NM 88240

DISTRICT II
P.O. Drawer DD, Artesia, NM 88210

DISTRICT III
1000 Rio Brazos Rd., Aztec, NM 87410

P.O. Box 2088
Santa Fe, New Mexico 87504-2088

WELL LOCATION AND ACREAGE DEDICATION PLAT

All Distances must be from the outer boundaries of the section

Operator Chevron USA Inc			Lease J. N. Carson NCT-A		Well No. 9
Unit Letter K	Section 28	Township 21S	Range 37E	County Lea	
Actual Footage Location of Well: 1874 feet from the South line and 2086 feet from the West line					
Ground level Elev. 3450'		Producing Formation Blinebry Oil & Gas		Pool Blinebry Oil & Gas	
				Dedicated Acreage: 160	Acres

- Outline the acreage dedicated to the subject well by colored pencil or hatchure marks on the plat below.
- If more than one lease is dedicated to the well, outline each and identify the ownership thereof (both as to working interest and royalty).
- If more than one lease of different ownership is dedicated to the well, have the interest of all owners been consolidated by communitization, unitization, force-pooling, etc?
☐ Yes ☐ No If answer is "yes" type of consolidation _____
If answer is "no" list the owners and tract descriptions which have actually been consolidated. (Use reverse side of this form if necessary.)
No allowable will be assigned to the well until all interests have been consolidated (by communitization, unitization, forced-pooling, or otherwise) or until a non-standard unit, eliminating such interest, has been approved by the Division.

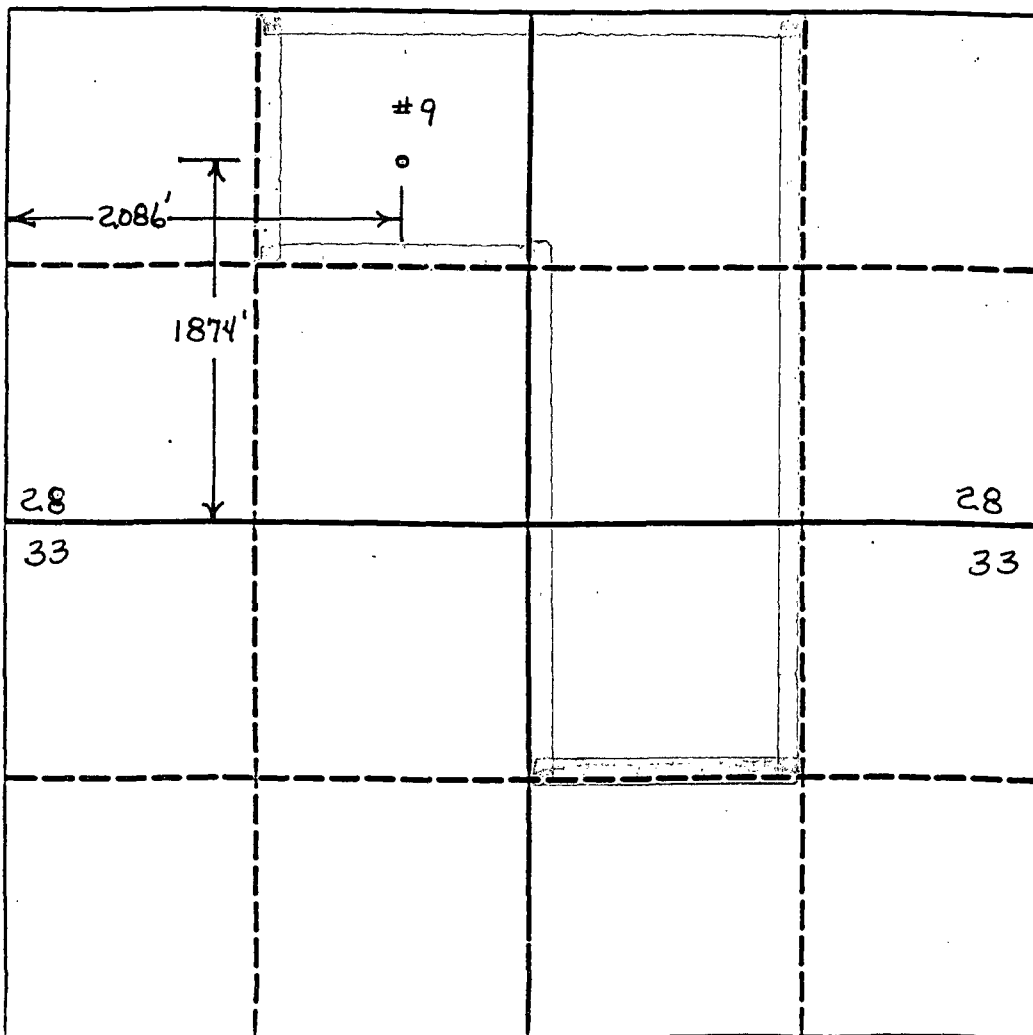

OPERATOR CERTIFICATION

I hereby certify that the information contained herein is true and complete to the best of my knowledge and belief.

Signature

Lloyd V. Trautman

Printed Name

Lloyd V. Trautman

Position

Sr. Petroleum Engineer

Company

Chevron USA

Date

6/21/93

SURVEYOR CERTIFICATION

I hereby certify that the well location shown on this plat was plotted from field notes of actual surveys made by me or under my supervision, and that the same is true and correct to the best of my knowledge and belief.

Date Surveyed

Signature & Seal of
Professional Surveyor

Certificate No.

0 330 660 990 1320 1650 1980 2310 2640 2000 1500 1000 500 0

Submit to Appropriate
District Office
State Lease - 4 copies
Fee Lease - 3 copies

State of New Mexico
Energy, Minerals and Natural Resources Department

Form C-102
Revised 1-1-89

OIL CONSERVATION DIVISION

P.O. Box 2088

Santa Fe, New Mexico 87504-2088

DISTRICT I

P.O. Box 1980, Hobbs, NM 88240

DISTRICT II

P.O. Drawer DD, Artesia, NM 88210

DISTRICT III

1000 Rio Brazos Rd., Aztec, NM 87410

WELL LOCATION AND ACREAGE DEDICATION PLAT

All Distances must be from the outer boundaries of the section

Operator Chevron USA Inc			Lease J.N. Carson NCT-A		Well No. 10
Unit Letter J	Section 28	Township 21S	Range 37E	County Lea	
Actual Footage Location of Well: 1980 feet from the South line and 2180 feet from the East line					
Ground level Elev. 3442'	Producing Formation Blinberry Oil & Gas		Pool Blinberry Oil & Gas		Dedicated Acreage: 160 Acres
<p>1. Outline the acreage dedicated to the subject well by colored pencil or hatchure marks on the plat below.</p> <p>2. If more than one lease is dedicated to the well, outline each and identify the ownership thereof (both as to working interest and royalty).</p> <p>3. If more than one lease of different ownership is dedicated to the well, have the interest of all owners been consolidated by communitization, unitization, force-pooling, etc.? <input type="checkbox"/> Yes <input type="checkbox"/> No If answer is "yes" type of consolidation _____</p> <p>If answer is "no" list the owners and tract descriptions which have actually been consolidated. (Use reverse side of this form if necessary.) _____</p> <p>No allowable will be assigned to the well until all interests have been consolidated (by communitization, unitization, forced-pooling, or otherwise) or until a non-standard unit, eliminating such interest, has been approved by the Division.</p>					

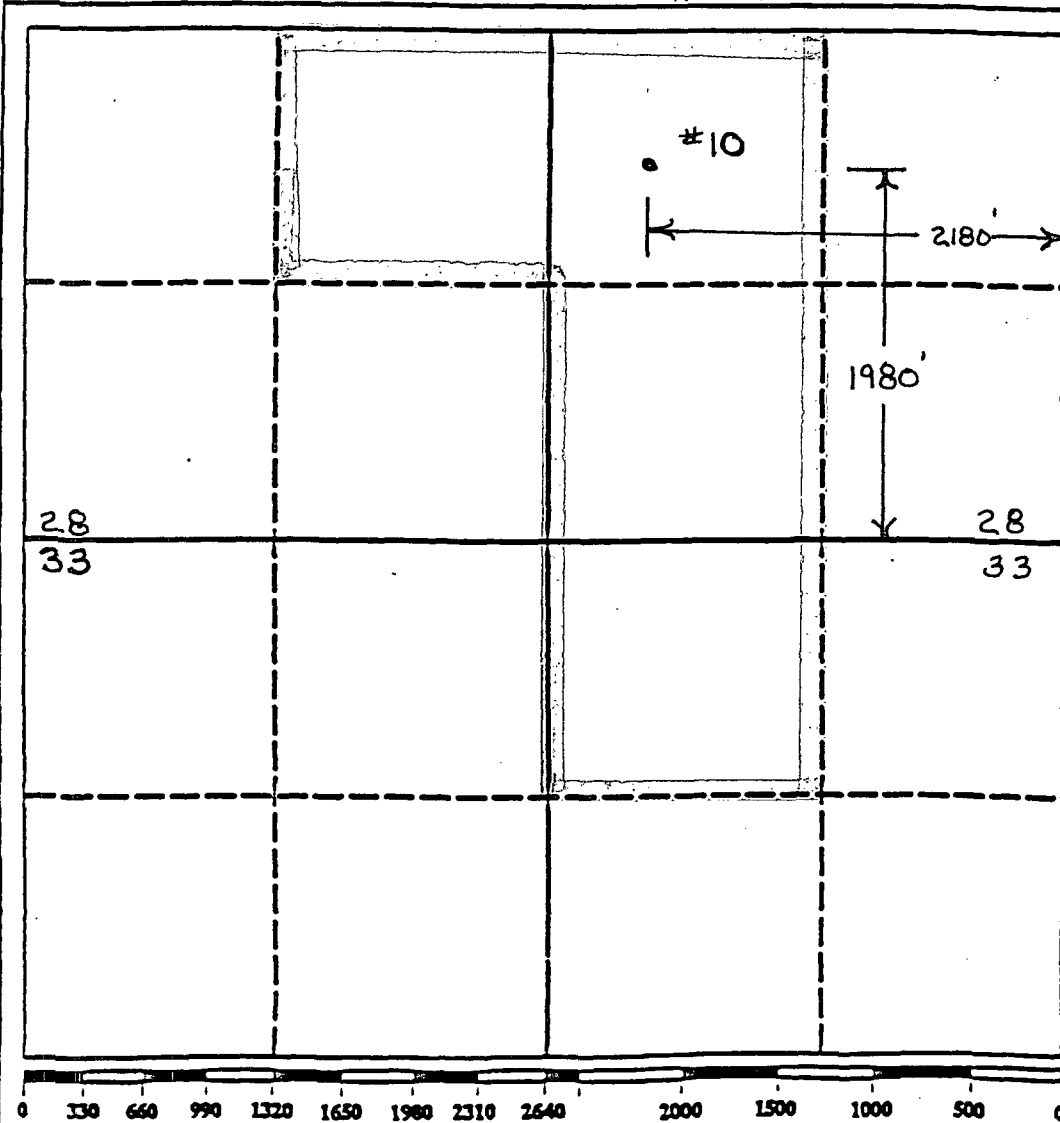

OPERATOR CERTIFICATION

I hereby certify that the information contained herein is true and complete to the best of my knowledge and belief.

Signature

Lloyd V. Trautman

Printed Name

Lloyd V. Trautman

Position

Sr Petroleum Engineer

Company

Chevron USA Inc

Date

6/21/93

SURVEYOR CERTIFICATION

I hereby certify that the well location shown on this plat was plotted from field notes of actual surveys made by me or under my supervision, and that the same is true and correct to the best of my knowledge and belief.

Date Surveyed

Signature & Seal of
Professional Surveyor

Certificate No.

CHEVRON U.S.A. INC.

UNORTHODOX GAS WELL LOCATION
AND SIMULTANEOUS DEDICATION
BLINEBRY OIL AND GAS POOL
J. N. CARSON NCT-A WELL # 7
810' FNL AND 2180' FEL
SECTION 33, T21S, R37E
LEA COUNTY, NEW MEXICO

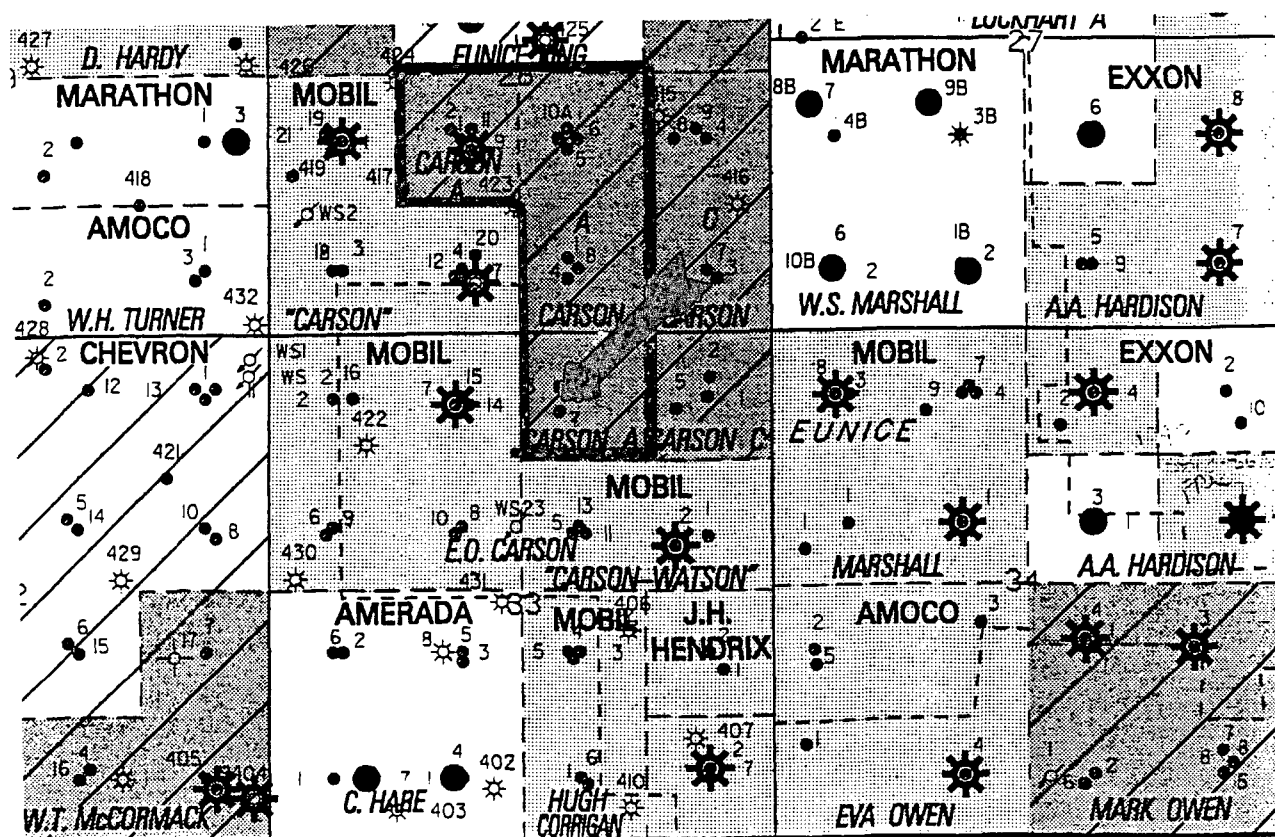

UNORTHODOX GAS WELL LOCATION
AND SIMULTANEOUS DEDICATION
BLINEBRY OIL AND GAS POOL
J. N. CARSON NCT-A WELL #.7
810' FNL AND 2180' FEL
SECTION 33, T21S, R37E
LEA COUNTY, NEW MEXICO

Offset Operators

Mobil Producing Texas and New Mexico
P. O. Box 1800
Hobbs, New Mexico 88240

Amerada Hess Corporation
Dr. D
Monument, New Mexico 88265

Amoco Production Company
200 Amoco Court
Farmington, New Mexico 87401

Marathon Oil Company
Box 552
Midland, Texas 79702

John H. Hendrix Corporation
223 Wall St.
Midland, Texas 79701

BEFORE THE OIL CONSERVATION COMMISSION
OF THE STATE OF NEW MEXICO

IN THE MATTER OF THE HEARING
CALLED BY THE OIL CONSERVATION
COMMISSION OF NEW MEXICO FOR
THE PURPOSE OF CONSIDERING:

CASE NO. 5128
Order No. R-4736

APPLICATION OF GULF OIL CORPORATION
FOR A NON-STANDARD GAS PRORATION
UNIT AND SIMULTANEOUS DEDICATION,
LEA COUNTY, NEW MEXICO.

ORDER OF THE COMMISSION

BY THE COMMISSION:

This cause came on for hearing at 9 a.m. on February 27, 1974, at Santa Fe, New Mexico, before Examiner Daniel S. Nutter.

NOW, on this 6th day of March, 1974, the Commission, a quorum being present, having considered the testimony, the record, and the recommendations of the Examiner, and being fully advised in the premises,

FINDS:

- (1) That due public notice having been given as required by law, the Commission has jurisdiction of this cause and the subject matter thereof.
- (2) That the applicant, Gulf Oil Corporation, seeks approval for a non-standard 160-acre gas proration unit comprising the NE/4 SW/4 and W/2 SE/4 of Section 28, and the NW/4 NE/4 of Section 33, both in Township 21 South, Range 37 East, NMPM, Blinbry Oil and Gas Pool, Lea County, New Mexico.
- (3) That the applicant seeks to simultaneously dedicate to said non-standard unit its J. N. Carson Wells Nos. 4 and 9 located in Units O and K, respectively, of Section 28, with unit production to be taken from said wells in any proportion.
- (4) That the proposed non-standard gas proration unit can be efficiently and economically drained and developed by the subject wells.
- (5) That approval of the subject application will afford the applicant the opportunity to produce its just and equitable share of the gas in the Blinbry Oil and Gas Pool and will otherwise prevent waste and protect correlative rights.

IT IS THEREFORE ORDERED:

(1) That effective at 7:00 a.m. March 1, 1974, the applicant, Gulf Oil Corporation, is hereby authorized to simultaneously dedicate a non-standard 160-acre gas proration unit comprising the NE/4 SW/4 and W/2 SE/4 of Section 28, and the NW/4 NE/4 of Section 33, both in Township 21 South, Range 37 East, NMPM, Blinbry Oil and Gas Pool, Lea County, New Mexico, to its J. N. Carson Wells Nos. 4 and 9 located in Units O and K, respectively, of said Section 28 with unit production to be taken from said wells in any proportion.

(2) That the allowable assigned to the above-described gas proration unit shall be based upon the unit size of 160 acres and that the operator may produce the allowable assigned to the unit from the subject wells in any proportion.

(3) That jurisdiction of this cause is retained for the entry of such further orders as the Commission may deem necessary.

DONE at Santa Fe, New Mexico, on the day and year herein-above designated.

STATE OF NEW MEXICO
OIL CONSERVATION COMMISSION

I. R. TRUJILLO, Chairman

ALEX J. ARMIJO, Member

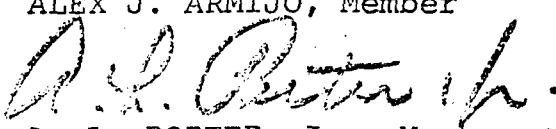
A. L. PORTER, Jr., Member & Secretary

S E A L

dr/