

3R - 223

**ANNUAL
MONITORING
REPORTS**

DATE:

3/2006

2005 ANNUAL GROUNDWATER REPORT **RECEIVED**
FEDERAL SITES VOLUME I

EL PASO TENNESSEE PIPELINE COMPANY MAR 17 2006

Oil Conservation Division
Environmental Bureau

TABLE OF CONTENTS

METER or LINE ID	SITE NAME	TOWNSHIP	RANGE	SECTION	UNIT
89961	Fields A#7A	32N	11W	34	E
89232	Johnston Fed #6A	31N	09W	35	F
94715	James F. Bell #1E	30N	13W	10	P
89620	Sandoval GC A #1A	30N	09W	35	C
LD151	Lat 0-21 Line Drip	30N	09W	12	O
73220	Fogelson 4-1 Com. #14	29N	11W	4	P
97213	Hamner #9	29N	09W	20	A
LD174	LAT L 40	28N	04W	13	H
89894	Hammond #41A	27N	08W	25	O
94810	Miles Fed 1A	26N	07W	5	F
LD072	K27 LD072	25N	06W	4	E
87640	Canada Mesa #2	24N	06W	24	I

3R170

3R202

3R196

3R235

3R213

3R068

3R190

3R212

3R186

3R223

3R204?

3R155



MWH

MONTGOMERY WATSON HARZA

LIST OF ACRONYMS

B	benzene
btoc	below top of casing
E	ethylbenzene
EPFS	El Paso Field Services
ft	foot/feet
GWEL	groundwater elevation
ID	identification
MW	monitoring well
PSH	phase-separated hydrocarbons
NMWQCC	New Mexico Water Quality Control Commission
T	toluene
TOC	top of casing
NA	not applicable
NE	not established
NM	not measured
NMOCD	New Mexico Oil Conservation Division
NS	not sampled
ORC	oxygen-releasing compound
ppb	parts per billion
µg/L	micrograms per liter
X	total xylenes

**EPTPC GROUNDWATER SITES
2005 ANNUAL GROUNDWATER REPORT**

3R223

**Miles Fed 1A
Meter Code: 94810**

SITE DETAILS

Legal Description:	Town:	26N	Range:	7W	Sec:	5	Unit:	F
NMOCD Haz Ranking:	40	Land Type:	Federal	Operator:	Louis Dreyfus Natural Gas			

PREVIOUS ACTIVITIES

Site Assessment:	5/94	Excavation:	6/94	Soil Boring:	9/95
Monitor Well:	9/95	Geoprobe:	2/97	Additional MWs:	10/99
Downgradient MWs:	10/99	Replace MW:	NA	Quarterly Initiated:	NA
ORC Nutrient Injection:	NA	Re-Excavation:	NA	PSH Removal Initiated:	2/99
Annual Initiated:	10/99	Quarterly Resumed:	NA		

SUMMARY OF 2005 ACTIVITIES

MW-1: Quarterly free-product recovery activities and water level monitoring were performed in 2005.

MW-2: Quarterly water level monitoring was performed in 2005.

MW-3: Quarterly water level monitoring was performed in 2005.

Site-Wide Activities: The site was inspected quarterly for hydrocarbon seeps. No seeps were detected. A technology review and data assessment were performed to evaluate free-product removal protocol and methodologies for sites with free-product.

SITE MAP

A site map (2005) is attached in Figure 1.

SUMMARY TABLES AND GRAPHS

- Historic analytical data are presented graphically in Figures 2 through 4.
- Free-product recovery data from 2005 are summarized in Table 1, and historic data are presented graphically in Figure 5.
- Field documentation is presented in Attachment 1 (included on CD).

**EPTPC GROUNDWATER SITES
2005 ANNUAL GROUNDWATER REPORT**

**Miles Fed 1A
Meter Code: 94810**

GEOLOGIC LOGS AND WELL COMPLETION DIAGRAMS

No subsurface activities were performed at this site during 2005.

DISPOSITION OF GENERATED WASTES

All purge water was taken to the El Paso Natural Gas Rio Vista Compressor Station. Phase separated hydrocarbons are stored in a 55 gallon drum and are periodically picked up by Mesa Oil for recycling.

ISOCONCENTRATION MAPS

No isoconcentration maps were prepared for this site, however, the attached site maps present water level data collected during 2005.

CONCLUSIONS

- The groundwater flow direction at this site is toward the northeast.
- Free-product recovery efforts at MW-1 resulted in removal of approximately 0.74 gallons of free-phase hydrocarbons during 2005 bringing the cumulative total recovered to date to approximately 11.83 gallons. Free-product removal in 2004 totaled 0.9 gallons, compared to 0.74 gallons in 2005, demonstrating that product accumulation is decreasing.
- Based on the technology review and free-product removal data for this site, it was concluded that oil-absorbent socks would be the most efficient and cost-effective product removal technique for MW-1 at this time.
- There was no apparent change in product recovery following redevelopment of MW-1 in October 2004.
- No seeps along the well pad slopes were noted during 2005.
- New oil absorbent socks were installed in MW-1 during the April 2005 monitoring event.

**EPTPC GROUNDWATER SITES
2005 ANNUAL GROUNDWATER REPORT**

**Miles Fed 1A
Meter Code: 94810**

RECOMMENDATIONS

- EPTPC will continue to inspect the well pad slopes for evidence of seeps. If a seep is found, photographic documentation will be made and the seep will be sampled.
- Continue with use of oil absorbent socks until free-product recovery efforts are completed at MW-1, this well will be sampled on an annual basis until sample results approach closure criteria. The well will then be scheduled for quarterly sampling until closure criteria are met.
- EPTPC will continue water level monitoring at MW-2 and MW-3, in conjunction with product removal activities. Because historical analyses indicate minimal contamination in MW-2 and MW-3, these wells will not be sampled until free-product recovery efforts at MW-1 are complete. These wells will then be sampled on an annual basis until closure samples are collected.

MW-1	1/25/05	4/14/05	7/19/05	10/21/05
GWEL	6015.20	6015.43	6014.68	6014.96
PRODUCT REMOVED (GALLONS)	0.18	0.11	0.23	0.21

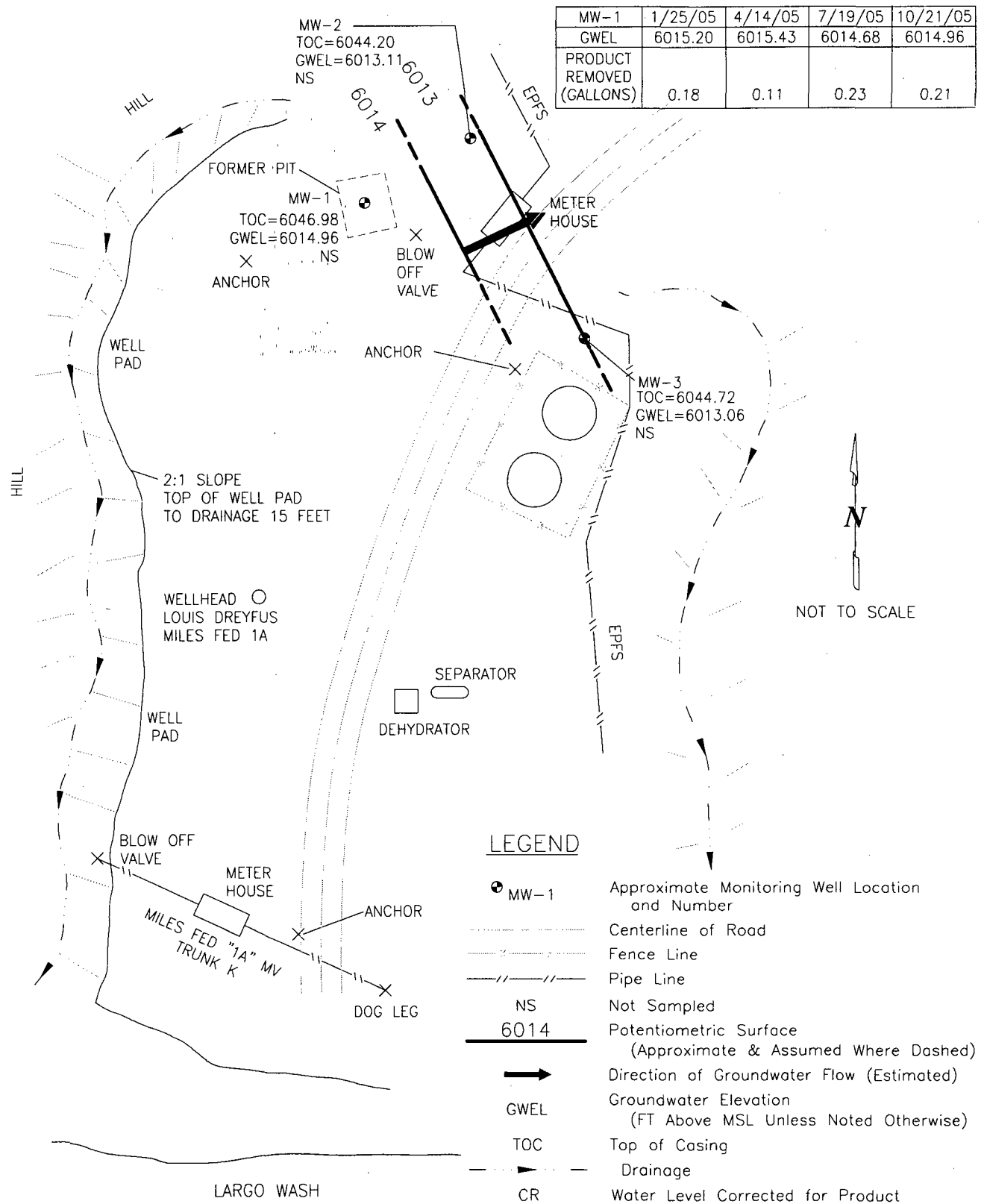

MILES FED 1A, METER 94497
2005

GROUNDWATER SITES
EL PASO TENNESSEE PIPELINE COMPANY

FIGURE 1

TABLE 1

SUMMARY OF FREE-PRODUCT REMOVAL DURING 2005
MILES FED 1A (METER #94810)

Site Name	Monitoring Well	Removal Date	Depth to Product (feet bgs)	Depth to Water (feet bgs)	Product Thickness (feet)	Volume of Product Removed (gallons)	Cummulative Volume of Product Removed (gallons)
Miles Fed 1A	MW-1	1/25/05	31.75	31.91	0.16	0.19	11.28
Miles Fed 1A	MW-1	4/14/05	31.52	31.68	0.16	0.11	11.39
Miles Fed 1A	MW-1	7/19/05	32.32	32.43	0.11	0.23	11.62
Miles Fed 1A	MW-1	10/21/05	0	32.02	0	0.21	11.83

FIGURE 2
HISTORIC BTEX CONCENTRATIONS AND GROUNDWATER ELEVATIONS
MILES FED 1A
MW-1

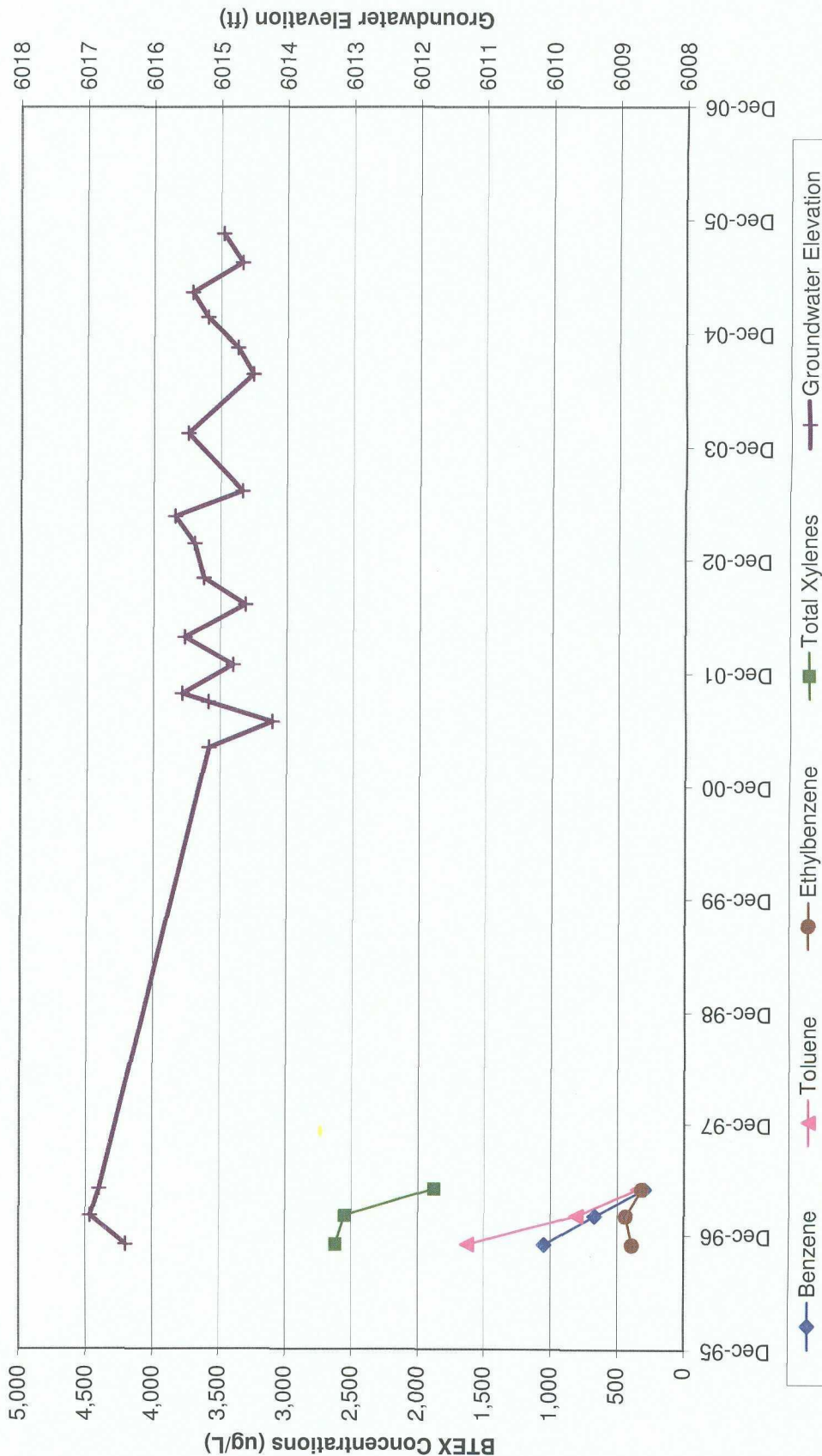

FIGURE 3
HISTORIC BTEX CONCENTRATIONS AND GROUNDWATER ELEVATIONS
MILES FED 1A
MW-2

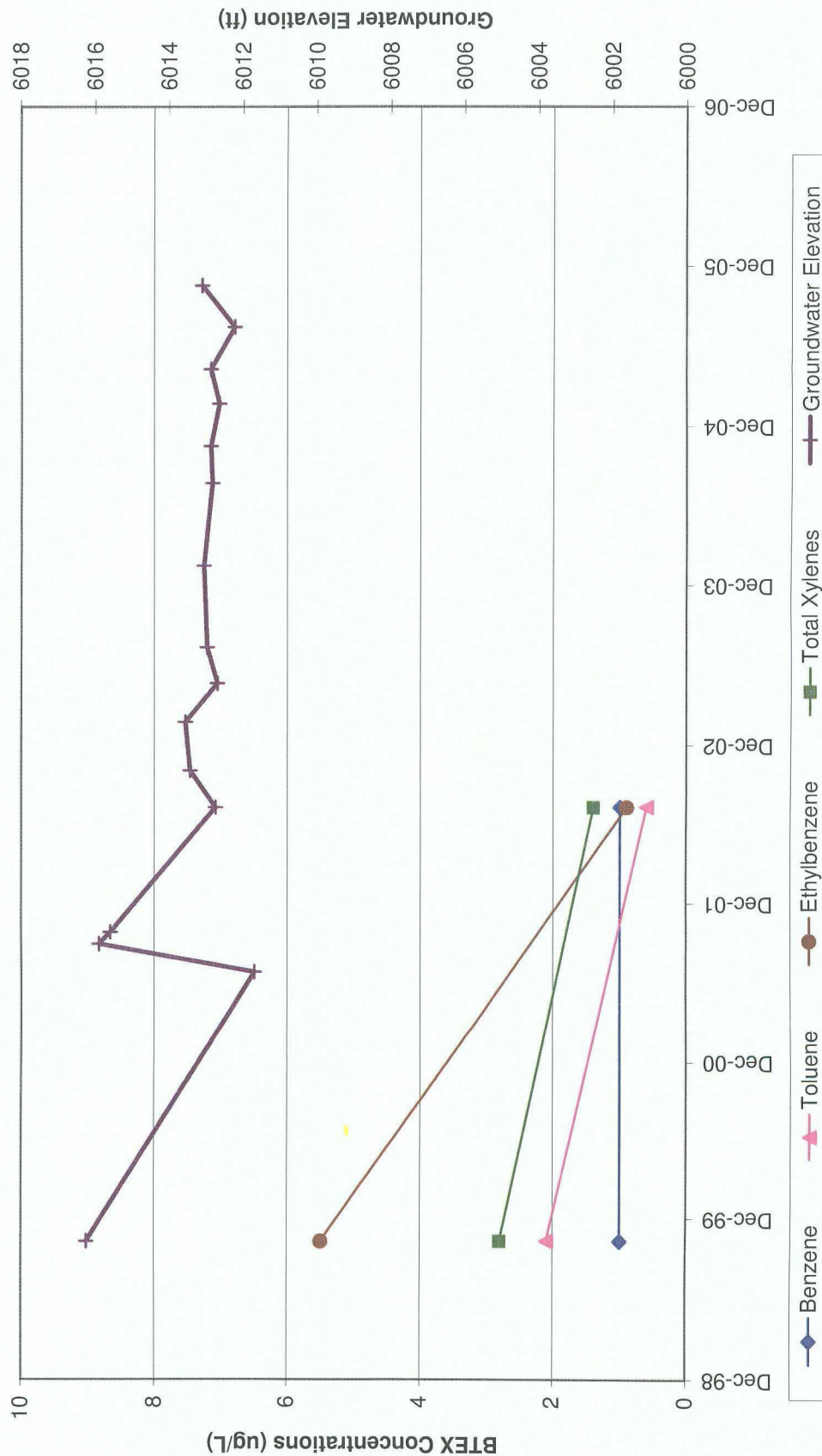

FIGURE 4
HISTORIC BTEX CONCENTRATIONS AND GROUNDWATER ELEVATIONS
MILES FED 1A
MW-3

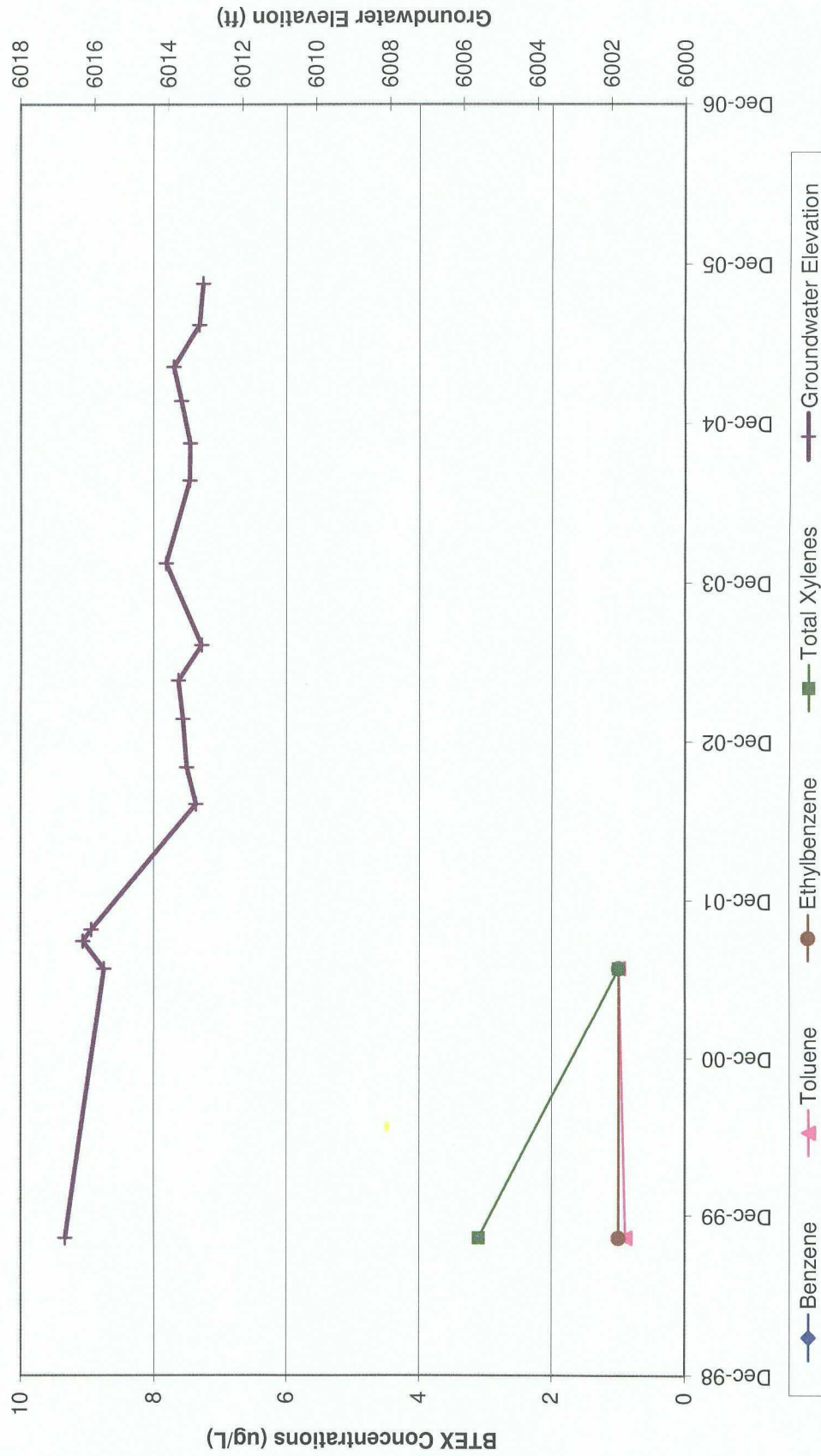

FIGURE 5
HISTORIC FREE-PRODUCT RECOVERY
MILES FED 1A
MW-1

