



ARCO Permian

600 N Marienfeld
Midland TX 79701
Post Office Box 1610
Midland TX 79702
Telephone 915 688-5200

CONSERVATION DIVISION
RECEIVED

January 9, 1995 '95 JAN 13 AM 8 52

Mr. William J. LeMay
New Mexico Oil Conservation Division
P. O. Box 2088
Santa Fe, New Mexico 87501

Mr. J. T. Sexton
New Mexico Oil Conservation Division
P. O. Box 1980
Hobbs, New Mexico 88240

RE: NSP-1685
Application for Unorthodox Eumont Gas Well Location & Simultaneous Dedication
Ernest C. Adkins #13
E/2 Section 9, T-21S, R-36E, Lea County, NM
Eumont (Yates/Seven Rivers/Queen) Gas Pool

Dear Mr. LeMay / Mr. Sexton:

ARCO Permian respectfully requests administrative approval for an unorthodox Eumont gas well location for the Ernest C. Adkins #13 well to be located 1051' FNL, 1980' FEL, Section 9, T-21S, R-36E in Lea County, New Mexico. This location is unorthodox do to being closer than 330' from a quarter-quarter section inner line. It is necessary to be closer than 330' from a quarter-quarter section inner line in order for this well to be drilled 100' away from a primary power line. At the same time, ARCO requests simultaneous dedication of the Eumont gas production from the Ernest C. Adkins #5, #9, and #12 with the Eumont gas production from the Ernest C. Adkins #13 well. The Ernest C. Adkins #5, #9, and #12 are Eumont gas wells currently dedicated to an existing 320-acre proration unit (NSP-1685) comprised of the E/2 Section 9, T-21S, R-36E. ARCO plans to drill the Ernest C. Adkins #13 as soon as this request is approved.

Attached are C-102 forms for the proposed configuration of the subject 320-acre Eumont gas proration unit. Also attached is a list of offset operators for this unit, and a land plat map of the surrounding area.

ARCO Permian believes approval of this request will be in the interest of conservation, will protect correlative rights, and will allow for a more complete recovery of Eumont gas reserves from the subject acreage.

ARCO Permian is notifying the offset operators of this application by sending a copy of this application package, along with waiver to objection forms, by certified mail. If you need further information, please call me at (915) 688-5446.

Sincerely,

David K. Newell
Sr. Operations/Analytical Engineer

cc: K. Murrish - (Hobbs)
Attachments

Offset Operators:

Please indicate your approval for our request as detailed in the attached package by signing the waiver form below. Please return the signed waiver in the enclosed self-addressed, stamped envelope.

Thank you for your cooperation in this matter.

WAIVER TO OBJECTION

ARCO Permian

**Application for an
Unorthodox Eumont Gas Well Location**

Ernest C. Adkins #13

and

Simultaneous Dedication of Eumont Gas Production

Ernest C. Adkins #5, #9, and #12 (existing)

Ernest C. Adkins #13 (new)

Eumont Gas Pool

E/2 Section 9, T-21S, R-36E

Lea County, New Mexico

I/We do hereby waive any objection to ARCO Permian's request for NMOCD Administrative Approval of an unorthodox well location for the Ernest C. Adkins #13, and simultaneous dedication of Eumont gas production from the Ernest C. Adkins #5, #9, #12, and #13 to an existing 320-acre proration unit.

Signed: _____

Title: _____

Company: _____

Date: _____

ARCO Permian
Application for an
Unorthodox Eumont Gas Well Location
Ernest C. Adkins #13

Simultaneous Dedication of Eumont Gas Production
Ernest C. Adkins #5, #9, and #12 (existing)
Ernest C. Adkins #13 (new)
Eumont Gas Pool
E/2 Section 9, T21S, R36E
Lea County, New Mexico

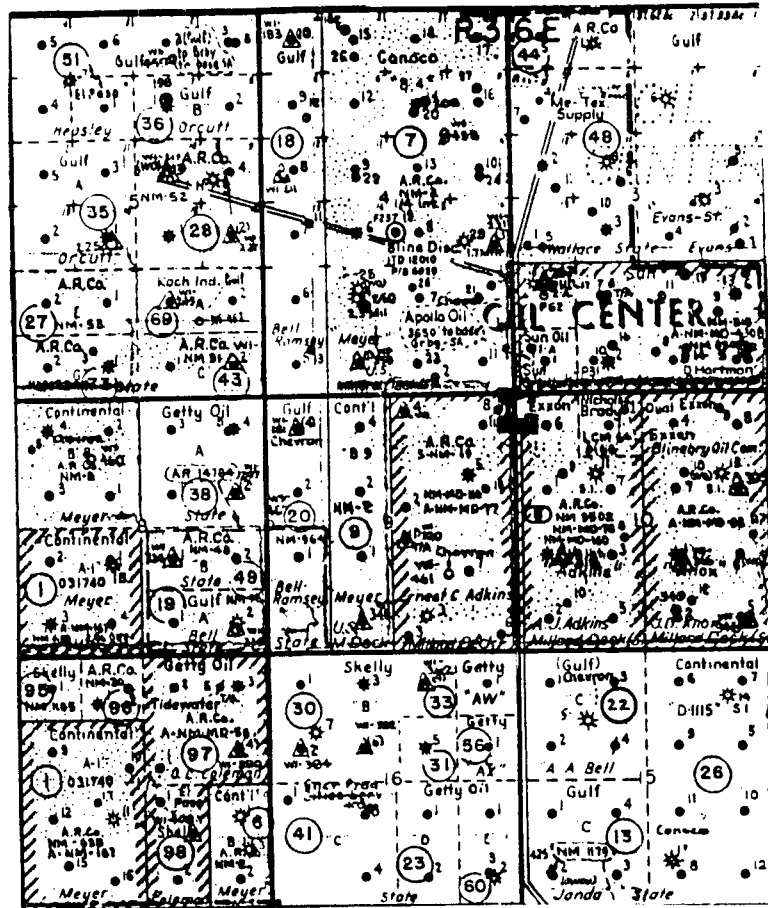

OFFSET OPERATORS

Conoco, Inc.
Texaco Expl. & Prod.
Chevron, USA
Exxon Company, USA
Oryx Energy Co.

Submit to Appropriate
District Office
State Lease - 4 copies
Fee Lease - 3 copies

State of New Mexico
Energy, Minerals and Natural Resources Department

Form C-102
Revised 1-1-89

OIL CONSERVATION DIVISION

P.O. Box 2088
Santa Fe, New Mexico 87504-2088

DISTRICT I
P.O. Box 1980, Hobbs, NM 88240

DISTRICT II
P.O. Drawer DD, Artesia, NM 88210

DISTRICT III
1000 Rio Brazos Rd., Aztec, NM 87410

WELL LOCATION AND ACREAGE DEDICATION PLAT

All Distances must be from the outer boundaries of the section

Operator ARCO PERMIAN			Lease ERNEST C. ADKINS		Well No. 9
Unit Letter 0	Section 9	Township T-21-S	Range R-36-E	County NMPM	LEA
Actual Footage Location of Well: 730 feet from the SOUTH line and 1910 feet from the EAST line					
Ground level Elev. 3590'	Producing Formation YATES/7-RIVERS/QUEEN		Pool EUMONT GAS	Dedicated Acreage: 320 Acres	

1. Outline the acreage dedicated to the subject well by colored pencil or hatchure marks on the plat below.
2. If more than one lease is dedicated to the well, outline each and identify the ownership thereof (both as to working interest and royalty).
3. If more than one lease of different ownership is dedicated to the well, have the interest of all owners been consolidated by communitization, unitization, force-pooling, etc.?
☐ Yes ☐ No If answer is "yes" type of consolidation _____
If answer is "no" list the owners and tract descriptions which have actually been consolidated. (Use reverse side of this form if necessary).
No allowable will be assigned to the well until all interests have been consolidated (by communitization, unitization, forced-pooling, or otherwise) or until a non-standard unit, eliminating such interest, has been approved by the Division.

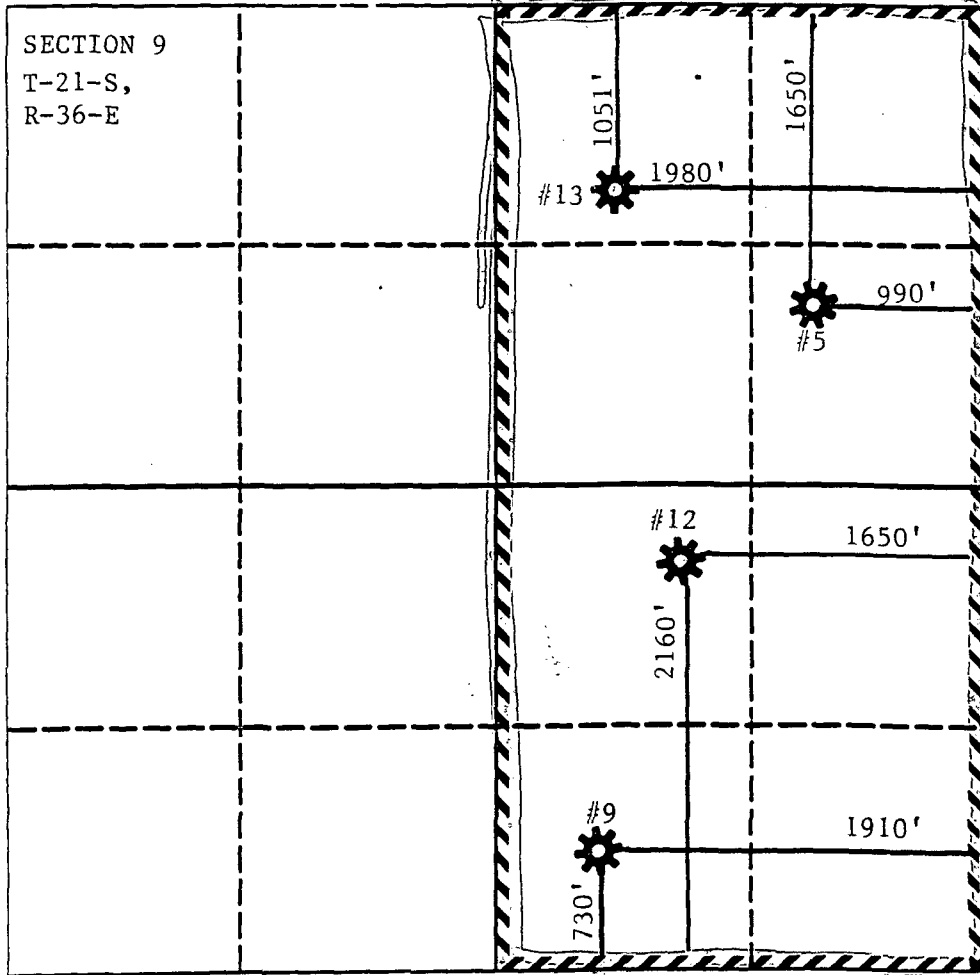

OPERATOR CERTIFICATION

I hereby certify that the information contained herein is true and complete to the best of my knowledge and belief.

Signature
Kathy E. Godfrey
Printed Name
KATHY E. GODFREY
Position
ENGINEERING TECHNICIAN
Company
ARCO PERMIAN
Date
JANUARY 9, 1995

SURVEYOR CERTIFICATION

I hereby certify that the well location shown on this plat was plotted from field notes, actual surveys made by me or under my supervision, and that the same is true and correct to the best of my knowledge and belief.

Date Surveyed
Signature & Seal of Professional Surveyor
Certificate No.

0 330 660 990 1320 1650 1980 2310 2640 2000 1500 1000 500 0

Submit to Appropriate
District Office
State Lease - 4 copies
Fee Lease - 3 copies

State of New Mexico
Energy, Minerals and Natural Resources Department

Form C-102
Revised 1-1-89

OIL CONSERVATION DIVISION

P.O. Box 2088
Santa Fe, New Mexico 87504-2088

DISTRICT I
P.O. Box 1980, Hobbs, NM 88240

DISTRICT II
P.O. Drawer DD, Artesia, NM 88210

DISTRICT III
1000 Rio Brazos Rd., Aztec, NM 87410

WELL LOCATION AND ACREAGE DEDICATION PLAT

All Distances must be from the outer boundaries of the section

Operator ARCO PERMIAN			Lease ERNEST C. ADKINS		Well No. 5
Unit Letter H	Section 9	Township T-21-S	Range R-36-E	County NMPM	LEA
Actual Footage Location of Well: 1650 feet from the NORTH line and 990 feet from the EAST line					
Ground level Elev. 3591'	Producing Formation YATES/7-RIVERS/QUEEN		Pool EUMONT GAS	Dedicated Acreage: 320 Acres	

- Outline the acreage dedicated to the subject well by colored pencil or hatchure marks on the plat below.
- If more than one lease is dedicated to the well, outline each and identify the ownership thereof (both as to working interest and royalty).
- If more than one lease of different ownership is dedicated to the well, have the interest of all owners been consolidated by communitization, unitization, force-pooling, etc.?
☐ Yes ☐ No If answer is "yes" type of consolidation _____
If answer is "no" list the owners and tract descriptions which have actually been consolidated. (Use reverse side of this form if necessary).
No allowable will be assigned to the well until all interests have been consolidated (by communitization, unitization, forced-pooling, or otherwise) or until a non-standard unit, eliminating such interest, has been approved by the Division.

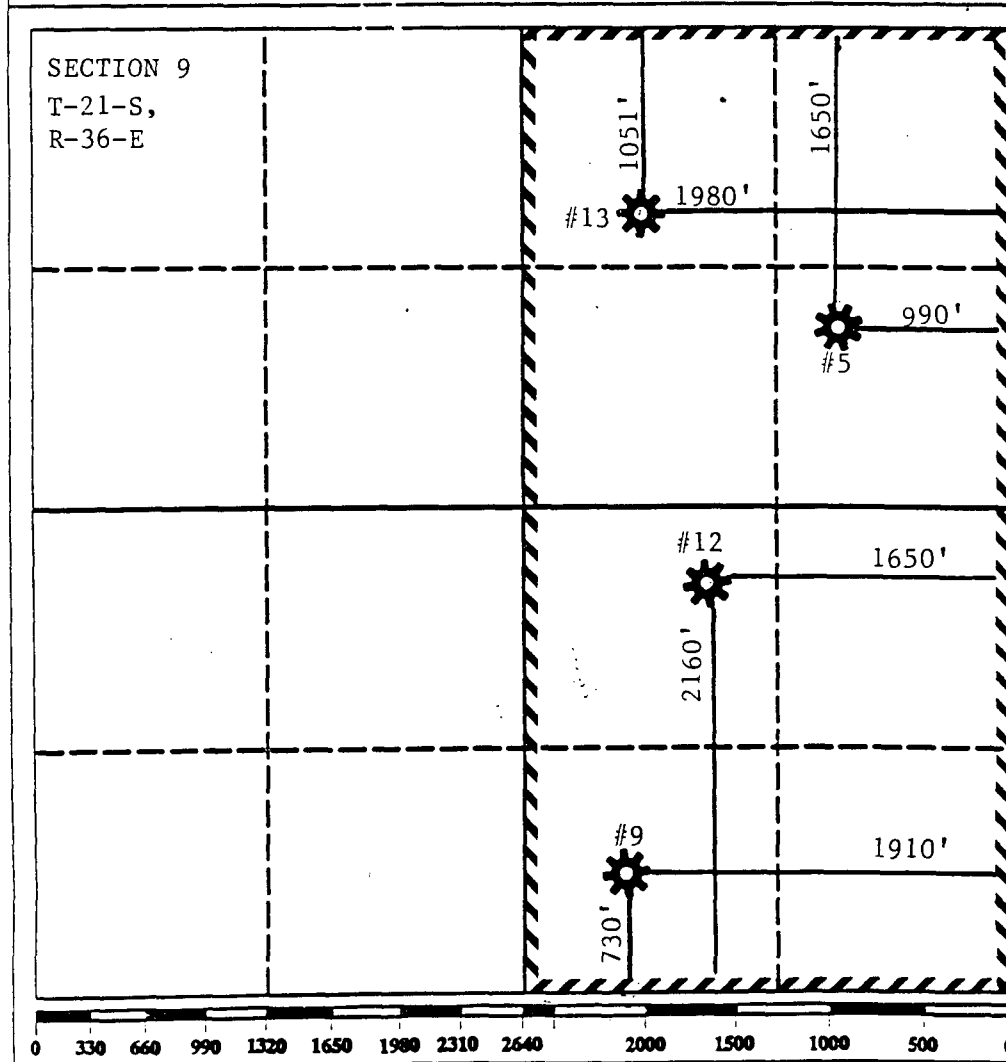

OPERATOR CERTIFICATION

I hereby certify that the information contained herein is true and complete to the best of my knowledge and belief.

Signature
Kathy E. Godfrey
Printed Name
KATHY E. GODFREY
Position
ENGINEERING TECHNICIAN
Company
ARCO PERMIAN
Date
JANUARY 9, 1995

SURVEYOR CERTIFICATION

I hereby certify that the well location shown on this plat was plotted from field notes actual surveys made by me or under my supervision, and that the same is true and correct to the best of my knowledge and belief.

Date Surveyed
Signature & Seal of Professional Surveyor
Certificate No.

Submit to Appropriate
District Office
State Lease - 4 copies
Fee Lease - 3 copies

State of New Mexico
Energy, Minerals and Natural Resources Department

Form C-102
Revised 1-1-89

OIL CONSERVATION DIVISION

P.O. Box 2088
Santa Fe, New Mexico 87504-2088

DISTRICT I
P.O. Box 1980, Hobbs, NM 88240

DISTRICT II
P.O. Drawer DD, Artesia, NM 88210

DISTRICT III
1000 Rio Brazos Rd., Aztec, NM 87410

WELL LOCATION AND ACREAGE DEDICATION PLAT

All Distances must be from the outer boundaries of the section

Operator ARCO PERMIAN			Lease ERNEST C. ADKINS		Well No. 12
Unit Letter J	Section 9	Township T-21-S	Range R-36-E	County NMPM	LEA
Actual Footage Location of Well:					
2160 feet from the SOUTH line and		1650 feet from the EAST line			
Ground level Elev. 3577'	Producing Formation YATES/7-RIVERS/QUEEN		Pool EUMONT GAS	Dedicated Acreage: 320 Acres	

1. Outline the acreage dedicated to the subject well by colored pencil or hatchure marks on the plat below.
2. If more than one lease is dedicated to the well, outline each and identify the ownership thereof (both as to working interest and royalty).
3. If more than one lease of different ownership is dedicated to the well, have the interest of all owners been consolidated by communitization, unitization, force-pooling, etc?
☐ Yes ☐ No If answer is "yes" type of consolidation _____
If answer is "no" list the owners and tract descriptions which have actually been consolidated. (Use reverse side of this form if necessary.)
No allowable will be assigned to the well until all interests have been consolidated (by communitization, unitization, forced-pooling, or otherwise) or until a non-standard unit, eliminating such interest, has been approved by the Division.

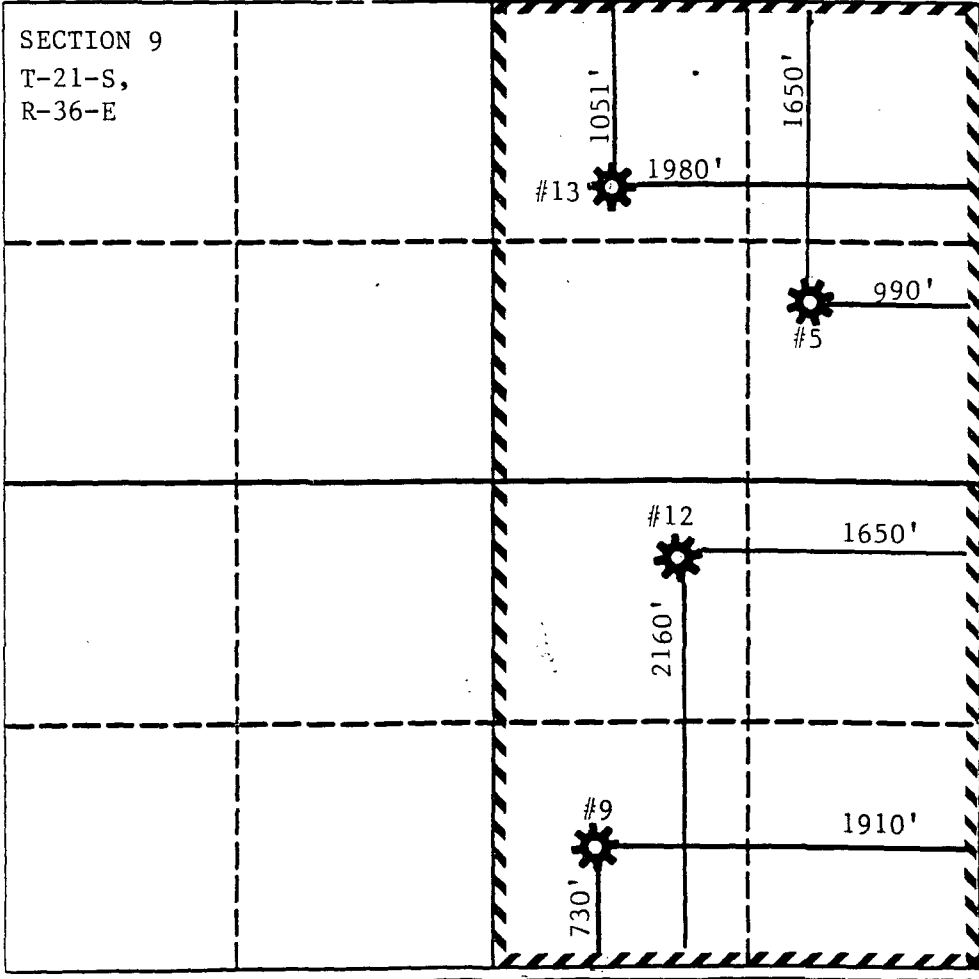
<p>SECTION 9 T-21-S, R-36-E</p> 	<p>OPERATOR CERTIFICATION</p> <p>I hereby certify that the information contained herein is true and complete to the best of my knowledge and belief.</p> <p>Signature <i>Kathy E. Godfrey</i></p> <p>Printed Name KATHY E. GODFREY</p> <p>Position ENGINEERING TECHNICIAN</p> <p>Company ARCO PERMIAN</p> <p>Date JANUARY 9, 1995</p> <p>SURVEYOR CERTIFICATION</p> <p>I hereby certify that the well location shown on this plat was plotted from field notes of actual surveys made by me or under my supervision, and that the same is true and correct to the best of my knowledge and belief.</p> <p>Date Surveyed</p> <p>Signature & Seal of Professional Surveyor</p> <p>Certificate No.</p>
--	---

Submit to Appropriate
District Office
State Lease - 4 copies
Fee Lease - 3 copies

State of New Mexico
Energy, Minerals and Natural Resources Department

Form C-102
Revised 1-1-89

OIL CONSERVATION DIVISION

P.O. Box 2088
Santa Fe, New Mexico 87504-2088

DISTRICT I
P.O. Box 1980, Hobbs, NM 88240

DISTRICT II
P.O. Drawer DD, Artesia, NM 88210

DISTRICT III
1000 Rio Brazos Rd., Aztec, NM 87410

WELL LOCATION AND ACREAGE DEDICATION PLAT

All Distances must be from the outer boundaries of the section

Operator ARCO PERMIAN			Lease ERNEST C. ADKINS		Well No. 13
Unit Letter B	Section 9	Township T-21-S	Range R-36-E	County NMPM	LEA
Actual Footage Location of Well: 1051 feet from the NORTH line and 1980 feet from the EAST line					
Ground level Elev. 3585'	Producing Formation YATES/7-RIVERS/QUEEN		Pool EUMONT GAS		Dedicated Acreage: 320 Acres

1. Outline the acreage dedicated to the subject well by colored pencil or hatchure marks on the plat below.

2. If more than one lease is dedicated to the well, outline each and identify the ownership thereof (both as to working interest and royalty).

3. If more than one lease of different ownership is dedicated to the well, have the interest of all owners been consolidated by communitization, unitization, force-pooling, etc.?

☐ Yes ☐ No If answer is "yes" type of consolidation

If answer is "no" list the owners and tract descriptions which have actually been consolidated. (Use reverse side of this form if necessary.)

No allowable will be assigned to the well until all interests have been consolidated (by communitization, unitization, forced-pooling, or otherwise) or until a non-standard unit, eliminating such interest, has been approved by the Division.

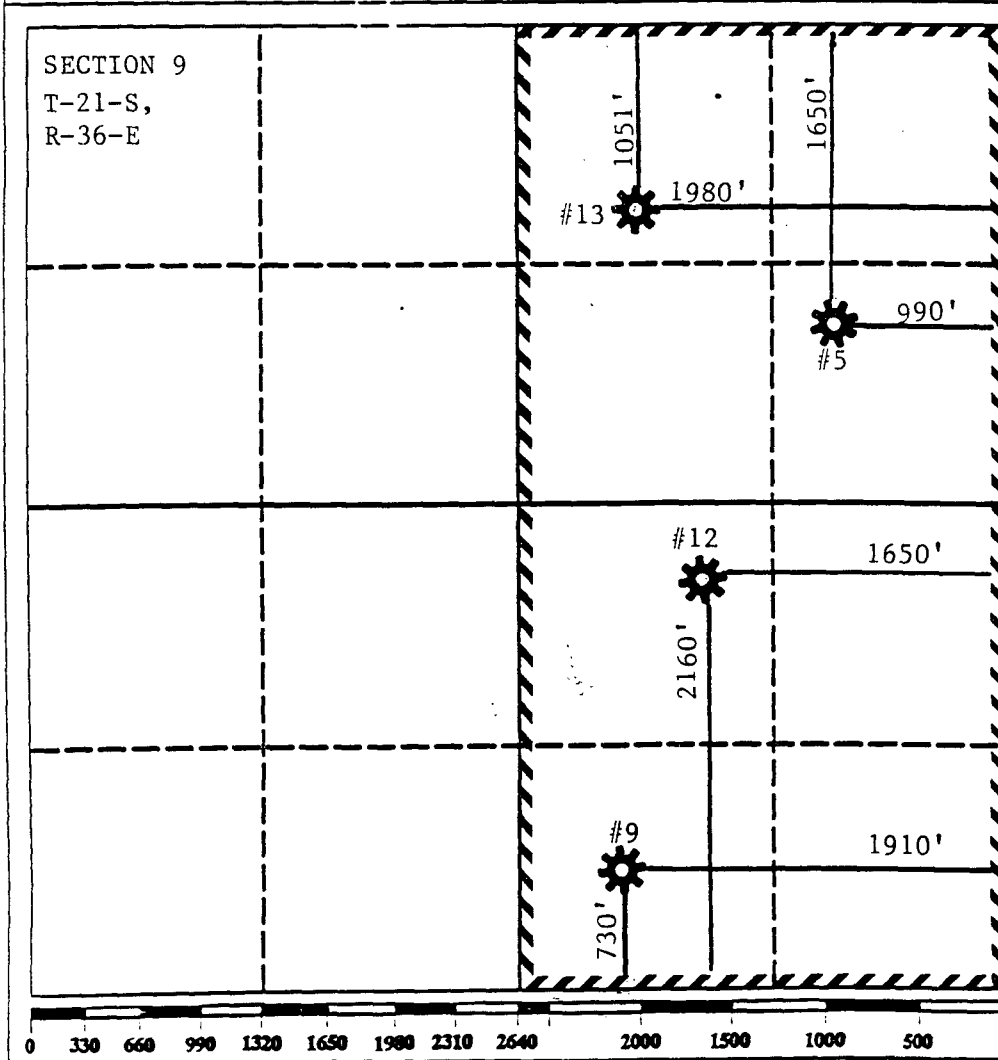

OPERATOR CERTIFICATION

I hereby certify that the information contained herein is true and complete to the best of my knowledge and belief.

Signature

Kathy E. Godfrey

Printed Name

KATHY E. GODFREY

Position

ENGINEERING TECHNICIAN

Company

ARCO PERMIAN

Date

JANUARY 9, 1995

SURVEYOR CERTIFICATION

I hereby certify that the well location shown on this plat was plotted from field notes of actual surveys made by me or under my supervision, and that the same is true and correct to the best of my knowledge and belief.

Date Surveyed

Signature & Seal of
Professional Surveyor

Certificate No.



STATE OF NEW MEXICO

ENERGY, MINERALS AND NATURAL RESOURCES DEPARTMENT

OIL CONSERVATION DIVISION



BRUCE KING
GOVERNOR

ANITA LOCKWOOD
CABINET SECRETARY

February 14, 1994

POST OFFICE BOX 2088
STATE LAND OFFICE BUILDING
SANTA FE, NEW MEXICO 87504
(505) 827-5800

ARCO Oil and Gas Company
Attention: David K. Newell
P.O. Box 1610
Midland, TX 79702

Administrative Order NSP-1685(SD)(L)

Reference is made to your application dated January 18, 1994, for the creation of a 320-acre non-standard gas spacing and proration (GPU) in the Eumont Gas Pool comprising the E/2 of Section 9, Township 21 South, Range 36 East, NMPM, Lea County, New Mexico, by combining the following two existing 160-acre non-standard gas spacing and proration units:

- the NE/4 is currently dedicated to the Ernest C. Adkins Well No. 5 (API No. 30-025-04582) located 1650 feet from the North line and 990 feet from the East line (Unit H) of said Section 9; and,
- the SE/4 is dedicated to the Ernest C. Adkins Well No. 9 (API No. 30-025-04586) located 730 feet from the South line and 1910 feet from the East line (Unit O) of said Section 9.

Both 160-acre units were authorized by Division Order No. R-520, dated August 12, 1954.

With the combining of these two 160-acre units, the location of the existing Well No. 9 becomes unorthodox pursuant to Rule 2(b) of the Special Rules and Regulations for the Eumont Gas Pool, as promulgated by Division Order No. R-8170, as amended.

It is also our understanding that a third well is planned for this 320-acre GPU, the Ernest C. Adkins Well No. 12 to be drilled at a standard gas well location 2160 feet from the South line and 1650 feet from the East line (Unit J) of said Section 9.

By the authority granted me under the provisions of Rules 2(a)4 and 2(c) of said Special Eumont Pool Rules, the above-described 320-acre GPU and resulting non-standard gas well location are hereby approved. Further, ARCO is permitted to produce the allowable assigned said 320-acre GPU from all three wells in any proportion.

Sincerely,

William J. LeMay
Director

WJL/MES/amg

cc: Oil Conservation Division - Hobbs

CMD :
OG6WELL

ONGARD
INQUIRE WELL DETAILS

02/02/95 08:06:51
OGOMES -EMGT

API Well No: 30 25 4582 Eff Date : 01-01-1900 APD Status : A
OGRID Idn : 990 ARCO PERMIAN
Prop Idn : 1445 ERNEST C ADKINS
Well No : 005

	U/L	Sec	Township	Range	North/South	East/West	Lot Idn
	---	---	-----	-----	-----	-----	-----
Surface Locn :	H	9	21S	36E	FTG 1650 F N	FTG 990 F E	
API County :	25	Lea					

Well type : G Ground Level Elevn : 99999 Cable/Rotary : R
Lease type : P State Lease Number :

Prpsd Depth : Prpsd Formation :

M0025:Enter PF keys to scroll

PF01 HELP	PF02	PF03 EXIT	PF04 GoTo	PF05	PF06
PF07	PF08	PF09	PF10 IWCM	PF11 HISTORY	PF12 NXTREC

CMD :
OG6WELL

ONGARD
INQUIRE WELL DETAILS

02/02/95 08:08:52
OGOMES -EMGT

API Well No: 30 25 4586 Eff Date : 01-01-1900 APD Status : A
OGRID Idn : 990 ARCO PERMIAN
Prop Idn : 1445 ERNEST C ADKINS
Well No : 009

	U/L	Sec	Township	Range	North/South	East/West	Lot Idn
	---	---	-----	-----	-----	-----	-----
Surface Locn :	O	9	21S	36E	FTG 999 F S	FTG 999 F E	
API County :	25	Lea					

Well type : G Ground Level Elevn : 99999 Cable/Rotary : R
Lease type : P State Lease Number :

Prpsd Depth : Prpsd Formation :

M0025:Enter PF keys to scroll

PF01 HELP	PF02	PF03 EXIT	PF04 GoTo	PF05	PF06
PF07	PF08	PF09	PF10 IWCM	PF11 HISTORY	PF12 NXTREC

CMD :
OG6WELL

ONGARD
INQUIRE WELL DETAILS

02/02/95 08:08:08
OGOMES -EMGT

API Well No: 30 25 32442 Eff Date : 06-02-1994 APD Status : A
OGRID Idn : 990 ARCO PERMIAN
Prop Idn : 1445 ERNEST C ADKINS
Well No : 012

	U/L	Sec	Township	Range	North/South	East/West	Lot Idn
	---	---	-----	-----	-----	-----	-----
Surface Locn :	J	9	21S	36E	FTG 2160 F S	FTG 1650 F E	
API County :	25	Lea					

Well type : O Ground Level Elevn : 3577 Cable/Rotary : R
Lease type : P State Lease Number :

Prpsd Depth : 3700 Prpsd Formation : YATES SEVEN RIVERS QUEEN

M0025:Enter PF keys to scroll

PF01 HELP	PF02	PF03 EXIT	PF04 GoTo	PF05	PF06
PF07	PF08	PF09	PF10 IWCM	PF11 HISTORY	PF12 NXTREC

CMD :
OG6WELL

ONGARD
INQUIRE WELL DETAILS

02/02/95 08:05:55
OGOMES -EMGT

API Well No: 30 25 32834 Eff Date : 01-24-1995 APD Status : A
OGRID Idn : 990 ARCO PERMIAN
Prop Idn : 1445 ERNEST C ADKINS
Well No : 13

	U/L	Sec	Township	Range	North/South	East/West	Lot	Idn
	---	---	-----	-----	-----	-----	-----	-----
Surface Locn :	B	9	21S	36E	FTG 1051 F N	FTG 1980 F E		
API County :	25	Lea						

Well type : G Ground Level Elevn : 3585 Cable/Rotary : R
Lease type : P State Lease Number :

Prpsd Depth : 3700 Prpsd Formation : YATES SRQ

M0025:Enter PF keys to scroll

PF01 HELP	PF02	PF03 EXIT	PF04 GoTo	PF05	PF06
PF07	PF08	PF09	PF10 IWCM	PF11 HISTORY	PF12 NXTREC