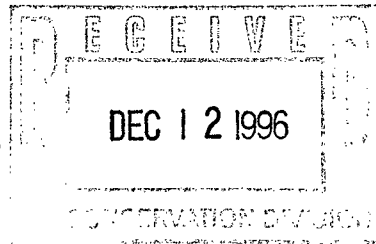

NSL(CSD)

11/1/97

December 4, 1996

**Chevron**

**Chevron U.S.A. Production Company**  
P.O. Box 1150  
Midland, TX 79702

**Administrative Application For Unorthodox  
Gas Well Location and Simultaneous Dedication  
Eumont Yates 7Rvrs Qn (Pro Gas) Pool  
330' FSL and 990' FEL  
Section 6, T-20-S, R-37-E  
Lea County, New Mexico**

12-12

State of New Mexico  
Energy, Minerals & Natural Resources Dept.  
Oil Conservation Division  
2040 South Pacheco  
Santa Fe, New Mexico 87504

Attn.: Mr. William J. LeMay -- Director

Gentlemen:

Chevron U.S.A. Inc. respectfully requests your approval of this administrative application for the subject Unorthodox Gas Well Location and Simultaneous Dedication.

Chevron is planning to re-complete the G. C. Mathews #12 in the Eumont Yates 7 Rvrs Qn (Pro Gas) Pool. It is also our desire to simultaneously dedicate the existing 160-acre Eumont Gas Proration Unit currently assigned to our G. C. Mathews #2 [Administrative Order NSP-312] to both wells. The 160-acre gas proration unit comprises the SE/4 of Section 6, T-20-S, R-37-E, Lea County, New Mexico. As the G. C. Mathews Well #2 is producing at a current rate of only 3-4 MCF/D, the proposed re-completion of Well #12 will essentially act as a replacement well for Well #2 to preserve the 160-acre GPU thus preventing waste through utilization of an existing wellbore and capturing reserves which otherwise would not be produced from this GPU.

As a result, the proposed location for the G. C. Mathews #12 of 330 feet FSL and 990 feet FEL, Unit Letter P, Section 6, Township 20 South, Range 37 East, Lea County, New Mexico is unorthodox.

In order to prevent waste, Chevron respectfully requests your approval of this administrative application for an unorthodox gas well location and simultaneous dedication. Attached is a map showing offset operators and a Form C-102 plat. A copy of this letter and attachments are being furnished by Certified Mail to offset operators as their notice of this application.

If you have any questions or require any further information concerning this application, please contact me at (915) 687-7246.

Yours very truly,

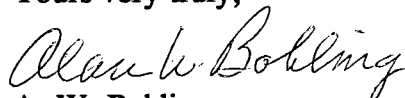
A handwritten signature in cursive script that reads "Alan W. Bohling".

A. W. Bohling  
Petroleum Engineer

awb  
Attachments

cc: NMOCD -- Hobbs, NM



**Chevron**

December 4, 1996

Administrative Application For Unorthodox  
Gas Well Location and Simultaneous Dedication  
Eumont Yates 7 Rvrs Qn (Pro Gas) Pool  
330' FSL and 990' FEL  
Section 6, T-20-S. R-37-E  
Lea County, New Mexico

**Chevron U.S.A. Production Company**  
P.O. Box 1150  
Midland, TX 79702

Meridian Oil, Inc.  
3300 N. "A" Street, Bldg. #6  
Midland, Texas 79705

Gentlemen:

Attached is a copy of Chevron's administrative application for NMOCD approval of an Unorthodox Gas Well Location and Simultaneous Dedication in the Eumont Yates 7 Rvrs Qn (Pro Gas) Pool.

Chevron plans to re-complete the **G. C. Mathews #12** in the Eumont Yates 7 Rvrs Qn (Pro Gas) Pool. It is our desire to also simultaneously dedicate the existing 160-acre Eumont Gas Proration Unit assigned to our G. C. Mathews Well No. 2 [Administrative Order NSP-312] to both wells. As a result, the location of the G. C. Mathews Well No. 12 becomes unorthodox. The location of Well No. 12 is 330 feet FSL and 990 feet FEL of Section 6, T-20-S, R-37-E, NMPM, Lea County, New Mexico.

If you have any questions, please contact me at (915) 687-7246.

Yours very truly,

A. W. Bohling  
Petroleum Engineer

awb  
Attachments

cc: NMOCD - Hobbs  
N. V. Mouser  
J. K. Ripley  
D. K. Owen  
D. K. Beckham  
Central Files - Lease and Well Files





**Chevron**

December 4, 1996

Administrative Application For Unorthodox  
Gas Well Location and Simultaneous Dedication  
Eumont Yates 7 Rvrs Qn (Pro Gas) Pool  
330' FSL and 990' FEL  
Section 6, T-20-S. R-37-E  
Lea County, New Mexico

**Chevron U.S.A. Production Company**  
P.O. Box 1150  
Midland, TX 79702

Texaco Exploration & Production, Inc.  
P. O. Box 3109  
Midland, Texas 79702

Gentlemen:

Attached is a copy of Chevron's administrative application for NMOCD approval of an Unorthodox Gas Well Location and Simultaneous Dedication in the Eumont Yates 7 Rvrs Qn (Pro Gas) Pool.

Chevron plans to re-complete the **G. C. Mathews #12** in the Eumont Yates 7 Rvrs Qn (Pro Gas) Pool. It is our desire to also simultaneously dedicate the existing 160-acre Eumont Gas Proration Unit assigned to our G. C. Mathews Well No. 2 [Administrative Order NSP-312] to both wells. As a result, the location of the G. C. Mathews Well No. 12 becomes unorthodox. The location of Well No. 12 is 330 feet FSL and 990 feet FEL of Section 6, T-20-S, R-37-E, NMPM, Lea County, New Mexico.

If you have any questions, please contact me at (915) 687-7246.

Yours very truly,

A. W. Bohling  
Petroleum Engineer

awb  
Attachments

cc: NMOCD - Hobbs  
N. V. Mouser  
J. K. Ripley  
D. K. Owen  
D. K. Beckham  
Central Files - Lease and Well Files





**Chevron**

December 4, 1996

Administrative Application For Unorthodox  
Gas Well Location and Simultaneous Dedication  
Eumont Yates 7 Rvrs Qn (Pro Gas) Pool  
330' FSL and 990' FEL  
Section 6, T-20-S. R-37-E  
Lea County, New Mexico

**Chevron U.S.A. Production Company**  
P.O. Box 1150  
Midland, TX 79702

Amerada Hess Corporation  
P. O. Box 2040  
Houston, Texas 77252

Gentlemen:

Attached is a copy of Chevron's administrative application for NMOCD approval of an Unorthodox Gas Well Location and Simultaneous Dedication in the Eumont Yates 7 Rvrs Qn (Pro Gas) Pool.

Chevron plans to re-complete the **G. C. Mathews #12** in the Eumont Yates 7 Rvrs Qn (Pro Gas) Pool. It is our desire to also simultaneously dedicate the existing 160-acre Eumont Gas Proration Unit assigned to our G. C. Mathews Well No. 2 [Administrative Order NSP-312] to both wells. As a result, the location of the G. C. Mathews Well No. 12 becomes unorthodox. The location of Well No. 12 is 330 feet FSL and 990 feet FEL of Section 6, T-20-S, R-37-E, NMPM, Lea County, New Mexico.

If you have any questions, please contact me at (915) 687-7246.

Yours very truly,

A. W. Bohling  
Petroleum Engineer

awb

Attachments

cc: NMOCD - Hobbs  
N. V. Mouser  
J. K. Ripley  
D. K. Owen  
D. K. Beckham  
Central Files - Lease and Well Files

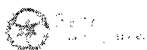

December 4, 1996



**Chevron**

Administrative Application For Unorthodox  
Gas Well Location and Simultaneous Dedication  
Eumont Yates 7 Rvrs Qn (Pro Gas) Pool  
330' FSL and 990' FEL  
Section 6, T-20-S. R-37-E  
Lea County, New Mexico

**Chevron U.S.A. Production Company**  
P.O. Box 1150  
Midland, TX 79702

Conoco Inc.  
10 Desta Drive West  
Midland, Texa 79705

Gentlemen:

Attached is a copy of Chevron's administrative application for NMOCD approval of an Unorthodox Gas Well Location and Simultaneous Dedication in the Eumont Yates 7 Rvrs Qn (Pro Gas) Pool.

Chevron plans to re-complete the **G. C. Mathews #12** in the Eumont Yates 7 Rvrs Qn (Pro Gas) Pool. It is our desire to also simultaneously dedicate the existing 160-acre Eumont Gas Proration Unit assigned to our G. C. Mathews Well No. 2 [Administrative Order NSP-312] to both wells. As a result, the location of the G. C. Mathews Well No. 12 becomes unorthodox. The location of Well No. 12 is 330 feet FSL and 990 feet FEL of Section 6, T-20-S, R-37-E, NMPM, Lea County, New Mexico.

If you have any questions, please contact me at (915) 687-7246.

Yours very truly,

A handwritten signature in cursive script that reads "A. W. Bohling".

A. W. Bohling  
Petroleum Engineer

awb  
Attachments

cc: NMOCD - Hobbs  
N. V. Mouser  
J. K. Ripley  
D. K. Owen  
D. K. Beckham  
Central Files - Lease and Well Files



December 4, 1996



**Chevron**

Administrative Application For Unorthodox  
Gas Well Location and Simultaneous Dedication  
Eumont Yates 7 Rvrs Qn (Pro Gas) Pool  
330' FSL and 990' FEL  
Section 6, T-20-S. R-37-E  
Lea County, New Mexico

**Chevron U.S.A. Production Company**  
P.O. Box 1150  
Midland, TX 79702

Cross Timbers Operating Co.  
3000 N. Garfield, Ste. 250  
Midland, Texas 79705

Gentlemen:

Attached is a copy of Chevron's administrative application for NMOCD approval of an Unorthodox Gas Well Location and Simultaneous Dedication in the Eumont Yates 7 Rvrs Qn (Pro Gas) Pool.

Chevron plans to re-complete the **G. C. Mathews #12** in the Eumont Yates 7 Rvrs Qn (Pro Gas) Pool. It is our desire to also simultaneously dedicate the existing 160-acre Eumont Gas Proration Unit assigned to our G. C. Mathews Well No. 2 [Administrative Order NSP-312] to both wells. As a result, the location of the G. C. Mathews Well No. 12 becomes unorthodox. The location of Well No. 12 is 330 feet FSL and 990 feet FEL of Section 6, T-20-S, R-37-E, NMPM, Lea County, New Mexico.

If you have any questions, please contact me at (915) 687-7246.

Yours very truly,

A handwritten signature in cursive script that reads "A. W. Bohling".

A. W. Bohling  
Petroleum Engineer

awb  
Attachments

cc: NMOCD - Hobbs  
N. V. Mouser  
J. K. Ripley  
D. K. Owen  
D. K. Beckham  
Central Files - Lease and Well Files



**Chevron**

December 4, 1996

Administrative Application For Unorthodox  
Gas Well Location and Simultaneous Dedication  
Eumont Yates 7 Rvrs Qn (Pro Gas) Pool  
330' FSL and 990' FEL  
Section 6, T-20-S. R-37-E  
Lea County, New Mexico

**Chevron U.S.A. Production Company**  
P.O. Box 1150  
Midland, TX 79702

Doyle Hartman, Oil Operator  
3811 Turtle Creek Boulevard, Ste. 730  
Dallas, Texas 75219

Gentlemen:

Attached is a copy of Chevron's administrative application for NMOCD approval of an Unorthodox Gas Well Location and Simultaneous Dedication in the Eumont Yates 7 Rvrs Qn (Pro Gas) Pool.

Chevron plans to re-complete the **G. C. Mathews #12** in the Eumont Yates 7 Rvrs Qn (Pro Gas) Pool. It is our desire to also simultaneously dedicate the existing 160-acre Eumont Gas Proration Unit assigned to our G. C. Mathews Well No. 2 [Administrative Order NSP-312] to both wells. As a result, the location of the G. C. Mathews Well No. 12 becomes unorthodox. The location of Well No. 12 is 330 feet FSL and 990 feet FEL of Section 6, T-20-S, R-37-E, NMPM, Lea County, New Mexico.

If you have any questions, please contact me at (915) 687-7246.

Yours very truly,

A. W. Bohling  
Petroleum Engineer

awb  
Attachments

cc: NMOCD - Hobbs  
N. V. Mouser  
J. K. Ripley  
D. K. Owen  
D. K. Beckham  
Central Files - Lease and Well Files



December 4, 1996



**Chevron**

Administrative Application For Unorthodox  
Gas Well Location and Simultaneous Dedication  
Eumont Yates 7 Rvrs Qn (Pro Gas) Pool  
330' FSL and 990' FEL  
Section 6, T-20-S. R-37-E  
Lea County, New Mexico

**Chevron U.S.A. Production Company**  
P.O. Box 1150  
Midland, TX 79702

John H. Hendrix Corporation  
P. O. Box 3040  
Midland, Texas 79702

Gentlemen:

Attached is a copy of Chevron's administrative application for NMOCD approval of an Unorthodox Gas Well Location and Simultaneous Dedication in the Eumont Yates 7 Rvrs Qn (Pro Gas) Pool.

Chevron plans to re-complete the **G. C. Mathews #12** in the Eumont Yates 7 Rvrs Qn (Pro Gas) Pool. It is our desire to also simultaneously dedicate the existing 160-acre Eumont Gas Proration Unit assigned to our G. C. Mathews Well No. 2 [Administrative Order NSP-312] to both wells. As a result, the location of the G. C. Mathews Well No. 12 becomes unorthodox. The location of Well No. 12 is 330 feet FSL and 990 feet FEL of Section 6, T-20-S, R-37-E, NMPM, Lea County, New Mexico.

If you have any questions, please contact me at (915) 687-7246.

Yours very truly,

*Alan W. Bohling*

A. W. Bohling  
Petroleum Engineer

awb  
Attachments

cc: NMOCD - Hobbs  
N. V. Mouser  
J. K. Ripley  
D. K. Owen  
D. K. Beckham  
Central Files - Lease and Well Files



**Chevron**

December 4, 1996

Administrative Application For Unorthodox  
Gas Well Location and Simultaneous Dedication  
Eumont Yates 7 Rvrs Qn (Pro Gas) Pool  
330' FSL and 990' FEL  
Section 6, T-20-S. R-37-E  
Lea County, New Mexico

**Chevron U.S.A. Production Company**  
P.O. Box 1150  
Midland, TX 79702

Marathon Oil Company  
P. O. Box 552  
Midland, Texas 79702

Gentlemen:

Attached is a copy of Chevron's administrative application for NMOCD approval of an Unorthodox Gas Well Location and Simultaneous Dedication in the Eumont Yates 7 Rvrs Qn (Pro Gas) Pool.

Chevron plans to re-complete the **G. C. Mathews #12** in the Eumont Yates 7 Rvrs Qn (Pro Gas) Pool. It is our desire to also simultaneously dedicate the existing 160-acre Eumont Gas Proration Unit assigned to our G. C. Mathews Well No. 2 [Administrative Order NSP-312] to both wells. As a result, the location of the G. C. Mathews Well No. 12 becomes unorthodox. The location of Well No. 12 is 330 feet FSL and 990 feet FEL of Section 6, T-20-S, R-37-E, NMPM, Lea County, New Mexico.

If you have any questions, please contact me at (915) 687-7246.

Yours very truly,

A. W. Bohling  
Petroleum Engineer

awb  
Attachments

cc: NMOCD - Hobbs  
N. V. Mouser  
J. K. Ripley  
D. K. Owen  
D. K. Beckham  
Central Files - Lease and Well Files



December 4, 1996



Administrative Application For Unorthodox  
Gas Well Location and Simultaneous Dedication  
Eumont Yates 7 Rvrs Qn (Pro Gas) Pool  
330' FSL and 990' FEL  
Section 6, T-20-S. R-37-E  
Lea County, New Mexico

Chevron U.S.A. Production Company  
P.O. Box 1150  
Midland, TX 79702

ARCO Permian  
P. O. Box 1610  
Midland, Texas 79702

Gentlemen:

Attached is a copy of Chevron's administrative application for NMOCD approval of an Unorthodox Gas Well Location and Simultaneous Dedication in the Eumont Yates 7 Rvrs Qn (Pro Gas) Pool.

Chevron plans to re-complete the **G. C. Mathews #12** in the Eumont Yates 7 Rvrs Qn (Pro Gas) Pool. It is our desire to also simultaneously dedicate the existing 160-acre Eumont Gas Proration Unit assigned to our G. C. Mathews Well No. 2 [Administrative Order NSP-312] to both wells. As a result, the location of the G. C. Mathews Well No. 12 becomes unorthodox. The location of Well No. 12 is 330 feet FSL and 990 feet FEL of Section 6, T-20-S, R-37-E, NMPM, Lea County, New Mexico.

If you have any questions, please contact me at (915) 687-7246.

Yours very truly,

*Alan W. Bohling*  
A. W. Bohling  
Petroleum Engineer

awb  
Attachments

cc: NMOCD - Hobbs  
N. V. Mouser  
J. K. Ripley  
D. K. Owen  
D. K. Beckham  
Central Files - Lease and Well Files

**CHEVRON U.S.A. INC.**

G. C. Mathews Lease  
Well No. 12

Unorthodox Location and  
Simultaneous Dedication Application  
Eumont (Pro Gas) Pool  
330' FSL and 990' FEL  
Section 7, T-20-S, R-37-E  
Lea County, New Mexico

**OFFSET OPERATORS**

Amerada Hess Corporation  
500 Dallas Street  
Houston, Texas 77002

ARCO Permian  
P. O. Box 1610  
Midland, Texas 79702

Conoco Incorporated  
10 Desta Drive West  
Midland, Texas 79705

Cross Timbers Operating Co.  
3000 N. Garfield, Ste. 250  
Midland, Texas 79705

Doyle Hartman, Oil Operator  
3811 Turtle Creek Boulevard, Suite 730  
Dallas, Texas 75219

John H. Hendrix Corporation  
P. O. Box 3040  
Midland, Texas 79702

Marathon Oil Company  
P. O. Box 552  
Midland, Texas 79702

Meridian Oil, Inc.  
3300 N. "A" Street, Bldg. #6  
Midland, Texas 79705

Texaco Exploration & Production, Inc.  
P. O. Box 3109  
Midland, Texas 79702

CHEVRON U.S.A. INC.  
G. C. Mathews Lease  
Well No. 12

Unorthodox Location and  
Simultaneous Dedication Application  
Eumont (Pro Gas) Pool  
330' FSL and 990' FEL  
Section 6, T-20-S, R-37-E  
Lea County, New Mexico

COMMERCIAL MAP

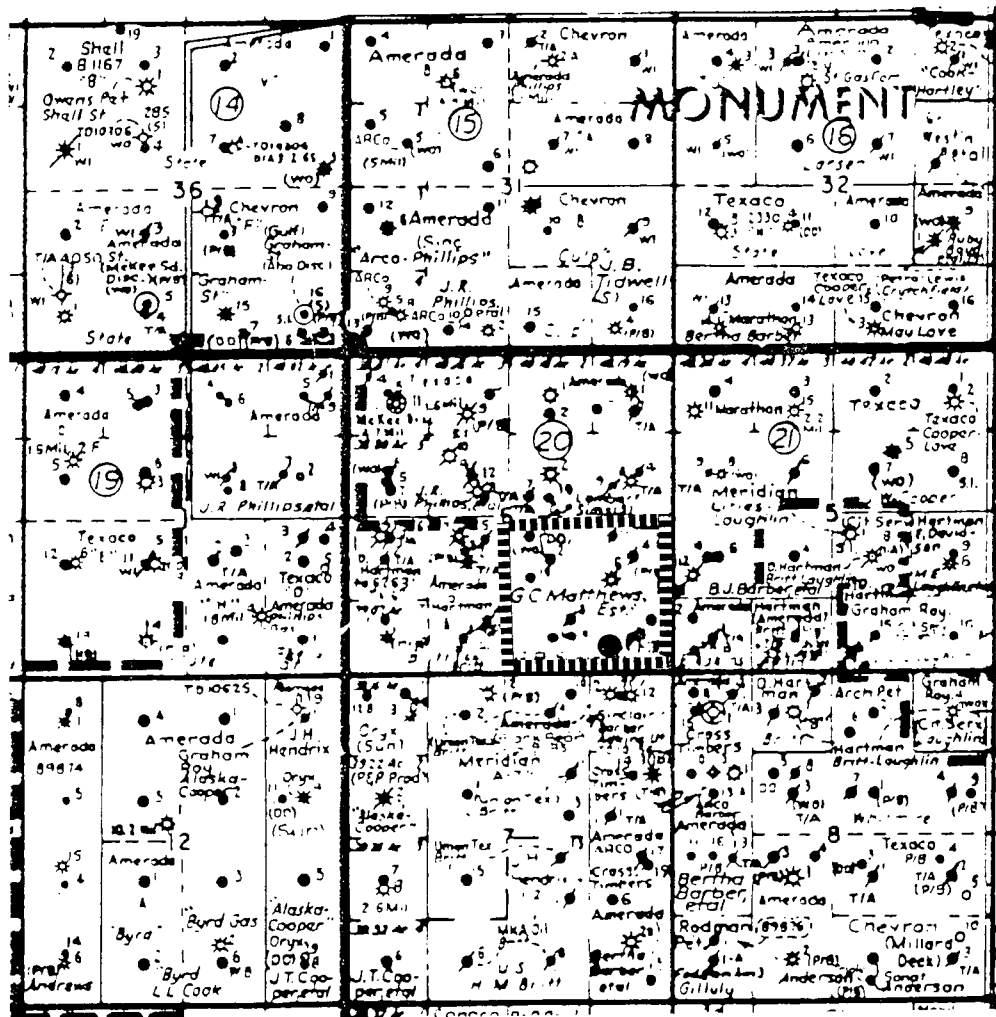

CHEVRON U.S.A. INC.  
G. C. Mathews Lease  
Well No. 12

Unorthodox Location and  
Simultaneous Dedication Application  
Eumont (Pro Gas) Pool  
330' FSNL and 990' FEL  
Section 6, T-20-S, R-37-E  
Lea County, New Mexico

PRORATION UNIT MAP

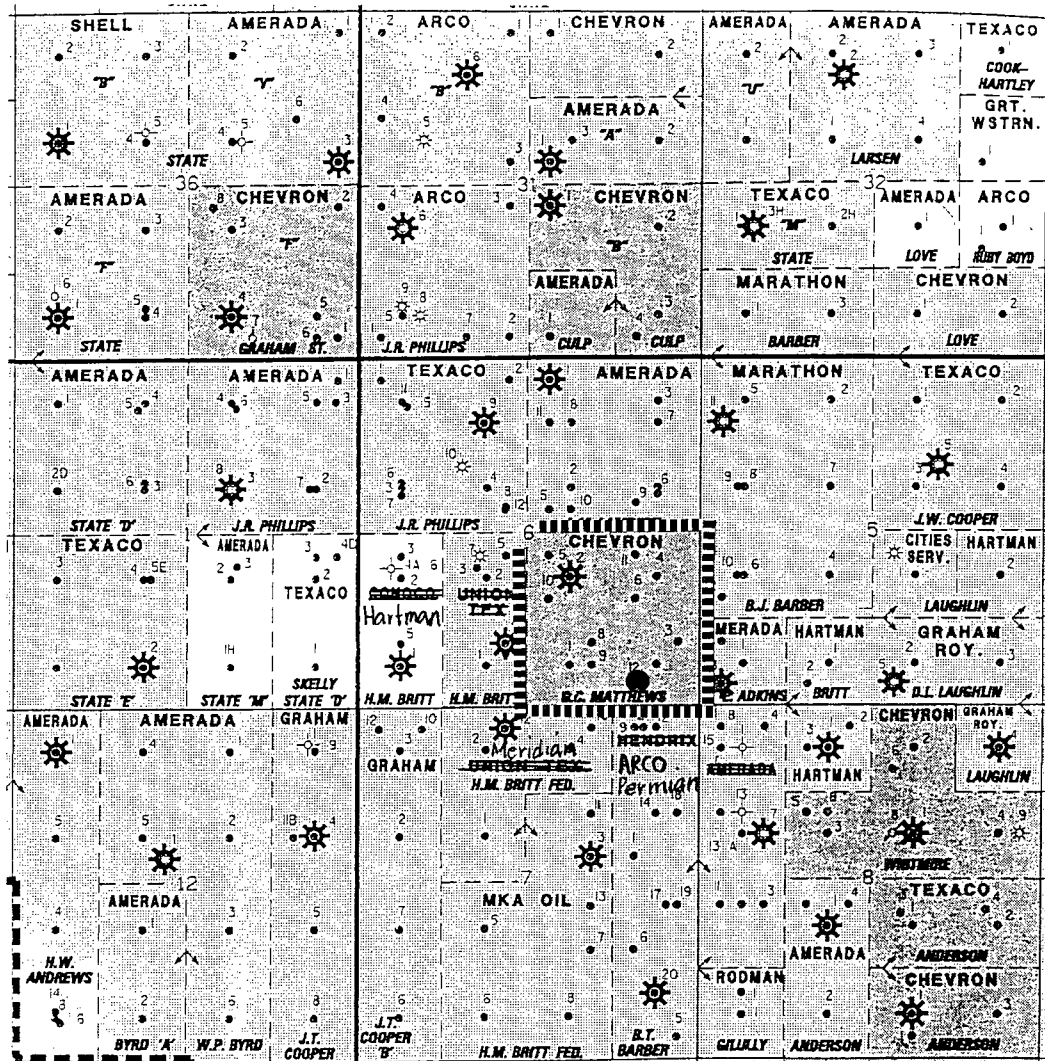

Form C-102  
Revised February 10, 1994  
Instructions on back  
Submit to Appropriate District Office  
State Lease - 4 Copies  
Fee Lease - 3 Copies

☐ AMENDED REPORT

## WELL LOCATION AND ACREAGE DEDICATION PLAT

|                            |  |                                      |  |  |                      |
|----------------------------|--|--------------------------------------|--|--|----------------------|
| API Number<br>30-025-05953 |  | Pool Code<br>76480                   |  | Pool Name<br>EUMONT YATES 7-RIVERS QUEEN (PRO GAS) |                      |
| Property Code<br>002688    |  | Property Name<br>G.C. MATHEWS        |  |  | Well Number<br>12    |
| OGRID No.<br>004323        |  | Operator Name<br>CHEVRON U.S.A. INC. |  |  | Elevation<br>3556 GL |

### <sup>10</sup> Surface Location

|               |         |          |       |         |               |                  |               |                |        |
|---------------|---------|----------|-------|---------|---------------|------------------|---------------|----------------|--------|
| UL or lot no. | Section | Township | Range | Lot Ida | Feet from the | North/South line | Feet from the | East/West line | County |
| P             | 6       | 205      | 37E   |         | 330           | SOUTH            | 990           | EAST           | LEA    |

<sup>11</sup> Bottom Hole Location If Different From Surface

|  |         |          |       |         |               |                  |               |                |        |
|--|---------|----------|-------|---------|---------------|------------------|---------------|----------------|--------|
| UL or lot No.  | Section | Township | Range | Lot Ida | Foot from the | North/South line | Foot from the | East/West line | County |
|  |         |          |       |         |               |                  |               |                |        |
| 11 Ductile 1 Acres 12 Joint or Infill 13 Consolidation Code 14 Order No. |         |          |       |         |               |                  |               |                |        |
| 160  |         |          |       |         |               |                  |               |                |        |
| NSP-312  |         |          |       |         |               |                  |               |                |        |

NO ALLOWABLE WILL BE ASSIGNED TO THIS COMPLETION UNTIL ALL INTERESTS HAVE BEEN CONSOLIDATED  
OR A NON-STANDARD UNIT HAS BEEN APPROVED BY THE DIVISION

|    |  |   |                 |  |
|----|--|---|-----------------|--|
| 16 |  |   |                 | <p><b>17 OPERATOR CERTIFICATION</b></p> <p>I hereby certify that the information contained herein is true and complete to the best of my knowledge and belief.</p> <p><u>Alan W. Bohling</u><br/>Signature</p> <p><u>Alan W. Bohling</u><br/>Printed Name</p> <p><u>Petroleum Engineer</u><br/>Title</p> <p><u>December 4, 1996</u><br/>Date</p>   |
|    |  | 6 |                 | <p><b>18 SURVEYOR CERTIFICATION</b></p> <p>I hereby certify that the well location shown on this plat was plotted from field notes of actual surveys made by me or under my supervision, and that the same is true and correct to the best of my belief.</p> <p>_____<br/>Date of Survey</p> <p>_____<br/>Signature and Seal of Professional Surveyor:</p> <p>_____<br/>Certificate Number</p> |
|    |  | 2 | 12<br>330' 990' |  |

DOYLE HARTMAN  
Oil Operator  
3811 Turtle Creek Blvd., Suite # 200  
DALLAS, TEXAS 75219  
(214)-520-1800 Office / 520-0811 Fax

## FAX COVER SHEET

To:

|                                   |  |
|-----------------------------------|--|
| NAME<br><i>Michael J. Stogner</i> | DATE AND TIME OF TRANSMISSION<br><i>12-12-96</i> |
| COMPANY<br><i>NMDCD</i>           | FAX NUMBER<br><i>(505) 827-8177</i>              |

From:

|                              |
|------------------------------|
| NAME<br><i>Doyle Hartman</i> |
|------------------------------|

Reference:

|  |
|--|
| SUBJECT<br><i>Administrative Application for Unorthodox Gas Well</i> |
|--|

*G.C. Mathe*  
*No. 12*

The information contained in this facsimile message is confidential and intended solely for the use of the individual or entity named above. If the reader of this message is not the intended recipient, or the employee or agent responsible for delivering it to the intended recipient, you are hereby notified that any dissemination, distribution, copying, or unauthorized use of this communication is strictly prohibited. If you have received this facsimile in error, please notify the sender immediately by telephone, and return the facsimile to the sender at the above address via the United States Postal Service.

Message:

---

---

---

---

---

---

---

---

---

---



**DOYLE HARTMAN**

*Oil Operator*

---

**Via Facsimile (915) 687-7666, FedEx**

December 12, 1996

Mr. A.W. Bohling  
Chevron U.S.A. Production Co.  
P.O. Box 1150  
Midland, Texas 79702

Re: Unorthodox Gas Well Location Application  
G.C. Mathews No. 12  
330' FSL & 990' FEL (P)  
Section 6, T-20-S, R-37-E  
Lea County, New Mexico

Gentlemen:

Reference is made to Chevron's letter to us dated December 4, 1996 (received December 12, 1996) regarding Chevron's proposed G.C. Mathews No. 12 unorthodox Eumont gas well location consisting of 330' FSL and 990' FEL of Section 6, T-20-S, R-37-E, Lea County, New Mexico.

At this time, we are currently contemplating a Eumont recompletion on our 320-acre H.M. Britt lease at a location in the NW/4 NE/4 Section 7, T-20-S, R-37-E. Therefore, in consideration of the foregoing, we are hereby agreeable to waiving our right to oppose Chevron's proposed G.C. Mathews No. 12 recompletion providing that Chevron likewise agrees not to oppose a successful Eumont recompletion by Hartman in the NW/4 NE/4 Section 7.

Yours very truly,

DOYLE HARTMAN, Oil Operator



Doyle Hartman

rjr

Chevron U.S.A. Production Co.  
December 12, 1996  
Page 2

cc: Mr. Michael J. Stogner, Chief Hearing Officer  
New Mexico Oil Conservation Division  
2040 South Pacheco Street  
Santa Fe, New Mexico 87505

Mr. Jerry Sexton, District 1 Supervisor  
New Mexico Oil Conservation Division  
P.O. Box 1980  
Hobbs, New Mexico 88241

Mr. James A. Davidson  
P.O. Box 494  
Midland, Texas 79702

Mr. Don Mashburn  
Mr. Steve Hartman  
Ms. Cindy Brooks  
Ms. Linda Land  
Ms. Sheila Potts  
Ms. Carolyn Sebastian  
H.M. Britt Files  
DOYLE HARTMAN, Oil Operator  
500 North Main  
Midland, Texas 79702