

NSL - 10/30/97



Chevron

October 9, 1997

Chevron U.S.A. Production Company
P.O. Box 1150
Midland, TX 79702

Administrative Application For Unorthodox
Oil Well Location
Chevron USA Production Co.
Monument "12" State #14
1200' FNL and 1350' FWL
Section 12, T-19-S, R-36-E
North Monument Abo Pool
Lea County, New Mexico

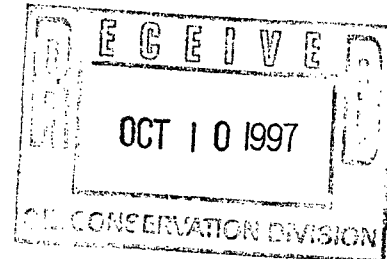

State of New Mexico
Energy, Minerals & Natural Resources Dept.
Oil Conservation Division
2040 South Pacheco
Santa Fe, New Mexico 87504

Via Overnight Mail

Attn.: Mr. William J. LeMay -- Director

Gentlemen:

Chevron U.S.A. respectfully requests your approval of this administrative application for the subject Unorthodox Oil Well Location in the North Monument Abo Pool.

Chevron proposes to drill the Monument "12" State #14 (12 #14) at a non-standard location within the Chevron operated Monument Working Interest Unit. The target for the 12 #14 is a shelf margin Abo carbonate build-up that is defined with wells and 3D seismic. The attached map shows the interpreted north to northeast orientation of this carbonate build-up. The build-up is narrow and based on seismic, the location of the 12 #14 is the lowest risk location in unit letter C of section 12.

Because the proposed location is within the Chevron operated Monument Working Interest Unit, no correlative rights will be violated as ownership does not vary within the unit. Also, since the location is in the interior of the unit and the North Monument Abo Pool is developed on 40-acre spacing, the location will not encroach on any parties outside the unit.

In addition to the Abo Build-Up Map, a Form C-102 plat original, a Form C-102 plat showing offset wells, and a list of working interest owners within the unit is attached. If you have any questions or require any further information concerning this application, please contact me at (915) 687-7114.

Sincerely,

Dave Rittersbacher

Dave Rittersbacher
Geologist - New Mexico Area

djr
Attachments

cc: NMOCD -- Hobbs, NM
Phillips Petroleum Co.
Leede Operating Co.
Amerada Hess Co. } **Certified Mail**

T19S R36E

Monument W.I. Unit
Chevron Operated
56% WI Below 4500'

Proposed
Chevron
Monument "12" State #14
1200' FNL 1350' FWL
Sec. 12-T19S-R36E

*Below 4500'
all mineral
interest is common.*

Abo
Shelf Margin
Build-up

Build



Wells Shown Are Abo FM Penetrations \geq 6750' TD
Abo Producers Are Solid Blue Circles

Chevron USA

Monument Working Interest Unit
Proposed Monument "12" State #14
Non-Standard Location

Dave Rittersbacher

10/8/97

Scale 1:36000.

DISTRICT I

P.O. Box 1980, Hobbs, NM 88241-1980

State of New Mexico

Energy, Minerals and Natural Resources Department

Form C-102

Revised February 10, 1994

Submit to Appropriate District Office

State Lease - 4 Copies

Fee Lease - 3 Copies

DISTRICT II

P.O. Drawer DD, Artesia, NM 88211-0719

DISTRICT III

1000 Rio Brazos Rd., Aztec, NM 87410

OIL CONSERVATION DIVISION

P.O. Box 2088

Santa Fe, New Mexico 87504-2088

DISTRICT IV

P.O. Box 2088, Santa Fe, NM 87504-2088

☐ AMENDED REPORT

WELL LOCATION AND ACREAGE DEDICATION PLAT

API Number		Pool Code	Pool Name
Property Code	Property Name MONUMENT "12" STATE		Well Number 14
OGRID No.	Operator Name CHEVRON U.S.A. PRODUCTION COMPANY		Elevation 3741

Surface Location

UL or lot No. C	Section 12	Township 19 S	Range 36 E	Lot Idn	Feet from the 1200	North/South line NORTH	Feet from the 1350	East/West line WEST	County LEA
--------------------	---------------	------------------	---------------	---------	-----------------------	---------------------------	-----------------------	------------------------	---------------

Bottom Hole Location If Different From Surface

UL or lot No.	Section	Township	Range	Lot Idn	Feet from the	North/South line	Feet from the	East/West line	County
Dedicated Acres		Joint or Infill	Consolidation Code	Order No.					

NO ALLOWABLE WILL BE ASSIGNED TO THIS COMPLETION UNTIL ALL INTERESTS HAVE BEEN CONSOLIDATED
OR A NON-STANDARD UNIT HAS BEEN APPROVED BY THE DIVISION

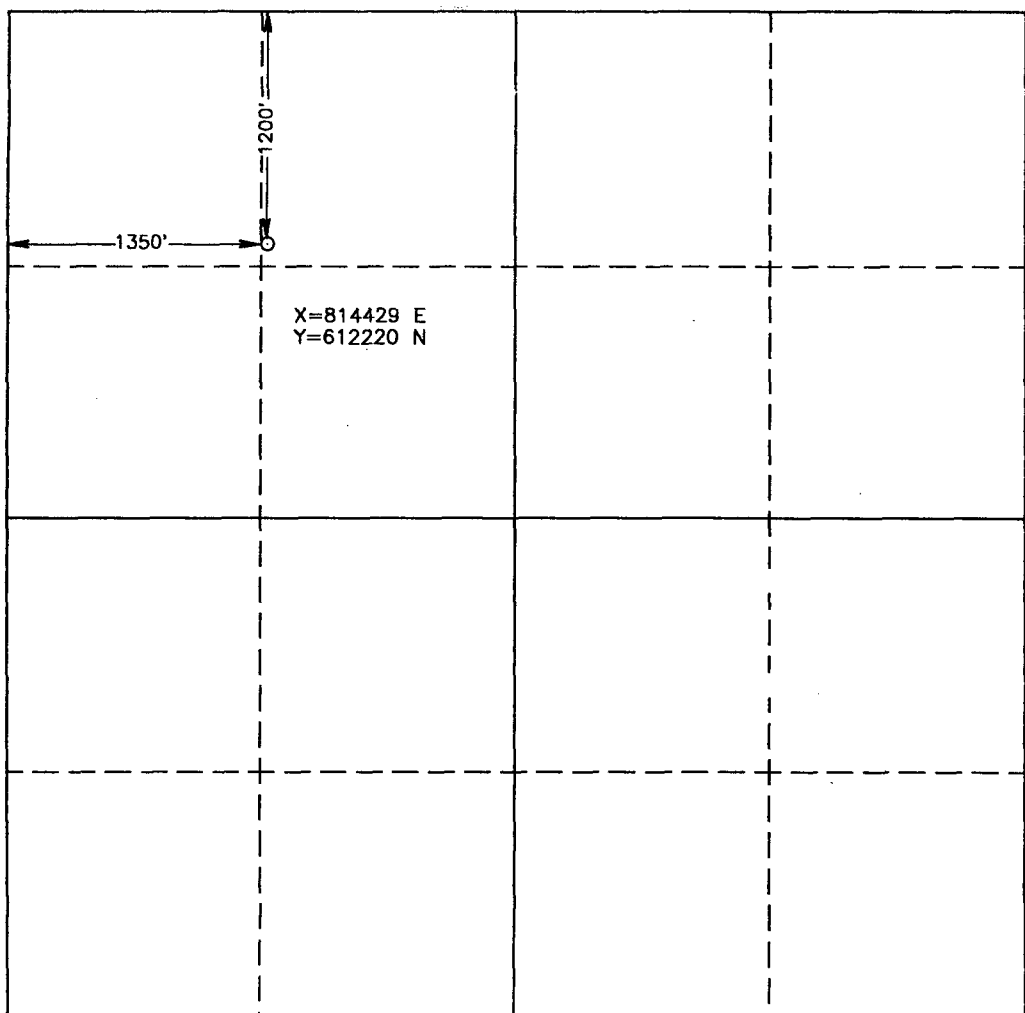
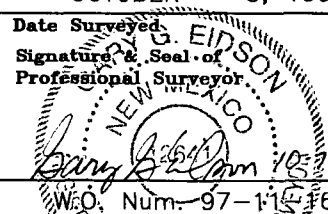
	OPERATOR CERTIFICATION <i>I hereby certify the the information contained herein is true and complete to the best of my knowledge and belief.</i> _____ Signature _____ Printed Name _____ Title _____ Date	
	SURVEYOR CERTIFICATION <i>I hereby certify that the well location shown on this plat was plotted from field notes of actual surveys made by me or under my supervision, and that the same is true and correct to the best of my belief.</i> OCTOBER 3, 1997 Date Surveyed _____ Signature & Seal of Professional Surveyor  W.O. Num. 97-1151619 Certificate No. RONALD J. EIDSON, 3239 PROFESSIONAL SURVEYOR, 12641	

DISTRICT I

P.O. Box 1980, Hobbs, NM 88241-1980

DISTRICT II

P.O. Drawer DD, Artesia, NM 88211-0719

DISTRICT III

1000 Rio Braxos Rd., Artesia, NM 87410

DISTRICT IV

P.O. Box 2088, Santa Fe, NM 87504-2088

State of New Mexico

Energy, Minerals and Natural Resources Department

Form C-102

Revised February 10, 1994

Submit to Appropriate District Office

State Lease - 4 Copies

Fee Lease - 3 Copies

OIL CONSERVATION DIVISION

P.O. Box 2088

Santa Fe, New Mexico 87504-2088

☐ AMENDED REPORT

WELL LOCATION AND ACREAGE DEDICATION PLAT

API Number	Pool Code	Pool Name
Property Code	Property Name MONUMENT "12" STATE	Well Number 14
OGRID No.	Operator Name CHEVRON U.S.A. PRODUCTION COMPANY	Elevation 3741

Surface Location

UL or lot No.	Section	Township	Range	Lot Idn	Feet from the	North/South line	Feet from the	East/West line	County
C	12	19 S	36 E		1200	NORTH	1350	WEST	LEA

Bottom Hole Location If Different From Surface

UL or lot No.	Section	Township	Range	Lot Idn	Feet from the	North/South line	Feet from the	East/West line	County
Dedicated Acres	Joint or Infill	Consolidation Code	Order No.						

NO ALLOWABLE WILL BE ASSIGNED TO THIS COMPLETION UNTIL ALL INTERESTS HAVE BEEN CONSOLIDATED
OR A NON-STANDARD UNIT HAS BEEN APPROVED BY THE DIVISION

	OPERATOR CERTIFICATION I hereby certify the the information contained herein is true and complete to the best of my knowledge and belief. <u>Dave Rittersbacher</u> Signature <u>Dave Rittersbacher</u> Printed Name <u>Geologist</u> Title <u>10/9/97</u> Date
	SURVEYOR CERTIFICATION I hereby certify that the well location shown on this plat was plotted from field notes of actual surveys made by me or under my supervision, and that the same is true and correct to the best of my belief. OCTOBER 3, 1997 Date Surveyed <u>GARY G. EDSON</u> Signature & Seal of Professional Surveyor <u>GARY G. EDSON</u> W.O. Num. 97-1151619 Certificate No. RONALD P. EDSON, 3239 GARY G. EDSON, 12841

Working Interest Owners
Monument Working Interest Unit
Lea Co., NM

Chevron USA
P.O. Box 1150
Midland, TX 79702
Attn: Dave Rittersbacher

Leede Operating Company
2100 Plaza Tower One
6400 S. Fiddler's Green Circle
Englewood, CO. 80111
Attn: Rusty Brusenhan

Amerada Hess Corporation
500 Dallas Street
Houston, TX 77002
Attn: W.S. Lehman

Phillips Petroleum Co.
4001 Penbrook
Odessa, TX 79762
Attn: Marianne McEwin

OCT 27 '97 06:59PM CHEVRON MIDLAND

TO: Michael Stogner
OCD - Santa FE
Fax (505) 827-1389

FROM: Dave Rittersbacher Chevron - Midland, TX
Office (915) 687-7114

2 Pages to follow

RE: NSL Application Monument "12" State #14

Michael,

Thanks for your call this afternoon. Attached are two faxes that we discussed. The first is a schematic diagram of the Abo trapping geometry in the North Monument area. The build-up that we are targeting is depicted on the far west edge of the schematic. The second fax is a structure map on top of the Abo reservoir. The mapping point is at the top of the cross-hatched interval shown in the schematic. The build-up is targeted because it gives us the best opportunity to be structurally high. Since we are losing structure to the north, being in the build-up is particularly important. I will have our landman- James Baca, call you to answer your questions regarding the Monument Working Interest Unit.

Thanks,

Dave

ABO TRAP GEOMETRY: Northern CBP - NM

Monument Abo Field

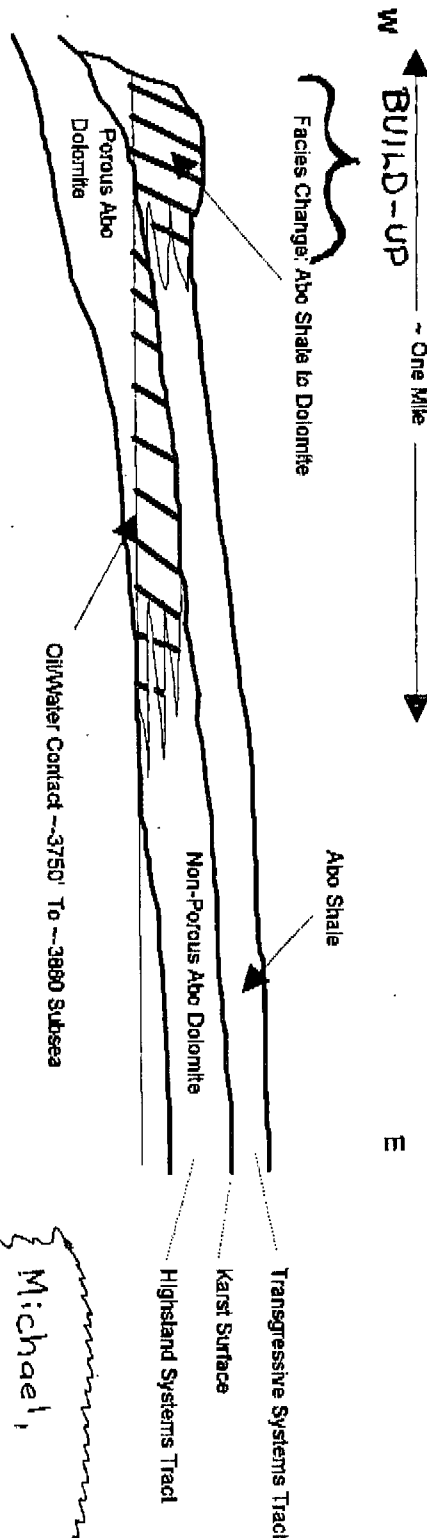

Goodwin Abo Field

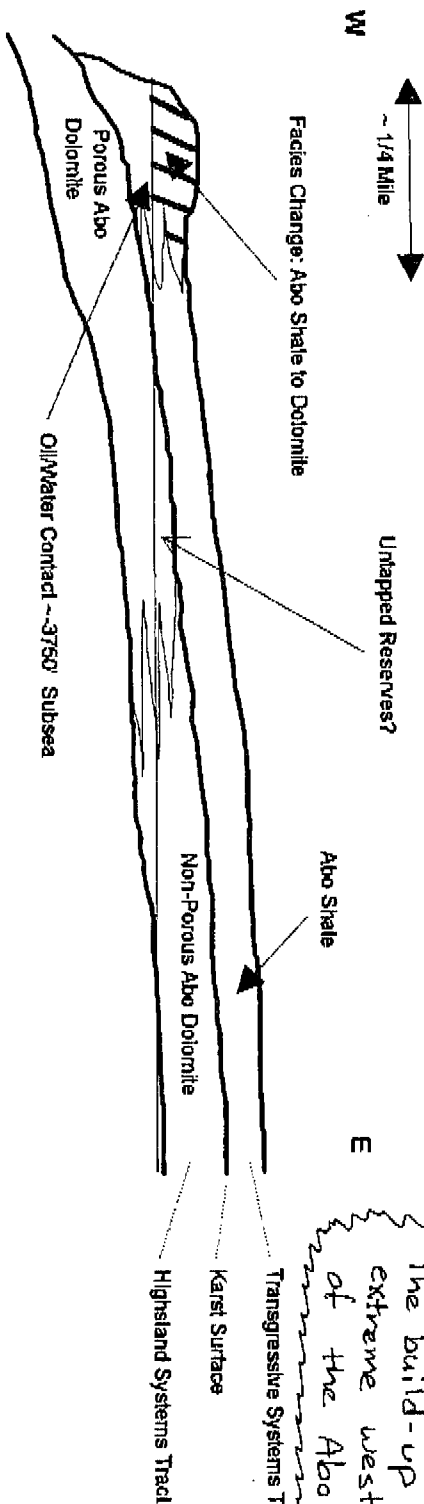

Michael,
The structure map
is drawn on top
of the [redacted]
"cross-hatched" area.
The build-up is on the
extreme western edge
of the Abo play.
Dave

Figure #2

10:28 AM 10/3/97

Abo_trap.xls

Prepared By: Dave Rittersbacher

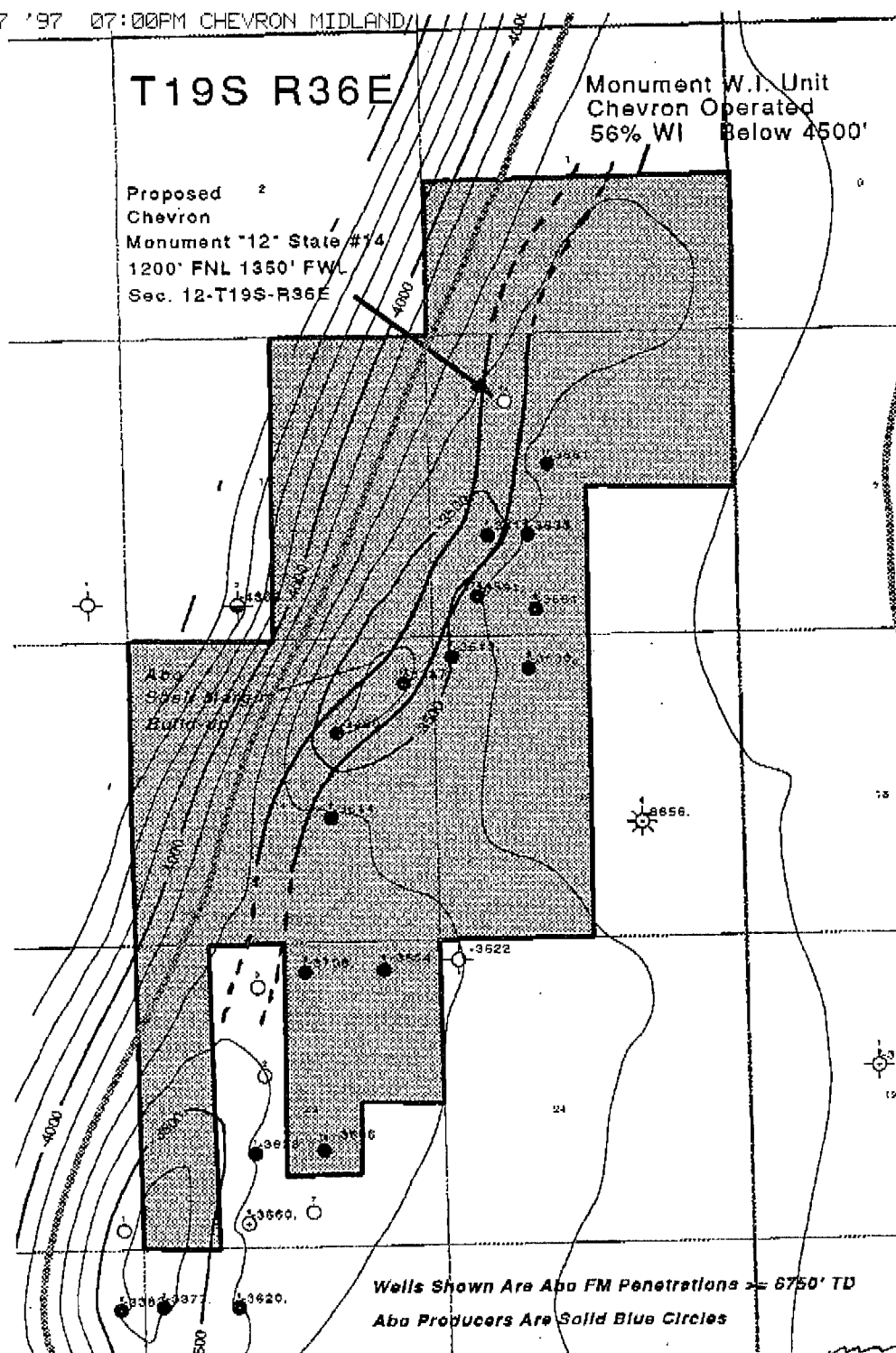

Chevron USA		
Monument Working Interest Unit Proposed Monument "12" State #14 Non-Standard Location		
Dave Rittersbacher		10/27/97
Scale 1:36000.		

Michael,
I added the projected trend of the build-up to the north and south. The interpretation is based on 3D seismic in areas of no well control.

Dave

County Lea

Pool North Monument - A60

TOWNSHIP 19 South

Range 36 East

NMPM

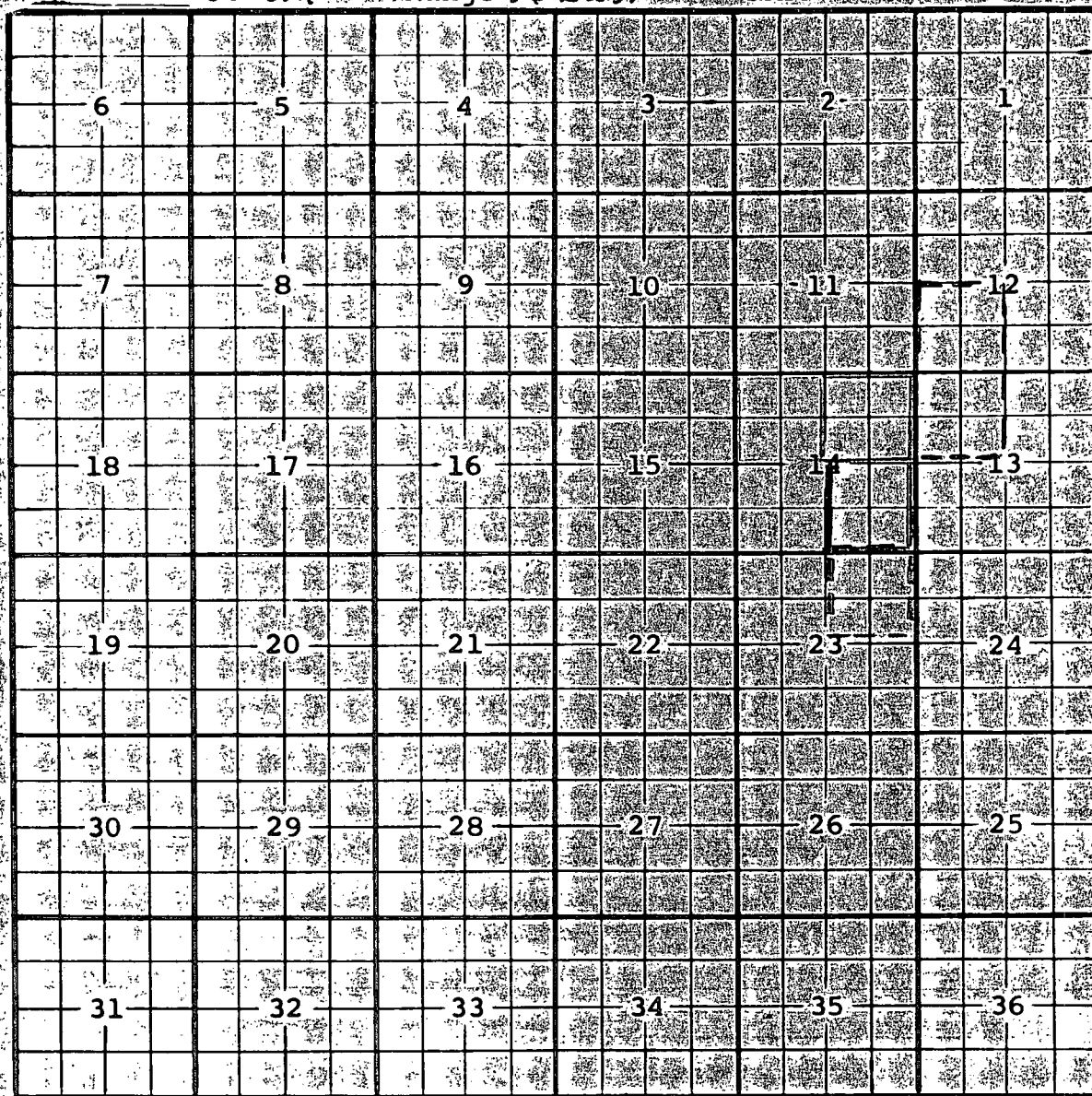

Description: NE 1/4 Sec 14 (R-5456, T-1-77)

Ext: SE 1/4 Sec. 14 (R-10776, 2-28-97)

CMD :
OG5SECT

ONGARD
INQUIRE LAND BY SECTION

10/28/97 11:37:06
OGOMES -EMEII
PAGE NO: 1

Sec : 12 Twp : 19S Rng : 36E Section Type : NORMAL

D 40.00 PEN B10164 03/53 PHILLIPS PETROLEU	C 40.00 PEN B10164 03/53 PHILLIPS PETROLEU	B 40.00 PEN B10164 03/53 PHILLIPS PETROLEU	A 40.00 PEN B10164 03/53 PHILLIPS PETROLEU
E 40.00 PEN B10164 1 03/53 PHILLIPS PETROLEU U A A	F 40.00 PEN B10164 03/53 PHILLIPS PETROLEU A A	G 40.00 PEN B10164 03/53 PHILLIPS PETROLEU	H 40.00 PEN B10164 03/53 PHILLIPS PETROLEU A

PF01 HELP
PF07 BKWD

PF02
PF08 FWD

PF03 EXIT
PF09 PRINT

PF04 GoTo
PF10 SDIV

PF05
PF11

PF06
PF12

CMD :
OG5SECT

ONGARD
INQUIRE LAND BY SECTION

10/28/97 11:37:18
OGOMES -EMEI
PAGE NO: 2

Sec : 12 Twp : 19S Rng : 36E Section Type : NORMAL

L 40.00 PEN B10233 04/53 PHILLIPS PETROLEU A A	K 40.00 PEN B10233 04/53 PHILLIPS PETROLEU A A	J 40.00 PEN B10233 04/53 PHILLIPS PETROLEU A	I 40.00 PEN B10233 04/53 PHILLIPS PETROLEU
M 40.00 PEN B10233 04/53 PHILLIPS PETROLEU A A	N 40.00 PEN B10233 04/53 PHILLIPS PETROLEU A A	O 40.00 PEN B10233 04/53 PHILLIPS PETROLEU A	P 40.00 PEN B10233 04/53 PHILLIPS PETROLEU

PF01 HELP
PF07 BKWD

PF02
PF08 FWD

PF03 EXIT
PF09 PRINT

PF04 GoTo
PF10 SDIV

PF05
PF11

PF06
PF12