

RECR - 6

REPORTS

2008

2008 REMEDIATION REPORT
FOR THE
RUTH PROPERTY IN EUNICE, NEW MEXICO

Topical Report RSI-2027

by

Angus Robb
Dave Henard
Charles Barber

RESPEC
5971 Jefferson NE, Suite 101
Albuquerque, New Mexico 87109

prepared for

New Mexico Oil Conservation Division
1220 South St. Francis Drive
Santa Fe, New Mexico 87505

December 23, 2008

TABLE OF CONTENTS

SECTION	PAGE
1.0 INTRODUCTION	1
2.0 PHASE 1: EXCAVATION AND DISPOSAL.....	1
2.1 EXCAVATION AND DISPOSAL.....	2
2.2 SAMPLING.....	2
3.0 PHASE 2: EXCAVATION, DISPOSAL, SAMPLING, BACKFILLING AND COMPACTION, GRADING AND SEEDING	2
3.1 EXCAVATION AND DISPOSAL.....	3
3.2 SAMPLING.....	3
3.3 BACKFILLING AND COMPACTION	3
3.3.1 Crusher Fines	3
3.3.2 Red Bed Clay.....	3
3.3.3 Topsoil.....	4
3.4 GRADING AND SEEDING.....	4
4.0 CONCLUSIONS AND RECOMMENDATION	4
4.1 INDICATION OF COMPACTION RESULTS AND TOPSOIL ANALYSES	4
4.2 NO FURTHER ACTION STATUS.....	4
4.3 ADDITIONAL ENVIRONMENTAL ASSESSMENT	4
5.0 SIGNATURES OF THE AUTHORS	5

LIST OF TABLES

TABLE	PAGE
1 Quick-Look Sheet of Soil Sample Analyses	T-1

LIST OF FIGURES

FIGURE	PAGE
1 Pit Location on the Ruth Property	F-1
2 Initial Sampling Locations.....	F-2
3 Phase 1 Sampling Locations.....	F-3
4 Phase 2 Sampling Locations.....	F-4
5 Backfill Cross Section.....	F-5

LIST OF PHOTOGRAPHS

PHOTO	PAGE
1 Original Pit Before Phase 1 Operations.....	P-1
2 Soil Stratigraphy in Pit.....	P-1
3 Excavation of North Pit.....	P-2
4 Close-up of Hydrocarbon-Contaminated Soil, East Side of Pit.....	P-2
5 South Side of Pit	P-3
6 North Side of Pit.....	P-3
7 Placement of Crusher Fines in Bottom of Excavation	P-4
8 First Lift of Red Bed Clay After Compaction.....	P-4
9 Second Lift of Red Bed Clay	P-5
10 Crusher Fines Covering Red Bed Clay	P-5
11 Compaction Testing of Crusher Fines	P-6
12 Spreading Topsoil to Level Site.....	P-6

LIST OF FOLDERS/FILES ON COMPACT DISK

Transport Manifests—Phase 1
 Laboratory Analyses of Soil Samples—Phase 1
 Transport Manifests—Phase 2
 Laboratory Analyses of Soil Samples—Phase 2
 Compaction Test Results
 Backfill Manifests

1.0 INTRODUCTION

RESPEC was retained by the New Mexico State Oil Conservation Division (OCD) on June 3, 2008 to conduct remediation of a site in southeast New Mexico contaminated by exempt oilfield waste. The site is known as the Ruth Property and is situated at the northwest corner of Avenue R and 15th Street in Eunice, New Mexico (see Figure 1. Pit Location on the Ruth Property). Operations began on June 5, 2008, and were completed by November 20, 2008. A total of 15,604 cubic yards (cu yds) was excavated, hauled, and disposed. The resulting open pit was backfilled with 15,260 cu yds of suitable materials and compacted to greater than 90 percent of Standard Proctor test compaction. The property was then graded to original contours, watered, and seeded with grass.

The project was performed in two phases, separated by an interval during which additional funding was procured.

2.0 PHASE 1: EXCAVATION AND DISPOSAL

Phase 1 operations began on June 5, 2008, and ended on June 27, 2008. Excavation materials consisted of topsoil, caliche, and sand contaminated by exempt oilfield waste in the form of petroleum hydrocarbons and chlorides resulting from the processing of crude oil and salt water at the facility formerly on the property.

RESPEC hired Phoenix Environmental LLC of Hobbs, New Mexico, to perform excavation and hauling operations and Sundance Services Inc. of Eunice, New Mexico, for use of its Parabo disposal facility. Material samples were analyzed by Hall Environmental Analysis Laboratories of Albuquerque, New Mexico.

A small previously excavated pit existed on the property (see Photographs 1 and 2 in the Photographs section of this report). This pit was enlarged after sample analyses indicated that additional contaminants were present both laterally and at depth. The ongoing soil analysis process revealed that the excavated volume of petroleum-contaminated soils would exceed 15,000 cu yds. Operations were suspended at the end of OCD's fiscal year on June 30, 2008, and then recommenced on July 28, 2008, as new project funding was made available for the new fiscal year.

Photographs 3 and 4, relating to Phase 1 excavation, can be found in the Photographs section of this report.

The quantities from Phase 1 operations are given in the following subsection.

2.1 EXCAVATION AND DISPOSAL

10,124 cu yds of contaminated materials was excavated and disposed during Phase 1 operations. Images of manifests and laboratory analyses relating to this task are contained on the compact disk (CD) included with this report.

2.2 SAMPLING

Contaminant delineation was assessed by sampling and subsequent analyses employing Environmental Protection Agency (EPA) Methods 418.1 (total petroleum hydrocarbons), 8015B (gasoline, diesel, motor oil range hydrocarbons [GRO, DRO, MRO]), and 300.0 Anions (chlorides). Results of the sample analyses are contained on the CD included with this report. A quick-look sheet of all Phase 1 laboratory results is included as Table 1 of this report. Site plans showing the locations and values of samples taken in Phase 1 are included as Figure 2 and Figure 3.

3.0 PHASE 2: EXCAVATION, DISPOSAL, SAMPLING, BACK-FILLING AND COMPACTION, GRADING AND SEEDING

Phase 2 field operations began on July 28, 2008, and ended on November 20, 2008. RESPEC hired the same subcontractors used in Phase 1. The work consisted of further excavation of contaminated materials and disposal of them as performed in Phase 1.

On completion of excavation, the open pit was backfilled with appropriately tested and compacted materials. Lastly, the property was graded, watered, and seeded with grass. Photographs 5 and 6, relating to Phase 2 excavation, can be found in the Photographs section of this report.

The quantities from Phase 2 operations are given in the following subsection.

3.1 EXCAVATION AND DISPOSAL

5,480 cu yds of contaminated materials was excavated, transported, and disposed at the Sundance Parabo facility. Images of manifests and soil sample analyses relating to this task are contained on the CD included with this report.

3.2 SAMPLING

Contaminant delineation was controlled as in Phase 1, utilizing the same laboratory analysis procedures as in Phase 1. The results are presented on the CD accompanying this report. A site plan showing the locations and values of samples taken in Phase 2 is included as Figure 4.

3.3 BACKFILLING AND COMPACTION

Backfilling and compaction were carried out from October 8, 2008, to November 13, 2008. Potential backfill materials were collected and tested for compactibility by Pettigrew and Associates of Hobbs, New Mexico. Pettigrew performed Standard Proctor tests per ASTM D 698. Test results are contained on the CD accompanying this report. Three types of backfill materials, discussed in the following subsections, were tested, determined to be suitable, and placed in the excavated zone. Photographs 7, 8, 9, 10, and 11 in the Photographs section of this report relate to this task.

3.3.1 Crusher Fines

9,980 cu yds of crusher fines, obtained from Wallach Concrete of Eunice, New Mexico, was emplaced and compacted in the pit. Images of manifests relating to this task are contained on the CD included with this report. Emplacement and compaction were executed in 2- to 3-foot lifts. The percentage compaction achieved, as related to Proctor tests, was measured at 2- to 3-foot lift intervals. These results are contained on the CD included with this report. In every case, tests showed that compaction of 90 percent or more was achieved. A cross section of the backfilled pit is included as Figure 5. It illustrates the locations of crusher fines emplacement and compaction.

3.3.2 Red Bed Clay

Red Bed clay, obtained from Wallach Concrete, was determined to be suitable for emplacement as an impervious layer about midway in the pit. 1,940 cu yds of red bed

clay was emplaced and compacted in the pit. Images of manifests relating to this task are contained on the CD included with this report. The location of the clay layer is shown in the cross section designated as Figure 5. The purpose of the clay layer is to provide an impervious barrier to downward subsurface migration of hydrocarbon and chloride contaminants percolating to groundwater. Compaction results are contained on the CD accompanying this report.

3.3.3 Topsoil

Topsoil was tested for contaminants and compactibility and determined to be suitable. 3,340 cu yds of this material was emplaced and compacted as the top layer over the pit. Images of manifests relating to this task are contained on the CD included with this report. Compaction results are also contained on the CD included with this report.

3.3.4 Grading and Seeding

Topsoil was graded to original ground contours, watered to a depth of 12 inches, and seeded with rye grass. Photograph 12 in the Photographs section of this report relates to this task.

4.0 CONCLUSIONS AND RECOMMENDATIONS

4.1 BACKFILLING AND COMPACTION

Compaction results and topsoil analyses indicate that the Ruth Property site is suitable for housing construction.

4.2 NO FURTHER ACTION STATUS

Currently, the Ruth Property site does not qualify for No Further Action (NFA) status, because hydrocarbon concentration at depth exceeds the 100 ppm limit for soils.

4.3 ADDITIONAL ENVIRONMENTAL ASSESSMENT

If NFA or site closure status is required, additional environmental assessment may be necessary for this site. Assessment may include groundwater evaluation for on-site and potential off-site sources of chemicals of concern.

5.0 SIGNATURES OF THE AUTHORS

Signatures of the RESPEC professionals involved in the preparation of this report:



Angus Robb
Project Manager



David A. Henard
Geologist II



Charles A. Barber
Geologist

ANALYTICAL RESULTS OF SOIL SAMPLES FROM THE RUTH PROPERTY SITE IN EUNICE, NM
FROM PHASE 1 AND PHASE 2 OPERATIONS
(p.1 of 3)

Sample #	Date/Time of Sample	Sample Location / Soil Description	Depth (ft.)	DRO	MRO	GRO	TPH	Chlorides
				Concentrations in Parts Per Million (ppm)				
500	6/5/08, 7:59 a.m.	Dirt pile southwest (brown soil)	0				270	
501	6/5/08, 8:02 a.m.	Dirt pile southeast (brown soil)	0				38	
502	6/5/2008	Sample discarded	--				NA	
503	6/5/08, 8:05 a.m.	Dirt pile northeast (brown soil)	0				190	
504	6/5/08, 8:09 a.m.	Dirt pile northwest (brown soil)	0				260	
505	6/5/08, 2:34 p.m.	Original pit wall south (brown soil)	3				9,200	
506	6/5/08, 2:38 p.m.	Original pit wall west (brown soil)	3				ND	
507	6/5/08, 2:43 p.m.	Original pit wall west north side (brown soil)	3				ND	
508	6/5/08, 2:50 p.m.	Pit floor south (black caliche)	6				1,600	
509	6/5/08, 2:57 p.m.	Pit wall north soft black layer	6				340,000	
510	6/5/08, 3:05 p.m.	Caliche pit N east side (caliche stained brown)	12				13,000	
511	6/5/08, 3:09 p.m.	Caliche pit N north side (white caliche)	15				ND	
512	6/6/08, 8:04 a.m.	Truck # 27	--				3,500	
513	6/6/08, 10:53 a.m.	PNM trench sample (brown soil w/ solid black chunks)	2				820	
514	6/6/08, 2:38 p.m.	Pit floor east caliche (clean-looking)	10				ND	
515	6/6/08, 3:01 p.m.	Truck # 40	--				2,600	
516	6/7/08, 7:50 a.m.	Truck # 62	--				420	
517	6/7/08, 11:08 a.m.	Truck # 75	--				1,200	
518	6/9/08, 7:18 a.m.	Pit bottom caliche NE corner (stained grey)	10				15,000	
519	6/9/08, 7:42 a.m.	Test pit west north fence line (brown soil)	2				ND	
520	6/9/08, 7:58 a.m.	Test pit middle north fence line (brown soil)	2				ND	
521	6/9/08, 8:00 a.m.	Test pit east north fence line (brown soil)	2				ND	
522	6/9/08, 8:13 a.m.	Truck # 82	--				600	
523	6/9/08, 10:23 a.m.	Truck # 96	--				13,000	
524	6/9/08, 11:45 a.m.	South pit wall exploration (black soil)	3				5,800	
525	6/9/08, 5:40 p.m.	Truck# 120	--				4,400	
526	6/10/08, 7:18 a.m.	Truck # 118	--				220	
527	6/10/08, 10:28 a.m.	Black caliche near old telephone pole	6				5,400	
528	6/10/08, 12:11 a.m.	Truck # 140	--				4,800	
529	6/10/08, 2:58 p.m.	Truck # 153	--				1,200	
530	6/11/08, 1:30 p.m.	Truck # 190	--				810	
531	6/12/08, 7:56 a.m.	Truck #209	--				1400	
532	6/12/08, 8:04 a.m.	Caliche Floor East (light brown stained caliche)	10				480	
533	6/12/08, 8:08 a.m.	Caliche Floor Middle (light brown stained caliche)	10				510	
534	6/12/08, 8:12 a.m.	Caliche Floor West (light brown stained caliche)	10				91	
535	6/12/08, 8:48 a.m.	Truck # 222	--				4,400	
536	6/13/08, 8:54 a.m.	Truck # 255	--				220	
537	6/13/08, 10:40 a.m.	South caliche Pit (grey caliche)	20				8,800	

ANALYTICAL RESULTS OF SOIL SAMPLES FROM THE RUTH PROPERTY SITE IN EUNICE, NM
FROM PHASE 1 AND PHASE 2 OPERATIONS

(p.2 of 3)

Sample #	Date/Time of Sample	Sample Location / Soil Description	Depth (ft.)	DRO	MRO	GRO	TPH	Chlorides
				Concentrations in Parts Per Million (ppm)				
538	6/13/08, 11:30 a.m.	South caliche Pit (red sand)	20				5,200	
539	6/16/08, 9:30 a.m.	South Pit Floor (gold brown caliche)	13				3,300	
540	6/16/08, 10:00 a.m.	Truck # 307	--				8,900	
541	6/16/08, 4:05 p.m.	Truck # 330	--				1,500	
542	6/16/08, 4:43 p.m.	South Pit Wall (gold/brown caliche)	10				2,700	
543	6/17/08, 11:30 a.m.	Truck # 349	--				1,300	
544	6/17/08, 11:38 a.m.	Brown soil east of pit	2				280	
545	6/18/08, 8:46 a.m.	Southwest corner of pit grey caliche (wet-looking)	10				9,500	
546	6/19/08, 7:49 a.m.	Truck # 411	--				350	
547	6/19/08, 4:21 p.m.	Truck # 442	--				ND	
548	6/19/08, 4:38 p.m.	South pit damp red sand	27				7,300	
549	6/19/08, 4:42 p.m.	North pit damp red sand	20				ND	
550	6/20/08, 9:30 a.m.	Truck # 445	--				2,100	
551	6/20/08, 10:12 a.m.	Truck # 452	--				1,700	
552	6/23/08, 2:02 p.m.	Truck # 520	--				26	
Center floor	6/24/08, 1:20 p.m.	Composite	--	ND	ND	ND	310	
North floor	6/24/08, 1:28 p.m.	Composite	--	55	ND	ND	200	
North wall	6/24/08, 1:29 p.m.	Composite	--	410	170	ND	35	
West wall (N)	6/24/08, 1:35 p.m.	Composite	--	41	ND	ND	1200	
East wall	6/24/08, 1:43 p.m.	Composite	--	39	66	ND	100	
South wall	6/24/08, 1:59 p.m.	Composite	--				350	
West wall (S)	6/24/08, 2:04 p.m.	Composite	--				2900	
South floor	6/24/08, 2:07 p.m.	Composite	--				1000	
600	9/4/08, 4:02 p.m.	SW wall N	25	12	ND	ND	ND	
601	9/4/08, 4:05 p.m.	SW wall S	25	18	ND	ND	34	
602	9/4/08, 4:10 p.m.	S wall W	22	16	ND	ND	22	
603	9/4/08, 4:17 p.m.	S wall, gold	15	7500	10,000	ND	17,000	
604	9/4/08, 4:22 p.m.	SE corner	25	10,000	13,000	280	24,000	
605	9/4/08, 4:31 p.m.	East side topsoil	2	250	1200	ND	550	
606	9/8/08, 10:20 a.m.	SE corner, caliche block	12	1800	3400	ND	3000	
607	9/8/08, 10:25 a.m.	South wall yellow	12	9000	12,000	ND	26,000	
608	9/8/08, 10:29 a.m.	SW wall	10	ND	ND	ND	ND	
609	9/8/08, 10:41 a.m.	West wall (corner block)	10	310	1400	ND	900	
610	9/10/08, 8:29 a.m.	North soil (West)	3	ND	ND	ND	34	
611	9/10/08, 8:34 a.m.	North soil (East)	2	ND	ND	ND	ND	
612	9/10/08, 8:43 a.m.	North 1st Bench (East)	8	540	2600	ND	610	
613	9/10/08, 8:47 a.m.	North 1st Bench (West)	8	ND	ND	ND	ND	

ANALYTICAL RESULTS OF SOIL SAMPLES FROM THE RUTH PROPERTY SITE IN EUNICE, NM
FROM PHASE 1 AND PHASE 2 OPERATIONS

(p.3 of 3)

Sample #	Date/Time of Sample	Sample Location / Soil Description	Depth (ft.)	DRO	MRO	GRO	TPH	Chlorides
				Concentrations in Parts Per Million (ppm)				
614	9/10/08, 8:53 a.m.	Soil east wall (North)	6	ND	ND	ND	ND	
615	9/10/08, 9:00 a.m.	East wall caliche bench (North)	2	440	1700	ND	1300	
616	9/10/08, 9:06 a.m.	East caliche wall (middle)	8	690	2200	ND	530	
617	9/10/08, 9:11 a.m.	SE corner soil	6	ND	ND	ND	ND	
618	9/10/08, 9:17 a.m.	South caliche wall (middle)	10	ND	ND	ND	ND	
619	9/10/08, 9:20 a.m.	South caliche wall (West)	10	ND	ND	ND	ND	
620	9/10/08, 9:27 a.m.	SW corner caliche	6	ND	ND	ND	ND	
621	9/10/08, 10:17 a.m.	Soil East wall (South)	4	ND	ND	ND	ND	
622	9/10/08, 10:21 a.m.	West "L" corner	9	ND	ND	ND	ND	
623	9/10/08, 10:33 a.m.	East wall caliche (North)	20	ND	ND	ND	ND	
624	9/10/08, 10:35 a.m.	East wall caliche (South)	22	22	76	ND	30	
625	9/10/08, 10:39 a.m.	South wall caliche	23	2600	4100	ND	3900	
626	9/10/08, 10:44 a.m.	SW corner caliche	25	ND	ND	ND	ND	
627	9/10/08, 10:48 a.m.	West wall South caliche	22	ND	ND	ND	ND	
628	9/16/08, 3:43 p.m.	SE corner (New)	24	ND	ND	ND	ND	150
629	9/16/08, 3:51 p.m.	South wall (New)	25	510	800	ND	880	630
630	9/16/08, 4:04 p.m.	West mid wall	23	ND	ND	ND	ND	100
631	9/16/08, 4:13 p.m.	NW wall	8	ND	ND	ND	ND	1.4
C1	9/16/08, 4:39 p.m.	Composite of all flagged samples	--	38	93	ND	ND	43
632	9/29/08, 11:05 a.m.	SE corner soil	4	ND	ND	ND	ND	
633	9/29/08, 11:09 a.m.	East side caliche/soil	7	ND	ND	ND	ND	
634	9/29/08, 11:11 a.m.	NE corner soil	4	ND	ND	ND	ND	
635	10/1/08, 4:23 p.m.	South of monitoring wells, caliche	10	ND	ND	ND	ND	
636	10/1/08, 4:29 p.m.	East caliche bench by telephone pole	13	ND	ND	ND	ND	
637	10/1/08, 4:36 p.m.	East caliche bench south	11	ND	ND	ND	ND	
638	10/20/08, 3:51 p.m.	[Backfill] crusher fines from Wallach Concrete	--	ND	ND	ND	ND	6.9
639	10/20/08, 3:55 p.m.	[Backfill] Red Bed clay from Wallach Concrete	--	ND	ND	ND	ND	23
640	10/20/08, 3:58 p.m.	[Not used as backfill] topsoil from Wallach Concrete	--	ND	ND	ND	ND	3.4
		[Backfill -- analysis ordered from Cardinal Laboratory by Phoenix Environmental] topsoil from local residential property						
641	10/29/08, 1:00 p.m.		--	<10	<10	<10		<16

DRO, MRO, GRO results are from analysis by EPA procedure 8015B
TPH results are from analysis by EPA procedure 418.1
Chlorides results are from analysis by EPA procedure 300.0

Pit Location on the Ruth Property

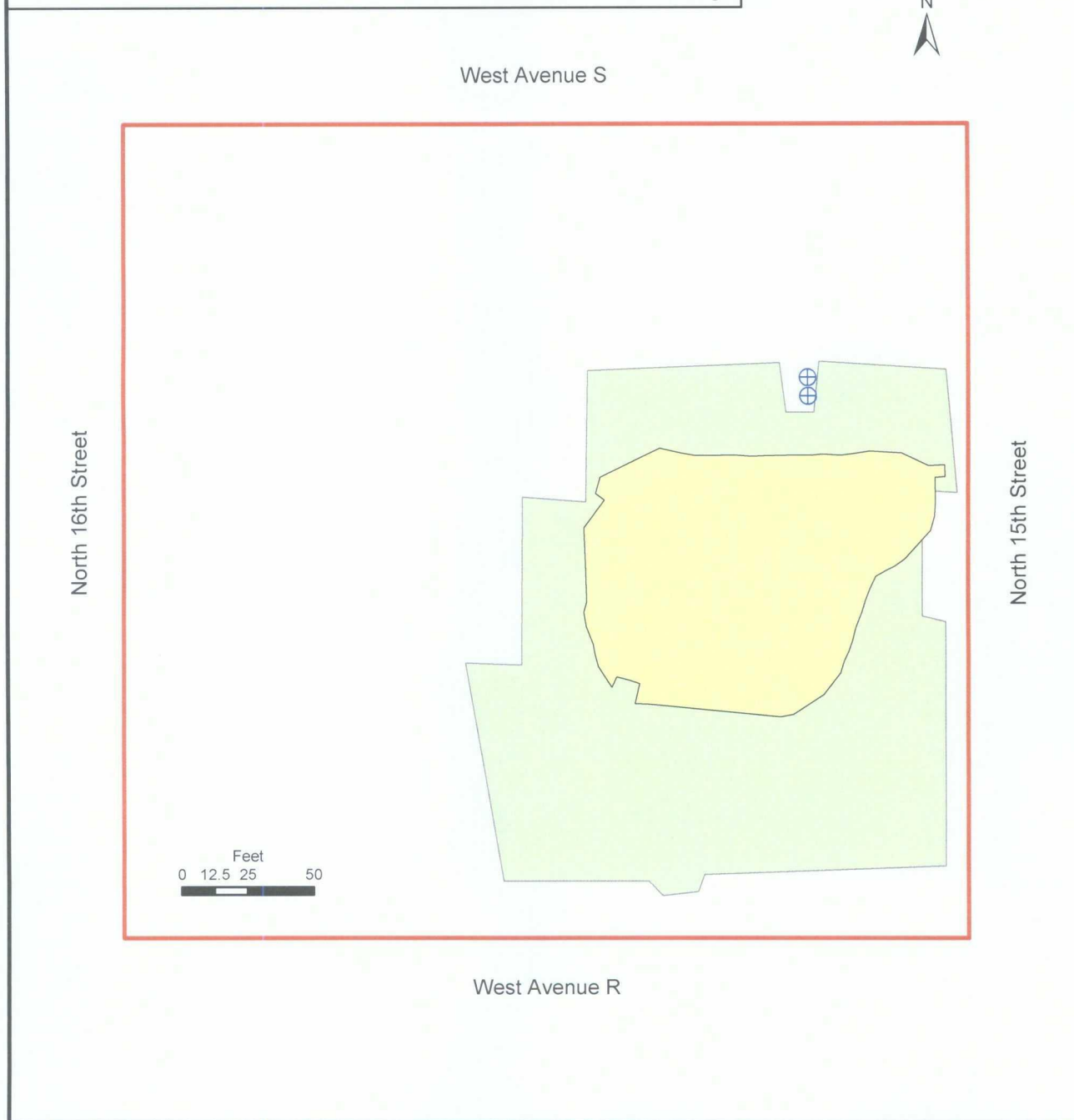

Legend

- ⊕ Monitoring well
- Yellow Original Pit
- Light Green Final pit
- Red Fence line



Ruth Property
Eunice
Lea County, NM

Created by: Charles Barber
Date: 12-19-2008

Figure 1

Initial Pit Sampling Locations



> MW-N 42.40 ft
> MW-S 42.13 ft

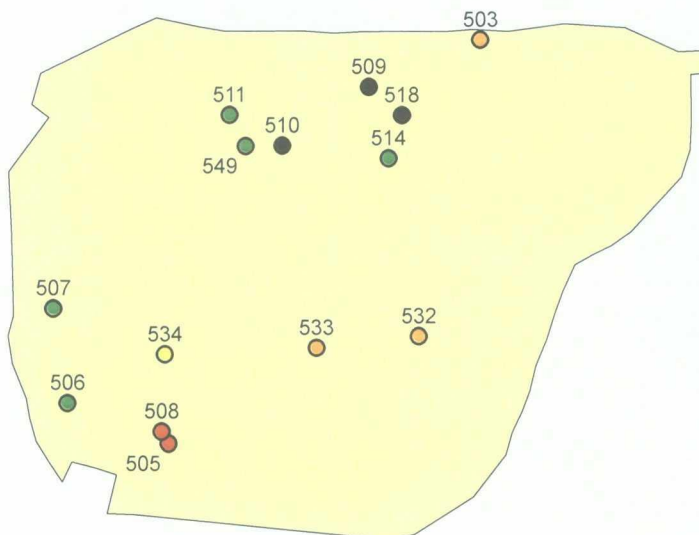

Legend

> Monitoring well

TPH in ppm

EPA 418.1

- 0
- 1 - 100
- 101 - 1000
- 1001 - 10000
- 10001 - 1000000

Original Pit

0 15 30 60
Feet



Ruth Property
Eunice
Lea County, NM

Created by: Charles Barber
Date: 12-19-2008

Figure 2

Phase 1 Sampling Locations



> MW-N 42.40 ft
> MW-S 42.13 ft

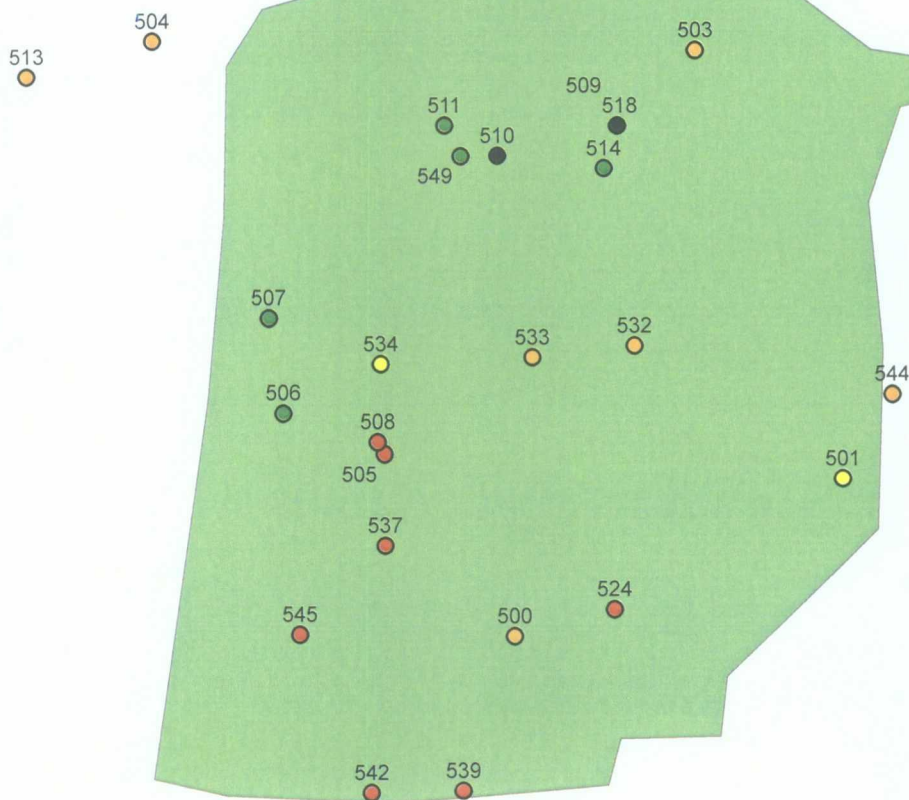

Legend

> Monitoring well

TPH in ppm

EPA 418.1

- 0
- 1 - 100
- 101 - 1000
- 1001 - 10000
- 10001 - 1000000

Phase 1 Pit

0 15 30 60
Feet



Ruth Property
Eunice
Lea County, NM

Created by: Charles Barber
Date: 12-19-2008

Figure 3

Phase 2 Sampling Locations

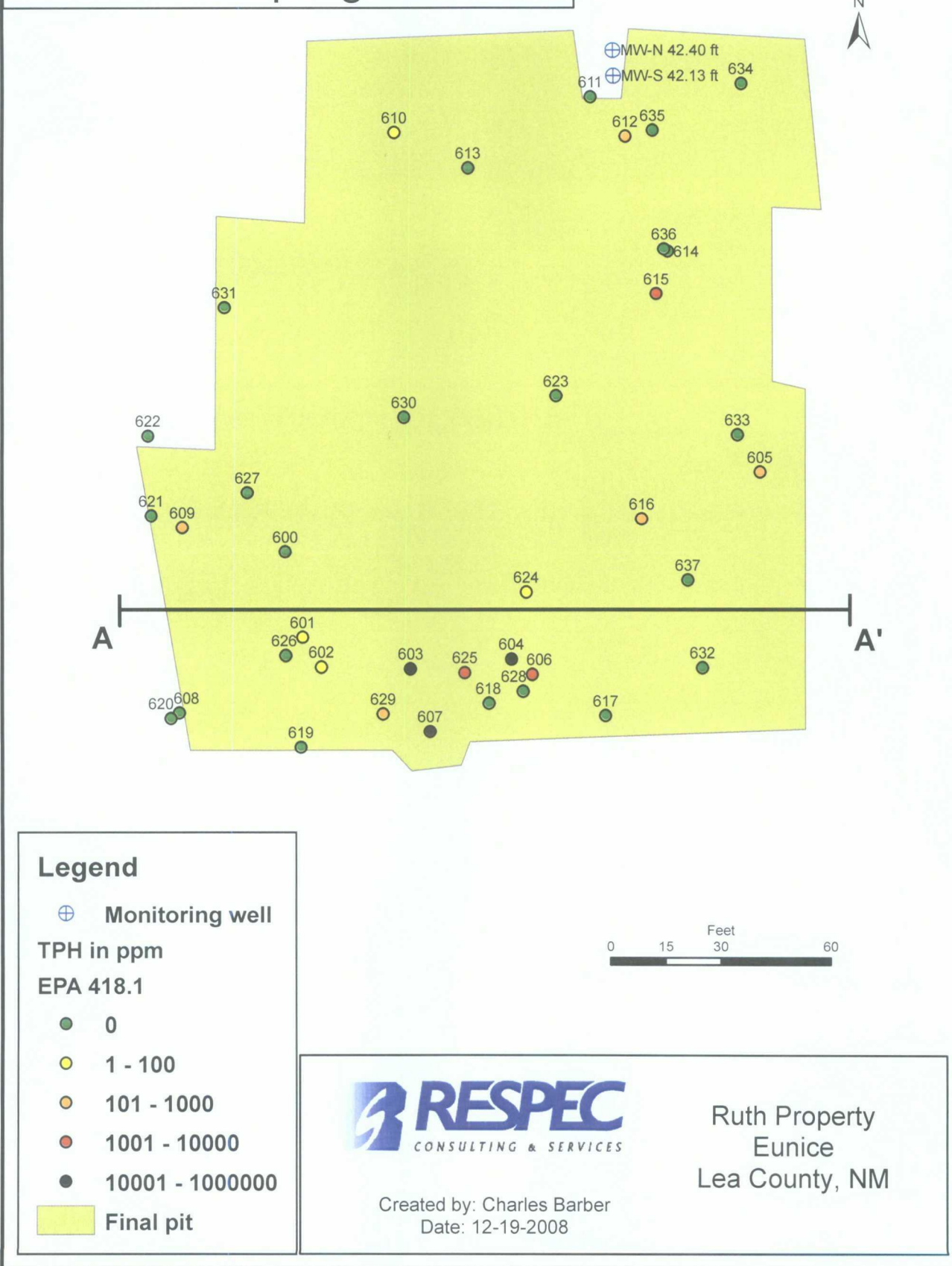

Figure 4

Backfill Cross Section



West

East

A

A'



Vertical Scale - 30 Feet

Note: Vertical scale has been exaggerated to show detail

Horizontal Scale - 60 Feet

Legend

-  Topsoil
-  Red Bed Clay
-  Crusher Fines



Created By: Charles Barber
Date: 12-19-2008

Ruth Property
Eunice
Lea County, NM

Figure 5



Photograph 1: Original Pit Before Phase 1 Operations. View to the Northeast

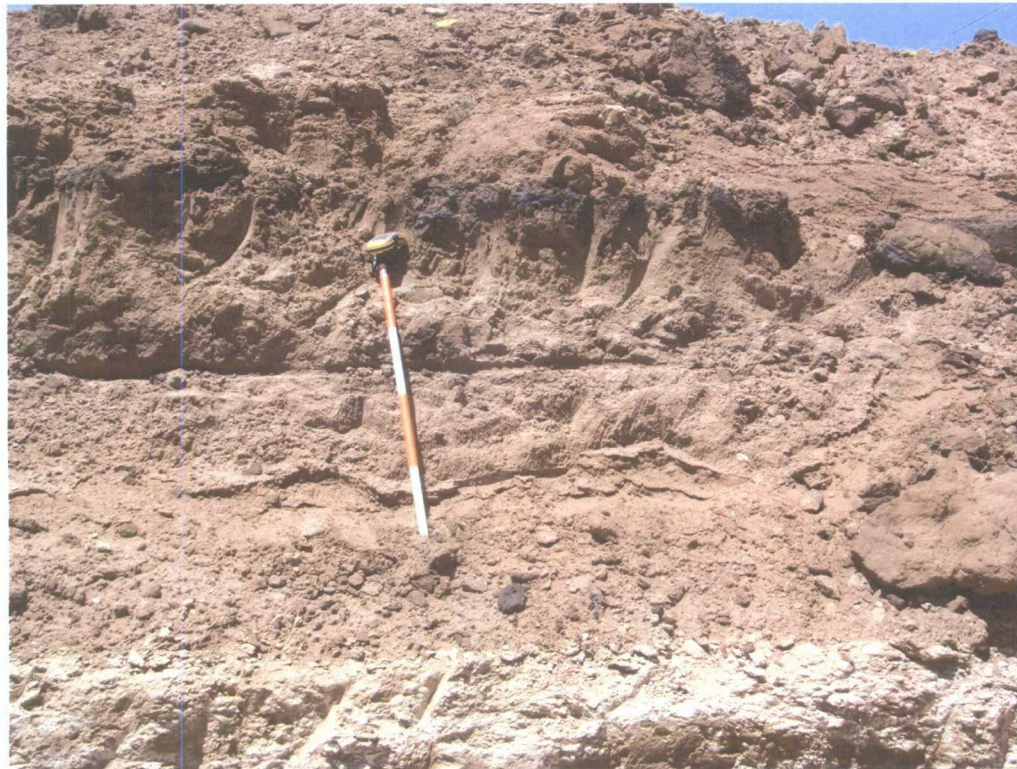

Photograph 2: Soil Stratigraphy in Pit. View to the North.



Photograph 3: Excavation of North End of Pit



Photograph 4: Close-up of Hydrocarbon-Contaminated Soil,
East Side of Excavation



Photograph 5: South Side of Excavation. View to the East.



Photograph 6: North Side of Pit . View to the West.



Photograph 7: Crusher Fines Placement in Bottom of Excavation



Photograph 8: First Lift of Red Bed Clay After Compaction



Photograph 9: Second Lift of Red Bed Clay



Photograph 10: Crusher Fines Covering Red Bed Clay



Photograph 11: Compaction Testing of Crusher Fines



Photograph 12: Spreading Topsoil to Level Site

Manifests Missing on CD-ROM

See paper copies following this page.

Section 1:

128
154b
220b
257b

Section 2:

48
49
86
90b
92b

Section 3:

351 - 353
355
357 - 359
467
486b
507 - 517

Section 4:

291b
252

b = the pink manifest sheet

128

TRANSPORTER'S MANIFEST

MANIFEST#

93890

SHIPPING FACILITY NAME & ADDRESS:

Respec
5971 Jefferson St NE Suite 101
Albuquerque NM 87109-3413

LOCATION OF MATERIAL:

Ruth Property
NW Corner of 15th and Ave R

TRANSPORTER NAME & ADDRESS:

Phoenix Environmental

DESCRIPTION OF WASTE:

NON-HAZARDOUS CONTAMINATED SOIL

QUANTITY:

20 cy

FACILITY CONTACT:

Angus Robb 505-379-2072

DATE:

9-9-08

SIGNATURE OF CONTACT:

Angus Robb

NAME OF TRANSPORTER: (DRIVER)

DATE:

9-9-08

SIGNATURE OF DRIVER:

Keith Johnson

DISPOSAL SITE:

SUNDANCE SERVICES INC.
P.O. BOX 1737
EUNICE NM 88231

DATE:

9-9-08

SIGNATURE :

Quacosta

Sundance Services, Inc.

P.O. Box 1737 ★ Eunice, New Mexico 88231

(575) 394-2511

Transporter
Manifest
154

Ticket # 94060

Lease Operator/Shipper/Company: Respec

Lease Name: Right Property

Transporter Company: Phoenix

Time

9:01 AM/PM

Date: 9-10-08

Vehicle No. 207

Driver No. 207

Charge To: Respec

TYPE OF MATERIAL

☐ Produced Water

☐ Drilling Fluids

☐ Completion Fluids

☐ Tank Bottoms

☒ Contaminated Soil

☐ C-117 No.:

☐ Other Materials

☐ BS&W Content:

Description: Oil

☐ JETOUT

☐ CALLOUT

VOLUME OF MATERIAL

BBLS.

20 YARDS

AS A CONDITION TO SUNDANCE SERVICES, INC.'S ACCEPTANCE OF THE MATERIALS SHIPPED WITH THIS JOB TICKET, OPERATOR/SHIPPER REPRESENTS AND WARRANTS THAT THE WASTE MATERIAL SHIPPED HERewith IS MATERIAL EXEMPT FROM THE RESOURCE, CONSERVATION AND RECOVERY ACT OF 1976, AS AMENDED FROM TIME TO TIME, 40 U.S.C. 6901, ET SEQ., THE NM HEALTH AND SAF. CODE 361.001 ET SEQ., AND REGULATIONS RELATED THERETO, BY VIRTUE OF THE EXEMPTION AFFORDED DRILLING FLUIDS, PRODUCED WATERS, AND OTHER WASTE ASSOCIATED WITH THE EXPLORATION, DEVELOPMENT OR PRODUCTION OF CRUDE OIL OR NATURAL GAS OR GEOTHERMAL ENERGY.

ALSO AS A CONDITION TO SUNDANCE SERVICES, INC.'S ACCEPTANCE OF THE MATERIALS SHIPPED WITH THIS JOB TICKET, TRANSPORTER REPRESENTS AND WARRANTS THAT ONLY THE MATERIAL DELIVERED BY OPERATOR/SHIPPER TO TRANSPORTER IS NOW DELIVERED BY TRANSPORTER TO SUNDANCE SERVICES, INC.'S FACILITY FOR DISPOSAL.

THIS WILL CERTIFY that the above Transporter loaded the material represented by this Transporter Statement at the above described location, and that it was tendered by the above described shipper. This will certify that no additional materials were added to this load, and that the material was delivered without incident.

DRIVER: Keith Johnson

FACILITY REPRESENTATIVE: Alcosta

Sundance Services, Inc.

P.O. Box 1737 ★ Eunice, New Mexico 88231

(575) 394-2511

Transporters
Manifest
220

Ticket # 84751

Lease Operator/Shipper/Company: Prosper

Lease Name: Bluff 113

Transporter Company: Prosper

Time 10:51

AM/PM

Date: 10-2-08

Vehicle No. 207

Driver No. 207

Charge To: Prosper

TYPE OF MATERIAL

☐ Produced Water

☐ Drilling Fluids

☐ Completion Fluids

☐ Tank Bottoms

☒ Contaminated Soil

☐ C-117 No.:

☐ Other Materials

☐ BS&W Content:

☐ JETOUT

☐ CALLOUT

Description: DIP

VOLUME OF MATERIAL

BBLS 20

YARDS

AS A CONDITION TO SUNDANCE SERVICES, INC.'S ACCEPTANCE OF THE MATERIALS SHIPPED WITH THIS JOB TICKET, OPERATOR/SHIPPER REPRESENTS AND WARRANTS THAT THE WASTE MATERIAL SHIPPED HERewith IS MATERIAL EXEMPT FROM THE RESOURCE, CONSERVATION AND RECOVERY ACT OF 1976, AS AMENDED FROM TIME TO TIME, 40 U.S.C. 6901, ET SEQ., THE NM HEALTH AND SAF. CODE 361.001 ET SEQ., AND REGULATIONS RELATED THERETO, BY VIRTUE OF THE EXEMPTION AFFORDED DRILLING FLUIDS, PRODUCED WATERS, AND OTHER WASTE ASSOCIATED WITH THE EXPLORATION, DEVELOPMENT OR PRODUCTION OF CRUDE OIL OR NATURAL GAS OR GEOTHERMAL ENERGY.

ALSO AS A CONDITION TO SUNDANCE SERVICES, INC.'S ACCEPTANCE OF THE MATERIALS SHIPPED WITH THIS JOB TICKET, TRANSPORTER REPRESENTS AND WARRANTS THAT ONLY THE MATERIAL DELIVERED BY OPERATOR/SHIPPER TO TRANSPORTER IS NOW DELIVERED BY TRANSPORTER TO SUNDANCE SERVICES, INC.'S FACILITY FOR DISPOSAL.

THIS WILL CERTIFY that the above Transporter loaded the material represented by this Transporter Statement at the above described location, and that it was tendered by the above described shipper. This will certify that no additional materials were added to this load, and that the material was delivered without incident.

DRIVER: [Signature]

FACILITY REPRESENTATIVE: [Signature]

Sundance Services, Inc.

P.O. Box 1737 ★ Eunice, New Mexico 88231

(575) 394-2511

Transporter
Manifest
257

Ticket # 84900

Lease Operator/Shipper/Company:

Lease Name:

Transporter Company:

Time

AM/PM

Date:

Vehicle No.

Driver No.

Charge To:

TYPE OF MATERIAL

☐ Produced Water

☐ Drilling Fluids

☐ Completion Fluids

☐ Tank Bottoms

☒ Contaminated Soil

☐ C-117 No.:

☐ Other Materials

☐ BS&W Content:

☐ JETOUT

☐ CALLOUT

Description:

VOLUME OF MATERIAL

BBLS.

YARDS

AS A CONDITION TO SUNDANCE SERVICES, INC.'S ACCEPTANCE OF THE MATERIALS SHIPPED WITH THIS JOB TICKET, OPERATOR/SHIPPER REPRESENTS AND WARRANTS THAT THE WASTE MATERIAL SHIPPED HERewith IS MATERIAL EXEMPT FROM THE RESOURCE, CONSERVATION AND RECOVERY ACT OF 1976, AS AMENDED FROM TIME TO TIME, 40 U.S.C. 6901, ET SEQ., THE NM HEALTH AND SAF. CODE 361.001 ET SEQ., AND REGULATIONS RELATED THERETO, BY VIRTUE OF THE EXEMPTION AFFORDED DRILLING FLUIDS, PRODUCED WATERS, AND OTHER WASTE ASSOCIATED WITH THE EXPLORATION, DEVELOPMENT OR PRODUCTION OF CRUDE OIL OR NATURAL GAS OR GEOTHERMAL ENERGY.

ALSO AS A CONDITION TO SUNDANCE SERVICES, INC.'S ACCEPTANCE OF THE MATERIALS SHIPPED WITH THIS JOB TICKET, TRANSPORTER REPRESENTS AND WARRANTS THAT ONLY THE MATERIAL DELIVERED BY OPERATOR/SHIPPER TO TRANSPORTER IS NOW DELIVERED BY TRANSPORTER TO SUNDANCE SERVICES, INC.'S FACILITY FOR DISPOSAL.

THIS WILL CERTIFY that the above Transporter loaded the material represented by this Transporter Statement at the above described location, and that it was tendered by the above described shipper. This will certify that no additional materials were added to this load, and that the material was delivered without incident.

DRIVER:

FACILITY REPRESENTATIVE:

48

TRANSPORTER'S MANIFEST

MANIFEST#

93236

SHIPPING FACILITY NAME & ADDRESS:

Respec
5971 Jefferson St NE Suite 101
Albuquerque NM 87109-3413

LOCATION OF MATERIAL:

Ruth Property
NW Corner of 15th and Ave R

TRANSPORTER NAME & ADDRESS:

Phoenix Environmental

DESCRIPTION OF WASTE:

NON-HAZARDOUS CONTAMINATED SOIL

QUANTITY:

20 cy

FACILITY CONTACT:

Angus Robb 505-379-2072

DATE:

09/5/08

SIGNATURE OF CONTACT:

ARobb

NAME OF TRANSPORTER: (DRIVER)

DATE:

9-5-08

SIGNATURE OF DRIVER:

Johl

DISPOSAL SITE:

SUNDANCE SERVICES INC.
P.O. BOX 1737
EUNICE NM 88231

DATE:

9-5-08

SIGNATURE:

Alvesta

TRANSPORTER'S MANIFEST

MANIFEST#

49
93238

SHIPPING FACILITY NAME & ADDRESS:

Respec
5971 Jefferson St NE Suite 101
Albuquerque NM 87109-3413

LOCATION OF MATERIAL:

Ruth Property
NW Corner of 15th and Ave R

TRANSPORTER NAME & ADDRESS:

Phoenix Environmental

DESCRIPTION OF WASTE:

NON-HAZARDOUS CONTAMINATED SOIL

QUANTITY:

20 cy

FACILITY CONTACT:

Angus Robb 505-379-2072

DATE:

09/05/08

SIGNATURE OF CONTACT:

[Signature]

NAME OF TRANSPORTER: (DRIVER)

DATE:

09/05/08

SIGNATURE OF DRIVER:

[Signature]

DISPOSAL SITE:

SUNDANCE SERVICES INC.
P.O. BOX 1737
EUNICE NM 88231

DATE:

9-5-08

SIGNATURE:

[Signature]

TRANSPORTER'S MANIFEST

MANIFEST#

03333

SHIPPING FACILITY NAME & ADDRESS:

Respec
5971 Jefferson St NE Suite 101
Albuquerque NM 87109-3413

LOCATION OF MATERIAL:

Ruth Property
NW Corner of 15th and Ave R

TRANSPORTER NAME & ADDRESS:

Phoenix Environmental

DESCRIPTION OF WASTE:

NON-HAZARDOUS CONTAMINATED SOIL

QUANTITY:

20 cy

FACILITY CONTACT:

Angus Robb 505-379-2072

DATE:

09/04/08

SIGNATURE OF CONTACT:

Angus Robb

NAME OF TRANSPORTER: (DRIVER)

DATE:

09/04/08

SIGNATURE OF DRIVER:

B Greenleaf

DISPOSAL SITE:

SUNDANCE SERVICES INC.
P.O. BOX 1737
EUNICE NM 88231

DATE:

09/04/08

SIGNATURE :

Al Costa

Sundance Services, Inc.

P.O. Box 1737 ★ Eunice, New Mexico 88231

(575) 394-2511

Transporter
Manifest
90

Ticket # 93349

Lease Operator/Shipper/Company: Respec

Lease Name: Beth Property

Transporter Company: Phoenix

Time 3:16

AM/PM (P)

Date: 7-5-08

Vehicle No. 208

Driver No. 208

Charge To: Respec

TYPE OF MATERIAL

☐ Produced Water

☐ Drilling Fluids

☐ Completion Fluids

☐ Tank Bottoms

☒ Contaminated Soil

☐ C-117 No.:

☐ Other Materials

☐ BS&W Content:

Description: OIL

☐ JETOUT

☐ CALLOUT

VOLUME OF MATERIAL

BBLs.

YARDS

AS A CONDITION TO SUNDANCE SERVICES, INC.'S ACCEPTANCE OF THE MATERIALS SHIPPED WITH THIS JOB TICKET, OPERATOR/SHIPPER REPRESENTS AND WARRANTS THAT THE WASTE MATERIAL SHIPPED HERewith IS MATERIAL EXEMPT FROM THE RESOURCE, CONSERVATION AND RECOVERY ACT OF 1976, AS AMENDED FROM TIME TO TIME, 40 U.S.C. 6901, ET SEQ., THE NM HEALTH AND SAF. CODE 361.001 ET SEQ., AND REGULATIONS RELATED THERETO, BY VIRTUE OF THE EXEMPTION AFFORDED DRILLING FLUIDS, PRODUCED WATERS, AND OTHER WASTE ASSOCIATED WITH THE EXPLORATION, DEVELOPMENT OR PRODUCTION OF CRUDE OIL OR NATURAL GAS OR GEOTHERMAL ENERGY.

ALSO AS A CONDITION TO SUNDANCE SERVICES, INC.'S ACCEPTANCE OF THE MATERIALS SHIPPED WITH THIS JOB TICKET, TRANSPORTER REPRESENTS AND WARRANTS THAT ONLY THE MATERIAL DELIVERED BY OPERATOR/SHIPPER TO TRANSPORTER IS NOW DELIVERED BY TRANSPORTER TO SUNDANCE SERVICES, INC.'S FACILITY FOR DISPOSAL.

THIS WILL CERTIFY that the above Transporter loaded the material represented by this Transporter Statement at the above described location, and that it was tendered by the above described shipper. This will certify that no additional materials were added to this load, and that the material was delivered without incident.

DRIVER: B. Branner

FACILITY REPRESENTATIVE: Alcorta

Sundance Services, Inc.

P.O. Box 1737 ★ Eunice, New Mexico 88231

(575) 394-2511

Transporter
Manifest
92

Ticket # 93357

Lease Operator/Shipper/Company: Respec

Lease Name: Buffy Property

Transporter Company: Phoenix

Time 3:43

AM/PM

Date: 9-5-08

Vehicle No. 209

Driver No. 209

Charge To: Respec

TYPE OF MATERIAL

- | | | |
|--|---|--|
| <input type="checkbox"/> Produced Water | <input type="checkbox"/> Drilling Fluids | <input type="checkbox"/> Completion Fluids |
| <input type="checkbox"/> Tank Bottoms | <input checked="" type="checkbox"/> Contaminated Soil | <input type="checkbox"/> C-117 No.: |
| <input type="checkbox"/> Other Materials | <input type="checkbox"/> BS&W Content: | |

Description: OIL

- ☐ JETOUT
☐ CALLOUT

VOLUME OF MATERIAL

BBLS. 20 YARDS

AS A CONDITION TO SUNDANCE SERVICES, INC.'S ACCEPTANCE OF THE MATERIALS SHIPPED WITH THIS JOB TICKET, OPERATOR/SHIPPER REPRESENTS AND WARRANTS THAT THE WASTE MATERIAL SHIPPED HERewith IS MATERIAL EXEMPT FROM THE RESOURCE, CONSERVATION AND RECOVERY ACT OF 1976, AS AMENDED FROM TIME TO TIME, 40 U.S.C. 6901, ET SEQ., THE NM HEALTH AND SAF. CODE 361.001 ET SEQ., AND REGULATIONS RELATED THERETO, BY VIRTUE OF THE EXEMPTION AFFORDED DRILLING FLUIDS, PRODUCED WATERS, AND OTHER WASTE ASSOCIATED WITH THE EXPLORATION, DEVELOPMENT OR PRODUCTION OF CRUDE OIL OR NATURAL GAS OR GEOTHERMAL ENERGY.

ALSO AS A CONDITION TO SUNDANCE SERVICES, INC.'S ACCEPTANCE OF THE MATERIALS SHIPPED WITH THIS JOB TICKET, TRANSPORTER REPRESENTS AND WARRANTS THAT ONLY THE MATERIAL DELIVERED BY OPERATOR/SHIPPER TO TRANSPORTER IS NOW DELIVERED BY TRANSPORTER TO SUNDANCE SERVICES, INC.'S FACILITY FOR DISPOSAL.

THIS WILL CERTIFY that the above Transporter loaded the material represented by this Transporter Statement at the above described location, and that it was tendered by the above described shipper. This will certify that no additional materials were added to this load, and that the material was delivered without incident.

DRIVER: [Signature]

FACILITY REPRESENTATIVE: [Signature]

351

TRANSPORTER'S MANIFEST

MANIFEST#

85278

SHIPPING FACILITY NAME & ADDRESS:

Respec
5971 Jefferson St NE Suite 101
Albuquerque NM 87109-3413

LOCATION OF MATERIAL:

Ruth Property
NW Corner of 15th and Ave R

TRANSPORTER NAME & ADDRESS:

Phoenix Environmental

DESCRIPTION OF WASTE:

NON-HAZARDOUS CONTAMINATED SOIL

QUANTITY:

20

FACILITY CONTACT:

Angus Robb 505-379-2072

DATE:

6-17-08

SIGNATURE OF CONTACT:



NAME OF TRANSPORTER: (DRIVER)

207

DATE:

6-17-08

SIGNATURE OF DRIVER:



DISPOSAL SITE:

SUNDANCE SERVICES INC.
P.O. BOX 1737
EUNICE NM 88231

DATE:

6-17-08

SIGNATURE:

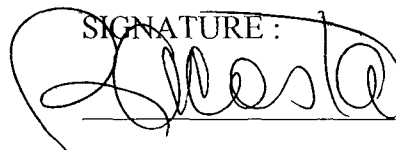

TRANSPORTER'S MANIFEST

MANIFEST#

332
85279

SHIPPING FACILITY NAME & ADDRESS:

Respec
5971 Jefferson St NE Suite 101
Albuquerque NM 87109-3413

LOCATION OF MATERIAL:

Ruth Property
NW Corner of 15th and Ave R

TRANSPORTER NAME & ADDRESS:

Phoenix Environmental

DESCRIPTION OF WASTE:

NON-HAZARDOUS CONTAMINATED SOIL

QUANTITY:

20

FACILITY CONTACT:

Angus Robb 505-379-2072

DATE:

6-17-08

SIGNATURE OF CONTACT:

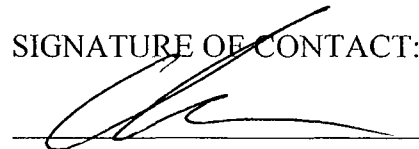

NAME OF TRANSPORTER: (DRIVER)

DATE:

6-17-08

SIGNATURE OF DRIVER:

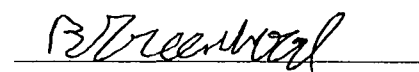

DISPOSAL SITE:

SUNDANCE SERVICES INC.
P.O. BOX 1737
EUNICE NM 88231

DATE:

6-17-08

SIGNATURE:

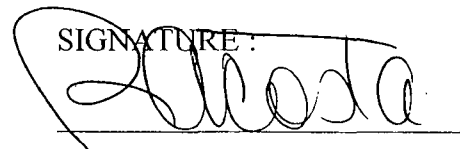

TRANSPORTER'S MANIFEST

MANIFEST#

85280

SHIPPING FACILITY NAME & ADDRESS:

Respec
5971 Jefferson St NE Suite 101
Albuquerque NM 87109-3413

LOCATION OF MATERIAL:

Ruth Property
NW Corner of 15th and Ave R

TRANSPORTER NAME & ADDRESS:

Phoenix Environmental

DESCRIPTION OF WASTE:

NON-HAZARDOUS CONTAMINATED SOIL

QUANTITY:

20

FACILITY CONTACT:

Angus Robb 505-379-2072

DATE:

6-17-08

SIGNATURE OF CONTACT:



NAME OF TRANSPORTER: (DRIVER)

DATE:

209 6-17-08

SIGNATURE OF DRIVER:

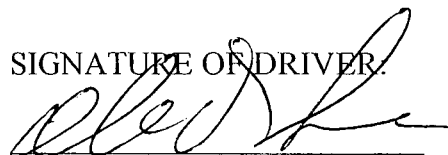

DISPOSAL SITE:

SUNDANCE SERVICES INC.
P.O. BOX 1737
EUNICE NM 88231

DATE:

6-17-08

SIGNATURE:

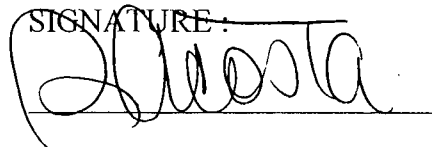

TRANSPORTER'S MANIFEST

MANIFEST#

355
85293

SHIPPING FACILITY NAME & ADDRESS:

Respec
5971 Jefferson St NE Suite 101
Albuquerque NM 87109-3413

LOCATION OF MATERIAL:

Ruth Property
NW Corner of 15th and Ave R

TRANSPORTER NAME & ADDRESS:

Phoenix Environmental

DESCRIPTION OF WASTE:

NON-HAZARDOUS CONTAMINATED SOIL

QUANTITY:

20

FACILITY CONTACT:

Angus Robb 505-379-2072

DATE:

6-17-08

SIGNATURE OF CONTACT:

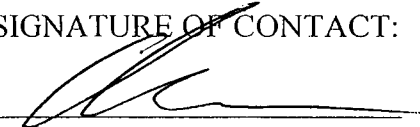

NAME OF TRANSPORTER: (DRIVER)

DATE:

6-17-08

SIGNATURE OF DRIVER:

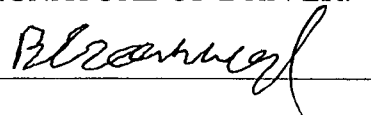

DISPOSAL SITE:

SUNDANCE SERVICES INC.
P.O. BOX 1737
EUNICE NM 88231

DATE:

6-17-08

SIGNATURE:

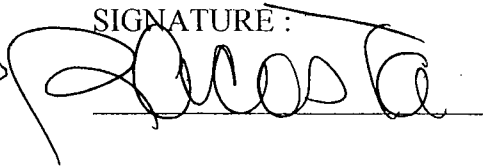

TRANSPORTER'S MANIFEST

MANIFEST#

35'1
85300

SHIPPING FACILITY NAME & ADDRESS:

Respec
5971 Jefferson St NE Suite 101
Albuquerque NM 87109-3413

LOCATION OF MATERIAL:

Ruth Property
NW Corner of 15th and Ave R

TRANSPORTER NAME & ADDRESS:

Phoenix Environmental

DESCRIPTION OF WASTE:

NON-HAZARDOUS CONTAMINATED SOIL

QUANTITY:

20

FACILITY CONTACT:

Angus Robb 505-379-2072

DATE:

6-17-08

SIGNATURE OF CONTACT:



NAME OF TRANSPORTER: (DRIVER)

DATE:

6-17-08

SIGNATURE OF DRIVER:

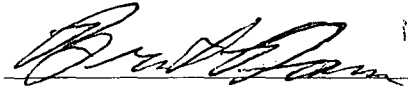

DISPOSAL SITE:

SUNDANCE SERVICES INC.
P.O. BOX 1737
EUNICE NM 88231

DATE:

6-17-08

SIGNATURE:

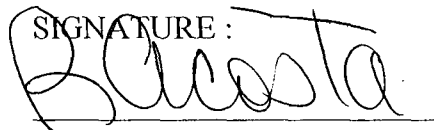

TRANSPORTER'S MANIFEST

MANIFEST#

85303

SHIPPING FACILITY NAME & ADDRESS:

Respec
5971 Jefferson St NE Suite 101
Albuquerque NM 87109-3413

LOCATION OF MATERIAL:

Ruth Property
NW Corner of 15th and Ave R

TRANSPORTER NAME & ADDRESS:

Phoenix Environmental

DESCRIPTION OF WASTE:

NON-HAZARDOUS CONTAMINATED SOIL

QUANTITY:

20

FACILITY CONTACT:

Angus Robb 505-379-2072

DATE:

6-17-08

SIGNATURE OF CONTACT:

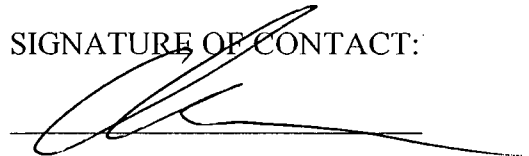

NAME OF TRANSPORTER: (DRIVER)

207

DATE:

6-17-08

SIGNATURE OF DRIVER:



DISPOSAL SITE:

SUNDANCE SERVICES INC.
P.O. BOX 1737
EUNICE NM 88231

DATE:

6-17-08

SIGNATURE :



TRANSPORTER'S MANIFEST

MANIFEST#

339
85307

SHIPPING FACILITY NAME & ADDRESS:

Respec
5971 Jefferson St NE Suite 101
Albuquerque NM 87109-3413

LOCATION OF MATERIAL:

Ruth Property
NW Corner of 15th and Ave R

TRANSPORTER NAME & ADDRESS:

Phoenix Environmental

DESCRIPTION OF WASTE:

NON-HAZARDOUS CONTAMINATED SOIL

QUANTITY:

20

FACILITY CONTACT:

Angus Robb 505-379-2072

DATE:

6-17-08

SIGNATURE OF CONTACT:



NAME OF TRANSPORTER: (DRIVER)

DATE:

208

6-17-08

SIGNATURE OF DRIVER:

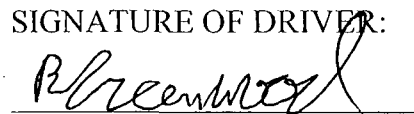

DISPOSAL SITE:

SUNDANCE SERVICES INC.
P.O. BOX 1737
EUNICE NM 88231

DATE:

6-17-08

SIGNATURE:

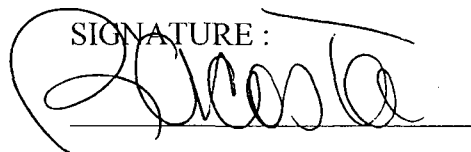

467

TRANSPORTER'S MANIFEST

MANIFEST# 85687

SHIPPING FACILITY NAME & ADDRESS:

Respec
5971 Jefferson St NE Suite 101
Albuquerque NM 87109-3413

LOCATION OF MATERIAL:

Ruth Property
NW Corner of 15th and Ave R

TRANSPORTER NAME & ADDRESS:

Phoenix Environmental

DESCRIPTION OF WASTE:

NON-HAZARDOUS CONTAMINATED SOIL

QUANTITY:

20 yds

FACILITY CONTACT:

Angus Robb 505-379-2072

DATE:

6-20-08

SIGNATURE OF CONTACT:

NAME OF TRANSPORTER: (DRIVER)

DATE:

6-20-08

SIGNATURE OF DRIVER:

B. Brennan

DISPOSAL SITE:

SUNDANCE SERVICES INC.
P.O. BOX 1737
EUNICE NM 88231

DATE:

6-20-08

SIGNATURE :

[Signature]

Sundance Services, Inc.

P.O. Box 1737 ★ Eunice, New Mexico 88231

(575) 394-2511

Transporter Manifest
486

Ticket # 85836

Lease Operator/Shipper/Company: Rodriguez

Lease Name: Plata Buena

Transporter Company: Phoenix

Time 9:35 AM/PM

Date: 6-23-08

Vehicle No. 207

Driver No. 207

Charge To: Rodriguez

TYPE OF MATERIAL

- | | | |
|--|---|--|
| <input type="checkbox"/> Produced Water | <input type="checkbox"/> Drilling Fluids | <input type="checkbox"/> Completion Fluids |
| <input type="checkbox"/> Tank Bottoms | <input checked="" type="checkbox"/> Contaminated Soil | <input type="checkbox"/> C-117 No.: |
| <input type="checkbox"/> Other Materials | <input type="checkbox"/> BS&W Content: | |

Description: OIL

- ☐ JETOUT
☐ CALLOUT

VOLUME OF MATERIAL

BBLs.

YARDS

AS A CONDITION TO SUNDANCE SERVICES, INC.'S ACCEPTANCE OF THE MATERIALS SHIPPED WITH THIS JOB TICKET, OPERATOR/SHIPPER REPRESENTS AND WARRANTS THAT THE WASTE MATERIAL SHIPPED HERewith IS MATERIAL EXEMPT FROM THE RESOURCE, CONSERVATION AND RECOVERY ACT OF 1976, AS AMENDED FROM TIME TO TIME, 40 U.S.C. 6901, ET SEQ., THE NM HEALTH AND SAF. CODE 361.001 ET SEQ., AND REGULATIONS RELATED THERETO, BY VIRTUE OF THE EXEMPTION AFFORDED DRILLING FLUIDS, PRODUCED WATERS, AND OTHER WASTE ASSOCIATED WITH THE EXPLORATION, DEVELOPMENT OR PRODUCTION OF CRUDE OIL OR NATURAL GAS OR GEOTHERMAL ENERGY.

ALSO AS A CONDITION TO SUNDANCE SERVICES, INC.'S ACCEPTANCE OF THE MATERIALS SHIPPED WITH THIS JOB TICKET, TRANSPORTER REPRESENTS AND WARRANTS THAT ONLY THE MATERIAL DELIVERED BY OPERATOR/SHIPPER TO TRANSPORTER IS NOW DELIVERED BY TRANSPORTER TO SUNDANCE SERVICES, INC.'S FACILITY FOR DISPOSAL.

THIS WILL CERTIFY that the above Transporter loaded the material represented by this Transporter Statement at the above described location, and that it was tendered by the above described shipper. This will certify that no additional materials were added to this load, and that the material was delivered without incident.

DRIVER: [Signature]

FACILITY REPRESENTATIVE: [Signature]

Sundance Services, Inc.

P.O. Box 1737 ★ Eunice, New Mexico 88231

(575) 394-2511

Transporter Manifest
291

Ticket # 85003

Lease Operator/Shipper/Company: <u>Respec</u>		
Lease Name: <u>Beth Prop</u>		
Transporter Company: <u>Phoenix</u>	Time <u>4:21</u>	AM/PM <u>(M)</u>
Date: <u>6/13/08</u>	Vehicle No. # <u>219</u>	Driver No. <u>209</u>
Charge To: <u>Respec</u>		

TYPE OF MATERIAL

- | | | |
|--|---|--|
| <input type="checkbox"/> Produced Water | <input type="checkbox"/> Drilling Fluids | <input type="checkbox"/> Completion Fluids |
| <input type="checkbox"/> Tank Bottoms | <input checked="" type="checkbox"/> Contaminated Soil | <input type="checkbox"/> C-117 No.: |
| <input type="checkbox"/> Other Materials | <input type="checkbox"/> BS&W Content: | |

Description:

0/10

- ☐ JETOUT
☐ CALLOUT

VOLUME OF MATERIAL

BBLs. 20 YARDS

AS A CONDITION TO SUNDANCE SERVICES, INC.'S ACCEPTANCE OF THE MATERIALS SHIPPED WITH THIS JOB TICKET, OPERATOR/SHIPPER REPRESENTS AND WARRANTS THAT THE WASTE MATERIAL SHIPPED HERewith IS MATERIAL EXEMPT FROM THE RESOURCE, CONSERVATION AND RECOVERY ACT OF 1976, AS AMENDED FROM TIME TO TIME, 40 U.S.C. 6901, ET SEQ., THE NM HEALTH AND SAF. CODE 361.001 ET SEQ., AND REGULATIONS RELATED THERETO, BY VIRTUE OF THE EXEMPTION AFFORDED DRILLING FLUIDS, PRODUCED WATERS, AND OTHER WASTE ASSOCIATED WITH THE EXPLORATION, DEVELOPMENT OR PRODUCTION OF CRUDE OIL OR NATURAL GAS OR GEOTHERMAL ENERGY.

ALSO AS A CONDITION TO SUNDANCE SERVICES, INC.'S ACCEPTANCE OF THE MATERIALS SHIPPED WITH THIS JOB TICKET, TRANSPORTER REPRESENTS AND WARRANTS THAT ONLY THE MATERIAL DELIVERED BY OPERATOR/SHIPPER TO TRANSPORTER IS NOW DELIVERED BY TRANSPORTER TO SUNDANCE SERVICES, INC.'S FACILITY FOR DISPOSAL.

THIS WILL CERTIFY that the above Transporter loaded the material represented by this Transporter Statement at the above described location, and that it was tendered by the above described shipper. This will certify that no additional materials were added to this load, and that the material was delivered without incident.

DRIVER:

Beth Prop

FACILITY REPRESENTATIVE:

John F. Felt

252

TRANSPORTER'S MANIFEST

MANIFEST#

84889

SHIPPING FACILITY NAME & ADDRESS:

Respec
5971 Jefferson St NE Suite 101
Albuquerque NM 87109-3413

LOCATION OF MATERIAL:

Ruth Property
NW Corner of 15th and Ave R

TRANSPORTER NAME & ADDRESS:

Phoenix Environmental

DESCRIPTION OF WASTE:

NON-HAZARDOUS CONTAMINATED SOIL

QUANTITY:

20 cy

FACILITY CONTACT:

Angus Robb 505-379-2072

DATE:

6-13-08

SIGNATURE OF CONTACT:

AR

NAME OF TRANSPORTER: (DRIVER)

DATE:

6-13-08

SIGNATURE OF DRIVER:

C. E. Newish

DISPOSAL SITE:

SUNDANCE SERVICES INC.
P.O. BOX 1737
EUNICE NM 88231

DATE:

6-13-08

SIGNATURE:

[Signature]