

3R - 190

**ANNUAL
MONITORING
REPORT**

2/28/2009

**MWH**

BUILDING A BETTER WORLD

RECEIVED

2009 MAR 2 AM 9 51

February 28, 2009

Mr. Glenn von Gonten
New Mexico Oil Conservation Division (NMOCD)
1220 South St., Francis Drive
Santa Fe, New Mexico 87505

**RE: El Paso Tennessee Pipeline Company Pit Groundwater Remediation Sites
2008 Annual Reports**

Dear Mr. Von Gonten:

MWH Americas, Inc., on behalf of El Paso Tennessee Pipeline Company (EPTPC), is submitting the enclosed 2008 Annual Reports for each of EPTPC's 21 remaining San Juan River Basin pit groundwater remediation Sites. The reports present the 2008 sampling and product recovery data and include recommendations for 2009 activities at these Sites.

The 2008 Annual Reports are divided into three volumes based on location type. The volumes are as follows:

<u>Volume</u>	<u>Location Type</u>
1	Federal Land
2	Non-Federal Land (Excl. Navajo Nation)
3	Navajo Nation

If you have any questions concerning the enclosed reports, please call either Doug Stavinocha of EPTPC (713-420-5150) or me (303-291-2276).

Sincerely,

Jed Smith
Project Manager

encl.

cc: Bill Freeman – NNEPA, Shiprock, NM (Volume 3 Only)
Bill Liese – BLM, Farmington, NM (Volume 1 Only)
Brandon Powell – NMOCD, Aztec, NM (Volumes 1, 2, and 3)
Doug Stavinocha – EPTPC (Volumes 1, 2, and 3)

**2008 ANNUAL GROUNDWATER REPORT
FEDERAL SITES VOLUME I
EL PASO TENNESSEE PIPELINE COMPANY**

TABLE OF CONTENTS

METER or LINE ID	NMOCD CASE NO.	SITE NAME	TOWNSHIP	RANGE	SECTION	UNIT
87640	3RP-155-0	Canada Mesa #2	24N	06W	24	I
89961	3RP-170-0	Fields A#7A	32N	11W	34	E
73220	3RP-068-0	Fogelson 4-1 Com. #14	29N	11W	4	P
89894	3RP-186-0	Hammond #41A	27N	08W	25	O
97213	3RP-190-0	Hamner #9	29N	09W	20	A
94715	3RP-196-0	James F. Bell #1E	30N	13W	10	P
70194	3RP-201-0	Johnston Fed #4	31N	09W	33	H
89232	3RP-202-0	Johnston Fed #6A	31N	09W	35	F
LD072	3RP-204-0	K27 LD072	25N	06W	4	E
LD174	3RP-212-0	LAT L 40	28N	04W	13	H
LD151	3RP-213-0	Lat 0-21 Line Drip	30N	09W	12	O
94810	3RP-223-0	Miles Fed 1A	26N	07W	5	F
89620	3RP-235-0	Sandoval GC A #1A	30N	09W	35	C



**2008 ANNUAL GROUNDWATER REPORT
NON-FEDERAL SITES VOLUME II
EL PASO TENNESSEE PIPELINE COMPANY**

TABLE OF CONTENTS

METER or LINE ID	NMOCD CASE NO.	SITE NAME	TOWNSHIP	RANGE	SECTION	UNIT
03906	3RP-179-0	GCU Com A #142E	29N	12W	25	G
93388	3RP-192-0	Horton #1E	31N	09W	28	H
LD087	3RP-205-0	K-31 Line Drip	25N	06W	16	N
72556	3RP-207-0	Knight #1	30N	13W	5	A
94967	3RP-214-0	*Lindrith B #24	24N	03W	9	N
70445	3RP-074-0	Standard Oil Com #1	29N	09W	36	N
71669	3RP-239-0	State Gas Com N #1	31N	12W	16	H

* Lindrith B#24 Site was submitted for closure in 2006, and is pending approval from NMOCD.
There were no activities for this site in 2008.



MWH

**EPTPC GROUNDWATER SITES
2008 ANNUAL GROUNDWATER REPORT**

**Hamner #9
Meter Code: 97213**

SITE DETAILS

Legal Description:	Town:	29N	Range:	9W	Sec:	20	Unit:	A
NMOCD Haz Ranking:	30	Land Type:	Federal	Operator:	BP / Amoco Production Company			

PREVIOUS ACTIVITIES

Site Assessment:	5/94	Excavation:	5/94	Soil Boring:	8/95
Monitor Well:	8/95	Geoprobe:	8/96	Additional MWs:	9/99
Downgradient MWs:	9/99	Replace MW:	NA	Quarterly Initiated:	11/96
ORC Nutrient Injection:	11/02	Re-Excavation:	NA	PSH Removal Initiated:	NA
Annual Initiated:	8/00	Quarterly Resumed:	NA	PSH Removal in 2008?	No

SUMMARY OF 2008 ACTIVITIES

MW-1: Quarterly groundwater sampling was performed during 2008. The November quarterly event comprised the "closure" sampling event.

MW-2: This well was dry during 2008.

MW-3: This well is damaged, and monitoring was not performed in 2008.

MW-4: Quarterly groundwater sampling was completed in February 2008, followed by closure sampling in November 2008.

Site-Wide Activities: No other activities were performed at this Site during 2008.

SITE MAPS

Site maps (February, May, August, November) are attached in Figures 1, 2, 3, and 4.

SUMMARY TABLES AND GRAPHS

- Historic analytical and water level data are summarized in Table 1 and presented graphically on Figures 5 through 8.
- The 2008 laboratory reports are presented in Attachment 1 (included on CD).
- The 2008 field documentation is presented in Attachment 2 (included on CD).

**EPTPC GROUNDWATER SITES
2008 ANNUAL GROUNDWATER REPORT**

**Hamner #9
Meter Code: 97213**

GEOLOGIC LOGS AND WELL COMPLETION DIAGRAMS

No subsurface activities were performed at this Site during 2008.

DISPOSITION OF GENERATED WASTES

All purge water was taken to the El Paso Natural Gas Rio Vista Compressor Station.

ISOCONCENTRATION MAPS

No isoconcentration maps were prepared for this Site; however, the attached Site maps present both the groundwater level and analytical data collected during 2008.

RESULTS

- The groundwater flow direction at this Site is to the west, based on historic water level data, as well as those data collected during 2008. This conclusion is supported by the fact that low level BTEX detections have been observed in MW-4 (located west of the former pit), while MW-2 (southwest of pit) and MW-3 (south of pit) have never had BTEX detections.
- Analytical results from samples collected at MW-1 indicate that benzene concentrations remained below the NMWQCC standard throughout 2008.
- Ethylbenzene, toluene, and total xylenes concentrations at MW-1 were also below NMWQCC standards in 2008.
- MW-2 was dry during all four monitoring events in 2008.
- The groundwater samples collected from MW-4 in 2008 were clean (i.e., no detection for BTEX compounds).

RECOMMENDATIONS

- EPTPC submitted this Site to the NMOCD for closure in January 2009. Per EPTPC's approved remediation plan, sampling has been discontinued pending a response from the NMOCD.
- Pending approval of EPTPC's closure request, the wells will be properly plugged and abandoned.

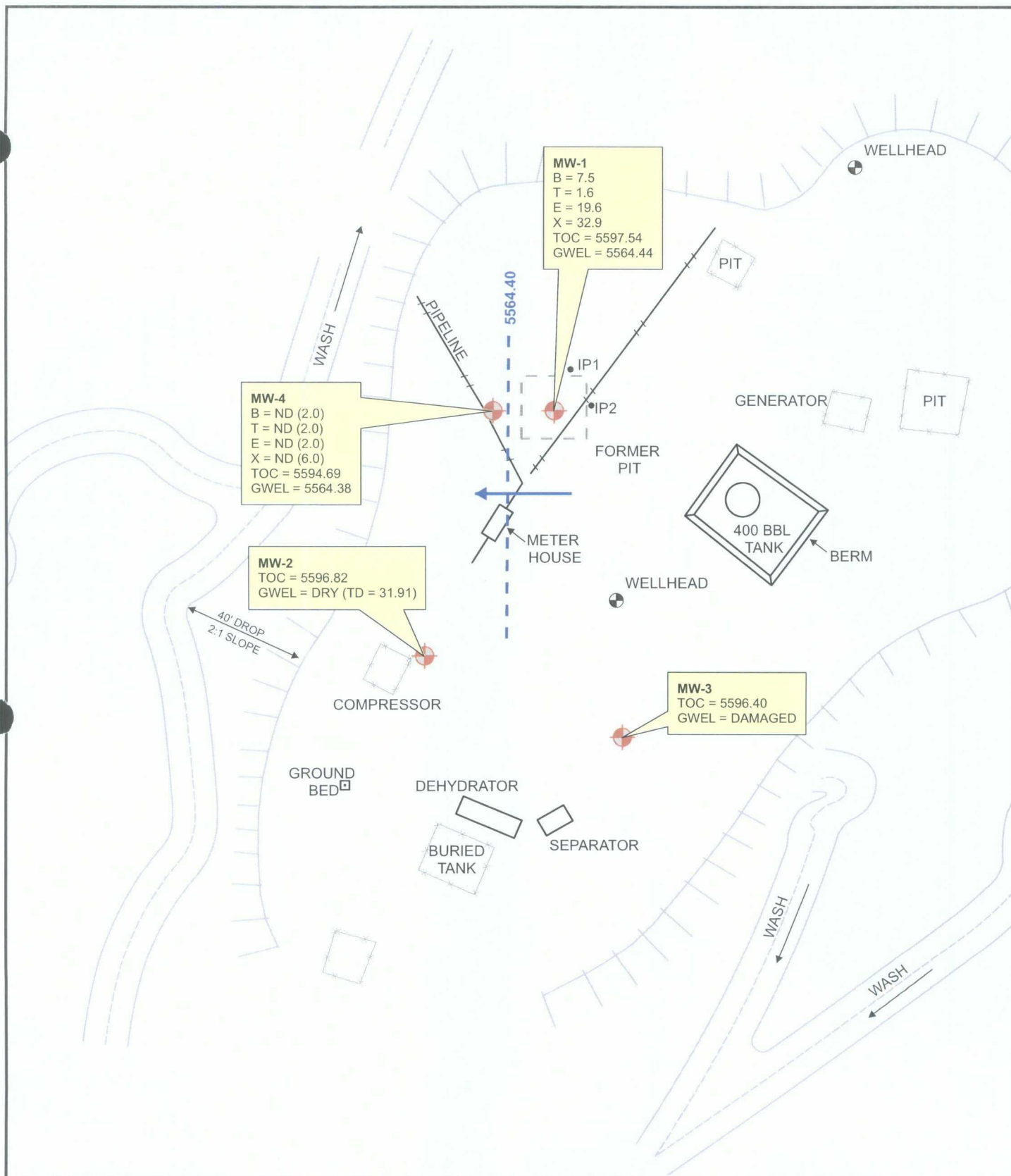

LEGEND

MW-4 Existing Monitoring / Observation Well

Groundwater Flow Direction

-1275- Potentiometric Surface Contour (Inferred Where Dashed)

ND Not Detected; Reporting Limit Shown In Parenthesis

B Benzene (ug/L)

T Toluene (ug/L)

E Ethylbenzene (ug/L)

X Total Xylenes (ug/L)

TOC Top of Casing (ft. AMSL)

GWEL Groundwater Elevation (ft. AMSL)

0 30 60 Feet



MWH



PROJECT:

HAMNER #9

TITLE:

Groundwater Potentiometric Surface Map,
and BTEX Concentrations - February 12, 2008

FIGURE:

1

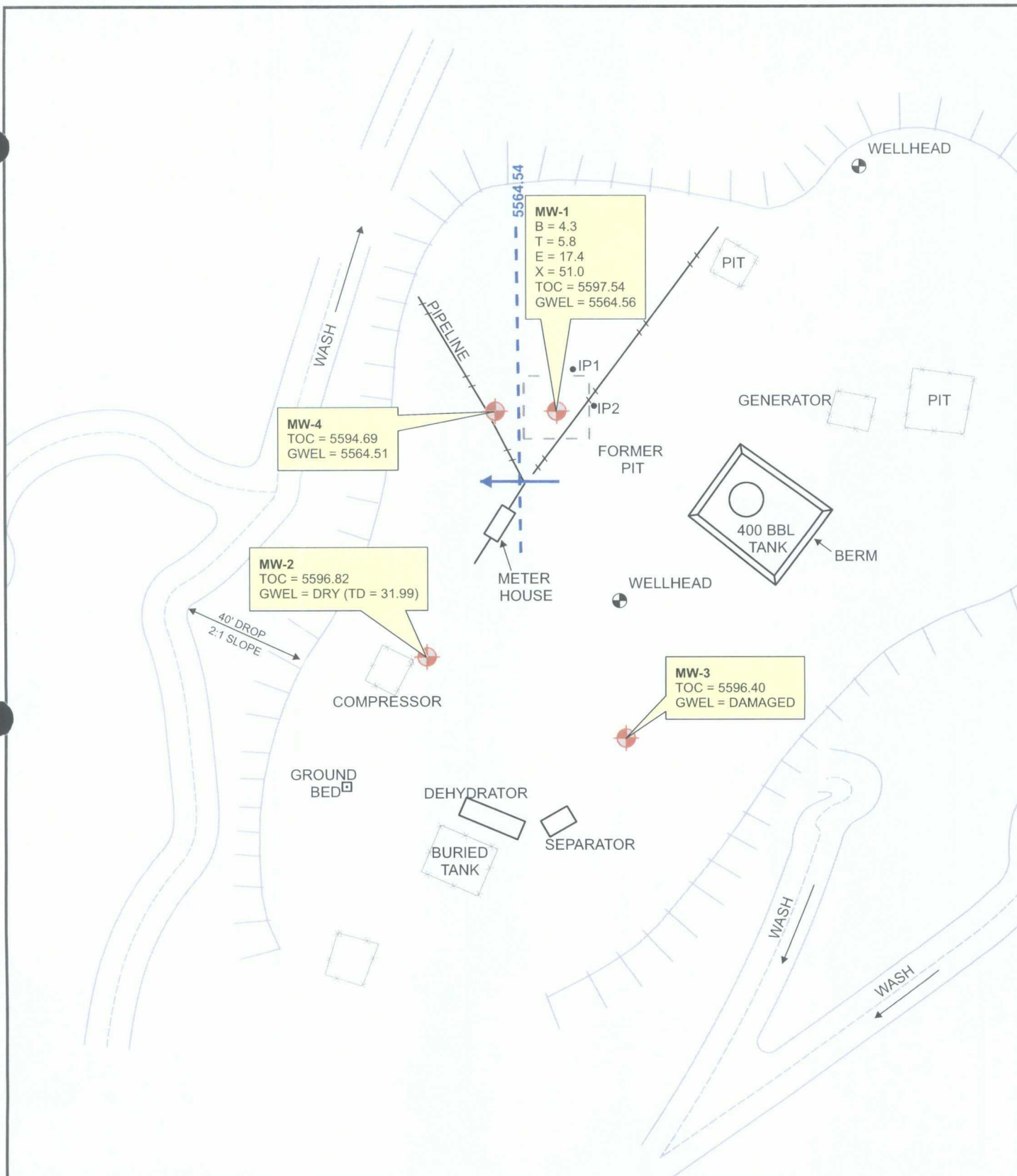

LEGEND

MW-4 Existing Monitoring / Observation Well

Groundwater Flow Direction

-1275- Potentiometric Surface Contour (Inferred Where Dashed)

ND Not Detected; Reporting Limit Shown In Parenthesis

B Benzene (ug/L)

T Toluene (ug/L)

E Ethylbenzene (ug/L)

X Total Xylenes (ug/L)

TOC Top of Casing (ft. AMSL)

GWEL Groundwater Elevation (ft. AMSL)

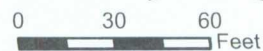

MWH



PROJECT:

HAMNER #9

TITLE:

Groundwater Potentiometric Surface Map,
and BTEX Concentrations - May 7, 2008

FIGURE:

2

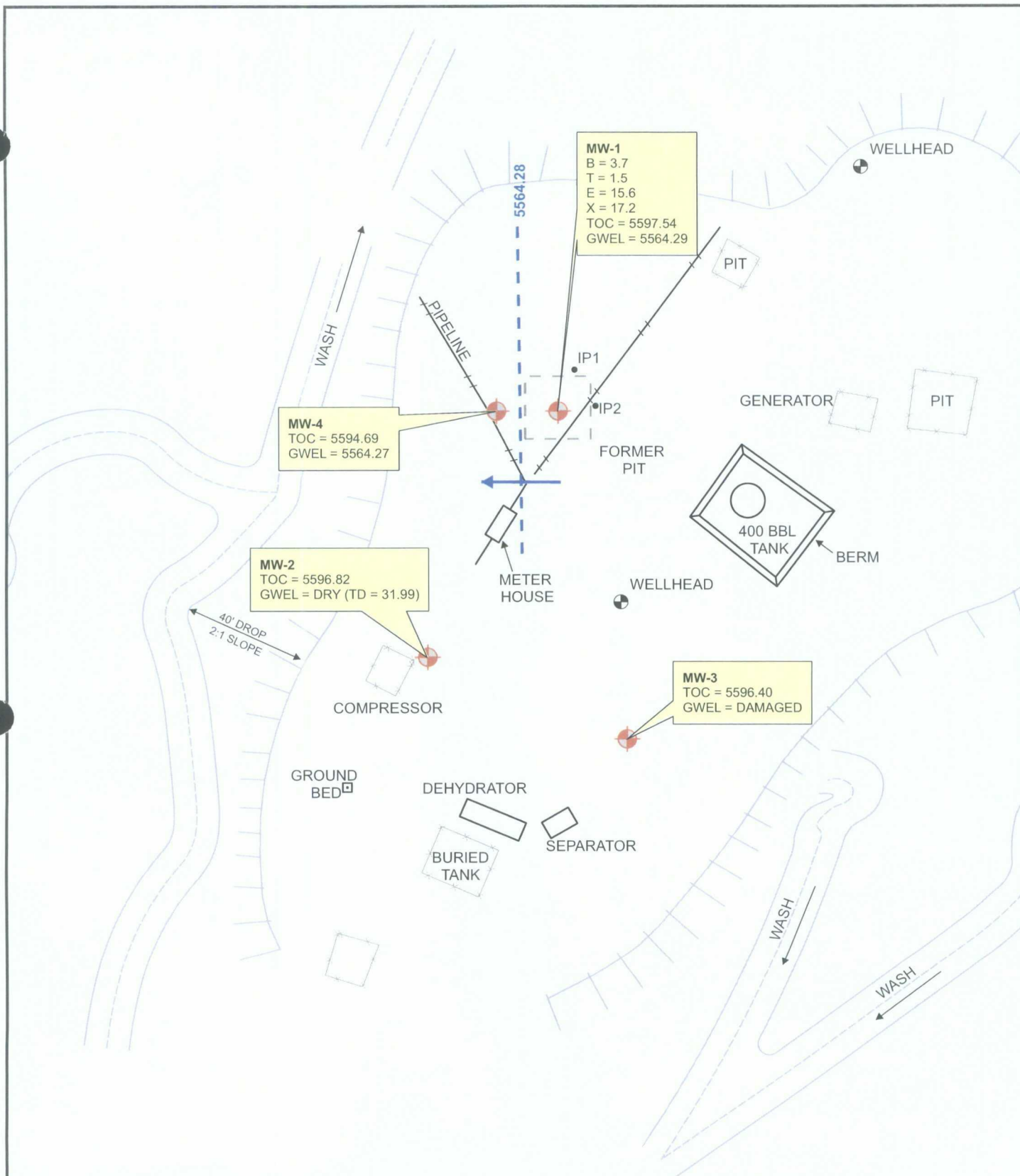

LEGEND

MW-4 Existing Monitoring / Observation Well

Groundwater Flow Direction

-1275- Potentiometric Surface Contour (Inferred Where Dashed)

ND Not Detected; Reporting Limit Shown In Parenthesis

B Benzene (ug/L)

T Toluene (ug/L)

E Ethylbenzene (ug/L)

X Total Xylenes (ug/L)

TOC Top of Casing (ft. AMSL)

GWEL Groundwater Elevation (ft. AMSL)

0 30 60 Feet



MWH



PROJECT:

HAMNER #9

TITLE:

Groundwater Potentiometric Surface Map,
and BTEX Concentrations - August 7, 2008

FIGURE:

3

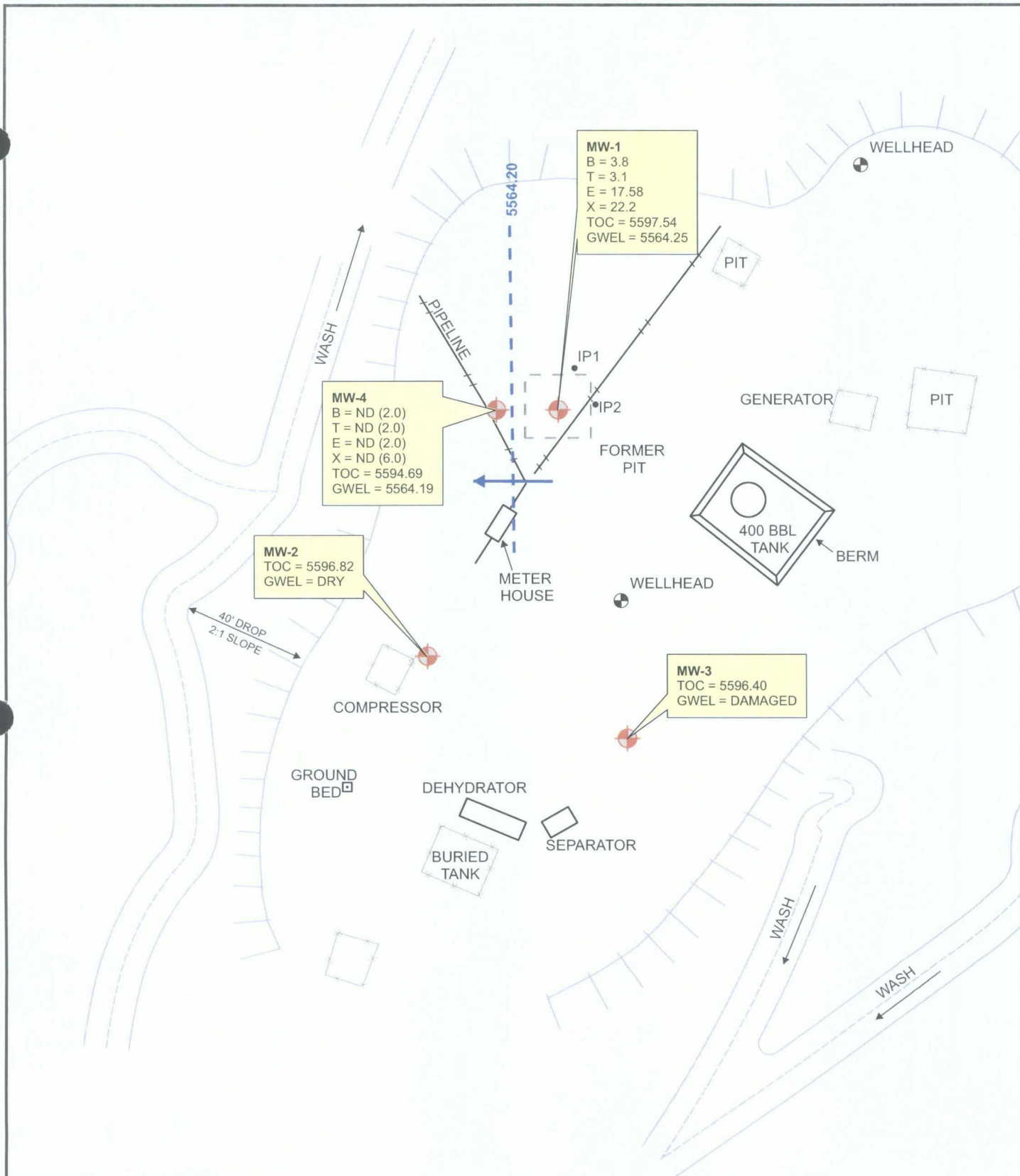

LEGEND

MW-4 Existing Monitoring / Observation Well

Groundwater Flow Direction

1275 Potentiometric Surface Contour (Inferred Where Dashed)

ND Not Detected; Reporting Limit Shown In Parenthesis

B Benzene (ug/L)

T Toluene (ug/L)

E Ethylbenzene (ug/L)

X Total Xylenes (ug/L)

TOC Top of Casing (ft. AMSL)

GWEL Groundwater Elevation (ft. AMSL)

0 30 60 Feet



MWH



PROJECT:

HAMNER #9

TITLE:

Groundwater Potentiometric Surface Map,
and BTEX Concentrations - August 7, 2008

FIGURE:

4

FIGURE 5
SUMMARY OF BTEX COMPOUNDS IN GROUNDWATER SAMPLES
HAMNER #9 (METER #97213)
MW01

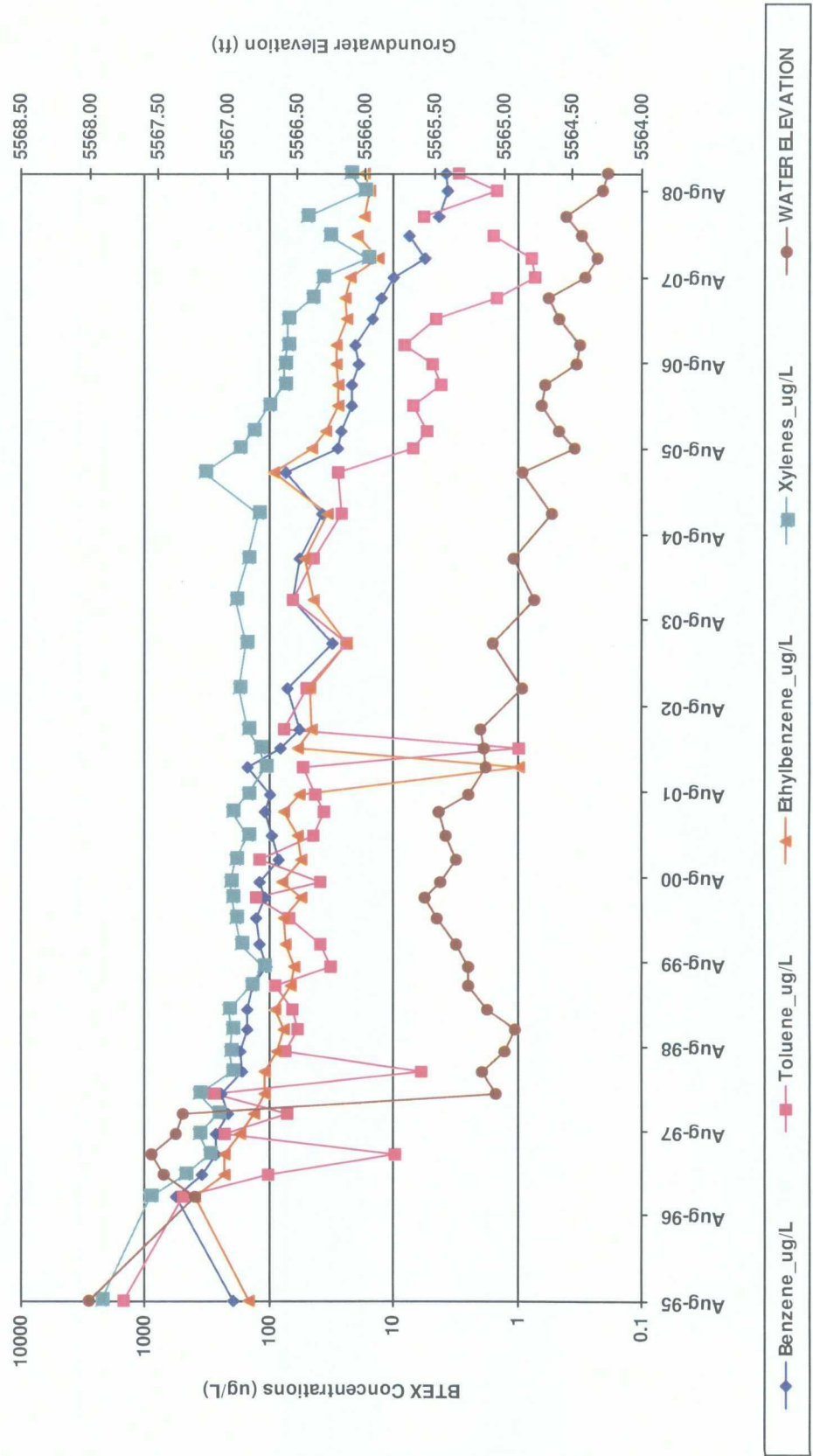

FIGURE 6
SUMMARY OF BTEX COMPOUNDS IN GROUNDWATER SAMPLES
HAMNER #9 (METER #97213)
MW02

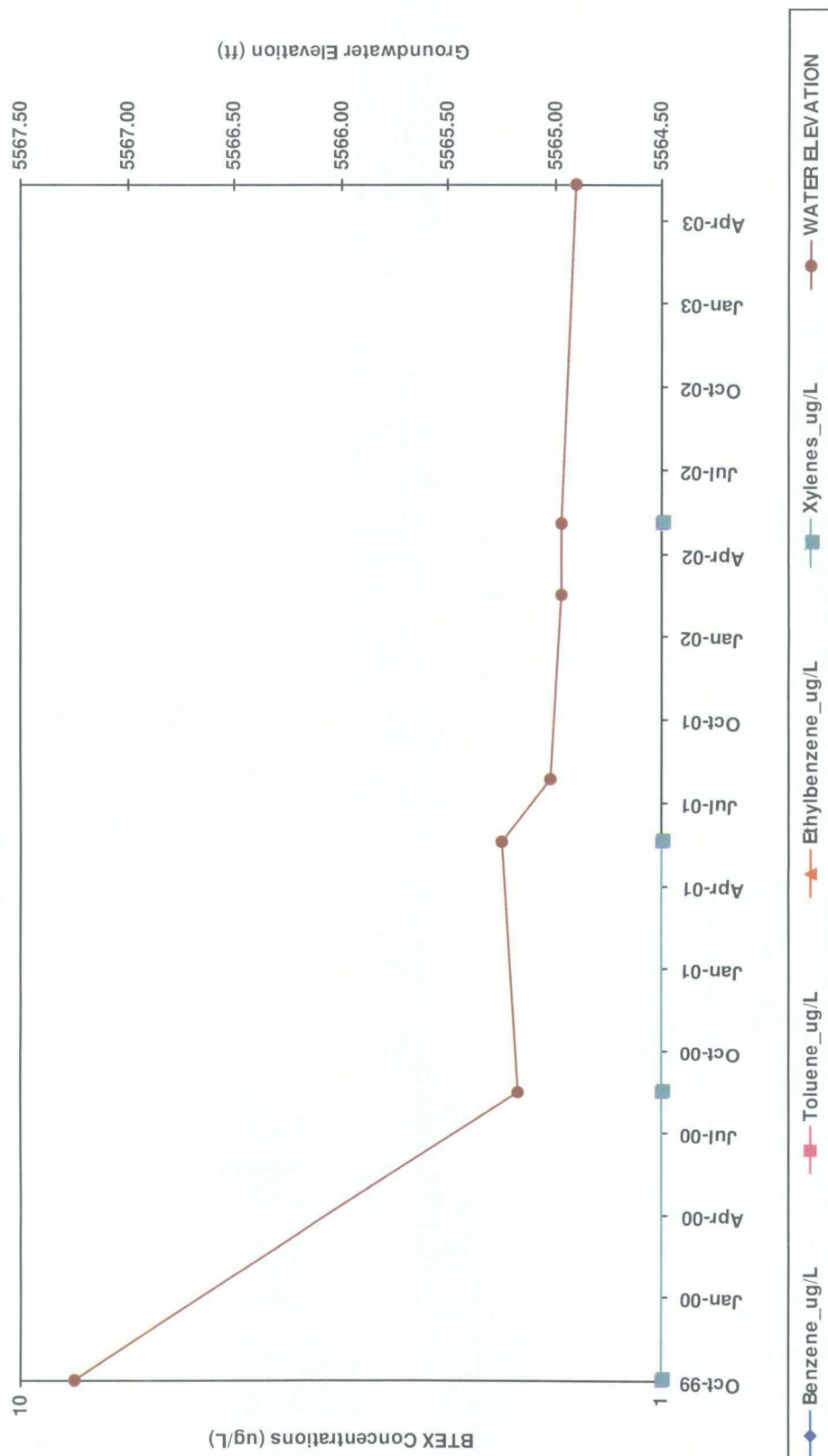

FIGURE 7
SUMMARY OF BTEX COMPOUNDS IN GROUNDWATER SAMPLES
HAMNER #9 (METER #97213)
MW03

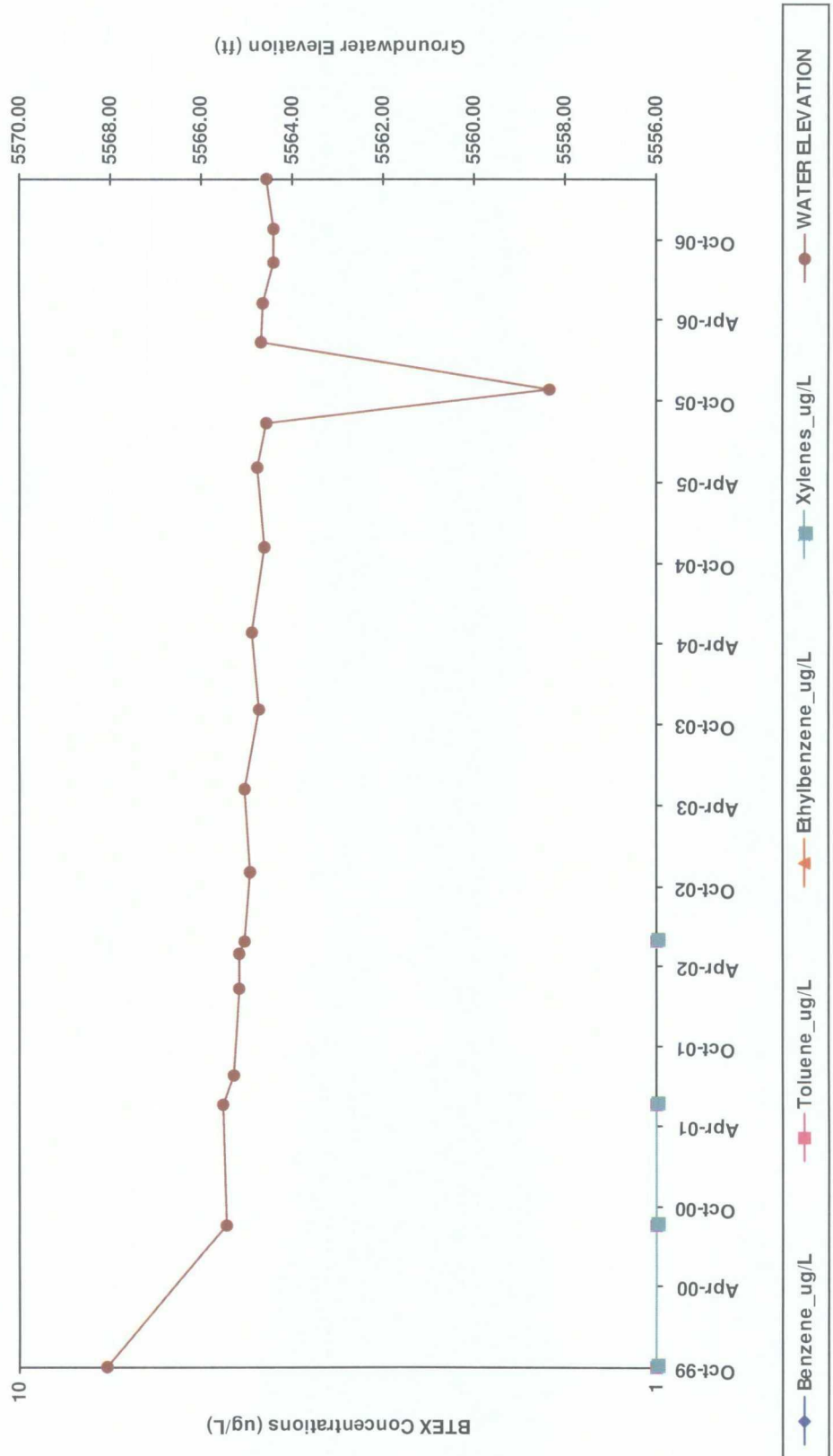

FIGURE 8
SUMMARY OF BTEX COMPOUNDS IN GROUNDWATER SAMPLES
HAMNER #9 (METER #97213)
MW04

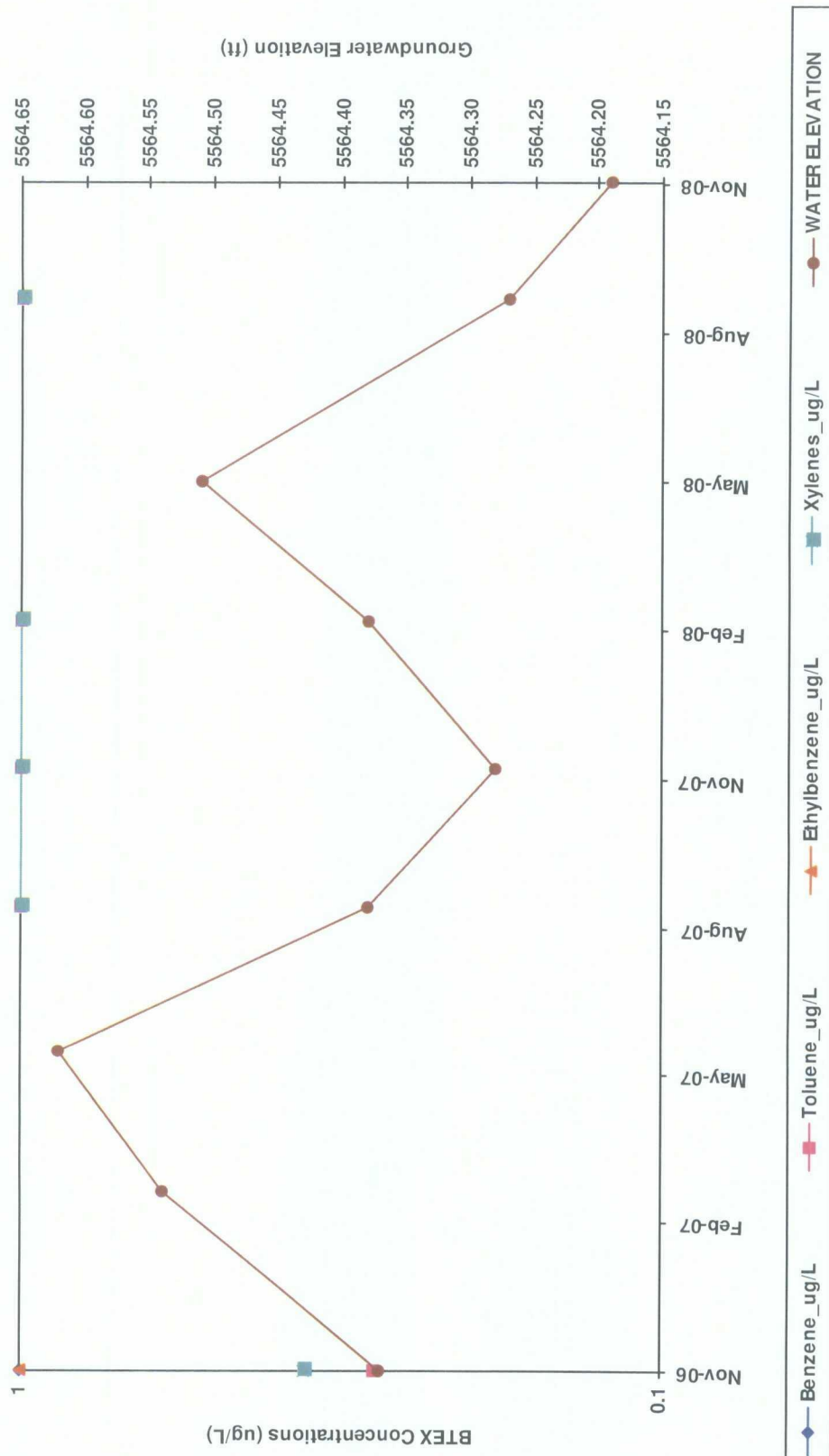

TABLE 1

**SUMMARY OF BTEX COMPOUNDS IN GROUNDWATER SAMPLES
HAMNER #9 (METER #97213)**

Monitoring Well	Sample Date	Benzene (ug/L)	Toluene (ug/L)	Ethylbenzene (ug/L)	Total Xylenes (ug/L)	Depth to Water (ft BTOC)
MW01	8/25/1995	198	1480	146	2250	29.53
	11/8/1996	559	499	395	933	30.30
	2/10/1997	350	101	233	476	30.07
	5/8/1997	266	9.75	230	308	29.99
	8/5/1997	272	228	172	370	30.16
	11/4/1997	216	72.1	133	260	30.21
	2/3/1998	245	276	109	375	32.48
	5/7/1998	166	6.02	110	202	32.38
	8/4/1998	171	74.4	86.1	209	32.54
	11/3/1998	151	58.7	76.4	204	32.62
	2/2/1999	153	64.8	89.7	217	32.42
	5/19/1999	137	89.4	67.3	141	32.28
	8/4/1999	105	32.6	63	113	32.28
	11/9/1999	120	39	75	170	32.19
	2/25/2000	130	70	78	190	32.05
	5/24/2000	110	130	56	200	31.96
	8/1/2000	120	39	80	210	32.08
	11/6/2000	84	120	56	190	32.19
	2/12/2001	95	44	60	150	32.12
	5/30/2001	110	36	78	200	32.06
	8/7/2001	99	43	58	150	32.28
	12/4/2001	150	53	1	110	32.40
	2/25/2002	83	1	59	120	32.39
	5/14/2002	57	78	46	150	32.37
	11/4/2002	72.5	50	47	178.6	32.67
	5/19/2003	31.1	24.4	23.9	158	32.45
	11/15/2003	65.5	65	44.5	190	32.76
	5/11/2004	57.6	44.5	52.1	153	32.61
	11/16/2004	38	26.4	34.7	126	32.88
	5/18/2005	74	27.9	93.1	340	32.67
	8/23/2005	28.6	7	46.3	175	33.05
	11/8/2005	26.2	5.5	35.5	137	32.93
	2/23/2006	22.1	7.1	28.2	102	32.81
	5/23/2006	21.6	4.2	28.3	76.6	32.83
	8/23/2006	18.9	5	29.1	76.7	33.06

Note: Non Detects are represented by a value of 1.

TABLE 1

**SUMMARY OF BTEX COMPOUNDS IN GROUNDWATER SAMPLES
HAMNER #9 (METER #97213)**

Monitoring Well	Sample Date	Benzene (ug/L)	Toluene (ug/L)	Ethylbenzene (ug/L)	Total Xylenes (ug/L)	Depth to Water (ft BTOC)
MW01	11/8/2006	20.4	8.2	28.8	71.9	33.09
	2/26/2007	14.8	4.7	23.7	72.1	32.94
	5/24/2007	12.5	1.5	24.6	45.1	32.86
	8/21/2007	10.1	0.75	22.2	38	33.13
	11/13/2007	5.7	0.79	13.3	16.5	33.21
	2/12/2008	7.5	1.6	19.6	32.9	33.10
	5/8/2008	4.3	5.8	17.4	51	32.98
	8/26/2008	3.7	1.5	15.6	17.2	33.25
	11/6/2008	3.8	3.1	17.5	22.2	33.29
MW02	10/15/1999	1	1	1	1	29.57
	8/28/2000	1	1	1	1	31.65
	5/30/2001	1	1	1	1	31.57
	5/14/2002	1	1	1	1	31.85
MW03	10/15/1999	1	1	1	1	28.34
	8/28/2000	1	1	1	1	30.96
	5/30/2001	1	1	1	1	30.87
	6/13/2002	1	1	1	1	31.33
MW04	11/8/2006	1	0.28	1	0.36	30.32
	8/21/2007	1	1	1	1	30.31
	11/13/2007	1	1	1	1	30.41
	2/12/2008	1	1	1	1	30.31
	8/26/2008	1	1	1	1	30.42

Note: Non Detects are represented by a value of 1.